

No.Ft.48-1850/2009(FCA),
H.P. Forest Department.

From: Nodal Officer-cum-Addl.Pr.CCF (FCA)
O/o Pr.CCF, H.P, Shimla-1

To: The Regional Officer,
Integrated Regional Office GoI, MoEF&CC,
CGO Complex, Shivalik Khand, Longwood,
Shimla, Himachal Pradesh.

Dated Shimla-1, the **29 NOV 2022**

Subject: **Renewal of 0.4087 hectare of forest land for the extraction of slates in Mauza Kunar Tehsil Bharmour Chamba in favour of Shri Prakash Chand S/o Shri Sorma Ram VPO Kunr, Tehsil Dharwala & Distt. Chamba, Himachal Pradesh.**

Memo:

Kindly refer to your office letter No. FC/HPB/05/43/2022 dated 17.06.2022 on the subject cited above.

2 The pointwise reply to the observations as raised vide your above referred communication is submitted as below:-

1. (i) As per the approved Mining Plan the estimated capacity of production is 9500 MT, and average annual production is 1900MT. The work is carried out only over the proposed land for extraction of slates and as yet slate stone/mining mineral is available and reclamation over the mining shall be carried out after the closing of mining area. A document provided by Mining Officer Chamba regarding the detail of proposed and existing mining lease in district Chamba is uploaded as **Annexure-I**.
(ii) Landscape map showing the approved/proposed/existing mining projects for hill slopes mining in district is uploaded as **Annexure-II**.
(iii) Copy of District Survey Report supplied by Mining Officer Chamba is uploaded as **Annexure-III**.
2. DFO Bharmour submitted that, as yet no any area of proposed mining site is mined out, over the whole area extraction of mining mineral is being undertaken. The area of Dumping Site 0.4 hectare has been restored/reclaimed by providing the crates etc. as per the site requirement.
3. Post Reclamation Plan of proposed mining area prepared by State Geologist (Retd.) at the time of approval of mining plan, which to be implemented after the completion/closing of mining activities is uploaded as **Annexure-IV**. The reclamation of mining area shall be done by the user agency on his cost as per the direction of forest department.
4. Needful has been done on the MoEF portal by the User Agency.
5. Needful has been done on the MoEF portal by the User Agency.
6. The proposed land for renewal on of mining lease is wasteland declared as Protected Forest as per 1952 Notification.
7. Dimension of dumping yard is 30m x 21m., where wastes generated during/after extraction of slates shall be dumped. The same has already been mentioned in

- the component wise breakup in the MoEF portal. The estimated waste to be generated is 4000 MT.
8. NPV bill as per the latest guidelines have been revised by DFO Bharmour and copy of same is uploaded as **Annexure-xiii**.
 9. FRA certificate along with the record of all consultations and proceedings of FRC/Gram Sabha of all affected villages are uploaded as **Annexure-V**.
 10. It is submitted that the daily approximate extraction of slates (mining mineral) will be 6.3MT and these Mining mineral as detail given in the Mining Plan/Transportation Plan shall be shifted through mule from the mining site to the nearest road site.
 11. Letter of DFO (wildlife) showing the exact distance, instead of approximate distance as desired by the GoI, MoEF is uploaded as **Annexure-VI**.
 12. It is submitted that this proposal is for renewal of mining lease, and the proposal earlier for diversion of above mentioned land was accorded by the GoI, MOEF on dated 02.09.2010, and during the time there was no such guidelines to add the safety zone as component part for diversion of forest land whereas, the safety zone around the site 7.5 meters has been maintained. As this proposal is for renewal of mining lease and addition/changes in the forest land could not be made, i.e. the area of safety zone could not be added/mentioned against the component wise breakup in the online part-I.
 13. Geological plan prepared by State Geologist HP (retd.) during the approval of Mining Plan is uploaded as **Annexure-vii**.
 14. Necessary clarification regarding the distance from the road to proposed mining site given by Revenue Officer and authenticated by Mining Officer, Chamba is uploaded as **Annexure-viii**.
 15. Application for renewal of CTO along with payment has been submitted. The receipt/status application is uploaded as **Annexure-ix**. As and when approval is received shall be submitted to your office please.
 16. Application of extension of Letter of Intent has been submitted. Copy is uploaded as **Annexure-x**.
 17. It is submitted that, however the area is in hilly slopes, but the strata is very hard/rock, so cause the mining is not vulnerable to soil erosion. Further, it is assured that if any soil erosion is occurred shall be protected by the user agency at the cost as per the requirement. The undertaking to pay the cost of Soil Moisture Conservation is uploaded as **Annexure-xi**.
 18. The necessary correction has been made by DFO concerned in online Part-II against appropriate column. The undertaking to pay the cost of implementation of Wildlife management Plant is uploaded as **Annexure-xii**.

Yours faithfully,

Encls: As above:

Nodal Officer-cum-Addl.Pr.CCF (FCA)
O/o Pr.CCF, H.P, Shimla-1

Annexure-I

No. Udyog/Bhu/Chamba/ML/Prakash Chand/- 316
Office of the Mining Officer,
Chamba, Distt. Chamba (H.P.),
Dated, Chamba-176314

2-7-2022

To

Sh. Prakash Chand S/o Sh. Sorma Ram
Village & P.O. Kunr Tehsil &
Distt. Chamba H.P.

Sub: -

**Renewal of 0.4087 ha. Of forest land for the extraction of
Slates in Muaza Kunr Tehsil & Distt. Chamba in favour of
Shri Prakash Chand S/o Sh. Sorma Ram VPO Kunr
Tehsil and Distt. Chamba, within the jurisdiction of
Bharmaour forest Division Distt. Chamba H.P.**

Sir,

Please find enclosed herewith the photocopy of survey
document of District Chamba and mining leases in hill slope as required by you.

Enclosed:- As Above

Yours Faithfully,

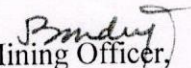
Mining Officer,
Chamba, Distt. Chamba

Prakash Chand Sorma S/o
Sh. Sorma Ram, V.P.O. Kunr, T.
Dharwala, Distt. Chamba (H.P.)
Pin-176324

Detail of Lease Holder in District Chamba Himachal Pradesh

Sr. no.	Name & Address of Mining Lease	Area (Bighas/Hect.)	Kh. No. Mouza/Mohal	Period of Mining Lease with date	Type (River Bed/Hill Slope)	Purpose of Lease (open sale/for crusher)	Name & style of Stone Crusher	Status of lease working/suspended /non working	Date of EIA Obtained
1.	Sh. Parkash Chand, S/o Sh. Soorma Ram, Vill. & P.O. Kunr, Tehsil & Distt. Chamba (H.P.)	0.414 Hectare	3026/2939/1 Kunr	14-01-11 to 13-01-2021	Hill Slope	Open		Under renewal	26-11-2016
2.	Smt. Rachya Devi w/o Sh. Roshan Lal VPO Kunr Tehsil & Chamba, H.P.	0.2186 Hectis	3026/2939/2 Kunr	20-02-2020 to 19-01-2030	Hill Slope	Open		Working	04-11-2016
3.	Sh. Neeraj Nayar S/o Sh. S. C. Nayar, Mohalla Bangotu, Tehsil & Chamba, H.P.	17-05 Bighas	1883/1579/1 Gehra	31-08-2020 to 30-08-2025	Hill Slope	Open		Working	29-09-2015
4.	Sh. Yogesh Kumar, S/o Sh. Jarno Ram, Village Batti-Hatti, P.O. Gehra, Tehsil & Distt. Chamba, H.P.	23-13-11 Bighas	1265/544/1, 1 244/598 Piura	04-08-2016 to 03-08-2021	Hill Slope	Open		Under renewal	30-04-2016
5.	GPA holder Sh. Shailender Thakur S/o Sh. Gian Chand, Village Lech, P.O. Gehra, Tehsil & Distt. Chamba, H.P.	3.7911 Hects	1823/1704/36 /1 Bhadour	30-05-2018 to 29-05-2023	Hill Slope	Open		Working	30-04-2016
6.	Sh. Chatter Singh, S/o Sh. Lehn Ram, Village Jawari P.O. Thanikothi, Tehsil Churah, Distt. Chamba, H.P.	2-00 Bighas	85/1,92 Jawari	29-03-2018 to 28-03-2023	Hill Slope	Open		Working	02-05-2017

(Signature)
Prakash Ch.
Sh. Soorma Ram

Dharwala, Distt. Chamba (H.P.)
Pin-176324

MINING OFFICER

LOCATION SHOWN ON SOI TOPOSHEET SLATE MINNING LEASE IN FAVOUR OF PARKASH CHAND S/O SH SORMA CHAND VILL AND P.O. KUNR DISTTIRIC CHAMBA (H.P.)

1. SLATE MINNING LEASE IN FAVOUR OF PARKASH CHAND S/O SH SORMA CHAND VILL AND P.O. KUNR DISST CHAMBA
2. SLATE MINNING LEASE IN FAVOUR SMT RACHYA DEVI W/O SH. ROSHAN LAL
3. SLATE MINNING LEASE IN FAVOUR OF GPA HOLDER SH. SHAILENDER THAKUR S/O SH. GAIAN CHAND
4. SLATE MINNING LEASE IN FAVOUR OF SMT CHANCHAL NAYYER
5. MINNING LEASE IN FAVOUR OF NEERAJ NAYAR S/O SH. S.C. NAYAR
6. SLATE MINNING IN FAVOUR OF SH. YOGESH KUMAR S/O SH JARMO RAM

India's 1st Map 1858 1871-1880 1891-1900 1901-1910 1911-1920 1921-1930 1931-1940 1941-1950 1951-1960 1961-1970 1971-1980 1981-1990 1991-2000 2001-2010 2011-2020 2021-2030 2031-2040 2041-2050 2051-2060 2061-2070 2071-2080 2081-2090 2091-2100 2101-2110 2111-2120 2121-2130 2131-2140 2141-2150 2151-2160 2161-2170 2171-2180 2181-2190 2191-2200 2201-2210 2211-2220 2221-2230 2231-2240 2241-2250 2251-2260 2261-2270 2271-2280 2281-2290 2291-2300 2301-2310 2311-2320 2321-2330 2331-2340 2341-2350 2351-2360 2361-2370 2371-2380 2381-2390 2391-2400 2401-2410 2411-2420 2421-2430 2431-2440 2441-2450 2451-2460 2461-2470 2471-2480 2481-2490 2491-2500 2501-2510 2511-2520 2521-2530 2531-2540 2541-2550 2551-2560 2561-2570 2571-2580 2581-2590 2591-2600 2601-2610 2611-2620 2621-2630 2631-2640 2641-2650 2651-2660 2661-2670 2671-2680 2681-2690 2691-2700 2701-2710 2711-2720 2721-2730 2731-2740 2741-2750 2751-2760 2761-2770 2771-2780 2781-2790 2791-2800 2801-2810 2811-2820 2821-2830 2831-2840 2841-2850 2851-2860 2861-2870 2871-2880 2881-2890 2891-2900 2901-2910 2911-2920 2921-2930 2931-2940 2941-2950 2951-2960 2961-2970 2971-2980 2981-2990 2991-3000 3001-3010 3011-3020 3021-3030 3031-3040 3041-3050 3051-3060 3061-3070 3071-3080 3081-3090 3091-3100 3101-3110 3111-3120 3121-3130 3131-3140 3141-3150 3151-3160 3161-3170 3171-3180 3181-3190 3191-3200 3201-3210 3211-3220 3221-3230 3231-3240 3241-3250 3251-3260 3261-3270 3271-3280 3281-3290 3291-3300 3301-3310 3311-3320 3321-3330 3331-3340 3341-3350 3351-3360 3361-3370 3371-3380 3381-3390 3391-3400 3401-3410 3411-3420 3421-3430 3431-3440 3441-3450 3451-3460 3461-3470 3471-3480 3481-3490 3491-3500 3501-3510 3511-3520 3521-3530 3531-3540 3541-3550 3551-3560 3561-3570 3571-3580 3581-3590 3591-3600 3601-3610 3611-3620 3621-3630 3631-3640 3641-3650 3651-3660 3661-3670 3671-3680 3681-3690 3691-3700 3701-3710 3711-3720 3721-3730 3731-3740 3741-3750 3751-3760 3761-3770 3771-3780 3781-3790 3791-3800 3801-3810 3811-3820 3821-3830 3831-3840 3841-3850 3851-3860 3861-3870 3871-3880 3881-3890 3891-3900 3901-3910 3911-3920 3921-3930 3931-3940 3941-3950 3951-3960 3961-3970 3971-3980 3981-3990 3991-4000 4001-4010 4011-4020 4021-4030 4031-4040 4041-4050 4051-4060 4061-4070 4071-4080 4081-4090 4091-4100 4101-4110 4111-4120 4121-4130 4131-4140 4141-4150 4151-4160 4161-4170 4171-4180 4181-4190 4191-4200 4201-4210 4211-4220 4221-4230 4231-4240 4241-4250 4251-4260 4261-4270 4271-4280 4281-4290 4291-4300 4301-4310 4311-4320 4321-4330 4331-4340 4341-4350 4351-4360 4361-4370 4371-4380 4381-4390 4391-4400 4401-4410 4411-4420 4421-4430 4431-4440 4441-4450 4451-4460 4461-4470 4471-4480 4481-4490 4491-4500 4501-4510 4511-4520 4521-4530 4531-4540 4541-4550 4551-4560 4561-4570 4571-4580 4581-4590 4591-4600 4601-4610 4611-4620 4621-4630 4631-4640 4641-4650 4651-4660 4661-4670 4671-4680 4681-4690 4691-4700 4701-4710 4711-4720 4721-4730 4731-4740 4741-4750 4751-4760 4761-4770 4771-4780 4781-4790 4791-4800 4801-4810 4811-4820 4821-4830 4831-4840 4841-4850 4851-4860 4861-4870 4871-4880 4881-4890 4891-4900 4901-4910 4911-4920 4921-4930 4931-4940 4941-4950 4951-4960 4961-4970 4971-4980 4981-4990 4991-5000 5001-5010 5011-5020 5021-5030 5031-5040 5041-5050 5051-5060 5061-5070 5071-5080 5081-5090 5091-5100 5101-5110 5111-5120 5121-5130 5131-5140 5141-5150 5151-5160 5161-5170 5171-5180 5181-5190 5191-5200 5201-5210 5211-5220 5221-5230 5231-5240 5241-5250 5251-5260 5261-5270 5271-5280 5281-5290 5291-5300 5301-5310 5311-5320 5321-5330 5331-5340 5341-5350 5351-5360 5361-5370 5371-5380 5381-5390 5391-5400 5401-5410 5411-5420 5421-5430 5431-5440 5441-5450 5451-5460 5461-5470 5471-5480 5481-5490 5491-5500 5501-5510 5511-5520 5521-5530 5531-5540 5541-5550 5551-5560 5561-5570 5571-5580 5581-5590 5591-5600 5601-5610 5611-5620 5621-5630 5631-5640 5641-5650 5651-5660 5661-5670 5671-5680 5681-5690 5691-5700 5701-5710 5711-5720 5721-5730 5731-5740 5741-5750 5751-5760 5761-5770 5771-5780 5781-5790 5791-5800 5801-5810 5811-5820 5821-5830 5831-5840 5841-5850 5851-5860 5861-5870 5871-5880 5881-5890 5891-5900 5901-5910 5911-5920 5921-5930 5931-5940 5941-5950 5951-5960 5961-5970 5971-5980 5981-5990 5991-6000 6001-6010 6011-6020 6021-6030 6031-6040 6041-6050 6051-6060 6061-6070 6071-6080 6081-6090 6091-6100 6101-6110 6111-6120 6121-6130 6131-6140 6141-6150 6151-6160 6161-6170 6171-6180 6181-6190 6191-6200 6201-6210 6211-6220 6221-6230 6231-6240 6241-6250 6251-6260 6261-6270 6271-6280 6281-6290 6291-6300 6301-6310 6311-6320 6321-6330 6331-6340 6341-6350 6351-6360 6361-6370 6371-6380 6381-6390 6391-6400 6401-6410 6411-6420 6421-6430 6431-6440 6441-6450 6451-6460 6461-6470 6471-6480 6481-6490 6491-6500 6501-6510 6511-6520 6521-6530 6531-6540 6541-6550 6551-6560 6561-6570 6571-6580 6581-6590 6591-6600 6601-6610 6611-6620 6621-6630 6631-6640 6641-6650 6651-6660 6661-6670 6671-6680 6681-6690 6691-6700 6701-6710 6711-6720 6721-6730 6731-6740 6741-6750 6751-6760 6761-6770 6771-6780 6781-6790 6791-6800 6801-6810 6811-6820 6821-6830 6831-6840 6841-6850 6851-6860 6861-6870 6871-6880 6881-6890 6891-6900 6901-6910 6911-6920 6921-6930 6931-6940 6941-6950 6951-6960 6961-6970 6971-6980 6981-6990 6991-7000 7001-7010 7011-7020 7021-7030 7031-7040 7041-7050 7051-7060 7061-7070 7071-7080 7081-7090 7091-7100 7101-7110 7111-7120 7121-7130 7131-7140 7141-7150 7151-7160 7161-7170 7171-7180 7181-7190 7191-7200 7201-7210 7211-7220 7221-7230 7231-7240 7241-7250 7251-7260 7261-7270 7271-7280 7281-7290 7291-7300 7301-7310 7311-7320 7321-7330 7331-7340 7341-7350 7351-7360 7361-7370 7371-7380 7381-7390 7391-7400 7401-7410 7411-7420 7421-7430 7431-7440 7441-7450 7451-7460 7461-7470 7471-7480 7481-7490 7491-7500 7501-7510 7511-7520 7521-7530 7531-7540 7541-7550 7551-7560 7561-7570 7571-7580 7581-7590 7591-7600 7601-7610 7611-7620 7621-7630 7631-7640 7641-7650 7651-7660 7661-7670 7671-7680 7681-7690 7691-7700 7701-7710 7711-7720 7721-7730 7731-7740 7741-7750 7751-7760 7761-7770 7771-7780 7781-7790 7791-7800 7801-7810 7811-7820 7821-7830 7831-7840 7841-7850 7851-7860 7861-7870 7871-7880 7881-7890 7891-7900 7901-7910 7911-7920 7921-7930 7931-7940 7941-7950 7951-7960 7961-7970 7971-7980 7981-7990 7991-8000 8001-8010 8011-8020 8021-8030 8031-8040 8041-8050 8051-8060 8061-8070 8071-8080 8081-8090 8091-8100 8101-8110 8111-8120 8121-8130 8131-8140 8141-8150 8151-8160 8161-8170 8171-8180 8181-8190 8191-8200 8201-8210 8211-8220 8221-8230 8231-8240 8241-8250 8251-8260 8261-8270 8271-8280 8281-8290 8291-8300 8301-8310 8311-8320 8321-8330 8331-8340 8341-8350 8351-8360 8361-8370 8371-8380 8381-8390 8391-8400 8401-8410 8411-8420 8421-8430 8431-8440 8441-8450 8451-8460 8461-8470 8471-8480 8481-8490 8491-8500 8501-8510 8511-8520 8521-8530 8531-8540 8541-8550 8551-8560 8561-8570 8571-8580 8581-8590 8591-8600 8601-8610 8611-8620 8621-8630 8631-8640 8641-8650 8651-8660 8661-8670 8671-8680 8681-8690 8691-8700 8701-8710 8711-8720 8721-8730 8731-8740 8741-8750 8751-8760 8761-8770 8771-8780 8781-8790 8791-8800 8801-8810 8811-8820 8821-8830 8831-8840 8841-8850 8851-8860 8861-8870 8871-8880 8881-8890 8891-8900 8901-8910 8911-8920 8921-8930 8931-8940 8941-8950 8951-8960 8961-8970 8971-8980 8981-8990 8991-9000 9001-9010 9011-9020 9021-9030 9031-9040 9041-9050 9051-9060 9061-9070 9071-9080 9081-9090 9091-9100 9101-9110 9111-9120 9121-9130 9131-9140 9141-9150 9151-9160 9161-9170 9171-9180 9181-9190 9191-9200 9201-9210 9211-9220 9221-9230 9231-9240 9241-9250 9251-9260 9261-9270 9271-9280 9281-9290 9291-9300 9301-9310 9311-9320 9321-9330 9331-9340 9341-9350 9351-9360 9361-9370 9371-9380 9381-9390 9391-9400 9401-9410 9411-9420 9421-9430 9431-9440 9441-9450 9451-9460 9461-9470 9471-9480 9481-9490 9491-9500 9501-9510 9511-9520 9521-9530 9531-9540 9541-9550 9551-9560 9561-9570 9571-9580 9581-9590 9591-9600 9601-9610 9611-9620 9621-9630 9631-9640 9641-9650 9651-9660 9661-9670 9671-9680 9681-9690 9691-9700 9701-9710 9711-9720 9721-9730 9731-9740 9741-9750 9751-9760 9761-9770 9771-9780 9781-9790 9791-9800 9801-9810 9811-9820 9821-9830 9831-9840 9841-9850 9851-9860 9861-9870 9871-9880 9881-9890 9891-9900 9901-9910 9911-9920 9921-9930 9931-9940 9941-9950 9951-9960 9961-9970 9971-9980 9981-9990 9991-10000



OPEN SERIES MAP

No. 143W7

Scale 1:50,000

143W2	143W6	143W10	143W14
143W3	143W7	143W11	143W15
143W4	143W8	143W12	143W16
143W5	143W9	143W13	143W17

सर्वेक्षण विभाग

SURVEY OF INDIA

CONVENTIONAL SYMBOLS

1. High Boundary	2. Low Boundary	3. Boundary of District	4. Boundary of Sub-District	5. Boundary of Taluk	6. Boundary of Panchayat	7. Boundary of Village	8. Boundary of Hamlet	9. Boundary of Settlement	10. Boundary of Road	11. Boundary of Railway	12. Boundary of Canal	13. Boundary of River	14. Boundary of Lake	15. Boundary of Pond	16. Boundary of Well	17. Boundary of Spring	18. Boundary of Waterfall	19. Boundary of Dam	20. Boundary of Barrage	21. Boundary of Lock	22. Boundary of Bridge	23. Boundary of Tunnel	24. Boundary of Viaduct	25. Boundary of Station	26. Boundary of Platform	27. Boundary of Goods Shed	28. Boundary of Warehouse	29. Boundary of Godown	30. Boundary of Mill	31. Boundary of Factory	32. Boundary of Workshop	33. Boundary of School	34. Boundary of College	35. Boundary of Hospital	36. Boundary of Post Office	37. Boundary of Police Station	38. Boundary of Court	39. Boundary of Jail	40. Boundary of Prison	41. Boundary of Fort	42. Boundary of Fortification	43. Boundary of Fortified Place	44. Boundary of Fortified Town	45. Boundary of Fortified Village	46. Boundary of Fortified Hamlet	47. Boundary of Fortified Settlement	48. Boundary of Fortified Road	49. Boundary of Fortified Railway	50. Boundary of Fortified Canal	51. Boundary of Fortified River	52. Boundary of Fortified Lake	53. Boundary of Fortified Pond	54. Boundary of Fortified Well	55. Boundary of Fortified Spring	56. Boundary of Fortified Waterfall	57. Boundary of Fortified Dam	58. Boundary of Fortified Barrage	59. Boundary of Fortified Lock	60. Boundary of Fortified Bridge	61. Boundary of Fortified Tunnel	62. Boundary of Fortified Viaduct	63. Boundary of Fortified Station	64. Boundary of Fortified Platform	65. Boundary of Fortified Goods Shed	66. Boundary of Fortified Warehouse	67. Boundary of Fortified Godown	68. Boundary of Fortified Mill	69. Boundary of Fortified Factory	70. Boundary of Fortified Workshop	71. Boundary of Fortified School	72. Boundary of Fortified College	73. Boundary of Fortified Hospital	74. Boundary of Fortified Post Office	75. Boundary of Fortified Police Station	76. Boundary of Fortified Court	77. Boundary of Fortified Jail	78. Boundary of Fortified Prison	79. Boundary of Fortified Fort	80. Boundary of Fortified Fortification	81. Boundary of Fortified Fortified Place	82. Boundary of Fortified Fortified Town	83. Boundary of Fortified Fortified Village	84. Boundary of Fortified Fortified Hamlet	85. Boundary of Fortified Fortified Settlement	86. Boundary of Fortified Fortified Road	87. Boundary of Fortified Fortified Railway	88. Boundary of Fortified Fortified Canal	89. Boundary of Fortified Fortified River	90. Boundary of Fortified Fortified Lake	91. Boundary of Fortified Fortified Pond	92. Boundary of Fortified Fortified Well	93. Boundary of Fortified Fortified Spring	94. Boundary of Fortified Fortified Waterfall	95. Boundary of Fortified Fortified Dam	96. Boundary of Fortified Fortified Barrage	97. Boundary of Fortified Fortified Lock	98. Boundary of Fortified Fortified Bridge	99. Boundary of Fortified Fortified Tunnel	100. Boundary of Fortified Fortified Viaduct	101. Boundary of Fortified Fortified Station	102. Boundary of Fortified Fortified Platform	103. Boundary of Fortified Fortified Goods Shed	104. Boundary of Fortified Fortified Warehouse	105. Boundary of Fortified Fortified Godown	106. Boundary of Fortified Fortified Mill	107. Boundary of Fortified Fortified Factory	108. Boundary of Fortified Fortified Workshop	109. Boundary of Fortified Fortified School	110. Boundary of Fortified Fortified College	111. Boundary of Fortified Fortified Hospital	112. Boundary of Fortified Fortified Post Office	113. Boundary of Fortified Fortified Police Station	114. Boundary of Fortified Fortified Court	115. Boundary of Fortified Fortified Jail	116. Boundary of Fortified Fortified Prison	117. Boundary of Fortified Fortified Fort	118. Boundary of Fortified Fortified Fortification	119. Boundary of Fortified Fortified Fortified Place	120. Boundary of Fortified Fortified Fortified Town	121. Boundary of Fortified Fortified Fortified Village	122. Boundary of Fortified Fortified Fortified Hamlet	123. Boundary of Fortified Fortified Fortified Settlement	124. Boundary of Fortified Fortified Fortified Road	125. Boundary of Fortified Fortified Fortified Railway	126. Boundary of Fortified Fortified Fortified Canal	127. Boundary of Fortified Fortified Fortified River	128. Boundary of Fortified Fortified Fortified Lake	129. Boundary of Fortified Fortified Fortified Pond	130. Boundary of Fortified Fortified Fortified Well	131. Boundary of Fortified Fortified Fortified Spring	132. Boundary of Fortified Fortified Fortified Waterfall	133. Boundary of Fortified Fortified Fortified Dam	134. Boundary of Fortified Fortified Fortified Barrage	135. Boundary of Fortified Fortified Fortified Lock	136. Boundary of Fortified Fortified Fortified Bridge	137. Boundary of Fortified Fortified Fortified Tunnel	138. Boundary of Fortified Fortified Fortified Viaduct	139. Boundary of Fortified Fortified Fortified Station	140. Boundary of Fortified Fortified Fortified Platform	141. Boundary of Fortified Fortified Fortified Goods Shed	142. Boundary of Fortified Fortified Fortified Warehouse	143. Boundary of Fortified Fortified Fortified Godown	144. Boundary of Fortified Fortified Fortified Mill	145. Boundary of Fortified Fortified Fortified Factory	146. Boundary of Fortified Fortified Fortified Workshop	147. Boundary of Fortified Fortified Fortified School	148. Boundary of Fortified Fortified Fortified College	149. Boundary of Fortified Fortified Fortified Hospital	150. Boundary of Fortified Fortified Fortified Post Office	151. Boundary of Fortified Fortified Fortified Police Station	152. Boundary of Fortified Fortified Fortified Court	153. Boundary of Fortified Fortified Fortified Jail	154. Boundary of Fortified Fortified Fortified Prison	155. Boundary of Fortified Fortified Fortified Fort	156. Boundary of Fortified Fortified Fortified Fortification	157. Boundary of Fortified Fortified Fortified Fortified Place	158. Boundary of Fortified Fortified Fortified Fortified Town	159. Boundary of Fortified Fortified Fortified Fortified Village	160. Boundary of Fortified Fortified Fortified Fortified Hamlet	161. Boundary of Fortified Fortified Fortified Fortified Settlement	162. Boundary of Fortified Fortified Fortified Fortified Road	163. Boundary of Fortified Fortified Fortified Fortified Railway	164. Boundary of Fortified Fortified Fortified Fortified Canal	165. Boundary of Fortified Fortified Fortified Fortified River	166. Boundary of Fortified Fortified Fortified Fortified Lake	167. Boundary of Fortified Fortified Fortified Fortified Pond	168. Boundary of Fortified Fortified Fortified Fortified Well	169. Boundary of Fortified Fortified Fortified Fortified Spring	170. Boundary of Fortified Fortified Fortified Fortified Waterfall	171. Boundary of Fortified Fortified Fortified Fortified Dam	172. Boundary of Fortified Fortified Fortified Fortified Barrage	173. Boundary of Fortified Fortified Fortified Fortified Lock	174. Boundary of Fortified Fortified Fortified Fortified Bridge	175. Boundary of Fortified Fortified Fortified Fortified Tunnel	176. Boundary of Fortified Fortified Fortified Fortified Viaduct	177. Boundary of Fortified Fortified Fortified Fortified Station	178. Boundary of Fortified Fortified Fortified Fortified Platform	179. Boundary of Fortified Fortified Fortified Fortified Goods Shed	180. Boundary of Fortified Fortified Fortified Fortified Warehouse	181. Boundary of Fortified Fortified Fortified Fortified Godown	182. Boundary of Fortified Fortified Fortified Fortified Mill	183. Boundary of Fortified Fortified Fortified Fortified Factory	184. Boundary of Fortified Fortified Fortified Fortified Workshop	185. Boundary of Fortified Fortified Fortified Fortified School	186. Boundary of Fortified Fortified Fortified Fortified College	187. Boundary of Fortified Fortified Fortified Fortified Hospital	188. Boundary of Fortified Fortified Fortified Fortified Post Office	189. Boundary of Fortified Fortified Fortified Fortified Police Station	190. Boundary of Fortified Fortified Fortified Fortified Court	191. Boundary of Fortified Fortified Fortified Fortified Jail	192. Boundary of Fortified Fortified Fortified Fortified Prison	193. Boundary of Fortified Fortified Fortified Fortified Fort	194. Boundary of Fortified Fortified Fortified Fortified Fortification	195. Boundary of Fortified Fortified Fortified Fortified Fortified Place	196. Boundary of Fortified Fortified Fortified Fortified Fortified Town	197. Boundary of Fortified Fortified Fortified Fortified Fortified Village	198. Boundary of Fortified Fortified Fortified Fortified Fortified Hamlet	199. Boundary of Fortified Fortified Fortified Fortified Fortified Settlement	200. Boundary of Fortified Fortified Fortified Fortified Fortified Road	201. Boundary of Fortified Fortified Fortified Fortified Fortified Railway	202. Boundary of Fortified Fortified Fortified Fortified Fortified Canal	203. Boundary of Fortified Fortified Fortified Fortified Fortified River	204. Boundary of Fortified Fortified Fortified Fortified Fortified Lake	205. Boundary of Fortified Fortified Fortified Fortified Fortified Pond	206. Boundary of Fortified Fortified Fortified Fortified Fortified Well	207
------------------	-----------------	-------------------------	-----------------------------	----------------------	--------------------------	------------------------	-----------------------	---------------------------	----------------------	-------------------------	-----------------------	-----------------------	----------------------	----------------------	----------------------	------------------------	---------------------------	---------------------	-------------------------	----------------------	------------------------	------------------------	-------------------------	-------------------------	--------------------------	----------------------------	---------------------------	------------------------	----------------------	-------------------------	--------------------------	------------------------	-------------------------	--------------------------	-----------------------------	--------------------------------	-----------------------	----------------------	------------------------	----------------------	-------------------------------	---------------------------------	--------------------------------	-----------------------------------	----------------------------------	--------------------------------------	--------------------------------	-----------------------------------	---------------------------------	---------------------------------	--------------------------------	--------------------------------	--------------------------------	----------------------------------	-------------------------------------	-------------------------------	-----------------------------------	--------------------------------	----------------------------------	----------------------------------	-----------------------------------	-----------------------------------	------------------------------------	--------------------------------------	-------------------------------------	----------------------------------	--------------------------------	-----------------------------------	------------------------------------	----------------------------------	-----------------------------------	------------------------------------	---------------------------------------	--	---------------------------------	--------------------------------	----------------------------------	--------------------------------	---	---	--	---	--	--	--	---	---	---	--	--	--	--	---	---	---	--	--	--	--	--	---	---	--	---	---	--	---	---	--	---	--	---	--	---	---	---	--	--	---	--	---	---	---	--	--	--	---	---	---	---	--	--	--	---	---	---	--	--	---	---	--	---	---	--	---	---	--	---	--	---	--	---	---	---	--	--	---	--	---	---	---	--	--	--	---	---	---	---	--	--	--	---	---	---	--	--	---	---	--	---	---	--	---	---	--	---	--	---	--	---	---	---	--	--	---	--	---	---	---	--	--	--	---	---	---	-----

Annexure - VII

- LEAD
- SURVEY STATION
- CONTOUR LINES
- APPROACH ROAD
- OLD WORKING PIT
- BENCH
- FACE OF DRAIN
- TOP SOIL DUMP
- CHECK DAM
- DRAIN
- PARAPET WALL
- ROAD LANE
- PLANTATION

	LEAD
	SURVEY STATION
	CONTOUR LINES
	APPROACH ROAD
	OLD WORKING PIT
	BENCH
	FACE OF DRAIN
	TOP SOIL DUMP
	CHECK DAM
	DRAIN
	PARAPET WALL
	ROAD LANE
	PLANTATION

SCALE	QUARRY
SH	PRANESH CHAND
1	500
2	1000
3	1500
4	2000
5	2500
6	3000
7	3500
8	4000
9	4500
10	5000

SHOWING PIT POSITION AT THE END OF

Pranesh Sharma
 B.Sc. Geology (Hons.)
 Shri Krishna College
 Dharwad

	SLATES
	DIP STRIKE
	SECTION LINES
	A
	B

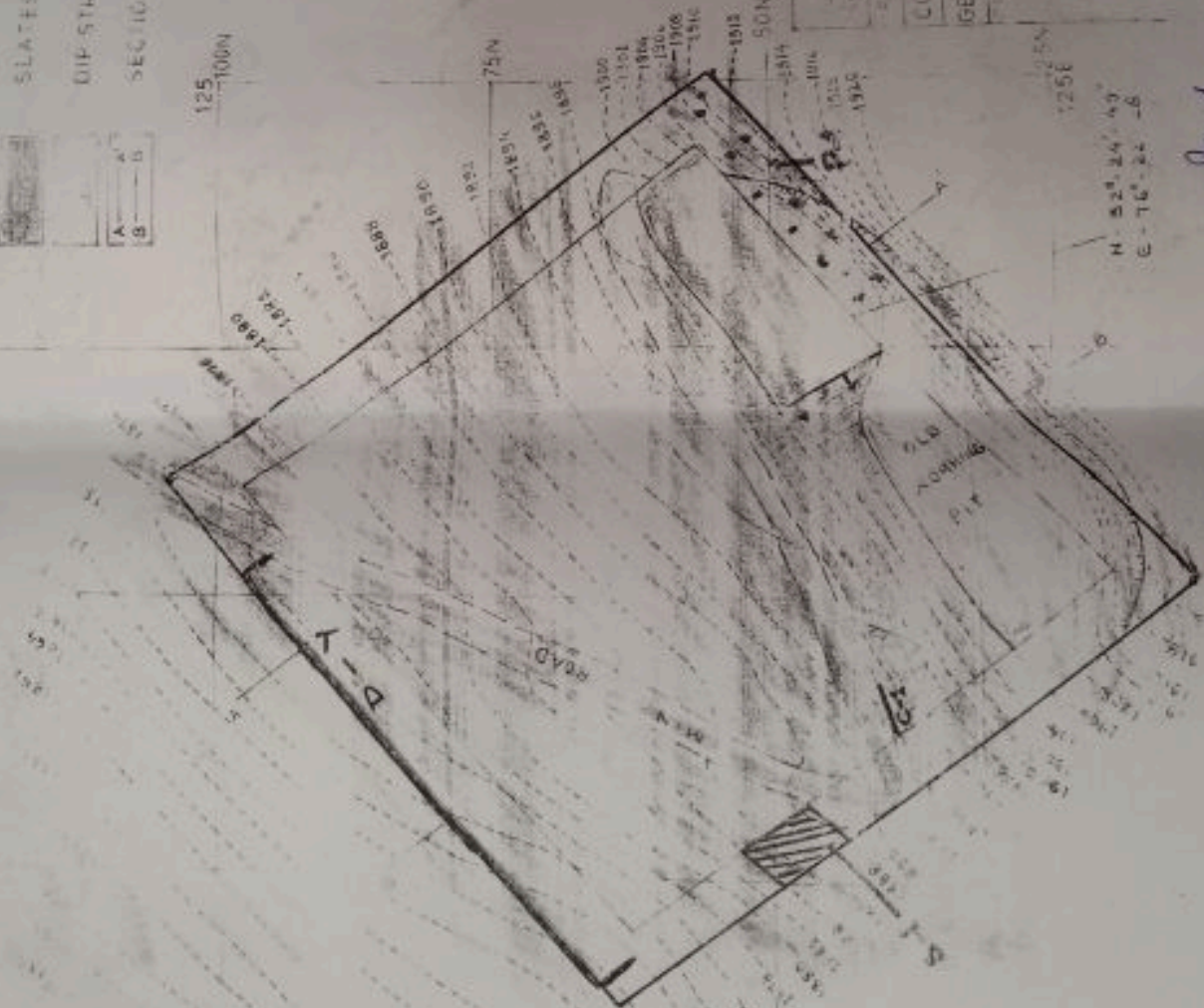

N - 32° 24' 49"
 E - 76° 22' 48"

Pranesh Sharma
 B.Sc. Geology (Hons.)
 Shri Krishna College
 Dharwad

Page 176/174

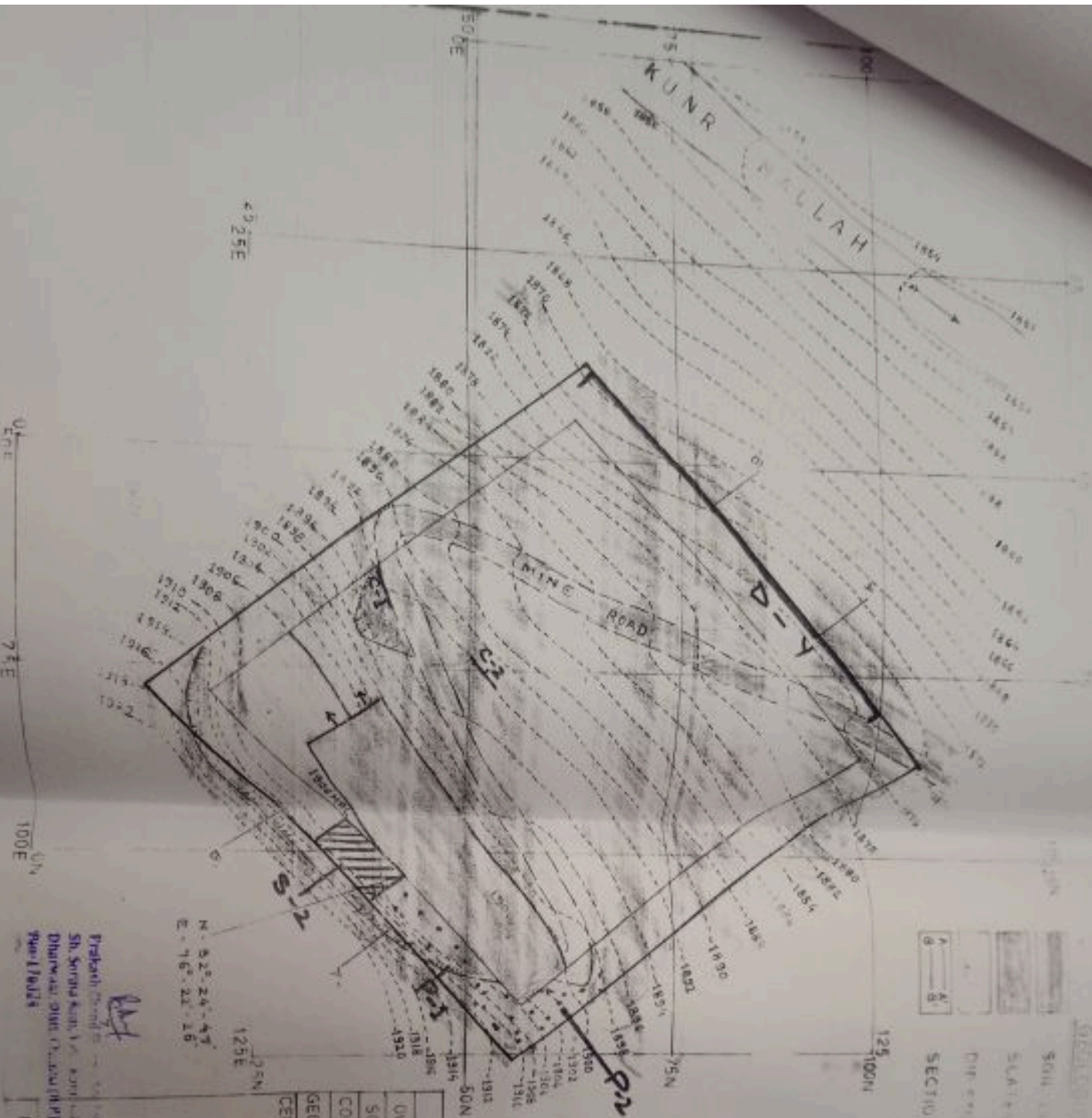

Prakash Singh
Sh. Suresh Kumar
Dharmendra Singh
1990/1991

PLATE NO.

Prakash Singh
Sh. Suresh Kumar
Dharmendra Singh
1990/1991

CERTIFIED THAT THE PLAN IS CORRECT

GEOLOGICAL PLAN SHOWING PIT POSITION AT THE END OF

CONTOUR INTERVAL : 2 METRS

SCALE : 1:500

OWNER : SH PRANASH CHAND

SLATE QUARRY

- LEASE BOUNDARY
- MINER'S STATION
- CONTOUR LINES
- APPROACH ROAD
- OLD WORKING PIT
- BENCH
- FACE ADVANCE
- 2-2
- 2-2
- CHECK DAM
- DRAIN
- PARAPET WALL
- DUMP YARD
- ELLEVATION

P-2

GEOLOGICAL INDEX

TOPOGRAPHICAL INDEX



SOIL COVER
SLATES
DIP STRIKE
SECTION LINES

125
100N

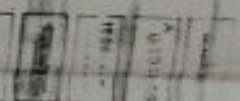

LEASE BOUNDARY
SURVEY STATION
CONTOUR LINES
APPROACH ROAD
OLD WORKING PIT
BENCH
FACE ADVANCE
TOP SOIL DUMP
CHECK DAM
DRAIN
PARAPET WALL
DUMP YARD
PLANTATION

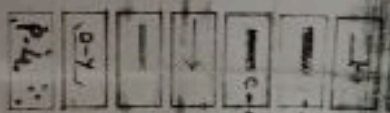

SLATE
QUARRY
OWNER: SH PRAKASH CHAND
SCALE: 1:500
CONTOUR INTERVAL: 2MTRS

GEOLOGICAL PLAN SHOWING PIT POSITION AT THE END OF A.I.H.
CERTIFIED THAT THE PLAN IS CORRECT.

Rajneesh S.I. 30/11/19
State Geologist (P&T)
Surveyor General
Surveyor Hills C.I.
Rajneesh S.I. 30/11/19
Rajneesh S.I. 30/11/19

0 50E 75E 100E
0N 50N 100N

25 25E

Prakash Chand Sharma S/o Late
Sh. Sornu Kaur, S/o Late Kaur, Loh,
Rajneesh S.I. 30/11/19
Rajneesh S.I. 30/11/19

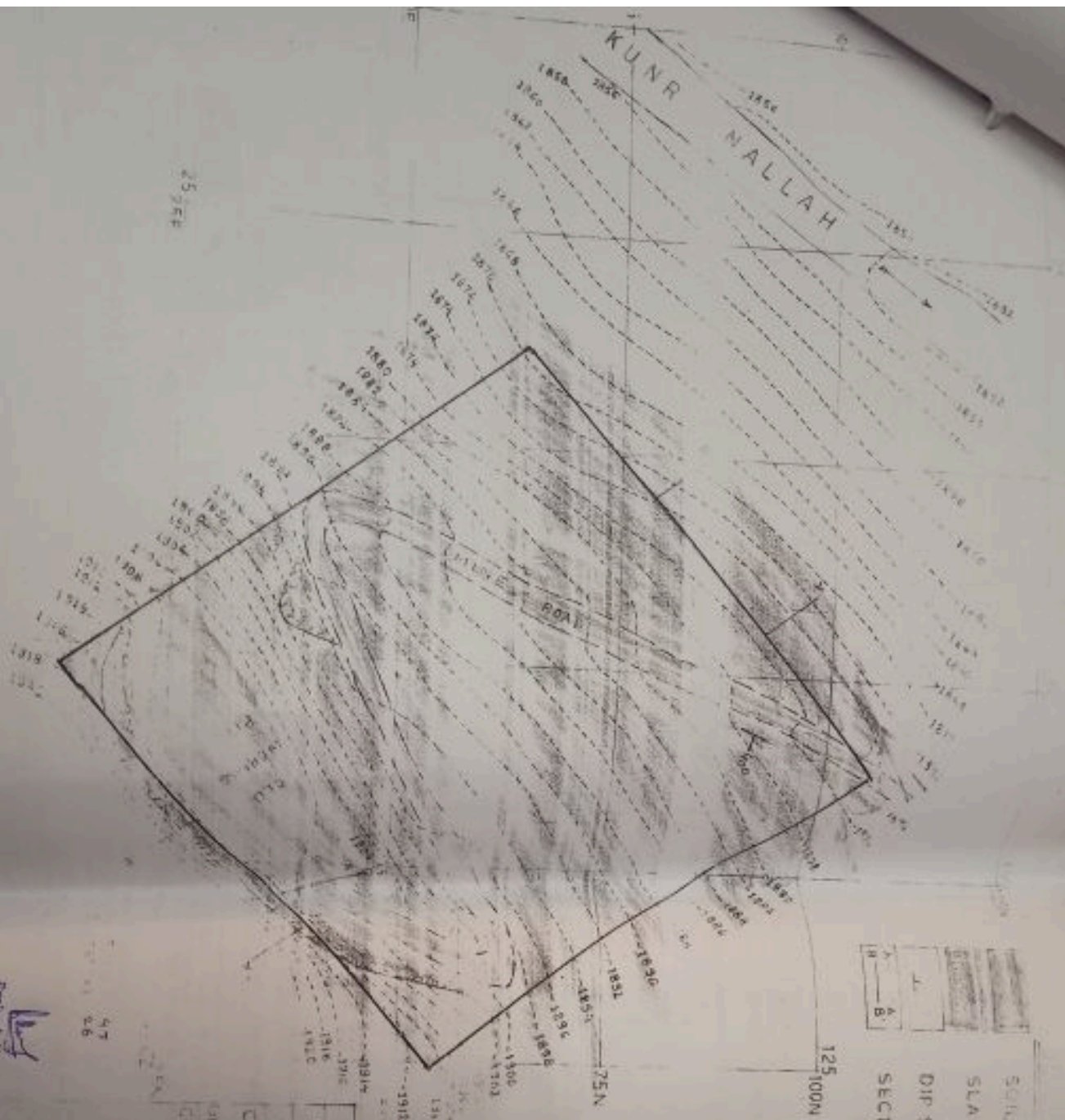

INDEX

SOIL COVER

SLATES

DIP STRIKE

SECTION LINES

LEASE BOUNDARY

SURVEY STATION

CONTOUR LINES

APPROACH ROAD

OLD WORKING PIT

SLATE QUARRY	
OWNER	SH. PRAKASH CHAND
SCALE	1:500
CONTOUR INTERVAL	2 METRS

RECOGNIZED PLAN SHOWING SURFACE FEATURE
CERTIFIED THAT THE PLAN IS CORRECT

MAHESHWARI SURVEYING
Sole Geologist (M. 601)
Strawberry College
Strawberry Hills, Co. to Dava, Sarab-2
Ropd No. HP/R.O.P/24/2019

Probable Survey No. 55-1-19
Sh. Surdas Nalla, Kunr Nallah
Dharmada, Dist. Chitauri (H.P.)
P.O. 170324



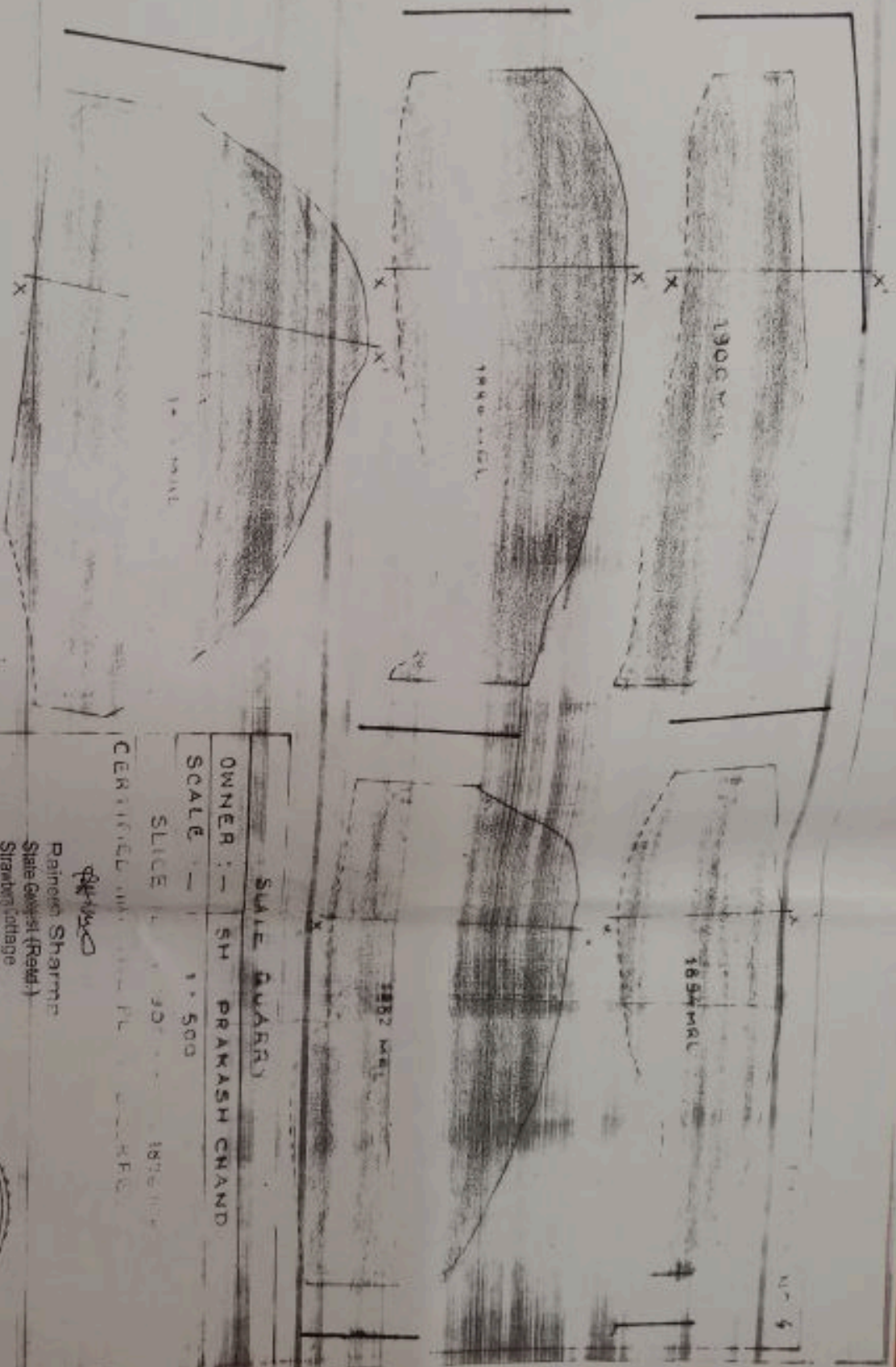

INDEX

SOIL COVER

SLATES

SECTION LINE

LEASE BOUNDARY

Prakash Chand S/o Mr. S/o Mr. Sh. Sornia Ram, Kari, Dharwala, Distt. Shimla (H.P.)
Pin-176324

CERTIFIED COPY OF PL. & MAP

SLATE QUARRY
OWNER :- SH. PRAKASH CHAND
SCALE :- 1:500
SLICE 1876/1877 1878/1879

Rajendra Sharma
State Geologist (Retd.)
Stranded (lodging)
Shriwasthi Chhola 3rd fl., Shimla-2
Reed No. 11 P.R.D.P. 74/2019



PLATE NO.

IV

PLATE NO: 10

WORKING AREA DURING FIRST YEAR

DO	2ND
DO	3RD
DO	4TH
DO	5TH
DO	6TH
DO	7TH
DO	8TH
DO	9TH
DO	10TH
DO	11TH
DO	12TH
DO	13TH
DO	14TH
DO	15TH
DO	16TH
DO	17TH
DO	18TH
DO	19TH
DO	20TH
DO	21TH
DO	22TH
DO	23TH
DO	24TH
DO	25TH
DO	26TH
DO	27TH
DO	28TH
DO	29TH
DO	30TH
DO	31TH
DO	32TH
DO	33TH
DO	34TH
DO	35TH
DO	36TH
DO	37TH
DO	38TH
DO	39TH
DO	40TH
DO	41TH
DO	42TH
DO	43TH
DO	44TH
DO	45TH
DO	46TH
DO	47TH
DO	48TH
DO	49TH
DO	50TH
DO	51TH
DO	52TH
DO	53TH
DO	54TH
DO	55TH
DO	56TH
DO	57TH
DO	58TH
DO	59TH
DO	60TH
DO	61TH
DO	62TH
DO	63TH
DO	64TH
DO	65TH
DO	66TH
DO	67TH
DO	68TH
DO	69TH
DO	70TH
DO	71TH
DO	72TH
DO	73TH
DO	74TH
DO	75TH
DO	76TH
DO	77TH
DO	78TH
DO	79TH
DO	80TH
DO	81TH
DO	82TH
DO	83TH
DO	84TH
DO	85TH
DO	86TH
DO	87TH
DO	88TH
DO	89TH
DO	90TH
DO	91TH
DO	92TH
DO	93TH
DO	94TH
DO	95TH
DO	96TH
DO	97TH
DO	98TH
DO	99TH
DO	100TH

SLATE QUARRY

OWNER : —

SH. PRAKASH HAND

CERTIFIED THAT THE PLANNED WORKING AREA IS CORRECT

Signature

Rajneesh Sharma
State Geologist (Reid)
Strawberry Cottage
Strawberry Hills, Chitoda Strath, Shimla-2
Regd. No.: H.P.R.O.P/24/2019



PLATE NO: 1

A

WORKING SEC ALONG X-Y

INDEX

- SOIL COVER
- SLATE
- BENCH
- LEASE BOUNDARY

Prakash
Sh. Soni
Dhar...
Pun-176

SURVEY DOCUMENT

STUDY ON THE DRAINAGE SYSTEM,
MINERAL POTENTIAL AND FEASIBILITY OF
MINING IN RIVER/ STREAM BEDS OF
DISTRICT CHAMBA, HIMACHAL PRADESH.

(SARIT CHANDER)
Assistant-Geologist
Geological Wing
Department of Industries
Shimla Himachal Pradesh

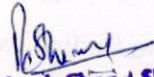
Prakash Chand Sharma S/o Late
Ch. Sorma Ram, V.P.O. Kaur, Teh.
Dharwala, Distt. Chamba (H.P.)
Pin-176324

a) **Geomorphological studies:**

- i) Place of origin
- ii) Catchment area
- iii) General profile of river stream
- iv) Annual deposition factor
- v) Replenishment
- vi) Total potential of minor minerals in the river bed.

b) **Geological Studies:**

- i) Lithology of catchment area
- ii) Tectonics and structural behaviour of rocks.

c) **Climatic parameters:**

- I) Intensity of rainfall.
- II) Climate zone.
- III) Temperature variation.

2) **BRIEF HISTORY OF THE DISTRICT:**

Chamba district in the state of Himachal Pradesh, in northern India. According to the 2001 Indian census the town is situated on the banks of the Ravi River (a major tributary of the Trans-Himalayan Indus River), at its confluence with the Sal River. Chambial were the Rulers of Chamba State ^[1] Chambials use suffix Varmans.

Though historical records date the history of the Chamba region to the Kolian tribes in the 2nd century BC, the area was formally ruled by the Maru dynasty, starting with the Raju Maru from around 500 AD, ruling from the ancient capital of Bharmour, which is located 75 kilometres (47 mi) from the town of Chamba. In 920, Raja Sahil Varman (or Raja Sahil Verma) shifted the capital of the kingdom to Chamba, following the specific request of his daughter Champavati (Chamba was named after her). From the time of Raju Maru, 67 Rajas of this dynasty have ruled over Chamba until it finally merged with the Indian Union in April 1948.

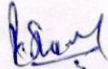
Rakash Choudhary S/o Late
Sh. Sorina Ram, V.P.O. Kuar, Teh.
Dharwala, Distt. Chamba (H.P.)
Pin-176324

Languages Spoken	Pahari(Chambyali), Punjabi, Hindi
Culture	Traditional and Pahari
Traditions	Religious
Art Forms	Chamba Rumal
Administrative Setup	
No. of Sub-Divisions	6
No. of Tehsils	7
No. of Sub-Tehsils	3
Development Blocks	7
Panchayats	283
Census Town	1 (Chamba) As per Census 2011

The district has varying altitude ranging from 609 to 6402 m above mean sea level, with some plain areas touching Pathankot district of Punjab in the south and Kangra district of H.P. in the South. In the East it touches Lahal Spiti district, in North with Jammu and Kashmir. The Ravi is the main river of Chamba district and is the heart and soul of the Chambyals. With its tributaries, it drains the whole of Chamba valley proper between Dhauladhar and Pangi range and thus commands the largest and most important part of the district. The river originates from Bara Bangahal area of Dhauladhar. The Main tributaries of Ravi are Budhil, Tundah, Beljedi, Sal, Siul, Siowa The river Chenab or Chandrabhaga rises from the mountains of Baralacha pass by two heads, the stream with its source on south-eastern side of the pass being called the Chandra and the other one which rises from north-western side is called the Bhaga. After the confluence of these two sister streams at Tandi, the river is generally known as Chenab. There are no large-sized lakes in Chamba district. However, a few water bodies namely Khajjiar Lake. The district with respect to revenue control has been divided into seven Tehsils and three sub-Tehsils. There are 283 Gram Panchayats.

3.2 Physiographical conditions

Introduction:-

The area in general is a part of the Lesser Himalaya. The lesser Himalaya, located in northwestern India in the States of Himachal Pradesh and Uttar Pradesh, in north-central India in the State of Sikkim, and in northeastern India in the State of Arunachal Pradesh, ranges from 1,500 to 5,000 metres in height. Terrains of the area are rugged and there is no. of steep sided valley and

Prakash Chand Sharma S/o Late
Sh. Sornu Kam. V.P.O. Kunt, Teh.
Dharwaia, Distt. Chamba (H.P.)
Pin-176324

The district can be divided into three distinct zones as per slope (Figure 4)

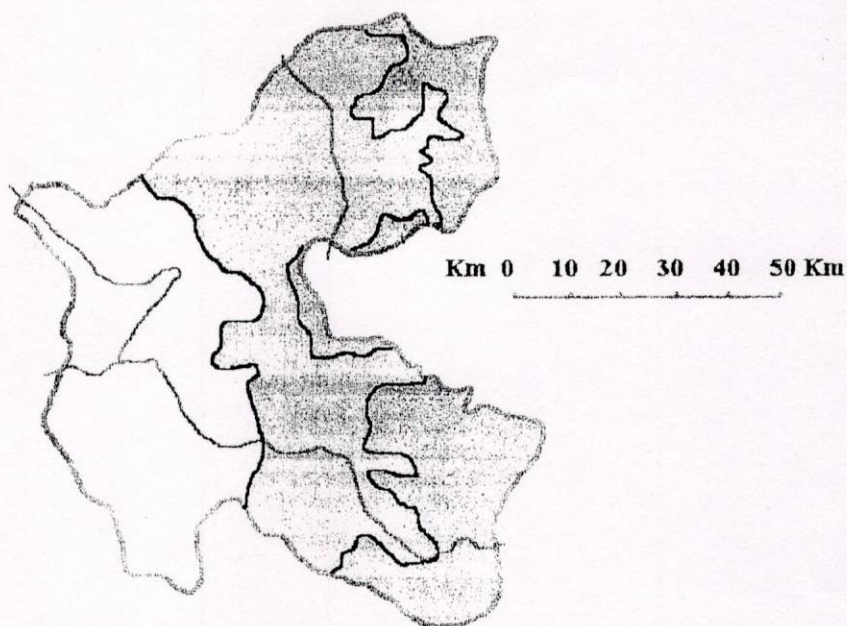

1. 400 -600 meters/km
2. 250 - 400 meters/km
3. Less than 250 meters/km

Slope Map of District Chamba

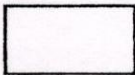
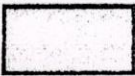

INDEX

Slope (In Meter per Km

	Less than 250
	250 - 400
	400 - 600



Prakash Chand Sharma S/o Late
Sh. Sorma Rao, V.P.O. Kumbhari
Dharwala, Distt. Chamba (H.P.)
Pin-176324

Fig:- 5:

Geological Map of the Himachal Pradesh

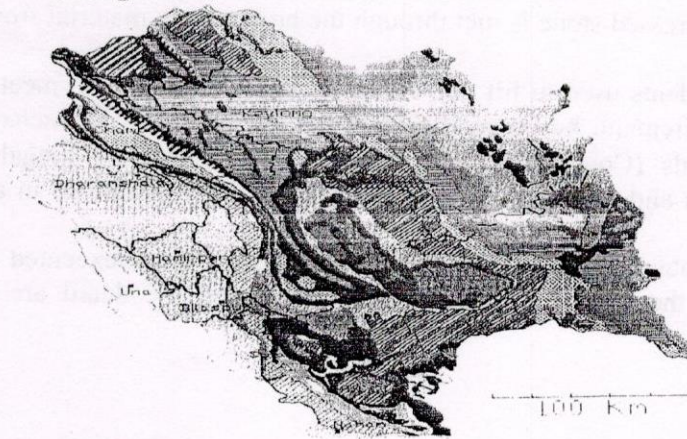

INDEX

Alluvium Deposit	
Siwalik Group	
Nako Granitoid	
Sirmour Group	
Guimal- Chikam Formation	
Spitti Formation	
Lilang Group	Tandi Group
Panjal Volcanics	Kalhel Group
Lipak/Po/Gamchidam/Takcha/ Muth/Thango	Salooni Formation
Tal Formation	Kunzam La Formation
Infra Krol- Krol	Katargali Formation
Dalhousie-Mandi-Karsog-Rohtang-Rackcham-Hanuman Tibba-Dhauladhar Granitoid	Batal Formation
Blaini Formation	Manjir Formation
Shimla Group	Chamba Formation
Shali Group	Jaunsar Formation
Largi Group	Salkhala Formation
Mandi Darla Volcanics	Deoban Group
Sundernagar Group	Dharagad Group
Kharsali	Rampur Group
Kullu Group	
Chaur - Kainchawa Granitoid	
Jutog Group	
Jeori Wangtu basement Complex	

15. Over view of Mining Activity of District Chamba:

Mainly three types of minor mineral constituents such as sand, stone and bajri are required for any type of construction apart from other material like cement and steel. In earlier times, the houses/ buildings were constructed in form of small dwellings with walls made up of mud plaster, stone and interlocking provided with wooden frames and there were negligible commercial as well as developmental activities resulting in less demand of building material. However with the passage of time, new vistas of developmental activities were started. As such the demand of minor minerals in the District started an increasing trend due to construction of Hydro projects. In order to meet the requirement of raw material for construction, the extraction of sand, stone and bajri is being carried

Prakash Chand Sharma
Prakash Chand Sharma S/o Late
Sh. Sorma K • **Kurr, Teh.**
Dharwala, Dist. • **Chamba (H.P.)**
Pin-176324

4	Sh. S.C. Nayar, Mohalla Bangotu, Chamba, H.P.	Nayar S/o Sh. S.C. Nayar, Mohalla Bangotu, Chamba, H.P.	Hects		Slope)
5	Sh. Chanchal Nayar W/o Sh. S.C. Nayar, Mohalla Bangotu, Chamba, H.P.	Sh. Chanchal Nayar W/o Sh. S.C. Nayar, Mohalla Bangotu, Chamba, H.P.	0.495 Hects.	<u>Govt. Land</u>	(Hill Slope)
6	M/s A.K. Slate Co., Vill. Jawari, Tehsil Churah, Chamba, H.P.	M/s A.K. Slate Co., Vill. Jawari, Tehsil Churah, Chamba, H.P.	0.167 Hects.	<u>Govt. Land</u>	(Hill Slope)
7	Sh. D.S. Thakur S/o Sh. Kripa Ram, V. & P.O. Kandla, Chamba, H.P.	M/s Thakur Stone Crusher, Kandla.	1.911 Hects.	<u>Govt. Land</u>	Siul River
8	Sh. D.S. Thakur S/o Sh. Kripa Ram, V. & P.O. Kandla, Chamba, H.P.	M/s Thakur Stone Crusher, Kandla.	<u>23-13-11</u> <u>Bighas</u>	Chamera Reservoir of NHPC, Stage-1	Siul River
9	Sh. Amar Chand S/o Sh. Laxmi Dhar, Vill. Lachori, P.O. Thakri Matti, Chamba, H.P.	M/s A.C. Stone Crusher, Lachhori,	0.748 Hects.	Chamera Reservoir of NHPC, Stage-1	Siul River
10	Sh. Amar Chand S/o Sh. Laxmi Dhar, Vill. Lachori, P.O. Thakri Matti, Chamba, H.P.	M/s A.C. Stone Crusher, Lachhori,	1.074 Hects.	Chamera Reservoir of NHPC, Stage-1	Siul River
11	Sh. Pawan Kumar, S/o Sh. Munshi Ram, Vill. Kolar Jolna, P.O. Jolna, Teh. Bhattiyat, Chamba, H.P.	M/s Nagbintru Stone Crusher, Kolar Jolna.	1.327 Hects.		(Hill Slope)
12	M/s Kartik Stone Crusher, Vill. Machhetar, P.O.	M/s Kartik Stone Crusher,	<u>05-06</u> <u>Bighas</u>	<u>Private</u> <u>Land</u>	(Hill Slope)

		H.P.			
19	Sh. Amar Chand S/o Sh. Laxmi Dhar, Vill. Lachori, P.O. Thakri Matti, Chamba, H.P.	Sh. Amar Chand S/o Sh. Laxmi Dhar, Vill. Lachori, P.O. Thakri Matti, Chamba, H.P.	16.1898 Hects.	Reservor area of NIIPC, Stage-	Siul Khad

16. Detail of Royalty and Production of Minor Mineral of Chamba District.

Mainly three types of minor mineral constituents such as sand stone and bajri are the main constituents required for the modern construction/developmental activities apart from other material like cement and steel. As such the demand of minor mineral in the District started an increasing trend. In order to meet the requirement of raw material for construction, the extraction of sand, stone and bajri is being carried out exclusively from the river beds. The increase could be gauged from the fact that during 2011-12 the royalty receipt on minor mineral was merely 58,94,528 l which has now been increased to 1,76,07,318 . The royalty received since 2011-12 onwards is tabulated in the following table.

Table -6:

Sr No.	Year	Royalty in laes	Production of mineral (in Metric tonne)
1	2011-12	58.9	294726
2	2012-13	83.9	207834
3	2013-14	91.6	229130
4	2014-15	77.3	193395
5	2015-16	183.0	305060
6	2016-17	176.0	293455

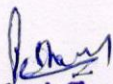
Prakash Chand Sharma S/o Late
Sh. Sorma Ram, V.P.O. Kurr, Teh.
Dharwala, Distt. Chamba (H.P.)
Pin-176324



कार्यालय ग्राम पंचायत कूर विकास खंड मैहला जिला चम्बा हि.प्र.

प्रस्ताव संख्या- 15

उपस्थिति - पूर्ण

आज दिनांक 24/07/2022 को ग्राम पंचायत कूर में ग्राम सभा बैठक आयोजन किया गया जिसकी अध्यक्षता प्रधान श्रीमती कल्पना देवी ने की और निम्नलिखित कार्यवाही प्रस्तावित हुई।

विषय - खनन पट्टा नवीनीकरण हेतु अनापत्ति प्रमाण पत्र बारे।

यह कि अध्यक्ष ने सभा सम्मुख प्रस्ताव रखा कि पंचायत को प्रकाश चंद पुत्र सोरमा का आवेदन खसरा न० 3026/2939 तदादी मौजा कूर 5-1-0 का खनन पट्टा नवीनीकरण की अनापत्ति हेतु प्राप्त हुआ है। जो कि खनन पट्टा स्वीकृत है जिसमे स्थानीय लोगों को रोजगार मिलता है। प्रार्थी पट्टा नवीनीकरण करवाना चाहता है, अतः सभा इस पर विचार करे बाद विचार के सभा ने सर्व सम्मति से पारित किया कि सभा को इससे कोई आपत्ति नहीं है।

यह भी पारित किया कि प्रमाणित प्रस्ताव आगामी कार्यवाही हेतु श्रीमान भू-विज्ञानी शिमला जी की सेवा में भेजा जाता है।

प्रमाणित किया जाता है कि प्रस्ताव प्रतिलिपि असल अनुसार सही है



पंचायत सचिव
ग्राम पंचायत कूर

Prakash Chandel Sharma
Sh. Sorma Ram, V.P.O. Kura
Dharwala, Distt. Chamba (H.P.)
Pin-176

रत्नगिरि ध्यानराव

Deer

निष्ठादित्त कार्य का दिवरण

9

11/10/20, 12/10/20, 13/10/20, 14/10/20, 15/10/20, 16/10/20, 17/10/20, 18/10/20, 19/10/20, 20/10/20, 21/10/20, 22/10/20, 23/10/20, 24/10/20, 25/10/20, 26/10/20, 27/10/20, 28/10/20, 29/10/20, 30/10/20, 31/10/20, 1/11/20, 2/11/20, 3/11/20, 4/11/20, 5/11/20, 6/11/20, 7/11/20, 8/11/20, 9/11/20, 10/11/20, 11/11/20, 12/11/20, 13/11/20, 14/11/20, 15/11/20, 16/11/20, 17/11/20, 18/11/20, 19/11/20, 20/11/20, 21/11/20, 22/11/20, 23/11/20, 24/11/20, 25/11/20, 26/11/20, 27/11/20, 28/11/20, 29/11/20, 30/11/20, 1/12/20, 2/12/20, 3/12/20, 4/12/20, 5/12/20, 6/12/20, 7/12/20, 8/12/20, 9/12/20, 10/12/20, 11/12/20, 12/12/20, 13/12/20, 14/12/20, 15/12/20, 16/12/20, 17/12/20, 18/12/20, 19/12/20, 20/12/20, 21/12/20, 22/12/20, 23/12/20, 24/12/20, 25/12/20, 26/12/20, 27/12/20, 28/12/20, 29/12/20, 30/12/20, 31/12/20, 1/1/21, 2/1/21, 3/1/21, 4/1/21, 5/1/21, 6/1/21, 7/1/21, 8/1/21, 9/1/21, 10/1/21, 11/1/21, 12/1/21, 13/1/21, 14/1/21, 15/1/21, 16/1/21, 17/1/21, 18/1/21, 19/1/21, 20/1/21, 21/1/21, 22/1/21, 23/1/21, 24/1/21, 25/1/21, 26/1/21, 27/1/21, 28/1/21, 29/1/21, 30/1/21, 31/1/21, 1/2/21, 2/2/21, 3/2/21, 4/2/21, 5/2/21, 6/2/21, 7/2/21, 8/2/21, 9/2/21, 10/2/21, 11/2/21, 12/2/21, 13/2/21, 14/2/21, 15/2/21, 16/2/21, 17/2/21, 18/2/21, 19/2/21, 20/2/21, 21/2/21, 22/2/21, 23/2/21, 24/2/21, 25/2/21, 26/2/21, 27/2/21, 28/2/21, 29/2/21, 30/2/21, 1/3/21, 2/3/21, 3/3/21, 4/3/21, 5/3/21, 6/3/21, 7/3/21, 8/3/21, 9/3/21, 10/3/21, 11/3/21, 12/3/21, 13/3/21, 14/3/21, 15/3/21, 16/3/21, 17/3/21, 18/3/21, 19/3/21, 20/3/21, 21/3/21, 22/3/21, 23/3/21, 24/3/21, 25/3/21, 26/3/21, 27/3/21, 28/3/21, 29/3/21, 30/3/21, 1/4/21, 2/4/21, 3/4/21, 4/4/21, 5/4/21, 6/4/21, 7/4/21, 8/4/21, 9/4/21, 10/4/21, 11/4/21, 12/4/21, 13/4/21, 14/4/21, 15/4/21, 16/4/21, 17/4/21, 18/4/21, 19/4/21, 20/4/21, 21/4/21, 22/4/21, 23/4/21, 24/4/21, 25/4/21, 26/4/21, 27/4/21, 28/4/21, 29/4/21, 30/4/21, 1/5/21, 2/5/21, 3/5/21, 4/5/21, 5/5/21, 6/5/21, 7/5/21, 8/5/21, 9/5/21, 10/5/21, 11/5/21, 12/5/21, 13/5/21, 14/5/21, 15/5/21, 16/5/21, 17/5/21, 18/5/21, 19/5/21, 20/5/21, 21/5/21, 22/5/21, 23/5/21, 24/5/21, 25/5/21, 26/5/21, 27/5/21, 28/5/21, 29/5/21, 30/5/21, 1/6/21, 2/6/21, 3/6/21, 4/6/21, 5/6/21, 6/6/21, 7/6/21, 8/6/21, 9/6/21, 10/6/21, 11/6/21, 12/6/21, 13/6/21, 14/6/21, 15/6/21, 16/6/21, 17/6/21, 18/6/21, 19/6/21, 20/6/21, 21/6/21, 22/6/21, 23/6/21, 24/6/21, 25/6/21, 26/6/21, 27/6/21, 28/6/21, 29/6/21, 30/6/21, 1/7/21, 2/7/21, 3/7/21, 4/7/21, 5/7/21, 6/7/21, 7/7/21, 8/7/21, 9/7/21, 10/7/21, 11/7/21, 12/7/21, 13/7/21, 14/7/21, 15/7/21, 16/7/21, 17/7/21, 18/7/21, 19/7/21, 20/7/21, 21/7/21, 22/7/21, 23/7/21, 24/7/21, 25/7/21, 26/7/21, 27/7/21, 28/7/21, 29/7/21, 30/7/21, 1/8/21, 2/8/21, 3/8/21, 4/8/21, 5/8/21, 6/8/21, 7/8/21, 8/8/21, 9/8/21, 10/8/21, 11/8/21, 12/8/21, 13/8/21, 14/8/21, 15/8/21, 16/8/21, 17/8/21, 18/8/21, 19/8/21, 20/8/21, 21/8/21, 22/8/21, 23/8/21, 24/8/21, 25/8/21, 26/8/21, 27/8/21, 28/8/21, 29/8/21, 30/8/21, 1/9/21, 2/9/21, 3/9/21, 4/9/21, 5/9/21, 6/9/21, 7/9/21, 8/9/21, 9/9/21, 10/9/21, 11/9/21, 12/9/21, 13/9/21, 14/9/21, 15/9/21, 16/9/21, 17/9/21, 18/9/21, 19/9/21, 20/9/21, 21/9/21, 22/9/21, 23/9/21, 24/9/21, 25/9/21, 26/9/21, 27/9/21, 28/9/21, 29/9/21, 30/9/21, 1/10/21, 2/10/21, 3/10/21, 4/10/21, 5/10/21, 6/10/21, 7/10/21, 8/10/21, 9/10/21, 10/10/21, 11/10/21, 12/10/21, 13/10/21, 14/10/21, 15/10/21, 16/10/21, 17/10/21, 18/10/21, 19/10/21, 20/10/21, 21/10/21, 22/10/21, 23/10/21, 24/10/21, 25/10/21, 26/10/21, 27/10/21, 28/10/21, 29/10/21, 30/10/21, 1/11/21, 2/11/21, 3/11/21, 4/11/21, 5/11/21, 6/11/21, 7/11/21, 8/11/21, 9/11/21, 10/11/21, 11/11/21, 12/11/21, 13/11/21, 14/11/21, 15/11/21, 16/11/21, 17/11/21, 18/11/21, 19/11/21, 20/11/21, 21/11/21, 22/11/21, 23/11/21, 24/11/21, 25/11/21, 26/11/21, 27/11/21, 28/11/21, 29/11/21, 30/11/21, 1/12/21, 2/12/21, 3/12/21, 4/12/21, 5/12/21, 6/12/21, 7/12/21, 8/12/21, 9/12/21, 10/12/21, 11/12/21, 12/12/21, 13/12/21, 14/12/21, 15/12/21, 16/12/21, 17/12/21, 18/12/21, 19/12/21, 20/12/21, 21/12/21, 22/12/21, 23/12/21, 24/12/21, 25/12/21, 26/12/21, 27/12/21, 28/12/21, 29/12/21, 30/12/21, 1/1/22, 2/1/22, 3/1/22, 4/1/22, 5/1/22, 6/1/22, 7/1/22, 8/1/2

18 6/11/19 19 20 21 22 23 24 25 26 27 28 29 30 31 32 33 34 35 36 37 38 39 40 41 42 43 44 45 46 47 48 49 50 51 52 53 54 55 56 57 58 59 60 61 62 63 64 65 66 67 68 69 70 71 72 73 74 75 76 77 78 79 80 81 82 83 84 85 86 87 88 89 90 91 92 93 94 95 96 97 98 99 100 101 102 103 104 105 106 107 108 109 110 111 112 113 114 115 116 117 118 119 120 121 122 123 124 125 126 127 128 129 130 131 132 133 134 135 136 137 138 139 140 141 142 143 144 145 146 147 148 149 150 151 152 153 154 155 156 157 158 159 160 161 162 163 164 165 166 167 168 169 170 171 172 173 174 175 176 177 178 179 180 181 182 183 184 185 186 187 188 189 190 191 192 193 194 195 196 197 198 199 200 201 202 203 204 205 206 207 208 209 210 211 212 213 214 215 216 217 218 219 220 221 222 223 224 225 226 227 228 229 230 231 232 233 234 235 236 237 238 239 240 241 242 243 244 245 246 247 248 249 250 251 252 253 254 255 256 257 258 259 260 261 262 263 264 265 266 267 268 269 270 271 272 273 274 275 276 277 278 279 280 281 282 283 284 285 286 287 288 289 290 291 292 293 294 295 296 297 298 299 300 301 302 303 304 305 306 307 308 309 310 311 312 313 314 315 316 317 318 319 320 321 322 323 324 325 326 327 328 329 330 331 332 333 334 335 336 337 338 339 340 341 342 343 344 345 346 347 348 349 350 351 352 353 354 355 356 357 358 359 360 361 362 363 364 365 366 367 368 369 370 371 372 373 374 375 376 377 378 379 380 381 382 383 384 385 386 387 388 389 390 391 392 393 394 395 396 397 398 399 400 401 402 403 404 405 406 407 408 409 410 411 412 413 414 415 416 417 418 419 420 421 422 423 424 425 426 427 428 429 430 431 432 433 434 435 436 437 438 439 440 441 442 443 444 445 446 447 448 449 450 451 452 453 454 455 456 457 458 459 460 461 462 463 464 465 466 467 468 469 470 471 472 473 474 475 476 477 478 479 480 481 482 483 484 485 486 487 488 489 490 491 492 493 494 495 496 497 498 499 500 501 502 503 504 505 506 507 508 509 510 511 512 513 514 515 516 517 518 519 520 521 522 523 524 525 526 527 528 529 530 531 532 533 534 535 536 537 538 539 540 541 542 543 544 545 546 547 548 549 550 551 552 553 554 555 556 557 558 559 560 561 562 563 564 565 566 567 568 569 570 571 572 573 574 575 576 577 578 579 580 581 582 583 584 585 586 587 588 589 590 591 592 593 594 595 596 597 598 599 600 601 602 603 604 605 606 607 608 609 610 611 612 613 614 615 616 617 618 619 620 621 622 623 624 625 626 627 628 629 630 631 632 633 634 635 636 637 638 639 640 641 642 643 644 645 646 647 648 649 650 651 652 653 654 655 656 657 658 659 660 661 662 663 664 665 666 667 668 669 670 671 672 673 674 675 676 677 678 679 680 681 682 683 684 685 686 687 688 689 690 691 692 693 694 695 696 697 698 699 700 701 702 703 704 705 706 707 708 709 710 711 712 713 714 715 716 717 718 719 720 721 722 723 724 725 726 727 728 729 730 731 732 733 734 735 736 737 738 739 740 741 742 743 744 745 746 747 748 749 750 751 752 753 754 755 756 757 758 759 760 761 762 763 764 765 766 767 768 769 770 771 772 773 774 775 776 777 778 779 780 781 782 783 784 785 786 787 788 789 790 791 792 793 794 795 796 797 798 799 800 801 802 803 804 805 806 807 808 809 810 811 812 813 814 815 816 817 818 819 820 821 822 823 824 825 826 827 828 829 830 831 832 833 834 835 836 837 838 839 840 841 842 843 844 845 846 847 848 849 850 851 852 853 854 855 856 857 858 859 860 861 862 863 864 865 866 867 868 869 870 871 872 873 874 875 876 877 878 879 880 881 882 883 884 885 886 887 888 889 890 891 892 893 894 895 896 897 898 899 900 901 902 903 904 905 906 907 908 909 910 911 912 913 914 915 916 917 918 919 920 921 922 923 924 925 926 927 928 929 930 931 932 933 934 935 936 937 938 939 940 941 942 943 944 945 946 947 948 949 950 951 952 953 954 955 956 957 958 959 960 961 962 963 964 965 966 967 968 969 970 971 972 973 974 975 976 977 978 979 980 981 982 983 984 985 986 987 988 989 990 991 992 993 994 995 996 997 998 999 1000 1001 1002 1003 1004 1005 1006 1007 1008 1009 1010 1011 1012 1013 1014 1015 1016 1017 1018 1019 1020 1021 1022 1023 1024 1025 1026 1027 1028 1029 1030 1031 1032 1033 1034 1035 1036 1037 1038 1039 1040 1041 1042 1043 1044 1045 1046 1047

[illegible][illegible][illegible][illegible]

5	8	10	12	14	16	18	20	22	24	26	28	30	32	34	36	38	40	42	44	46	48	50	52	54	56	58	60	62	64	66	68	70	72	74	76	78	80	82	84	86	88	90	92	94	96	98	100
---	---	----	----	----	----	----	----	----	----	----	----	----	----	----	----	----	----	----	----	----	----	----	----	----	----	----	----	----	----	----	----	----	----	----	----	----	----	----	----	----	----	----	----	----	----	----	-----

[illegible]

Prof. Dr. Suresh Chandra Sharma
Sh. Saroj Kanti Das, Kanti Nagar,
Dharwala Distt., Chamba (H.P.)
Pin-176324

~~SECRET~~

ॐ नमो भगवते वासुदेवाय

प्रमाणित किया जाता है कि
समय प्रमाणित
विश्व शास्त्र लेखक महाराज

No. 1458
Himachal Pradesh Forest Department.

From:

Divisional Forest Officer,
Wildlife Division Chamba, H.P.

To:

Prakash Chand Sharma,
S/o Late Sh. Sorma Ram,
VPO Kunr, Tehsil Dharwala,
Distt. Chamba H.P.-176324

Dated Chamba, the 16/7/22

Sub: Renewal of 0.4087 ha. of forest land for the extraction of slates in Mauza Kunar, Tehsil Bharmour Chamba in favour of Sh. Prakash Chand S/o Sh. Sorma Ram VPO Kunr Tehsil & Distt. Chamba, within the jurisdiction of Bharmour Forest Division, Distt. Chamba H.P.

Sir,

Please refer to your letter dated 01/07/2022 on the subject cited above.

2. In this connection, the report was sought from Range Forest Officer, Wildlife Range Bharmour who has submitted that the nearest distance of the proposed work is at the aerial distance of 10.03 KM from the Eco-Sensitive Zone of nearest Wildlife Sanctuary i.e. Tundah.

This is for your information and necessary action.

Divisional Forest Officer
Wildlife Division Chamba
Ph/Fax: 01899-222639

No.Udyog/Bhu/Chamba/M/L/Parkash Chand/ 563

Office of the Mining Officer
Chamba, District Chamba H.P.

Dated..... 30/9/22.

To

Sh. Parkash Chand S/o Sh. Soma Ram
Village and P.O. Kunr Tehsil and District Chamba H.P.

Subject: Regarding distance from mining lease.

Sir,

With reference to the subject cited above. Please find enclosed herewith the information as required by you received to this office from Naib Tehsildar Dharwala Sub-Tehsil Dharwala District Chamba H.P.

Enclosed: As Above

Yours faithfully,

P. Pandey
Mining Officer
District Chamba H.P.
Chamba Dist. Chamba H.P.

Prakash Chand Sharma
Prakash Chand Sharma S/o
Sh. Soma Ram, V.P.O. Kunr, T.
Dharwala, Distt. Chamba (H.P.)
Pin-176324

मीमा भी

तस्फुटि की जाती है कि बाहरी भाग खान पान करने पर बाधा
की चम्बा क्षेत्र रोड से प्रवेश कर पुत्र मोरमा निवास करने व हा
बा क्षेत्र के नाम प्रस्तावित स्मैलर खान भीम कंद खमान नम्बर 3026
2934
रकबा तादापी 5-04-00 वर्गमा भीम चम्बा क्षेत्र रोड से राणवे (Chamba)
द्वारा लगभग 800 मी. व खन्वर रोड द्वारा लगभग 1-5 Km है,
मार्ग: रिपोर्ट क्षेत्र में पेश है।

Prakash
ग्रामीण रजिस्टर ऑफिसर
पटवार मकल...
बहरील...
8/4/2024

Prakash
MINING OFFICER
Chamba Distt. Chamba (H.P.)

Prakash
Sh. Sur.
Dharwad.
Pin-176324

State Pollution Control Board, Himachal Pradesh

Application No.	610003650	Date:	04-08-2022
Applicant Name	Prakash Chand		
Bank Name.	NA		
Bank Id.	1170		
Application No.	OR202N015151		
Name and Address of Industry	Prakash Chand Sharma (Slate Mines), VPO. Kunr Teh & Distt. Chamba H.P, Chamba, Chamba		
Name of Regional Office	RO Chamba		
Applied For	CTO - both - reNew		
Payment Date	04-08-2022		
Payment Details			
CTO both (Rs.)	16000.0		
Total Amount Paid (Rs.)	16000.0		
Transaction Status	Successfully Completed		
Print			

Prakash Chand Sharma
Sh. Sornia Assistant Secretary to Govt.
Dharwala, Distt. Chamba (H.P.)
Pin-176324

[Home](#)[Consent Management](#)[Waste Management](#)[Sampling Results](#)[Environmental Statement](#)[Logout](#)

- ▶ [Apply For Consent](#)
- ▶ [Industry Profile](#)
- ▶ [Change Password](#)
- ▶ [Password Recovery Transactions](#)
- ▶ [Delete Inprogress Application](#)
- ▶ [View Notices](#)

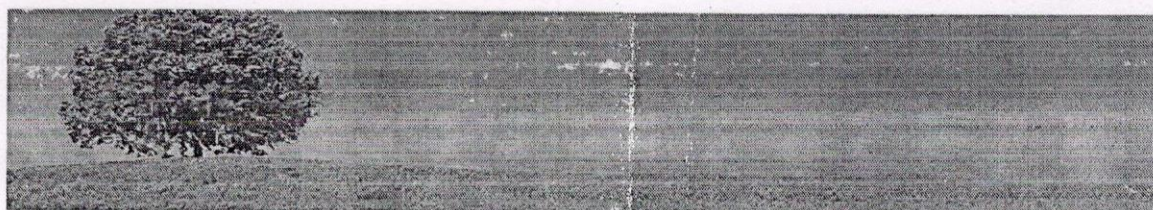

Welcome Prakash Chand Sharma (Slate Mines)

Date : 4-8-2022

Consent Application Details

Application No : 6835642

Congratulations! Application submitted successfully.

Your Consent Application application has been received under the Application Number **6835642**. (Note this number for future communication and know the online status of the application submitted)

Submitted application is under processing. Please send the following documents by post/by hand. You may ignore sending the documents which have been uploaded online.

To view the submitted application form click onto "View Application Form" and To print the application form click onto "Print Application Form"

[View Application Form](#)[Print Application Form \(Air| Water](#)

Head Office Address
Member Secretary
Himachal Pradesh Pollution Control Board,
'Him Parivesh', Phase - III, Nev. Shimla-171009, HP.

Pollution Control Board, Copyright © 2009 All Rights Reserved.

Prakash Chand Sharma S/o Late
Sh. Sornu Kaur, V.P.O. Kunr. Ten.
Dharwala, Distt. Chamba (H.P.)
Pin-176324



Himachal Pradesh State Pollution Control Board

'Him Parivesh', Phase -III, New Shimla-171009, HP.

Form-XIII

(See Rule 22)

Application for Consent to Industry /Operate/Renewal the industrial plant/plants under Section 25/26 of the Water (Prevention & Control of Pollution) Act, 1974 .

Application for Consent to Establish or take any step to establish any Industry , operation processes or any treatment and disposal system for discharge, under Section-25 or continuation or discharge under Section -26 of the Water (Prevention and Control of Pollution) Act, 1974.

RCTO for the period(01/04/2021-31/03/2026)

From

Prakash Chand Sharma (Slate Mines), VPO. Kunr Teh & Distt.
Chamba H.P
City:Chamba
Block:Chamba
District:Chamba

Date:04/08/2022

Industry ID: 26236

Application No.: 6835642

To

The Member Secretary,
Himachal Pradesh Pollution Control Board,
Him Parivesh, Phase-III, New Shimla,
Shimla- 171009, HP.

Sir,

I / we hereby apply for Consent/ Renewal of Consent under Section-25 of Water (Prevention and Control of Pollution) Act, 1974 (6 of 1974) to establish or take any step to establish any Health Care Facility/CBWTF/Research Lab or operation or process or a treatment and disposal system or any extension or addition to bring into use any new altered outlet for discharge of sewage / trade effluent* to continue to discharge sewage /trade effluent * from land/ premises owned byPrakash Chand Sharma (Slate Mines)

The other relevant details are below:

Prakash Chand Sharma V.P.O.
Sh. Sorma Kaur V.P.O. Kunr, Teh.
Dharwala, Distt. Chamba (H.P.)
Pin-176324

"This is computer generated document from OCMMS by HPSPCB"



Form-I
[See Rule 27]

Application for Consent to Establish/Operate/Renewal the Industry under section-21 of the
Air (Prevention & Control of Pollution) Act, 1981

RCTO for the period(01/04/2021-31/03/2026)

From

Prakash Chand Sharma (Slate Mines), VPO. Kunr Teh & Distt.
Chamba H.P
City:Chamba
Block:Chamba
District:Chamba

Date:04/08/2022

Industry ID: 26236

Application No.: 6835642

To

The Member Secretary,
Himachal Pradesh Pollution Control Board,
Him Parivesh, Phase-III, New Shimla,
Shimla- 171009, HP.

Sir,

I/We hereby apply for Consent/Renewal of Consent under Section 21 of the Air (Prevention & Control of Pollution) Act, 1981 to Establish/Operate the Industry owned by Prakash Chand Sharma (Slate Mines) to be located at

The relevant details are as under:

1.	Full name of the Industry	Prakash Chand Sharma (Slate Mines)
2.	Full address with PIN Code of the Industry with telephone numbers (Give Revenue/City Survey No. for which application is made, 1 stating District, Taluka/Village).	AddressVillage &Post Office Kunr Tehsil & Distt. Chamba (HP) Pin :176324 Telephone No. :9816402879
3.	Names of full time directors/partners/ owners with addresses and telephone numbers. (Use separate sheet if space provided is not sufficient)	Name: Prakash Chand (Owner) Village & Post Office Kunr Tehsil & Distt. Chamba (HP)
4.	Total capital cost of the project (Rs. In Lakhs).	27.78
	Expansion Cost.	

[Signature]
Prakash Chand Sharma S/o [Name] (H.P.)
Sh. Sornu, V.P.O. Kunr, Distt. Chamba (H.P.)
Dharwala, Distt. Chamba (H.P.)
Pin-176324
This is computer generated document from HP PCB
Prakash Chand Sharma S/o [Name] (H.P.)
Sh. Sornu, V.P.O. Kunr, Distt. Chamba (H.P.)
Dharwala, Distt. Chamba (H.P.)
Pin-176324

Annexure I

Dated: 2/7/2022

State Geologist
Jammu and Kashmir, Shimla.

Renewal of 0.4087 ha. Of forest land for the extraction of slates in Mauza Kunar
Tehsil Bharmour Chamba in favour of Shri Prakash Chand S/o Shri Ram VPO
Kunr Tehsil & Chamba, within the jurisdiction of Bharmour Forest Division
District Chamba, HP.

Respected Sir,

Kindly refer to GoI. MOEF, Integrated Regional Office, Shimla letter No.
FC/HPB/05/43/2022 dated 17.06.2022 observation point No. 16 vide which GoI. MOEF has
asked to provide the fresh Letter of Intent (LOI). as the validity of earlier issued LOI has been
expired on 12.10.2021.

Therefore, your self is requested to kindly extend the validity of LOI for the above
mining as per the approved mining Plan (copy enclosed). so that the reply along with documents
could be sent to GoI, MoEF within stipulated time, please.

Thanking You.

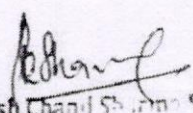
Prakash Chand Sharma S/o Late
Sh. Sorma Ram, VPO Kunr, Teh.
Prakash Chand S/o Shri Sorma Ram
Dharwala, Dist. Chamba (H.P.)
VPO Kunr Tehsil & Chamba.
Pin-176324

Recd. Prs
05/07/22

EE746536175IN IVR1667741928179
SF CHAMBA HO. 176310/
Counter No: 05/07/2022.13:10
To: THE STATE GEOLOGIST, HP
PIN: 171001, Shimla GPO
From: PRAKASH CHAND, KUNR
M: 98000
Amt: ₹1.70/Cash/Txn: 6.70
Track on www.indiapost.gov.in
Qd: 1800186666 (Near Muske, Stay Safe)

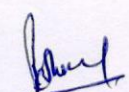
Prakash Chand Sharma S/o Late
Sh. Sorma Ram, VPO Kunr, Teh.
Dharwala, Dist. Chamba (H.P.)
Pin-176324

UNDERTAKING REGARDING SOIL CONSERVATION PLAN.

Full Title of the Project: Renewal of Lease for Extraction of Slates in Mauza Kunr, Tehsil & District Chamba

I, Prakash Chand S/o Sorma Ram, sole proprietor for Extraction of Slates in Mauza Kunr, Tehsil & District Chamba is hereby undertake hereby submit that the Soil Conservation Plan of the area is not yet prepared and I herewith undertake to pay the amount against the Soil Conservation Plan as per the FCA guidelines on or before the stage-II approval.

Place: Chamba

Dated: ...03.10.2022

Prakash Chand S/o Sorma Ram

VPO Kunr, Tehsil & District Chamba (HP)

Proprietor

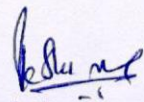
Prakash Chand Sharma S/o Late
Sh. Sorma Ram, V.P.O. Kunr, Teh.
Dharwala, Distt. Chamba (H.P.)
Pin-176324

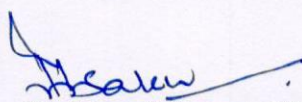
Divisional Forest Officer
Bharmour Forest Division
Bharmour (HP)

UNDERTAKING REGARDING WILDLIFE MANAGEMENT PLAN

Full Title of the Project: Renewal of Lease for Extraction of Slates in Mauza Kunr, Tehsil & District Chamba

I, Prakash Chand S/o Sorma Ram, sole proprietor for Extraction of Slates in Mauza Kunr, Tehsil & District Chamba is hereby undertake hereby submit that the Wildlife Management Plan of the area is not yet prepared and I herewith undertake to pay the amount against the Wildlife Management Plan and Soil Conservation Plan as per the FCA guidelines on or before the stage-II approval.

Place: Chamba

Dated: 03.12.2022

Prakash Chand S/o Sorma Ram
VPO Kunr, Tehsil & District Chamba (HP)

Proprietor

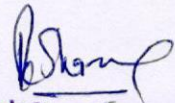
Prakash Chand S/o Late
Sh. Sorma Ram, V.P.O. Kunr, Teh.
Dharwala, Dist. Chamba (H.P.)
Pin-176324

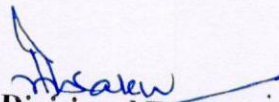
Divisional Forest Officer
Bharmour Forest Division
Bharmour (HP)