



GOVERNMENT OF SIKKIM
FORESTS AND ENVIRONMENT DEPARTMENT
FOREST SECRETARIAT, DEORALI, GANGTOK-737 102
Email:fca.sikkim@gmail.com

Ref. No. 2012/FCA/F&E/.....1036

Dated 12/11/2023

To,

✓ The Inspector General of Forest cum Nodal Officer,
 Integrated Regional Office,
 Ministry of Env. Forests & Climate Change,
 Government of India,
 IB-198, Sector-III, Salt Lake City,
 Kolkata -700106.

Sub: Proposal for diversion of 0.4047 Ha of forest land for extension of Sewage Plant scheme for Jorethang town in Namchi Sikkim by Public Health Department, Govt. of Sikkim – Addl. information req.

Proposal No. : FP/SK/Others/149384/2021

Madam,

With reference to letter no. IRO/KOL/SK/Others/149384/2021/448 dated 31.10.2022, please find enclosed herewith the additional information for the aforesaid proposal furnished by the user agency and concerned DFO.

Sl. No.	Query	Reply
1	As per Decision Support System, the proposed CA land is categorized as Moderately Dense Forest. Suitability of proposed CA land may be rechecked and maybe proposed in other suitable site.	Compensatory Afforestation location has been changed due to NDFC (as suggested). The new proposed CA site location on toposheet has been marked and Kml file uploaded on the Parivesh portal.
2	Layout map of the Sewage Treatment Plant along with component wise break up of proposed forest land.	Layout map of the Sewage Treatment Plant along with component wise break up of proposed forest land submitted/uploaded on Parivesh Portal.
3	Since it is not a site-specific project, the details of other alternative sites explored and reason for their rejection needs to be uploaded.	As per the field report proposed site is the only suitable site available for the construction of sewage treatment plant.
3	Google Earth image shows existence of trees in the forest land proposed for diversion. Whereas canopy density mentioned by concerned DFO is 'zero' and tree enumeration in the proposed land is also mentioned as 'zero'. It may be clarified.	The existence of trees in the forest land proposed for diversion as viewed under Google earth image may be due to the area for diversion being less. The site inspection clearly shows no trees required for felling. As the proposed areas falls close to the Rangeet river bank. The photograph to support the site inspection submitted.

Since, required additional information has been furnished, it is requested to kindly consider the aforesaid proposal for according In-Principle Approval under Section 2 of Forest (Conservation) Act, 1980, please.

Yours sincerely,

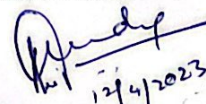

(Brijendra Swaroop, IFS),
 APCCF-cum-Nodal Officer (FCA),
 Brijendra Swaroop, IFS
 APCCF-cum-Nodal Officer (FCA)
 Forest & Environment Department
 Govt. of Sikkim



Copy for information to:-

1. Secretary,
Public Health Department,
Govt. of Sikkim
2. CF (T)
3. DFO(T) Namchi
4. File for record.



OFFICE OF THE SUB-DIVISIONAL MAGISTRATE
GOVERNMENT OF SIKKIM
JORETHANG SUB-DIVISION
NAMCHI SIKKIM

Memo No. 359/SDM/JORT(S)

Dated: 02/02/2023

To,

The Assistant Engineer,
PHE Department,
Jorethang Sub-Division,
Namchi, Sikkim.

Sub: reg. Suitable land for Construction of Sewerage Treatment Plant at Jorethang.

Madam,

With reference to your letter No. 205/PHED/J/South/23-24 dated 02/02/2023, we would like to inform you that within the surrounding of Jorethang there is no suitable Private or Government land for construction of Sewerage Treatment Plant.

Further, as per your letter it's mentioned that for the Construction of Sewerage Plant the department has identified land at Chirbiray Tar. The jurisdiction of Chirbiray Tar doesn't fall under the undersigned, you may consult with DC Office Namchi for the same.

Furthermore, we can only mentioned that there is no suitable land in an around Jorethang for the construction of Sewerage Treatment Plant under the jurisdiction of undersigned.

Thanking you.



SUB-DIVISIONAL MAGISTRATE
JORETHANG SUB-DIVISION

Sub-Divisional Magistrate
Jorethang Sub-Division
South Sikkim

COMPONENT WISE SIZING OF STP 1.70 MLD AT JORETHANG, S-SIKKIM

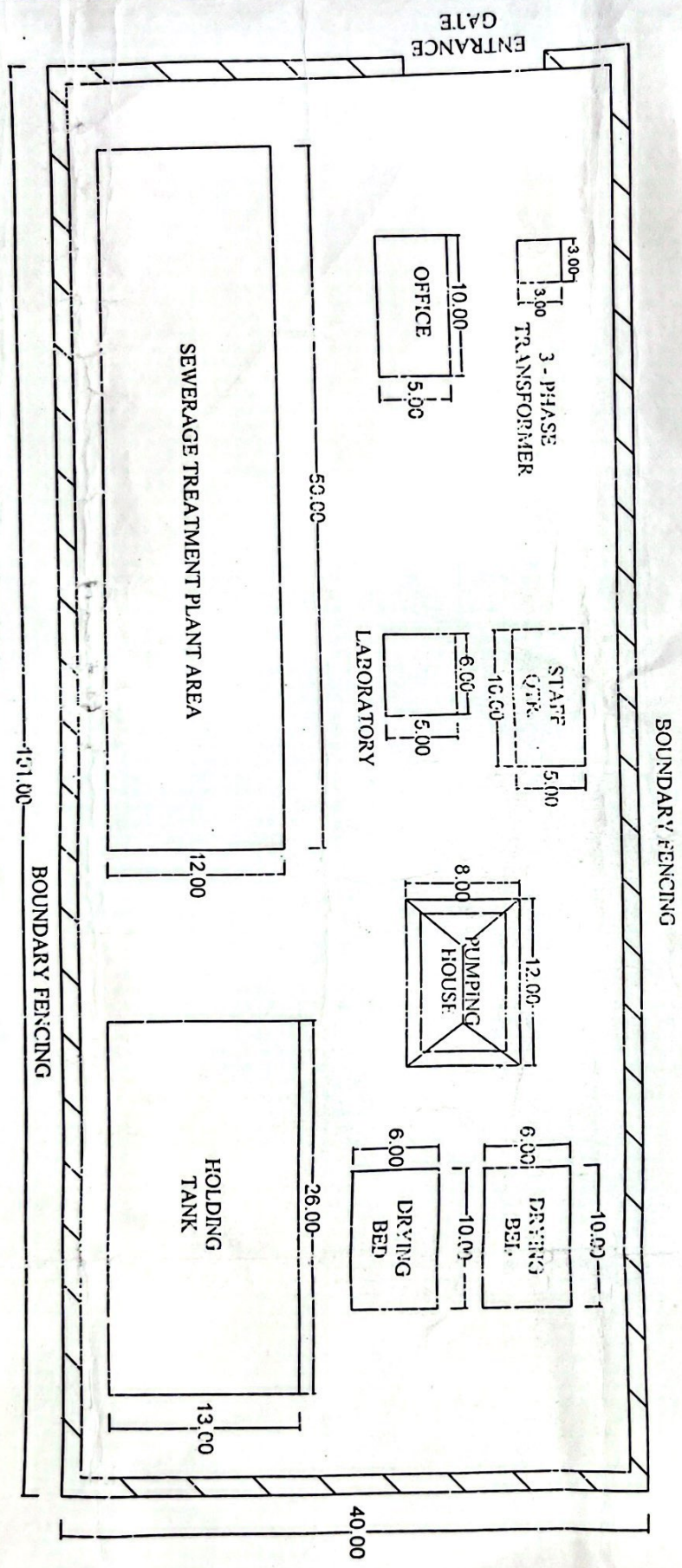

TOTAL AREA : 101 mtr x 40 mtr = 4040 sq. mtr = 0.404 HA

[Signature]
Superintending Engineer (SWM)
Public Health Engg. Department
Govt. of Sikkim, Gangtok

[Signature]
Assistant Engineer
Public Health Engineering Dept.
Jorethang-Sub Division
South Sikkim

**MAP SHOWING THE CA LAND OF 1 HA AGAINST THE DIVERSION OF FOREST LAND (AREA 0.4047 HIA.)
FOR EXTENSION OF SEWERAGE PLANT SCHEME FOR JORETHANG UNDER MELLI (T) RANGE,
SOUTH SIKKIM.**

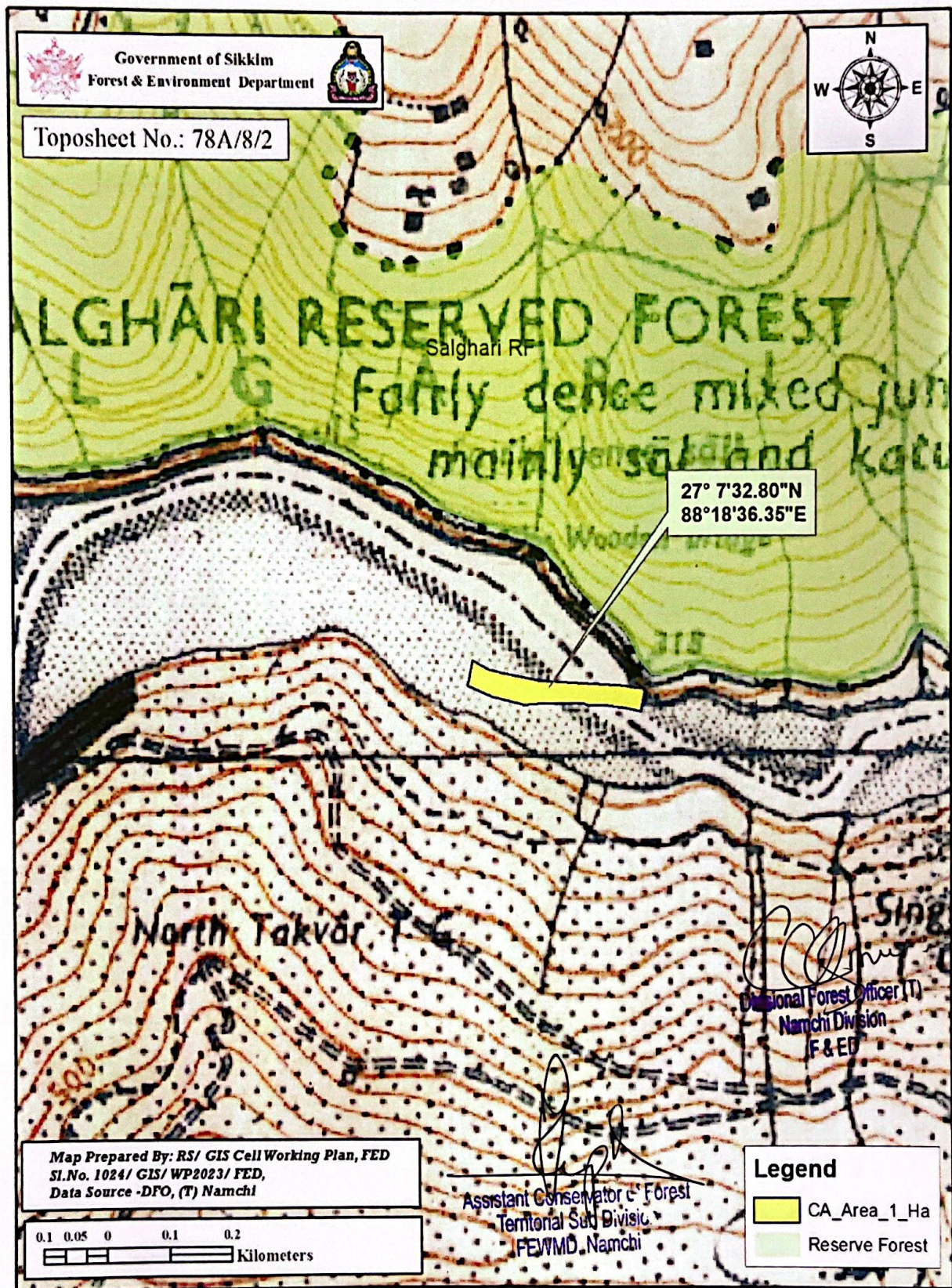



Assistant Conservator, Forest
Territorial Sub-Division
FEWMD, Nayabazar

10/02/23
District Forest Officer
Nayabazar



GPS Map Camera

South Sikkim, Sikkim, India

Melli - Nayabazar Rd, Sikkim 737121, India

Lat 27.126452°

Long 88.308592°

10/02/23 11:05 AM GMT +05:30

