

**Full Title of Project:** Diversion of 9.58 Ha. of land For Development of Six lane access controlled in Delhi portion of Delhi Saharanpur Highway from Akshardham NH9 (Old NH24) junction to Delhi/UP Border (Ch. 0.000 to Ch. 14.750) in the state of Delhi on EPC mode under Economic Corridor in Phase 1 of Bharatmala Pariyojana.

**File No.:** FP/DL/ROAD/142233/2021

**Date of Proposal:** 12.05.2021

### **SITE INSPECTION REPORT**

The site proposed for diversion constitute land of area 9.58 ha situated near Akshardham NH9 (Old NH24) junction to Delhi/UP Border (Ch. 0.000 to Ch. 14.750) in the state of Delhi. This land is having the legal status of Deemed Forest. The purpose of diversion is for For Development of Six lane access controlled in Delhi portion of Delhi Saharanpur Highway from Akshardham NH9 (Old NH24) junction to Delhi/UP Border (Ch. 0.000 to Ch. 14.750) in the state of Delhi on EPC mode under Economic Corridor in Phase 1 of Bharatmala Pariyojana, FCA, 1980.

The site proposed at from Akshardham NH9 (Old NH24) junction to Delhi/UP Border (Ch. 0.000 to Ch. 14.750) was inspected by the undersigned along with officials of NHAI on 05.01.2022.. On the Left side of proposed road Yamuna River is present, and the stretch passes through shakarpur, Mayur Vihar , Shastri Park, Khajuri Pushta etc. There are a total of 5104 trees existing on the site of major Peepal, Pilkhan, Subabul, Kikar, Sehtoot, Kachnar etc. species.

  
**(ADITYA MADANPOTRA)**  
**Dy. Conservator of Forests**  
**Central Forest Division**

**Office Seal**

**Place: New Delhi**

**Date: 22.04.2022**

ADITYA MADANPOTRA, IFS  
Dy. Conservator of Forests  
central Forests Division  
Govt. of NCT of Delhi  
Kamla Nehru Ridge, Delhi-110007

**Full Title of Project:** Diversion of 9.58 Ha. of land For Development of Six lane access controlled in Delhi portion of Delhi Saharanpur Highway from Akshardham NH9 (Old NH24) junction to Delhi/UP Border (Ch. 0.000 to Ch. 14.750) in the state of Delhi on EPC mode under Economic Corridor in Phase 1 of Bharatmala Pariyojana.

**File No.:** FP/DL/ROAD/142233/2021

**Date of Proposal:** 12.05.2021

### JOINT INSPECTION REPORT

The site proposed at from Akshardham NH9 (Old NH24) junction to Delhi/UP Border (Ch. 0.000 to Ch. 14.750) in the state of Delhi was inspected by the undersigned along with officials of NHAI on 05.01.2022.

The purpose of diversion is for For Development of Six lane access controlled in Delhi portion of Delhi Saharanpur Highway from Akshardham NH9 (Old NH24) junction to Delhi/UP Border (Ch. 0.000 to Ch. 14.750) in the state of Delhi on EPC mode under Economic Corridor in Phase 1 of Bharatmala Pariyojana, FCA, 1980.

The site proposed at from Akshardham NH9 (Old NH24) junction to Delhi/UP Border (Ch. 0.000 to Ch. 14.750) was inspected by the undersigned along with officials of NHAI on 05.01.2022.. On the Left side of proposed road Yamuna River is present, and the stretch passes through shakarpur, Mayur Vihar , Shastri Park, Khajuri Pushta etc. There are a total of 5104 trees existing on the site of major Peepal, Pilkhan, Subabul, Kikar, Sehtoot, Kachnar etc. species.

  
Signature of User Agency

  
Office Seal

Project Director  
National Highways Authority of India  
PIU-Ghaziabad

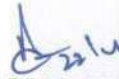
  
(ADITYA MADANPOTRA)  
Dy. Conservator of Forests  
Central Forest Division

Office Seal

ADITYA MADANPOTRA, IFS  
Dy. Conservator of Forests  
central Forests Division  
Govt. of NCT of Delhi  
Kamla Nehru Ridge, Delhi-110007

Place: New Delhi

Date :22.04.2022



# DGPS MAP

Development of Six-lane access controlled in Delhi portion of Delhi Saharanpur Highway from Akshardham NH-9 (Old NH-24) junction to Delhi/UP Border (Ch. 0.000 to Ch. 14.750) in the state of Delhi on EPC mode under Economic Corridor in Phase-I of Bharatmala Pariyojana



December - 2021

CLIENT:-



**NAT**  
Minist

**ADITYA MADANPOTRA, IFS**  
Dy. Conservator of Forests  
central Forests Division  
Govt. of NCT of Delhi  
Kamla Nehru Ridge, Delhi-110007

**PRORITY OF INDIA**  
Government of India

CONSULTANT:-



**S.A. Infrastructure Consultants Pvt. Ltd.**  
1101A, 11 FLOOR TOWER A-II, ANSAL CORPORATE PARK,  
PLOT NO. 7A/1, SECTOR 142, NOIDA-201301 (UTTAR PRADESH)  
PHONE NO- 0120-6148000 FAX-0120-6148090  
EMAIL: [info@sainfra.com](mailto:info@sainfra.com)

LONGITUDE	LATITUDE	KML_FOLDER	Patach nme
77° 16' 56.2842" E	28° 36' 50.2495" N	Coordinate	L1
77° 16' 56.4713" E	28° 36' 50.3368" N	Coordinate	L1
77° 16' 55.1370" E	28° 36' 52.4193" N	Coordinate	L1
77° 16' 54.9125" E	28° 36' 52.2946" N	Coordinate	L1

77° 16' 53.8526" E	28° 36' 54.1713" N	Coordinate	L2
77° 16' 53.9896" E	28° 36' 54.2586" N	Coordinate	L2
77° 16' 53.5907" E	28° 36' 54.9070" N	Coordinate	L2
77° 16' 53.4181" E	28° 36' 54.8073" N	Coordinate	L2

77° 16' 48.9270" E	28° 37' 1.6844" N	Coordinate	L3
77° 16' 49.1016" E	28° 37' 1.8340" N	Coordinate	L3
77° 16' 46.0464" E	28° 37' 6.5851" N	Coordinate	L3
77° 16' 45.7846" E	28° 37' 6.4604" N	Coordinate	L3

77° 16' 44.4628" E	28° 37' 7.8196" N	Coordinate	L4
77° 16' 44.6498" E	28° 37' 7.9318" N	Coordinate	L4
77° 16' 45.2234" E	28° 37' 7.1836" N	Coordinate	L4
77° 16' 45.3606" E	28° 37' 7.1711" N	Coordinate	L4

77° 16' 40.8839" E	28° 37' 13.6368" N	Coordinate	L5
77° 16' 41.1084" E	28° 37' 13.8114" N	Coordinate	L5
77° 16' 37.5794" E	28° 37' 18.8991" N	Coordinate	L5
77° 16' 37.2801" E	28° 37' 18.7619" N	Coordinate	L5

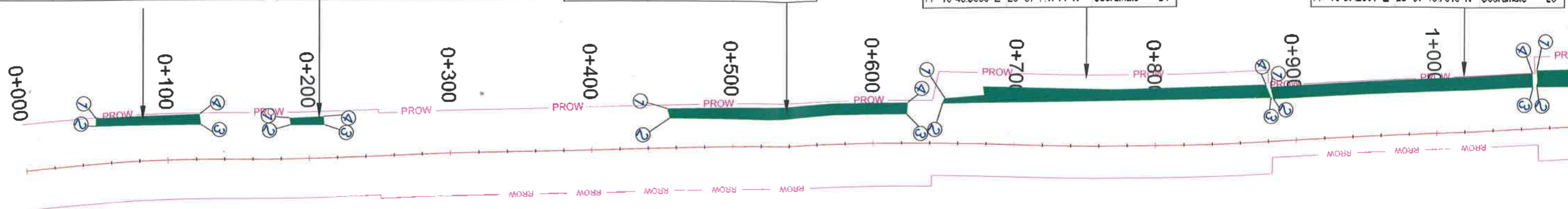

77° 16' 37.1429" E	28° 37' 18.8118" N	Coordinate	L6
77° 16' 37.5170" E	28° 37' 18.9864" N	Coordinate	L6
77° 16' 33.6015" E	28° 37' 25.1964" N	Coordinate	L6
77° 16' 33.0404" E	28° 37' 25.0093" N	Coordinate	L6

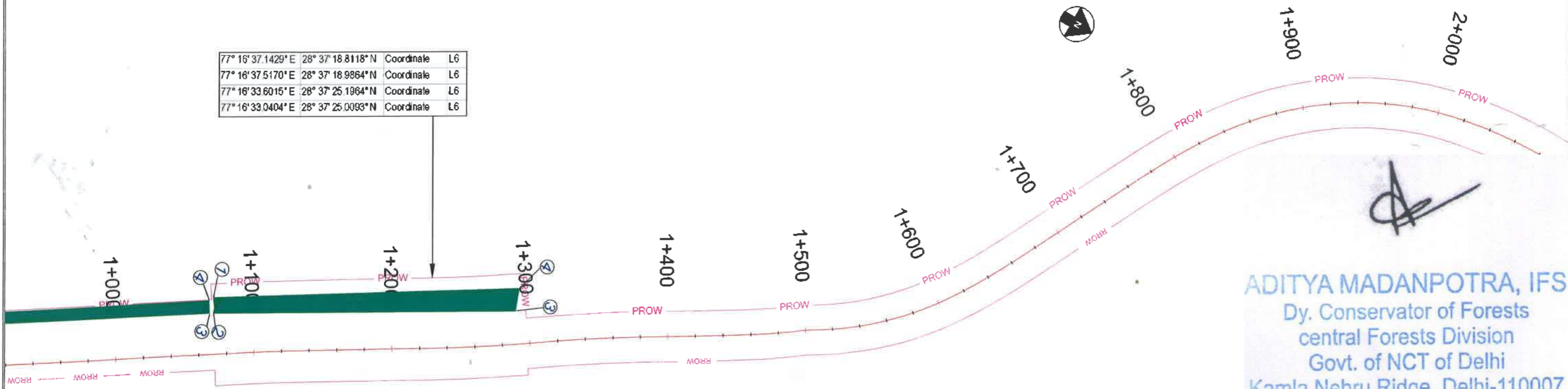

**ADITYA MADANPOTRA, IFS**  
 Dy. Conservator of Forests  
 central Forests Division  
 Govt. of NCT of Delhi  
 Kamla Nehru Ridge, Delhi-110007

Project Director  
 National Highways Authority of India  
 PIU-Ghaziabad



<p><b>LEGEND :</b></p> <p>PROW ——— PROW ———</p> <p>PROPOSED CENTER LINE ———</p> <p>DEEMED FOREST LAND [Green Box]</p>	<p><b>CONSULTANT:</b></p> <p><b>S.A. Infrastructure Consultants Pvt. Ltd.</b></p> <p><small>110114, 11 Floor, Sector 48, Anand Complex Park              Plot No. 12/15, Sector 42, Noida-201301, Uttar Pradesh              Phone No: 0120-4146009 Fax: 0120-4146000              Email: info@saiconsultants.com</small></p>	<p><b>CLIENT :</b></p> <p><b>NATIONAL HIGHWAYS AUTHORITY OF INDIA</b></p> <p><small>(Ministry of Road, Transport &amp; Highways, Govt. of India)</small></p>	<p><b>PROJECT:</b></p> <p>Development of Six-lane access controlled in Delhi portion of Delhi Saharanpur Highway from Akshardham NH-9 (Old NH-24) junction to Delhi/UP Border (Ch. 0,000 to Ch. 14.750) in the state of Delhi on EPC mode under Economic Corridor in Phase-I of Bharatmala Pariyojana</p>	<p><b>DRAWING TITLE :</b></p> <p>DGPS MAP</p> <p>Km 0+000 To Km 2+000</p>	<p><b>DRAWING NO. :</b> 131893/DGPS/01</p> <p><b>DATE :</b> APRIL - 2021</p>
---	---	--	---	---	--

DATE: 04/02/2021 11:00:00 AM

Paper Size A3



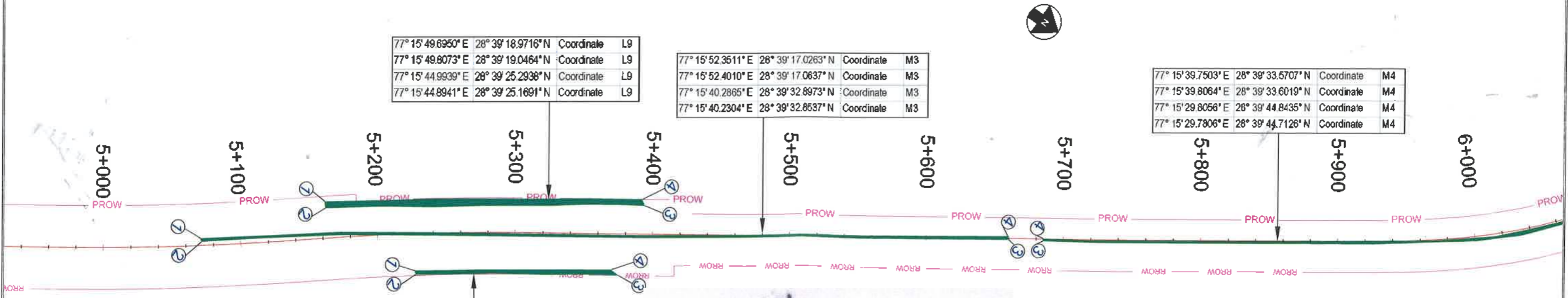
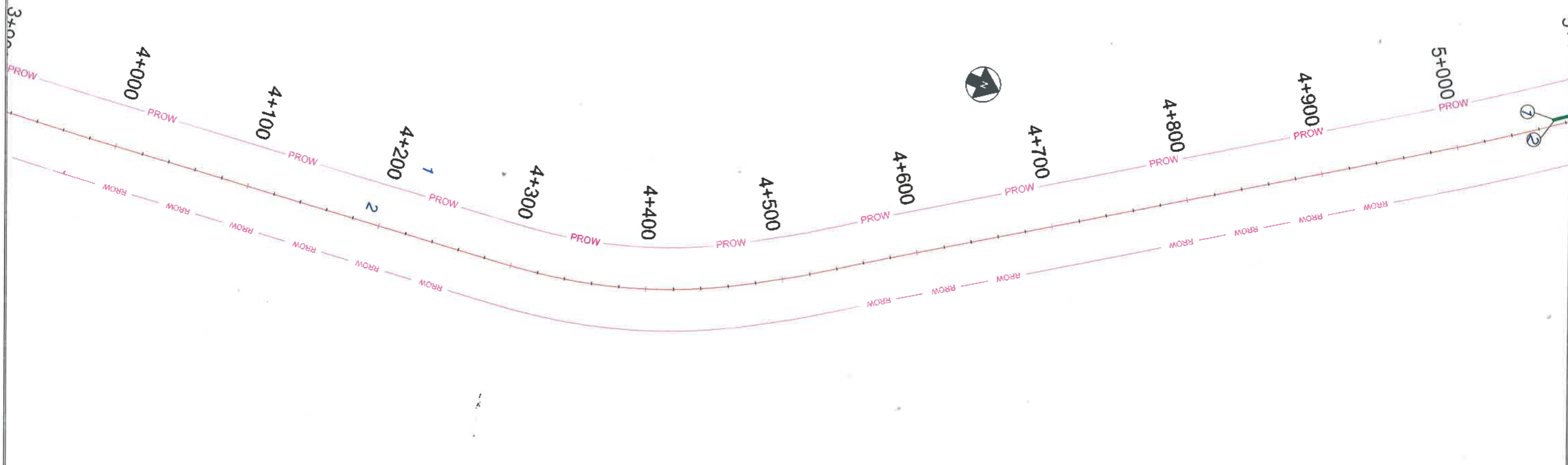

77° 15' 49.6950" E	28° 39' 18.9716" N	Coordinate	L9
77° 15' 49.8073" E	28° 39' 19.0464" N	Coordinate	L9
77° 15' 44.9939" E	28° 39' 25.2938" N	Coordinate	L9
77° 15' 44.8941" E	28° 39' 25.1691" N	Coordinate	L9

77° 15' 52.3611" E	28° 39' 17.0263" N	Coordinate	M3
77° 15' 52.4010" E	28° 39' 17.0637" N	Coordinate	M3
77° 15' 40.2865" E	28° 39' 32.8973" N	Coordinate	M3
77° 15' 40.2304" E	28° 39' 32.8537" N	Coordinate	M3

77° 15' 39.7503" E	28° 39' 33.5707" N	Coordinate	M4
77° 15' 39.8064" E	28° 39' 33.6019" N	Coordinate	M4
77° 15' 29.8056" E	28° 39' 44.8435" N	Coordinate	M4
77° 15' 29.7806" E	28° 39' 44.7126" N	Coordinate	M4

77° 15' 49.8634" E	28° 39' 21.6370" N	Coordinate	R5
77° 15' 49.9257" E	28° 39' 21.7119" N	Coordinate	R5
77° 15' 46.9267" E	28° 39' 25.6804" N	Coordinate	R5
77° 15' 46.9080" E	28° 39' 25.4746" N	Coordinate	R5



**ADITYA MADANPOTRA, IFS**  
 Dy. Conservator of Forests  
 central Forests Division  
 Govt. of NCT of Delhi  
 Kamla Nehru Ridge, Delhi-110007

**Project Director**  
 National Highways Authority of India  
 PIU-Ghaziabad

<b>LEGEND :</b>	
PROW	
PROPOSED CENTER LINE	
DEEMED FOREST LAND	

<b>CONSULTANT:</b>	
<b>S.A. Infrastructure Consultants Pvt. Ltd.</b>	1101A, 11 Floor Tower A-B, Ansal Concrete Park Plot No. 3A/1, Sector 142, Noida-201301 (Uttar Pradesh) Phone No: 0120-4188800 Fax: 0120-4188809 Email: saic@saicinfra.com

<b>CLIENT:</b>	
<b>NATIONAL HIGHWAYS AUTHORITY OF INDIA</b>	Ministry of Road, Transport & I.T.

ethi Saharanpur  
 UP Border (Ch.  
 onomic Corridor in

<b>DRAWING TITLE :</b>	DGPS MAP
	Km 4+000 To Km 6+000

<b>DRAWING NO :</b>	131883.0695/03
<b>DATE :</b>	APRIL - 2021

DATE: 14/03/2021, 10:00am  
 PWT: DGS, 131883.0695/03, 131883.0695/03

Paper Size A3







77° 15' 18.8664" E	28° 41' 57.7444" N	Coordinate	L15
77° 15' 19.0285" E	28° 41' 57.7787" N	Coordinate	L15
77° 15' 19.4743" E	28° 42' 0.2976" N	Coordinate	L15
77° 15' 19.6956" E	28° 42' 0.2134" N	Coordinate	L15
77° 15' 19.8047" E	28° 42' 1.0193" N	Coordinate	L15
77° 15' 19.5553" E	28° 42' 1.1908" N	Coordinate	L15
77° 15' 19.7829" E	28° 42' 3.0550" N	Coordinate	L15
77° 15' 19.6520" E	28° 42' 3.3075" N	Coordinate	L15

77° 15' 21.8404" E	28° 42' 17.8318" N	Coordinate	L17
77° 15' 22.1335" E	28° 42' 17.8381" N	Coordinate	L17
77° 15' 22.2925" E	28° 42' 18.9993" N	Coordinate	L17
77° 15' 21.9869" E	28° 42' 19.0336" N	Coordinate	L17

77° 15' 21.5848" E	28° 42' 13.7866" N	Coordinate	L16
77° 15' 21.7843" E	28° 42' 15.0620" N	Coordinate	L16
77° 15' 21.2325" E	28° 42' 14.9996" N	Coordinate	L16

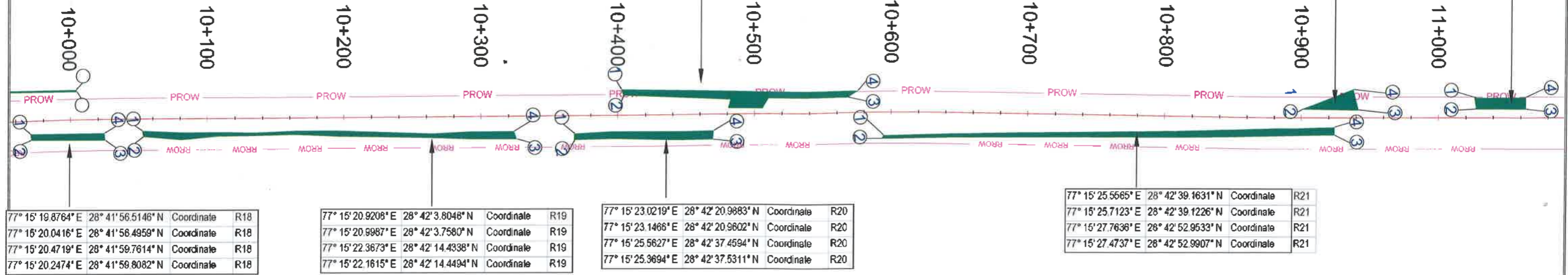

77° 15' 19.8764" E	28° 41' 56.5146" N	Coordinate	R18
77° 15' 20.0416" E	28° 41' 56.4959" N	Coordinate	R18
77° 15' 20.4719" E	28° 41' 59.7614" N	Coordinate	R18
77° 15' 20.2474" E	28° 41' 59.8082" N	Coordinate	R18

77° 15' 20.9208" E	28° 42' 3.8048" N	Coordinate	R19
77° 15' 20.9987" E	28° 42' 3.7580" N	Coordinate	R19
77° 15' 22.3673" E	28° 42' 14.4338" N	Coordinate	R19
77° 15' 22.1615" E	28° 42' 14.4494" N	Coordinate	R19

77° 15' 23.0219" E	28° 42' 20.9883" N	Coordinate	R20
77° 15' 23.1466" E	28° 42' 20.9802" N	Coordinate	R20
77° 15' 25.5627" E	28° 42' 37.4594" N	Coordinate	R20
77° 15' 25.3694" E	28° 42' 37.5311" N	Coordinate	R20

77° 15' 25.5685" E	28° 42' 39.1631" N	Coordinate	R21
77° 15' 25.7123" E	28° 42' 39.1226" N	Coordinate	R21
77° 15' 27.7638" E	28° 42' 52.9533" N	Coordinate	R21
77° 15' 27.4737" E	28° 42' 52.9907" N	Coordinate	R21

77° 15' 22.9128" E	28° 42' 28.5185" N	Coordinate	L18
77° 15' 23.0805" E	28° 42' 28.4437" N	Coordinate	L18
77° 15' 23.3586" E	28° 42' 30.0383" N	Coordinate	L18
77° 15' 23.1560" E	28° 42' 30.2783" N	Coordinate	L18

77° 15' 23.8481" E	28° 42' 36.4774" N	Coordinate	L19
77° 15' 24.2939" E	28° 42' 36.3527" N	Coordinate	L19
77° 15' 28.5555" E	28° 43' 7.7051" N	Coordinate	L19
77° 15' 28.3653" E	28° 43' 7.6864" N	Coordinate	L19

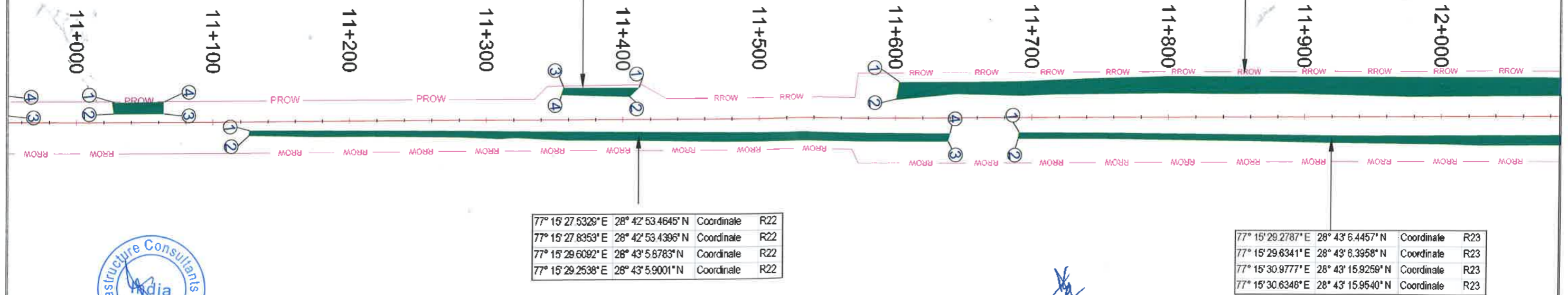

77° 15' 27.5329" E	28° 42' 53.4645" N	Coordinate	R22
77° 15' 27.8353" E	28° 42' 53.4396" N	Coordinate	R22
77° 15' 29.6092" E	28° 43' 5.8783" N	Coordinate	R22
77° 15' 29.2538" E	28° 43' 5.9001" N	Coordinate	R22

77° 15' 29.2787" E	28° 43' 6.4457" N	Coordinate	R23
77° 15' 29.6341" E	28° 43' 6.3958" N	Coordinate	R23
77° 15' 30.9777" E	28° 43' 15.9259" N	Coordinate	R23
77° 15' 30.6348" E	28° 43' 15.9540" N	Coordinate	R23



Project Director  
National Highways Authority of India  
PIU, Ghaziabad

<b>LEGEND :</b>
PROW
PROPOSED CENTER LINE
DEEMED FOREST LAND

<b>CONSULTANT:</b>
S.A. Infrastructure Consultants Pvt. Ltd.
15/1A, 11 Floor Tower A-8, Anand Corporate Park, Phase-2, Sector-142, Gurgaon-122001, Haryana Phone No: 9120414990 Fax: 0120414886 Email: info@saiconsultants.com

<b>CLIENT :</b>
NATIONAL HIGHWAYS AUTHORITY OF INDIA (Ministry of Road Transport & Highways, Govt. of India)

<b>PROJECT:</b>
Development of Six-lane access controlled in Delhi portion of Delhi Saharanpur Highway from Akshardham NH-9 (Old NH-24) Junction to Delhi/UP Border (Ch. 0.000 to Ch. 14.750) in the state of Delhi on EPC mode under Economic Corridor in Phase-I of Bharatnala Pariyojana

<b>DRAWING TITLE :</b>
DGPS MAP
Km 10+000 To Km 12+000

<b>DRAWING NO :</b> 191890DGS/
06
<b>DATE :</b> APRIL - 2021

77° 15' 23.8481" E	28° 42' 36.4774" N	Coordinate	L19
77° 15' 24.2939" E	28° 42' 36.3527" N	Coordinate	L19
77° 15' 28.5555" E	28° 43' 7.7051" N	Coordinate	L19
77° 15' 28.3653" E	28° 43' 7.6864" N	Coordinate	L19

77° 15' 28.3372" E	28° 43' 8.0746" N	Coordinate	L20
77° 15' 28.5773" E	28° 43' 8.0527" N	Coordinate	L20
77° 15' 29.8305" E	28° 43' 16.2002" N	Coordinate	L20
77° 15' 29.5811" E	28° 43' 16.2221" N	Coordinate	L20

77° 15' 29.6559" E	28° 43' 16.7614" N	Coordinate	L21
77° 15' 29.9147" E	28° 43' 16.7271" N	Coordinate	L21
77° 15' 30.9372" E	28° 43' 23.7289" N	Coordinate	L21
77° 15' 30.6598" E	28° 43' 23.7539" N	Coordinate	L21

77° 15' 30.7564" E	28° 43' 16.9873" N	Coordinate	R24
77° 15' 31.4422" E	28° 43' 16.3094" N	Coordinate	R24
77° 15' 31.7898" E	28° 43' 18.6568" N	Coordinate	R24
77° 15' 31.0483" E	28° 43' 18.7067" N	Coordinate	R24

77° 15' 31.0931" E	28° 43' 18.7815" N	Coordinate	R25
77° 15' 31.4142" E	28° 43' 18.7441" N	Coordinate	R25
77° 15' 32.8669" E	28° 43' 28.8993" N	Coordinate	R25
77° 15' 32.5334" E	28° 43' 28.9211" N	Coordinate	R25

77° 15' 32.6736" E	28° 43' 29.6178" N	Coordinate	R26
77° 15' 32.9823" E	28° 43' 29.5804" N	Coordinate	R26
77° 15' 40.0402" E	28° 44' 18.6603" N	Coordinate	R26
77° 15' 39.6661" E	28° 44' 18.6915" N	Coordinate	R26

77° 15' 30.7096" E	28° 43' 24.1249" N	Coordinate	L22
77° 15' 31.0183" E	28° 43' 24.1280" N	Coordinate	L22
77° 15' 38.8213" E	28° 44' 18.4889" N	Coordinate	L22
77° 15' 38.3848" E	28° 44' 18.5450" N	Coordinate	L22

77° 15' 32.6736" E	28° 43' 29.6178" N	Coordinate	R26
77° 15' 32.9823" E	28° 43' 29.5804" N	Coordinate	R26
77° 15' 40.0402" E	28° 44' 18.6603" N	Coordinate	R26
77° 15' 39.6661" E	28° 44' 18.6915" N	Coordinate	R26

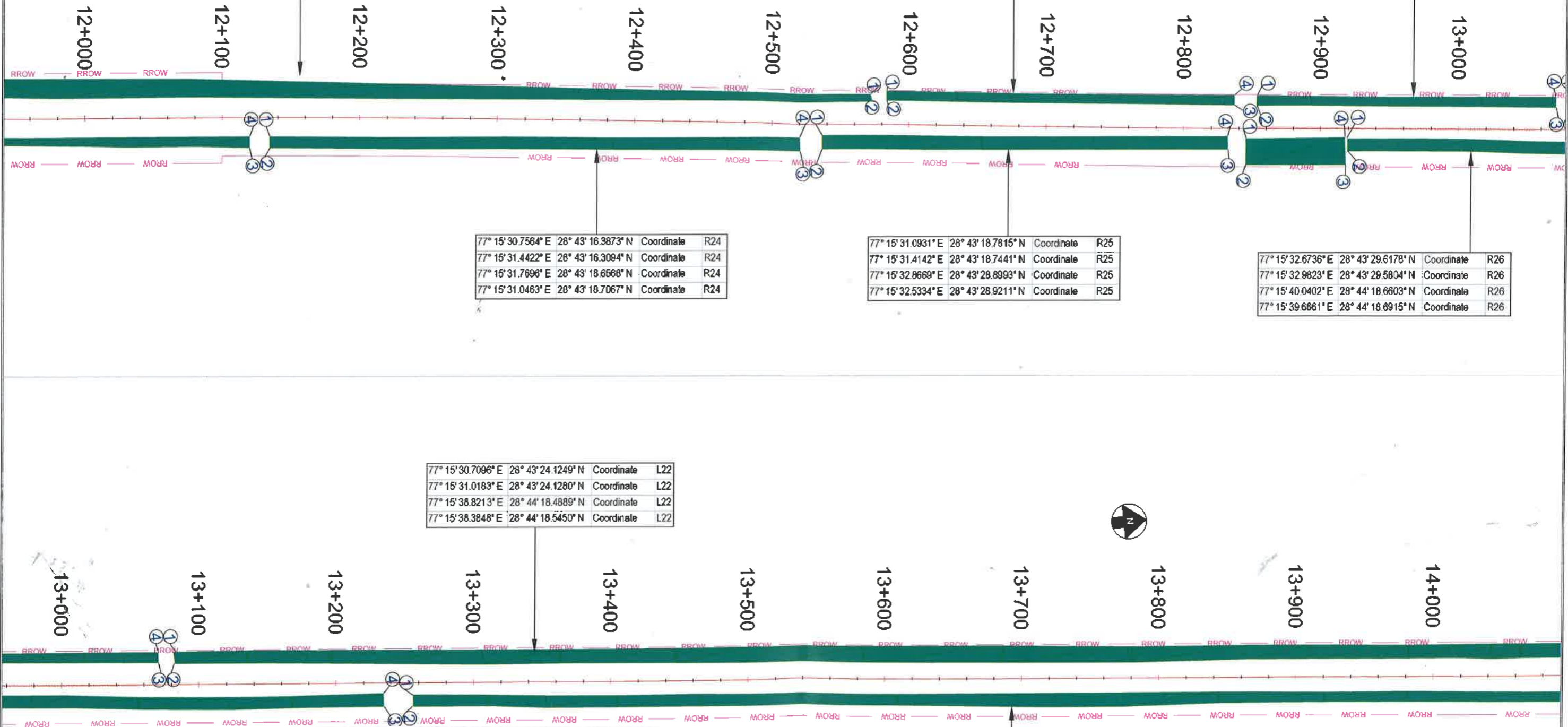

**ADITYA MADANPOTRA, IFS**  
 Dy. Conservator of Forests  
 central Forests Division  
 Govt. of NCT of Delhi  
 Kamla Nehru Ridge, Delhi-110007

**Project Director**  
 National Highways Authority of India  
 PIU-Ghaziabad

<b>LEGEND :</b>	
PROW	— PROW — PROW —
PROPOSED CENTER LINE	— — — — —
DEEMED FOREST LAND	█



PROJECT: Development of Six- lane access controlled in Delhi portion of Delhi Saharanpur Highway from Akshardham NH-9 (Old NH-24) junction to Delhi/UP Border (Ch. 0.000 to Ch. 14.750) in the state of Delhi on EPC mode under Economic Corridor in Phase-I of Bharatmala Pariyojana	DRAWING TITLE : DGPS MAP Km 12+000 To Km 14+000	DRAWING NO : 131803DGP/07
		DATE : APRIL - 2021

Date: 09/04/2021  
 Time: 10:00 AM  
 Scale: 1:1000

Paper Size: A3

77° 15' 30.7096" E	28° 43' 24.1249" N	Coordinate	L22
77° 15' 31.0183" E	28° 43' 24.1280" N	Coordinate	L22
77° 15' 38.8213" E	28° 44' 18.4889" N	Coordinate	L22
77° 15' 38.3648" E	28° 44' 18.5450" N	Coordinate	L22



14+000      14+100      14+200      14+300      14+400      14+500      14+600      14+700

77° 15' 32.6736" E	28° 43' 29.6178" N	Coordinate	R26
77° 15' 32.9823" E	28° 43' 29.5804" N	Coordinate	R26
77° 15' 40.0402" E	28° 44' 18.6603" N	Coordinate	R26
77° 15' 39.6661" E	28° 44' 18.6915" N	Coordinate	R26

*(Signature)*  
**ADITYA MADANPOTRA, IFS**  
 Dy. Conservator of Forests  
 central Forests Division  
 Govt. of NCT of Delhi  
 Kamla Nehru Ridge, Delhi-110007

*(Signature)*  
 Project Director  
 National Highways Authority of India  
 PIU-Ghaziabad



<b>LEGEND :</b> PROW ——— PROW ——— PROPOSED CENTER LINE ——— DEEMED FOREST LAND ———	<b>CONSULTANT:</b> S.A. Infrastructure Consultants Pvt. Ltd. <small>1101A, 11 Floor, Tower A-8, Anand Corporate Park, Phase III, Sector 142, Gurgaon-122001, Haryana                  Phone No- 0120-9148000 Fax-0120-4148009                  Email- info@saiinfra.com</small>	<b>CLIENT:</b> NATIONAL HIGHWAYS AUTHORITY OF INDIA <small>(Ministry of Road, Transport &amp; Highways, Govt. of India)</small>	<b>PROJECT:</b> Development of Six-lane access controlled in Delhi portion of Delhi Saharanpur Highway from Akshardham NH-9 (Old NH-24) junction to Delhi/UP Border (Ch. 0,000 to Ch. 14.750) in the state of Delhi on EPC mode under Economic Corridor in Phase-I of Bharatmala Pariyojana	<b>DRAWING TITLE :</b> DGPS MAP Km 14+000 To Km 14+750	<b>DRAWING NO :</b> 13185JGFS/ 08 <b>DATE :</b> APRIL - 2021 Paper Size A3
--	---	---	--	--	--

DATE: 16/03/2021 11:20:00 AM  
 PATH: D:\Sai\Projects\Akshardham\Layouts\14+000\_14+750\_Road.dwg