

**वन विभाग, कार्यालय****वन मण्डल अधिकारी, फतेहाबाद वन मण्डल, फतेहाबाद**

पुराना कोर्ट रोड, नजदीक पी0डब्ल्यू0डी0 रेस्ट हाउस, फतेहाबाद-125050, फोन-01667-220313 (का0/फैक्स)

क्रमांक **797**दिनांक **21/9/2022**

सेवा में

अति० प्रधान मुख्य वन संरक्षक (एफ०सी०ए०),
हरियाणा, पंचकूला।

विषय :-

Diversion of 33.71 Ha. (5.69 ha. In Jind division, & 17.69 ha. & 10.23 ha. Fatehabad division) of Forest Land for construction of channel for supply 180 Cs water to Nuclear Power Plant at Gorakhpur, Tehsil & District Fatehabad through old abandoned Sirsa Branch from RD 388500 to 424780 falling under Forest Division & District Hisar, Jind and Fatehabad, Haryana.

Online Proposal No. -FP/HR/Canal/152229/2022.

सन्दर्भ:-

पर्यावरण, वन एवं जलवायु परिवर्तन मंत्रालय भारत सरकार का पत्र क्रमांक 9-HRB135/2022-CHA दिनांक 25-07-2022

उपरोक्त प्रस्ताव के सम्बंध में सन्दर्भांकित पत्र द्वारा ऑनलाईन पोर्टल पर लगाई त्रुटियां निम्न प्रकार से दूर करके ऑनलाईन अपलोड करने उपरान्त आपको आगामी आवश्यक कार्यवाही हेतु भेजी जाती है :-

1. User Agency से सम्बंधित है।
2. FRA-Undertaking पोर्टल पर अपलोड कर दिया गया है।
3. User Agency से सम्बंधित है।
4. User Agency से सम्बंधित है।
5. वृक्षों को विभिन्न प्रजातियों के अनुसार ऑनलाईन पोर्टल पर अपलोड कर दिया गया है।
6. Vegetation Density को सही करके अपलोड कर दिया गया है।
7. TOPO Sheet पर SOI के नम्बर अंकित करके पोर्टल पर अपलोड कर दिया गया है।
8. User Agency से सम्बंधित है।
9. User Agency से सम्बंधित है।
10. User Agency से सम्बंधित है।
11. मद संख्या 11 पर दर्शाई गई त्रुटि इस वन मण्डल से सम्बंधित ना होकर हिसार वन मण्डल से सम्बंधित है।
12. नए मजदूरी दर के अनुसार CA तैयार करके पोर्टल पर अपलोड की जा चुकी है।
13. वन मण्डल, हिसार से सम्बंधित है।

**वन विभाग, कार्यालय****वन मण्डल अधिकारी, फतेहाबाद वन मण्डल, फतेहाबाद**

पुराना कोर्ट रोड, नजदीक पी0डब्ल्यू0डी0 रेस्ट हाउस, फतेहाबाद-125050, फोन-01667-220313 (का0/फैक्स)

14. उक्त प्रोजेक्ट से सम्बंधित इस वन मण्डल की डाईवर्ट की जाने वाली वन भूमि पर कोई wetlands नहीं है।
15. 23858 पौधों लगाकर करवाए जाने वाले प्रतिपुर्ति पौधारोपण हेतु proposed CA Sites के 11 patches में 1000 पौधे लगाने हेतु 1 अतिरिक्त साईट 'Dehman Minor, RD 26 to 30, L/R Side' को शामिल करके प्रतिपुर्ति पौधारोपण हेतु proposed CA Sites के patches की संख्या 12 कर दी गई है।
16. वन मण्डल, हिसार से सम्बंधित है।
17. वन मण्डल, जीन्द से सम्बंधित है।

सलंगन/उपरोक्त

वन मण्डल अधिकारी,
फतेहाबाद।

पृ0 कमांक 798दिनांक 21/9/2022

इसकी एक प्रति मुख्य वन संरक्षक, पश्चिमी परिमण्डल, हिसार को सूचनार्थ एवं आगामी आवश्यक कार्यवाही हेतु प्रेषित है।

वन मण्डल अधिकारी,
फतेहाबाद।

PART-II

(To be filled by the Deputy Conservator of Forests)

State Serial No. of Proposal : **FP/HR/CANAL/152229/2022**

Diversion of 33.71 Ha. (5.69 Ha. in Jind Division, 17.79 Ha. in Hisar Division and 10.23 Ha. in Fatehabad Division) of Forest Land in favour of Executive Engineer, Adampur Water Services Division, Hisar for Construction of Carrier Channel for Nuclear Power Plant at Village-Gorakhpur, Tehsil & Distt.-Fatehabad on old abandoned Sirsa Branch from RD 388500 to 424780 falling under Forest Division and Distt. Jind, Hisar and Fatehabad, Haryana.

a)	Location of the project/Scheme	Haryana
(I)	State/Union Territory	Haryana
(ii)	District	Fatehabad
(iii)	Forest Division	D.F.O. (T), Fatehabad
(iv)	Area of Forest Land proposed for Diversion (in Ha.)	10.23
(v)	Legal status of forest.	P.F.
(vi)	Density of vegetation.	1.3/M2
(vii)	Species-wise (scientific names) and diameter class-wise enumeration of trees (to be closed in case of irrigation/hydel projects enumeration at FRL, FRL-2, FRL-4 meter also to be enclosed).	Attached (Marking List)
(viii)	Brief note on vulnerability of the forest area to be erosion.	The P.F. is along the Water Canal it is not vulnerable to erosion.
(ix)	Approximate distance of proposed site for diversion from boundary of forest.	N.A.
(x)	Whether forms part of National, wildlife sanctuary, Biosphere reserve, Tiger reserve, Elephant corridor, etc. (if so, the detail of the area and comments of the Chief Wildlife warden to be annexed).	N.A.
(xi)	Whether any rare / endangered / unique species of Flora and Fauna found in area if so details thereof.	N.A.
(xii)	Whether any protected archaeological / heritage site / defence establishment or any other important monument is located in the area. If so the details thereof with NOC from competent authority, if required.	N.A.
8	Whether the requirement of forestland as proposed by user agency in col 2 of part 1 is un avoidable and barest minimum for the project. If no recommendation are item - wise with details alternatives examined.	Yes
9	Whether any work violation of Act has been carried out (Yes/No). If yes details of the same including period of work done, action taken in violation is still in progress.	No
10	Details of compensatory afforestation Scheme :	Attached.
i)	Details of Non forest area/ degrade forest area identifies for compensatory afforestation, its distance from adjoining forest, number of plants, size of each path.	Attached.
ii)	Map showing non-forest area identified for compensatory afforestation and adjoining forest boundaries.	Attached.
iii)	Detailed compensator afforestation scheme including species to be planted, implementing agency, time schedule, costructure etc.,	Attached.
iv)	Total financial outlay for compensatory afforestation scheme.	Attached.
v)	Certificates from competent authority regarding suitability of area indified for compensatory afforestation and from management point of view. (To be signed by the concerned Deputy Conservator of forests)	Suitability Certificate Attached.
11	Site inspection report of the DCF (to be enclosed) especially highlighting facts asked in col-7 (xi, xii) 8 and 9 above.	Attached.
12	Division/District profile :	
i)	Geographical area of district.	2520 Sq. Km.
ii)	Forest area of District	5550.84 Ha.
iii)	Total forest area diverted since 1980 with number of cases.	144.94331 Ha. (215 Cases)
iv)	Total compensatory afforestation stipulated in the district/vision since 1980 on	1133.93 RKM
a)	Forestland including penal compensatory afforestation.	-----
b)	Non-Forestland	-----
v)	Progress of compensatory afforestation as on (date_ ----- on.	-----
a)	Forest Land	-----
b)	Non-Forestland	Nil.
13	Specific recommendations of the DCP for acceptance or otherwise of the proposal reasons.	Recommendation in Public Interest.

Dated

Divisional Forest Officer
Fatehabad Forest Division
Fatehabad.

Check List No. 16

REPORT ON SITE INSPECTION OF A FOREST AREA PROPOSED FOR DIVERSION

1	Name of project/proposal	Diversion of 33.71 Ha. (5.69 Ha. in Jind Division, 17.79 Ha. in Hisar Division and 10.23 Ha. in Fatehabad Division) of Forest Land in favour of Executive Engineer, Adampur Water Services Division, Hisar for Construction of Carrier Channel for Nuclear Power Plant at Village-Gorakhpur, Tehsil & Distt.-Fatehabad on old abandoned Sirsa Branch from RD 388500 to 424780 falling under Forest Division and Distt. Jind, Hisar and Fatehabad, Haryana.
	Date of Inspection	7-03-2022
2	Legal status of the forest land proposed for diversion	P.F.
3	Item-wise break-up details of forest land proposed for diversion.	Check List No. 7 Attached.
4	Total cost of the project at present rates	44627 Lacs.
5	Whether proposal involves any construction of buildings (including residential) or not? If yes, details thereof.	No
6	Wildlife:	
	Whether forest area proposed for diversion is important from wildlife point of view or not?	No
7	Vegetation:	
	Total No. of trees to be felled.	1338
	Effect of removal of trees on the general eco-system in the area.	-----
	Important Species:	
	No. of trees to be felled of girth below 60 cms.	314
	Number of trees to be felled of girth above 60 cms.	1024
8	Background note on the proposal	A proposal has been received from Executive Engineer, Adampur Water Services Division, Hisar for Diversion of 33.71 Ha. (5.69 Ha. in Jind Division, 17.79 Ha. in Hisar Division and 10.23 Ha. in Fatehabad Division) of Forest Land in favour of Executive Engineer, Adampur Water Services Division, Hisar for Construction of Carrier Channel for Nuclear Power Plant at Village-Gorakhpur, Tehsil & Distt.-Fatehabad on ol abandoned Sirsa Branch from RD 388500 to 424780 falling under Forest Division and Distt. Jind, Hisar and Fatehabad, Haryana. Site Inspection of the land involved in the Proposal has been done by me on dated 7-03-2022

9	<u>Compensatory Afforestation:</u>	
	Whether land for comp. afforestation is suitable from plantation and management point of view or not?	Yes
	Whether land for compensatory afforestation is free from encroachment/other encumbrances?	Yes
	Whether land for C.A is important from religious/archaeological point of view?	No
	Land identified for C.A is in how many patches? Whether patches are compact or not?	One
	Map with details	Attached.
	Total amount to be remitted by the user agency	49195754
10	Whether proposal involves violation of Forest (Conservation) Act, 1980. If yes, a detailed report on violation including action taken against the concerned officials.	No
11	Whether proposal involves rehabilitation of displaced persons. If yes, whether rehabilitation plan has been prepared by State Govt. or not?	No
12	<u>Reclamation Plan:</u>	
	Details and financial allocation:	-----
13	Details on catchment and command area under the project.	-----
14	Cost Benefit Ratio	-----
15	Recommendations of the PCCF/State Government.	
16	Recommendations of Regional APCCF along with detailed reasons.	

17	Regional APCCF shall give detailed comments on whether there are any alternative routes/alignments for locating the project on the non-forest land.	
18	Utility of the Project:	
	Number of scheduled caste/tribes to be benefited by the project.	Nil.
19	Whether land being diverted has any socio-cultural/religious value.	No
	Whether any scared grove or very old growth trees/forests exists in the area proposal for diversion.	No
	Whether the land under diversion forms parts of any unique eco-system.	No
20	Situation w.r.t. any P.A.	-----
21	Any other information relating to the project.	-----

 Divisional Forest Officer
 Divisional Forest Officer
 Fatehabad.

Diversion of 33.71 Ha. (5.69 Ha. in Jind Division, 17.79 Ha. in Hisar Division and 10.23 Ha. in Fatehabad Division) of Forest Land in favour of Executive Engineer, Adampur Water Services Division, Hisar for Construction of Carrier Channel for Nuclear Power Plant at Village-Gorakhpur, Tehsil & Distt.- Fatehabad on old abandoned Sirsa Branch from RD 388500 to 424780 falling under Forest Division and Distt. Jind, Hisar and Fatehabad, Haryana.

CHECK LIST SERIAL NUMBER:- 17

"LOCATION MAP"

Location map of Non-Forest/Degraded Forest Area Identified for Compensatory Afforestation in lieu of Proposal for diversion of

10.23

in Fatehabad Distt

Village Bodiwali, Sarwarpur, Dhingsara, matana, Dhanger, Bighar, Chaharwala, Daiyer, Dhabi Khurd, Jandwala Baghar, Gadli, Chuli Bagaria, Kajal Heri, Khara Kheri, Bhoda Hoshnak, Bhuthan Kalan, Jhalnia, Khairampur, Malhad, Daulatpuriya, Dhani Binja Lamba, Mochiwali, Chaubara.

Forest Division Fatehabad

Forest Range

Fatehabad

Block No./Compartment No./Survey No.

No.	C.A Site name	No. of Plants to be planted	Area required for Plantation (ha.)
1	Manawali Minor RD 24 to tail L/R Side	2900	2.9
2	Bighar Minor RD 0 to tail L/R Side	1900	1.9
3	Kheri Disrty RD 100 to 120 L/R Side	1900	1.9
4	Dhabi Minor RD 35 to 42 L/R Side	1400	1.4
5	Chaharwala Minor RD 0 to 10 L/R Side	1400	1.4
6	Kheri Disrty RD 44 to 58 L/R Side	1900	1.9
7	Khara Kheri Distry RD 0 to 20 L/R Side	1000	1
8	Khairampur Minor RD 0 to 16 L/R Side	1900	1.9
9	Lift Minor RD 0 to tail L/R Side	1400	1.4
10	Fatehabad Distry RD 140 to 190 L/R Side	3800	3.8
11	Munshiwala Minor RD 55 to 85 L/R Side	3358	3.5
12	Dehaman minor, RD 26 to 30 L/R Side	1000	1
	G.Total	23858	24

Dated _____

 Divisional Forest Officer
 Divisional Forest Division
 Fatehabad.

CA Site :- Dehman Minor RD 26 to 30 L & R-Side for Proposal No. - FP/HR/CANAL/152229/2022



29° 28' 20.576" N, 75° 41' 12.293" E
 29° 28' 20.000" N, 75° 41' 12.546" E
 29° 28' 20.183" N, 75° 41' 12.460" E

29° 28' 32.319" N, 75° 41' 53.815" E
 29° 28' 32.193" N, 75° 41' 53.856" E
 29° 28' 31.722" N, 75° 41' 53.998" E

29° 28' 29.656" N, 75° 41' 42.923" E
 29° 28' 29.470" N, 75° 41' 42.983" E

Legend

- GPS_Point
- CA Site

[Signature]
 Divisional Forest Officer
 Fatehabad Forest Division
 Fatehabad

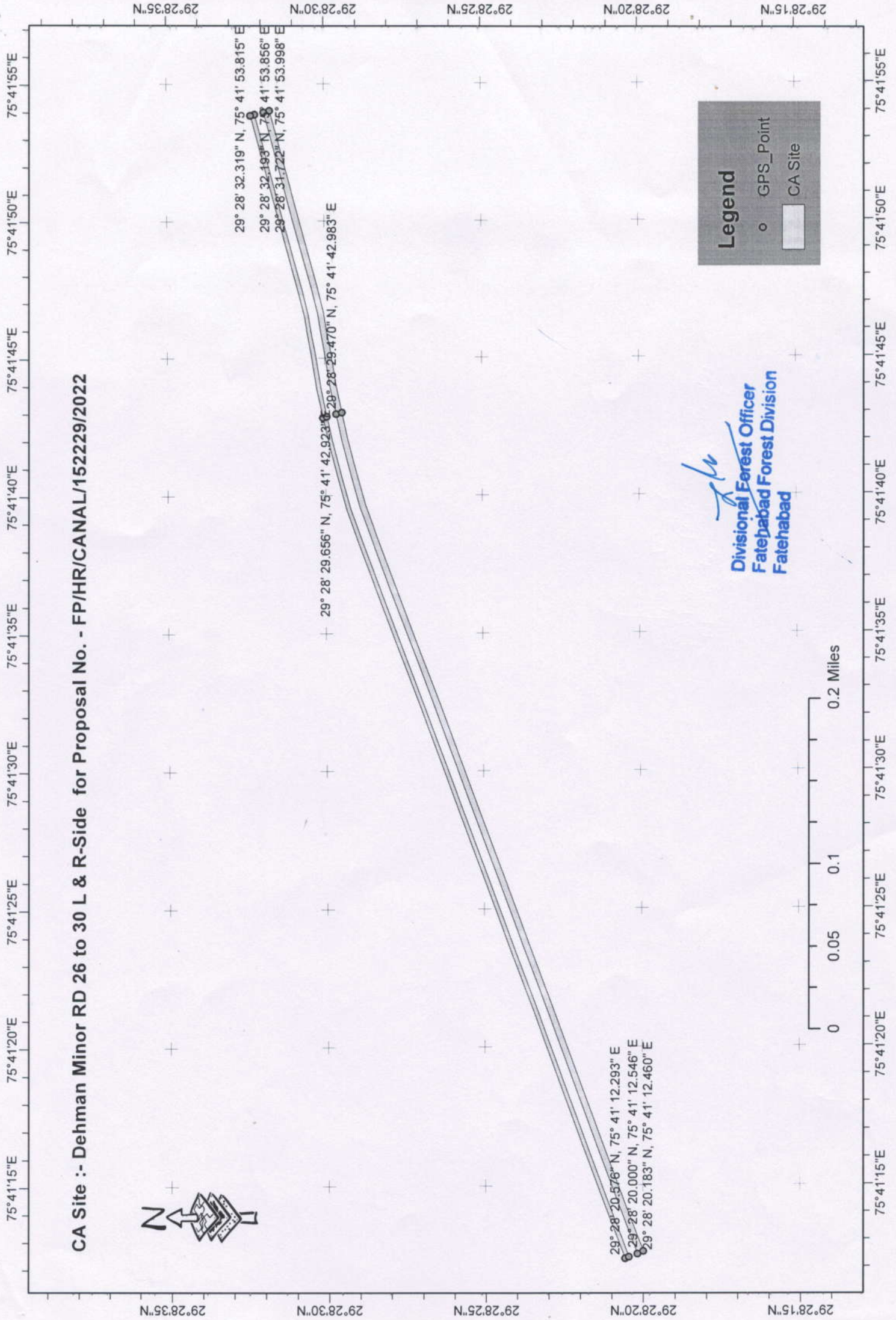
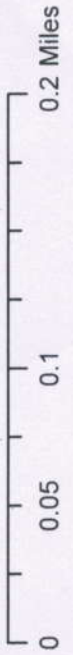



OPEN SERIES
MAP

No. H43P11

Scale 1:50,000

1

H43P6

1

H43P10

Fatehabad
HARYANA

1

H43P14

1

H43P15

2

H43P16

3

H43P7

3

H43P11

Hisar
HARYANA

3

H43P12

Alwar
RAJASTHAN

1	Patiāla, PUNJAB.	3	Sirsa, HARYĀNA
2	Bhiwāni, HARYĀNA	4	Jind, HARYĀNA

भारतीय सर्वेक्षण विभाग

SURVEY OF INDIA

1st Edition 2007.

Price : Rs. 50/-

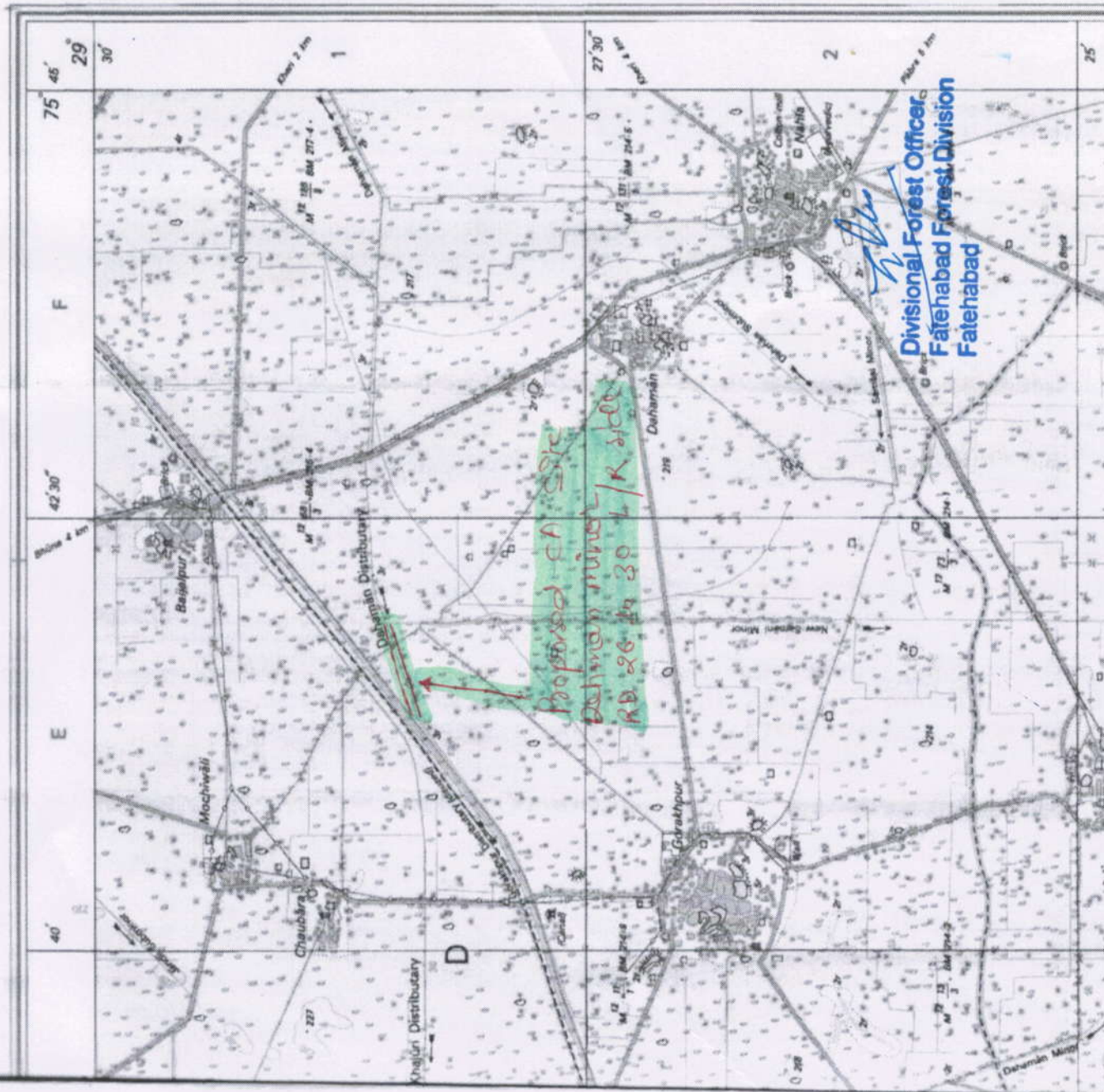

Divisional Forest Officer
Fatehabad Forest Division
Fatehabad

Diversion of 33.71 Ha. (5.69 Ha. in Jind Division, 17.79 Ha. in Hisar Division and 10.23 Ha. in Fatehabad Division) of Forest Land in favour of Executive Engineer, Adampur Water Services Division, Hisar for Construction of Carrier Channel for Nuclear Power Plant at Village-Gorakhpur, Tehsil & Distt.-Fatehabad on old abandoned Sirsa Branch from RD 388500 to 424780 falling under Forest Division and Distt. Jind, Hisar and Fatehabad, Haryana.

CHECK LIST SERIAL NUMBER:- 18

C.A. Scheme

Detailed scheme for Compensatory Afforestation to be carried out in lieu of
ha., of forest area to be diverted for

10.23

Diversion of 33.71 Ha. (5.69 Ha. in Jind Division, 17.79 Ha. in Hisar Division and 10.23 Ha. in Fatehabad Division) of Forest Land in favour of Executive Engineer, Adampur Water Services Division, Hisar for Construction of Carrier Channel for Nuclear Power Plant at Village-Gorakhpur, Tehsil & Distt.-Fatehabad on old abandoned Sirsa Branch from RD 388500 to 424780 falling under Forest Division and Distt. Jind, Hisar and Fatehabad, Haryana.

			No.	C.A. Site Name	No. of	Area
Details of de-graded forest land/non forest land where CA is to be carried out :			1	Manawali Minor RD 24 to tail L/R Side	2900	2.9
			2	Bighar Minor RD 0 to tail L/R Side	1900	1.9
			3	Kheri Disrty RD 100 to 120 L/R Side	1900	1.9
			4	Dhabi Minor RD 35 to 42 L/R Side	1400	1.4
			5	Chaharwala Minor RD 0 to 10 L/R Side	1400	1.4
			6	Kheri Disrty RD 44 to 58 L/R Side	1900	1.9
			7	Khara Kheri Distry RD 0 to 20 L/R Side	1000	1
			8	Khairampur Minor RD 0 to 16 L/R Side	1900	1.9
			9	Lift Minor RD 0 to tail L/R Side	1400	1.4
			10	Fatehabad Distry RD 140 to 190 L/R Side	3800	3.8
			11	Munshiwal Minor RD 55 to 85 L/R Side	3358	3.5
			12	Dehaman minor, RD 26 to 30 L/R Side	1000	1
			G.Total		23858	24
Division :	Fatehabad	District	Fatehabad	Villages	Village Bodiwali, Sarwarpur, Dhingsara, matana, Dhanger, Bighar, Chaharwala, Daiyer, Dhabhi Khurd, Jandwala Baghar, Gadli, Chuli Bagaria, Kajal Heri, Khara Kheri, Bhoda Hoshnak, Bhuthan Kalan, Jhalnia, Khairampur, Malhad, Daulatpuriya, Dhani Binja Lamba, Mochiwali, Chaubara.	

2).	Description of Area :		
i	Whether the site selected for Compensatory Afforestation is a Land Bank (Yes or No)	Yes	
ii	If the C.A site is other than the Land Bank, reasons be given	N.A	
iii	In case of Non-Forest Area identified for CA, then what is the distance of CA site from adjoining forest boundary	N.A	
iv	Soil Type	Sandy Loam	
v	Topography :	a. Hilly/Undulating/Plain.	
		b. Slope:-Steep/Medium/Gentle.	
vi	Whether the area is bearing any root stock of vegetation	No.	

3 Plantation of Model:-

Copy of the approved Compensatory Afforestation Scheme/Model showing component wise physical and financial break up is as under :-

Detail of year wise breakup of requirement of funds is as under :-

The plantation cost is calculated for Tall Plants norms at 4 mtr x 2.5 mtr spacing at the wage rate of Rs. 388-42/- per day as under :-

Area to be Diverted	10.23	
Area to be planted under Normal C.A.	Two Times of the Area to be Diverted	20.46
Nos of trees to be felled	1338	Nos.
Nos of Plants to be damaged	1699	Nos. Plants
Nos of Plants to be planted under Normal C.A.	20460	Plants

1 Schedule of Plantation Programme :-

Detail of year wise break-up of requirements of funds is as under :-

Bill

Sr. No.	Description	Rate		Total Amount
A	Compensatory Afforestation Charges	Nos of Plants	Rate Per plant	
i	1st Year Cost of Afforestation	20460	336.70	6888882.00
ii	2nd Year Maintenance	20460	92.78	1898278.80
iii	3rd Year Maintenance	20460	57.76	1181769.60
iv	4th Year Maintenance	20460	10.73	219535.80
v	5th Year Maintenance	20460	10.73	219535.80
vi	6th Year Maintenance	20460	10.73	219535.80
vii	7th Year Maintenance	20460	10.73	219535.80
viii	8th Year Maintenance	20460	10.73	219535.80
ix	9th Year Maintenance	20460	10.73	219535.80
x	10th Year Maintenance	20460	10.73	219535.80
	Total Charges			11505681.00
xi	Barbed wire fencing charge (RKM)	81.84	Rs. 200000/- per RKM	16368000.00
	Total (Column No. F56+57)			27873681.00
			Or Say	27873681
	Supervisory / Over Head / Miscellaneous Charges		10% on the C.A. Charges	1341654.63
	Total (A) C.A. Charges			1341654.63
			Or Say	1341655
B	Additional Compensatory Afforestation Charges			
i	1st Year Cost of Afforestation	3398	336.70	1144106.60
ii	2nd Year Maintenance	3398	92.78	315266.44
iii	3rd Year Maintenance	3398	57.76	196268.48
iv	4th Year Maintenance	3398	10.73	36460.54
v	5th Year Maintenance	3398	10.73	36460.54
vi	6th Year Maintenance	3398	10.73	36460.54
vii	7th Year Maintenance	3398	10.73	36460.54
viii	8th Year Maintenance	3398	10.73	36460.54
ix	9th Year Maintenance	3398	10.73	36460.54
x	10th Year Maintenance	3398	10.73	36460.54
	Total Charges			1910865.30
xi	Barbed wire fencing charge (RKM)	13.59	Rs. 200000/- per RKM	2718400.00
	Total (Column No. F73+F74)			4629265.30
			Or Say Rs.	4629265
C	Penal C.A.			
D	Catchment Area Treatment			0
	Soil and Moisture Conservation Charges		30% of the Total C.A.	4024963.89
	Total (C+D)		Or Say Rs.	4024964
E	Safety Zone (if required)			0
F	Additional Charges (if required)	Qty.	Rate	0
	Total (E+F)			0
G	Felling Charges (Vol. M3)	1091.50	Rs.1400 /- per m ³	1528100
	Grand Total (A+B+C+D+E+F+G) to be deposited in CAMPA Fund			39397665

Technical Details :-

2 Technical Details of Compensatory Afforestation Scheme are as follows :-

a	General Details	Plantation will be done with 6 standard barbed wire in RF/PF.
b	Spacement.	4 x 2 ½ mtr.
c	Species.	Shisham, Kikar, Neem, Bakain and etc.
d	Plantation Method.	Strip Plantation.
e	Soil and Moisture Conservation Works.	Hoeing, Weeding & Soil Work.
f	Protection (Fencing, watchman, Peoples Participation etc).	Fencing with Barbed Wire/Protection Watcher
g	Proposed Monitoring Mechanisim.	Inspection by officers.
h	Any Other Information	No any.

Divisional Forest Officer
Fatehabad Forest Division
Fatehabad

Diversion of 33.71 Ha. (5.69 Ha. in Jind Division, 17.79 Ha. in Hisar Division and 10.23 Ha. in Fatehabad Division) of Forest Land in favour of Executive Engineer, Adampur Water Services Division, Hisar for Construction of Carrier Channel for Nuclear Power Plant at Village-Gorakhpur, Tehsil & Distt.-Fatehabad on old abandoned Sirsa Branch from RD 388500 to 424780 falling under Forest Division and Distt. Jind, Hisar and Fatehabad, Haryana.

Proposal No.

FP/HR/CANAL/152229/2022

NPV CALCULATION SHEET

	Description	Total Area	Rate	Total Amount (in Rs.)
A	Net Present Value of Forest Land to be Diverted	10.23	957780	9798089.40
Or Say Rs.				9798089

Diverted Land Detail

1	Eco Class	III
2	Canopy Density	Very Dense/Dense/Open
Total NPV Payable Amount		9798089

 Divisional Forest Officer,
 Fatehabad Forest Division
 Fatehabad,

Diversion of 33.71 Ha. (5.69 Ha. in Jind Division, 17.79 Ha. in Hisar Division and 10.23 Ha. in Fatehabad Division) of Forest Land in favour of Executive Engineer, Adampur Water Services Division, Hisar for Construction of Carrier Channel for Nuclear Power Plant at Village-Gorakhpur, Tehsil & Distt.-Fatehabad on old abandoned Sirsa Branch from RD 388500 to 424780 falling under Forest Division and Distt. Jind, Hisar and Fatehabad, Haryana.

CHECK LIST SERIAL NUMBER:- 20
"LAND SUITABILITY CERTIFICATE BY D.F.O CONCERNED"

This is to certified that **23.858** Ha. land bearing Survey
 No./ Compartment No **CA Site Name**

No.	C.A Site name	No. of Plants to be planted	Area required for Plantation (ha.)
1	Manawali Minor RD 24 to tail L/R Side	2900	2.9
2	Bighar Minor RD 0 to tail L/R Side	1900	1.9
3	Kheri Disrty RD 100 to 120 L/R Side	1900	1.9
4	Dhabi Minor RD 35 to 42 L/R Side	1400	1.4
5	Chaharwala Minor RD 0 to 10 L/R Side	1400	1.4
6	Kheri Disrty RD 44 to 58 L/R Side	1900	1.9
7	Khara Kheri Distry RD 0 to 20 L/R Side	1000	1
8	Khairampur Minor RD 0 to 16 L/R Side	1900	1.9
9	Lift Minor RD 0 to tail L/R Side	1400	1.4
10	Fatehabad Distry RD 140 to 190 L/R Side	3800	3.8
11	Munshiwal Minor RD 55 to 85 L/R Side	3358	3.5
12	Dehaman minor, RD 26 to 30 L/R Side	1000	1
	G.Total	23858	24

Village Bodiwali, Sarwarpur, Dhingsara, Matana, Dhanger, Bighar, Chaharwala, Daiyer, Dhabhi Khurd, Jandwala Baghar, Gadli, Chuli Bagaria, Kajal Heri, Khara Kheri, Bhoda Hoshnak, Bhuthan Kalan, Jhalnia, Khairampur, Malhad, Daulatpuriya, Dhani Binja Lamba. District Fatehabad

identified for Compensatory Afforestation is suitable for plantation from management point of view and is free from all sorts of encumbrances and encroachment.

Place : _____

Date : _____

 Divisional Forest Officer
 Fatehabad Forest Division
 Fatehabad.

Full title of the Project:- Diversion of 33.71 Ha of Forest Land for construction of channel for supply 180 Cs water to Nuclear Power Plant at Gorakhpur, Tehsil & District Fatehabad through old abandoned Sirsa Branch from RD 388500 to 424780 under Forest Division District Hisar, District Jind and District Fatehabad

File No. FP/HR/Canal/152229/2022

Date of Proposal 09.02.2022

UNDERTAKING

In respect of permission for the Diversion of 33.71 Ha of Forest Land for construction of channel for supply 180 Cs water to Nuclear Power Plant at Gorakhpur, Tehsil & District Fatehabad through old abandoned Sirsa Branch from RD 388500 to 424780 under Forest Division District Hisar, District Jind and District Fatehabad

It is hereby undertaking that before your final approval this office will give the necessary certificate regarding **Scheduled Tribes & other Traditional Forest dwellers Recognition of Forest Right Act 2006**, from the office of the Deputy Commission, Hisar.

It is requested you to please issue us in principle approval for the proposed diverted area.

Ramesh
Soo

Qx
Executive Engineer
Adampur W/S Division
HISAR
Sign of User Agency

JS
Divisional Forest Officer
Fatehabad Forest Division
Fatehabad

**SITE PLAN AND LAND DETAIL OF DISTRICT FATEHABAD
JURISDICTION .RD 395000 TO RD 424780**

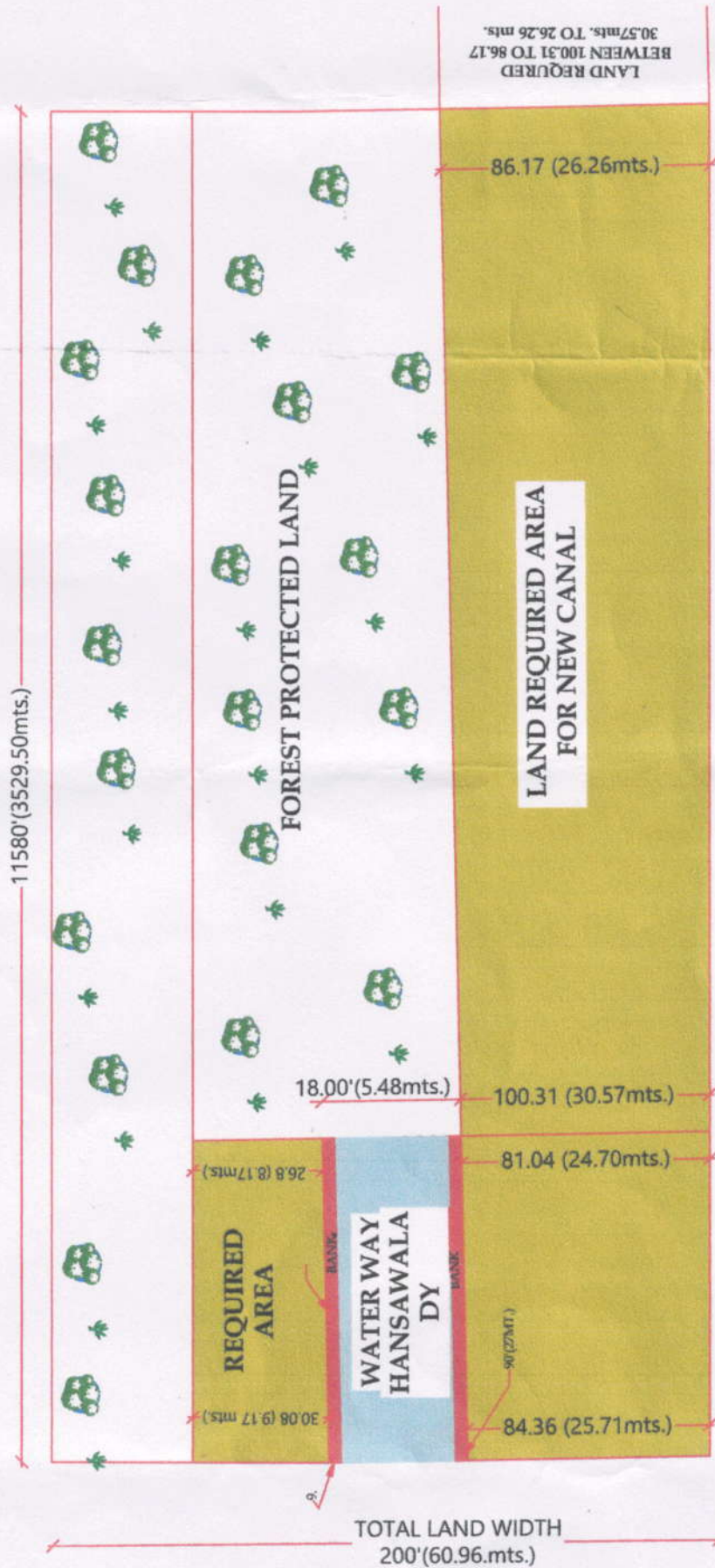

DETAIL OF LAND REQUIRED :-

LENGTH = 11580' (3529.58 mts.)

TOTAL AREA = 1133087' SFT.

D/D :- EXISTING HANSAWALA DY :- 1133087-32400 = 1100687 SFT
OR 102253.82 Sqm.

WATER WAY & BANK

OR = 25.27 ACRES OR 10.23 HAC.

Executive Engineer
Adampur W/S Division
HISAR

Rakesh
Sooj Purse