

**TAMILNADU FOREST DEPARTMENT**

From

Thiru. K. Rajkumar, IFS.,  
District Forest Officer,  
Dharmapuri Forest Division,  
Dharmapuri – 636 705.

To

The Principal Chief Conservator of  
Forests (Head of Department),  
Panagal Maaligai, Saidapet,  
Chennai – 600 015.

(Through Additional Principal Chief  
Conservator of Forests, Dharmapuri Circle,  
Dharmapuri.

---

**C.No. 2340 / 2016 / D, Dated. 19-06-2019**

Sir,

Sub : Forest (Conservation) Act 1980 – Dharmapuri Forest Division –  
Proposal for diversion of Forest land in Noolahalli-Reddihalli  
Reserve Forest of Dharmapuri Range for Construction of  
“Police Wireless VHF Repeater Station” in Vathalmalai village  
over an extent of 0.054 ha – Resubmission of proposal -  
Regarding.

Ref : 1. The Principal Chief Conservator of Forests (Head of  
Department), Chennai C.No.TS3 / 4742 / 2018, dated  
25-03-2019  
2. The Chief Conservator of Forests, Dharmapuri  
6109 / 2016 / D, dated 18-01-2019

~ \* ~ \* ~ \* ~ \* ~

I submit to state that in response to shortcomings noticed in the above proposal by the Principal Chief Conservator of Forests (Head of Department), Chennai in the 1<sup>st</sup> reference cited above, for rectification and resubmission of proposal through online i.e., in the proposal for diversion of 0.054 ha of forest land in Noolahalli-Reddihalli Reserved Forest in Dharmapuri Forest Range of Dharmapuri Forest Division for the purpose of construction of Police Wireless VHF Repeater Station in favour of Tamil Nadu Police, Dharmapuri is as follows.

2) As per the instructions by the Principal Chief Conservator of Forests (Head of Department), Chennai, the Compensatory Afforestation Scheme has been prepared with rate of 1,000 seedlings per ha with seven years maintenance in



Kalappambadi (Extension) RF and uploaded in the website and the same is enclosed with this report.

3) The geo-referenced map, surveyed sketch and kml files of the proposed Compensatory Afforestation land in Kalappambadi (Extension) RF is uploaded in the website and the same is enclosed with this report.

4) As per the instructions by the Principal Chief Conservator of Forests (Head of Department), Chennai, the compensatory area shown in Survey of India Toposheet (Number D43X16) is enclosed with GPS readings and the same is uploaded in the website.

I submit that, the reply along with above said documents are enclosed herewith for kind consideration of Principal Chief Conservator of Forests and for obtaining Government Orders at the earliest.

Enclosure. As stated above. (in duplicate)

Yours faithfully,

*[Signature]*  
19/06/2019

*[Signature]*  
19/6/2019.  
District Forest Officer,  
Dharmapuri Forest Division,  
Dharmapuri.

Copy to the Additional Principal Chief Conservator of Forests, Dharmapuri Circle, Dharmapuri with enclosure.

Copy to the Superintendent of Police, Dharmapuri.



**ABSTRACT**

**COMPENSATORY AFFORESTATION SCHEME**

**Cost estimate for Compensatory Afforestation scheme in 1.00 ha. in Kalappambadi Extension RF of Dharmapuri Division, including maintenance of plantation for seven years**

Sl. No.	Details of work	Year	Unit	Rate per unit	Amount proposed
<b>I. Compensatory Afforestation for Taller Seedlings</b>					
1	Raising nursery for taller seedlings (30x45) @ 1,000 No per ha. for 1.00 ha including 10% casualities during 2019-2020 (12.75 x 1,100 No)	2019-2020	1 ha.	Rs. 90,200.00	Rs. 90,200.00
2	Planting the taller seedlings in 1.00 ha of at Mukkalnayakkanahalli RF during 2020-2021	2020-2021	1 ha.	Rs. 3,69,100.00	Rs. 3,69,100.00
3	First year maintenance	2021-2022	1 ha.	Rs. 1,79,500.00	Rs. 1,79,500.00
4	Second year maintenance	2022-2023	1 ha.	Rs. 1,97,500.00	Rs. 1,97,500.00
5	Third Year Maintenance - (10% of the previous year maintenance cost)	2023-2024	1 ha.	Rs. 19,800.00	Rs. 19,800.00
6	Fourth Year maintenance (taller seedlings) - (Add 10% cost escalation in the previous year maintenance cost)	2024-2025	1 ha.	Rs. 21,800.00	Rs. 21,800.00
7	Fifth Year maintenance (taller seedlings) - (Add 10% cost escalation in the previous year maintenance cost)	2025-2026	1 ha.	Rs. 24,000.00	Rs. 24,000.00
8	Sixth Year maintenance (taller seedlings) - (Add 10% cost escalation in the previous year maintenance cost)	2026-2027	1 ha.	Rs. 26,400.00	Rs. 26,400.00
9	Seventh year maintenance (taller seedlings) - (Add 10% cost escalation in the previous year maintenance cost)	2027-2028	1 ha.	Rs. 29,100.00	Rs. 29,100.00
12	Providing water facility for the planted seedlings	LS	1 ha.		Rs. 50,000.00
<b>Total cost required for compensatory afforestation in 1.00 ha.</b>					Rs. 10,07,400.00
					(or) Rs. 10,07,500.00
<b>(Average cost per ha. is Rs.</b>		<b>Rs.</b>	<b>10,07,500.00</b>		

**K RAJKUMAR** Digitally signed by K RAJKUMAR  
Date: 2019.06.19 15:50:59 +05'30'  
District Forest Officer,  
Dharmapuri Forest Division,  
Dharmapuri.



**Model estimate for raising nursery for taller saplings (30 cm x 45 cm size) in 1.00 ha of Compensatory Afforestation in the degraded forest area of Kalappambadi Extension RF**

Period of nursery	: 10 months	Area of CA land in ha.	1.00
Size of poly bags	: 30 cm x 45 cm x 450G	No. of seedling planed per ha.	1,000
		Total No. of saplings to be planted :	1,000
		Add 10% extra for causalities	100
		Total No. of Saplings to be raised :	<u>1,100</u>
Nursery Location	: Private Land	Labour rate for 2018-2019	: Rs. 326.50

Sl. No.	Qty.	Description of work	FSR. item No.	FSL	Rate per unit		Amount
1	1,100 Nos	Cost of Polythene bags 30 x 45 cm x 600G (Rs.7,594 + 18% GST)	As per tender rate 2018-19		Rs. 8,960.92	1,000 No	Rs. 9,857.00
2	165 m <sup>2</sup>	Preparation of nursery by clearing and levelling the site for forming standard beds of 10m x 1m size (1,500 m <sup>2</sup> for 10000 Nos)	4.1	2.42	Rs. 790.13	200 M2	Rs. 652.00
3	2.00 Kg	Cost of seeds (20kg for 10000 Nos)	LR		Rs. 150.00	1 kg	Rs. 300.00
4	1 m <sup>3</sup>	Formation of germination bed of size 10mx1mx0.30m by heaping the soil.	PWD SSR 2018-19 Item No.62		Rs. 63.60	1 M3	Rs. 64.00
5	1 Bed 15 days	Watering the germination beds twice daily with the rose can for 15 days.	4.5.1	0.82	Rs. 267.73	10 Beds/ days	Rs. 402.00
6	1 Bed 15 days	Watering the germination beds once daily with the rose can for 15 days.	4.5.2	0.41	Rs. 133.87	10 Beds/ days	Rs. 201.00
7	1,100 No.	Preparation of soil mixture by breaking clods, sieving & mixing with red soil, silt and sand etc. according to requirements and farmyard manure in the ratio 4:1 heaping at the filling site and filling in polythene bags and arranging bags in beds and pricking out the seedlings (excluding cost of soil mixture and FYM)	4.6.7	28.57	Rs. 9,328.11	1,000 Nos	Rs. 10,261.00
8	39.00 kg	Cost of Vermicasting @ 35 gms/seedlings	as per Research Unit Rate		Rs. 10.00	1 kg	Rs. 390.00



Sl. No.	Qty.	Description of work	FSR. item No.	FSL	Rate per unit		Amount
9	17.00 kg	Cost of VAM @ 15gms/seedlings	as per Research Unit Rate		Rs. 18.00	1 kg	Rs. 306.00
10	7.00 kg	Cost of Azospirillum @ 6gms/seedlings	as per Research Unit Rate		Rs. 27.00	1 kg	Rs. 189.00
11	7.00 kg	Cost of Phosphobacteria @ 6gms/seedlings	as per Research Unit Rate		Rs. 27.00	1 kg	Rs. 189.00
12	1,100 No	Cost of vertical sticks of size 2.50m height.	As per PCCF Chennai. C.No.TS3 / 33950 / 2013, dated: 12.06.2015.		Rs. 6.00	1 No.	Rs. 6,600.00
13	550 No	Cost of horizontal sticks.			Rs. 1.00	1 No.	Rs. 550.00
14	1,100 No 2 times	Tying plants to the vertical stick once in a month - 2 times..			Rs. 0.20	1 time	Rs. 440.00
15	1,100 Nos 2 times	Pruning side branches once in 2 month - 2 times.			Rs. 1.00	1 time	Rs. 2,200.00
16		Watering the container plants with rose can. (Watering regime as per the NHAI ME approved in PCCF's Ref.No. J1 / 57395 / 2003, dated : 12.12.2003)					
	1,100 No	a) Twice daily - 60 days.	4.10.7	0.56	Rs. 182.84	1,000 No / day	Rs. 12,067.00
	1,100 No	b) Once daily - 210 days.	4.11.7	0.28	Rs. 91.42	1,000 No / day	Rs. 21,118.00
17	1,100 No	Shifting the container once in 21 days first shift is after 45 days from the date of pricking out - 6 times.	4.15.7	2.69	Rs. 878.29	1,000 No / shift	Rs. 5,797.00
18	1100 No	Cost of water for watering the container seedlings from the private wells - 270 days.			Rs. 3.20	1,000 No / shift	Rs. 986.00
19	66 m <sup>2</sup>	Land rent nursery in private lands for 10 months (60.00sq.m. for 1000 No)	4.17 (FSR 1998-1999)		Rs. 86.00	40.00 Sq.m	Rs. 1,419.00
20	1100 No	Nursery Protection mazdoor 1No./20,000Nos. of 30 x 45cm bags - 300 days	Wages rate	0.50	Rs. 326.50	10,000 No / MD	Rs. 5,387.00



Sl. No.	Qty.	Description of work	FSR. item No.	FSL	Rate per unit	Amount
21	LS	Contingencies for application of pesticides and panchagavya, providing nursery name board etc., and unforeseen items of works if any.			LS	Rs. 2,625.00
<b>Total cost for 1,000 seedlings</b>						<b>Rs. 82,000.00</b>
<b>Cost per seedlings</b>						<b>Rs. 82.00</b>

**Cost Estimation for Raising Nursery**

- 1 Total cost required for raising nursery for taller saplings for 1.00 ha during 2018 - 2019 Rs. 82,000.00
- 3 Total cost required for raising nursery during 2019-2020. (including 10% cost escalation for 2019-2020 ) Rs. 90,200.00

**Specifications :**

This estimate is prepared based on the Model Estimate 2015-16 for Compensation Afforestation plantations communicated by the Principal Chief Conservator of Forests, Chennai C.No.TS3 / 33950 / 2013, dated: 12.06.2015 and also as per 2018 -2019 FSR communicated by the Chief Conservator of Forests, Dharmapuri circle vide Ref. No.3734/2018/D/ Dated : 07.05.2018.

**K RAJKUMAR** Digitally signed by K RAJKUMAR  
Date: 2019.06.19 15:51:32 +05'30'

District Forest Officer,  
Dharmapuri Division,  
Dharmapuri,



**Model estimate for planting the taller seedlings (30 x 45cm size) for Compensatory Afforestation over an area of 1.00 ha. in the degraded forest areas of Kalappambadi Extension RF**

Size of poly bags : 30 cm x 45 cm x 450G

Area of CA land in ha.	1.00
No. of seedling to be planed per ha.	1,000
Total No. of saplings to be planted	: 1,000
Add 10% extra for casualities	100
Total No. of Saplings to be raised	: <u>1,100</u>
Labour rate for 2018 -2019	: Rs. 326.50

Nursery Location : Private Land

Sl. No.	Quantity	Description of works	FSR item No.	FSL	Rate	Per	Amount
1	1,000 No.	Digging of 60 cm <sup>3</sup> pits in all types of soils during rainy season.	5.8.1	7.72	Rs. 2,520.58	100 Nos	Rs. 25,206.00
2	500 kg.	Cost and transport of poultry manure @ 500 g per plant.	L.R. and As per ME		Rs. 5,000.00	1,000 kg.	Rs. 2,500.00
3	1,000 No.	Application of poultry manure @ 500 g per plant by mixing in the pit before planting - @ 1 Mazdoor for 200 plant.	L.R. and As per ME		Rs. 326.50	200 Nos.	Rs. 1,633.00
4	1,000 No.	Cost of bio fertilizer including cost of application (Vermicompost-1kg, Bio-fertilizer-100gand VAM-100g).	NHAI Model Estimate		Rs. 7.70	1 No.	Rs. 7,700.00
5	1,100 No.	Transporting of container saplings to the radius of 40km excluding loading and unloading.	NHAI Model Estimate		Rs. 7.00	1 No.	Rs. 7,700.00
6	1,100 No.	Loading & unloading the polythene container seedlings (30x45cm) in private / department vehicles (excluding hire charges).	5.11.7	3.29	Rs. 1,074.19	1,000 Nos	Rs. 1,182.00
7	1,100 No.	Transporting of (30x45cm) polythene container seedlings by head loads unto 500m in hills / hillocks.	5.13.2 (i)	34.00	Rs. 11,101.00	1,000 Nos	Rs. 12,211.00
8	1,100 No.	Distribution of polythene container saplings from where seedlings are stacked to the planting spot unto 500m in hills / hillocks.	5.15.3	52.50	Rs. 17,141.25	1,000 Nos	Rs. 18,855.00
9	1,000 No.	Planting the container plants by refilling pits of 60cm <sup>3</sup> size in plains and hillocks.	5.22	1.71	Rs. 558.32	100 Nos	Rs. 5,583.00
10	1,000 Nos	Scraping for 1m dia and soil working 15cm depth around each plants and removing the grass roots away from the site of upturning the soil	5.24	1.23	Rs. 401.60	100 Nos	Rs. 4,016.00



Sl. No.	Quantity	Description of works	FSR item No.	FSL	Rate	Per	Amount
11	1,000 Nos	Forming semi circular bunds to the plants in the hillocks by collecting the stones and earth from the area and forming revetment on the lower side with stones and earth heaped and giving inward slope.	5.25	2.88	Rs. 940.32	100 Nos	Rs. 9,403.00
12	1,000 No.	Forming catch water drains for each plant of size 0.90 x 0.45 x 0.30m in hillocks and hard gravelly soil.	5.26	6.84	Rs. 2,233.26	100 Nos	Rs. 22,333.00
13	100 No.	Replacement of casualties by reopening failed pits of 60cm <sup>3</sup> pits and planting the container plants by refilling pits of size 60cm <sup>3</sup> (1/2 pitting rate + full planting rate).	5.23	5.57	Rs. 1,818.61	100 Nos	Rs. 1,819.00
14	1,000 No. 15 days	Watering the plants once in 6 days during summer / non-rainy period from January to March @ 1 Mazdoor for 200 plants / watering day - 15 watering days.	NHAJ Model Estimate		Rs. 326.50	200 Nos	Rs. 24,488.00
15	3,00,000 litre	Cost of water 20 litre per seedlings from January to March - 15 watering days @ the rate once in 6 days = 20x4000x15 =120000 litre.	NHAJ Model Estimate		Rs. 1,200.00	12,000 litre	Rs. 30,000.00
16	360 MD	Engaging protection mazdoor (1 mazdor for 12 months after planting).	Wages rate		Rs. 326.50	1 MD	Rs. 1,17,540.00
17	1 Nos.	Erection of name boards	LR		Rs. 5,000.00	1 No.	Rs. 5,000.00
18	200 m	Scraping annually fire line to a width of 6m in hill areas (2000m for 10ha).	2.2.1	30	Rs. 9,795.00	1,000 m	Rs. 1,959.00
19	LS	Contingencies to meet out unforeseen items of works such as Documentation charges & Erection of Information Board etc. complete.	LS				Rs. 5,872.00
<b>Total cost for 1.00 ha.</b>							<b>Rs. 3,05,000.00</b>

- 1 Total cost required for planting for 1.00 ha during 2018-2019      Rs. 3,05,000
- 2 Cost required for planting for 1.00ha during 2019-2020  
(including 10% cost escalation)      Rs. 3,35,500
- 3 Cost required for planting per 1.00ha during 2020-2021  
(including 10% cost escalation)      Rs. 3,69,100



**Specifications :**

This estimate is prepared based on the Model Estimate 2015-2016 for Compensation Afforestation plantations communicated by the Principal Chief Conservator of Forests, Chennai C.No.TS3 / 33950 / 2013, dated: 12.06.2015 and also as per 2018-2019 FSR communicated by the Chief Conservator of Forests, Dharmapuri circle vide Ref. No.3734/2018/D/ Dated : 07.05.2018.

**K RAJKUMAR**

Digitally signed by K RAJKUMAR  
Date: 2019.06.19 15:52:01 +05'30'

District Forest Officer,  
Dharmapuri Division,  
Dharmapuri,



**Model Estimate for I & II Year maintenance of planted saplings over an area of 1.00 ha. of Compensatory Afforestation areas of Kalappambadi Extension RF**

Size of poly bags : 30 x 45cm x 600G

Total No. of seedlings planted : 1,000

Seedlings planted for 1st year maint. 100

Wage Rate for 2018-2019 Rs. 326.50

Sl. No.	Quantity	Description of works	FSR item No.	FSL	Rate	Per	Amount
1	100 Nos	Raising cost of taller seedlings 30 x 45 x 600 G bags for casualty replacement	ME		Rs. 82.00	1 No.	Rs. 8,200.00
2	50 kg.	Cost and transport of poultry manure @ 500g per plant.	Local Rate		Rs. 5,000.00	1000 kg.	Rs. 250.00
3	100 Nos	Application of poultry manure @ 500g per plant by mixing in the pit before planting - @ 1 Mazdoor for 200 plant.	Local Rate		Rs. 326.50	200 Nos.	Rs. 163.00
4	100 Nos.	Cost of Bio-fertilizer including cost of application (Vermicompost-1kg, Bio-fertilizer-100g and VAM-100g).	NHAI Model Estimate		Rs. 7.70	1 No.	Rs. 770.00
5	100 Nos.	Transporting of container saplings to the radius of 40km excluding loading and unloading.	NHAI Model Estimate		Rs. 7.00	1 No.	Rs. 700.00
6	100 Nos	<b>Loading &amp; unloading</b> the polythene container seedlings (30x45cm) in private / department vehicles (excluding hire charges).	5.11.7	3.29	Rs. 1,074.19	1000 Nos	Rs. 107.00
7	100 Nos	Transporting of (30x45cm) polythene container seedlings by <b>head loads</b> up to 500m in hills / hillocks.	5.13.2 (i)	34.00	Rs. 11,101.00	1000 Nos	Rs. 1,110.00
8	100 Nos	Distribution of polythene container saplings from where seedlings are stacked to the planting spot up to 500m in hills / hillocks.	5.15.3	52.50	Rs. 17,141.25	1000 Nos	Rs. 1,714.00
9	100 Nos	Replacement of casualties by reopening failed pits of 60cm <sup>3</sup> pits and planting the container plants by refilling pits of size 60cm <sup>3</sup> (1/2 pitting rate + full planting rate).	5.23	5.57	Rs. 1,818.61	100 Nos	Rs. 1,819.00
10	1000 Nos	Scraping for 1m dia and soil working 15cm depth around each plants and removing the grass roots away from the site of upturning the soil	5.24	1.23	Rs. 401.60	100 Nos	Rs. 4,016.00



Sl. No.	Quantity	Description of works	FSR item No.	FSL	Rate	Per	Amount
11	1000 Nos 30 days	Watering the plants once in 6 days during summer / non-rainy period from January to June (Mazdoor for 200 plants / watering day - 30 watering days).	NHAI ME		Rs. 326.50	200 Nos	Rs. 48,975.00
12	600000 litre	Cost of water 20 litre per seedlings from January to March (30 watering days) @ the rate once in 6 days = $20 \times 30 \times 4000 / 2 = 2,40,000$ litre.	NHAI ME		Rs. 1,200.00	12000 litre	Rs. 60,000.00
13	200 m	Scraping annually fire line to a width of 6m in hill areas.	2.2.1	30.00	Rs. 9,795.00	1000 m	Rs. 1,959.00
14	LS	Contingencies to meet out unforeseen items of works such as documentation charges & erection of Information Board etc. complete .	LS				Rs. 4,913.00
<b>Total for 1.00 ha.</b>							<b>Rs. 1,34,696.00</b>

- |   |  |              |
|---|--|--------------|
| 1 | Total cost required for First year maintenance of 1.00 ha during 2018-2019                                   | Rs. 1,34,696 |
| 2 | Cost required for first year maintenance of 1.00 ha during 2019-2020 (including 10% cost escalation)         | Rs. 1,48,200 |
| 3 | Cost required for first year maintenance of 1.00 ha during 2020-2021 (including 10% cost escalation)         | Rs. 1,63,100 |
| 4 | First year maintenance - Rate per ha. for 2021-2022 including 10% cost escalation in the previous year rate  | Rs. 1,79,500 |
| 5 | Second year maintenance - Rate per ha. for 2022-2023 including 10% cost escalation in the previous year rate | Rs. 1,97,500 |

**Specifications :**

This estimate is prepared based on the Model Estimate 2015-16 for Compensation Afforestation plantations communicated by the Principal Chief Conservator of Forests, Chennai C.No.TS3 / 33950 / 2013, dated: 12.06.2015 and also as per 2018-19 FSR communicated by the Chief Conservator of Forests, Dharmapuri circle vide Ref. No.3734/2018/D/ Dated : 07.05.2018.

**K RAJKUMAR**

Digitally signed by K RAJKUMAR  
Date: 2019.06.19 15:58:28  
+05'30'

District Forest Officer,  
Dharmapuri Division,  
Dharmapuri.



## **Certificate regarding suitability of Land of Compensatory Afforestation**

This is to certify that the Compensatory Afforestation area has been identified in the degraded forest of Kalappambadi Extension RF instead of Noolahalli-Reddihalli RF for diversion of 0.054 ha of forest land for the purpose of Construction Communication Tower with Police Wireless VHF Repeater Station at Vathalmalai in Noolahalli-Reddihalli RF. The degraded portion of this area has been inspected by me on 14<sup>th</sup> June 2019 and it is suitable for raising Compensatory Afforestation. The proposed Compensatory Plot is easily approachable and manageable for afforestation activities.

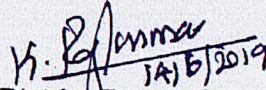
  
District Forest Officer,  
Dharmapuri Forest Division,  
Dharmapuri.



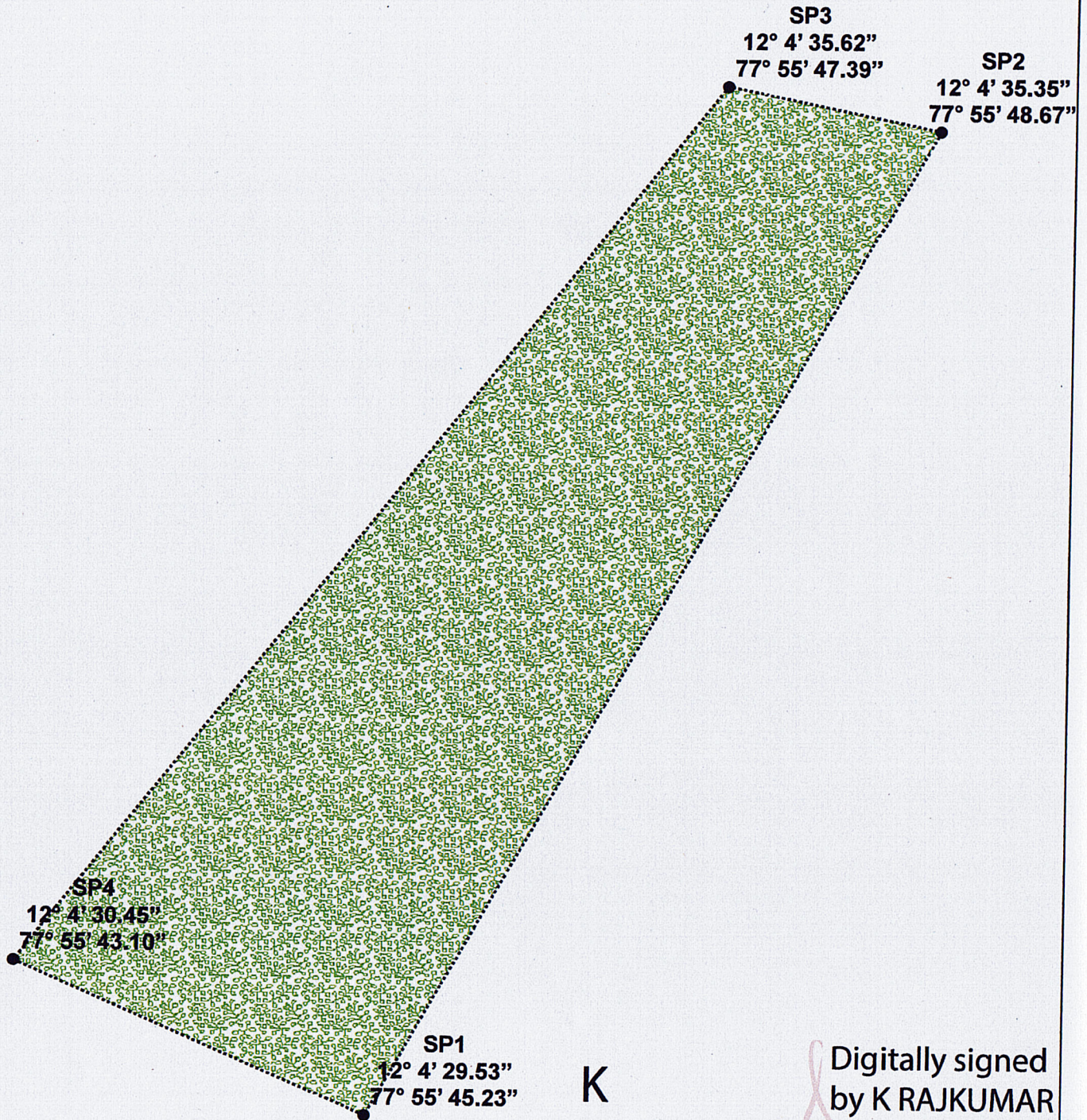
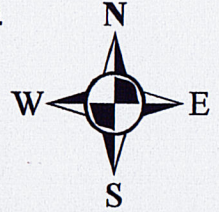

**Proposed Compensatory Afforestation Plot in  
Kalappambadi (Extension) RF in Dharmapuri Division**



**K**  
**RAJKUMAR**  
Digitally signed  
by K RAJKUMAR  
Date: 2019.06.19  
15:42:40 +05'30'

Area 1.08 ha  
Scale 1:750

**Legend**

-  Proposed Compensatory Afforestation Plot
-  Survey Points



# Proposed Compensatory Afforestation Plot in Kalappambadi (Extension) RF in Dharmapuri Division

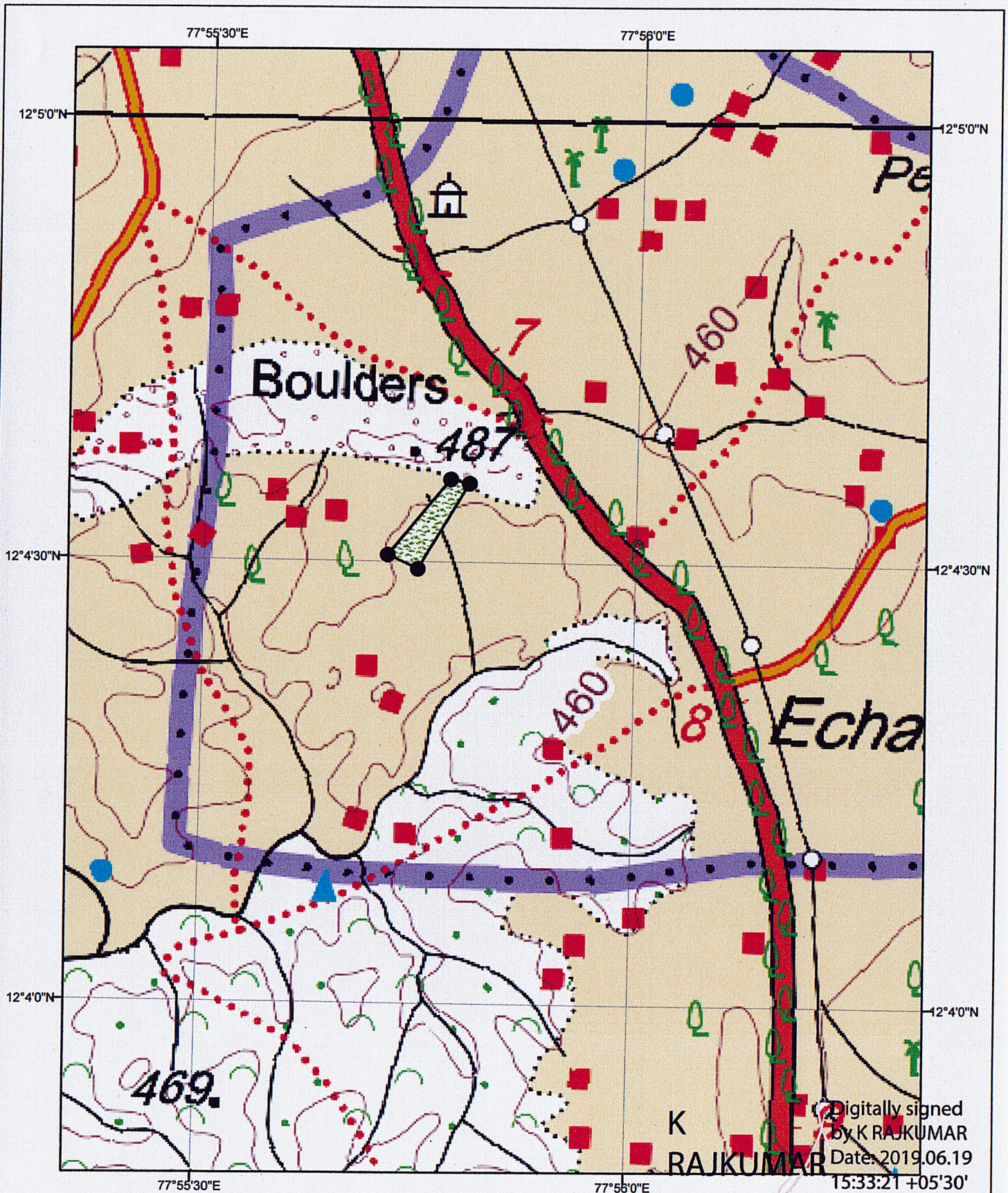
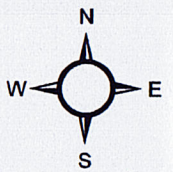

**Toposheet No.**  
**OSM - D43 X16**

**Scale 1:7,500**  
**Area 1.08 ha**

Legend



Proposed Compensatory Afforestation Land



Survey Points