

**GOVERNMENT OF ANDHRA PRADESH
FOREST DEPARTMENT**

FROM

Sri P.Ramakrishna, IFS.,
Conservator of Forests,
Kurnool Circle, Kurnool.

TO

The Prl.Chief Conservator of Forests &
Head of Forest Force,
Andhra Pradesh, Guntur.

Rc.No.2576/2018-TO, Dated:-13.07.2022

Sir,

Sub:- APFD – F(C)Act, 1980 – Diversion of forest land over an extent of 2.90 Ha. in Compt.No.313, Gulamaliabad South R.F, Dhône Range, Kurnool Division & District in favour of M/s Sainath Stone Crushers (Mg.Prt. Sri Y.Bala Thimma Reddy) for grant of quarry lease for Road metal – Additional Information submission off – Reg.

Ref:- 1) PCCF, AP, Guntur Rc.No.EFS02-15029/59/2018/FCA-SEC-PCCF/FCA-1(ii), Dt.06.03.2022

2) DFO, Kurnool Rc.No.2656/2018/H5, Dt.08.07.2022.

Adverting to the reference 1st cited, it is submitted that in the reference 2nd cited, the District Forest Officer, Kurnool has submitted the additional information as sought in Prl.Chief Conservator of Forests reference 1st cited. The additional information has submitted by the District Forest Officer point wise is submitted hereunder.

Point	Reply
1) Furnish the location of the pits and status of reclamation of forest land exhausted for minerals regarding the existing lease of Sri Y.Bala Thimma Reddy, Banaganapalli	<p>The DFO, Kurnool has submitted that the location of the pits of the existing quarry lease under operation by Sri Y.Bala Thimma Reddy, Banaganapalli in Compt.No.313 of G.A.Bad South RF duly signed by the DFO,Kurnool is enclosed in (6) sets.</p> <p>Further the DFO, Kurnool has submitted that the user agency has submitted that an area of 2.625 Ha. granted Quarry lease in Compt.No.313, G.A.Bad South RF, Dhône Range, Kurnool Division in favour of Sri Y.Bala Thimma Reddy vide G.O.Ms.No.85, EFS&T (For.I) Dept, Dt.31.10.2012 for mining of quarry Road metal from 03.10.2012 to 02.10.2022. The</p>

	<p>mining operations were carried out in 2.00 Ha. area only as against 2.625 Ha. granted for lease. Out of 2.00 Ha. in which mining carried in about 1 Ha. area reclamation work has already been completed by filling with waste dump available in the mining area. The remaining balance area i.e., about 1 Ha. is under operation for mining. The user agency further stated that after expiry of the lease period, the reclamation work in this balance area i.e., 1 Ha. will also be attended well before completion of the mining lease period and it will be handed over back to the Forest Department accordingly.</p>
<p>2) It is reported that the user agency will utilize the common road of M/s GMR Stone crushers to transport the quarried material. But NoC from M/s GMR stone crusher was not submitted. Hence it is requested to obtain the NOC from M/s GMR stone crusher and submit to this office for processing the proposals.</p>	<p>The DFO, Kurnool has submitted that the user agency has submitted that a copy of NOC in the form of affidavit obtain from M/s GMR Stone Crusher for utilization of common road by M/s Sainath Stone Crushers (Mg.Prt. Y.Bala Thimma Reddy). The affidavit copy in (6) sets as furnished by the user agency is enclosed.</p>
<p>3) Calculate and incorporate NPV Rates as per the revised NPV rates issued by GOI, MoEF & CC, New Delhi F.No.5-3/2011-FC (Vol.I), Dt.06.01.2022</p>	<p>The DFO, Kurnool has submitted that the NPV has been calculated as per the revised NPV rates issued by GOI, MoEF & CC, New Delhi F.No.5-3/2011-FC (Vol.I) Dt.06.01.2022. The NPV arrived as per the new rates duly signed by the DFO, Kurnool in (6) is enclosed.</p>
<p>4) Submit details of non forest land used for dumping of Road metal</p>	<p>The DFO, Kurnool has submitted that the user agency has submitted that an area of 1.855 Acres in Sy.No.293 of Bhanumukala (V), Banaganapalli</p>

(M) located outside the Reserve forest is belongs to Sri Y.Bala Thimma Reddy of Banaganapalli as per land record i.e., 1B Form downloaded from the meebhoomi website and Pattadhar Passbook and Ownership Deed pertains to Sri Y.Bala Thimma Reddy, who is owner of the M/s Sainath Stone Crushers. Out of 1.855 Acres, about 1 Acres situated in above Sy.No. at South-East corner will be utilized for dumping of overburden obtained from the proposed quarry lease area. The copies of ownership deed, sketch of land, Pattadar passbook in (6) sets are enclosed.

Further the District Forest Officer, Kurnool has also submitted the information regarding other mining leases existing in Compt.No.313 of G.A.Bad South Reserve forest, Dhone Range of Kurnool Division obtained from the Deputy Director, Mines & Geology, Kurnool along with the details of existing mining leases in favour of M/s Sainath Stone Crushers (Mg.Prt Sri Y.Bala Thimma Reddy) is also submitted in her report. A copy of the District Forest Officers report is enclosed.

This is submitted for favour of information and necessary action.

Encl:- As above.

Yours faithfully,
Sd/-P.Ramakrishna,
Conservator of Forests,
Kurnool Circle, Kurnool.

//t.c.b.o//

P. Sainath Reddy
Technical Officer
16/7/22

NET PRESENT VALUE (NPV) CALCULATION SHEET

Statement showing the calculation of Net Present Value in the proposed area for diversion of forest land over an extent of **2.90 Ha** (Mining Area-2.27 ha, Safety Zone area-0.61 ha & Road area-0.02 ha) of Forest land for grant of quarry lease for road metal in Compt.No.313, G.A Bad South Reserve Forest, GA Bad Beat, Banaganapalli Section, Dhone Range of Kurnool Division in favour of **M/s Sainath Stone Crushers [Mg.Partner:Y.Balathimma Reddy]**, Banaganapalli

[As per GoI, MoEF&CC (FC Division), New Delhi, F.No.5-3/2011-FC(Vol-I), dt.06.01.2022 communicated in Principal Chief Conservator of Forests & HoFF, A.P., Guntur Ref.no.EFS02-15032/1/2022-FCA, Dt:18.01.2022.]

Sl. No	Category	Description	Area proposed for diversion in Ha	Net Present Value per Ha	Increase the value as per order of the Supreme Court of India in sanctuaries 5 times on the NPV rate	Total of Net Present Value (NPV)
1	Eco-class-III Open Forest	Consisting of Tropical Dry Deciduous Forests	2.90 ha	Rs.9,57,780/- per Ha	0	Rs.27,77,562/- 2.90 Ha x Rs.9,57,780 Rs.27,77,562/- (Twenty seven lakhs seventy seven thousand five hundred and sixty two only)

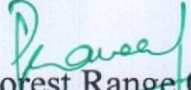
Forest Range Officer,
Dhone Range

Place: Kurnool
Date: 08-07-2022

Signature

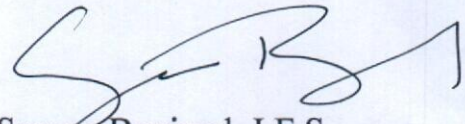

Name: Ms. Suman Beniwal, I.F.S,

Designation: District Forest Officer, Kurnool

NET PRESENT VALUE (NPV) CALCULATION SHEET

Statement showing the calculation of Net Present Value in the proposed area for diversion of forest land over an extent of 2.90 Ha (Mining Area-2.27 ha, Safety Zone area-0.61 ha & Road area-0.02 ha) of forest land for grant of quarry lease for road metal in Comp. No. 313, G.A. Bad South Reserve Forest, GA Bad Bad, Banaganapalli Section, Dhone Range of Kurnool Division in favour of M/s Sainath Stone Crushers [M/s. Partner: Y. Balakrishna Reddy], Banaganapalli.

[As per Govt. MoF&C (FC Division), New Delhi, F.No. 3-32911-FC(Vol-I), dt. 06.01.2022 communicated in Principal Chief Conservator of Forests & Hort. A.P., Guntur Ref. no. EP502/2022-12022-FC, dt. 18.01.2022.]

Sl. No.	Category	Description	Area proposed for diversion in Ha	Net Present Value per Ha	increase the value as per order of the Supreme Court of India in amount 3 times of the NPV rate	Total of Net Present Value (NPV)
1	Eco-class-III Open Forest	Consisting of Tropical Dry Deciduous Forests	2.90 ha	Rs. 9,27,780/- per Ha	0	Rs. 27,77,562/- (Twenty seven lakhs seven thousand five hundred and sixty two only)

Forest Range Officer,
Dhone Range

Signature
Name: Ms. Suman Beniwal, I.F.S.
Designation: District Forest Officer, Kurnool

Place: Kurnool
Date: 06-07-2022

To
The District Forest Officer,
Kurnool Division,
Kurnool.

Dated:-07.07.2022

Respected Madam,

Sub:- APFD – F(C)Act, 1980 – Proposals for diversion of forest land over an extent of 2.900 Ha. in Compt.No.313 of G.A.Bad South Block, Dhone Range of Kurnool Division & District in favour of M/s Sainath Stone Crushers (Mg.Prt. Sri Y.Bala Thimma Reddy) for grant of quarry lease for Road metal – Additional information as called for – Submitted- Reg.

Ref:- PCCF, AP, Guntur Rc.No.EFS02-15029/59/2018-FCA-SEC-PCCF/FCA-1(ii), Dt.06.03.2022 communicated in DFO, Kurnool Rc.No.4424/2018-H5, Dt.18.04.2022

In obedience to the reference cited, I, Sri Y.Bala Thimma Reddy, R/o Banaganapalli Mg.Prt. of M/s Sainath Stone Crushers submit that the addition information as sought by the Prl.Chief Conservator of Forests, Andhra Pradesh, Guntur vide reference 1st cited, point wise is submitted herewith for favour of kind perusal and further process.

Point	Reply
1) Furnish the location of the pits and status of reclamation of forest land exhausted for minerals regarding the existing lease of Sri Y.Bala Thimma Reddy, Banaganapalli	<p>The location map of pits of the existing quarry lease under operation by Sri Y.Bala Thimma Reddy, Banaganapalli in Compt.No.313 of G.A.Bad South RF is enclosed.</p> <p>It is further submitted that an area of 2.625 Ha. granted Quarry lease in Compt.No.313, G.A.Bad South RF, Dhone Range, Kurnool Division in favour of Sri Y.Bala Thimma Reddy vide G.O.Ms.No.85, EFS&T (For.I) Dept, Dt.31.10.2012 for mining of quarry Road metal from 03.10.2012 to 02.10.2022. The mining operations were carried out</p>

	<p>in 2.00 Ha. area only as against 2.625 Ha. granted for lease. Out this 2.0 Ha. under operation, about in 1 Ha. area reclamation work has already been completed by filling with waste dump available in the mining area. The remaining balance area i.e., about 1 Ha. is under operation. After expiry of the lease period, the reclamation work in this balance area of 1 Ha. will also be attended well before completion of the mining lease period and it will be handed over back to the Forest Department.</p>
<p>2) It is reported that the user agency will utilize the common road of M/s GMR Stone crushers to transport the quarried material. But NoC from M/s GMR stone crusher was not submitted. Hence it is requested to obtain the NOC from M/s GMR stone crusher and submit to this office for processing the proposals.</p>	<p>The copy of NOC affidavit obtain from M/s GMR Stone Crusher in utilization of common road by M/s Sainath Stone Crushers (Mg.Prt. Y.Bala Thimma Reddy) is enclosed for perusal.</p>
<p>3) Calculate and incorporate NPV Rates as per the revised NPV rates issued by GOI, MoEF & CC, New Delhi F.No.5-3/2011-FC (Vol.I), Dt.06.01.2022</p>	<p>Pertains to DFO's Office Kurnool. However it is submitted that the undertaking in payment of NPV and additional NPV as worked out by the DFO already been submitted along with the proposals.</p>
<p>4) Submit details of non forest land used for dumping of Road metal</p>	<p>It is submitted an area of 1.855 Acres in Sy.No.293 of Bhanumukala (V), Banaganapalli (M) located outside the Reserve forest is pertains to Sri Y.Bala Thimma Reddy of Banaganapalli, who is owner of the M/s Sainath Stone Crushers of which about 1 Acres situated at South-East corner in this survey number will</p>

	be utilized for dumping of overburden obtained from the proposed quarry lease area. The copies of ownership deed, sketch of land, Pattadar passbook are enclosed for perusal.
--	---

In view of the above, I request that the proposals may kindly be further processed at the earliest.

Thanking you Madam,

Encl:- As above.

Yours faithfully,

Y. Bala Thimma Reddy

(Y.BALA THIMMA REDDY)
M/s Sainath Stone Crushers,
R/o Banaganapalli

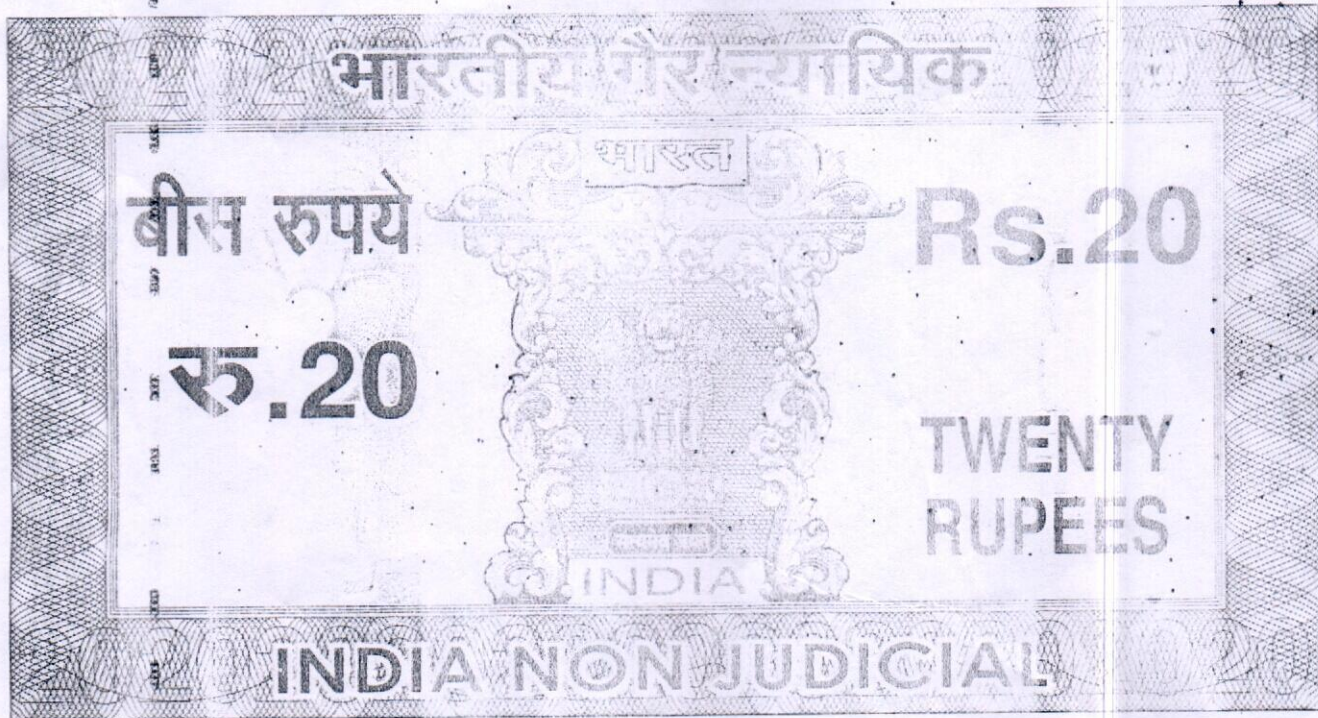

ఆంధ్ర ప్రదేశ్ ANDHRA PRADESH

S.No. 4732 Date 8-6-2022 Rs. 20/-

Sold To Y. 200 680123 50 500 28 20/8/22

For whom 866

82AA 263876
N. NAVEED FARVESH

Licensed Stamp Vendor, L.No. 1306-007 of 2011
RLN-1306-007 of 2020, S.R.O. Banaganapalli Premise
Banaganapalli-518 124, Cell 9449458460

No Objection Affidavit

I, Gali Maddilety Reddy, S/o. G.Rama Subba Reddy, Aged about 57 Years, Proprietor of GMR stone crushers residing at H.No.2/41, Nawab Fort, Near Sub Post Office, Banaganapalle, Nandyal District, - Pin Code: 518124, do here by solemnly affirm and states as under.

Government of India, MoEF&CC, IRO., Vijayawada, F.no.4-APB082/2018-CHN/7, Dt.22.12.2020 have accorded forest clearance for diversion of 2.597 Ha. (Mining Area - 2.01 ha, Safety Zone - 0.47 ha, Road Area - 0.11 ha) forest land in compt.No.313 of Gulamaliabad South RF, Dhone Range, Kurnool Division for grant of quarry lease for Road metal in favour of M/s. G.M.R.Stone Crushers.

Sri Y BalaThimma Reddy, (Mg. Partner), M/s. Sainath Stone Crushers has applied for forest clearance for diversion of forest land over an extent of 2.90 ha in Compartment no.313, Gulamaliabad South Reserve Forest, Dhone Range, Kurnool Division & District and he desires to utilize the road which was sanctioned by Government of India.

In this regard, I have no objection to utilize my road by Sri Y BalaThimma Reddy, M/s. Sainath Stone Crushers for transportation of road metal which was sanctioned by Government of India, MoEF&CC, IRO., Vijayawada, F.no.4-APB082/2018-CHN/7, Dt.22.12.2020 have accorded forest clearance for diversion of 2.597 Ha. (Mining Area - 2.01 ha, Safety Zone - 0.47 ha, Road Area - 0.11 ha) forest land in compt.No.313 of Gulamaliabad South RF, Dhone Range, Kurnool Division for grant of quarry lease for Road metal in favour of M/s. G.M.R.Stone Crushers.

Proprietor
GMR stone crushers

G. Maddilety Reddy
Deponent 8-6-22

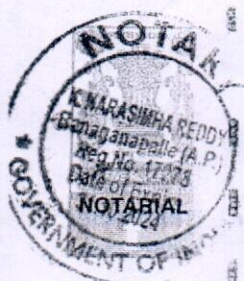

TESTED
K. NARASIMHA REDDY

K. NARASIMHA REDDY, B.A., B.Ed., Solemnly affirmed and executed before me on this
ADVOCATE & NOTARY 8-6-2022.

Appointed by Govt. of India
Obula Reddy Complex, Banaganapalle, Nandyal District, Pin Code 518124

District *Kurnool*

Village No. 32
గ్రామము నెం.

Name *Bhanumukkalu*
పేరు

Taluk *Banagampalli*
తాలూకా

Field No. 2933
ఫీల్డ్ నెంబరు

Area 7.41
విస్తీర్ణము

Hectares 3.00
హెక్టార్లు

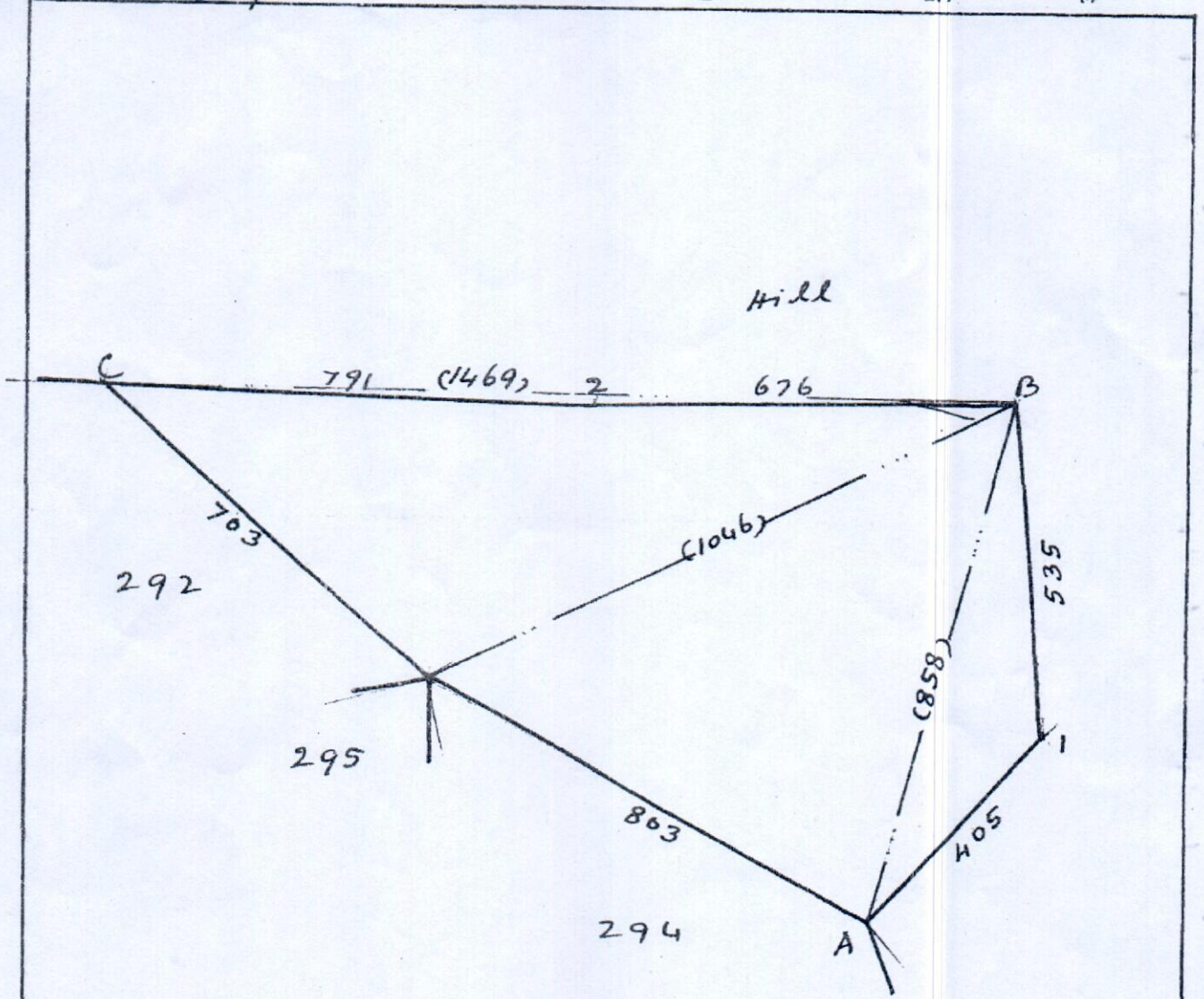

	B		
	1469		
	791	20	2
	C		
	B		
	858		
	356	193	1
	A		

Plotted by *K. Hussain*
26.10.83

Ally, Hussain
Brick's
son

Scale One Centimeter = () Chain of 20 Meters
పేజీలు : ఒక సెం. మీటరు = () 20 మీటర్లకు సమానం.

6/14/11

**GOVERNMENT OF ANDHRA PRADESH
DEPARTMENT OF MINES AND GEOLOGY**

BY RPAD

From
V. Nagini, M.Sc., B.Ed.,
Deputy Director of Mines & Geology (FAC),
KURNOOL.
Mail: deputydirectorkurnool@gmail.com

To
The District Forest Officer,
Kurnool (T) Division,
Kurnool.

Letter No: 2128/MP/2021, Dated:16-05-2022

Sir,

Sub:- Mines & Minerals – Proposal for diversion of forest land over an extent of 2.90 Ha. (Mining Area-2.27 Ha, Safety Zone-0.61 Ha. & Road area-0.02 Ha.) in Compartment No.313, Gulamalaiabad South Reserve Forests, Dhone Range, Kurnool Division & District in favour of M/s Sainath Stone Crushers, Mg. Partner: Sri Y.Bala Thimma Reddy for grant of quarry lease for road metal – Mining Plan approved – Additional information called for – Information submitted – Regarding..

- Ref:**
1. Application No.MIN011700056142, dt:13.05.2021 filed by M/s Sainath Stone Crusher, Mg.Partner: : Sri Y.Bala Thimma Reddy for Road Metal Quarry Lease.
 2. Circular Memo .No.3861432/P/2020, Dated:16.07.2021 of the Director of Mines and Geology, Ibrahimpatnam.
 3. Letter No.Ref.no.EFS02 – 15029 / 59 / 2018 – FCA SEC – PCCF / FCA-1, Dated:01.08.2021 of the Prl. Chief Conservator of Forests & Head of Forest Force, Andhra Pradesh, Guntur.
 4. PCCF& HoFF, AP, Guntur Ref.no.Efs02-15029/22/2020-FCA SEC-PCCF/FCA-1, dt.09.08.2021.
 5. Draft Mining Plan submitted by M/s Sainath Stone Crushers, Mg.Partner: Sri Y.Bala Thimma Reddy on 23.09.2021.
 6. This office Letter No.2128/MP/2021, Dated:14.12.2021 for approval of MINING plan.
 7. Letter No.Rc.no.3494/QL/2017, dated:14.12.2021 of the District Forest Officer, Kurnool (T) Division, Kurnool received in this office on 15.12.2021.
 8. This office Letter No.2128/MP/2021, Date:10.01.2022.
 9. Letter No.Rc.no.4424/2018/H5, dated:18.04.2022 of the District Forest Officer, Kurnool (T) Division, Kurnool.
 10. Lr No.1394/QL/2017, dated:27.04.2022 of the Assistant Director of Mines and Geology, Banaganapalle received in this office on 09.05.2022.

I invite kind attention to the subject and reference cited. Through the reference 9th cited, the District Forest Officer, Kurnool (T) Division, Kurnool has informed that the PCCF & HoFF, AP, Guntur vide letter No.EFS02-15029/59/2018-FCA SEC-PCCF/FCA-1(i), dated:06.03.2022 has informed that as per para no.7.8(i) of guidelines GoI, MoEF&CC (FC Division), New Delhi in F.No.5-2/2017-FC, dt:28.03.2019, wherever a proposal for fresh mining is submitted, following information is required to the GoI for processing the proposal for forest clearance under the Forest (Conservation) Act, 1980.

- 1) A brief note of the lessee/company with details of their existing mining leases in the state with their capacity of production and location of these pits and status of reclamation of forest land that are exhausted in minerals.
- 2) The State Government should also submit details of all other mining leases for particular mineral with their capacity and average annual production and projected future requirement should be submitted for processing the proposal for forest clearance under the Forest (Conservation) Act, 1980.

(Contd...2)

Further stated that, the information submitted by the Deputy Director of Mines and Geology, Kurnool to the District Forest Officer, Kurnool (T) Division, Kurnool vide reference 8th cited is not provided information of capacity of production and present level of average annual production of the existing mining leases of Sri Y.Balathimma Reddy, Banaganapalle which is required to process fresh proposals as per the provisions laid down in 7.8(i) of guidelines of GoI, MoEF & CC(FC Division), New Delhi in F.No.5-2/2017-FC, dt.28.03.2019.

Finally, the District Forest Officer, Kurnool (T) Division, Kurnool requested the Deputy Director of Mines and Geology, Kurnool to furnish the information on above two points as desired by the Principal Chief Conservator of Forests & HoFF, AP, Guntur at an early date for further processing of the proposal under the Forest (Conservation) Act, 1980 and the same copy marked to the Assistant Director of Mines and Geology, Banaganapalle.

In this connection, it is submitted that, vide letter No.1394/QL/2017, Dt.27.04.2022, the Assistant Director of Mines and Geology, Banaganapalle has submitted report to this office stating that M/s Sainath Stone Crushers, Mg.Ptr: Sri Y.Bala Thimma Reddy having one existing quarry lease in Compartment No.313 of Gulamalaibad South R.F. Kurnool Division, over an extent of 2.900 Hectares for Road Metal. The additional information of the lease is as follows.

S.No	Name of the lease	Location of the Quarry lease	Capacity of Production (In Cbm)	Present level average annual Production of existing lease (In Cbm)
01	M/s Sainath Stone Crushers, Mg.Ptr: Sri Y.Bala Thimma Reddy	Compartment No.313 of Gulamalaibad South R.F. Kurnool Division, over an extent of 2.900 Hectares.	1.25 Lakhs per Annam	45,000 Cbm

Further it is submitted that, the lessee reclamation the exhausted mineral pits to an extent of 1.000 Hectares in S-E of the existing leased area.

Reserves of Road Metal of other mining leases existing in Compartment No.313 of Gulamaliabad South R.F, Kurnool Division as follows.

Name of the Mineral	No.of existing leases	Total Capacity of each mine	Avarage Annual Production (in Cbm)	Future requirement of this mineral (in Cbm)	Present Requirement (Out of Co.No.5)	Remarks (If any)
1	2	3	4	5	6	7
Road Metal	05	5.8 Lakhs in Cbm	5.2 Lakhs in Cbm	Nearly 10 Lakhs in Cbm	6.8 Lakhs in Cbm	

(Contd...3)

Further, the Assistant Director of Mines and Geology, Banaganapalle has submitted that there are huge Government works, Civil Works, GNSS Canal strengthening works, NH-544 D Bangalore - Amaravathi road works are in progress and finally requested to process and accord clearance for diversion of forest land for non-forest purpose for grant of quarry lease for road metal over an extent of 2.900 Hectares in Comp.No.313 OF Gulamalaiabad South Block R.F., Banaganapalle section of Dhone Range, Kurnool Division of Kurnool District for a period of 20 years in favour of M/s Sainath Stone Crushers, Mg.Partner::Sri Y.Bala Thimma Reddy.

In view of the above, I request the District Forest Officer, Kurnool (T) Division, Kurnool to consider the above information furnished by the Assistant Director of Mines and Geology, Banaganapalle to process and accord clearance for diversion of forest land for non-forest purpose for grant of quarry lease for road metal over an extent of 2.900 Hectares in Comp.No.313 of Gulamalaiabad South Block R.F., Banaganapalle section of Dhone Range, Kurnool Division of Kurnool District for a period of 20 years in favour of M/s Sainath Stone Crushers, Mg.Partner::Sri Y.Bala Thimma Reddy.

This is submitted for favour of kind information and necessary action

Encl: Reference-7,8 , 9 & 10.

Yours faithfully,

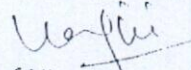
Deputy Director of Mines and Geology (FAC),
Kurnool.

Copy submitted to the Director of Mines and Geology, Ibrahimpatnam for favour of information.
Copy to the Asst. Director of Mines and Geology, Banaganapalle for information.

1

**GOVERNMENT OF ANDHRA PRADESH
DEPARTMENT OF MINES AND GEOLOGY**

From

Sri I.V. Subba Reddy, M.Sc.,
Asst. Director of Mines & Geology,
Banaganapalle.

To

The Deputy Director of
Mines & Geology,
Kurnool.

Lr.No.1394/QL/2017, Dt:27-04-2022.

Sir,

Sub:- Mines & Quarries - O/o Asst. Director of Mines & Geology, Banaganapalle - Quarry lease for **Road Metal** over an extent of **2.900 Hectares** in **Compartment No.313, Gulamalaibad South Reserve Forest, Dhone Range, Kurnool Division, Kurnool District** - in favour of **M/s Sainath Stone Crushers, Mg.Prt: Sri Y. Bala Thimma Reddy** for grant of quarry lease for Road Metal - Submission additional information - Reg.

- Ref:-** 1.Application filed by **M/s Sainath Stone Crushers, Mg.Part: Sri Y. Bala Thimma Reddy** on 13.05.2017.
2. This office proposals Lr.No.1394/QL/2017, dt:18.09.2017.
3. Memo No.21982/R4-2/2017, dt:08.01.2017 from the Director of Mines & Geology, Ibrahimapatnam.
4. Rc.No.4424/2018/H5, dt:14.12.2021 from the District Forest Officer, Kurnool.
5. This office Lr.No.1394/QL/2017, dt:14-12-2021 addressed to the Deputy Director of Mines & Geology, Kurnool.
6. Rc.No.4424/2018/H5, dt:18.04.2022 from the District Forest Officer, Kurnool (T) Division, Kurnool.

I invite kind attention to the subject and references cited and submit that through the ref.1st cited, Quarry lease application filed **M/s Sainath Stone Crushers, Mg.Prt:Sri Y. Bala Thimma Reddy** for grant of Quarry lease for Road Metal and Building Stone over an extent of 2.900 Hectares in Comp.No.313 of Gulamaliabad South Block R.F., Banaganapalle section of Dhone Range Kurnool Divisional of Kurnool District.

In this connection, through the ref.3rd cited, the Director of Mines & Geology, Ibrahimapatnam directed to resubmit the proposals keeping in view of the guidelines forwarded by Principal Chief Conservator Forest, Guntur vide Lr.No.45921/2001-FAC, dt:07.12.2017 and also enclosed Proforma-M consisting of 6 points and examine the points and submit the same for taking further necessary action in the matter.

Through the ref.4th cited, the District Forest Officer, Kurnool requested the DDM&G, Kurnool and copy marked to the ADM&G, Banaganapalle to furnish the additional information of other mining leases for particular mineral with their capacity and average annual production and projected future requirements of the state of Andhra Pradesh in respect of the subject proposals for further processing of the proposals.

Through the ref.5th cited, the additional information submitted to the Deputy Director of Mines & Geology, Kurnool. However through the ref.6th cited, the District Forest Officer, Kurnool has again requested the Deputy Director of Mines & Geology, Kurnool and copy marked to the ADM&G, Banaganapalle to submit the additional information as desired by the Principal Chief Conservator of Forests and HoFF, A.P. Guntur.

:: 2 ::

In this connection, it is submit that **M/s Sainath Stone Crushers, Mg.Prt:Sri Y. Bala Thimma Reddy** having one existing quarry lease in Compartment No. 313 of Gulamaliabad South R.F. Kurnool Division, over an extent of 2.900 Hectares for Road Metal. The additional information of the lease is as follows.

Sl. No.	Name of the lessee	Location of the Quarry lease	Capacity of Production (in Cbm)	Present level average annual Production of existing lease (in Cbm)
1	M/s Sainath Stone Crushers, Mg.Prt:Sri Y. Bala Thimma Reddy	Compartment No. 313 of Gulamaliabad South R.F. Kurnool Division, over an extent of 2.900 Hectares	1.25 Lakhs per Annam	45,000 Cbm

Further it is submit that, the lessee reclamation the exhausted mineral pits to an extent of 1.000 Hectare in the S-E of the exiting leased area.

In this connection, it is submit that generally the road metal occurs in the Government and Patta lands. Here in this office jurisdiction the road metal huge extent available in the forest land only. The same mineral is not abundantly available in the non-forest areas, so there is huge demand for civil constructions road works, canal works etc., and there is future need to overcome the shortage of road metal.

Geological Reserves in the applied area:

Name of the Mineral	No.of existing leases	Total Capacity of each mine	Average Annual Production (in Cbm)	future requirement of this mineral (in Cbm)	Present requirement (out of Col.No.5)	Remarks (if any)
1	2	3	4	5	6	7
Road Metal	5	5.8 Lakhs in Cbm	5.2 Lakhs in Cbm	Nearly 10 Lakhs in Cbm	6.8 Lakhs in Cbm	

Further it is submit that there is huge Government works, Civil work, GNSS Canal strengthening works, NH-544 D Bangalore-Amaravathi road work is in progress.

In view of the above circumstances, the above additional information with a request to process and accord clearance for diversion of forest land for non-forest purpose for grant of quarry lease for road metal over an extent of **2.900 Hectares** Comp.No.313 of Gulamaliabad South Block R.F., Banaganapalle section of Dhone Range Kurnool Divisional of Kurnool District for a period of 20 years in favour **M/s Sainath Stone Crushers, Mg.Prt: Sri Y. Bala Thimma Reddy**.

This is submitted for favour of information and to take further necessary action in the matter.

Yours faithfully,

J.V. Subbarao
Asst. Director of Mines & Geology(FAC),
Banaganapalle.

Copy submitted to the District Forest Officer, (T) Division, Kurnool for favour of information.

Copy to **M/s Sainath Stone Crushers, Mg.Prt:Sri Y. Bala Thimma Reddy**, H.No.2/23-4-18, Near G.M. Talkies, Karim Bag Colony, Banaganapalle (V) & (M), Kurnool District for information.

Map showing the Location Sketch of Sanctioned Quarry Lease & Road, Already Dugged Pit area and Reclamation Area in Compt.No.313, G.A.Bad South Block of Dhone Range, Kurnool Division in favour of Sri Y.Bala Thimma Reddy, R/o Banaganapalli

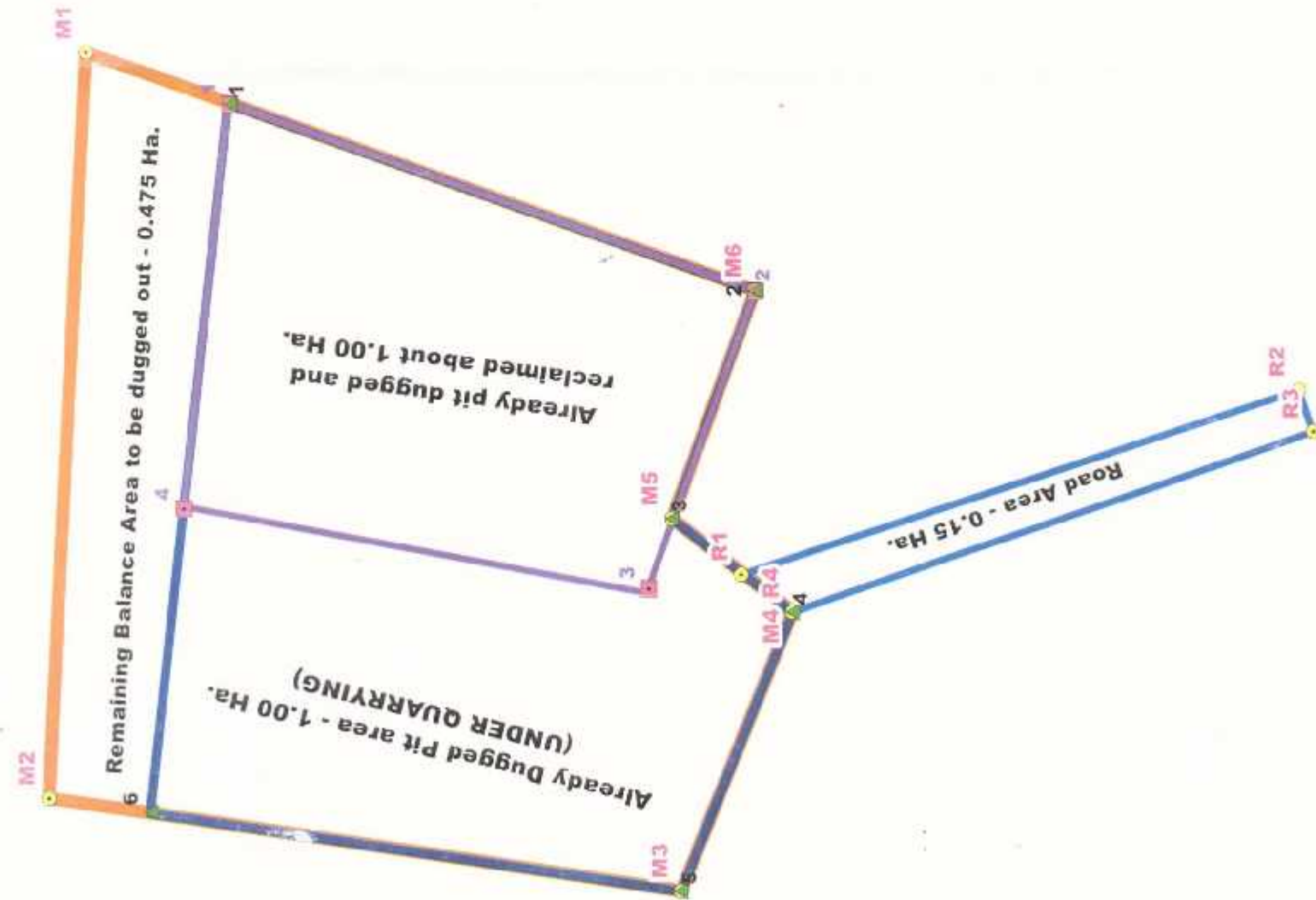

TOTAL QUARRY LEASE AREA - 2.625 Ha.

Already Dugged Pit area Geo-coordinates

S.NO	LATITUDE	LONGITUDE
1	15.31338	78.18770
2	15.31225	78.18730
3	15.31243	78.18681
4	15.31217	78.18661
5	15.31241	78.18601
6	15.31355	78.18618

Reclamation area Geo-coordinates

S.NO	LATITUDE	LONGITUDE
1	15.31338	78.18770
2	15.31225	78.18730
3	15.31248	78.18666
4	15.31348	78.18683

Quarry Lease & Road Geo-coordinates

S.NO	LATITUDE	LONGITUDE
M1	15.31369	78.18781
M2	15.31377	78.18621
M3	15.31241	78.18601
M4	15.31217	78.18661
M5	15.31243	78.18681
M6	15.31225	78.18730
R1	15.31228	78.18669
R2	15.31108	78.18709
R3	15.31105	78.18700
R4	15.31217	78.18661

Y-Bala Thimma Reddy

Legend

- Pit already dugged area
- Reclamation area
- Quarry Lease & Road Geo-coordinates
- Reclamation Area
- Already dugged Pit Area
- Road
- Total Quarry Lease area

భూమి యజమాన్యపు హక్కు పత్రం మరియు
పట్టాదారు పాసుపుస్తకము



ఆంధ్రప్రదేశ్ ప్రభుత్వము
రెవెన్యూ శాఖ

రెవెన్యూ శాఖ రెజిస్ట్రార్ కుమారిల కైమం-ప్రభుత్వ ధ్వేయం

ఆంధ్ర ప్రదేశ్ ప్రభుత్వము
రెవెన్యూ శాఖ
భూమి యజమాన్యపు హక్కు పత్రం మరియు
పట్టాదారు పాసుపుస్తకము
(ఆంధ్రప్రదేశ్ XIV (సీ) రూల్ (47) ఆఫ్ రూల్ (జి) ప్రకారము)



13R44F032000471



- జిల్లా: కర్నూలు
డివిజన్: నంద్యాల
మండలం: బురగానపల్లి
గ్రామం: బానిమిక్కుల
ఖాతా నెంబరు: 682
1. హక్కుదారు పేరు : విడుమకంటి బాల రెడ్డి
 2. తండ్రి / భర్త పేరు : కొండారెడ్డి
 3. స్త్రీ లేదా పురుషుడు: M
 4. చిరునామా : 1-100-A, KAPULAPALLE, Kurnool, Banaganapalle, KAPULAPALLE, 518186
 5. కులము: OC
 6. ఆధార్ నెంబర్: 792212792650
 7. మొబైల్ నెంబర్ : 9440821279
 8. ఎన్జిడార్ నెంబర్: 9440821279



భూమి యజమాన్యపు హక్కు పత్రం మరియు
పట్టాదారు పాసుపుస్తకము

ఆంధ్రప్రదేశ్ ప్రభుత్వము

హోమి యజమాన్యపు హక్కు పత్రం మరియు పట్టాదారు పోసువుస్థకము

జిల్లా: కర్నూలు

డివిజన్: నంద్యాల

ముండలం: బనగానపల్లె

గ్రామం: బానుముక్కల

వరుస సంఖ్య	సర్వే నెంబరు/ సబ్ డివిజను నెంబరు	విస్తీర్ణం ఎ.సెం/ ఎ.గుం	వర్గీకరణ మూగాణి / మెట్ట/ అరుతడి/	ఏ విధంగా సుక్రమించింది 1. అనుపంశికము లేదా 2. కొనుగోలు లేదా 3. ఏదైనా ఇతర లావాదేవీ ద్వారా	ఉత్తర్వుల ప్రకారం
(1)	(2)	(3)	(4)	(5)	(6)
1	291	*1.7500	మెట్ట	స్వంతం	
2	293	*1.8550	మెట్ట	కొనుగోలు	
3	315	*3.3800	మెట్ట	చాదసత్వం	
4	316-2	*0.2500	మెట్ట	స్వంతం	
5	325-2	*0.4525	మెట్ట	కొనుగోలు	

1106 11-06-2021

ఆంధ్రప్రదేశ్ ప్రభుత్వము

హోమి యజమాన్యపు హక్కు పత్రం మరియు పట్టాదారు పోసువుస్థకము

జిల్లా:

డివిజన్:

ముండలం:

గ్రామం:

వరుస సంఖ్య	సర్వే నెంబరు/ సబ్ డివిజను నెంబరు	విస్తీర్ణం ఎ.సెం/ ఎ.గుం	వర్గీకరణ మూగాణి / మెట్ట/ అరుతడి/	ఏ విధంగా సుక్రమించింది 1. అనుపంశికము లేదా 2. కొనుగోలు లేదా 3. ఏదైనా ఇతర లావాదేవీ ద్వారా	ఉత్తర్వుల ప్రకారం
(1)	(2)	(3)	(4)	(5)	(6)