



**OFFICE OF THE DIVISIONAL FOREST OFFICER DODA
FOREST DIVISION DODA**

Telephone- 01996-233538

Email:- dfododa14@gmail.com

**The Conservator of Forests,
Chenab Circle, Doda**

No: - DFO/D 341-42

Dated:- 04-05-2021

Sub:- Proposal for diversion of Forest land for construction of link road from Gai Dessa to Bhatta via Mangalthata and Dewal Kund in Doda Forest Division.

Ref:- Proposal No. FP/JK/Road/45770/2020.

Sir,

With reference to the above cited proposal, this office is in receipt of EDS regarding Compensatory Afforestation and stabilization of muck dumping sites vide Addl. Pr. Chief Conservator of Forests, Nodal Officer's (FCA) letter No. PCCF/FCA/3133/6190-93 dated 30-03-2021. In this regard, kindly find enclosed herewith requisite documents. The detail is as under:

1. Compensatory Afforestation plan as approved by the Pr.CCF (HoFF) circulated vide circular No. PCCF/FCA/1119/6086-6131 dated 27/03/2021. (copy enclosed as Annexure-A)
2. Proposal for biological measure for stabilization of muck dumping Sites. (copy enclosed as Annexure-B)
3. Model plan related to Engineering measures for stabilization of muck dumping site. (copy enclosed as Annexure-C)

Yours faithfully,

Navneet Singh
Navneet Singh, IFS

**Divisional Forest Officer
Forest Division Doda**

Copy submitted to the Addl. Principal Chief Conservator of Forests, Nodal Officer (FCA) for favour of information please. This is in reference to his office letter No. PCCF/FCA/3135/6190-93 dated 30-03-2021.

Full Title of the Project:- Construction of link road Gai Dessa to Bhatta via Magal Thatha and Dewal Kund.

File No.:- FP/JK/ROAD/45770/2020.

Date of Proposal:- 22-06-2020.

Name of the Forest Division:- Doda Forest Division.

Forest area to be diverted:- 2.557Ha

Detail of land where Compensatory Afforestation to be carried out:

Degraded Forest land: Yes **Area:** 5.2 Ha
Non-Forest land: No **Forest Division:** Doda Forest Division
Range: Siraj **District:** Doda
Tehsil: Bhagwah **Compartment No.** 44/Sj
C.A Site: Mangalthata Village **C.A Area:** 5.2 Ha.

C.A Site Geo-Coordinates:

Starting point: Latitude: 33°17.850' N **Longitude:** 75°29.430' E

Ending point: Latitude: 33°17.876' N **Longitude:** 75°29.505' E

I. Description of C.A Site:

- a. **Soil type:** Sandy Loom with boulders
- b. **Topography:** Hilly
- c. **Slope:** Steep.
- d. **In case of degraded forest land-description of forest land and crown density:** Deodar
Kail Conversion working circle with crown density is 20-30%.

Plantation Model: Compensatory Afforestation over an area of 5.2 Hac. of degraded forest land is proposed to be raised. The area selected for this purpose is in village Mangalthata, which is degraded forest. Presently the area supports scattered trees. Whole of the plantation of 5.2 Hac. will be raised in a single compact block inside the degraded forest for such purpose. The area identified for plantation has also been shown on the attached map. Plants @ 1000 plants per hectare will be planted. The species to be planted will be mainly conifer and other misc. species of broad leaved plants. The plantation will be raised in the following year after the approval of FCA proposal and further maintenance and beating up of failures will be done for the subsequent ten years. The scheme will be implemented by Forest Department through DFO, Doda. Total financial Outlay for compensatory plantation scheme is 1029576/- Site is suitable for Compensatory Afforestation. The monitoring will be done as per existing monitoring mechanism in the forest department at present.

Forest Range Officer
Siraj Range
Hq Doda

Executive Engineer
FWD (R&B) Spl. Sub Division
Doda

Named
Divisional Forest Officer
Doda Forest Division Doda

Compensatory Afforestation for degraded forest area

S.No.	Description			Rate (in ₹)	Total amount (in ₹)
		Unit	No.		
A	1st year cost of Afforestation			40.03	208156
1	2nd year maintenance		1300	40.03	52039
2	3rd year maintenance		520	40.03	20815.6
3	4th year maintenance		260	40.03	10407.8
4	5th year maintenance		260	40.03	10407.8
5	6th year maintenance		260	40.03	10407.8
6	7th year maintenance		260	40.03	10407.8
7	8th year maintenance		260	40.03	10407.8
8	9th year maintenance		260	40.03	10407.8
9	10th year maintenance		260	40.03	10407.8
	Total		8840		353865.2
B	Other Afforestation Interventions (As per the requirement of the site condition)				
1	Patch Sowing	No. of patches	1560	6.99	10904.4
2	Planting of grass slips	No. of slips	1560	6.35	9906
	Total				20810.4
C.	Fencing:				
1	Square PCC Post Fencing (4 Strand)	Rft	3120	72.78	227073.6
2	Wooden fencing				
3	Chain link fencing				
4	Fencing repair		3120	16.74	52228.8
	Total				279302.4
D	Site Preparation: (Cutting, Grubbing and removal of lantana)			22904	35730.24
		Ha	1.56		
E	Pruning and Training of existing root stocks:			6.35	9906
		No.	1560		
	Total C.A Charges				699614.24
F	Soil and water conservation and protection measures like constructon of fire lines and inspection path.				260000
	Total (A+B+C+D+E+F)				959614.24
G	Supervisory/Watch and ward/Overhead/Miscellaneous charges: (10% of the C.A Charges)				69961.424
	Grand Total: (A+B+C+D+E+F+G)				1029575.664

III **Technical Details:** Technical detail of compensatory afforestation scheme are as follow:

i **General detail**

ii **Plantation method:** Poly bags

iii **Spacing:** 2 x 2 m

iv **Species proposed to be planted:** Deodar and Kail

v **Silviculture Operations:** Nil

vi **Soil and Moisture Conservation Works:**

vii **Protection:** (Fencing, Watch and Ward, People's Participation etc): Yes

viii **Proposed monitoring Mechanisim:** Regular patrolling of concerned beat guard

ix **Any other information:** No

Naveet
Divisional Forest Officer
Doda Forest Division Doda

[Signature]
Forest Range Officer
Siraj Range
Hq Doda

[Signature]
Executive Engineer
PWD (R&B) Spl. Sub Division
Doda

itude: 33°17'41"
ngitude: 75°29'21"
vation: 2108.14 m
curacy: 2.5 m
STime: 04-24-2021 14:56:39
te: co 44 block dessa mgithata pul'upr

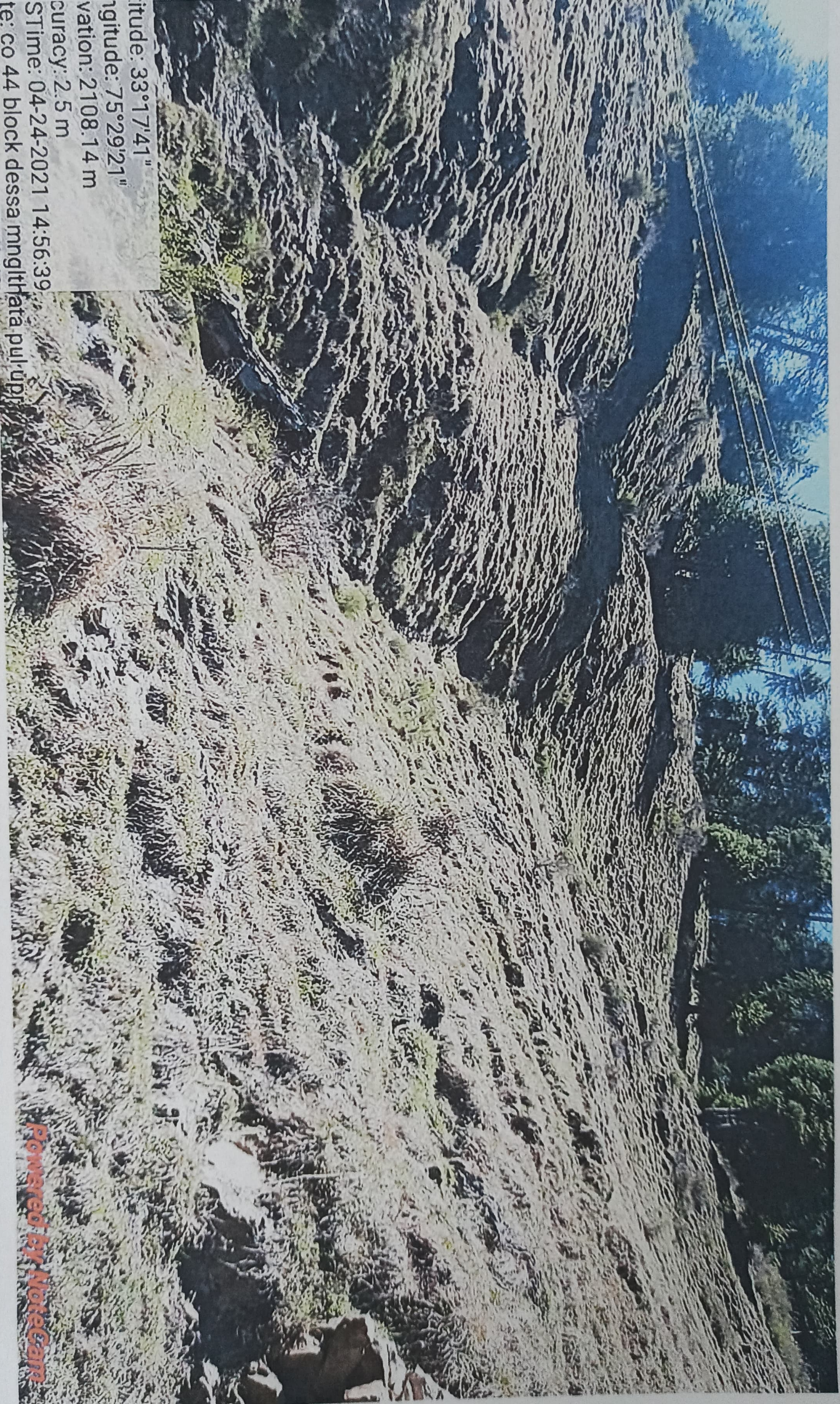

Powered by NoteCam



Latitude: 33°17'39"

Longitude: 75°29'18"

Elevation: 2111.23 m

Accuracy: 5.5 m

GPSTime: 04-24-2021 14:59:20

Note: co 44 block dessa mnglthata pul upi.

Biological measures for stablization of muck dumping site for construction of road from Gai Dessa to Bhatta via Mangalthata and Dewal Kund.

S.No.	Item of Work	Unit	Quantity	Rate	Amount
1	Fencing :- Using fence post conforming to product code PCFP-3 at spacing of 10' & 5 strands of Galvaized Barbed wire with 2 Criss cross conforming to the product code GA-BW all fence post be fixed in the cement cocree 1:3:6(1 cement:3 coarse sand:6 stone aggregate 40 mm nominal size) block of size 1'6"x1'x1'.	Rft	65	100	6500
2	Afforestation (1st year)				
i	Plantation:- Poly bagged plantng of fast-growing soil binding local species (Trees/Shrubs) in pits of size (45x45x45)cm in staggered fashion along the counter.	Nos.	75	29.34	2200.5
ii	Agave:- Agave bulbs planted between interspacesof plants, open spaces & along the fence line of size.	Nos.	200	15.45	3090
iii	Grass Slips:- (Soil bindin grasses viz: vetivers, Napier, Saccharum munja & Arundo donax)	Nos.	200	6.35	1270
iv	Cutting:- Ipomea/Vitex/Popular/Salix/Mulberry (area specific)	Nos.	50	6	300
v	Seed ball:- Broad casting/dibbling of the seed balls	Nos.	50	2.35	117.5
	Total				6978
3	Maintenance for 9 years : 2nd year @ 25% + 3rd year @ 10% +4th year to 10th year 7x@5%= 70% of afforestation	year			4884.6
4	Geo-Textile Mat	Sq.M	50	300	15000
	Total (1+2+3+4)				33362.6
5	Overhead 10% of total				3336.26
	Grand Total				36698.86
6	Total financial for five identical muck dumping sites				183494.3

* The location of seven muck dmping sites is enclosed alongwith.

Executive Engineer
PWD (R&B) Doda
Doda

Range Officer
Siraj Range
Hq Doda

Divisional Forest Officer
Forest Division Doda
Doda Forest Division Doda

Detail of muck dumping sites for construction of road from Gai Dessa to Bhatta via Mangalthata and Dewal Kund

S.No.	Muck dumping site	Proposed Length (in metre)	Proposed Width (in metre)	Area proposed to be diverted (in Ha)	Location
1	Dumping site I	25	20	0.05	RD 5/600 to RD 5/625
2	Dumping site II	25	20	0.05	RD 6/400 to RD 6/425
3	Dumping site III	25	20	0.05	RD 6/900 to RD 6/925
4	Dumping site IV	25	20	0.05	RD 8/000 to RD 8/025
5	Dumping site V	25	20	0.05	RD 9/200 to RD 9/225
Total				0.25	

 Executive Engineer
 PWD (R&B) Doda
 Doda

 Range Officer
 Siraj Range
 Hq Doda

 Divisional Forest Officer
 Forest Division Doda
 Doda Forest Division Doda

OFFICE OF THE EXECUTIVE ENGINEER PWD (R&B) SPECIAL SUB DIVISION DODA

The Divisional Forest Officer,
Forest Division,
Doda.

No. 431-34
Dt. 12-04-2021

Subject :- Proposal for diversion of Forest land for construction of link road from Gai Dessa to Bhatta via Mangal Thatha and Dewal Kund.
Ref.:- Your letter No. DFO/D 56-57 dated 02-04-2020.

Sir,

With reference to the subject cited above kindly find enclosed here with Model plan related to Engineering measures for stabilization of Muck Dumping in forest area.

Yours Faithfully



Executive Engineer,
PWD (R&B) Spl. Sub Division,
Doda.

Copy to the:-

- 01/- Superintending Engineer PWD (R&B) Circle Doda for favour of information please.
- 02/- Asstt. Executive Engineer West Sub Division Doda for information
- 03/- LAC for reference.

Model Plan related to Engineering Measures for Stabilization of Muck Dumping Sites in Forest Area (for link road from Gai Dessa to Bhatta via Mangal Thatha and Dewal Kund)

Typical estimate for the construction of Crated Wall to protect dumping sites of surplus Muck /E.

Taking length of Crated wall = 5×25.00 mtr = 125.00 mtr

Trench Excavation in Dense soil
for structure

$$\begin{aligned} &= 1 \times 125.00 \text{ mtr} \times 1.20 \text{ mtr} \times 0.70 \text{ mtr} \\ &= 105.00 \text{ Cum @ Rs } 120.00/\text{Cum} \\ &= \text{Rs } 12600.00 \end{aligned}$$

For two layer Crated Wall ,

Quantity
Amount

$$\begin{aligned} &= 2 \times 125.00 \text{ mtr} \times 1.20 \text{ mtr} \times 1.20 \text{ mtr} = 360.00 \text{ Cum} \\ &= 360.00 \text{ Cum @ Rs. } 2000.00 / \text{Cum (Including cost of} \\ &\quad \text{Crates and labour for handling of available stones)} \\ &= \text{Rs } 720000.00 \end{aligned}$$

Total Amount for 175.00 mtrs Two Layered Crated Wall = Rs.(12600.00+720000.00)

= Rs 732600.00

Rate per Mtr.

$$= \text{Rs } 5860.80 (\text{Say } 5860/\text{Mtr}).$$

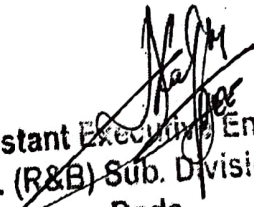
Assistant Executive Engineer
P.W.D. (R&B) Sub. Division (West)
Doda

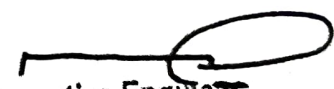
Executive Engineer
PWD (R&B) Spl. Sub Division

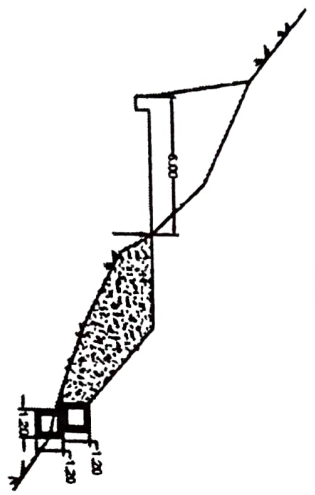
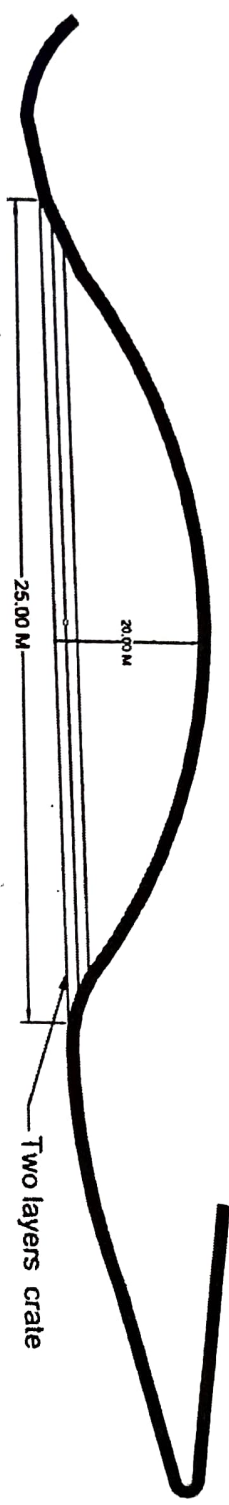

Typical Site plan and X
 Section for Stabilization of
 Muck/Surplus Excavated
 Material in Forest Area
 Scale : Site Plan : 1CM = 6M
 X Section : 1 Cm = 1M

[Handwritten signature]

Assistant Executive Engineer
 P.W.D. (R&B) Sub. Division (East)
 Donda

[Handwritten signature]

Executive Engineer
 PWD (R&B) Spl. Sub Division
 Donda

[Handwritten signature]