

By-Mail

No.F.6-1083/FC/Fo-15/ 30273

Government of Tripura

Office of the Principal Chief Conservator of Forests

Tripura: Agartala

Dated, Agartala, the 29 /10/2018

To
The Nodal Officer, In-Charge,
HR-ER, ONGC, Tripura Asset,
Badhargat Complex,
Tripura-799001

Sub:- Proposal for diversion of 1.28 ha of forest land for construction of drill site, waste pit at location TIDG under DFO, Sepahijala

Ref:- Your letter No.F.AGT/GA/LA/296/TIDG(ITI#7)/2006/124 dated 14.09.18

Sir,

With reference the above I am directed to enclose herewith a report regarding soft copy of shape file submitted by you against proposal for diversion of 1.28 ha of forest land for construction of drill site, waste pit at location TIDG under DFO, Sepahijala. Since the area proposed for diversion was 1.28 ha whereas the area found in GIS Domain is 1.530584 ha. The softcopy of shape file is also returned herewith for resubmission after rectification

Enclo:- As stated

Yours faithfully,

[C.K Das, IFS]

Dy. Conservator of Forests

gc

Report regarding shape file submitted by User Agency namely ONGC Ltd for diversion of forest land for drill site TIDG under TWLS, Referring letter No.AGT/GA/LA/298/TIDG(ITI#7)/2006/124, Dated : 14/09/2018

The CD Contains:

- TIDG Geo_Referenced Map.JPG
- TIDG KML FILES.PDF
- TIDG.KML
- TIDG_Drillsite.shp
- TIDG_Report.PDF

OBSERVATION:

The area of shapefile (Drill site - TIDG) submitted by User Agency calculated in GIS Domain "1.530584 hectare" with the projected coordinate system "WGS_1984_Web_Mercator_Auxiliary_Sphere".

// User Agency is requested to submit shapefile in projected coordinate system "WGS_1984_UTM_Zone_46N" henceforth.

*** Map enclosed with report.

**** The Findings are given according to the CS Map Sheet provided by the DLRS and Geo-referred by the TSAC.

Pranajit Paul.
6/10/18

6/10/18

MAP SHOWING DRILL SITE TIDG AT MOUJA JAGATRAMPUR

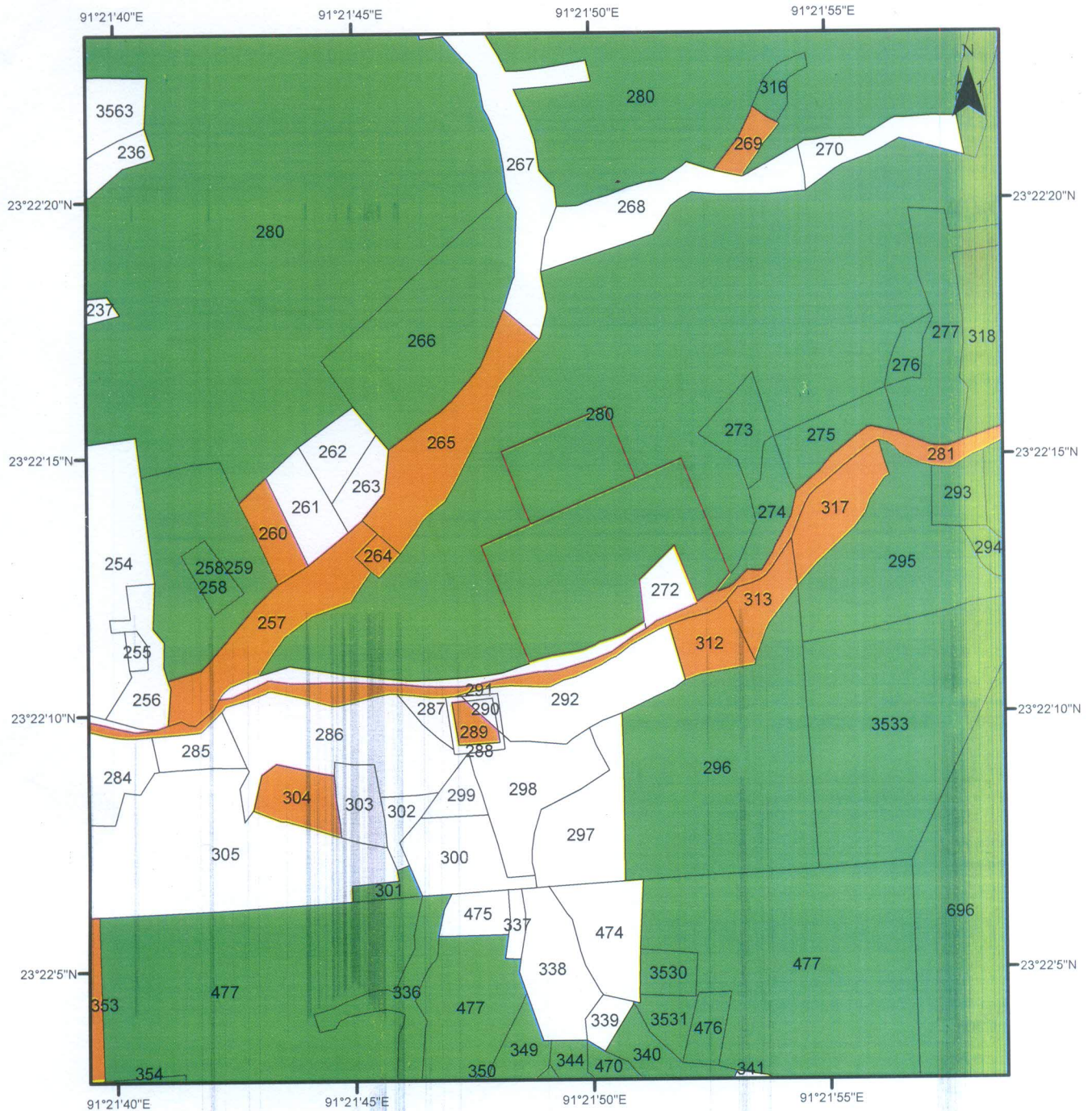

**** The Findings are given according to the CS Map Sheet provided by the DLRS and Geo-referred by the TSAC.

AREA CALCULATED IN GIS DOMAIN : 1.530584 HA

Coordinate System: WGS 1984 Web Mercator Auxiliary Sphere

Projection: Mercator Auxiliary Sphere

Datum: WGS 1984

False Easting: 0.0000

False Northing: 0.0000

Central Meridian: 0.0000

Standard Parallel 1: 0.0000

Auxiliary Sphere Type: 0.0000

Units: Meter

PREAPRED BY-

GISLAB

TRIPURA FOREST DEPARTMENT.

Date: 28-09-2018

Prasenjit Paul
28/09/18

0 0.0375 0.075 0.15 0.225 0.3 Kilometers

Legend

- TIDG_Drillsite
- LAND STATUS**
- NON FOREST
- R.F.
- PRF
- UGF