

No. 274
H.P. Forest Department.

Dated Luhri, the/ 19-4-25

From: - DFO, Anni

To: -CCF (T) Rampur

Subject:-

Diversion of 1.668 hac. of Forest land in favour of HPPWD for the C/o road from Shamshar to Chalohan Km. 0/00 to 3/420 within the jurisdiction of Ani Forest Division. Distt. Kullu H.P.

Sir,

Kindly refer to MoEF letter No. FP/HP/Road/151416/2022 dated

14.10.2024 on the subject above.

The point wise reply of the observation as raised by the MoEF on the said proposal is as under

Sr.No.	Observation	Reply
1	State Govt. has not submitted the revenue records (Jamabandi etc.) pertaining to the proposed CA land as per Para 13(3)©, of the consolidated guidelines and clarification issued under Van (Sanrakshan evam Samvardhan) Adhiniyam, 1980 and Van (Sanrakshan evam Samvardhan) Rules, 2023, if the proposed CA land is Govt. Wasteland falling under the category of protected forest and is neither demarcated on the ground nor transferred and muted in the name of Forests Department in revenue record has to be declared as PF under IFA1927. The state Govt. is requested to uploaded the clarifications in this regard for the CA land submitted in the instant proposal.	In this context it is intimated that the mutation of the proposed CA land in lieu of diversion of forest land for construction of road from Shamshar to Chalohan has been carried out by the Revenue Department and the revenue record of the same i.e Jamabandi etc. of the proposed CA land is attached for ready reference please.

This is for favour of information and further

necessary action please.

Encl:- As above

Divisional Forest Officer
Ani Forest Division at Luhri
19/04/25

95

342
==

[illegible]

7th July

नमूना	रजदरा	इ-एल कार्बन रजदरा	रजदरा मात्र
एल/एल/की	रजदरा		रजदरा
रजदरा बी.गु.रा रजदरा रजदरा	रजदरा रजदरा 1	$160 \times 95 = 15200$ रजदरा-रजदरा रजदरा	रजदरा-रजदरा रजदरा

25451070

Proposed Area for CA-33364.

बाला दंडुरा (नागनी धार)

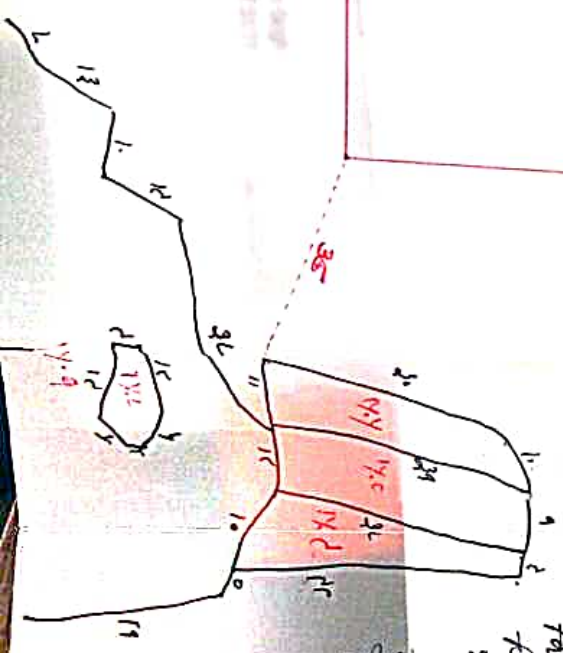

श्रीमान जी
'रघीर' की-जाती है कि वह सीधे सम्मेलन
के छाटा पर संख्या 382/KLR दिनांक 02/09/2023
की अनुसंधान के पोर्टल से प्राप्त है 382/का.वि. सं. 1
38-00-00 सी.डी. वन बूटि 2 नमू. एवं 1 कलबेरा
विषा विषादी संज्ञा संख्या 1000-10000 नमू.
विषादी पाती संख्या 1000, 1000, 1000, 1000, 1000
संख्या 1000 नमू. नमू. है।
कॉप: रिपोर्ट भिन्न-विधियों के नमू. वन-
मंडल की संख्या से नमू. 1000 नमू. है।
उपरोक्त है।

Daniel
1.C कठिना

