

- NOTES:**
- STORM WATER OF OUR BUILDING WILL NOT DISTURB THE ROAD.
  - 1.00 M. WIDE SLAB CULVERT WILL BE PROVIDED BY US.
  - LEVEL OF BUILDING WILL BE KEPT 2% BELOW THE ROAD
  - WE SHALL NOT DEMAND ANY GAP IN VERGE IN FRONT OF BUILDING
  - THE MORTH INSTRUCTIONS SHALL NOT BE VIOLATED.
  - CERTIFIED THAT ALL MORTH CONDITIONS HAVE BEEN SPECIFIED.
  - CERTIFIED THAT WE WILL APPLY THE CASE FOR RENEWAL AS PER NORMS
  - WE WILL PAY THE NECESSARY RENT FOR THE USE OF ROAD LAND

- NOTES:**
- ORAL MARKINGS SHALL BE DONE AS PER DIRECTIONS OF PWD/MORTH AUTHORITY AS PER IRC-67.
  - ALL DIMENSION ARE IN METER/ MM UNLESS SPECIFIED.

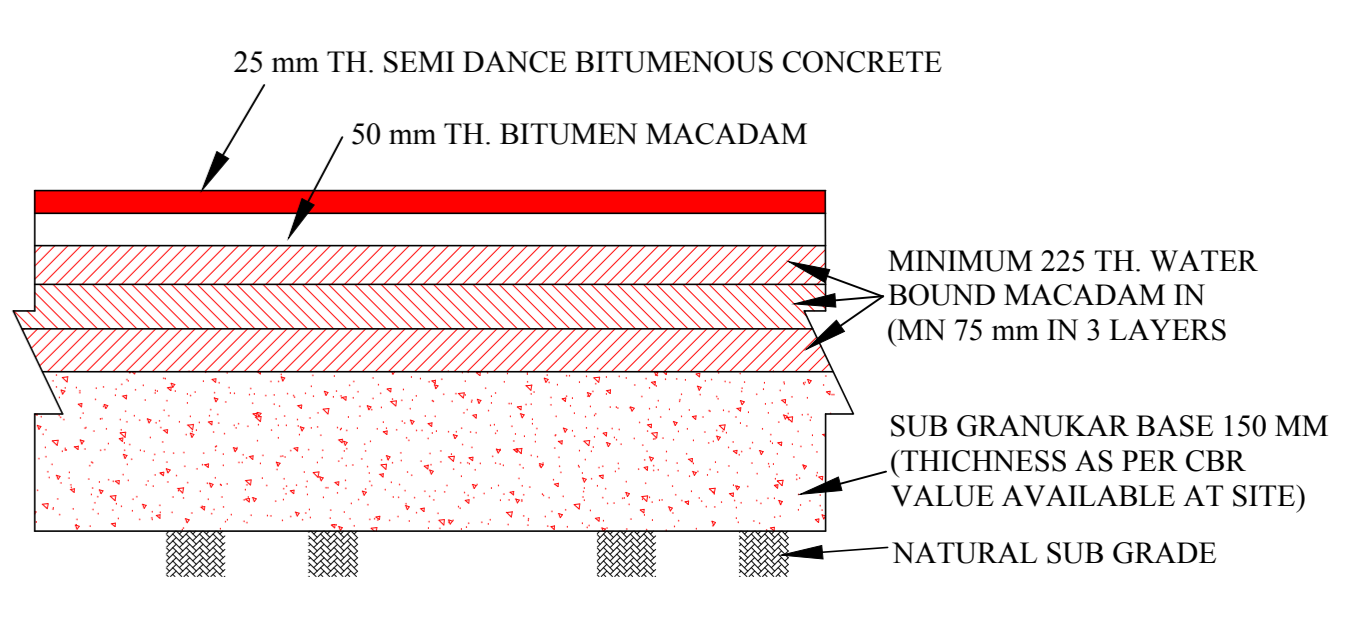
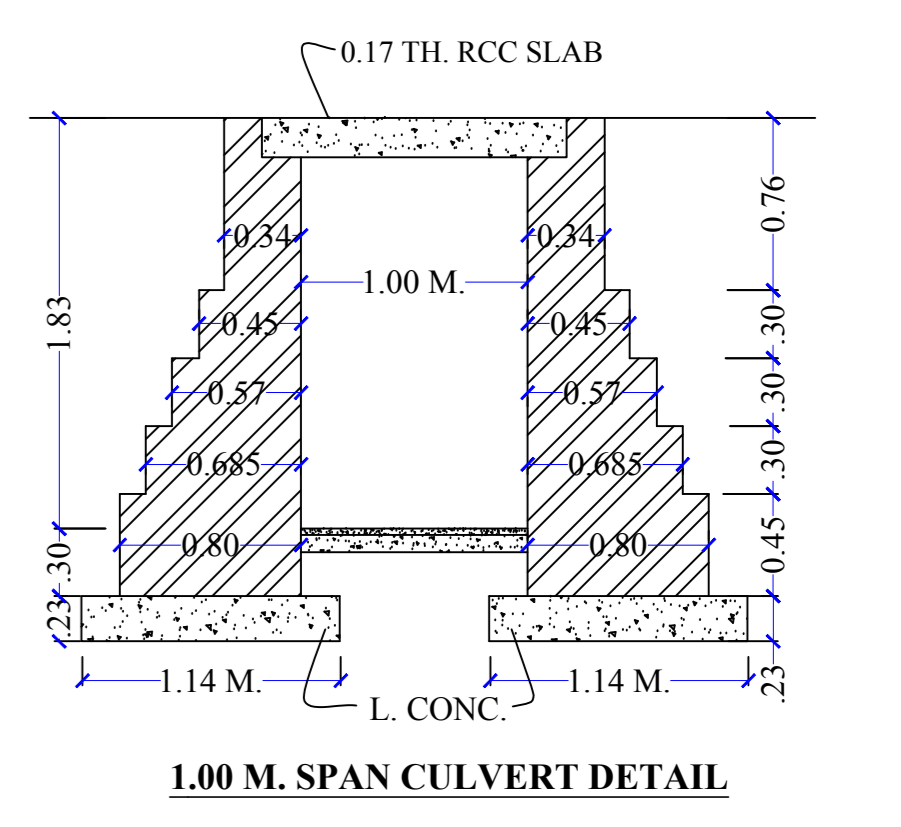
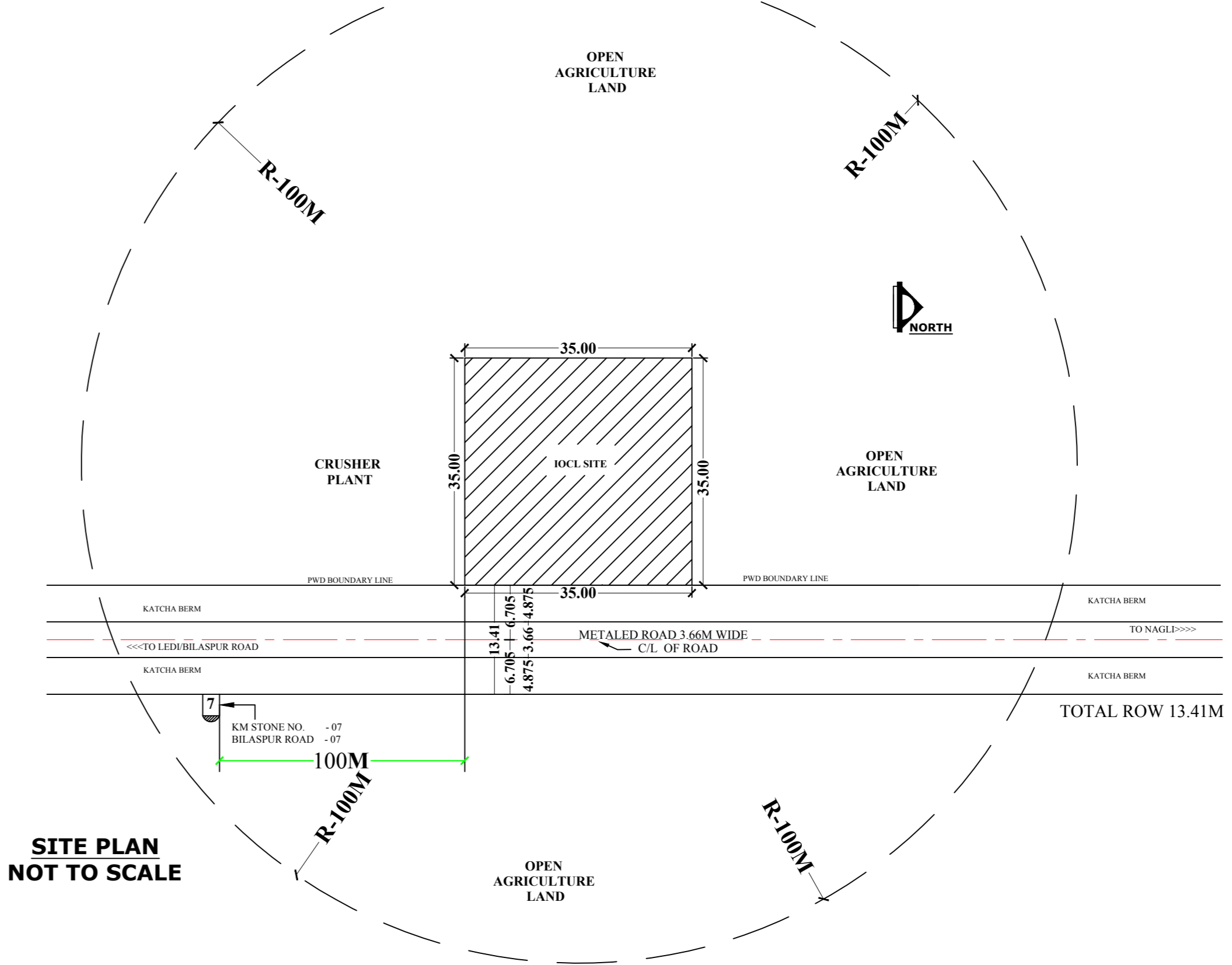
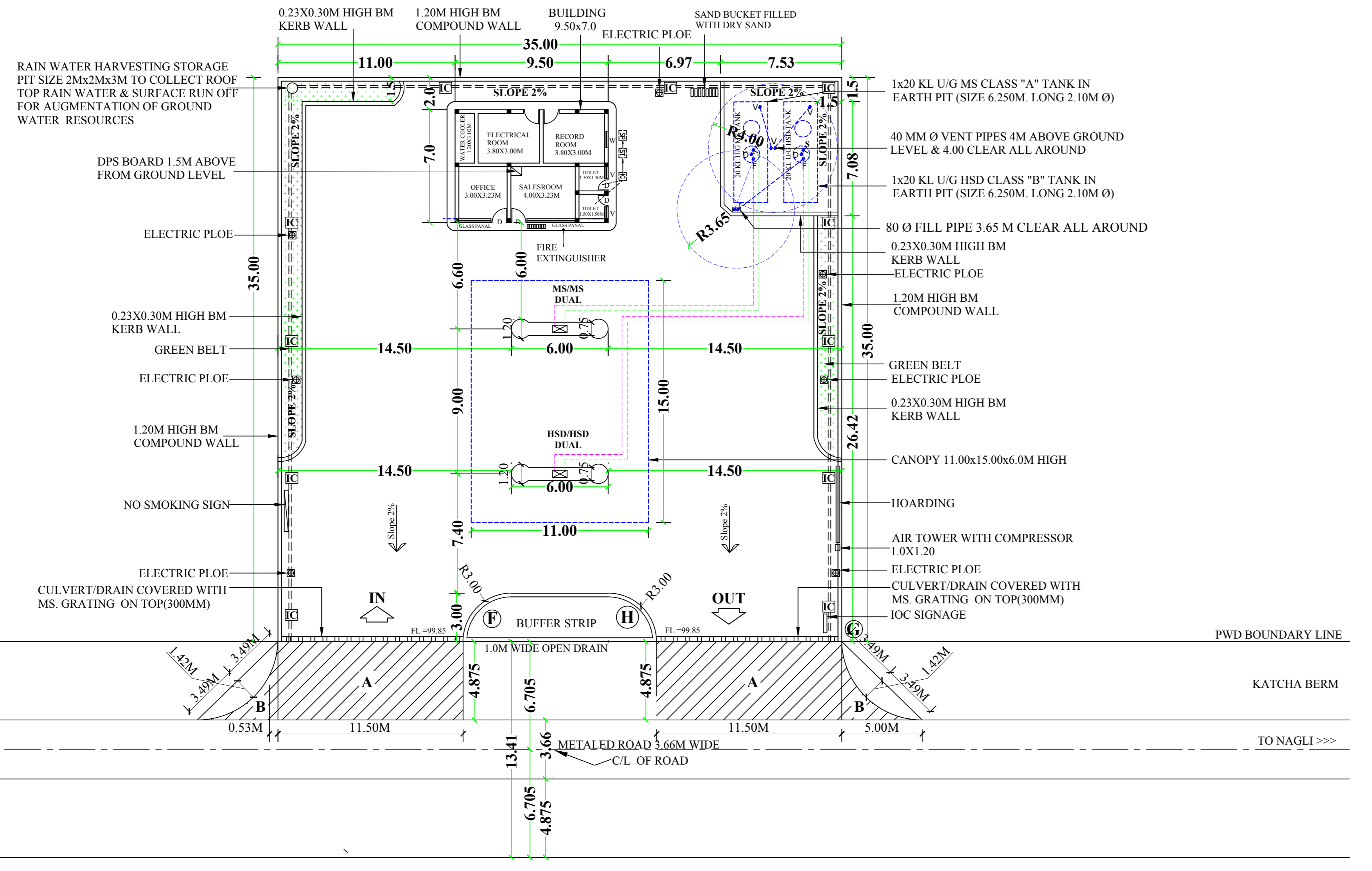

Forest Area-

Area 'A'x2	=2(11.5x4.875)
Area 'B'x2	=2x(6.5x0.875+0.0)
	=2x(12.19+(.4x1.42))
	=2x(12.19+0.56)
	=2x12.75
	=25.50
Total Area (A+B)	=11.16 SQM
	=123.28 SQM
	=0.0123 HE.

NON FOREST AREA = 1225 SQM  
=0.1225 HE.

REV. NO.	DESCRIPTION OF FACILITIES	DATE

REVISE DRAWING

- REFERENCE:-**
- F : Tank FILL Point
  - S : Tank Suction Point
  - V : Tank Vent Point
  - D : Tank Dip Point
  - EFP : Extended Fill Pipe
  - SAP : Single Arm Pole
  - DAP : Double Arm Pole

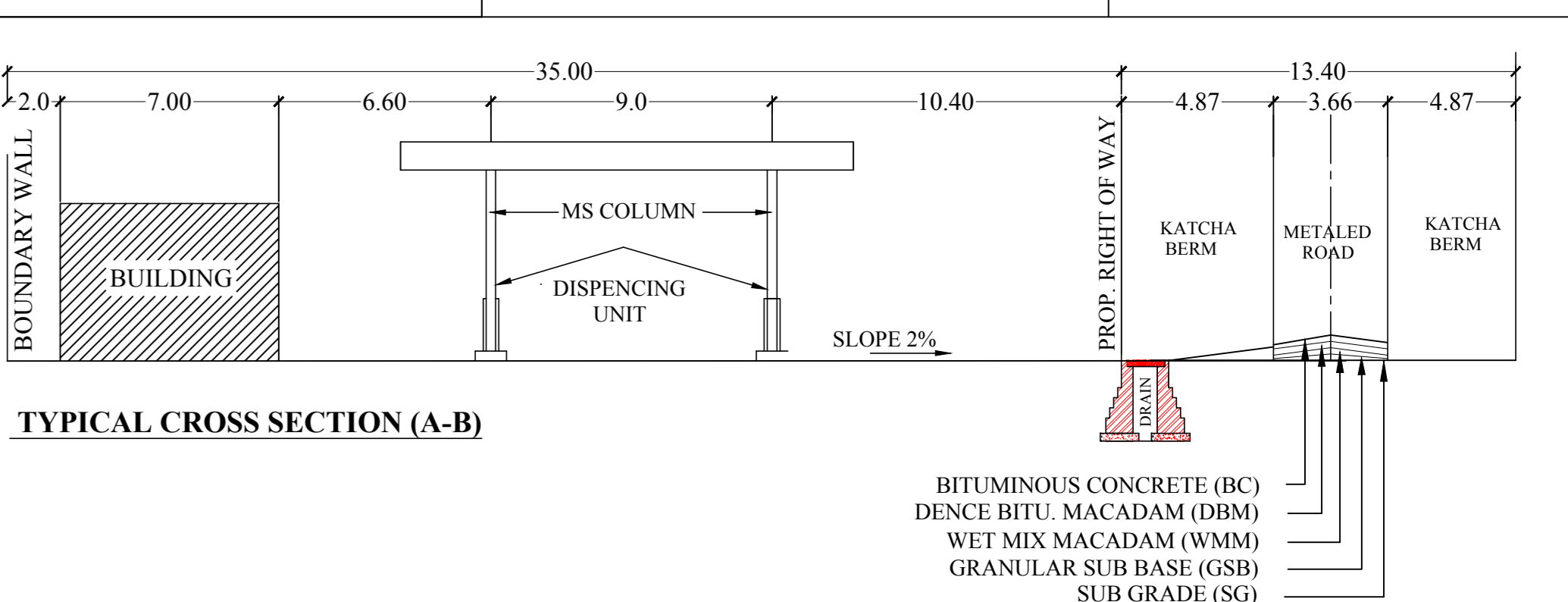
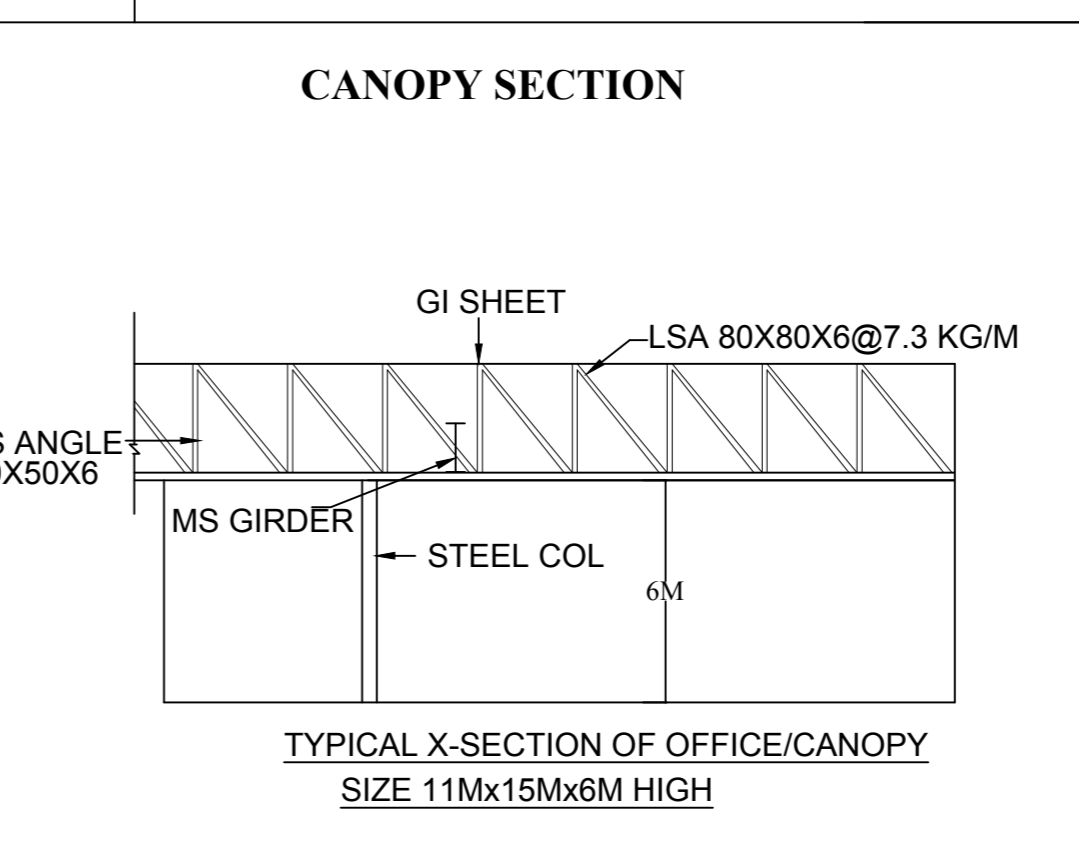
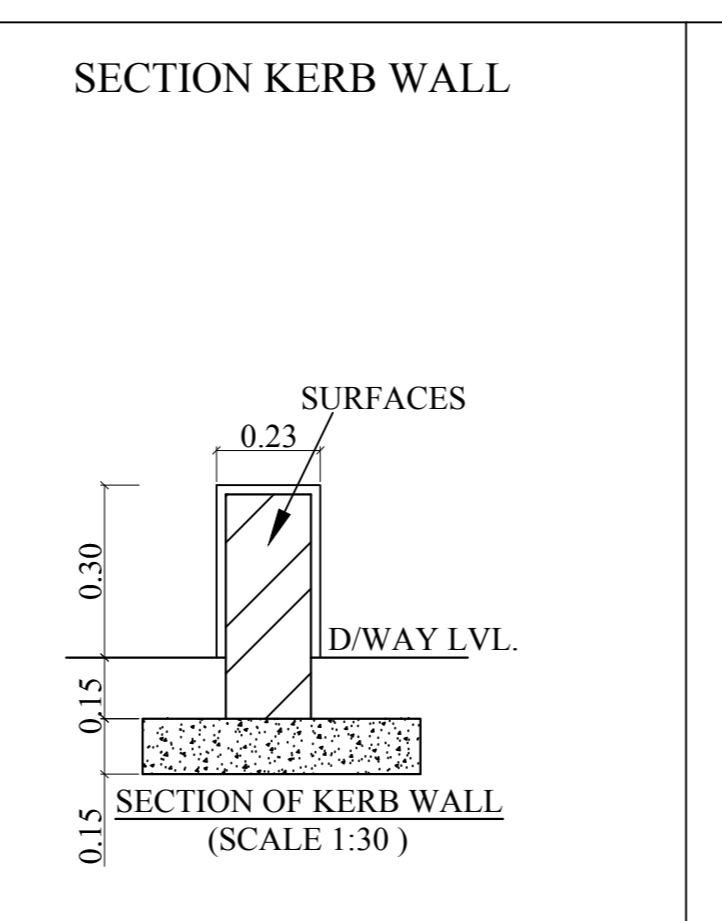
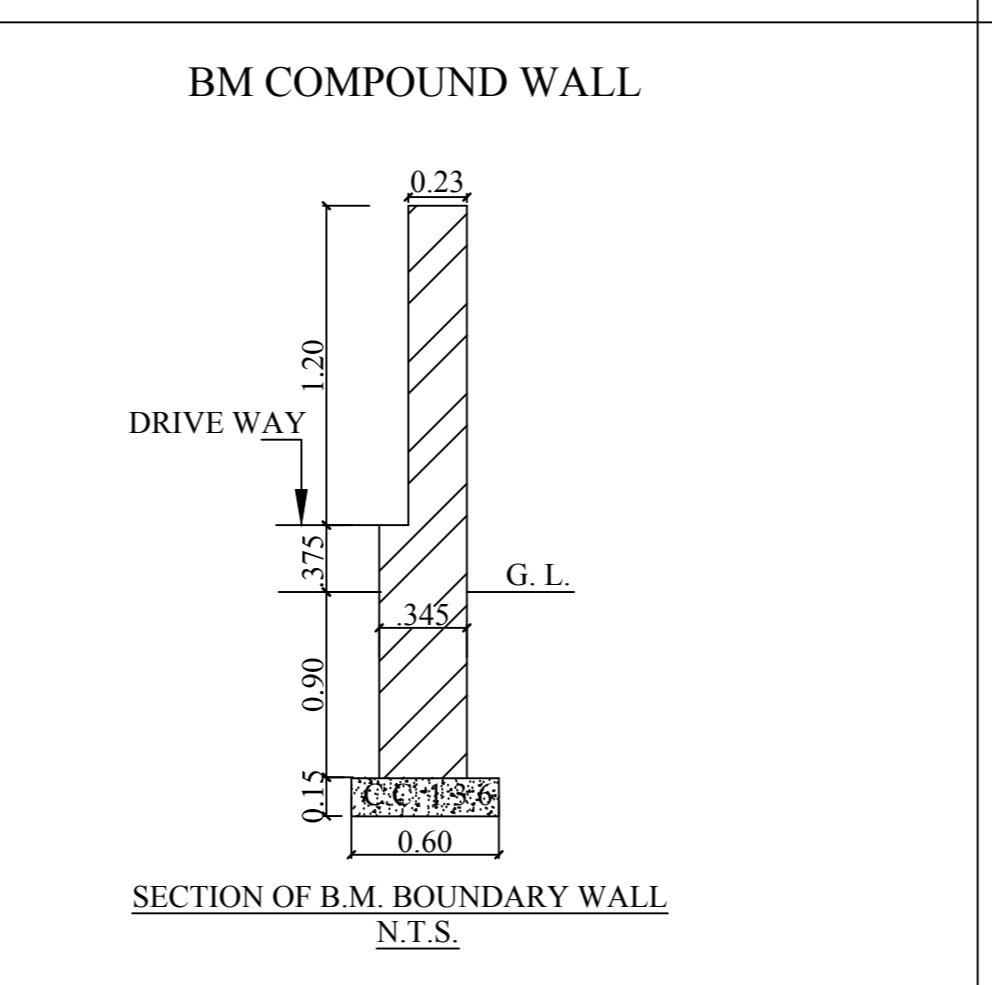
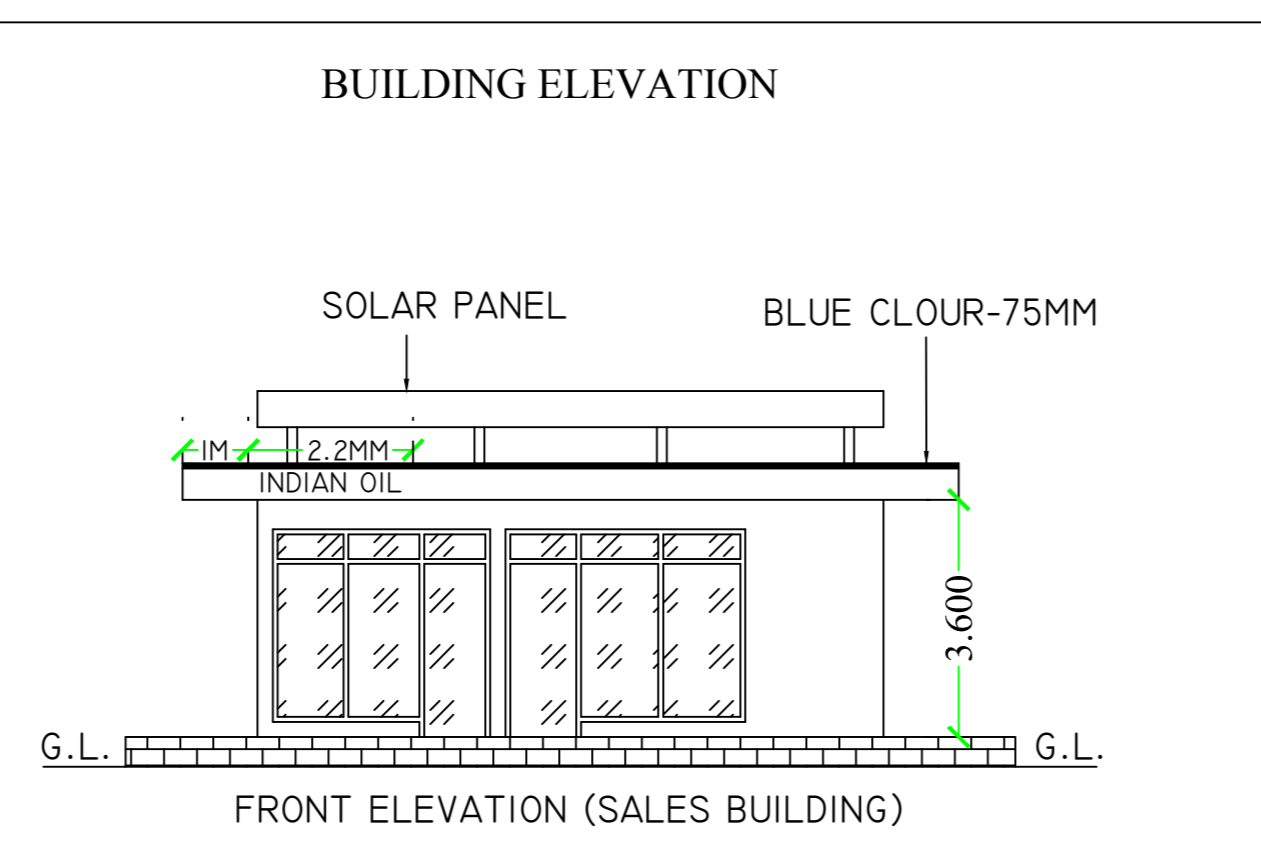
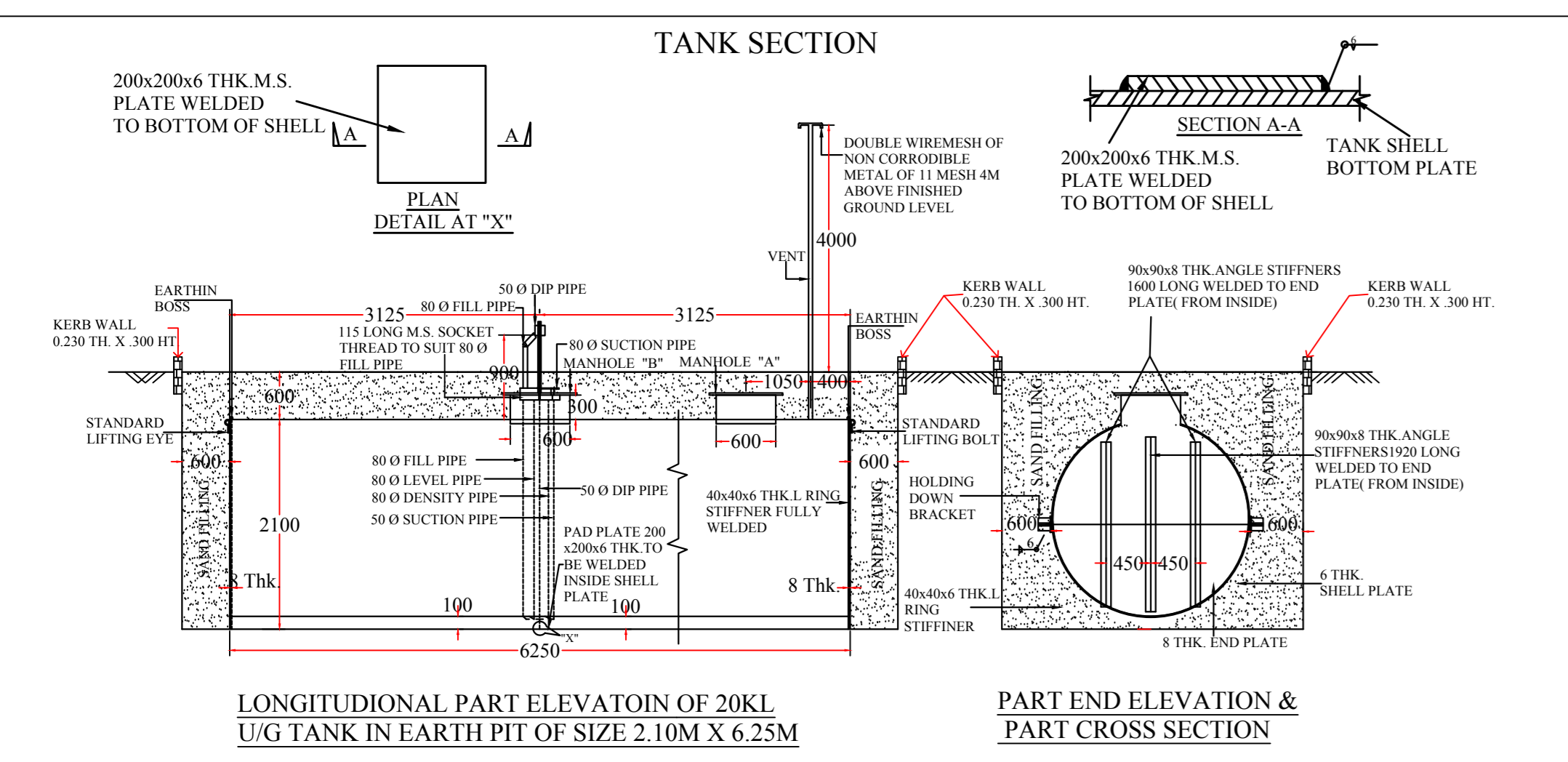

- GENERAL NOTES:**
- NO ROAD CROSSING WITHIN 100.00 M ON EITHER SIDE OF THE PLOT.
  - NO DRAIN SEWER OR STRUCTURE WITHIN 1.50 M FROM THE UNDER GROUND TANKS.
  - SUCTION, FILL & VENT PIPES UNDER THE DRIVEWAY TO BE HOUSED UNDER PIPE SLEEVES.
  - VENT PIPES 40 MM DIA 4.00 M HIGH FROM THE GROUND LEVEL AND 4.00 M CLEAR ALL ROUND WITHIN THE PLOT FILLED WITH INVERTED 'U' TYPE VENT HOOD COVERED WITH TWO LAYERS OF NON CORRODABLE MATTET WIRE GAUZE OF 11 MESH PER LINEAR CENTIMETER AT ITS OPEN ENDS.
  - D.P.S. BOARD FIXED ON THE WALL OF DEALER ROOM 1.500 M HIGH FROM ITS FLOOR LEVEL AND SHALL NOT BE KEPT UNDER LOCK AND KEY.
  - FILL POINTS ARE KEPT 3.650 M CLEAR ALL ROUND.
  - "NO SMOKING" SIGN SHALL BE DISPLAYED AT THE PETROL PUMP.
  - 2 NOS. DCP TYPE FIRE EXTINGUISHERS AND DRY SAND BUCKET OF CAPACITY 10 KG FOR EACH DISPENSING PUMP, 2 NO. CO2 TYPE FIRE EXTINGUISHERS OF CAPACITY 4.50 KG EACH FOR ELECTRIC FIRE SHALL BE PROVIDED AT THE PUMP.
  - TANKS FED BY TANK LORRY.
  - BOTH THE TANKS SHALL NOT BE REPLENISHED AT THE SAME TIME.
  - FILL PIPES AND DIP PIPES ARE FITTED WITH LOCKING ARRANGEMENT.
  - ALL ELECTRIC FITTINGS SHALL CONFORM TO IS 2148 OR EQUIVALENT ISI SPECIFICATIONS.
  - NO HT LINE PASSING OVER KSK/RO LAND

- SPECIFICATIONS:-**
- CERTIFIED THAT UNDERGROUND MS TANKS SHALL BE FABRICATED AND INSTALLED AS APPROVED BY CCOE NAGPUR, VIDE LETTER NO. P-6 (3) 51 DATED 23.01.07.
- NOTES:-**
- CERTIFIED THAT THIS IS A NEW KSK/RO.
  - CERTIFIED THAT ALL THE CLEARANCES/APPROVALS FROM OTHER RELEVANT GOVT. DEPTT. SHALL BE OBTAINED.
  - CERTIFIED THAT M.S. CANOPY SHALL CONFIRM TO SOUND ENGG. SPEC. AND THERE IS NO CHANCE OF ITS EVER CAVING-IN UNDER NORMAL CIRCUMSTANCES.
  - CERTIFIED THAT ALL FACILITIES AS SHOWN IN THE DRAWING SHALL BE INSTALLED/PROVIDED AT ABOVE KSK/RO.
  - ALL DIMENSION IN METER OTHERWISE SPECIFIED.

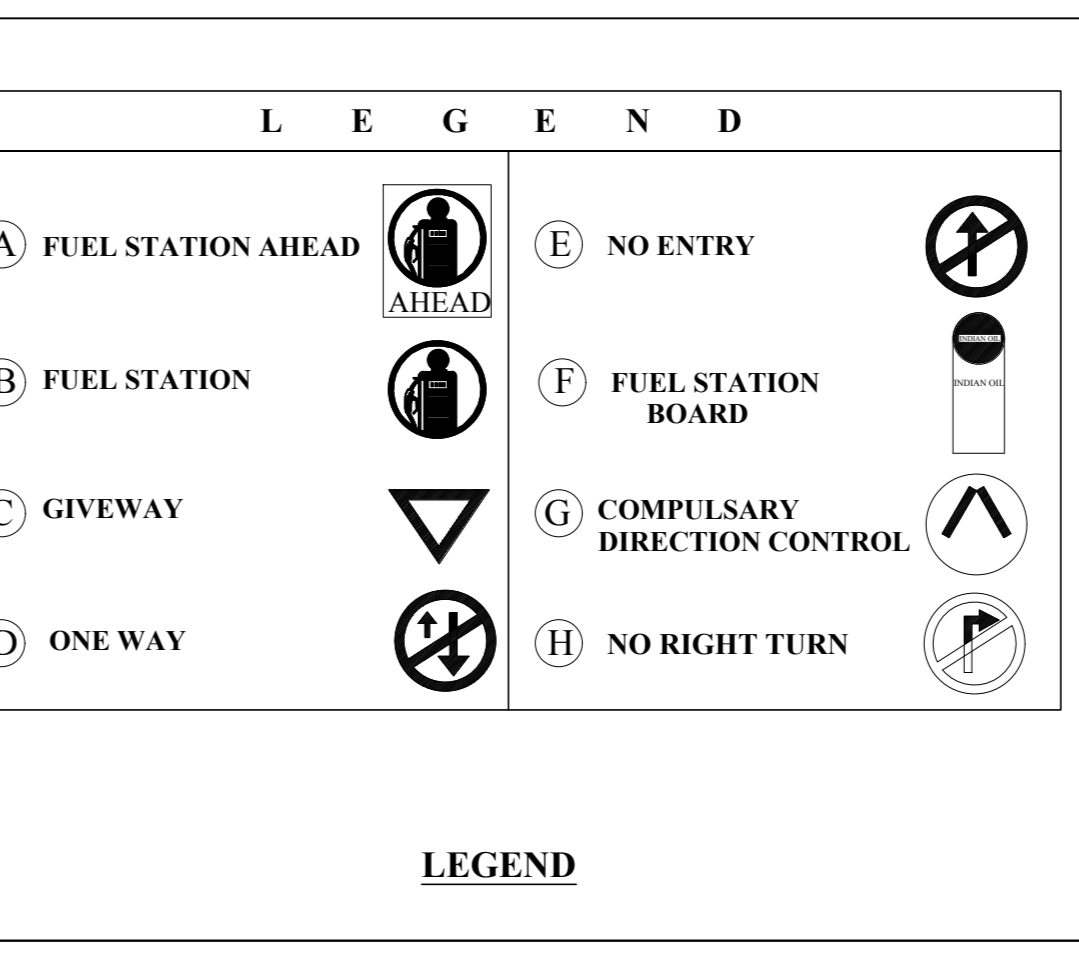
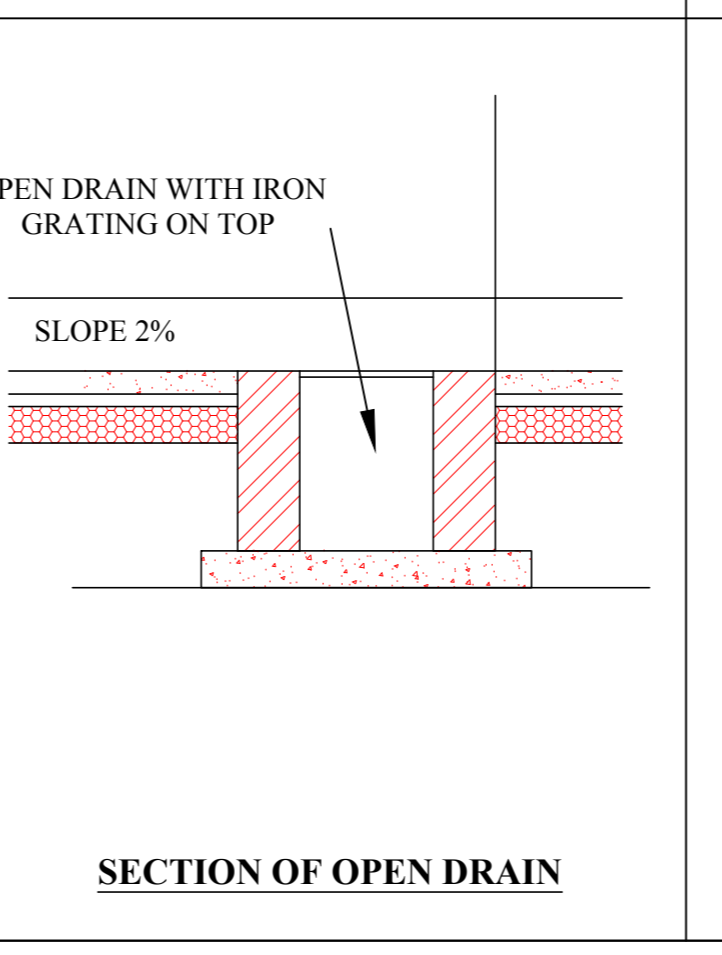
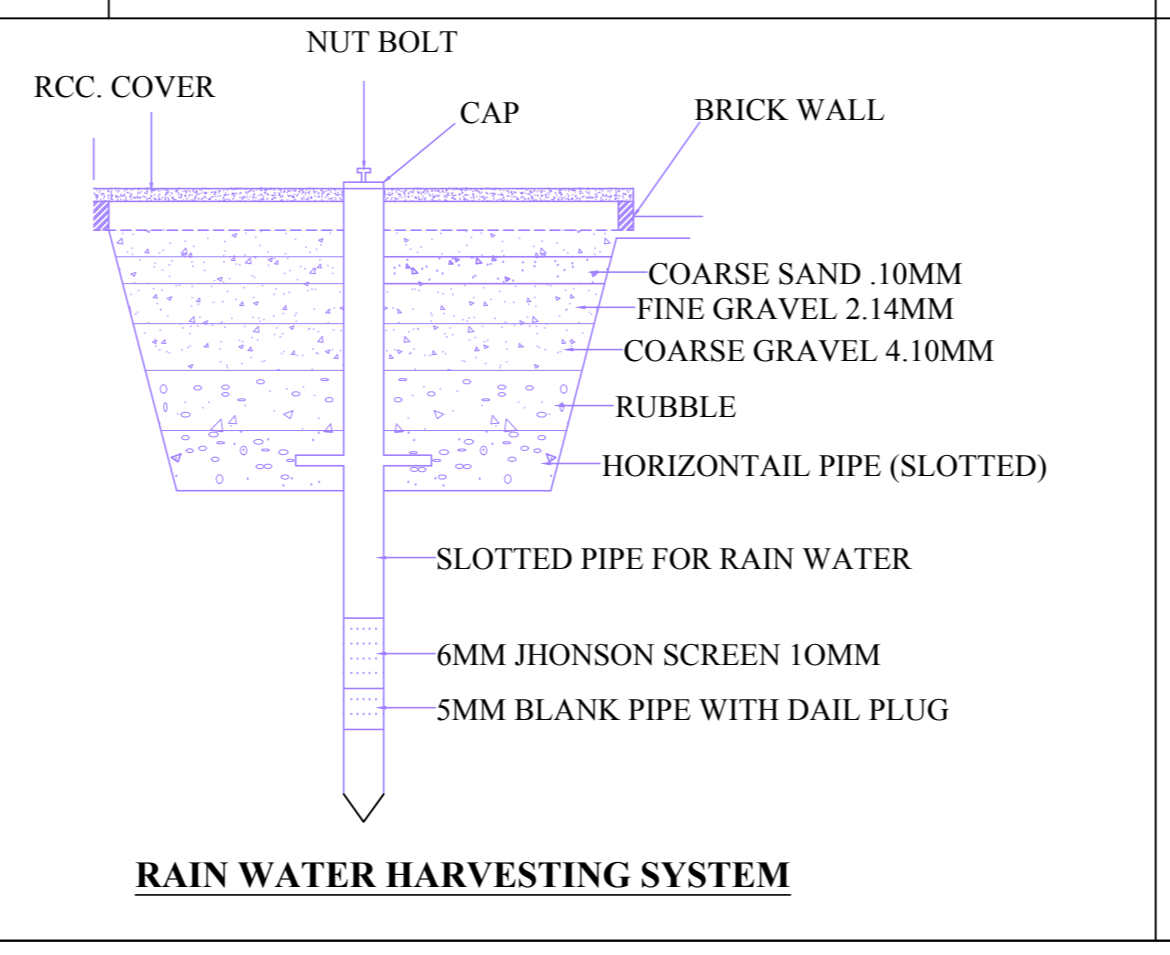

**TANK DATA CHART**

TANK	SIZE OF TANK	MS PLATES SHELL	NO OF H.D.B. END	VENT PIPE DIA.	SLAB TH. IN MM	TANK & PUMP MS	HSD
20 KL	2.1M X 6.25M. LONG	6mm	8	40	--	1+1	1+1

**SITE DATA CHART**

LOCATION	PRITHIPUR
KHASRA NO.	5/10/2
KHEWAT NO.	48/54
POLICE STN.	BILASPUR
RAILWAY STN.	JAGADHARI
THEHSIL	BILASPUR
DISTT.	YAMUNA NAGAR
STATE	HARYANA
PIN CODE	135102

**INDIAN OIL CORPORATION LIMITED, MARKETING DIVISION, PANIPAT DIVISIONAL OFFICE, PANIPAT.**

**TITLE:-**  
SITE/LAYOUT PLAN OF IOCL RETAIL OUTLET (KSK) SITUATED ON LEDI-NAGLI ROAD (ODR), RD 7.100 (LHS), AT VILLAGE PRITHIPUR, BLOCK BILASPUR, DISTT. YAMUNA NAGAR (HARYANA).

DRG. NO.PDO/FOREST/PRITHIPUR

DATE :16.07.2019

DRAWN BY:-  
DEV SHREE TRADERS PANIPAT

CHECKED BY

APPROVED BY