

VILLAGE MAP SHOWING THE C.A. LAND FOR KANSUR 110KV SUB-STATION  
REVENUE SURVEY NUMBER 96 OF KEREGADDE VILLAGE, SIDDAPURA TALUK,

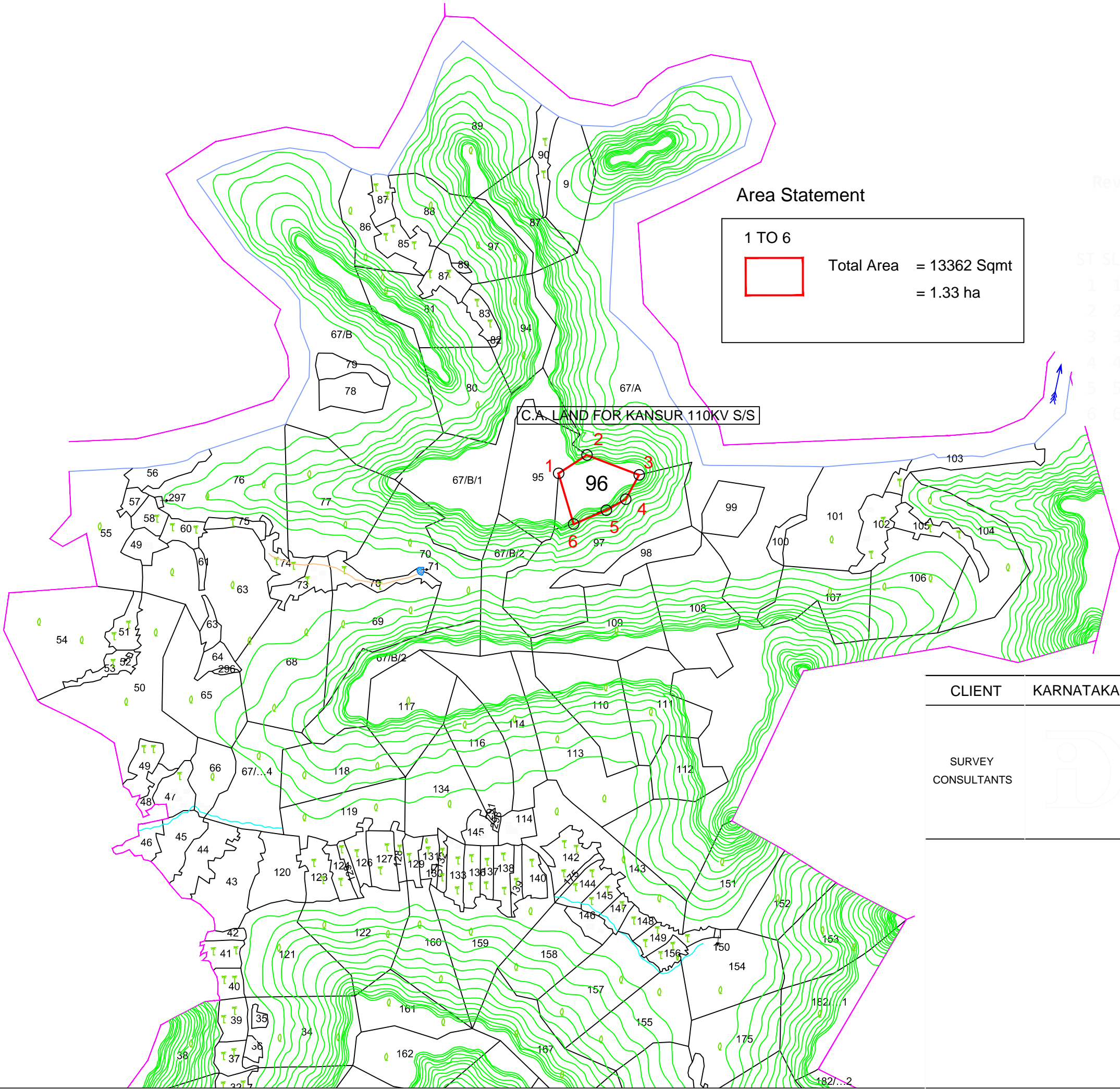
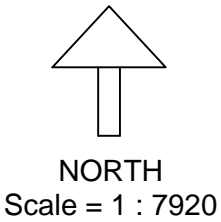

Area Statement

1 TO 6

Total Area = 13362 Sqmt  
= 1.33 ha

C.A. LAND  
Taluk Siddapur  
Village Keregadde  
Revenue Sy No: 96

ST	SL	DIST	LEG	L	BEARING	CO-ORDINATES
1	1	116 m	116 m	11°	true	N14 31 03.2 E74 46 49.2
2	2	185 m	69 m	56°	true	N14 31 04.4 E74 46 51.1
3	3	298 m	113 m	111°	true	N14 31 03.1 E74 46 54.6
4	4	356 m	58 m	209°	true	N14 31 01.5 E74 46 53.7
5	5	401 m	45 m	243°	true	N14 31 00.8 E74 46 52.4
6	6	469 m	68 m	246°	true	N14 30 59.8 E74 46 50.2

CLIENT	KARNATAKA POWER TRANSMISSION CORPORATION LIMITED		
SURVEY CONSULTANTS		M/s DEEKSHA INFOTECH	
		SURVEY, GEO TECH, MAP MAKING AND CAD TOPOMAP & VILLAGE MAP GEO REFERENCE, DGPS SURVEY # C/53, K.G. Nagar, Sameerapura Chamarajapete, Bangalore - 560 018 Mobile No. : 8861164378, 9980654378 e-mail : deekshainfotech97@gmail.com	