

Diversion of 0.769995 ha. Protected forest land for laying under ground OFC from village -Dolatpar to Mata na madh & Village Dayapar to Ghaduli in Lakhpatt Taluka in Kutch District in favour of Railtel corporation of India.  
(Online Proposal No.FP/GJ/OFC/46707/2020)

Details of degraded forest area identified for compensatory afforestation viz. Survey no / Compartment no / Khasra no. / Khatoni no. Village, Tehsil, District etc. along with map in appropriate scale showing the boundaries of adjoining forest areas with their use in distinct colors and GPS readings.

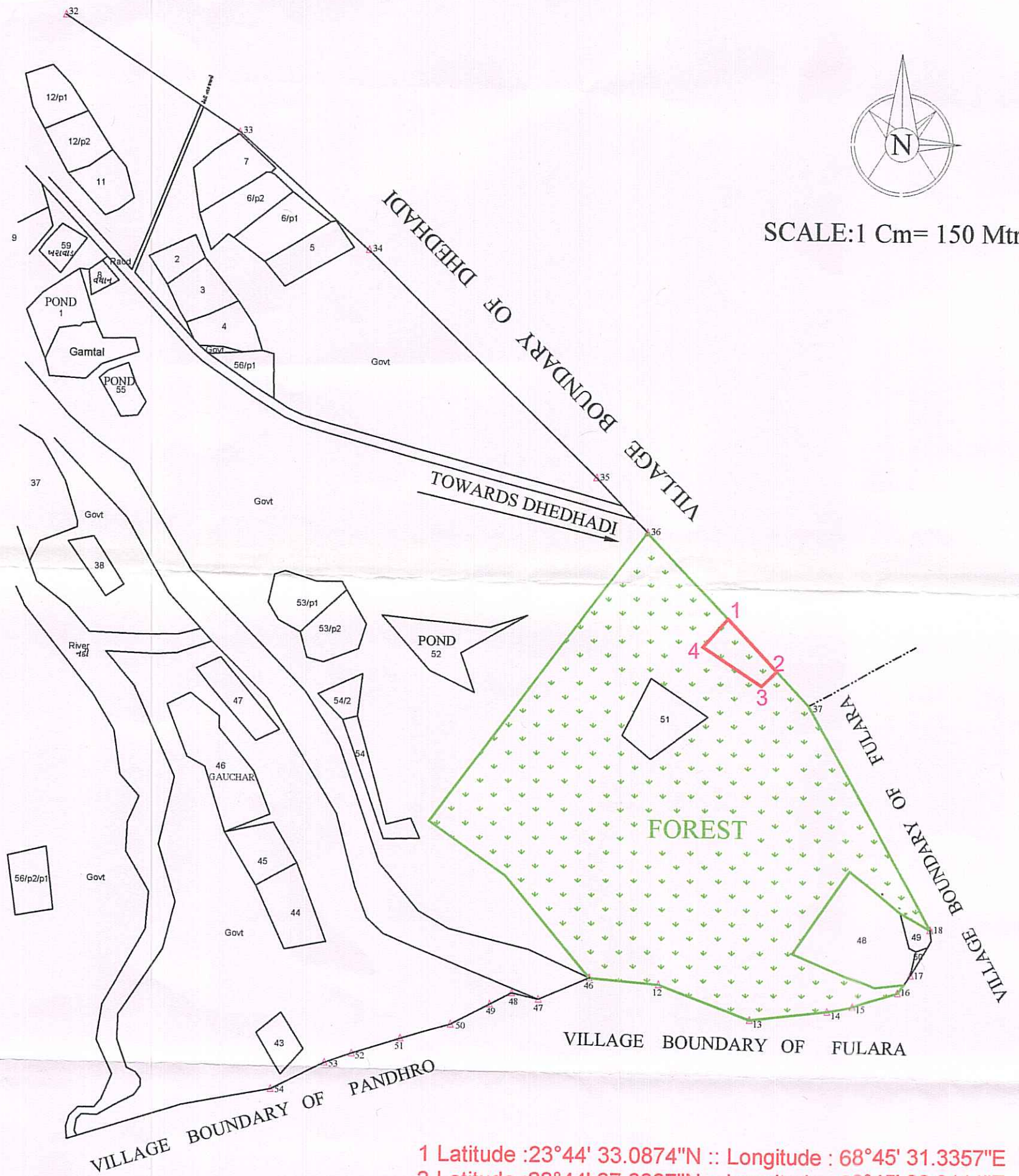

#### LEGEND

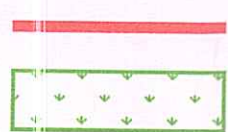

Degraded Forest land for C.A. (2.00 Ha.)

Reserved Forest Land

  
 Dy. Conservator of Forest  
 Kachchh West Division, Bhuj

Survey No. 56/pt  
 Village : BAIYAVO  
 Taluka : LAKHPAT  
 District: KUTCH