

INDEX MAP ON TOPOSHEET FOR C.A. LAND FOR THE PROJECT
M/S TS WIND POWER DEVELOPERS SATARA.

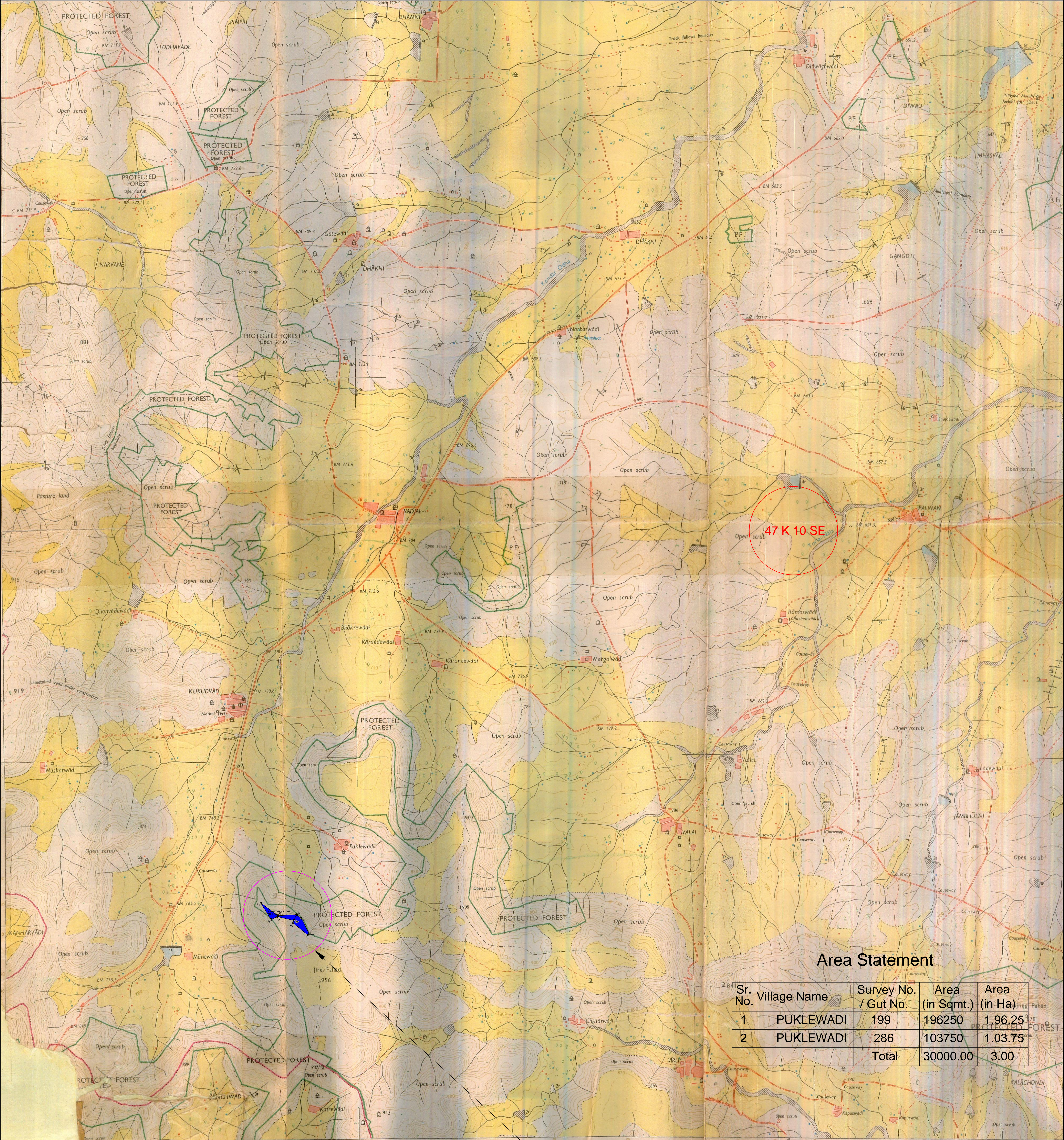

Area Statement

| Sr. No. | Village Name | Survey No. / Gut No. | Area (in Sqmt.) | Area (in Ha) |
|---------|--------------|----------------------|-----------------|--------------|
| 1 | PUKLEWADI | 199 | 196250 | 1.96.25 |
| 2 | PUKLEWADI | 286 | 103750 | 1.03.75 |
| Total | | | 30000.00 | 3.00 |

Boundary Point Co-Ordinate List

| Sr.No | POINT | EASTING | NORTHING | LATITUDE | LONGITUDE |
|-------|-------|---------|----------|----------------|----------------|
| 1 | P1 | 463985 | 1937480 | N17° 31' 23.9" | E74° 39' 38.5" |
| 2 | P2 | 463994 | 1937494 | N17° 31' 24.4" | E74° 39' 38.8" |
| 3 | P3 | 4638350 | 1937660 | N17° 31' 29.8" | E74° 39' 33.9" |
| 4 | P4 | 463789 | 1637682 | N17° 31' 30.5" | E74° 39' 31.8" |
| 5 | P5 | 463776 | 1937619 | N17° 31' 28.4" | E74° 39' 31.4" |
| 6 | P6 | 463770 | 1937588 | N17° 31' 27.4" | E74° 39' 31.2" |
| 7 | P7 | 463567 | 1937620 | N17° 31' 28.5" | E74° 39' 24.3" |
| 8 | P8 | 463501 | 1637565 | N17° 31' 26.7" | E74° 39' 22.1" |
| 9 | P9 | 463354 | 1937718 | N17° 31' 31.6" | E74° 39' 17.1" |
| 10 | P10 | 463575 | 1937634 | N17° 31' 28.9" | E74° 39' 24.6" |

LEGEND

| | |
|--|--|
| | PROPOSED NON FOREST AREA FOR CA 3.00 Ha. |
| | GOV. OF MAHARASTRA FOREST |
| | VILLAGE BOUNDARY |
| | RIVER |
| | ROAD |
| | 37 KHASARA BOUNDARY |
| | BOUNDARY POINT |

CA LAND

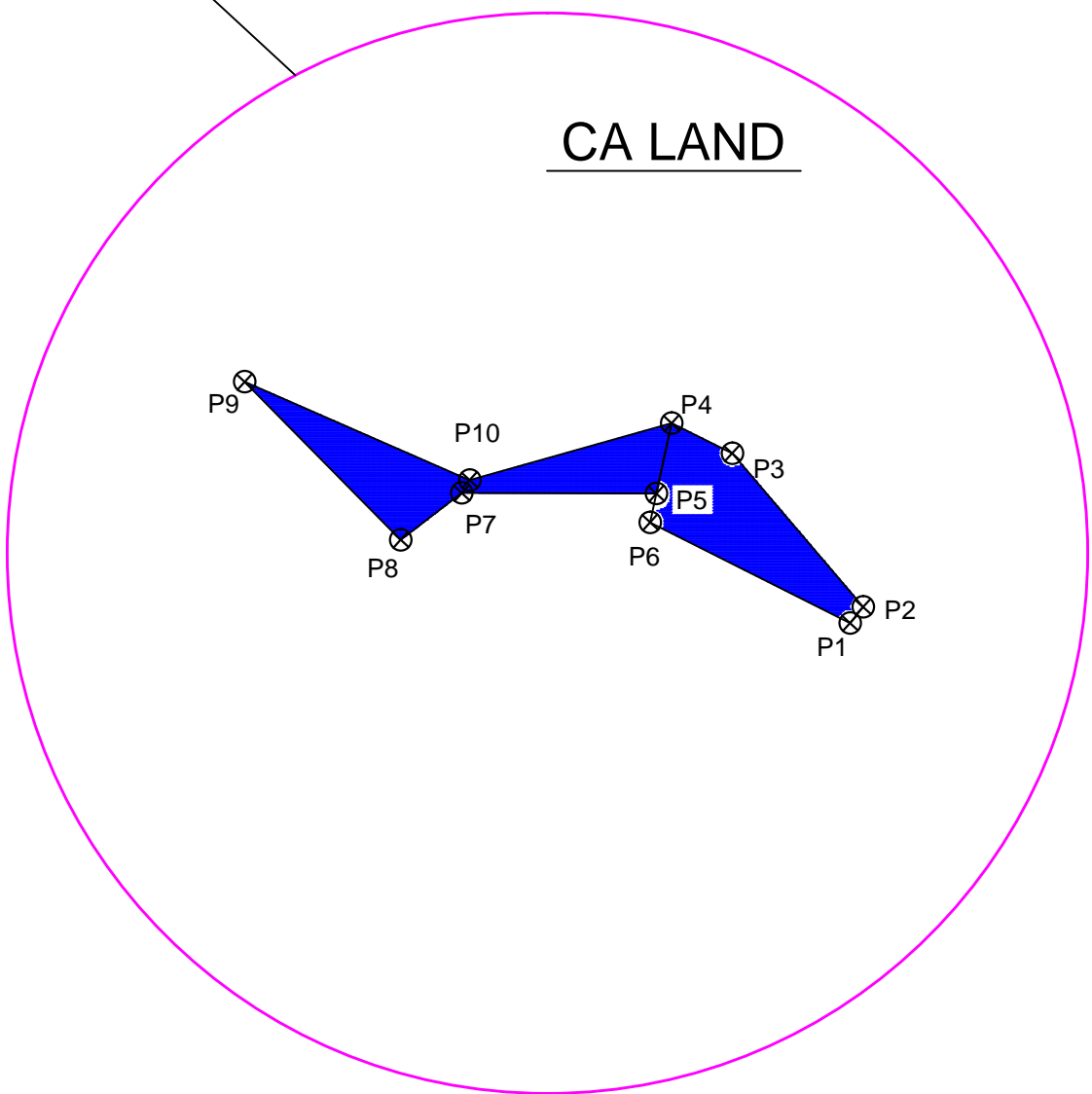

LEGEND

| | |
|--|--|
| | PROPOSED NON FOREST AREA FOR CA 3.00 Ha. |
|--|--|

Project Proponent

M/S TS WIND POWER DEVELOPERS SATARA.

Village -PUKLEWADI, Tahsil - MAN, District - SATARA

Scale 1 : 25,000

Date

Drawn by :

Subject : Proposed Compensatory afforestation Land against diversion 3.00 Ha. Private Forest Area of village - Chelewadi (Bhadale), Taluka - Koregaon, Dist. - Satara, and Village - Alapur, Taluka - Phaltan, Dist. - Satara for proposed M/S TS WIND POWER DEVELOPERS SATARA.

Checked by :

TOPOSHEET PLAN

Approved by :