

Diversion of 0.3968 Ha for Laying of Water Pipeline in Forest lands of Gunjanur, Chinnakara, Dharmapur, Narayanpur, Shakalathpalli and Bommaraladodi for filling 35 Main and 20 Secondary Tanks from Bhima River in favour of Krishan Bhagya Jala Nigam Ltd (KBJNL.)

TopoSheet No. 56H

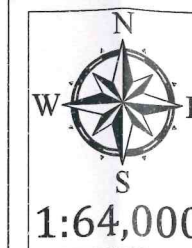

Legend

- Forest_Water_Pipeline
- Forest Water Pipeline Polygon
- Power_transmission_line_for_pump_houses_in_non_forest_area
- Natural_Nalla_to_Secondary_Tanks
- Entire_Water_Pipeline_Alignment
- Pump_houses_delivery_Chambers_in_non_forest_area
- Tanks

Sl No.	Component	Dia Of pipeline in MM	Village Name	Survey No.	Total Area extent for FC		
					Length (mtr)	Width (mtr)	Extent in Ha.
1	Pipeline	800	Gunjanur	76/1	54.74	2.97	0.0163
2	Pipeline	800	Chinnakar	77/1	275.5	2.52	0.0694
3	Pipeline	800	Dharmapur	13	849.4	2.6	0.2208
4	Pipeline	800	Narayanpur	83/1	85.5	2.35	0.0201
5	Pipeline	212	Sakalathpalli	35	1001.3	0.4	0.0401
7	Pipeline	600	Bommaraladodi	108	350.6	0.86	0.0302
					Total		0.3968

Justification Note

The Project "Filling up of 35 Tanks in Yadgir District" is Karnataka State Government Project, executed by KBJNL (Irrigation Department) which aims at filling 35 direct and 20 indirect tanks. The primary purpose of the project is to ensure that this part of dry region which is of late suffering from scanty rainfall which leads to drought like situation as we come towards the end of summer season can be avoided to some extent. The primary reason for running the project in forest area is

- 1) Following Tanks are in the Forest Area and to fill them we have to enter forest land which was accepted in previous justification.
 - a. Duppali Tank in Bommaraladodi Village (Forest Diversion sought is 0.03 Ha)
 - b. Malkappanahalli Tank in Shakalathpalli Village (Forest Diversion sought is 0.04 Ha)

2) There is Reserve Forest area & Social Forest plantations and to minimize the requirement of forest land we have used proposed alignment along road throughout Narayanpur, Chinnakar & Gunjanur (Forest diversion sought is 0.0201Ha, 0.0694Ha & 0.0163Ha) so that the only extent of land required is the physical width of laying the pipe. If change alternate alignments 1 & 2 to or any other alignment then we will also require land for movement of vehicles and pipes which will increase the extent of forest land hence alternative alignments have been ruled out for this reason. Additionally, there are also excessive boulders found along the alternate alignments which might require blasting. Since blasting is not permitted in forest area hence we have gone through proposed alignment for laying a pipeline.

3) The stretch of Dharmapur (Forest diversion sought is 0.02208Ha) is in Ghat we can't go along road due to inaccessibility of land and it requires tunneling within forest area which might require blasting hence we have taken a path which is feasible in ghat section to lift water to a height of 178Meter. Hence alternative alignment is not been considered and there are also excessive boulders found along the alternate alignments which might require blasting since blasting is not permitted in forest area hence we have gone through proposed alignment for laying a pipeline.

4) Despite running 194 Kms of Pipeline network and 170.8332 Ha of Land acquisition is in our proposal, our forest land requirement is kept to a minimal of 0.3968 Ha

Yours faithfully,

Executive Engineer,
KBJNL, Sonthi L.I.Division,
Khanapur Camp