

VILLAGE MAP SHOWING THE AREA FOR CA LAND BY M/S JSW STEEL LTD.,
OVER AN EXTENT OF **12.58 ha. (31.09Acres.)** IN TIMMAPURA VILLAGE OF LINGASUGUR TALUK, RAICHUR DISTRICT
IN LIEU OF ML NO.2621(RAMA IRON ORE MINES)

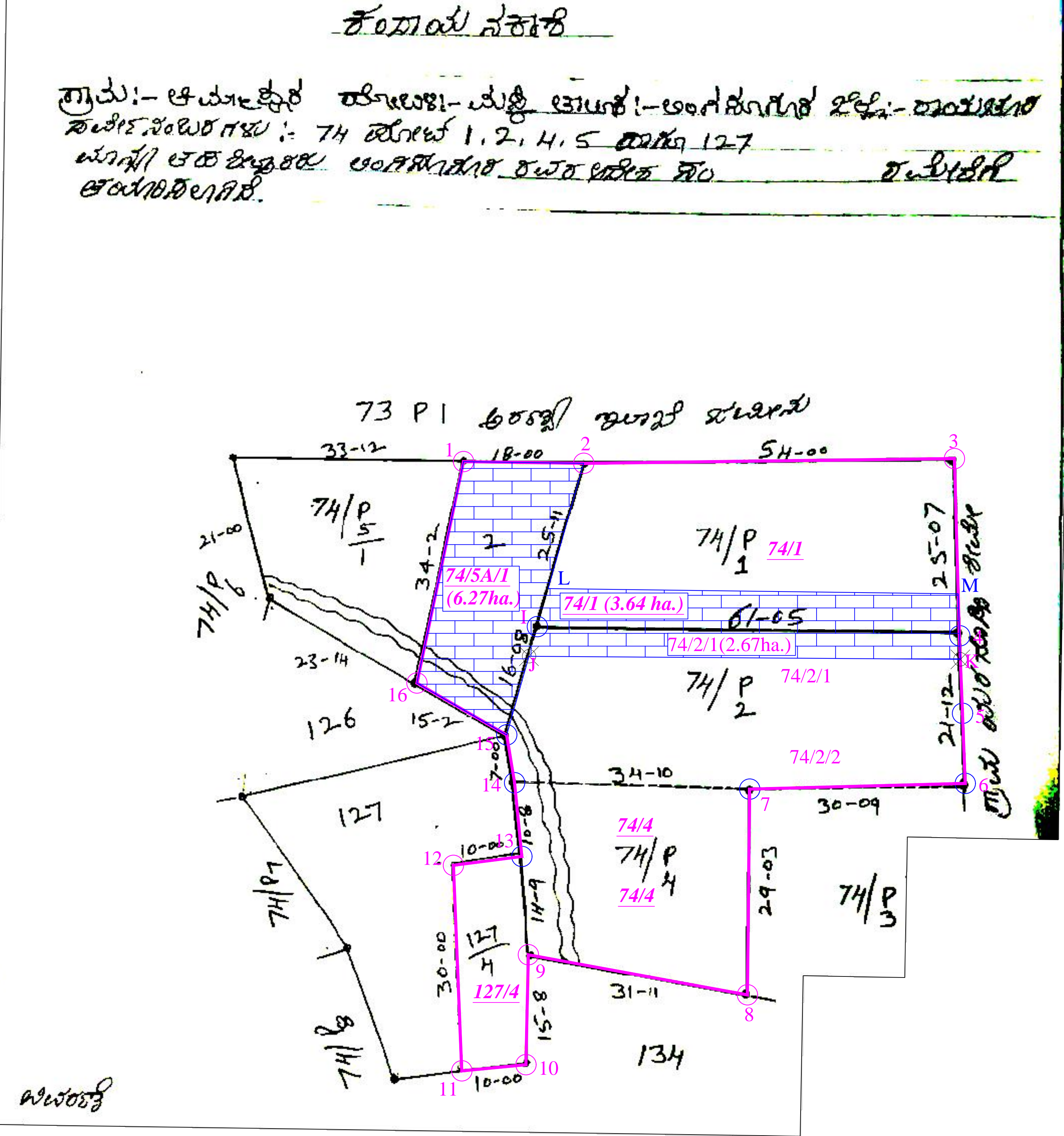

Details of "CA" Area identified by JSW Steel Ltd

Village	Sy. No.	Extent in Acres	Extent in ha.
Timmapur	74/4	22.250	9.004
	74/2/1	21.450	8.681
	74/2/2	15.050	6.091
	74/1	36.180	14.642
	74/5A/1	15.500	6.273
	127/4	7.650	3.096
		118.080	47.786

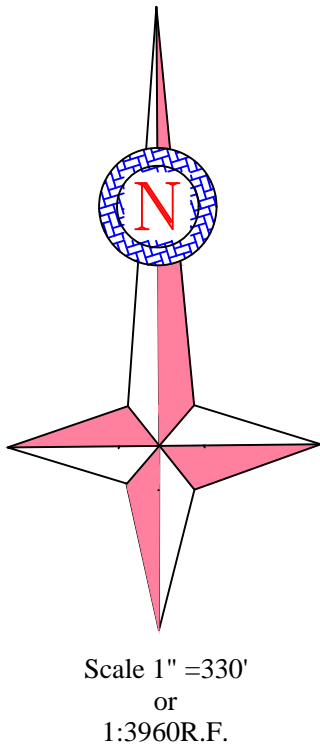

Co Ordinates of "CA" Area identified by JSW Steel Ltd (Datum-WGS 84)

P.No	Zone	Latitude	Longitude	Latitude	Longitude
1	43 P	1762913	660675	15.9403	76.5012
2	43 P	1762885	660849	15.9401	76.5028
3	43 P	1762815	661390	15.9394	76.5078
4	43 P	1762563	661362	15.9371	76.5076
5	43 P	1762443	661349	15.9360	76.5074
6	43 P	1762340	661339	15.9351	76.5073
7	43 P	1762376	661023	15.9355	76.5044
8	43 P	1762077	660977	15.9328	76.5039
9	43 P	1762181	660667	15.9337	76.5010
10	43 P	1762022	660640	15.9323	76.5008
11	43 P	1762026	660545	15.9323	76.4999
12	43 P	1762327	660576	15.9350	76.5002
13	43 P	1762326	660677	15.9350	76.5012
14	43 P	1762434	660682	15.9360	76.5012
15	43 P	1762506	660681	15.9367	76.5012
16	43 P	1762600	660561	15.9375	76.5001

Details of the area 12.58ha

Village	Sy. No.	Extent in Acres	Extent in ha.
Timmapur	74/2/1(Part)	6.60	2.67
	74/1(Part)	8.99	3.64
	74/5A/1	15.50	6.27
Total		31.09	12.58

GPS Co Ordinates of Area-12.58ha. (31.09 acres.) earmarked as a CA land in lieu of ML No.2621 Rama Iron Ore Mines.

P.No	Zone	Latitude	Longitude	Latitude	Longitude
1	43 P	1762913	660675	15.9403	76.5012
2	43 P	1762885	660849	15.9401	76.5028
L	43 P	1762710	660772	15.9385	76.5021
M	43 P	1762617	661368	15.9376	76.5076
K	43 P	1762522	661357	15.9368	76.5075
J	43 P	1762616	660730	15.9376	76.5017
15	43 P	1762506	660681	15.9367	76.5012
16	43 P	1762600	660561	15.9375	76.5001

L E G E N D

	VILLAGE MAP IMAGES(PART)
	Boundary of CA Land 47.78 ha.(118.08 acres) identified by JSW Steel Ltd.
	GPS Co Ordinates of Area-12.58Ha.(31.09 acres.) earmarked as a CA land in lieu of ML No.2621 Rama Iron Ore Mines.
	Points fixed in the field by revenue surveyor.

VILLAGE MAP SHOWING THE AREA FOR CA LAND BY M/S JSW STEEL LTD., OVER AN EXTENT OF **21.22 ha. (52.43Acres.)** IN HALVABI VILLAGE OF LINGASUGUR TALUK, RAICHUR DISTRICT

IN LIEU OF ML NO.2621(RAMA IRON ORE MINES)

ಜೆ.ಎಸ್. ಡಬ್ಲ್ಯೂ ಸ್ಟೀಲ್ (ಅ) ಲಿಮಿಟೆಡ್ ಸಂಸ್ಥೆಗೆ ಸೇರಿದ ಹೆಸರಿನಲ್ಲಿ:- ಬಳ್ಳಾರಿ ಜಿಲ್ಲೆ:- ಬಳ್ಳಾರಿ ಇವರಿಂದ ಅರಣ್ಯ ಸಂರಕ್ಷಣಾ ಕಾಯ್ದೆ ೧೯೮೦ ರ ಅಡಿಯಲ್ಲಿ ಪರಿಹಾರಾತ್ಮಕ ನಡೆದು ತೆಗೆದು ಬೆಳೆಸಬೇಕಾದ ಅರಣ್ಯ ಇಲಾಖೆಗೆ ಒಪ್ಪು ನೀಡುವ ಬಗ್ಗೆಯ ಸಲಹೆ ಲಭ್ಯವಿರುವುದರಿಂದ ಗ್ರಾಮ:- ಹಾಲಬಾಬಿ ಹೊಬಳಿ:- ಅಂನಕು ಗೂಡು ತಾಲೂಕು:- ಅಂನಕು ಗೂಡು ಜಿಲ್ಲೆ:- ರಾಯಚೂರು

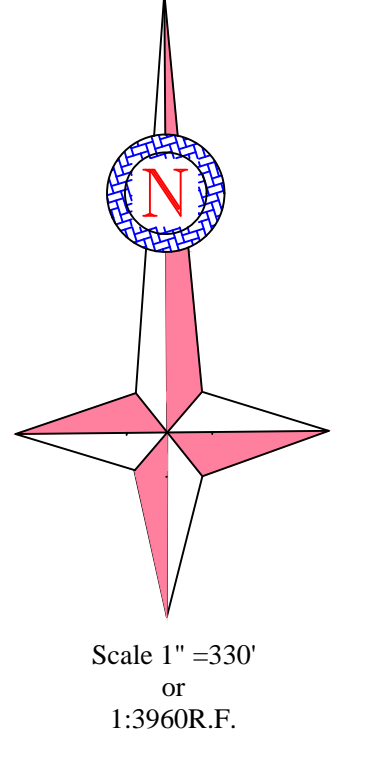

Details of "CA" Area identified by JSW Steel Ltd

Village	Sy. No.	Area in			
		Acres	Gunta	Acres	Ha.
Halvabi	140	6	11	6.28	2.54
	39	23	38	23.95	9.69
	142	9	26	9.65	3.91
	140	12	22	12.55	5.08
	Total	52	17	52.43	21.22

GPS Co Ordinates of Area-21.22ha. (52.43acres) earmarked as a CA land in lieu of ML No.2621 Rama Iron Ore Mines.

P.No	Zone	Latitude	Longitude	Latitude	Longitude
A	43 Q	1795346	651034	16.2341	76.4132
B	43 Q	1795585	651384	16.2362	76.4165
C	43 Q	1795341	651430	16.2340	76.4169
D	43 Q	1795188	651106	16.2326	76.4138
E	43 Q	1795329	651699	16.2339	76.4194
F	43 Q	1795015	651635	16.2310	76.4188
G	43 Q	1794827	651614	16.2293	76.4186
H	43 Q	1794826	651410	16.2293	76.4167
I	43 Q	1794833	651241	16.2294	76.4151
J	43 Q	1794804	650818	16.2292	76.4111
K	43 Q	1794951	650727	16.2305	76.4103
L	43 Q	1795097	651133	16.2318	76.4141

L	E	G	E	N	D
	Village map images(part)				
	Boundary of CA Land 21.22 ha.(52.43acres) identified by JSW Steel Ltd.				
	Area-21.22ha.(52.43acres) earmarked as a CA land in lieu of ML No.2621 Rama Iron Ore Mines.				



ಬೆಂಗಳೂರು ಸರ್ಕಾರದ ಸರ್ವೆ ಸಂಖ್ಯೆಗಳು
 - - - - - ರಾಜ್ಯ ಸರ್ಕಾರ
 □ ಕೃಷಿ ಭೂಮಿ
 □ ಅರಣ್ಯ ಭೂಮಿ

ಅರಣ್ಯ ಭೂಮಿ ಸರ್ವೆ ಸಂಖ್ಯೆಗಳು
 ಸ.ನಂ. ವಿವರ
 143 21-26
 39 23-38
 119 29-10
 141 29-10
 142 20-33
 139 25-17
 140 29-04
 138 27-27
 137 19-02
 121 21-31
 107 31-17

Project Proponent
 For JSW Steel Ltd.