

कार्यालय क्षेत्रीय प्रमुख  
खनिज साधन विभाग, मध्यप्रदेश शासन  
संचालनालय भौमिकी तथा खनिकर्म  
क्षेत्रीय कार्यालय रीवा, मध्यप्रदेश  
ई मेल – rhdgmrew@mp.gov.in

क्रमांक

/मा.प्ला./न.क्र./2021

रीवा, दिनांक

प्रति,

स्वामी नित्यानंद जी महाराज स्टोन्स  
प्रो. श्री ललित पंधाल  
निवासी मकान नंबर 975/76 सेक्टर 13,  
हुड्डा भिवानी, हरियाणा

विषय :- खनन योजना के अनुमोदन बाबत।

संदर्भ :- 1. कार्यालय कलेक्टर (खनिज शाखा) जिला रीवा का आदेश क्रमांक 5937/खनिज/2021 रीवा, दिनांक 11.10.2021

2. इस कार्यालय का आवक क्रमांक 1307 दिनांक 23.12.2021

—00—

उपरोक्त विषयांतर्गत संदर्भित पत्र के माध्यम से ग्राम हरई गुजरान, तहसील मऊगंज, जिला रीवा (म.प्र.) के खसरा क्रमांक 2/1 पी. (वन भूमि) रकबा 4.590 हे0 क्षेत्र पर खनिज पत्थर (आंत्रिकी क्रिया से गिहटी निर्माण) उत्खनिपट्टा की खनन योजना आर.क्यू.पी. श्री पुष्पेन्द्र कुमार तिवारी द्वारा मध्यप्रदेश गौण खनिज नियम, 1996 के नियम-42 के अंतर्गत अनुमोदन हेतु प्रस्तुत की गई है।

प्रस्तुत खनन योजना मध्यप्रदेश गौण खनिज नियम, 1996 के नियम 42 (सी) के अधीन प्रदत्त अधिकारों के अंतर्गत अवधि अनुबंध निष्पादन दिनांक से 05 वर्ष (2022-2023 से 2026-2027) तक के लिये अनुमोदित की जाती है।

यह खनन योजना अनुमोदन निम्नलिखित शर्तों के अधीन होगा :-

1. आवेदक को वन संरक्षण अधिनियम 1980 के तहत व्यपवर्तन की कार्यवाही करनी होगी।
2. खनन योजना का अनुमोदन केन्द्र सरकार, राज्य सरकार अथवा अन्य किसी प्राधिकारी द्वारा समय-समय पर लागू किये गये कानूनों पर किसी प्रकार का प्रतिकूल प्रभाव डाले बिना किया गया है।
3. इस खनन योजना का अनुमोदन किसी भी न्यायालय के सक्षम क्षेत्राधिकार के किसी अन्य आदेश या निर्देश पर प्रभाव डाले बिना किया गया है।
4. खान अधिनियम 1952 और उसके अधीन बनाये गये नियमों/उपबंधों का पट्टेदार द्वारा पालन किया जावेगा।
5. किसी भी स्तर पर यदि यह देखा गया कि खनन योजना में दी गई जानकारी गलत या गलत तरीके से तथ्यों को प्रस्तुत किया गया है, तो इस खनन योजना का अनुमोदन तत्काल प्रभाव से रद्द कर दिया जावेगा।
6. म.प्र. राज्य सरकार के आदेश दिनांक 10.08.2011 अनुसार अनुमोदित खनन योजना में यदि प्रस्तावित उत्पादन में वृद्धि होती है तो ऐसी परिस्थितियों में उत्पादन की बढ़ी हुई

मात्रा के लिये पट्टेदार द्वारा अतिरिक्त स्टाम्प शुल्क का भुगतान किया जायेगा एवं पट्टेदार द्वारा एक पूरक अनुबंध निष्पादित किया जायेगा।

7. पट्टेदार को निर्देशित किया जाता है कि एक साल की अवधि के अंदर स्वीकृति क्षेत्र का डी.जी.पी.एस. सर्वे करायेगें।
8. उपरोक्तानुसार शर्तों के अलावा आवेदक/पट्टेदार द्वारा म.प्र. गौण खनिज नियम 1996 के समस्त प्रावधानों का पालन करना अनिवार्य होगा।
9. यदि यह अनुमोदन किसी अन्य कानून या अदालत के आदेश/निर्देश से प्रतिकूल होता है तो यह अनुमोदन तत्काल प्रभाव से स्वतः निरस्त माना जावेगा।
10. इस खनन योजना के अवधि समाप्त होने के 120 दिवस पूर्व खनन स्कीम प्रस्तुत की जावे, यदि इस अवधि में स्कीम प्रस्तुत नहीं की जाती है तब म.प्र. गौण खनिज नियम 1996 के नियम 30(27) के तहत दण्डनीय होगा।

संलग्न :- खनन योजना एक प्रति।

पृ. क्रमांक 104-/मा.प्ला./न.क्र./2021

प्रतिलिपि :-

✓ कलेक्टर, (खनिज शाखा) जिला सीवा (म.प्र.) की ओर खनन योजना की एक प्रति संलग्न कर आवश्यक कार्यवाही हेतु प्रेषित।

क्षेत्रीय प्रमुख

संचालनालय भौमिकी तथा खनिकर्म

क्षेत्रीय कार्यालय सीवा, मध्यप्रदेश

सीवा, दिनांक 25/01/2022

क्षेत्रीय प्रमुख

संचालनालय भौमिकी तथा खनिकर्म

क्षेत्रीय कार्यालय सीवा, मध्यप्रदेश

इस योजना में नोटर से अधिक गहराई पर खनन करने वाली की दशा में म.प्र. गौण खनिज अधिनियम 1957 के विभाग 30 (24) धारा 26 के तहत प्रमाणित करने के लिए DGMSP धारा 24, IBM गणपुर तथा सम्बन्धित जिले के कलेक्टर एवं खनिज अधिकारी को लिखित अंशकाल सुनिश्चित किया जाना अनिवार्य है।

Reg.No.....1307  
Date...23/12/2021  
Govt. of M.P. Directorate of Geology & Mining Regional Office Rewa

# MINING PLAN & PROGRESSIVE MINE CLOSURE PLAN FOR HARRAI GUJRAN STONE QUARRY LEASE

(FOR MAKING GITTI THROUGH STONE CRUSHER)

VILLAGE – HARRAI GUJRAN, TEHSIL – MAUGANJ  
DISTRICT - REWA (M.P.)

KHASARA NO. 2/1 (P) AREA: 4.590 Ha. (Govt. Forest Land)

(Forest Comp. No. : P-334 Beat - Kaduawan, Range – Mauganj, Rewa Division)

LEASE PERIOD : 10 YEAR (From date of Agreement)

(PERIOD OF MINING PLAN 05 YEAR)

Prepared Under Rule Sub- Section 42(C) of Madhya Pradesh  
Miner Mineral Rule 1996, Amendment Rule, 2013



December, 2021

P.K.T.  
Pushpendra Kumar Tiwari  
RQP/DGMMP/30/2013

## APPLICANT

SWAMI NITYANANDJI MAHARAJ STONES  
PROP. SHRI LALIT PANGHAL

R/o House no. 975/76, Sector 13, Hudda Bhiwani  
District Bhiwani, Haryana

Regional Head  
Directorate of Geology & Mining  
Regional Office Rewa (M.P.)

PREPARED BY

PUSHPENDRA KUMAR TIWARI  
Reg.: RQP/DGMMP/30/2013  
Mob. : 9424933558



**MINING PLAN FOR HARRAI GUJRAN (QUARRY LEASE)**

MP ID : 34517  
MP SUBMISSION DATE : 07/12/2021  
SUBMITTED AT : Rewa  
VILLAGE : HARRAI GUJARAAN 1044  
DISTRICT : REWA  
TEHSIL : MAUGNJ  
MINERAL : Gitti  
KHASRA NO : 2/1 (P)  
AREA : 4.5900 HECTARE

**PROPOSED PRODUCTION:**

**PROPOSED MINERAL PRODUCTION DETAILS..**

YEAR	FIN. YEAR	PROD. QTY.	UNIT
YEAR-1	2022-2023	83653	CUBIC METER
YEAR-2	2023-2024	83653	CUBIC METER
YEAR-3	2024-2025	83653	CUBIC METER
YEAR-4	2025-2026	83653	CUBIC METER
YEAR-5	2026-2027	83653	CUBIC METER
TOTAL PRODUCTION		418265 CUBIC METER	

STATE : M.P  
LEASE PERIOD : 10 Year  
SANCTION ORDER NO. : 5937/KHANIJ/2021, REWA  
SANCTION ORDER DATE : 11/10/2021

**SUBMITTED UNDER RULES 42 OF MPMMR,1996 FOR APPROVAL OF QUARRY LEASE**

**LESSEE:**

NAME: SWAMI NITYANANDJI MAHARAJ STONES  
FATHER NAME: PROP. SHRI LALIT PANGHAL  
ADDRESS: HOUSE NO. 975/76, SECTOR 13, HUDDA BHIWANI, DISTRICT BHIWANI, HARYANA  
DISTRICT: REWA

**PREPARED BY:**

RQP NAME : PUSHPENDRA TIWARI  
RQP ADDRESS : GRAM & POST LOHI, TEHSIL HUJUR, DISTRICT REWA, MP  
RQP REGISTRATION : RQP/DGMMP/30/2013  
VALID UP TO : 09/05/2023  
MOBILE NO : 9424933558



## **CONTENT'S**

<b>Chapters</b>	<b>Description</b>	<b>Page No.</b>
<b>1</b>	General	<b>1-2</b>
<b>2</b>	Location and Accessibility	<b>3-5</b>
<b>3</b>	Geology and Reserves	<b>6-11</b>
<b>4</b>	Mining	<b>12-17</b>
<b>5</b>	Mine Drainage	<b>18</b>
<b>6</b>	Stacking of mineral reject and disposal of waste	<b>19</b>
<b>7</b>	Provision for separate stacking of surface soil excavated from mining operation and its utility	<b>20-21</b>
<b>8</b>	Use of mineral	<b>22</b>
<b>9</b>	Others	<b>23</b>
<b>10</b>	Mineral processing/beneficiation	<b>24</b>
<b>11</b>	Any other matter which is directed to include in mining plan	<b>25</b>
<b>12</b>	Environment management plan	<b>26-32</b>
<b>13</b>	Progressive mine closure plan	<b>33-41</b>
	Consent from the applicant	<b>42</b>
	Undertaking	<b>43</b>

### **LIST OF ANNEXURE**

<b>Annexure</b>	<b>Description</b>
<b>I</b>	Reference No. and Consent letter from State Govt.
<b>II</b>	Copy of Revenue Map
<b>III</b>	Copy of Khasra
<b>IV</b>	RQP Certificate

### **LIST OF PLATE (MAP)**

<b>S.No.</b>	<b>Description</b>
<b>1</b>	Map showing QL Area in DRM of Rewa District
<b>2</b>	Location Map
<b>3</b>	Geological Plan and Section
<b>4</b>	Conceptual Plan and Section
<b>5</b>	Five year working
<b>6</b>	Land use map
<b>7</b>	Environmental Management Plan
<b>8</b>	Progressive Mine Closer Plan

*P. K. Tiwari*  
District Mineral Officer  
WB/01/2012/30/2013

## **CHAPTER -1**

### **1.0 GENERAL**

i	<b>Name of Applicant</b>	Swami Nityanandji Maharaj Stones
ii	<b>Address</b>	Prop. Shri Lalit Panghal, R/o House no. 975/76, Sector 13, Hudda, Bhiwani, District Bhiwani, Hariyana
iii	<b>Phone</b>	8307520901
iv	<b>Status of Applicant</b>	Proprietorship Firm
v	<b>Mineral(s), which occurring in the area and which the applicant intends to mine</b>	Sand stone (quartzitic nature)
vi	<b>Proposed Quarry Lease Period</b>	10 Year (from agreement)
vii	<b>Mining Plan Period</b>	5 Year
viii	<b>Category of Mine</b>	B

### **1.1 NAME OF RQP PREPARING MINING PLAN**

i	<b>Name</b>	Pushpendra Kumar Tiwari
ii	<b>Address</b>	Village & Post Lohi, Tehsil Huzur District Rewa (M.P.)
iii	<b>Phone</b>	09424933558
v	<b>E.mail</b>	geopushpendra@rediffmail.com
vi	<b>Registration No.</b>	RQP/DGMMP/30/2013

**Regional Head**  
D'tate of Geology & Mining  
Regional Office, Rewa (M.P.)

**1.2 DETAILS OF EXPLORATION ALREADY CARRIED OUT IF ANY :** No exploration was previously carried out.

**1.3 REFERENCE NO. AND DATE OF CONCENT LETTER FROM THE STATE GOVERNMENT:-** The proposed quarry lease area is a protected Forest and thus attracts the Provisions of Forest Conservation Act, 1980. Applicant should be applying for diversion of forest land under FCA Act 1980, after approval of mining plan. The Collector (Mining branch) Rewa, sanctioned in principal quarry lease vide its letter No 5937/khanij/2021,

PREPARED BY: PUSHPENDRA KUMAR TIWARI, RQP /DGMMP/30/2013

1

**P.K. Tiwari**  
Pushpendra Kumar Tiwari  
RQP/DGMMP/30/2013

Rewa dated 11.10.2021 (**Annexure I**), addressed to Swami Nityanandji Maharaj Stones.

#### **1.4 STATUS OF STATUTORY CLEARANCE**

S.No.	Statutory Clearance	Present Status
1	Forest Clearance	To be obtained
2	Environment Clearance	EC will be obtained from MoEF and CC
3	Surface Rights	Total area of 4.590 Ha. is forest land and surface rights will be obtained from forest department after forest clearance from MoEF and CC

The area under quarry lease is Forest land and forest clearance will be obtained from MoEF &CC. The conditions imposed by the MoEF &CC and the same will be implemented during the span of mining plan period.

  
**Regional Head**  
**D'tate of Geology & Mining**  
**Regional Office, Rewa (M.P.)**

  
**Pushpendra Kumar Tiwari**  
**RQP/DGMMP/30/2013**



## **CHAPTER -2**

### **2.0 LOCATION AND ACCESSIBILITY:**

**2.1.1 BY ROAD:-**Area is located at East direction of Rewa city (District H.Q.) 85 km and about 20 km South of Mauganj tehsil. The accessibility of the area is by well Metal road connected from Rewa to Harrai gujran via Mauganj. The approachability is by means of regular Bus/Private Taxis which is easily available up to Harrai gujran.

### **2.1.2 BY TRAIN**

The applied area can't be accessed; nearly station is Rewa is about 85 km from the applied area.

### **2.2 Name and distances of major town and utility**

The details of major town and other details are given below:

TOWN	DISTANCE	DIRECTION	UTILITY
Rewa	85 KM	West	District Head Quarter of Rewa District. . In this place all facilities like Education, Transportation, and Hospitals etc. are available

### **2.3 Climate:**

The area witnesses the subtropical climate with a averaging rainfall of 900-1000 mm annually. The variation in temperature is 40<sup>0</sup> to 46<sup>0</sup> c during summer and winter 4<sup>0</sup>C respectively. The wind generally blows in northeast direction. From November to February the area experiences pleasant winter. March is start of summer, which continues up to June. The monsoon sets in by June and retreats by September. Relative humidity varies to averages between 20% to 75%.

Propose prospecting operations are of small scale and will not cause adverse effect on environment of the area. Standard norms will be adopted for protection of environment.

Regional Head  
Dyate of Geology & Mining  
Regional Office, Rewa (M.P.)

## 2.4 Physiography

The area under quarry lease is of 4.590 Ha is new quarry lease case which is granted by the State Govt. Topographically point of view it's a almost undulating topography. The quarry lease has highest elevation of 338 m & lowest one is 332 MRL , thus total elevation difference is of 6 m and slope towards north and West of the area. Overall drainage is towards north and West parts of the area.

## 2.5 Local Resources

### 2.5.1 WATER

One hand pump will be established within the QL area.

### 2.5.2 ELECTRICITY

Electricity facility is available in the Applied area .Nearest electricity facility is available at Harrai gujran Village.

### 2.5.3 MANPOWER

Man power is easily available from the surrounding villages i.e Harrai gujran, Harraha, Kaduawan etc

### 2.5.4 OTHER FACILITIES

Nearest hotels and Restaurants is available in at Mauganj which is North direction from the area.

### 2.5.5 INFRASTRUCTURES

Presently no infrastructures have developed in the applied area. The daily needs facilities are available in Harrai Gujran Villages while the other requirements are easily from Rewa.

## 2.6 DETAILS OF THE AREA

Details of khasra no. and area are given as follows (Annexure 2)

i	<b>District</b>	Rewa
ii	<b>Taluka</b>	Mauganj
iii	<b>Village</b>	Harrai Gujran
iv	<b>Area</b>	4.590 Ha
v	<b>Khasra No.</b>	2/1 (P)
vi	<b>Forest Comp. No.</b>	P -334 (Kaduawan Beat, Mauganj range)
vii	<b>Occupancy</b>	Govt. Forest Land



Regional Head  
Directorate of Geology & Mining  
Regional Office, Rewa (M.P.)



\*Khasra panchsala is enclosed along with khasra map and Forest compartment map.

## 2.6.1 WHETHER AREA IS RECORDED IN FOREST: Yes

### 2.6.1.2 TYPES OF LAND

Forest (specify)	Area (Ha.)	Non Forest (Specify)	Area (Ha.)	Total Ha.
P-334 (Kaduawan Mauganj range of Rewa Division) (open Mixed Jungle)	4.590	Nil	Nil	4.590

**2.6.2 EXISTENCE OF PUBLIC ROAD:** No public Road is passing through the lease area.

**2.6.3 TOPOSHEET NO.:** Area falls in survey of India Topo sheet No.63 H/14

**2.6.4 COORDINATE OF CORNER POINT OF QUARRY LEASE** There are 07 corner points and Lat/Long values of these pillars are given in the sketch enclosed as key plan and surface plan Plate-01 and Plate-03 respectively and also listed in below Table-

Corner Point	Latitude	Longitude
A	24°32'36.367"N	81°48'58.954"E
B	24°32'38.439"N	81°49'2.093"E
C	24°32'32.689"N	81°49'8.957"E
D	24°32'28.766"N	81°49'5.029"E
E	24°32'32.241"N	81°48'58.982"E
F	24°32'33.534"N	81°48'59.700"E
G	24°32'34.937"N	81°48'59.942"E

(Source: DGPS survey report)

**2.6.5 LAND USE PATTERN:** Govt. forest land.

**2.6.6 VALIDITY OF LEASE PERIOD:** The period for the lease will be 10 years from the date of execution as per MPMMR rule 1996.

## **CHAPTER-3**

### **3.0 GEOLOGY AND RESERVES**

#### **3.1.1 TOPOGRAPHY**

The area under quarry lease is of 4.590 Ha is new quarry lease case which is granted by the State Govt. Topographically point of view it's a almost undulating topography. The quarry lease has highest elevation of 338 m & lowest one is 332 MRL , thus total elevation difference is of 6 m and slope towards north and West of the area. Overall drainage is towards north and West parts of the area.

#### **3.1.2 REGIONAL GEOLOGY:**

The regional geological set-up of Rewa district is characterized by the occurrence of early Paleozoic rocks and sediment of Vindhyan basin. The present area of quarry lease constitutes a part of the upper vindhyan system.

The Vindhyan system has been divided in to the lower and upper division of very unequal proportions, but just justified by an unconformity between the two parts, quite apparent at some places and nonresistant at others, and also by a sharp lithological contrast between the lower and upper portions of the system the main division of the Vindhyan are shown in following table-

#### **CLASSIFICATION OF THE VINDHYAN SUPER GROUP**

(Modified after Auden, 1933)

**Table: 3.1**

<u>Super Group</u>	<u>Group</u>	<u>Formation</u>	<u>Thickness</u>
V		Upper Bhander Shale (Calcareous & Siliceous) Sirbu shale	
	Bhander group	Lower Bhander Shale Bhander limestone	1000 m.
I		Ganurgarh shales	



			Upper Rewa Shale	2000 m.
			Jhiri shales	
N	Upper Vindhyan	Rewa group	Lower Rewa Shale	
			Panna shale	
			Upper Kaimur Shale	
D		Kaimur group	Bijaigarh shale	400 m.
			Lower Kaimur Shale	
			H-----U---N---C---O---N---F---O---R---M---I---T---Y-----	
			Rohtas formation:	1300 m.
Y			Suket shale	
			Nimbahera limestone and shale	
			Conglomerate and Shale	
			(Calcareous & Siliceous)	
	Lower		Khenjua formation:	
A	Vindhyan	Semri Group	Gluconitic member	
			Fawn limestone	
			Olive shales	
			Porcellinite Formation;	
N			Porcellinic shales	
			Trappoid beds	
			Pocellinite shales	
			Basal formation:	
			Kajarahat limestone	
			Bleaching shales	
			Basal Quartzite and conglomerate	

  
**Regional Head**  
 Directorate of Geology & Mining  
 Regional Office, Rewa (M.P.)

The principal geological formations of the upper Vindhyan are Kaimur group, Rewa group and Bhandar group, which are described as follows.

#### **Kaimur group:**

The Kaimur are mainly arenaceous formation with inter bedded shale with which are associated carbonaceous shales and band of Siderite (iron-

carbonate) and Pyrite matter. An assemblage of Shale (Calcareous & Siliceous), shales Shalestone and porcellinite overlying the Semri group has been designated as the Kaimur group, being the lowest unit of the upper part of the Vindhyan Supergroup. It has derived its name from the Kaimur range in central India, which divides the valley of Tons with that of the Son. The name was first suggested by (Oldham, 1856) for the lowest "series" of Vindhyan system. Thickness of the Kaimur varies enormously, from a few meter to 400 m. (Pascoe, 1968). The general succession of the Kaimur group as deduced by (Auden, 1933) is given in table- 3.1.

#### **Rewa group:**

The Rewa group comprising a 2000-meter thick succession of red shale and Sand stone beds in separated from the underlying succession of the Kaimur group by a diamond-bearing horizon of conglomerate. The conglomerate bed about 70 cm. In thickness consist of pebbles of vein quartz, jasper and green quartzite in a matrix of sand and clay. Diamond occurs as placer deposit in the form of granules and grains in the matrix.

The Rewa group consists of rather coarse Shale and sandstone showing current bedding. The Rewa succession having less consistent lithological characters compared to the other two groups has been further subdivided in to alternating shale and Shale formation (table-3.1). A Diamond bearing conglomerate horizons again marks the upper limit of the Rewa group. The famous Panna diamond field of India is situated in the country of Rewa rocks. The name was originally coined by (Oldham, 1856) after Rewa district in Madhya Pradesh.

#### **Bhander group:**

As a result of the very flat basin like nature of the main Vindhyan area, the youngest series namely Bhander covers a larger exposed surface than the others, its outcrop include a very large tract from Sauger to beyond Rewa, spreading over a wide extent of country southwest of Agra. A considerable portion of the trap area north of the Narmada series is proved by the occurrence of inliers far away from the boundary of the main outcrop. The succession has been divided in to five formations. The upper Bhander sand



stone having a uniformly fine-grained character, has been the most popular and versatile building stone of northern India. of the lower Bhandar, the Ganurgarh shales at the bottom and the Sirbu shale at the top area of the usual Vindhyan type. The later are frequently aluminous. Raindrop, pitting as well as ripple marking has been observed in these Shales.

REFERENCE [A] Special Publication GSI Vol 28,83

[B] Fundamentals of Historical Geology and Stratigraphy of India, by Ravindra Kumar

### **3.2 Local geology:**

The principal geological formations in the area are sand stone belonging to upper Vindhyan super group. Sand stone quartzitic in nature, which made harder to sand stone. They are black in colour.

Geological Plan & sections are prepared at suitable interval on scale of **1:1000** (Plate no. III)

**THE TOPOGRAPHIC PLAN OF THE APPLIED AREA PREPARED ON SCALE WITH CONTOUR INTERVAL 1M DEPENDING UPON THE TOPOGRAPHY OF THE AREA SHOULD BE TAKEN AS BASE PLAN FOR PREPARATION OF GEOLOGICAL PLAN. THE DETAILS OF EXPLORATION ALREADY CARRIED OUT INCLUDING EVIDENCES OF MINERAL EXISTENCE SHOULD BE SHOWN ON GEOLOGICAL PLAN.**

The scale of surface and surface geological mapping is 1:1000 with contour interval of 1m **(Please refer plate no. III).**

This is new quarry lease Case.

**GEOLOGICAL SECTION:** Prepared on 1:1000 scales (please refer plate no. III)

### **3.3 BROADLY INDICATE THE YEAR WISE FUTURE PROGRAMME OF EXPLORATION TAKING IN TO CONSIDERATION THE FUTURE PROGRAMME PLANNED IN NEXT ONE YEARS**

- (i) Considering the geological occurrence there is no need of exploration
- (ii) Updated transverse section: Please refer plate no. III
- (iii) Updated assay plan: As in the applied area there is no different grade of minerals hence therefore grade plan is not given.

### **3.4 GEOLOGICAL RESERVES & GRADE**

As the area falls in protected forest, hence exploration and geological survey could not be done due to the restriction of forest department under forest Conservation Act. However, the extension of the rock body has been recorded by studying nala sections found in the area. The reserves/resource has been calculated under the Stratiform, form of regular habit.

### 3.5 STRUCTURAL FINDINGS

As per present finding following litho sequence has been established over the Mine area: It is massive body.

Weathered sandstone with siliceous soil 0.5 M

Quartzitic sand stone (gitti) is fine grained, black Color in massive Form of tabular habit.

**3.6 Geological Axis:** In Stratiform deposit.

The area of 4.590 Ha. is geologically proved for stone ( for making gitti)and depth wise influence is taken as per given information that Quartzitic sand stone (gitti) is continued for more than 30 m depth. Keeping the mining UPL about 30 m depth is considered under G1 category

### A] MINERAL ZONE VOLUME IN M<sup>3</sup>

Parameters considered

1. Area: 4.590 Ha.
2. Present thickness of mineralization:30 m
3. Present knowledge: not required
4. Grade: not required (size as per required for road construction )
5. Mineral rejects=05%

### B] GEOLOGICAL RESOURCES IN M<sup>3</sup>

AREA M <sup>2</sup>	THICKNE SS M	VOLUME M <sup>3</sup>	DEPLETED VOLUME OF M <sup>3</sup> (approx)	LEFT VOLUME OF IN M <sup>3</sup>
45900	30	1377000	NIL	1377000

### C] RESERVES UNDER BLOCKED CATEGORY

Parameters considered Unminable portion of lease area due to Barrier zone



Average perimeter along lease boundary for loss in 7.5m (G1) = 180619m<sup>3</sup>  
 Average cross sectional area along slope loss in G-1 zone = 37620M<sup>3</sup>  
 Mineral blocked in approach road: About 980 M<sup>2</sup> area blocked due to approach road and this area also included in sanctioned area.

Area x Mineral thickness x recovery

980x30x95%=27930M<sup>3</sup>

Further there are no any other losses due to legal provisions or cut of grade problem of Strata hence not considered.

MINERAL BLOKED IN BARRIER ZONE M <sup>3</sup>	MINERAL BLOKED IN MAINTING THE SLOPE OF BENCHES-T
AVERAGE PERIMETERX7.5M X MINERAL THICKNESS-M X RECOVERY (95%) 845X7.5X30X 95 % = 180619M <sup>3</sup>	AVERAGE CROSS SECTIONAL AREA IN M <sup>2</sup> X MEAN LENGTH-M X RECOVERY ) 200X 198X95% M <sup>3</sup> = 37620M <sup>3</sup>
218239M <sup>3</sup>	

**D] TOTAL MINERAL UNDER BLOKED CATEGORY IS**

**27930 (approach road)+218239 (barrier zone and bench slope) = 246739M<sup>3</sup>**

**E] RESERVES AVAILABLE FOR MINING:**

AREA M <sup>2</sup>	THICKNESS M	VOLUME M <sup>3</sup>	MINERAL BLOKED IN APPROACH ROAD BENCHES AND BARRIER ZONE IN M <sup>3</sup>	VOLUME OF RECOVERABLE MINERAL IN M <sup>3</sup> (95%)
45900	30	1377000	246169	1074289

At present 1074289m<sup>3</sup> volumes available for mining

**E] LIFE OF MINE:** Average production of 83653 M<sup>3</sup> of stone considered from the mine.

**Life of mine** = total Recoverable reserve / Average Annual Production

**= 1074289/83653**

**= 12.84 Year say 13 Year.**

The life of mine may be change depend upon the rate of production.

## **CHAPTER-4**

### **MINING**

#### **4.1 PROPOSED METHOD OF MINING**

Proposed mining activity will be carried out by the new open cast semi mechanized method of mining using hand tools such as spades, chisel, hammer etc. Stone formation will be loosened by regular drilling and this will be transported from pit bottom to surface by machine and from the loading point of view, Stone is transported by truck/dumper to the Stone crusher.

During the ensuing years the Stone quarrying will be according to the proposed method of semi mechanized way the following machines are proposed to be deployed on hire basis:

#### **4.2 DETAILS OF MACHINERY:-**

Semi Mechanized opencast mining method has been proposed. During development, hydraulic excavators will be used while developing. Tipper trucks will be used for transporting stone and waste. Earth moving machine while developing, Chisel, hammer tasla, rods Sufficient quantity will be used during mining operation. These machine will be used on hire basis as below-

<b>S.No.</b>	<b>Particular</b>	<b>No.</b>
01	Excavator	02
02	Rock Breaker	02
03	Drill Machine	02
04	Hyva	07
05	Water Tanker	01
06	Tractor	01

#### **4.3 YEARWISE PROPSED METHOD OF MINING**

It will be commenced after the agreement and bhu pravesh with EC term and condition and the mining method will be the same as proposed with one production benches of 6.0m height while thin layer of OB will be scrapped ahead of working in stone formation and this thin layer of OB is considered under waste and this waste is saleable or it will be used for

making and maintenance of approach road.

#### YEARWISE PRODUCTION FOR THE FIRST FIVE YEAR

Year	Location	Average RL in (M)	No. of Bench	Area Excavated in (M <sup>2</sup> )	Bench Height (M)	Total Vol. of Mineral in M <sup>3</sup>	Volume in M <sup>3</sup> (95%)
1 <sup>st</sup> Year	AS SHOWN ON PLAN	335-329	Ist	14676	6	88056	83653
TOTAL							83653
2 <sup>nd</sup> Year	AS SHOWN ON PLAN	335-329	Ist	14676	6	88056	83653
TOTAL							83653
3 <sup>rd</sup> Year	AS SHOWN ON PLAN	335-329	Ist	9229	6	55374	52605
		329-323	IIInd	5447	6	32682	31048
TOTAL							83653
4 <sup>th</sup> Year	AS SHOWN ON PLAN	329-323	IIInd	14676	6	88056	83653
TOTAL							83653
5 <sup>th</sup> Year	AS SHOWN ON PLAN	329-323	IIInd	14676	6	88056	83653
TOTAL							83653
GRANT TOTAL							418265 M3

Note: Production is taken from massive formation and after loosening the formation it is subjected to swelling factor by 10-25%.

#### 4.4 YEAR WISE TOTAL PRODUCTION

YEAR	PRODUCTION M <sup>3</sup>
<b>FIRST YEAR</b>	<b>83653</b>
<b>SECOND YEAR</b>	<b>83653</b>
<b>THIRD YEAR</b>	<b>83653</b>
<b>FORTH YEAR</b>	<b>83653</b>
<b>FIFTH YEAR</b>	<b>83653</b>
<b>TOTAL</b>	<b>418265 M3</b>

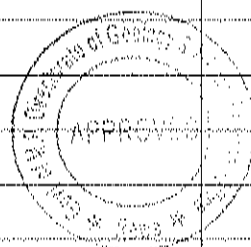

*[Signature]*  
Regional Head  
Directorate of Geology & Mining  
Regional Office Rewa (M.P.)



Note: Production are taken from massive formation and after loosening the formation it is subjected to swelling factor by 10-25%.

#### 4.5 PROPOSED RATE OF PRODUCTION WHEN THE MINE IS FULLY DEVELOPED

The average production will be 83653M<sup>3</sup> (per year) or 334.61 M3 per day were working day calculated 250 days in a year

#### 4.6 YEARWISE SCHEME OF PRODUCTION FOR SECOND FIVE YEAR:-

YEAR	PRODUCTION M <sup>3</sup>
FIRST YEAR	83653
SECOND YEAR	83653
THIRD YEAR	83653
FORTH YEAR	83653
FIFTH YEAR	83653
TOTAL	418265 M3

#### 4.7 CONCEPTUAL MINING PLAN FOR ENTIRE LEASE PERIOD/CONCEPTUAL PERIOD BASED ON THE GEOLOGICAL MINING AND ENVIRONMENTAL CONSIDERATIONS

##### i) CONCEPTUAL EXPLORATION

No exploration proposed.

##### ii) CONCEPTUAL LIFE OF QUARRY LEASE AFTER THIS PLAN PERIOD

Proposed Mining will be Open Cast Semi-mechanised means confined within the ultimate pit limit 30 m. The Life of Mine after this plan period will about 8 years because of deposit were left about 656024M3.

##### iii) CONCEPTUAL TOP SOIL DUMP MANAGEMENT

There is negligible amount of top soil within the applied area. It will use for afforestation purposes.

##### iv) CONCEPTUAL RECLAMATION AND REHABILITATION:

In the conceptual period area will be developed up to 305MRL.

Present reclamation and rehabilitation is not required.

  
**Regional Head**  
 D'tate of Geology & Mining  
 Regional Office, Rewa (M.P.)



- a) About 3.858 Ha. area will be "mined out" at the end of five year.
- b) No area will come under reclamation and rehabilitation by the end of proposal period,
- c) Total mined area about 3.858 Ha at the end of five year period up to 323 MRL.
- d) About 3.858 Ha. Area will be rehabilitated by water reservoir.
- e) The mined out area will be wire fenced with gate and proper haulage road will be provided.

**4.8 BACK FILLING:** No Backfilling proposed for this plan period and conceptual period as per FCA-1980.

#### **4.9 DEPTH OF MINING PROPOSED DURING PLAN PERIOD**

During plan period 12 meters depth is proposed. After the depth of 6 meter from surface, lessee will take permission from DGMS and inform to govt. authority as per rules.

#### **4.10 LAYOUT OF MINE WORKINGS FOR FACES AND SITES FOR DISPOSAL OF OVERBURDEN/ WASTE**

During the five year period area within UPL ,will be developed and proposed benches will be developed as per shown in five year plan, bench height will be average 6 m each and the during the period pit bottom RL will reach from 335 MRL to 323MRL . The proposal is given for systematic development with proper bench height.

There is no overburden anticipated during the quarrying operation. The excavated weathered stone will be directly loaded into tipper to the needy crusher/other buyers for road project and construction works for filling leveling of low lying areas. It will be also used for maintenance of approach road for mine site and village road.

**4.11 STRIPPING RATIO:-** In surface mining, stripping ratio or strip ratio refers to the amount of waste or overburden that must be removed to release a given ore quantity. It is a number or ratio that express how much waste is mined per unit of ore. The units of a stripping ratio can vary

Regional Head  
Directorate of Geology & Mining  
Regional Office, Rewa (M.P.)

P.K. Tiwari  
Pushpendra Kumar Tiwari  
RQP/DGMMP/30/2013

between mine types. This is case of stone and there is only weathered stone (quartzitic sandstone) in very negligible quantity which may be salable so stripping ratio not considered here.

**4.12 ULTIMATE PIT LIMIT :** In this quarry lease about 4.590 ha area is mineralized. Considering the current data and geology, pit layout is designed. The mining will be carried out in this plan period and in the conceptual stage up to 30 meter.

**4.13 BLASTING:** This granted area is a quarry Lease of sand stone blasting is required, therefore lessee will take all necessary permission and do accordingly DGMS norms.

**4.14 DRILLING:** Drilling of the blast holes is proposed by the compressed air operated jack hammer or Wagon Drill, height of the bench is proposed to be kept 6m. The specification of jack hammer or Wagon drill is as follow

**a) DRILL PATTERN OF JACK HAMMER IS AS FOLLOW**

Type	Make	No.	Dia Of Hole	Drilling Rod	Capacity	HP
Tractor compressor, or Jack Hammer	Atlas Copco	01 01	32mm	1500mm	110CFM	50

**b) Specification of jack hammer is unit:**

Type	Power	No.	Dia Of Hole	Drilling Rod	Capacity	HP
Jack compressor, Compressor	Pneumatic Portable Diesel	02 01	32 to 40mm 300CFM	800x40 1500x34mm 1500mm	210CFM	50

Regional Head  
State of Geology & Mining  
Regional Office, Rewa (M.P.)

**4.15 TYPE OF EXPLOSIVE TO BE USED/ TO BE USED:** Slurry explosive frequency of blasting will be once or two in a week. Delay detonators will be used.

**4.16 STORAGE OF EXPLOSIVE:** The applicant will engage an authorized explosive agency to carry out the small amount of blasting and it will be supervised by competent and statutory foreman/ mines manager. The



storage of explosive not proposed, Blasting should be done by only Govt. authorized agency after permission taken by authority.

**4.17 PRECAUTION TO BE TAKEN DURING THE DRILLING AND**

**BLASTING:** sufficient warning by signal is given in the entire area falling with danger zone, wet drilling will be used for blasting hole, control blasting will be done. Lessee will take all necessary permission and do accordingly DGMS norms. First Aid Box will be keeping ready at all the time. Necessary precautionary announcement will be carried out before the blasting operation.

**4.18 TRANSPORTATION :-** 07 trucks/Hywa of 10 m3 capacity are quite sufficient for transportation of mined out Stone (gitti).

**4.13 GREEN BELT -** The green belt will be developed in lease area and other places depending on availability of land by planting local species fruit plants.

  
Regional Head  
State of Geology & Mining  
Regional Office, Rewa (M.P.)

  
Pushpendra Kumar Tiwari  
RQP/DGMMP/30/2013



## **CHAPTER- 5**

### **5.0MINE DRAINAGE**

#### **a) LIKELY DEPTH OF WATER TABLE BASED ON OBSERVATION FROM NEAR BY WELL AND WATER BODIES.**

The groundwater resource is available in the form of Hand pump/ dug well near the applied area and as per given information presently ground water table 50-60m BGL and the proposal are given quite above to GWT but in rainy season accumulated water has to dewatered. Further the applied area is in vicinity of naturally water logged area and one pond in eastern direction. The average water retention during the rainy season is 2-6M and these water logged area has been protected by bund.

#### **b) WORKING EXPECTED TO BE ABOVE/REACH BELOW WATER TABLE BY WHICH YEAR:**

Ensuing five year period proposals are given up to 323 MRL which is about 20m above the ground water table. Further the proposals are given only for 12 m depth hence there will be no impact to adjacent and nearby water logged areas.

#### **c) QUANTITY AND QUALITY OF WATER LIKELY TO BE ENCOUNTERED, PUMPING ARRANGEMENTS AND PLACES WHERE MINE WATER IS FINALLY PROPOSED TO BE DISCHARGED.**

During the rainy season rain water and seepage water will accumulate in the working work and this accumulated water will be discharged with the help of a 5 H.P. pump having capacity to lift 22,000 lit/hour with maximum head of 12-15 m. The pumped out water will be drained to the agriculture land on in Nallah as per the situation.

Regional Head  
D'tate of Geology & Mining  
Regional Office, Rewa (M.P.)

P.K. Tiwari  
Pushpendra Kumar Tiwari  
RQP/DGMMP/30/2013

## **CHAPTER -6**

### **STACKING OF MINERAL REJECT AND DISPOSAL OF WASTE**

#### **a) RATE OF YEARLY GENERATION OF WASTE AND PROPOSALS FOR DISPOSAL OF WASTE NEXT FIVE YEAR:**

This is New Case there is no any waste dumps within the applied area. The voids will be around 5% in Quartzites zone. Most of the OB and waste will be utilized for maintenance of approach road to mine site. During the five year plantation will be done in barrier zone of the lease area. During the first five year separate lavatory for male and female will be constructed in east barrier zone area. Advance of benches will not be less then height of benches.

#### **b) YEAR WISE GENERATION**

<b>YEAR</b>	<b>LATERITIC SOIL IN M3</b>	<b>OB WASTE IN M3</b>	<b>INTERCALATED WASTE IN M3</b>
1 <sup>st</sup> Year	NIL	7338	NIL
2 <sup>nd</sup> Year	NIL	7338	NIL
3 <sup>rd</sup> Year	NIL	4615	NIL
4 <sup>th</sup> Year	NIL	NIL	NIL
5 <sup>th</sup> Year	NIL	NIL	NIL
<b>TOTAL WASTE</b>	<b>NIL</b>	<b>19291 M3</b>	<b>NIL</b>

#### **c) LAND CHOSEN FOR DISPOSAL OF WASTE WITH PROPOSED JUSTIFICATION**

Not applicable

Regional Head  
D'tate of Geology & Mining  
Regional Office, Rewa (M.P.)

#### **d) MANNER OF DISPOSAL OF AND CONFIGURATION, SEQUENCE OF BUILD OF DUMPS ALONG WITH THE PROPOSAL FOR THE STACKING OF SUB GRADE MINERAL, TO BE INDICATED YEARWISE**

There is no overburden anticipated during the quarrying operation. The excavated weathered stone will be directly loaded into tipper to the needy crusher/other buyers for road project and construction works for filling leveling of low lying areas.

#### **e) PRECAUTION FOR CONFINEMENT OF DUMPS TO PREVENT POLLUTION OF SURFACE WATER BODIES /COURSES**

Not applicable

P.K.T.  
Pushpendra Kumar Tiwari  
RQP/DGMMP/30/2013



## **CHAPTER -7**

### **7.0 PROVISION FOR SEPARATE STACKING OF SURFACE SOIL EXCAVATED FROM MINING OPERATION AND ITS UTILITY**

This is quarry lease case for Stone quarry, keeping the negligible OB consideration OB/lateritic soil is likely to be generated.

#### **a) LAND CHOSEN FOR DISPOSAL OF WASTE WITH PROPOSED JUSTIFICATION**

The waste dump of Stone proposed to preparation of approach road to mine site.

#### **b) MANNER OF DISPOSAL OF AND CONFIGURATION, SEQUENCE OF BUILD OF DUMPS ALONG WITH THE PROPOSAL FOR THE STACKING OF SUB GRADE MINERAL, TO BE INDICATED YEARWISE**

##### **c) YEAR WISE GENERATION**

<b>YEAR</b>	<b>LATERITIC SOIL</b>	<b>OB WASTE</b>	<b>Mineral WASTE</b>	<b>LOCATION FOR DISPOSAL OF WASTE</b>
1 <sup>st</sup> Year	NIL	7338	4403	used for maintenance of approach road for mine site
2 <sup>nd</sup> Year	NIL	7338	4403	
3 <sup>rd</sup> Year	NIL	4615	4403	
4 <sup>th</sup> Year	NIL	NIL	4403	
5 <sup>th</sup> Year	NIL	NIL	4403	
TOTAL WASTE	NIL	19291 M3	22015M3	

#### **d) LAND CHOSEN FOR DISPOSAL OF WASTE WITH PROPOSED JUSTIFICATION**

It will be used for maintenance of approach road for mine site.

#### **e) MANNER OF DISPOSAL OF AND CONFIGURATION, SEQUENCE OF BUILD OF DUMPS ALONG WITH THE PROPOSAL FOR THE STACKING OF SUB GRADE MINERAL, TO BE INDICATED YEARWISE**

The overburden consists of Lateritic soil which is soft and friable and can easily be removed mechanically. It is 0.3 to 0.7 meter in thickness. During



the proposed five year mining OB will be generated which will be utilized for maintenance of approach road.

**f) PRECAUTION FOR CONFINEMENT OF DUMPS TO PREVENT POLLUTION OF SURFACE WATER BODIES /COURSES**

The overburden and mine waste will be loaded in to the tippers and unloaded mechanically by tippers. Mostly overburden and waste will be utilized for maintenance of approach road to mine site. The reject stone in form of lumps will be utilised as building material. There is no toxic constituent in lateritic soil and weathered intercalated so no adverse effect on surface water body. Surface water free from any toxic substances

**g) PRECAUTION FOR CONFINEMENT OF DUMPS TO PREVENT POLLUTION OF SURFACE WATER BODIES /COURSES**

The surface water in the form of seasonal rainfalls is the only source of water in the area. There is no manufacturing unit or beneficiation plant in the area so for and hence no surface water quality will be disturbed in this area.

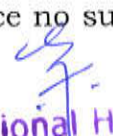
  
Regional Head  
D'tate of Geology & Mining  
Regional Office, Rewa (M.P.)

  
Pushpendra Kumar Tiwari  
RQP/DGMMP/30/2013

## CHAPTER -8

### **USE OF MINERAL**

#### **81 CHANGES PROPOSED IN THE USE OF MINERALS, IF ANY**

Lessee acquired this lease as to have captive quarry for the plant. Mineral will be used for road material and cement aggregate.

#### **8.2 CHANGE IN THE SPECIFICATION, IF ANY, IMPOSED BY THE USER INDUSTRIES AND/ OR SPECIFICATION REQUIRED IN CASE OF NEW USER INDUSTRIES, IF ANY TO BE GIVEN.**

No changes in specifications are imposed by user industry.

  
**Regional Head**  
**Director of Geology & Mining**  
**Regional Office, Rewa (M.P.)**

  
**Pushpendra Kumar Tiwari**  
**RQP/DGMMP/30/2013**

## **CHAPTER -9**

### **OTHERES**

#### **(a)SITE SERVICES**

Site services for staff/Labours.

Mines Office With First Aid Facility	Tool Room	Shelter Room for Male	Shelter Room for Female	Lavoratory	
				Male	Female
28M <sup>2</sup>	18M <sup>2</sup>	21M <sup>2</sup>	21M <sup>2</sup>	6 M <sup>2</sup>	6 M <sup>2</sup>

#### **(b)EMPLOYMENT POTENTIAL**

1	Skilled	Supervisory staff	1
		Permit Manager/First Aid In charge	1
		Operator/ Mechanic	2
		Mines Manager/Mat	1
2	Semiskilled	Driver	2
		Mali/watchman/pump operator	1
3	Unskilled	Labour	11

#### **(c) WELFARE MEASURES**

First Aid Facility	First aid kits are kept in Mines office room, in case of such eventualities the victim will be given first aid immediately at the site and injured person will be taken to the hospital. Hospital is available at distance of 20Km (N) in Mauganj the competent and Statutory foreman/ permit manager will be in charge of first aid.
Labour Health	As per Mines Rule, Periodic medical examination related to occupational health safety will be conducted to all the workers in applicants own cost.
Precautionary safety measures to the Laborers	Safety provisions like helmet, goggles, safety shoes, Dust mask, Ear muffs etc have to be provided as per the circulars and amendments made for Mine labours under the guidance of DGMS being a semi mechanized operation.



## **CHAPTER -10**

### **MINERAL PROCESSING/BENEFICIATION**

Mineral processing of ROM Mineral that is mechanical, dressing, sizing & sorting etc. will be done at mine site or at crusher.

  
**Regional Head**  
Deptt. of Geology & Mining  
Regional Office, Rewa (M.P.)

  
Pushpendra Kumar Tiwari  
RQP/DGMMP/30/2013

## CHAPTER - 11

### **11.0 ANY OTHER MATTER WHICH IS DIRECTED TO INCLUDE IN MINING PLAN**

To comply the required particulars of Rules Regulation of MMR 1996 as per amendment made in Gazette notification dated 23<sup>rd</sup> March 2013.

### **11.1 RESULTS OF ANY INVESTIGATION CARRIED OUT FOR SCIENTIFIC MINING CONSERVATION OF MINERALS AND PROTECTION OF ENVIRONMENT, FUTURE PROPOSAL IF ANY.**

1) The operation in the area yet to started and the mine production has not reached to its rated capacity so no such investigation is done so far.

2) For protection of dust while blasting and loading trucks, the care will be taken by spraying water on roads and working pits

*P.K. Tiwari*  
Pushpendra Kumar Tiwari  
RQP/DGMMP/30/2013

*Regional Head*  
Director of Geology & Mining  
Regional Office, Rewa (M.P.)

## **CHAPTER -12**

### **ENVIRONMENT MANAGMENT PLAN**

#### **12.1 BASE LINE INFORMATION**

The base line information provides the data for prediction and evaluation of impacts of mining on biophysical and socio - economic environment .Relevant information for base line study and assessments are –

A	Type of land/ Khasra No	Govt. forest land/ 2/1 (P)
B	Latitude	24°32'28.67"N to 24°32'39.91"N
C	Longitude	81°49'0.15"E to 81°49'9.10"E
D	Toposheet No.	63H/14
E	Village	Harrai gujran
F	Post Office	Harrai gujran
G	Tehsil	Mauganj
H	District	Rewa
I	State	Madhya Pradesh
J	Police Station	Mauganj
K	Hospital	Mauganj
L	School	Harrai gujran
M	Rest house	Mauganj
N	Airport	Jabalpur
O	Elictricity	Harrai gujran
P	Bazar Place	Harrai gujran
Q	Total area applied for Quarry lease	4.590 Ha.
R	General Topography	Undulated
S	Human settlement	Nil
T	Dam/pond/lake	Nil
U	Forest	QL area is forest land
V	National park / Monuments	Nil
W	National Highway/state Highway	Nil

**Regional Head**  
D'tate of Geology & Mining  
Regional Office, Rewa (M.P.)

#### **12.2 LAND USE PATTERN:**



The total land under quarry lease is around 4.590 Ha . which a part of Govt forest land of Kaduawan beet of Mauganj range of Rewa division . Presently the area comes under forest land for which the applicant will be apply for diversion of land under FCA 1980.

#### **12.2.1 Landscape and Land Subsidence:**

Topographically the area has part of undulating topography and as per information G1 has taken 30m thickness or up to and in ensuing five year and conceptual period average 6M thick area will be developed by one bench of 6M height

#### **12.3 CLIMATIC CONDITION:-**

The area proposed/under for quarry lease is characterized by sub tropical climate. The day temperature during summer rises as high as 46<sup>o</sup> C, but winter area generally pleasant with minimum temperature going down to 4<sup>o</sup> C in chilly winter days. The annual rainfall is 1000 mm average rainy days vary from 60 to 80 days during monsoon period.

#### **12.4 WATER REGIME**

From opening of quarry lease to conceptual period the proposal is given above GWT hence there will be no impact on GWT. The area is free from any water course the surface water in the area is mainly naturally precipitated water, which flows over the area for very short span of time during rains only. Ground Water condition in the nearby area seems to be good as observed in the adjoining village.

#### **12.5 FLORA AND FAUNA -**

Regionally the area falls under subtropical climatic zone and sustaining dry tropical land. The land under quarry lease is a protected forest land. The local neem, palas, tendu and babul and sagoun are common plants in the QL area. Species of common birds like crow, sparrow, and pigeon are rarely seen.

#### **12.6 HUMAN SETTLEMENT**

There is no human settlement in the proposed area. There is only one villages namely, Harrai gujran falls near 1 km from the area.

#### **12.7 PUBLIC BUILDING, WORSHIP PLACES AND MONUMENTS**

  
**Regional Head**  
D'tate of Geology & Mining  
Regional Office, Rewa (M.P.)

There are no such objectionable features in the area.

## **12.8 QUALITY OF AIR AND WATER**

At present the area is free from any industrial pollution i.e. there is no source of water as well as air pollution in the area. The area forms a good ground water condition. Water from all sources is portable and is free from any hazardous elements.

**12.8.1 AMBIENT AIR QUALITY:** The area does not have any industrial activity in the core/ buffer zone and hence the ambient air quality good for habitants.

**12.8.2 AMBIENT NOISE LEVEL:** The area does not have any industrial activity in the core/ buffer zone and hence the ambient noise quality good for habitants.

**12.8.3 AMBIENT WATER QUALITY:** Quality of water is potable .The Groundwater of this area is free from pollution and is suitable for drinking purpose.

## **12.9 ENVIRONMENTAL IMPACTASSESSMENT STATEMENT**

### **1. Relevant information for evaluation of Impact of mining on environment:-**

**A) HEALTH AND HYGIENE:** - in general the health of villagers in moderately good.

**B) OCCUPATION :-** Main occupation of the villagers is agriculture. Also works as Laborers in farms.

**C) EDUCATION :-** Mostly educated up to primary standard.

**D) ECONOMIC CONDITION :-** In general poor , due to lack of other avenues to earn other than agriculture.

### **12.10 INFORMATION ON ENVIRONMENT FEATURE**

#### **a) LAND ENVIRONMENT**

**i) LANDSCAPE :-** The area falls in forest land. There is no major stream or drainage. Also no big escarpments & major geomorphic features. However local vegetation is found grown up in the area.

**ii) AESTHETIC ENVIRONMENT :-** Nothing special about aesthetic environment in the area.

**iii) SOIL AND LAND USE PATTERN:** Forest land.

**iv) AGRICULTURE :-** At present the land is not used for agriculture purpose.

  
Regional head  
D'tate of Geology & Mining  
Regional Office, Rewa (M.P.)



v) **FOREST :-** Presently the area comes under forest land for which the applicant will be apply for diversion of land under FCA 1980.

vi) **VEGETATION :-** As the area falls under protected forest, hence the area has vegetation having mainly Tendu, Bahera and Sagoun (tectona grandis). At present the area under quarry lease possess as well as plants and bushes and big trees.

**b) WATER ENVIRONMENT**

**SURFACE WATER :-** No surface water bodies are available in the area.

i) **GROUND WATER :-** the area having elevated surface and water levels in the area are deeper side and bore wells are the major source of ground water in the area. The Mining operations will be above from water table hence no adverse impact is envisaged.

ii) **WATER QUALITY :-** the water from bore wells and dug wells is hygienic and unpolluted and no adverse effect has been noticed by the villagers in the past. There would be no change in the quality of ground water due to proposed mining activities

**c) AIR ENVIRONMENT** Mining activities are so planed, that there is no possibility of

i) Pollution of air and ground water.

ii) Adverse effect of human settlement.

**NOISE :-**The mining operation will be carried out semi mechanized at remote place hence there is no scope of noise pollution except momentary increase in noise level during drilling and blasting.

**AIR :-**The transportation vehicle, drilling and blasting operation will generate some dust for very short period, this will increase the spm level in the, the spm level will not be more than permissible limit in any case. Sprinkler will be used in haulage road for minimizing dust.

**d) SOCIO-ECONOMIC ENVIRONMENT :-**

**1. SOCIO-ECONOMIC BENEFITS ARISING OUT OF MINING**

There will be positive effect to some extent on socio-economic environment of the area as mining activity will assure job continuity of



  
Regional Head  
Directorate of Geology & Mining  
Regional Office, Rewa (M.P.)



already engaged people also it may cause further job opportunities for additional people, which ultimately will improve the financial status of the local people.

**2) SOCIAL & DEMOGRAPHIC PROFILE :-** Main occupation of the villagers is agriculture. Also work as a laborers in farms. Mostly educated up to primary standard. Economic condition in general is poor due to lack of other avenues to earn other than agriculture.

**3) OCCUPATIONAL HEALTH & SAFETY :-** In general the health of villages is moderately good. The proposed mining activities are too small and semi mechanized. There would not be any pollution to noise, air and water. Moreover chemically no toxic substance is present in the deposit.

**4) HUMAN SETTLEMENT:-** The laborers will be engaged from the nearby village and as such there is no problem to human settlement. It is evident from the above information that the mining operation will not disturb the present environment and the life style of the people. Moreover the mining will help towards development of the area by solving unemployment problem to a certain extent.

**5) RECREATION FACILITY :-** At present there is only local festivals and visit to weekly market place are only source of recreation to the villagers. Mining activities will help to development of the area and by passage of time recreation facilities would also be increased.

**12.11 AFFORESTATION PROGRAMME :-** About 750 Plants are proposed in Mining Plan Period. The area of plantation is marked and shown on plate of EMP. Plantation of wide leaf trees, tall grasses around the quarry pits, on OB dumps and also around the offices, are proposed.

*[Handwritten signature]*  
Regional Head  
State of Geology & Mining  
Regional Office, Rewa (M.P.)

*[Handwritten signature]*  
Pushpendra Kumar Tiwari  
RQP/DGMMP/30/2013

Year	No. Saplings	Survival Rate	No. of Trees	Expnd./ Year	Location
I Year	150	80%	120	75000	Barrier Zone
II Year	150	80%	120	75000	
III Year	150	80%	120	75000	
IV Year	150	80%	120	75000	
V Year	150	80%	120	75000	
<b>Total</b>	<b>750</b>	<b>80%</b>	<b>600</b>	<b>3750000</b>	

### 1. Base for selection of proposed plant species:

Selection of plant species is a **vital component for eco-restoration success**. The choice of plant species depends on the characteristics of soil, climatic conditions and ultimate land use. Grasses are more tolerant to adverse soil pH and moisture stress than legumes, and are, therefore, easier to establish. Pasture grasses and legume can be used for stabilization of spoil dumps. Trees and shrubs will be used where a wind break is desired or where visual shield is required and are also suitable to steep or rocky terrain and coarse waste.

Tree species *Boswellia serrata*, *Diospyros melanoxylon*, *Madhuca latifolia*, *Lagerstroemia parviflora*, *Buchanania lanzan*, *Anogeissus latifolia*, *Lannea coromandelica*, *Semecarpus anacardium*, *Cassia fistula*, *Emblica officinalis*, *Terminalia tomentosa* and *Holarrhena antidysentrica* are already found in the area of Central India forests. It means that edaphic as well as climatic conditions are suitable for the growth of these species. *Azadirachta indica* and *Cassia siamea* are fast growing species and have wider adoptability towards edaphic and climatic conditions.

Being the mega tree *Ficus* species are proposed for plantation. The grass species mentioned are early soil binders and bushes fast growing.

The availability of moisture in the soil, especially during warm dry summer, is important. If water level is not high enough, irrigation will be needed to



provide moisture. As the vegetation matures, the need for the irrigation diminishes, since, grasses get adapted to dry summer conditions.

The species selected for establishment will also depend on the future land use of the area, soil conditions and climate.

**List of plant species recommended for plantation**

S.No.	Local Name	Botanical Name
1	Karanja	Pongamia Pinnata
2	Neem	Azadirachta indica
3	Amaltas	Cassia Fistula
4	Mahua	Madhuca indica
5	Bahera	Terminalia belerica
6	Ficus	Ficus Benjamina

Mango, Neem, Karanj, Subabool, and Golmohar. Sapling will be planted in 30-cm. deep hole covered with soil and manure. Mali will take care of plants for better survival conditions.

**12.12 LAND USE PATTERN** The present land use pattern in the lease area is forest land. The details of the land use at various stages of the mining operations are given in **Table-**

Sr. No.	Details	Existing Land Use	After 5 Years	After 10 Years	At The End of Mine Life
1	Area excavated or in active mining	-	3.858	3.858	3.858
2	Storage for topsoil	-	_*	_*	_*
3	Storage for OB	-	_*	_*	_*
4	Infrastructure	-	0.01	0.01	-
5	Roads/Approach road	-	0.198	0.198	0.060
6	Greenbelt over safety zone	-	0.524	0.524	0.672
7	Plantation	4.590 Ha			
8	Unused	-	-	-	-
TOTAL		<b>4.590 Ha</b>	<b>4.590 Ha</b>	<b>4.590 Ha</b>	<b>4.590 Ha.</b>

**Note:** \*: The OB of QL is proposed to preparation of approach road to mine site and little amount of soil generated and it will be used for plantation purpose.



## CHAPTER-13

### PROGRESSIVE MINE CLOSURE PLAN

#### 13.01.1 BRIEF INTRODUCTION OF THE AREA

i	<b>Name of Applicant</b>	Swami Nityanandji Maharaj Stones
ii	<b>Address</b>	Prop. Shri Lalit Panghal, R/o House no. 975/76, Sector 13, Hudda, Bhiwani, District Bhiwani, Haryana
iii	<b>Phone</b>	8307520901
iv	<b>Status of Applicant</b>	Proprietorship Firm
v	<b>Mineral(s), which occurring in the area and which the applicant intends to mine</b>	Sand stone (quartzitic nature)
vi	<b>Proposed Quarry Lease Period</b>	10 Year (from agreement)
vii	<b>Plan Period</b>	5 Year
viii	<b>Category of Mine</b>	B

#### 13.01.2 DETAILS OF THE AREA:

i	<b>District</b>	Rewa
ii	<b>Taluka</b>	Mauganj
iii	<b>Village</b>	Harrai gujran
iv	<b>Area</b>	4.590 Ha.
v	<b>Khasra No.</b>	2/1 (P)
vi	<b>Occupancy</b>	Govt. Forest Land

  
Regional Head  
D'tate of Geology & Mining  
Regional Office, Rewa (M.P.)

**a) Whether area is recorded in forest:** Yes, QL area is protected forest.

**b) Existence of public road:** No public Road is passing through the lease area.

**c) Toposheet No.:** Area falls in survey of India Toposheet No.63 H/14

**d) CO-ORDINATE OF CORNER POINT OF QUARRY LEASE**

Corner Point	Latitude	Longitude
A	24°32'36.367"N	81°48'58.954"E
B	24°32'38.439"N	81°49'2.093"E
C	24°32'32.689"N	81°49'8.957"E
D	24°32'28.766"N	81°49'5.029"E
E	24°32'32.241"N	81°48'58.982"E
F	24°32'33.534"N	81°48'59.700"E
G	24°32'34.937"N	81°48'59.942"E

(Source: DGPS survey report)

**e) Land use pattern:** Govt. Forest land.

**f) Validity of lease period:** Lease deed is not executed till date. The period for the lease will be 10 years from the date of execution as per MPMMR rule 1996.

**13.01.02 METHOD OF MINING AND MINERAL PROCESSING:**

Open cast semi -mechanized mining methods.

**13.01.03 REASON FOR CLOSURE**

As per Rule Minor Mineral Rules and latest amendment vide Gazette notification dated 23<sup>Rd</sup> March 2013 and progressive mine closure plan has been opted because of mining operation are yet to be started and suppose to be continued till the existence of the mineral in the area.

**13.01.04 STATUTORY OBLIGATIONS**

No statutory obligations are there; routine legislative conditions were mentioned in the approval letter .The details as required

**Any special condition while execution of lease:** No

**Any imposed conditioned by MoEF or Central Pollution Board:** It will be as per Mo EF/MPPCB/CPCB rules. Directorate of Mines Safety.

  
Regional Head  
D'tate of Geology & Mining  
Regional Office, Rewa (M.P.)



#### 13.01.04 CLOSURE PLAN PREPARATION

i	<b>Name of Applicant</b>	Swami Nityanandji Maharaj Stones
ii	<b>Address</b>	Prop. Shri Lalit Panghal, R/o House no. 975/76, Sector 13, Hudda, Bhiwani, District Bhiwani, Haryana
iii	<b>Phone</b>	8307520901

#### MINE DESCRIPTION

##### 13.02.01. TOPOGRAPHY

Please refer page no. 5

##### 13.02.02 REGIONAL GEOLOGY

Please refer page no. 5-8

##### 13.02.03 LOCAL GEOLOGY

Please refer page no. 8

##### 13.02.04 RESERVES AND RESOURCE

Please refer page no. 9-11

##### 13.02.05UP DATED RESERVES

Updated reserves will be the same as geological reserves.

##### 13.02.06 MINING METHOD

Please refer page no. 12

##### 13.02.07 MINERAL BENEFICIATION: -

Please refer page no. 20

#### 13.03 REVIEW OF IMPLEMENTATION OF MINING PLAN OF MINING INCLUDING ONE YEARS PROGRESSIVE CLOSURE PLAN UP TO THE FINAL CLOSURE OF MINE

Not applicable as it is a new Case.

#### 13.04 CLOSURE PLAN

##### 13.04.01 MINED OUT LAND

About 3.858 Ha. Area mined out at the end of plan period

##### 13.04.2 WATER QUALITY MANAGEMENT:

There are no surface water bodies; the ground water is available in the form of dug well near the applied area. Ground water level is below the



conceptual pit depth proposed as per the present knowledge of deposit. After the completion of mining operations in this area the surface water is likely to be contaminated due to wash off from the dust prone area. The same can be controlled by adequate plantation before the conceptual period is over.

During present PMCP period to conceptual period following steps will be taken for water quality management:

1. There is no surface water body, the water table is quite below the proposed one year and conceptual working, hence there will be no impact on ground water
2. Proposal of settling tank: During the rainy or post Monsoon season the collected water within the pit will be passing through the settling tanks to settle the suspended heavy particles the clear water will be discharged to agriculture land /nallah
3. The garland drain will be provided around the dump, whatever wash off from higher altitude area then it will be further drain to settling tank to suspend if any heavy particles then it will drain to agriculture field or nallah

The Stone does not contain any toxic element which is likely to cause surface/ground water pollution. Mining operation will not pose any problem to general water table of area.

#### **13.04.03 AIR QUALITY MANAGEMENT: -**

Once the mining operation in this area is over the ambient air can only be polluted by dust raised from the waste dumps. As stated above the waste dumps will be stabilized and secured against dust being air borne by adequate plantation before the conceptual period is over.

At the end of conceptual period following steps will be taken for air quality management:

1. Adequate plantation.
2. If required then regular sprinkling of water over the dust zone.

The proposed mining operation are small, hence there will be no such impact on air quality management.

#### **13.04.04 WASTE MANAGEMENT**

NO dumps are present after five year.

#### **13.04.05 TOP SOIL MANGEMENT:**

Top soil generate for the first two year and it will use for afforestation.

#### **13.04.06 TAILING DAM MANAGEMENT:**

No tailing generation hence tailing dam management is not required.

#### **13.04.07 INFRASTRUCTURE**

During the plan period mine office, separate toilet for men and women and shelter room will be constructed and first aid facilities will be enhanced.

**(i) Any decommissioning proposal:** No

#### **13.04.08 DISPOSAL OF MINING MACHINERY**

As such there is no mining machinery.

#### **13.04.09 SAFETY AND SECURITY**

For mining activity separate watch man will be appointed for security of mine. First aid facility will be provided at mine site. Fencing will be provided around the working pit, which will restrict the fall of animal in to working pit. Entrance of general public will be restricted and can be permitted if necessary with prior permission of manager/supervisor/lessee.

#### **13.04.10 DISASTER MANAGEMENT: -**

High-risk accidents are not anticipated in the area because proposed mining is of small scale. In case of natural disaster such as earthquake, flood, storm etc., as per the situation, lessee will take the assistance from the local competent authority of govt. and non-govt. agency, similarly mines manager will be in touch of local people for immediate amelioration and in the case of flood in the local nallah which is between 1-2 km (aerial) in radial direction will take anticipatory care in coordination with state govt. directives. Further the proper maintenance and replacement of required machineries of crusher unit will be taken care to avoid the any accidental event.

#### **13.04.11 CARE AND MAINTENANCE DURING TEMPORARY DISCONTINUANCE**



Special precautions and guidelines will be followed giving by the Central/State government for unplanned mining operations. Proposed mining is of small scale mine, most of the mining facilities will be adopted on hire basis in such case care will be taken as per the terms and conditions of the contract. During the temporary discontinuous of mining operations, Chokidar will be appointed for protection of mine site.

### **13.5 ECONOMIC REPERCUSSION OF CLOSURE OF MINE AND MANPOWER RETRENCHMENTS**

Proposed mining is of small scale mine, most of the mining facilities will be adopted on hire basis in such case care will be taken as per the terms and conditions of the contract. So far the crusher unit which is on contractual basis will be dealt as per their terms and condition of contract. At the conceptual stage the crushing unit will be shifted and reinstalled in applicant private where the engaged workers will be shifted as per their contractual term and condition.

#### **10.5.1 NUMBER OF LOCAL RESIDENTS EMPLOYED IN THE MINE, STATUS OF THE CONTINUATION FAMILY OCCUPATION AND SCOPE OF JOINING THE OCCUPATION:**

The number of local resident are propose to employ will be around 05-06 from the nearby areas and these local people have already their own traditional and family occupations like agriculture, sundry jobs and having their huts and in future when mine totally closed down due to exhaustion of reserves or other reason, they can easily join to their respective employments.

#### **10.5.2 COMPENSATING GIVEN OR TO BE GIVEN TO THE EMPLOYEES CONNECTING WITH SUSTENANCE OF HIMSELF AND THEIR FAMILY MEMBERS:**

For employees the retrenchment compensations to the workers, as and when required will be done as per the Central Labour Legislations.

#### **10.5.3 SATELLITE OCCUPATION CONNECTED TO THE MINING INDUSTRY-NUMBER OF PERSON ENGAGED THEREIN -CONTINUANCE OF SUCH BUSINESS AFTER MINE CLOSE:**

P.K. Tiwari  
Pushpendra Kumar Tiwari  
RQP/DGMMP/30/2013

Regional Head  
Directorate of Geology & Mining  
Regional Office, Rewa (M.P.)



This is New Case and there is no proposal for closing of mining operation during the plan period or up to lease period. There are other mines also operation in the vicinity of the area. The workers mostly works in seasonal agriculture and hence satellite occupations connected to the mining industry are not considered. Hence, after the mines closes there will not be any adverse effect.

#### **10.5.4 CONTINUED ENGAGEMENT OF EMPLOYEES IN THE REHABILITATED STATUS OF MINING LEASE AREA AND ANY OTHER REMNANT ACTIVITIES:**

This is very little chance of Mining Lease area getting rehabilitated as the land is Govt. Land.

#### **10.5.5 Envisaged repercussions on the expectation of the society around due to closure of mine:**

The employment potential of the mines is small; hence it will have no repercussion on the society around due to closure of mine. While the employment potential remain the same

#### **10.6 TIME SCHEDULING FOR PROGRESSIVE RECLAMATION AND REHABILITATION.**

The details of time schedule of all abandonment operations as lease in Para 4 should be described here. The manpower and other resources required for completion of lease job should be described. The schedule such operation should also supplementry by PERT (Programme Evaluation and Review Technique) Bar chart etc.:

It is not applicable at this stage because the mining operations are yet to be started and will be continuing for forthcoming period. There will not be any mined out area or generation of soil dump during the proposal period hence no reclamation and rehabilitation is envisaged. As discussed in foregoing chapters there is no proposal for abandonment of mine or initiating closure operations during the mining plan period so at this station no question of abandonment does not arise.

#### **13.07 COSTS FOR PROGRESSIVE RECLAMATION AND REHABILITATION**

The applicant has applied for grant of mining lease and mining operation will commence after the grant of mining lease therefore at this stage it is not possible to assess the abandonment cost. However for first one year the abandonment cost for implementation the protective and measures including their maintenance and monitoring programmed will be about Rs.100000.00, which is discussed as below:

(i) **Progressive reclamation and rehabilitation measure:**

Not applicable.

(ii) **Plantation:**

About 750 plants are proposed during plan period the cost for maintaining the plantation is as follows:

Cost: Rs.15000.00 & Care and maintenance: Rs 360000.00

(iii) **Parapet:**

Not proposed.

(iv) **Bund/Garland:**

Not proposed

(v) **Retaining/Toe wall:**

Not proposed

(vi) **Settling Tank:**

Not proposed

(vii) **Miscellaneous:** It will be around Rs.200000.00

Proposal	Cost in Rs.
Reclamation/Rehabilitation	0000.00
Plantation	375000.00
Parapet	-
Bund/Garland	-
Toe wall	-
Settling Tank	-
Miscellaneous	200000.00
Total	5750000.00

  
**Regional Head**  
 Directorate of Geology & Mining  
 Regional Office, Rewa (M.P.)

  
**Pushpendra Kumar Tiwari**  
 RQP/DGMMP/30/2013

### 13.08 FINANCIAL ASSURANCE

Total area is 4.590 Ha. hence as per Rule 42(5) in sub clause (a) of clause (6) of sub rule (j) of MPMMR 1996 financial assurance calculation will be 75000.00 per ha. 4.590 Ha X 75000 (Per Ha.) = Rs. 375000.00

This FA will be submitted after the necessary instruction from approval officer and it will be submitted before the final submission.

### 13.09 CERTIFICATE: Refer annexure no. IV

PLACE: REWA

DATE: 12/12/2021

Pushpendra Kumar Tiwari

RQP/DGMMP/30/2013

PUSHPENDRA KUMAR TIWARI

P.K.Ti-

RQP/DGMMP/ 30/2013

  
Regional Head  
D'tate of Geology & Mining  
Regional Office, Rewa (M.P.)

Pushpendra Kumar Tiwari  
RQP/DGMMP/30/2013



### CONSENT FROM THE APPLICANT

I hereby accept all content given in this Mining Plan by the recognized person may be deemed to have been made with my knowledge and consent and shall be acceptable to me and binding on me in all respect, "understood the contents of the Mining Plan and agree to implement".

**Regional Head**  
Directorate of Geology & Mining  
Regional Office, Rewa (M.P.)

#### **Applicant**

Lalit Panghal

(For Swami Nityanandji Maharaj Stones)

*P.K. Tiwari*  
Pushpendra Kumar Tiwari  
RQP/DGMMP/30/2013

## UNDETAKEING

I, Lalit Panghal, Proprietor of Swami Nityanandji Maharaj Stones R/o House no. 975/76, Sector 13, Hudda, Bhiwani, District Bhiwani, Hariyana Proprietor of Harrai Gujran Stone Quarry lease, Tehsil Mauganj, District Rewa (M.P.) hereby undertake that

1. We will obtain all consent approval from competent authorities' like SPCB, MoEF & CC. We also commit that environmental degradation like air, water, noise and vibration will be kept within permissible limits.
2. Water sprinkler for dust suppression during the transportation of material will be done within the lease area.
3. We also commit that the unnecessary cutting of trees will be avoided.

Place: Rewa

(Lalit Panghal)

Date: 12 /12/2021

Proprietor

Regional Head  
Office of Geology & Mining  
Regional Office, Rewa (M.P.)



## संचालनालय भौमिकी तथा खनिकर्म मध्यप्रदेश

मध्यप्रदेश गौण खनिज नियम 1996 के अंतर्गत  
मान्यता प्राप्त योग्य व्यक्ति

### प्रमाण पत्र

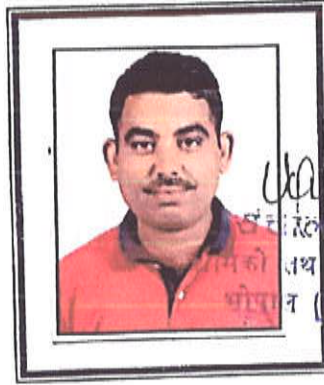

श्री पुष्पेन्द्र कुमार तिवारी, पिता श्री राम किशोर तिवारी, पता ग्राम एवं पोस्ट लोही, तहसील हुजूर, जिला रीवा, मध्यप्रदेश, जिनकी फोटो तथा हस्ताक्षर अभिप्रमाणित है, को म.प्र. गौण खनिज नियम 1996 के अंतर्गत मान्यता प्राप्त योग्य व्यक्ति के रूप में प्रदत्त पंजीयन क्रमांक **RQP/DGMMP/30/2013**, दिनांक 10.05.2018 से 09.05.2023 की अवधि के लिये नवीनीकृत किया जाता है।

मान्यता प्राप्त व्यक्ति के हस्ताक्षर - P. K. T.

भापाल, दिनांक 10.05.2018

  
संचालक

भौमिकी तथा खनिकर्म  
मध्यप्रदेश, भापाल



# कार्यालय कलेक्टर (खनिज शाखा) जिला-रीवा (म.प्र.)

E-mail- modgmrew@mp.gov.in

क्रमांक/ 5937

/खनिज/2021

रीवा दिनांक 11/01/2021

प्रति,

स्वामी नित्यानंद जी महाराज स्टोन्स,  
प्रो. श्री ललित पंभाल  
निवासी मकान नंबर 975/76 सेक्टर 13,  
हुड्डा भिवाड़ी, हरियाणा

विषय :- ग्राम हरई गुजरान तहसील मऊगंज जिला रीवा के खसरा नं. 2/1पी (वन भूमि) रकबा 04.590 हे० क्षेत्र पर खनिज यांत्रिक क्रिया से गिट्टी बनाने हेतु पत्थर (अर्थात् क्रेशर के उपयोग हेतु) का उत्खनिपट्टा आवेदन पत्र क्रमांक 770 दिनांक 12.11.2020 के निराकरण विषयक।

संदर्भ :- 1. कार्यालयीन पत्र क्रमांक 422/खनिज/2021 रीवा, दिनांक 11.01.2021  
2. आपका पत्र दिनांक 07.07.2021

---X-X-X---

उपरोक्त विषयान्तर्गत आपके द्वारा ग्राम हरई गुजरान तहसील मऊगंज जिला रीवा के खसरा नं. 2/1पी (वन भूमि) रकबा 04.590 हे० क्षेत्र पर खनिज यांत्रिक क्रिया से गिट्टी बनाने हेतु पत्थर (अर्थात् क्रेशर के उपयोग हेतु) उत्खनिपट्टा आवेदन पत्र 10 वर्ष की अवधि के लिये दिनांक 12.11.2020 को इस कार्यालय में प्रस्तुत किया गया था।

वन मण्डलाधिकारी रीवा के प्रतिवेदन अनुसार आवेदित क्षेत्र वन भूमि है जो कि खसरा नं. 2/1पी (वन भूमि) के अंतर्गत है। प्रकरण में आवश्यक परीक्षण उपरांत प्राप्त प्रतिवेदनों के आधार पर रीवा जिले के ग्राम हरई गुजरान तहसील मऊगंज जिला रीवा के खसरा नं. 2/1पी (वन भूमि) रकबा 04.590 हे० में से उपलब्ध रकबा 04.590 हे० क्षेत्र पर खनिज यांत्रिक क्रिया से गिट्टी बनाने हेतु पत्थर (अर्थात् क्रेशर के उपयोग हेतु) उत्खनिपट्टा 10 वर्ष की अवधि के लिये स्वीकृत करने का निर्णय लिया जाकर सैद्धान्तिक सहमति संदर्भित पत्र दिनांक 11.01.2021 द्वारा प्रदान की गई थी। कोविड संक्रमण के कारण समयावधि में कार्यवाही पूर्ण नहीं होने को दृष्टिगत रखते हुये म.प्र. गौण खनिज नियम 1996 के नियम 18 (2) में निहित प्रावधानों के अनुरूप पूर्ण सैद्धान्तिक स्वीकृति में अवधि वृद्धि की जाती है।

आप इस सैद्धान्तिक सहमति पत्र जारी होने के दिनांक से 06 माह के अंदर अनुमोदित खनन योजना इस कार्यालय में उपलब्ध करावें। अनुमोदित खनन योजना एवं वन संरक्षण अधिनियम 1980 के अंतर्गत वन विभाग में अनुमति प्राप्त कर इस कार्यालय में उपलब्ध कराने के पश्चात् ही उत्खनिपट्टा स्वीकृत अन्वेष जारी किया जा सकेगा।

(कलेक्टर महो० द्वारा अनुमोदित)

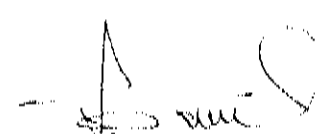
  
प्रभारी अधिकारी खनिज  
हेतु कलेक्टर जिला रीवा (म.प्र.)

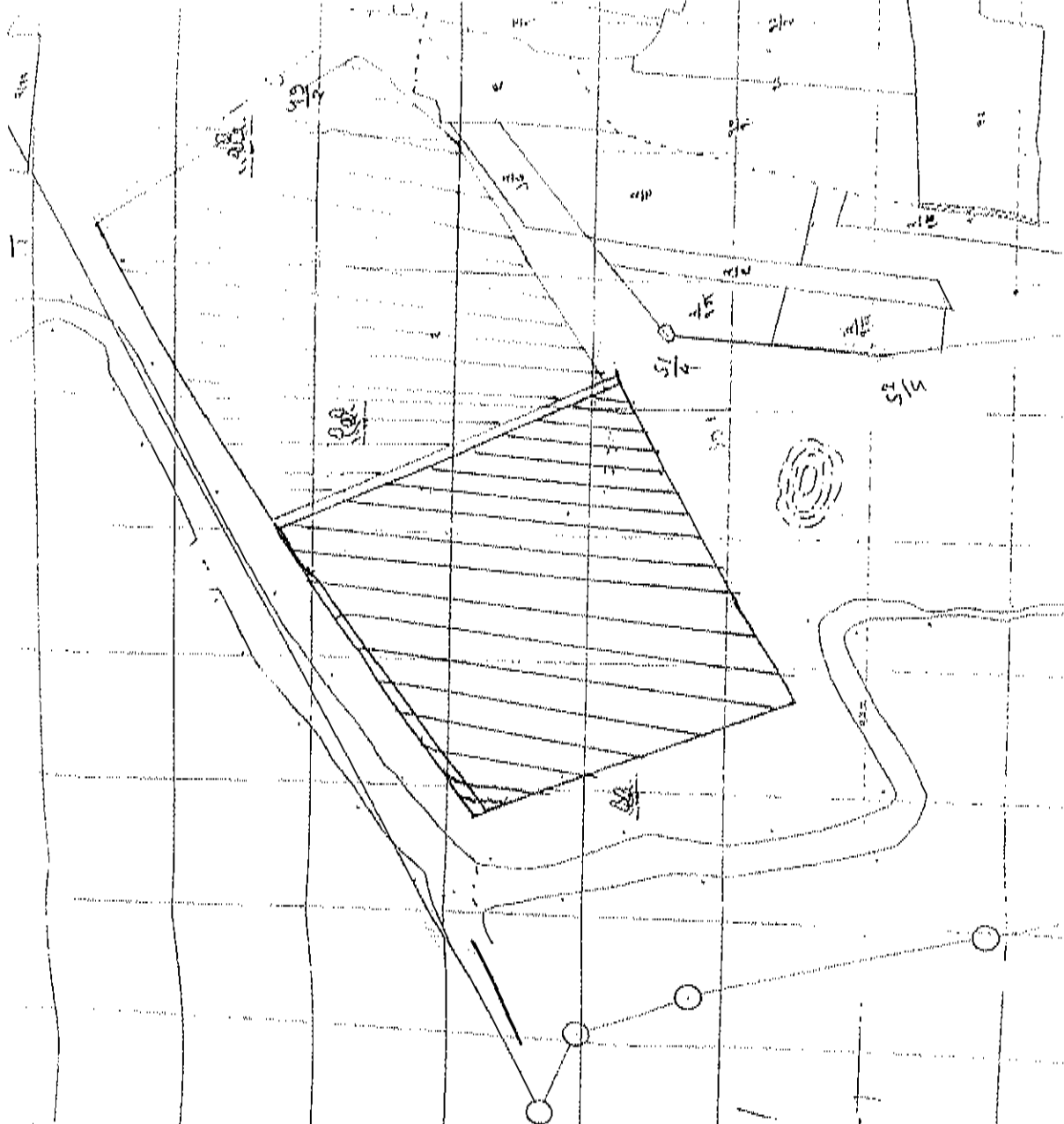

संकेत -

- संकेत २३ - अविश्व विमान संकेत /  
 संकेत - ०४:५९०५

- संकेत २३ - अविश्व विमान संकेत /  
 संकेत - ०४:५९०५

*[Signature]*

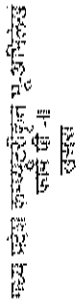

22

11-12-13



# कार्यालय तहसीलदार तहसील मऊगंज जिला-रीवा (म.प्र.)

क्रमांक 337/प्रवा.तह./ 2020

मऊगंज दिनांक 03-12-2020

प्रति

कलेक्टर महोदय,  
(खनिज शाखा)  
जिला-रीवा, (म.प्र.)

विषय:- पर्यावरणीय सम्मति हेतु सिया द्वारा निर्धारित बिन्दुओं पर जानकारी प्रदाय करने के संबंध में  
संदर्भ:- श्रीमान् जी का पत्र क्रमांक/ 5205 / खनिज / 2020 रीवा दिनांक 13/11/2020 !

---0000---

महोदय,

विषयांतर्गत संदर्भित पत्र के संबंध में अनुरोध है कि आवेदक स्वामी नित्यानंद जी महाराज स्टोन प्रो. ललित पट्टाल के आवेदन पत्र पर ग्राम हररहा की आराजी नं. 2/1, रकवा 35.099 हे. में से अंश रकवा 4.590 हे. की जॉच हल्का पटवारी सरिहा एवं राजस्व निरीक्षक सीतापुर से खनिज पत्थर यान्त्रिक विधि से गिट्टी निर्माण हेतु निर्धारित बिन्दुओं पर (1-6) बिन्दुबार प्रतिवेदन मगाया गया प्रतिवेदन श्रीमान् जी की ओर अवलोकनार्थ एवं अग्रिम कार्यवाही हेतु सादर सम्प्रेषित है।

03/12/2020  
तहसीलदार  
तहसील मऊगंज जिला-रीवा (म.प्र.)  
जिला रीवा (म.प्र.)

## पर्यावरणीय सम्मति हेतु सिया द्वारा निर्धारित बिन्दु

क्र.	निर्धारित बिन्दु	वस्तुस्थिति
1.	क्या 10 कि.मी. की दूरी में कोई नेशनल पार्क/ अभ्यारण्य/जैवविविधता स्थित है? तो उसकी दूरी	नहीं
2.	खनिपट्टा/उत्खननपट्टा/घोष विक्रय खदान क्षेत्र से वन क्षेत्र की दूरी कितनी है?	वन सम्पर्क
3.	क्या 500 मीटर की दूरी के अंदर कोई मानव बसाहट/शैक्षणिक संस्थान/चिकित्सालय/पुरातत्व धरोहर/राष्ट्रीय महत्त्व के स्मारक स्थित है? तो उसकी दूरी	500 मीटर है मानव धरोहर
4.	क्या 500 मीटर की दूरी के अंदर कोई जलीय निकाय/नदी/तालाब/नहर स्थित है? तो उसकी दूरी	नहीं है
5.	500 मीटर की परिधि में स्वीकृत अन्य खनिपट्टा/लीज की जानकारी (रित के प्रकरण में यह जानकारी 1000 मीटर रहेगी)	—
6.	रत उत्खनन के प्रकरण में नदी का नाम	—

की  
25/11/2020

62  
96/11/2020

कार्यालय क्षेत्रीय प्रमुख  
खनिज साधन विभाग, मध्यप्रदेश शासन  
संचालनालय भौमिकी तथा खनिकर्म  
क्षेत्रीय कार्यालय रीवा मध्यप्रदेश  
ई मेल — rhdgmrew@mp.gov.in

फोन एवं फैक्स न. 07662 222044, 222045

क्रमांक 1451/भौ./न.क्र./2020-21

रीवा दिनांक 22/12/2020

प्रति

प्रभारी अधिकारी खनिज  
जिलाध्यक्ष कार्यालय  
जिला रीवा (म.प्र.)

विषय :- ग्राम हरई गुजरान तह. मऊगंज जिला रीवा के ख.न. 2/1 (पी ) रकबा 4.590 हे. में खनिज पत्थर (यां. वि. से गिट्टी निर्माण) का उत्खनिपट्टा हेतु आवेदन पत्र। आवेदक स्वामी नित्यानंद जी महाराज स्टोन्स प्रो. श्री ललित पट्टाल।

संदर्भ :- आपका पत्र क्रमांक 5200/खनिज/2020 रीवा दिनांक 13.11.2020

—00—

उपरोक्त क्षेत्र का निरीक्षण किया गया। आवेदित क्षेत्र के अक्षांश देशांश की जानकारी के अभाव में आवेदक द्वारा बताए गए आवेदित क्षेत्र एवं आसपास स्थित क्षेत्र में स्थित खदानों में विद्यमान चट्टानों के संस्तर का अवलोकन किया गया। क्षेत्रीय भौगोलिक एवं भूगर्भीय स्थिति के अनुसार क्षेत्र में विन्ध्य समूह की चट्टानें विद्यमान हैं। क्षेत्र में पाया जाने वाला खनिज क्वार्ट्जिटिक सैंड स्टोन है। जिसे गौण खनिज के रूप में प्रयुक्त किया जा सकता है। क्षेत्र में अन्य किसी प्रकार का मिनेरलाइजेशन नहीं देखा गया। क्षेत्र में लगभग 2,29,000 घन मीटर खनिज उपलब्ध हो सकता है।

  
क्षेत्रीय प्रमुख

 संचालनालय भौमिकी तथा खनिकर्म  
क्षेत्रीय कार्यालय रीवा मध्यप्रदेश



क्रमांक/मा.चि./1052-2  
प्रति.

रीवा, दिनांक 18.11.2020

कलेक्टर (खनिज शाखा)  
जिला रीवा (म.प्र.)

विषय :- ग्राम हरईगुजरान तहसील मऊगंज के खसरा नम्बर 2/1 (पी) का रकबा 04.590 हे.  
भूमि पर अनुज्ञप्ति/उत्खनन पट्टा पत्थर यांत्रिकीय विधि से गिट्टी निर्माण हेतु  
आवेदक स्वामी नित्यानंद जी महाराज स्टोन्स प्रो. ललित पंचाल।

संदर्भ :- आपका पत्र क्र./5196/खनिज/2020 रीवा, दिनांक 13.11.2020

—0—

विषयान्तर्गत संदर्भित पत्र से प्राप्त प्रकरण का मौका निरीक्षण उप वनमण्डलाधिकारी  
मऊगंज एवं वन परिक्षेत्राधिकारी मऊगंज के द्वारा की गई, जिसमें उप वनमण्डलाधिकारी मऊगंज  
एवं वन परिक्षेत्राधिकारी मऊगंज के प्रतिवेदन अनुसार उक्त भूमि वन भूमि है।

उक्त प्रकरण भारत सरकार पर्यावरण एवं वन मंत्रालय जलवायु परिवर्तन मंत्रालय  
भोपाल की स्वीकृति/अधिरोपित शर्तों तथा वन संरक्षण अधिनियम 1980 के पालन हेतु प्रकरण  
की सैद्धांतिक स्वीकृति आदेश, माइनिंग प्लान अनुमोदित होने का सक्षम अधिकारी का पत्र की  
कॉपी इस कार्यालय को उपलब्ध करावें, जिससे वन संरक्षण अधिनियम 1980 के तहत व्यपवर्तन  
की कार्यवाही की जा सके।

अतः प्रतिवेदन आपकी ओर आवश्यक कार्यवाही हेतु प्रेषित है।

(चन्द्रशेखर सिंह मा.प्र.से.)  
वनमंडलाधिकारी  
वनमण्डल(सा.)रीवा(म.प्र.)

पृष्ठांकन क्रमांक/मा.चि./

रीवा, दिनांक .....2020

प्रतिलिपि :-

1. उपवनमण्डलाधिकारी मऊगंज की ओर सूचनार्थ प्रेषित।
2. वन परिक्षेत्राधिकारी मऊगंज की ओर सूचनार्थ प्रेषित।

sol  
वनमंडलाधिकारी  
वनमण्डल(सा.)रीवा(म.प्र.)

कार्यालय ग्राम पंचायत क्षेत्र हररहा जनपद पंचायत मउगंज, जिला रीवा म0प्र0

क्रमांक/क्यू-1

मउगंज, दिनांक/30/11/2020

### अनापत्ति प्रमाण - पत्र

प्रमाणित किया जाता है कि ग्राम पंचायत क्षेत्र हररहा अंतर्गत ग्राम पंचायत हररहा ग्राम हरईगुजरान तहसील मउगंज के खसरा नम्बर 2/1 (पी) रकवा 4.460 हेक्टेयर, एवं खसरा नंबर 2/1(पी) रकवा 4.590 हेक्टेयर, राजस्व भूमि नहीं है आवेदित भूमि वन विभाग की वन भूमि कक्ष क्रमांक पी. 334 का अंश भाग कमरा: 4.460 हे., 4.590 हे. कुल रकवा 9.050 हेक्टेयर पर आवेदक स्वामी नित्यानंद जी महाराज स्टोन्स पो0 ललित पंघाल द्वारा वन संरक्षण अधिनियम 1980 का यदि उलंघन नहीं किया जाता तो ग्राम पंचायत कोई आपत्ति नहीं होगी। जिसका अनापत्ति प्रमाण-पत्र जारी किया जाता है।

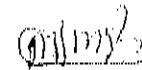

प्रधान

प्रशासकीय समिति

ग्राम पंचायत हररहा

ग्राम पंचायत क्षेत्र हररहा

जनपद पंचायत मउगंज

जिला रीवा म0प्र0

# कार्यवृत्ति ग्राम सभा (गौरी)

पृष्ठ संख्या

हरद्वारा

ग्राम सभा के नाम

सम्मिलन की तारीख 30/11/2020 सम्मिलन का स्थान

पृष्ठ संख्या 2/1/167

उपस्थित सदस्यों की संख्या 120

ग्राम सभा के समक्ष रहे गये विषय

सम्मिलन के कार्यवृत्ति

(2)

प्रस्तावित 2 सदस्यों को  
असहमत मोहोदय की अनुमति  
(1)  
ग्राम हरद्वारा ग्राम सभा  
सदस्यों के समक्ष 2/1  
प्रा. रकबा 4.460 हे. एवं खसरा  
नं. 2/1 प्रा. रकबा 4590 हे.  
अभिप्राय अनुमति / उत्तरदान  
पत्रा. माहिती सिद्धि. सं.  
जिन्होंने निर्माण वापस

ग्राम हरद्वारा 30/11/2020 को ग्राम सभा 12/1/167  
की विशेष आम सभा का आयोजन मोहोदय सिंह कायेंद  
ग्राम प्रधान की अध्यक्षता में समय 11 वजे दिन 2/1/20  
की गई बैठक का कारण ग्राम सभा के सदस्यों के  
आवाजों की विलोपन सिंह वन वाला वन घरेलू सहायक  
सिंह का फुर आवाज रहे /  
बैठक में उपस्थित सभी ग्राम सभा सदस्यों का  
निर्णय ग्राम सभा रकबा 2/1 (P) खसरा नं. 2/1 (P)  
रकबा 4.460 हे. एवं खसरा नं. 2/1 (P) रकबा 4590 हे.  
में आवेदन स्वामी निवास नंद जो महाराज स्थान  
प्रा. रकबा 4.460 हे. द्वारा अनुमति / उत्तरदान पत्रा.  
पत्रा. माहिती सिद्धि. से जिन्होंने निर्माण की  
पंचायत लक्ष्मी अनापत्ते का प्रमाण एवं प्रमाण  
पत्रा. माहिती सिद्धि. है। ग्राम सभा में उपस्थित सभी  
सदस्यों सिंह वन वाला वन घरेलू सहायक सिद्धि.  
ग्राम सभा को बताया गया कि दोनों

P.T.O



[illegible]

प्रधान-  
प्रशासकीय समिति  
ग्राम पंचायत हरहा  
ज.पं.मण्डोल, दिल्ली-हरहा (न.प्र.)

5

## खनि निरीक्षक का प्रतिवेदन

खनि निरीक्षण की मर्यादा  
प्रतिवेदन/पत्रिका  
2/1 (P) - 2022/2023

1. स्थल निरीक्षण का दिनांक 02-1-2021

2. खनि नियमों के अनुसार आवेदित क्षेत्र से प्रतिबंधित दूरी

- |                             |   |
|-----------------------------|---|
| (1) पुल                     | नहीं है                                   |
| (2) राष्ट्रीय/राजमार्ग      | नहीं है                                   |
| (3) रेलवे लाइन              | नहीं है                                   |
| (4) नदी/नाला/नहर            | नहीं है                                   |
| (5) जलाशय/बांध              | नहीं है                                   |
| (6) ग्राभीण मार्ग           | आवृत्ति पर 50 मीटर से कम दूरी पर स्थित है |
| (7) सार्वजनिक संस्थान       | नहीं है                                   |
| (8) आबादी                   | नहीं है                                   |
| (9) सार्वजनिक उपयोग की भूमि | नहीं है                                   |
| (10) धार्मिक स्थल           | नहीं है                                   |
| (11) मरघट                   | नहीं है                                   |

3. आवेदित खनिज की प्रारंभिक उपलब्धता संबंधी प्रतिवेदन

ऊपरी स्तर पर पत्थर दिखता है  
देखा है (उपलब्ध है)

4. आवेदित क्षेत्र के आसपास अन्य स्वीकृत

खनि रियायतों का विवरण:-

क्र०	ग्राम	खसरा	खनिज	खनि रियायत
------	-------	------	------	------------

5. आवेदित क्षेत्र नवीन है, अथवा पूर्व में क्षेत्र में खनन हुआ है।

नहीं है

6. अन्य कोई आवश्यक जानकारी

नहीं है

7. आवेदित क्षेत्र के संबंध में स्वीकृति/अस्वीकृति संबंधी स्पष्ट अनुशंसा

दिनांक.....



हस्ताक्षर  
(खनि निरीक्षक का नाम)

## मानचित्रकार का प्रतिवेदन

1.	आवेदक का नाम	—	नित्यानंद जी महाराज स्टोन प्रो. ललित पैघाल			
2.	आवेदित क्षेत्र	—				
	(अ) ग्राम	—	हरई गुजरान			
	(ब) तहसील	—	हनुमना			
	(स) जिला	—	रीवा			
	(द) रकबा	—	4.590 हे०			
	(इ) खसरा क्रमांक	—	2/1 अंश भाग			
3.	आवेदन का प्रकार	—	उत्खनिपट्टा			
4.	आवेदित खनिज	—	पत्थर (यांत्रिकी क्रिया से गिट्टी निर्माण)			
5.	आवेदन प्रस्तुति का दिनांक	—	12/11/2020			
6.	क्या आवेदित क्षेत्र सुरक्षित है अथवा नहीं?	—	नहीं			
7.	आवेदित क्षेत्र पूर्व में धारित है अथवा नहीं?	—	नहीं			
8.	आवेदित क्षेत्र यदि पूर्व में धारित था तो उसका पूर्ण विवरण (पट्टेदार का नाम, स्वीकृत अवधि, खनिज का नाम एवं क्षेत्र निरस्त होने का कारण) खनि रियायत अवधि समाप्ति के पश्चात् खुला घोषित हुआ अथवा नहीं	—	नहीं			
9.	यदि क्षेत्र खुला घोषित है तब खुला घोषित होने की अधिसूचना अनुसार आवेदित क्षेत्र के मानचित्र की स्थिति एवं रकबा	—	नहीं			
10.	आवेदित क्षेत्र पर पूर्व के आवेदन लंबित है अथवा नहीं? (लंबित होने पर विस्तृत विवरण)	—	आवेदित क्षेत्र पर पूर्व से आवेदन लंबित हैं, जिसका विवरण तालिका अनुसार है—			
	क्र.	आवेदक का नाम	ग्राम का नाम	खसरा क्र.	रकबा	आवेदन दिनांक
	1.	नित्यानंद जी महाराज स्टोन प्रो. ललित पैघाल	हरई गुजरान	2/1 पी.	4.460 हे०	12.11.2020
	2.	श्री मयंक सिंह परिहार	हरई गुजरान	2/1 पी.	4.590 हे०	21.12.2020
	3.	श्री दीपक अग्रवाल	हरई गुजरान	2/1 पी.	4.460 हे०	21.12.2020
11.	आवेदित क्षेत्र पूर्व के आवेदनों से आच्छादित होता है तब क्षेत्र उपलब्धता क्षेत्र का विवरण	आवेदित क्षेत्र पर पूर्व से अन्य प्राप्त आवेदनों में समस्त आवेदकों द्वारा आवेदित क्षेत्र रकबा को चिन्हांकित नहीं किया गया है। आवेदित क्षेत्र का रकबा वृहद् है। वर्तमान आवेदक द्वारा आवेदित क्षेत्र को नक्शे में चिन्हित किया गया है। अन्य लंबित आवेदन पत्रों में आवेदकों द्वारा आवेदित क्षेत्र को चिन्हित नहीं किये जाने से आच्छादन होने की स्थिति स्पष्ट नहीं होती है।				





प्रतिबंधित क्षेत्र छोड़ने के उपरान्त उपलब्ध क्षेत्र (निर्धारित प्रारूप में प्रस्तुत करें)		:-			
आवेदित क्षेत्र		प्रतिबंधित क्षेत्र		स्वीकृति हेतु उपलब्ध / प्रस्तावित क्षेत्र	
खसरा क्र.	रकबा	खसरा क्र.	रकबा	खसरा क्र.	रकबा
2/1 पी.	4.460 हे०	—	—	2/1 पी.	4.460 हे०
13.	आवेदित क्षेत्र का इतिहास		—	<p>आवेदित क्षेत्र शासकीय वन भूमि है। आवेदित क्षेत्र पर पूर्व से अन्य आवेदन प्राप्त हैं। समस्त स्थलीय प्रतिवेदन तहसीलदार, ग्राम पंचायत, क्षेत्रीय प्रमुख, खनि निरीक्षक द्वारा प्राप्त प्रतिवेदन अनुसार आवेदित भूमि का सम्पूर्ण भाग वन भूमि है। तहसीलदार प्रतिवेदन अनुसार नदी, नाला, मरघट आदि सार्वजनिक स्थल नियमानुसार दूरी पर स्थित है। आवेदित क्षेत्र ऊबड़-खाबड़ व पथरीली पड़त भूमि है।</p> <p>वन मण्डलाधिकारी वन मण्डल रीवा द्वारा प्राप्त प्रतिवेदन अनुसार आवेदित क्षेत्र वन भूमि है, भारत सरकार पर्यावरण वन एवं जलवायु परिवर्तन मंत्रालय क्षेत्रीय कार्यालय भोपाल की अधिरोपित शर्तों तथा वन संरक्षण अधिनियम 1980 के तहत आवेदित क्षेत्र व्यवर्तन की कार्यवाही किये जाने हेतु वन विभाग को कोई आपत्ति नहीं बताई गई है।</p> <p>आवेदित क्षेत्र पूर्व से अन्य लंबित आवेदनों से आच्छादित है। वर्तमान आवेदक द्वारा आवेदित क्षेत्र को नक्शे में चिन्हित किया गया है। वन मण्डलाधिकारी के प्रतिवेदन के आधार पर संपूर्ण आवेदित क्षेत्र सैद्धांतिक सहमति की स्वीकृत हेतु शासन निर्देशों के अनुरूप उपलब्ध मान्य किया जा सकता है।</p>	
14	क्षेत्र उपलब्धता संबंधी स्पष्ट अनुसंशा नक्शे में भी अंकित की जाये		—	अंकित है।	

अतः उक्त क्षेत्र उपलब्धता संबंधी प्रतिवेदन अग्रिम कार्यवाही हेतु सादर प्रस्तुत है।

दिनांक :- 02.01.2021

  
(वीर सिंह)

सहा. मानचित्रकार  
खनिज शाखा, जिला-रीवा (म.प्र.)

## GOOGLE MAP



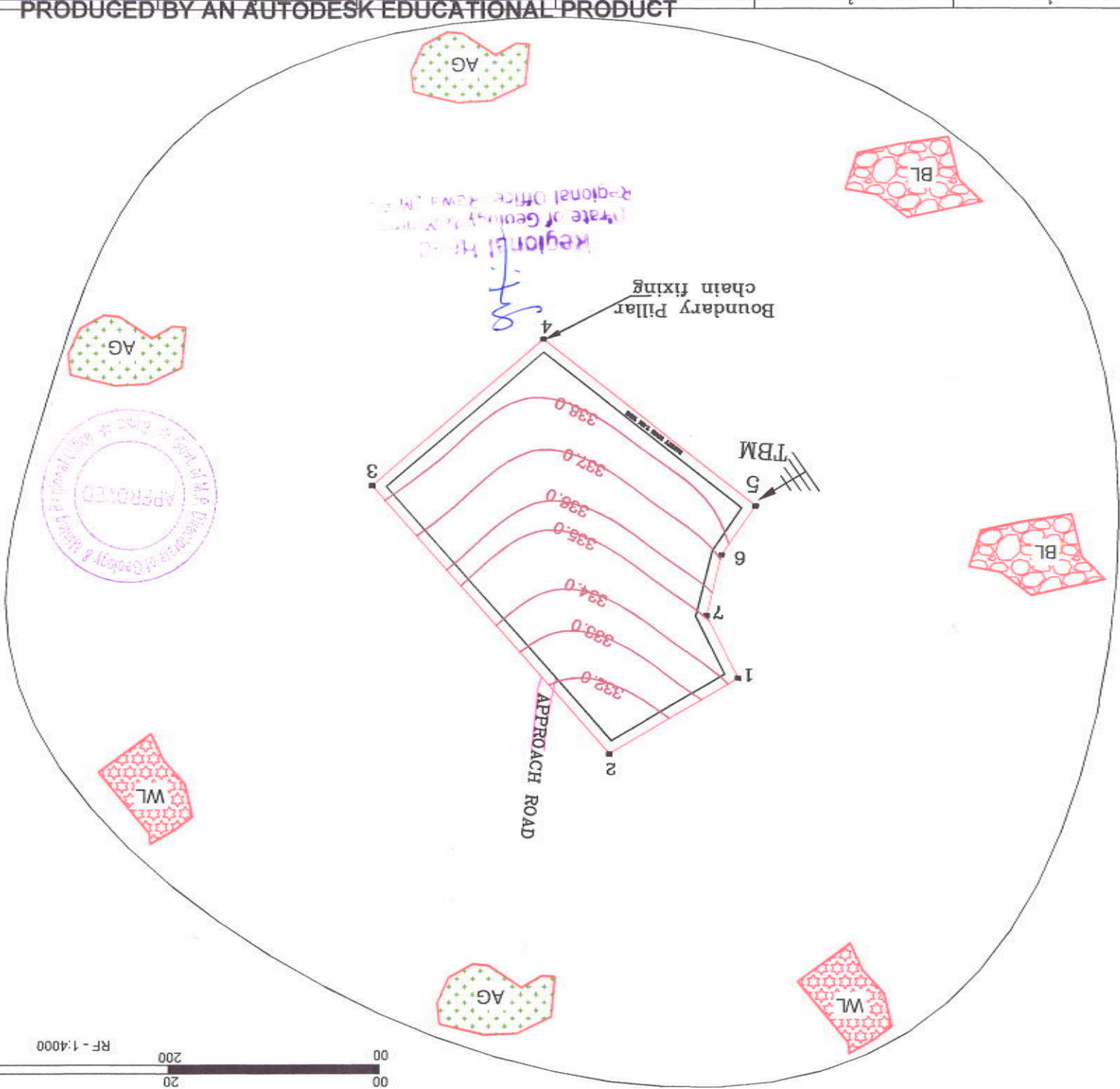

Scale-1:4000



SL. No.	SYMBOL	DESCRIPTION
01		LEASE BOUNDARY
02		CONTOUR
03		TEMP. BENCH MARK
04		AGRICULTURAL LAND
05		WASTE LAND
06		BARREN LAND
LAND USE PLAN		
THIS PLAN AND SECTION MADE UP BY BEST OF MY KNOWLEDGE		
AREA - 4.590 Ha.		
VILLAGE - Harrai Gunjan		
DISTRICT - Rewa (M.P.)		
Khassra No. 1/2(P)		
CLIENT		
Swami Nityanandji Maharaj Stones		
Prop : Shri Lalit Panghal		
R/o: H.No. 975/76, Sector 13, Hudda,		
Bhiwani, Distt.-Bhiwani, Haryana		
Pushpendra Kumar Tiwari		
RGP/DGMM/230/2013		

INDEX



## LOCATION AND KEY MAP



INDIA

MADHYA PRADESH

REWA

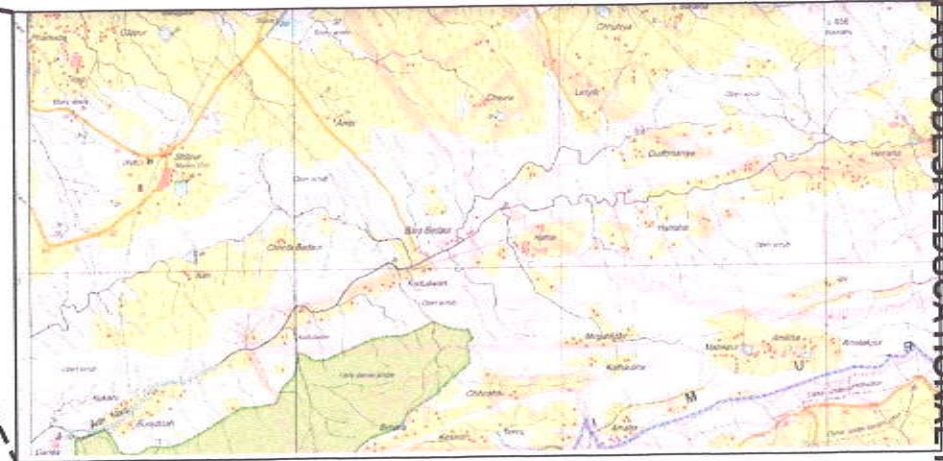
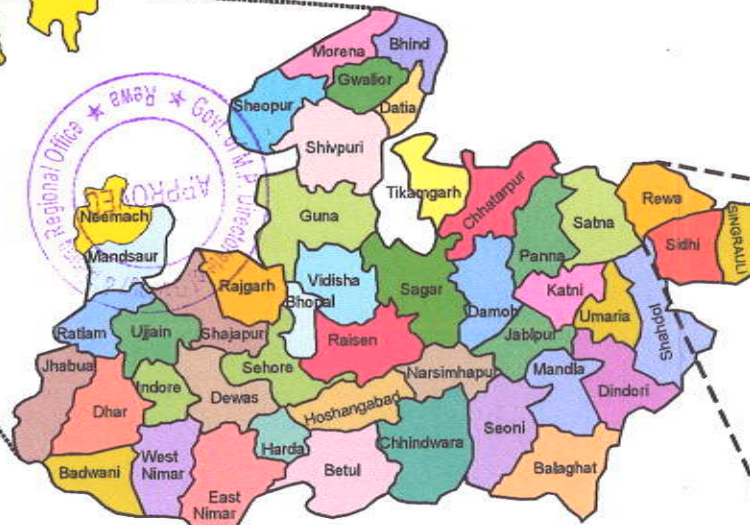

PLATE :-

## LOCATION AND KEY MAP

THIS PLAN & AREA - 4.590 Ha.  
SECTION MADE VILLAGE- Harrai Gunjran  
UP BY BEST OF TEHSIL - Mauganj  
MY KNOWLEDGE DISTRICT - Rewa (M.P.)  
Khasra No. 2(P)

## CLIENT

Swami Nityanandji Maharaj Stones  
Prop : Shri Lalit Panghal  
R/o: H.No. 975/76, Sector 13, Hudda,  
Bhiwani, Distt.-Bhiwani, Haryana

## NAME

P.K. Tiwari  
Pushpendra Kumar Tiwari  
RQP/DCM/99/2033

Regional Head  
D'tate of Geology & Mining  
Regional Office, Rewa (M.P.)



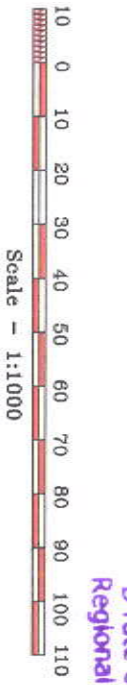
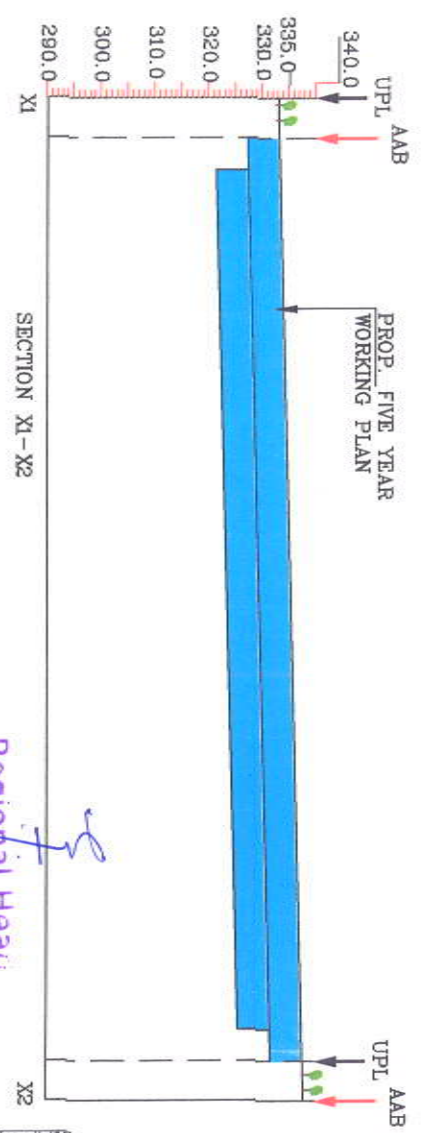
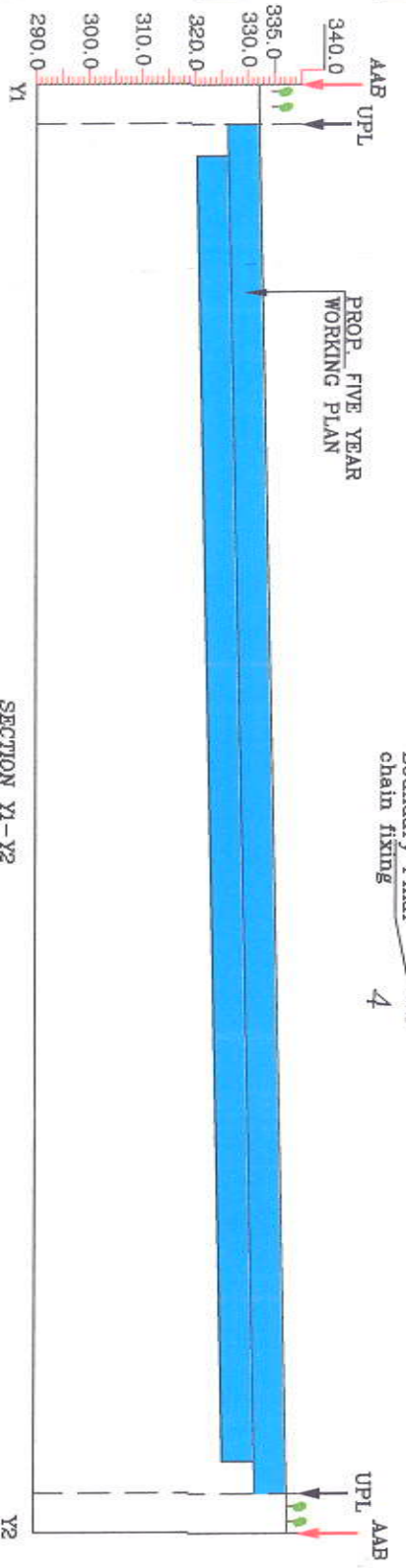
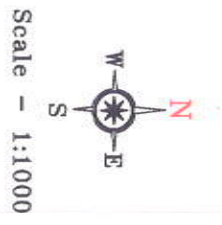
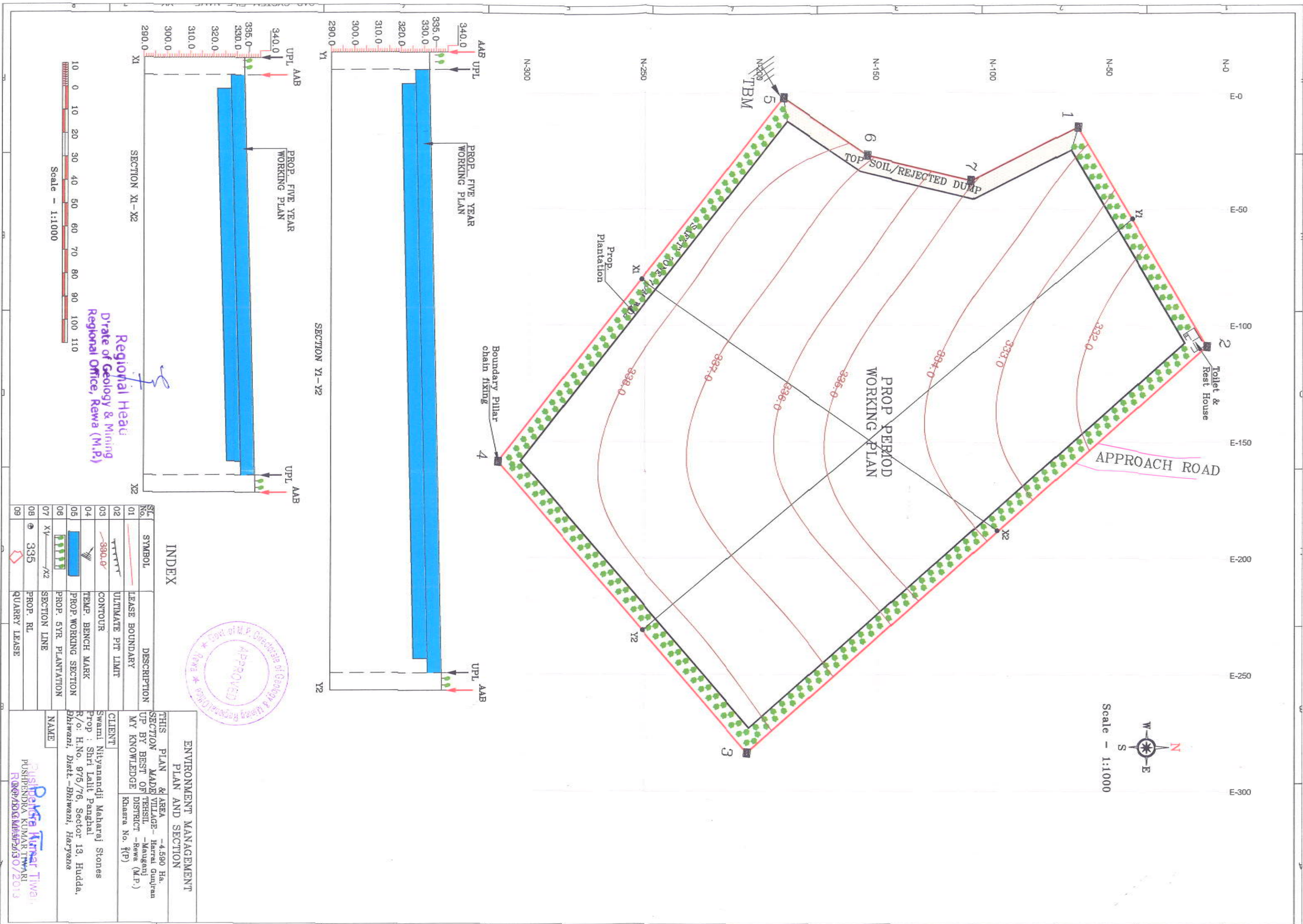

INDEX

Sl. No.	SYMBOL	DESCRIPTION
01	-----	LEASE BOUNDARY
02	-----	ULTIMATE PIT LIMIT
03	-----	CONTOUR
04	-----	TEMP. BENCH MARK
05	-----	PROP. WORKING SECTION
06	-----	PROP. 5YR. PLANTATION
07	-----	SECTION LINE
08	-----	PROP. RL
09	-----	QUARRY LEASE

ENVIRONMENT MANAGEMENT PLAN AND SECTION

THIS PLAN & AREA	-4.590 Ha.
SECTION MADE	VILLAGE - Harrai Gunjan
UP BY BEST OF	TEHSIL - Manganj
MY KNOWLEDGE	DISTRICT - Rewa (M.P.)
CLIENT	Swami Nityanandji Maharaj Stones
	Prop : Shri Lalit Panghal
	R/o : H.No. 975/76, Sector 13, Hudda,
	Bhivani, Distt.-Bhivani, Haryana
NAME	Pushpendra Kumar Tiwari
	ROEP/DOA/MH/2013/2013



Regional Head  
D'tate of Geology & Mining  
Regional Office, Rewa (M.P.)



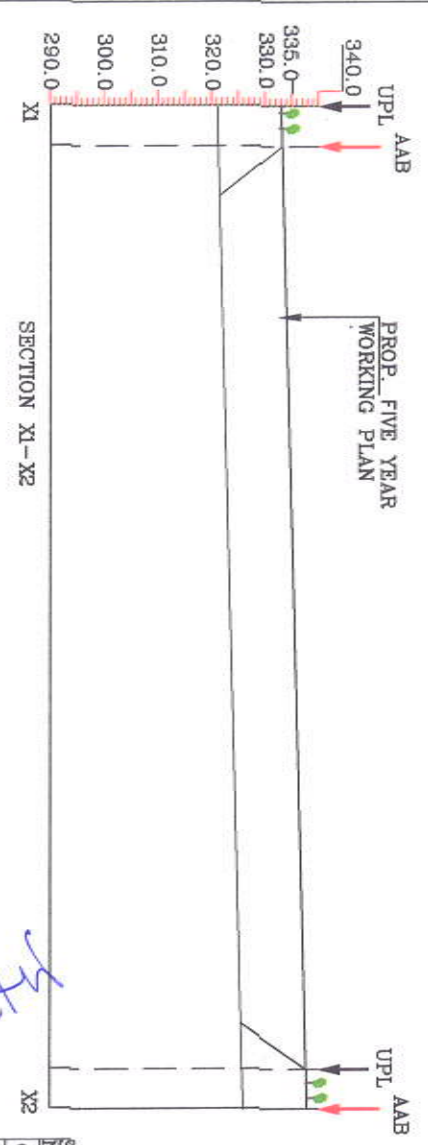
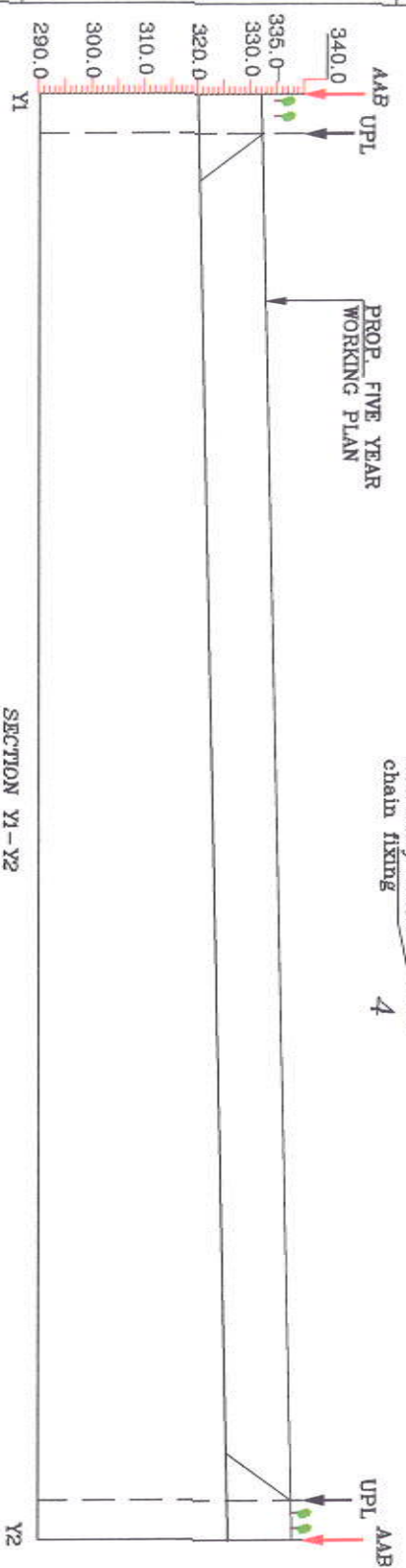
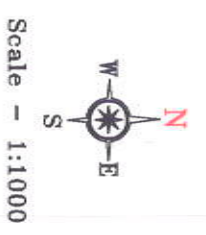
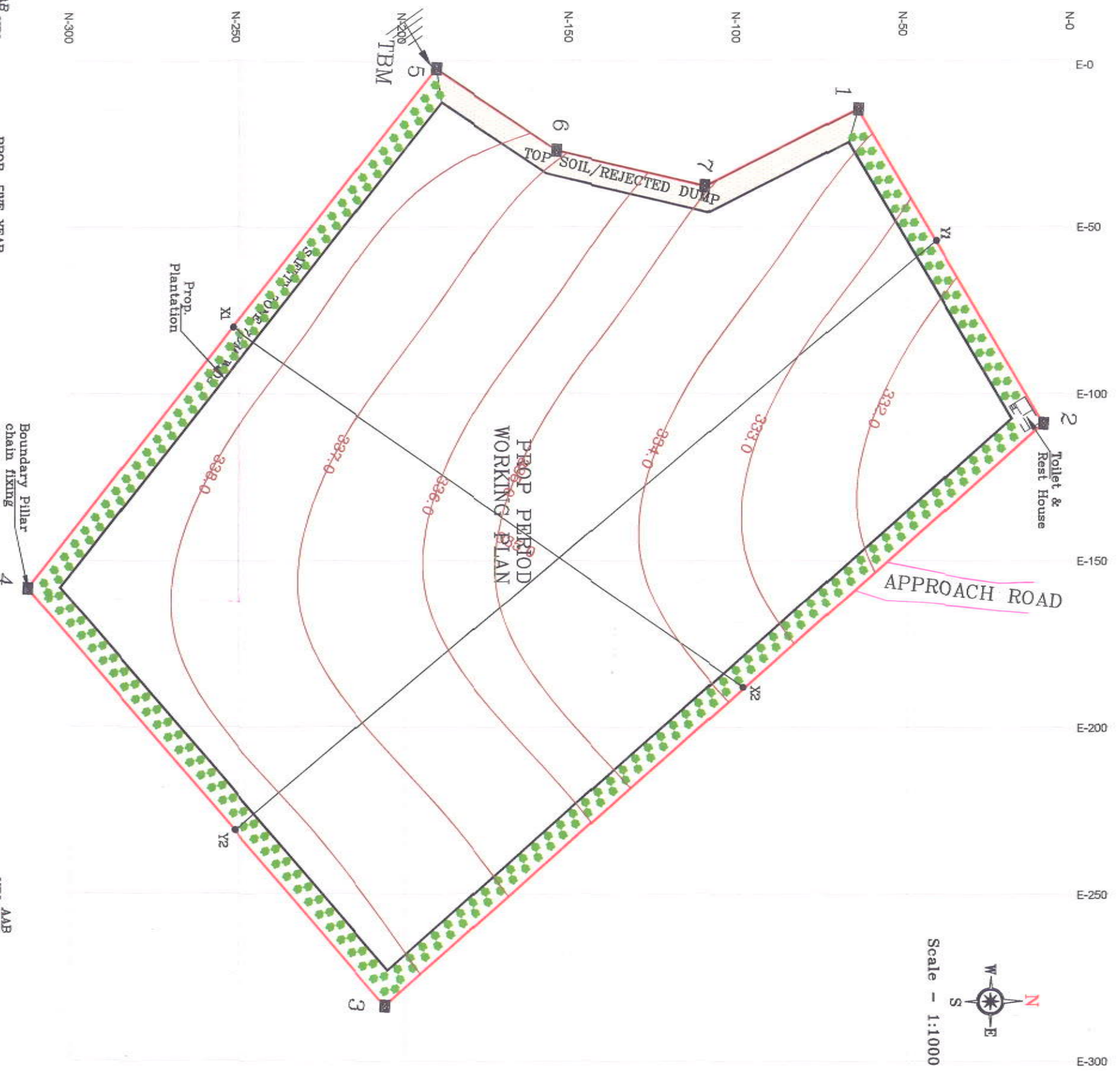

# INDEX

S.No.	SYMBOL	DESCRIPTION
01	-----	LEASE BOUNDARY
02	-----	ULTIMATE P.T. LIMIT
03	-----	CONTOUR
04	-----	TEMP. BENCH MARK
05	-----	PROP. WORKING SECTION
06	-----	PROP. 5YR. PLANTATION
07	-----	SECTION LINE
08	-----	PROP. RL
09	-----	QUARRY LEASE

# PROP. SURFACE & GEOLOGICAL PLAN

THIS PLAN & AREA - 4.590 Ha.	CLIENT
SECTION MADE VILLAGE - Harrai Gungun	Swami Nityanandji Maharaj Stones
UP BY BEST OF DISTRICT - Rewa (M.P.)	Prop : Shri Lalit Penghal
MY KNOWLEDGE	R/o : H.No. 976/76, Sector 13, Hudda,
	Bhiwani, Distt.-Bhiwani, Haryana
	NAME
	P. V. T. Tiwari
	PO/POA/KUMAR TTV/ARI
	KOP/POA/M.P.30/2013



Scale - 1:1000

Regional Head  
Director of Geology & Mining  
Regional Office, Rewa (M.P.)



Scale - 1:1000

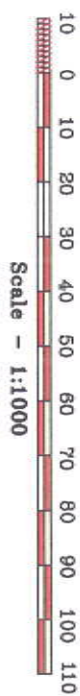
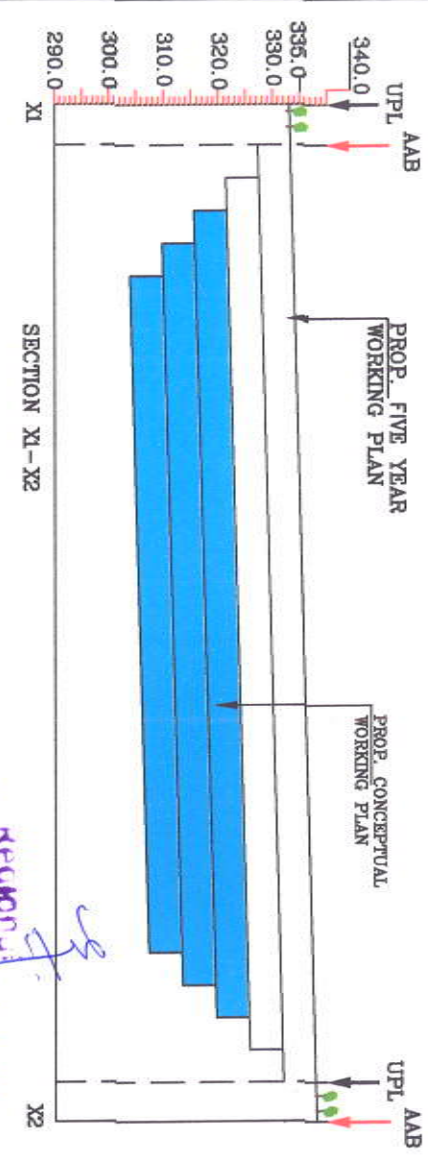
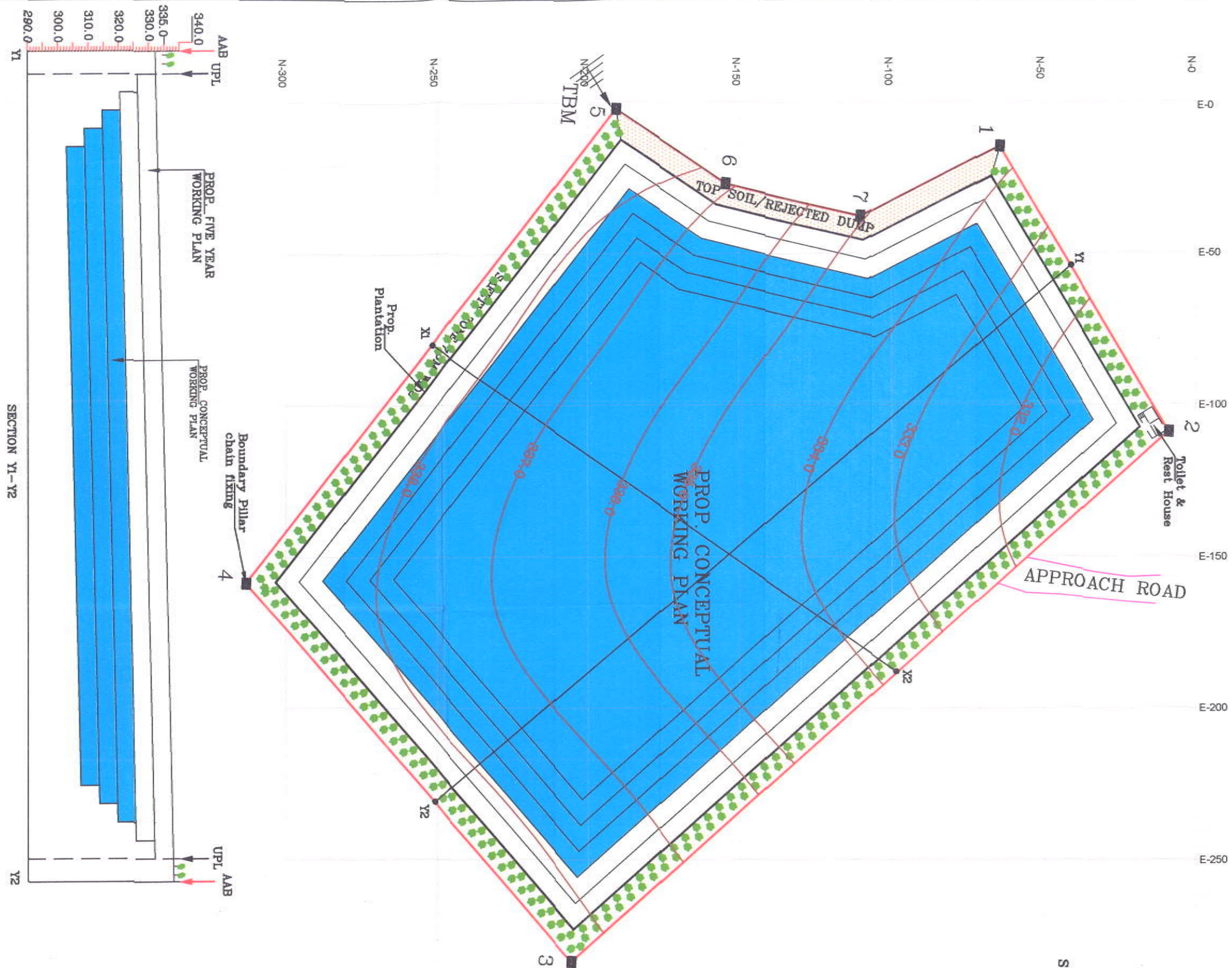
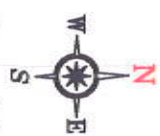

Scale - 1:1000

# INDEX

Sl. No.	SYMBOL	DESCRIPTION
01	-----	LEASE BOUNDARY
02	-----	ULTIMATE PIT LIMIT
03	-----	CONTOUR
04	-----	TEMP. BENCH MARK
05	-----	PROP. WORKING SECTION
06	-----	PROP. 5YR. PLANTATION
07	-----	SECTION LINE
08	-----	PROP. RL
09	-----	QUARRY LEASE

# CONCEPTUAL PLAN AND SECTION

THIS PLAN & AREA	-4.590 Ha.
SECTION MADE BY	MADE BY BEST OF
UP BY BEST OF	THSIL, -Maugan
MY KNOWLEDGE	DISTRICT -Rewa (M.P.)
CLIENT	Swami Nityanandji Maharej Stones
	Prop : Shri Lalit Panghal
	R/o: H.No. 975/76, Sector 13, Huda,
	Bhiwani, Distl.-Bhiwani, Haryana
NAME	



PUSHENDRA KUMAR TIWARI  
R.O/DGM MP/30/2013  
RQP/DEMMP/30/2013

Regional Office of Geology & Mining  
Regional Office, Rewa (M.P.)



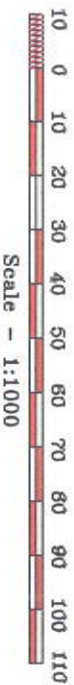
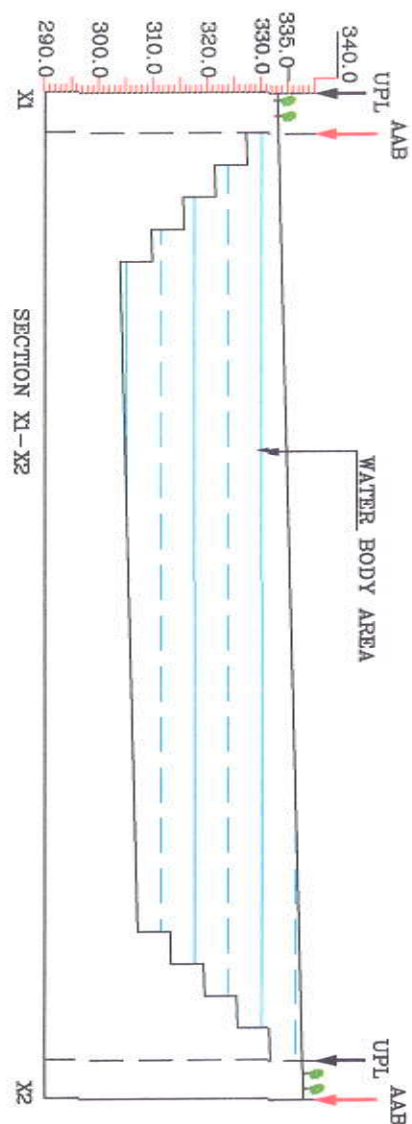
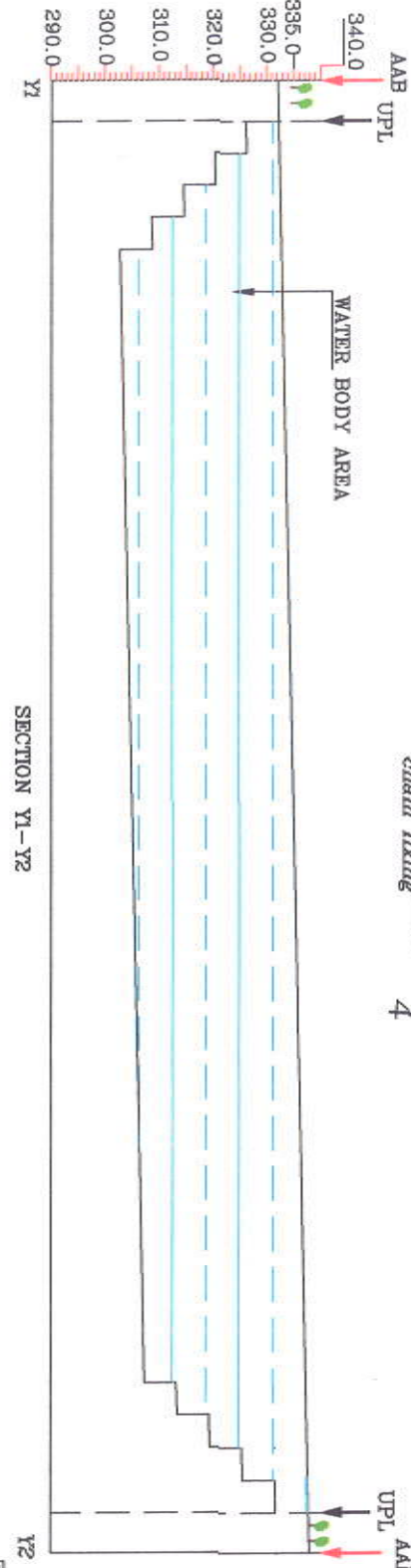
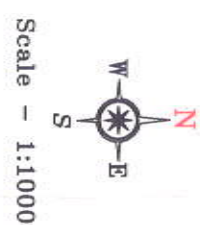
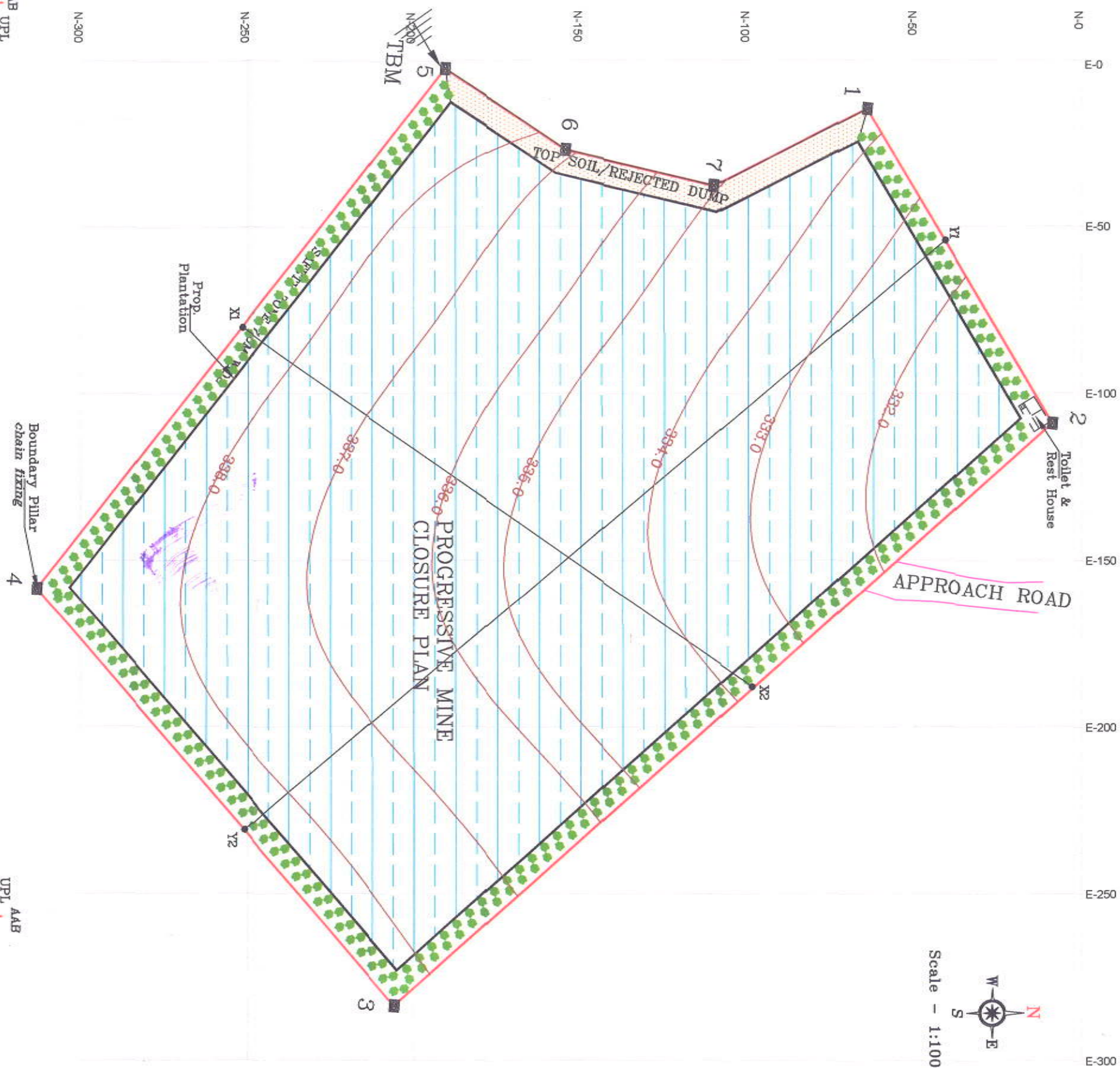

**Regional Head**  
**Directorate of Geology & Mining**  
 Regional Office, Rewa (M.P.)

Y2 INDEX

SIL. NO.	SYMBOL	DESCRIPTION
01	—	LEASE BOUNDARY
02	—	ULTIMATE PTT LIMIT
03	—	CONTOUR
04	—	TEMP. BENCH MARK
05	—	PMCP WORKING
06	—	PMCP PLANTATION
07	—	WATER BODY AREA

**PROGRESSIVE MINE CLOSURE PLAN**

THIS PLAN AREA - 4.560 Ha.  
 SECTION MADE AT VILLAGE - Harrai Gunjan  
 UP BY BEST OF DISTRICT - Rewa (M.P.)  
 MY KNOWLEDGE Khazra No. 1(P)

**CLIENT**  
 Swami Nityanandji Maharaj Stones  
 Prop : Shri Lalit Panghal  
 R/o: H.No. 975/76, Sector 13, Hudda,  
 Bhiwani, Distt.-Bhiwani, Haryana

**NAME**  
**P. S. Tiwari**  
 P. S. Tiwari  
 ROP/100000/2013



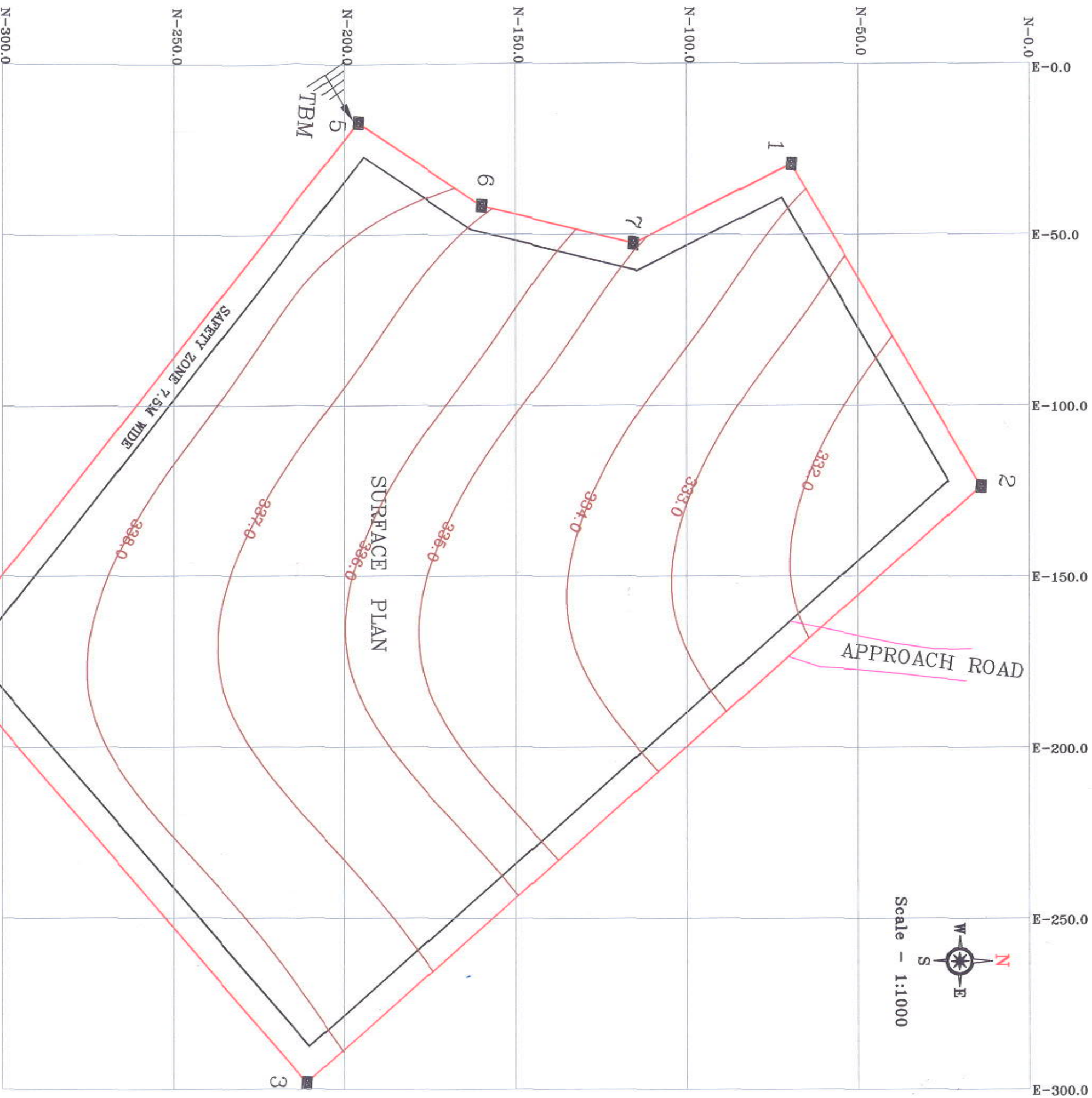

Scale - 1:1000

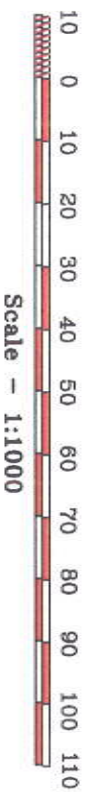

Scale - 1:1000



Regional Office  
Directorate of Geology & Mining  
Regional Office, Rewa (M.P.)

INDEX

Sl. No.	SYMBOL	DESCRIPTION
01		LEASE BOUNDARY
02		ULTIMATE PTT LIMIT
03		CONTOUR /RL
04		TEMP. BENCH MARK
05		SPOT LEVEL
06		QUARRY LEASE
07		

SURFACE PLAN

THIS PLAN & AREA - 4.560 Ha.  
SECTION MADE VILLAGE - Harrai Gunjan  
UP BY BEST OF DISTRICT - Mauganj  
MY KNOWLEDGE - Rewa (M.P.)  
Khazra No. 8(P)

CLIENT  
Swami Mityanandji Maharaj Stones  
Prop : Shri Laiti Panghal  
R/o : H.No. 975/76, Sector 13, Hudda,  
Bilwani, Distt.-Bilwani, Haryana

NAME

P. S. Tiwari  
PUSHPENDRA KUMAR TIWARI  
RWP/2024 MP/09/2023/2013



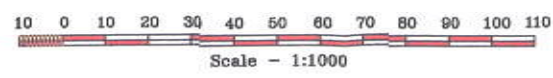
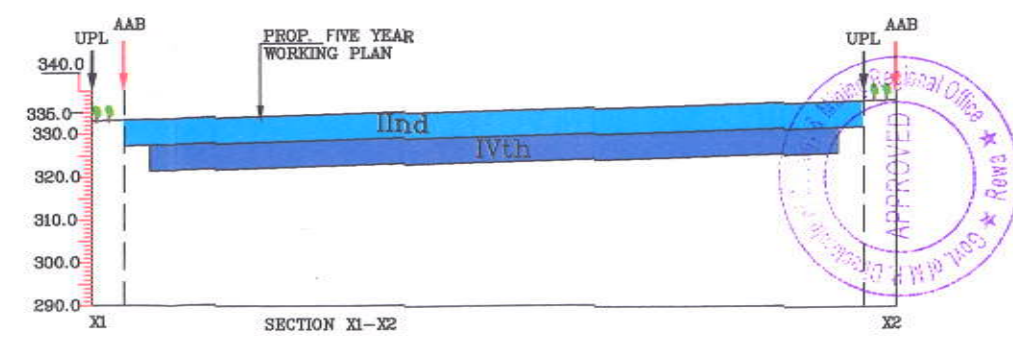
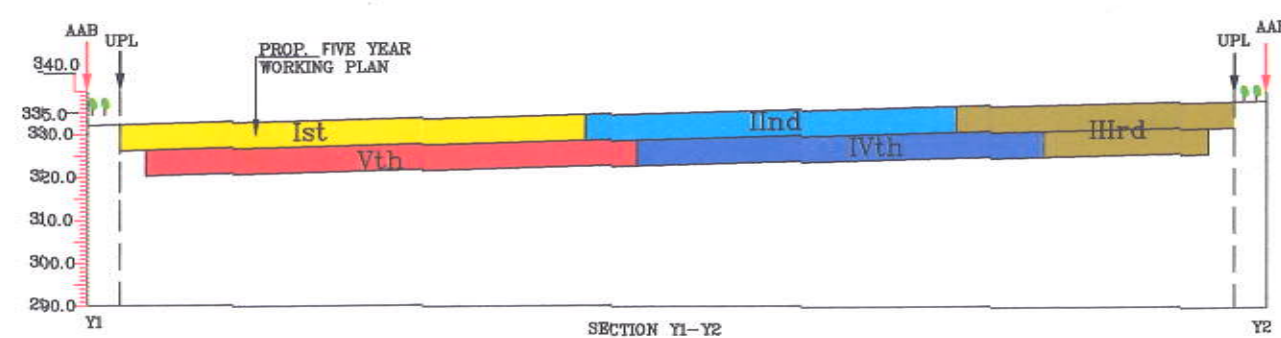
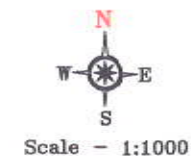

# INDEX

SL. No.	SYMBOL	DESCRIPTION
01	—	LEASE BOUNDARY
02	———	ULTIMATE PIT LIMIT
03	330.0	CONTOUR
04	—	TEMP. BENCH MARK
05	—	PROP. 5 YEAR WORKING
06	—	PROP. 5 YR. PLANTATION
07	X1—X2	SECTION LINE
08	335.0	PROP. RL
09	◇	QUARRY LEASE

# PROP. FIVE YEAR PLAN & SECTION

THIS PLAN & SECTION MADE UP BY BEST OF MY KNOWLEDGE

AREA — 4.590 Ha.  
VILLAGE — Harrai Gunjan  
TEHSIL — Mauganj  
DISTRICT — Rewa (M.P.)  
Khasra No. 1(P)

CLIENT  
Swami Nityanandji Maharaj Stones  
Prop : Shri Lalit Panghal  
R/o: H.No. 975/76, Sector 13, Hudda,  
Bhiwani, Distt.—Bhiwani, Haryana

NAME Pushendra Kumar Tiwari  
PUSHPENDRA KUMAR TIWARI  
RQP/2013/003

