

Georeferenced Map of Proposed Forest Land to be Diversion For 132kv Along Ramsanehighat - Burhwal Road TSS Transmission Line in Barabanki District (Uttar Pradesh)

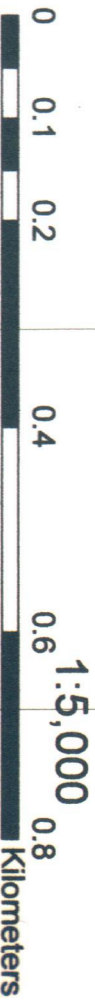
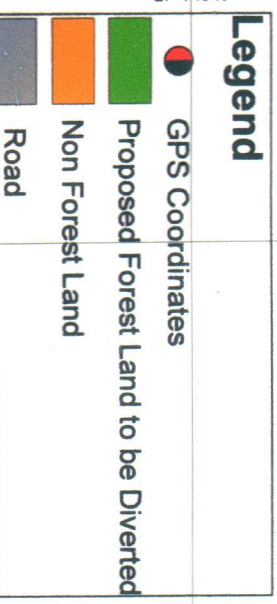
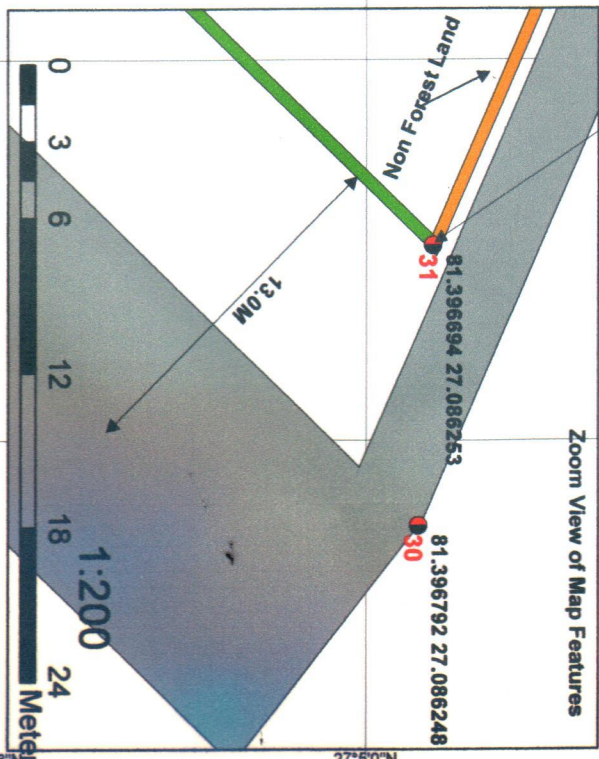
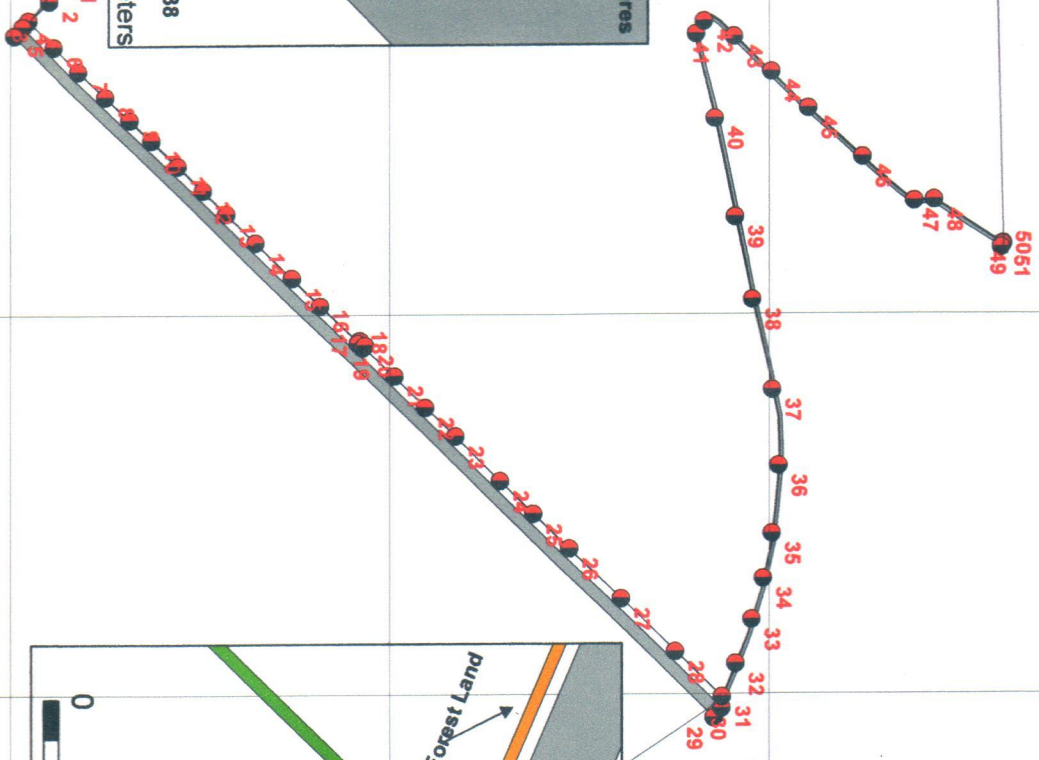
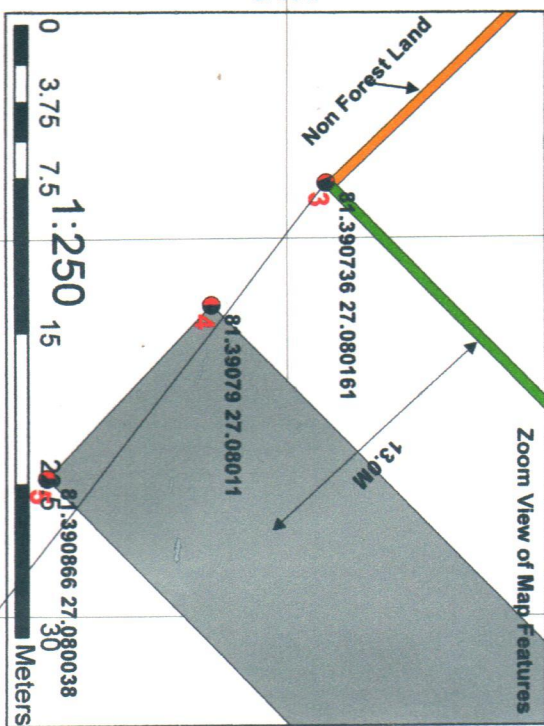
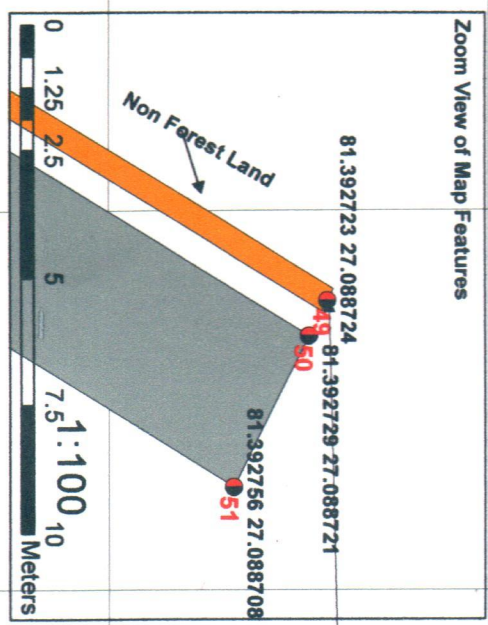

Executive Engineer

Electricity Transmission Division-III

U.P. Power Corporation Ltd.

Map prepared on the basis of GPS Coordinates and Sata Information Provided by User Agency