

Georeferenced Map of Proposed Reliance 4G Project for for Laying of Optical Fibre Cable (OFC) along with road on NH-24 (Delhi-Lucknow Road) from Km.464.700 to Km. 489.00, on SH-25 (Lucknow-Hardoi Road) from Km. 224.000 to Km. 262.50, on SH - (Lucknow - Sultanpur Road) (Somnath Dwar - Shaheed Path (via Arjun Ganj)) from Km. 3.35 to Km. 10, on SH- Luknow-Sultanpur road (Hazratganj Chauraha - Mayawati Aawas)from KM.00 TO KM.2.00, on Lucknow-Sultanpur (Arjunganj-link Saheed path) KM. 10.00 to KM. 11.50, on NH-24B (Lucknow-Raebareli) from Km. 5.500 to Km. 18.00, & on NH-24B (Lucknow-Raebareli) from Km 18.00 to KM.23.00
Total Km. 90.45 & 0.9533 Ha. in Social Forestry Division Lucknow, District: Lucknow - UP.

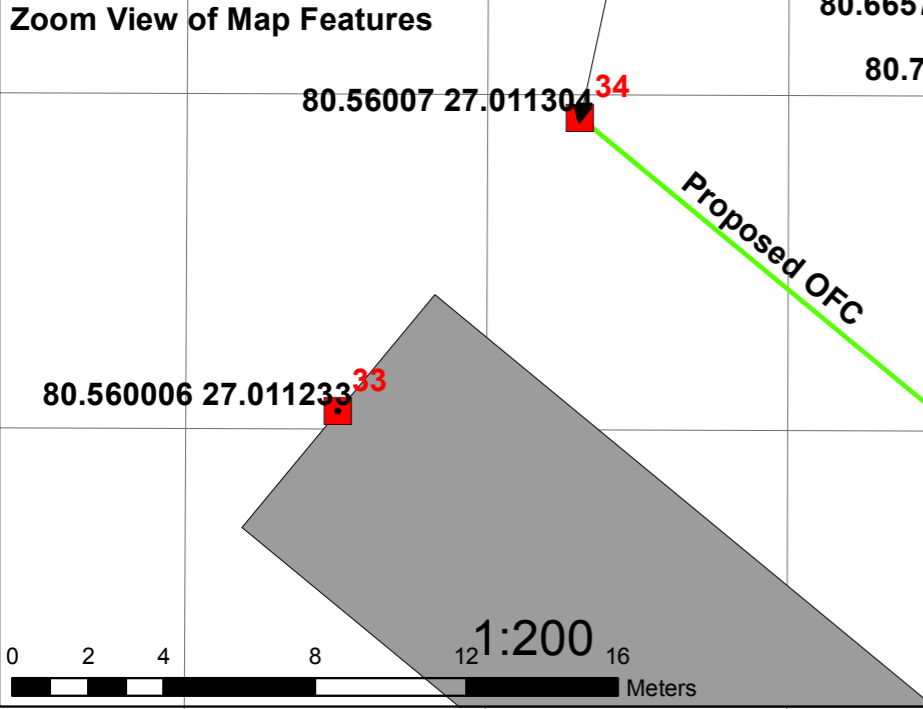

Legend

- GPS Coordinates
- Divider
- Proposed OFC
- Road

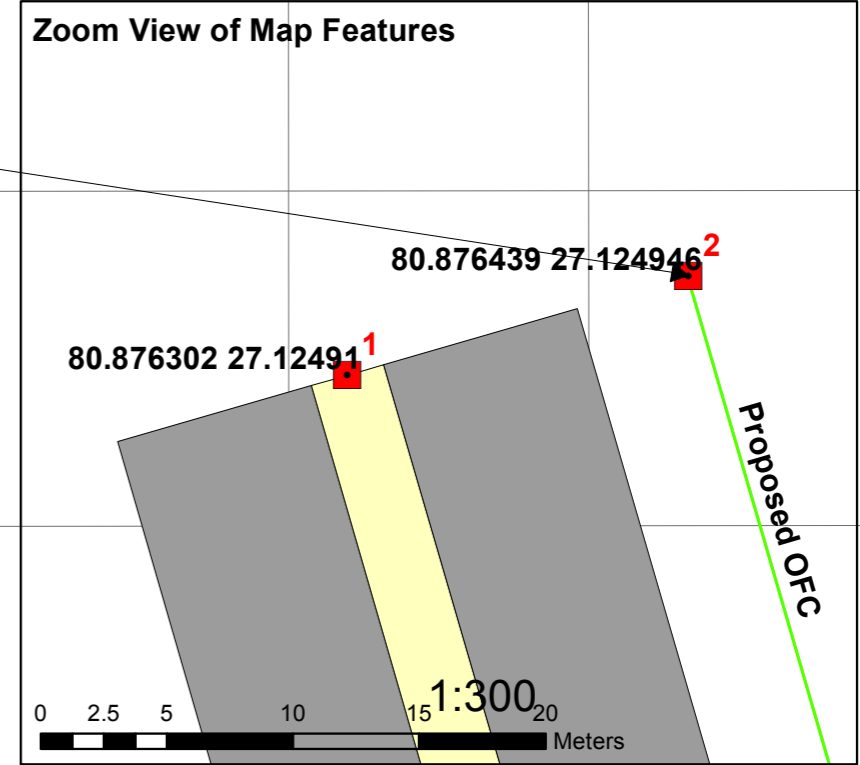
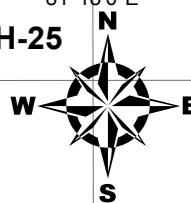
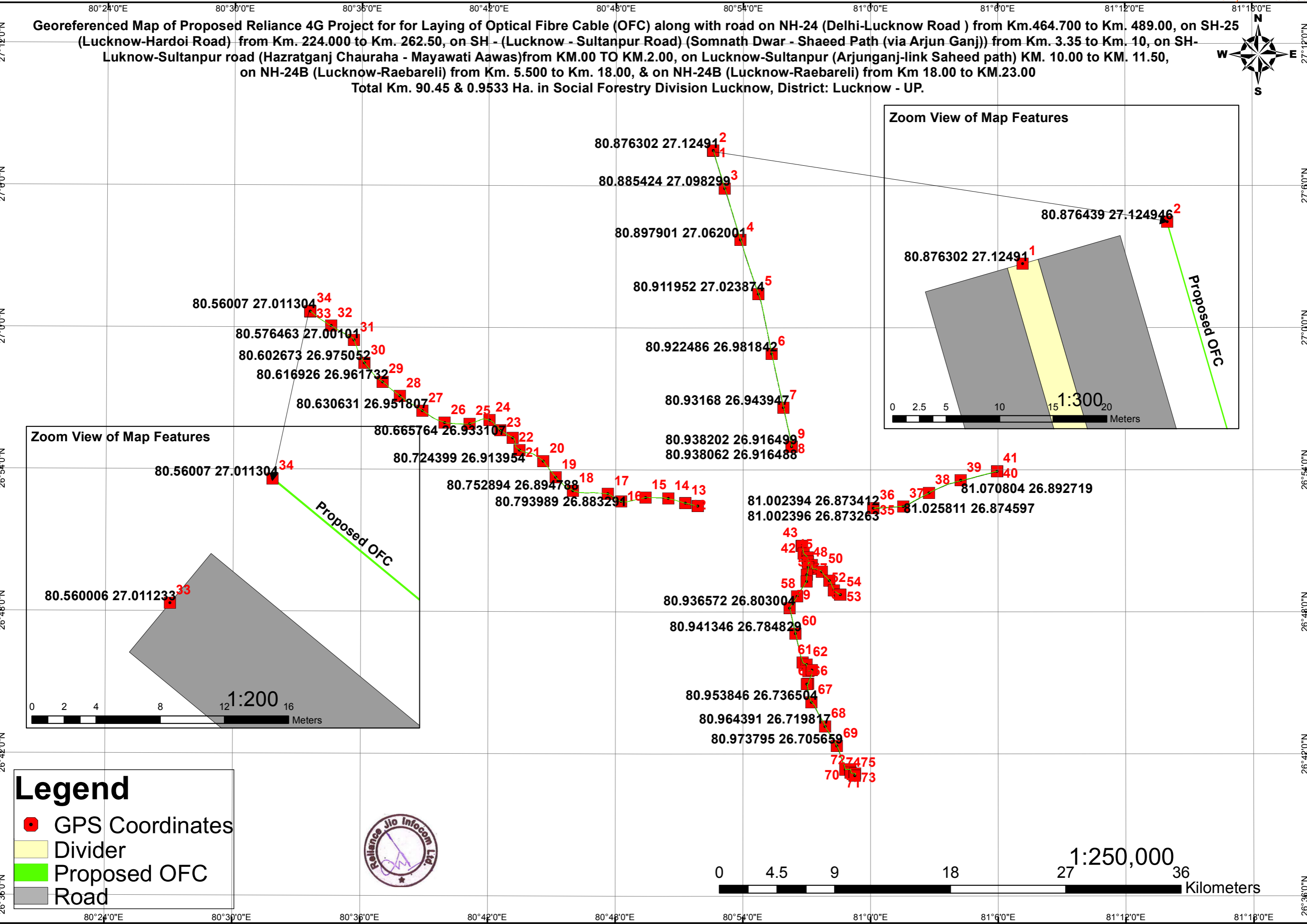
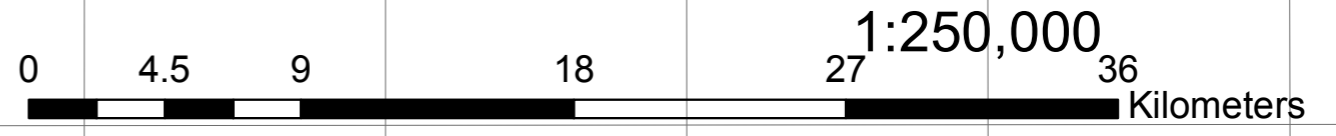

Note: Map prepared on the basis of GPS Coordinates and Site information Provided by User Agency

Prepared By: NRM Geomatics Pvt.Ltd. Lucknow