

*Alphabeta*  
 Project Director  
 National Highways Authority of India

ROW  
 PROPOSED CENTER LINE  
 FOREST LAND TO BE DIVERTED

Consultant:  
**SA** S.A. Infrastructure Consultants Pvt. Ltd.  
 1101A, 11 Floor Tower A-II, Ansal Corporate Park,  
 Plot No. 7A/1, Sector 142, Noida-201301 (Uttar Pradesh)  
 Phone No- 0120-6148000 Fax-0120-6148090  
 Email : info@sainfra.com

Client : National Highways Authority Of India  
 Project: Construction of Four Laning of Rajauli-Bakhtiyarpur section from Km 101+630 to Km 152+520 (Package-III) of NH-31 in the State of Bihar.

Drawing Title :  
 DGPS MAP  
 Ch: 123+000 to Ch: 125+000  
 (District - Nalanda)

DRAWING NO: I/1892/DGPS/1  
 DATE: JUNE 2013  
 SCALE: Horizontal 1:2000  
 SHEET: 1 OF 5

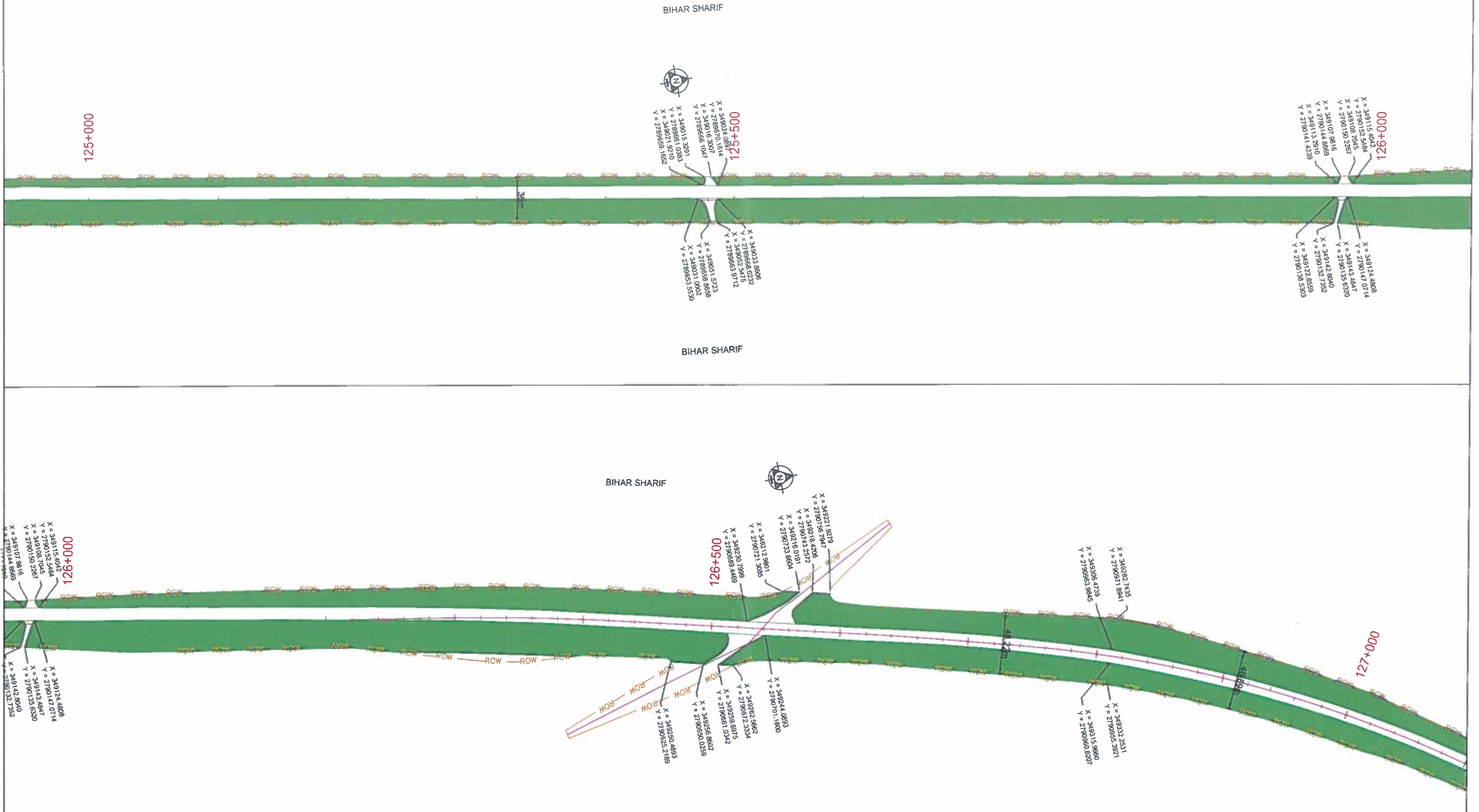

*Shakun*  
 Project Director  
 National Highways Authority of India  
 Project Implementation Unit

ROW	
PROPOSED CENTER LINE	
FOREST LAND TO BE DIVERTED	

Consultant:  
 S.A. Infrastructure Consultants Pvt. Ltd.  
 1101A, 11 Floor Tower A-II, Ansal Corporate Park,  
 Plot No. 7A/1, Sector 142, Noida-201301 (Uttar Pradesh)  
 Phone No- 0120-8148000 Fax-0120-8148090  
 Email : info@sainfra.com

Client: National Highways Authority Of India  
 Project: Construction of Four Laning of Rajauli-Bakhtiyarpur section from Km 101+630 to Km 152+520 (Package-III) of NH-31 in the State of Bihar.

Drawing Title :  
 DGPS MAP  
 Ch: 125+000 to Ch: 127+000  
 (District - Nalanda)

DRAWING NO : 0131892/DGPS/2	SCALE : Horizontal 1:2000
DATE : JUNE 2019	SHEET 2 OF 5

Size A3



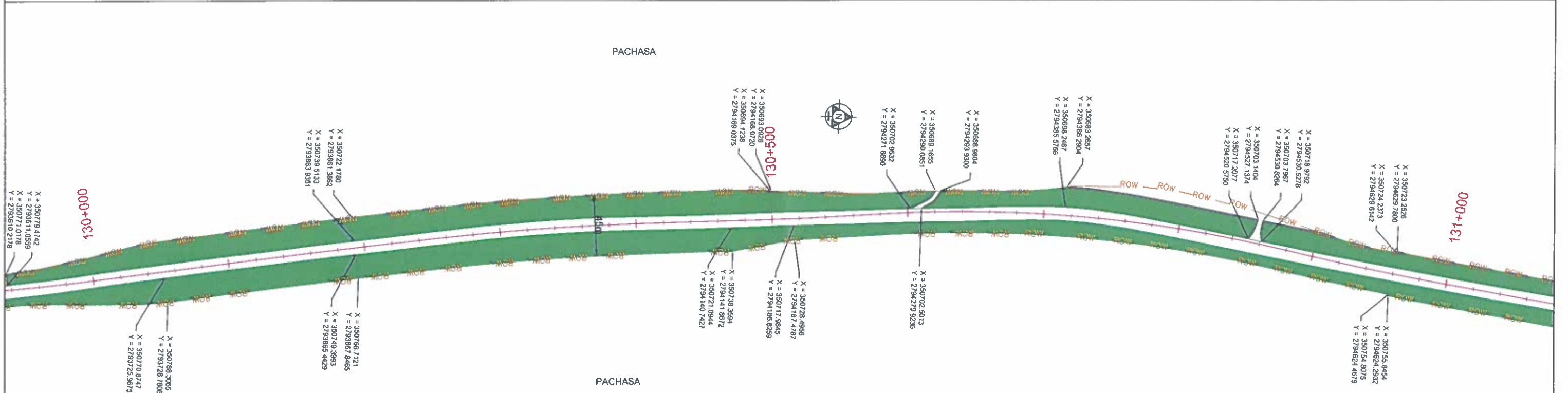
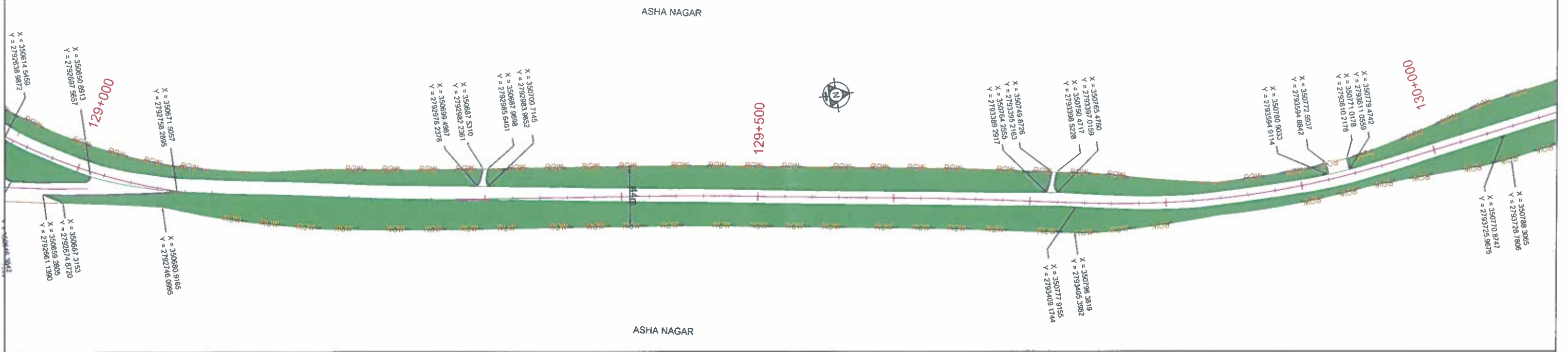

ROW  
 PROPOSED CENTER LINE  
 FOREST LAND TO BE DIVERTED

Consultant:  
  
**S.A. Infrastructure Consultants Pvt. Ltd.**  
 1101A, 11 Floor Tower A-II, Ansal Corporate Park,  
 Plot No. 7A/1, Sector 142, Noida-201301 (Uttar Pradesh)  
 Phone No- 0120-6148000 Fax-0120-6148090  
 Email : info@sainfra.com

Client:  National Highways Authority Of India  
 Project: Construction of Four Laning of Rajauli-Bakhtiyarpur section from Km 101+630 to Km 152+520 (Package-III) of NH-31 in the State of Bihar.

Drawing Title :  
**DGPS MAP**  
 Ch: 129+000 to Ch: 131+000  
 (District - Nalanda)

DRAWING NO: 0131892/DGPS/4  
 DATE: JUNE 2019  
 SCALE: Horizontal 1:2000  
 SHEET: 4 OF 5

*Ashak*  
 Project Director  
 National Highways Authority of India  
 Project Implementation Unit

Patel Sir

← RAJAULI

BAKHTIYARPUR →

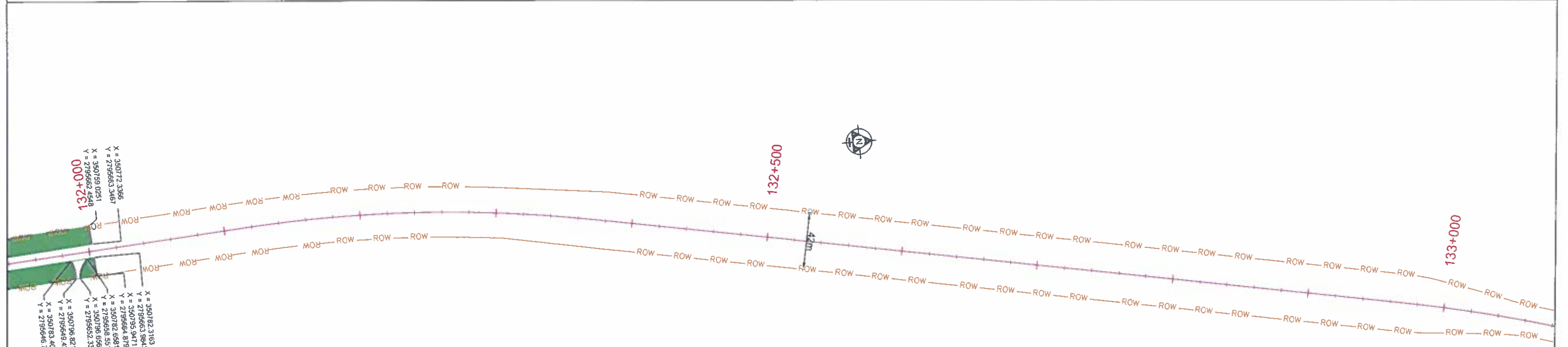
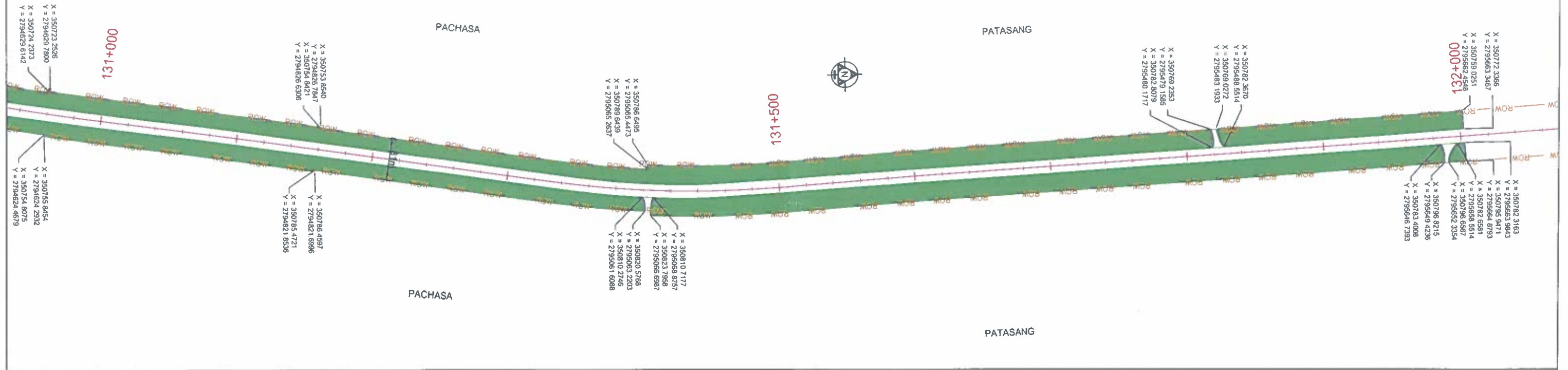

ROW  
 PROPOSED CENTER LINE  
 FOREST LAND TO BE DIVERTED

Consultant:  
 **S.A. Infrastructure Consultants Pvt. Ltd.**  
 1101A, 11 Floor Tower A-II, Ansal Corporate Park,  
 Plot No. 7A/1, Sector 142, Noida-201301 (Uttar Pradesh)  
 Phone No- 0120-6148000 Fax-0120-6148000  
 Email : info@sainfra.com

Client :  National Highways Authority Of India  
 Project: Construction of Four Laning of Rajauli-Bakhtiyarpur section from Km 101+630 to Km 152+520 (Package-III) of NH-31 in the State of Bihar.

Drawing Title :  
**DGPS MAP**  
 Ch: 131+000 to Ch: 133+000  
 (District - Nalanda)

DRAWING NO: 013193/DGPS/15  
 DATE: JUNE 2019  
 SCALE: Horizontal 1:2000  
 SHEET 5 OF 5  
 PATNA

  
**Project Director**

National Highways Authority of India

Power Size