

165

Shri Bharatbhai Nagjibhai Talavia
"Gandhi Smruti-2", Street No. 2
Maruti 50 Ft. Road,
Kuvadava Road, RAJKOT
Date : 12/09/2018

To,
Deputy Conservator of Forest,
Morbi Forest Division,
Morbi.

Sub. : Diversion of 0.21 Ha. Forest land for laying approach road for Industrial purpose at Village : Jiyana, Tal. Dist. Rajkot

Ref. : Govt. Letter dtd. 4.9.2018

Respected Sir,

In connection with the subjected cited above and letter under reference it is to state that, on our proposal for approach road from forest land from Kuvadva – Wankaner Highway Govt. has asked the clarification that there is existing road to approach the field from village Jiyana. In this regards it is to clarity that :

01. The project is an Industrial Project which envisages Thousand of Mandays and government policy is also to appreciate the Industry.
02. Existing road indicated in the letter under reference comes from Village Jiyana which is only field cart track. The Road is very narrow and having very uneven bed with up & downs in the surface. To widen this narrow road about 15 to 20 khatedars were contacted but no one is ready to give their land even on sell basis at any cost. Hence it is not possible to widen this read and heavy industrial vehicles can't pass from it.

Due to about difficulty very near from Highway and using minimum land of forest and in the Govt. Interest proposal for this road is submitted.

So it is requested to take further necessary actions for approval to the submitted proposal please.

Yours faithfully, **MARUTI INDUSTRIES.**

ગુણગુણી બી 212

[Bharatbhai Nagjibhai Talavia]

Partner.

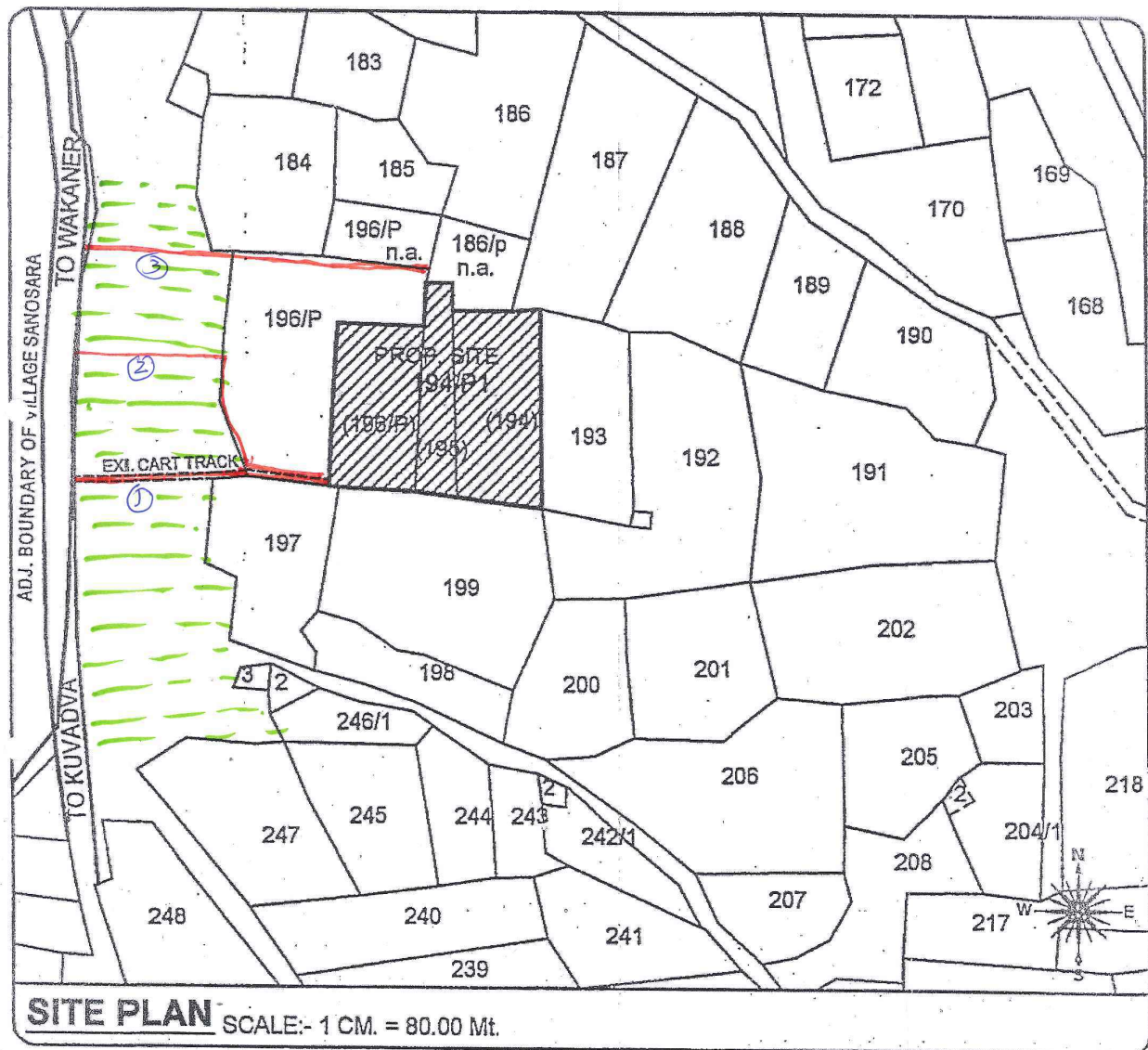

Forest area
Proposed land