

NEAR PLAN FOR CONSTRUCTION OF 2 LANE ROAD OVER BRIDGE ON DELHI BHATINDA

SECTION AT JIND.

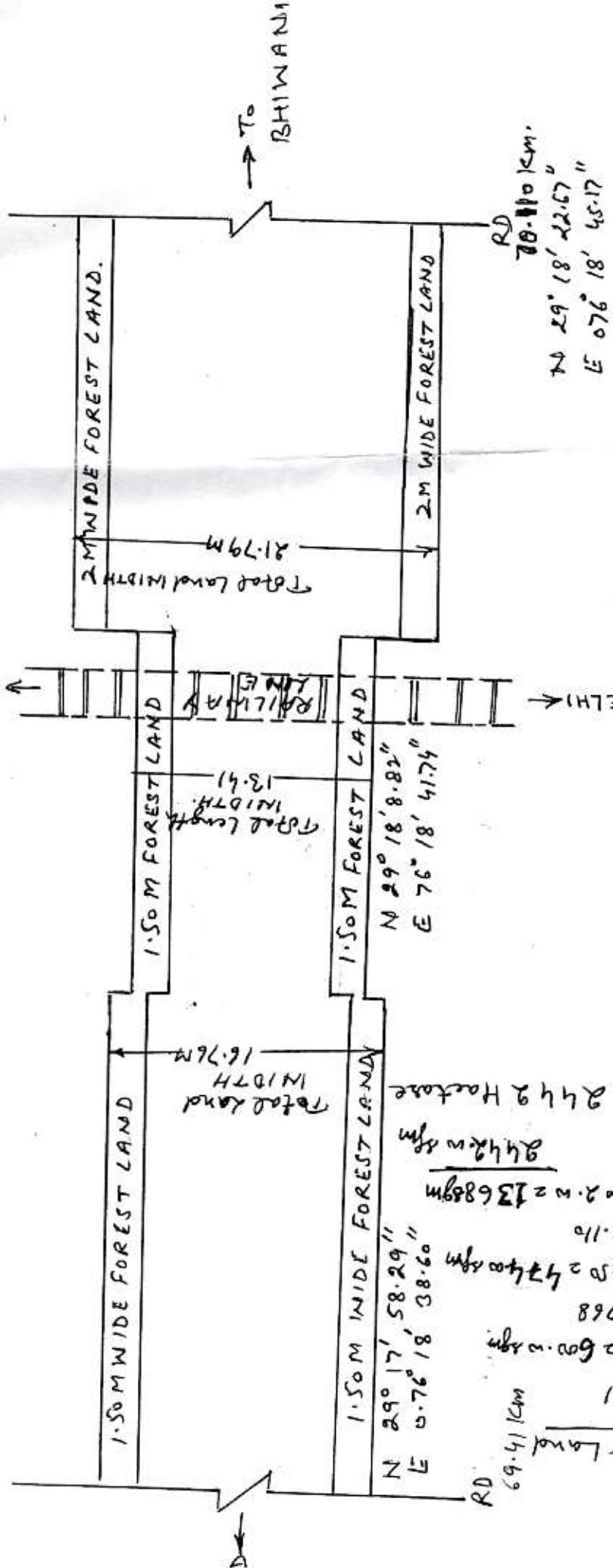

Sub Divisional Engineer,
 Provincial Sub-Division No-II
 PWD B&R Br. JIND

Executive Engineer
 Provn. Divn. JIND

Total Forest Land
 RD 69.41 to 69.61
 = 2020 x 1.50 = 600.00 sqm
 RD 69.61 to 69.768
 = 2 x 158 x 1.50 = 474.00 sqm
 RD 69.768 to 70.110
 = 2024 x 2.00 = 1368.80 sqm
 2442.80 sqm
 or 0.2442 Hectare

8800
 25