

DIVERSION OF 4.5769 HECTARE OF FOREST LAND FOR DEVELOPMENT OF AIRPORT IN SY NO. 12 OF SIRIYURU VILLAGE, IN FAVOUR OF EXECUTIVE ENGINEER KARNATAKA PUBLIC WORKS DEPARTMENT SHIVAMOGGA

Legend

- GPS Points
- Proposed Area ILS
- Airport Outer Boundary
- Village_Boundary

N
W E
S
1:15,000

Sl No.	Component Name	Village Name	Survey No.	Extent in Ha
1	Instrument Landing System	Shiriyuru	12	4.576995

GPS Points Proposed Area WGS-84		
ID No.	Latitdue	Longitude
1	13.862506	75.637886
2	13.863607	75.642555
3	13.862844	75.642863
4	13.861742	75.637753

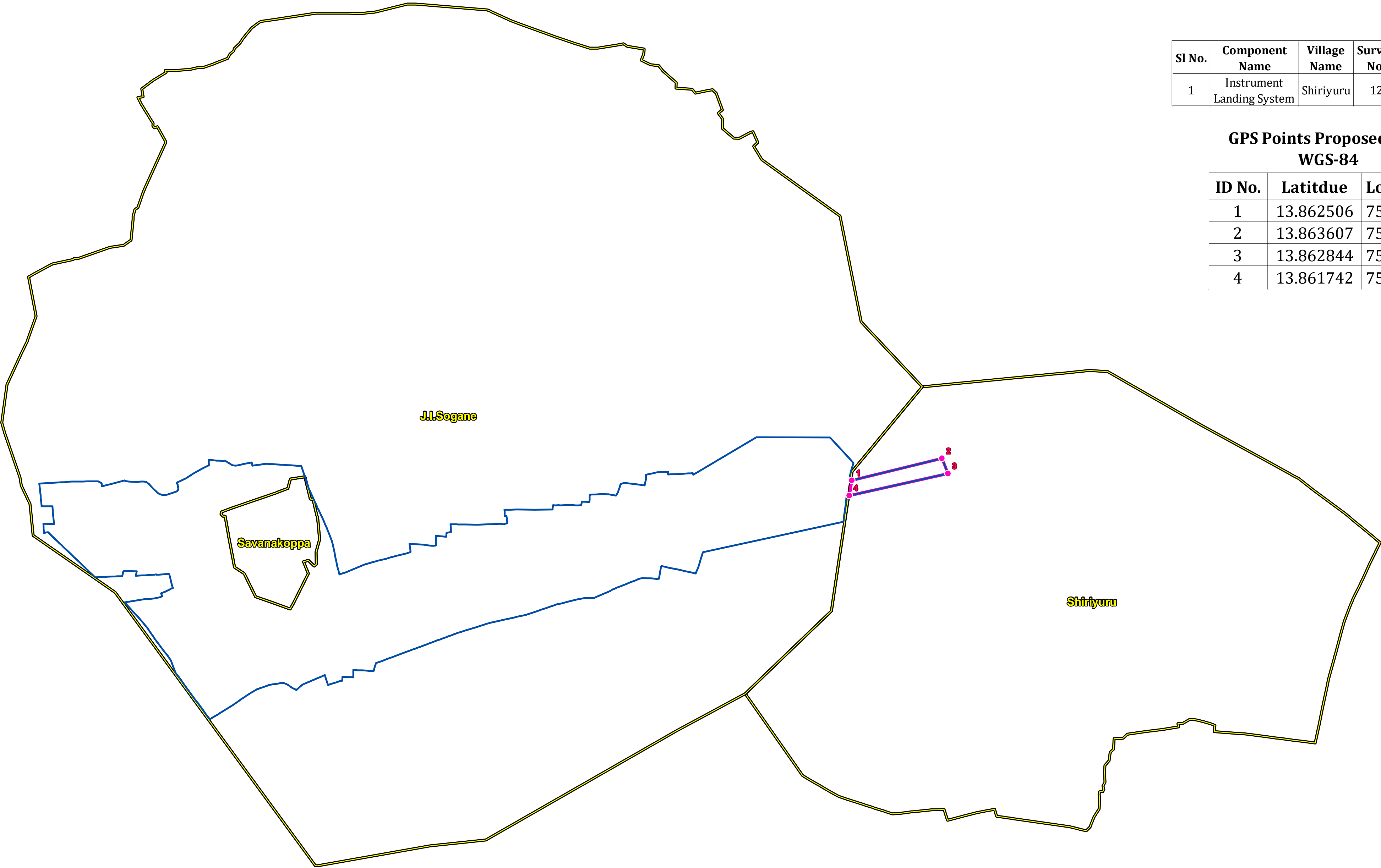

ತಮ್ಮ ವಿಶ್ವಾಸಿ,
(ಎಂ. ಸಂಪತ್ ಕುಮಾರ್ ಸಿಂಗ್)
ಕಾರ್ಯಪಾಲಕ ಇಂಜಿನಿಯರ್,
ಲೋ.ಇ. ವಿಶೇಷ ವಿಭಾಗ, ಶಿವಮೊಗ್ಗ.

DIVERSION OF 4.5769 HECTARE OF FOREST LAND FOR DEVELOPMENT OF AIRPORT IN SY NO. 12 OF SIRIYURU VILLAGE, IN FAVOUR OF EXECUTIVE ENGINEER KARNATAKA PUBLIC WORKS DEPARTMENT SHIVAMOGGA

Legend

●

GPS Points

Proposed Area ILS

Airport Outer Boundary

Shiriyuru_Village

N

W

E

S

1:2,000

Sl No.	Component Name	Village Name	Survey No.	Extent in Ha
1	Instrument Landing System	Shiriyuru	12	4.576995

GPS Points Proposed Area WGS-84		
ID No.	Latitdue	Longitude
1	13.862506	75.637886
2	13.863607	75.642555
3	13.862844	75.642863
4	13.861742	75.637753

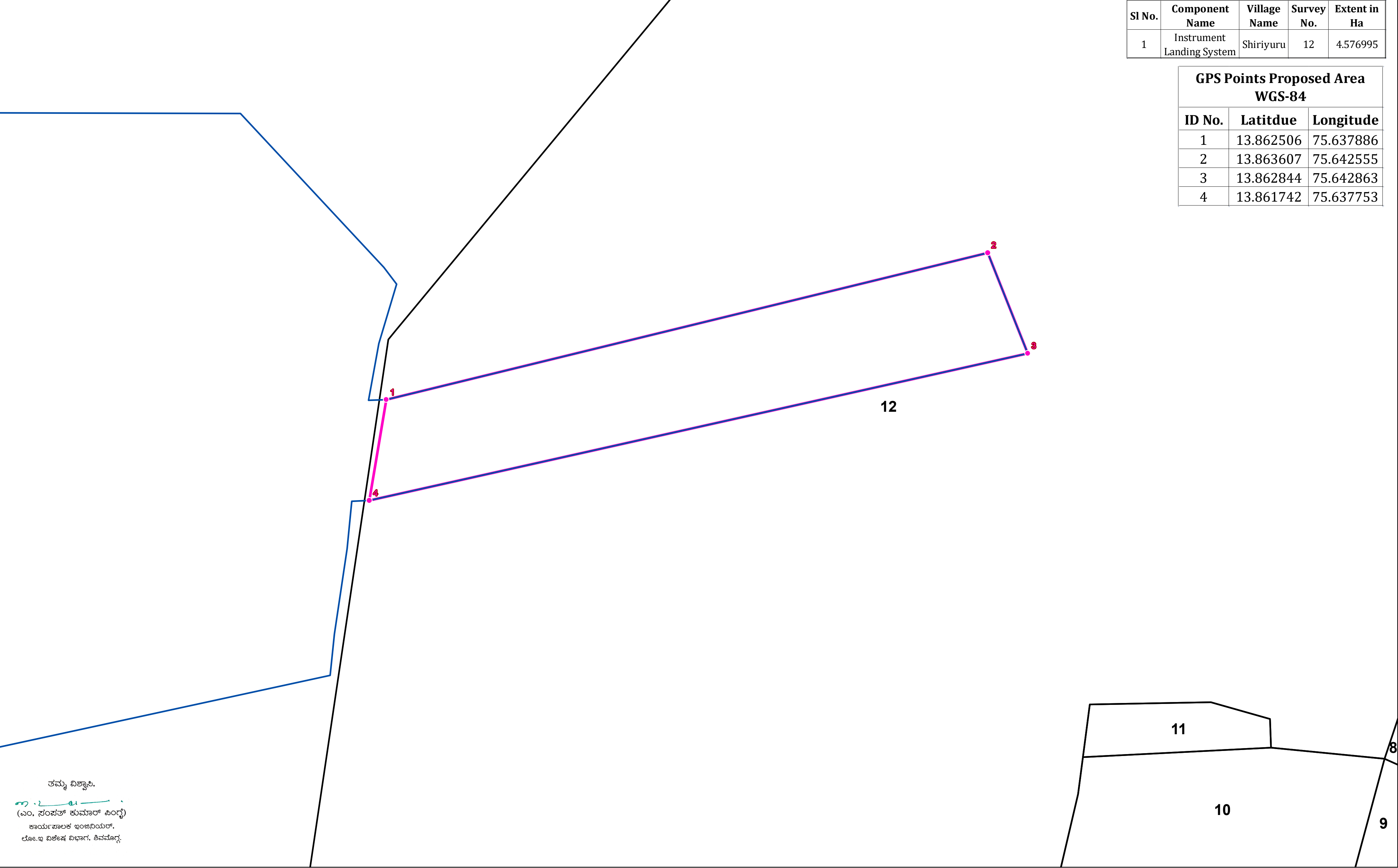

ತಮ್ಮ ವಿಶ್ವಾಸಿ,
(ಎಂ. ಸಂಪತ್ ಕುಮಾರ್ ಸಿಂಗ್)
ಕಾರ್ಯಪಾಲಕ ಇಂಜಿನಿಯರ್,
ಲೋ.ಇ. ವಿಶೇಷ ವಿಭಾಗ, ಶಿವಮೊಗ್ಗ.

DIVERSION OF 4.5769 HECTARE OF FOREST LAND FOR DEVELOPMENT OF AIRPORT IN SY NO. 12 OF SIRIYURU VILLAGE, IN FAVOUR OF EXECUTIVE ENGINEER KARNATAKA PUBLIC WORKS DEPARTMENT SHIVAMOGGA

Legend

- GPS Points
- Proposed Area ILS
- Airport Outer Boundary

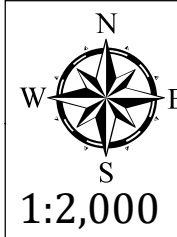

Sl No.	Component Name	Village Name	Survey No.	Extent in Ha
1	Instrument Landing System	Shiriyuru	12	4.576995

GPS Points Proposed Area WGS-84

ID No.	Latitdue	Longitude
1	13.862506	75.637886
2	13.863607	75.642555
3	13.862844	75.642863
4	13.861742	75.637753

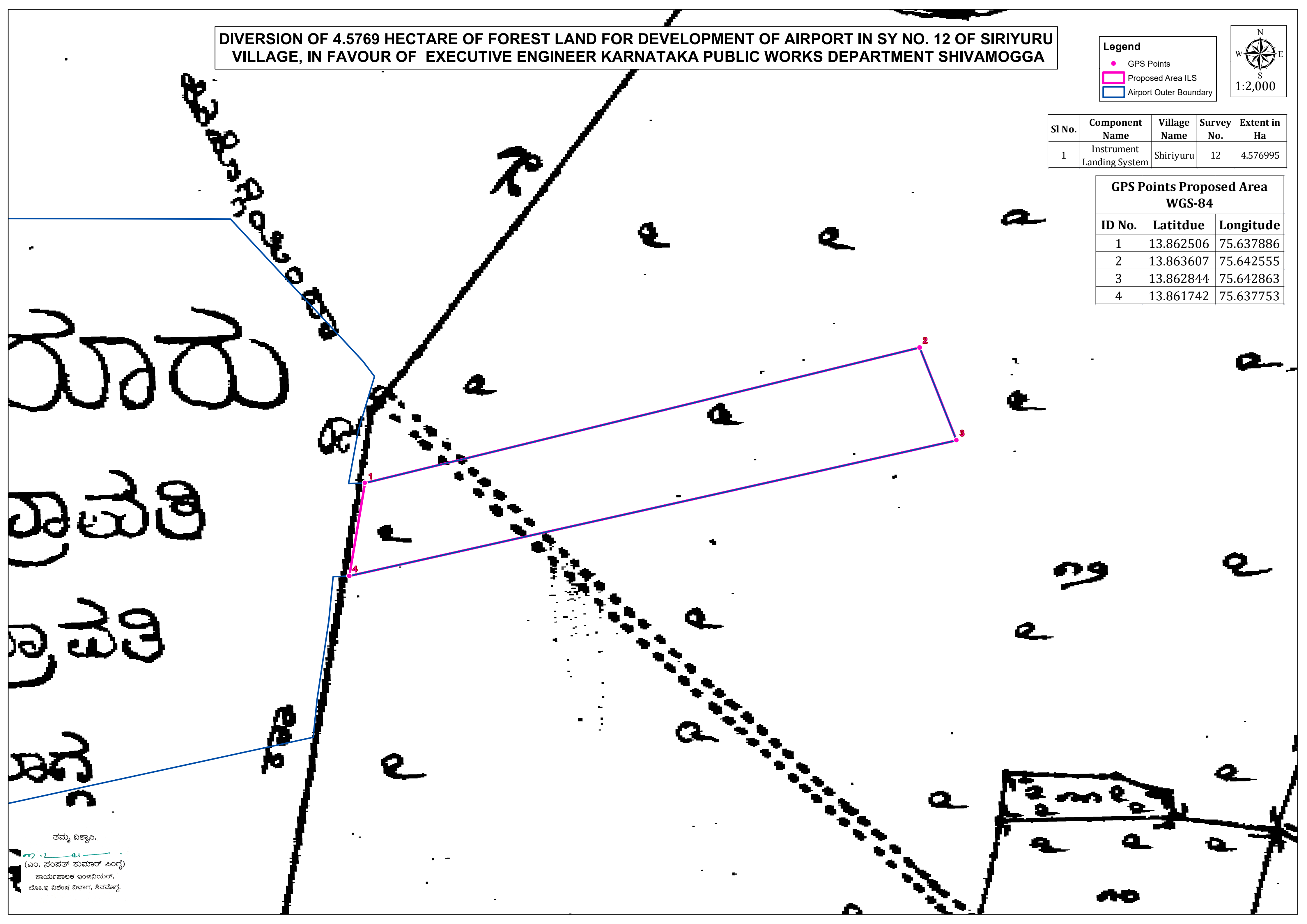

ತಮ್ಮ ವಿಶ್ವಾಸಿ,

(ಎಂ. ಸಂಪತ್ ಕುಮಾರ್ ಸಿಂಗ್)

ಕಾರ್ಯಪಾಲಕ ಇಂಜಿನಿಯರ್,

ಲೋ.ಇ ವಿಶೇಷ ವಿಭಾಗ, ಶಿವಮೊಗ್ಗ.

DIVERSION OF 4.5769 HECTARE OF FOREST LAND FOR DEVELOPMENT OF AIRPORT IN SY NO. 12 OF SIRIYURU VILLAGE, IN FAVOUR OF EXECUTIVE ENGINEER KARNATAKA PUBLIC WORKS DEPARTMENT SHIVAMOGGA

Legend

GPS Points

Proposed Area ILS

Airport Outer Boundary

Shiriyuru_Village

N

W

E

S

1:5,000

Sl No.	Component Name	Village Name	Survey No.	Extent in Ha
1	Instrument Landing System	Shiriyuru	12	4.576995

GPS Points Proposed Area WGS-84		
ID No.	Latitdue	Longitude
1	13.862506	75.637886
2	13.863607	75.642555
3	13.862844	75.642863
4	13.861742	75.637753

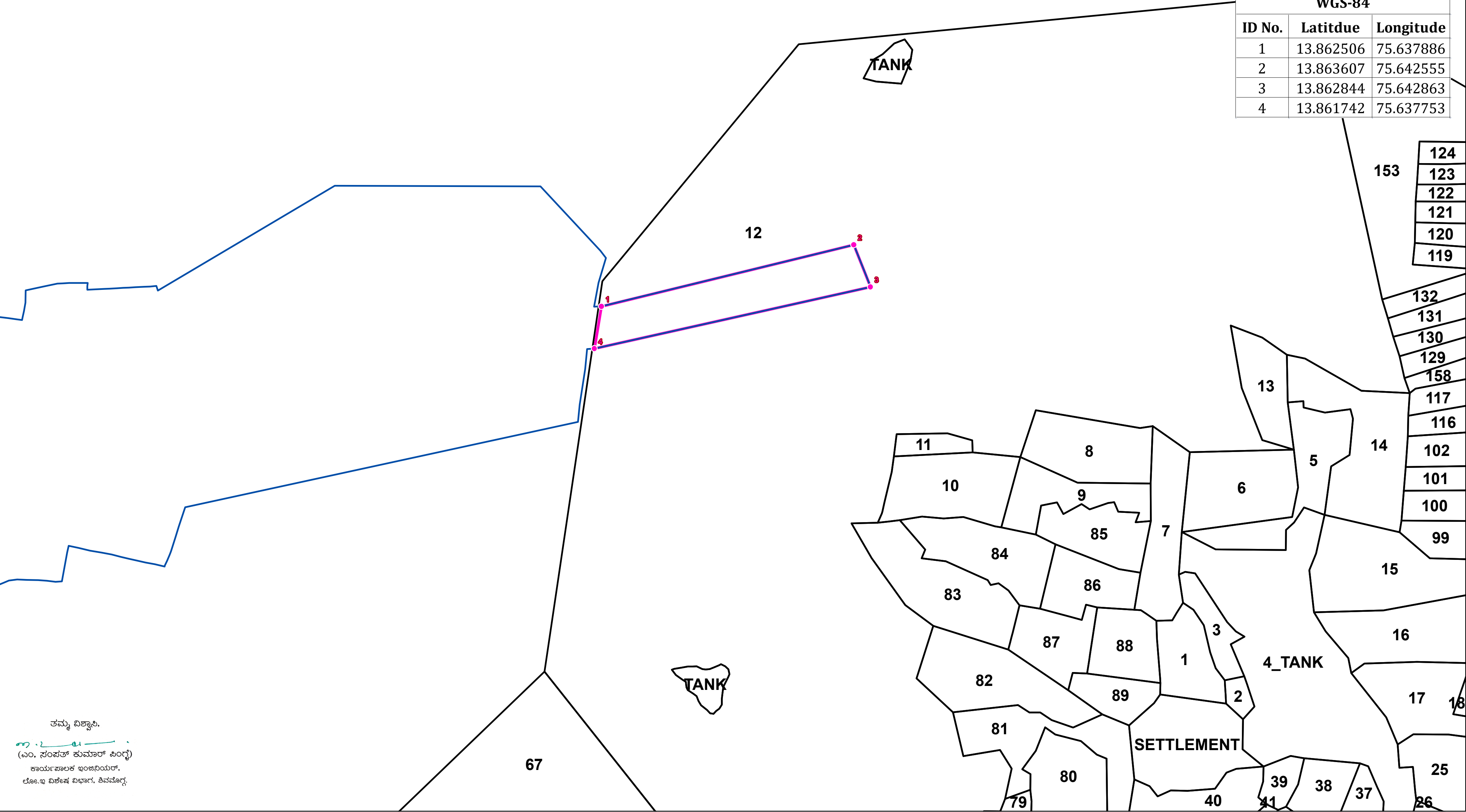

ಶ್ರೀಮತಿ ಬಿ.ಶ್ರೀಮತಿ,
(ಎಂ. ಸಂಪತ್ ಕುಮಾರ್ ಸಿಂಗ್)
ಕಾರ್ಯಪಾಲಕ ಇಂಜಿನಿಯರ್,
ಲೋ.ಇ. ವಿಶೇಷ ವಿಭಾಗ, ಶಿವಮೊಗ್ಗ.

DIVERSION OF 4.5769 HECTARE OF FOREST LAND FOR DEVELOPMENT OF AIRPORT IN SY NO. 12 OF SIRIYURU VILLAGE, IN FAVOUR OF EXECUTIVE ENGINEER KARNATAKA PUBLIC WORKS DEPARTMENT SHIVAMOGGA

Legend

- GPS Points
- Proposed Area ILS
- Airport Outer Boundary



Sl No.	Component Name	Village Name	Survey No.	Extent in Ha
1	Instrument Landing System	Shiriyuru	12	4.576995

GPS Points Proposed Area WGS-84

ID No.	Latitdue	Longitude
1	13.862506	75.637886
2	13.863607	75.642555
3	13.862844	75.642863
4	13.861742	75.637753

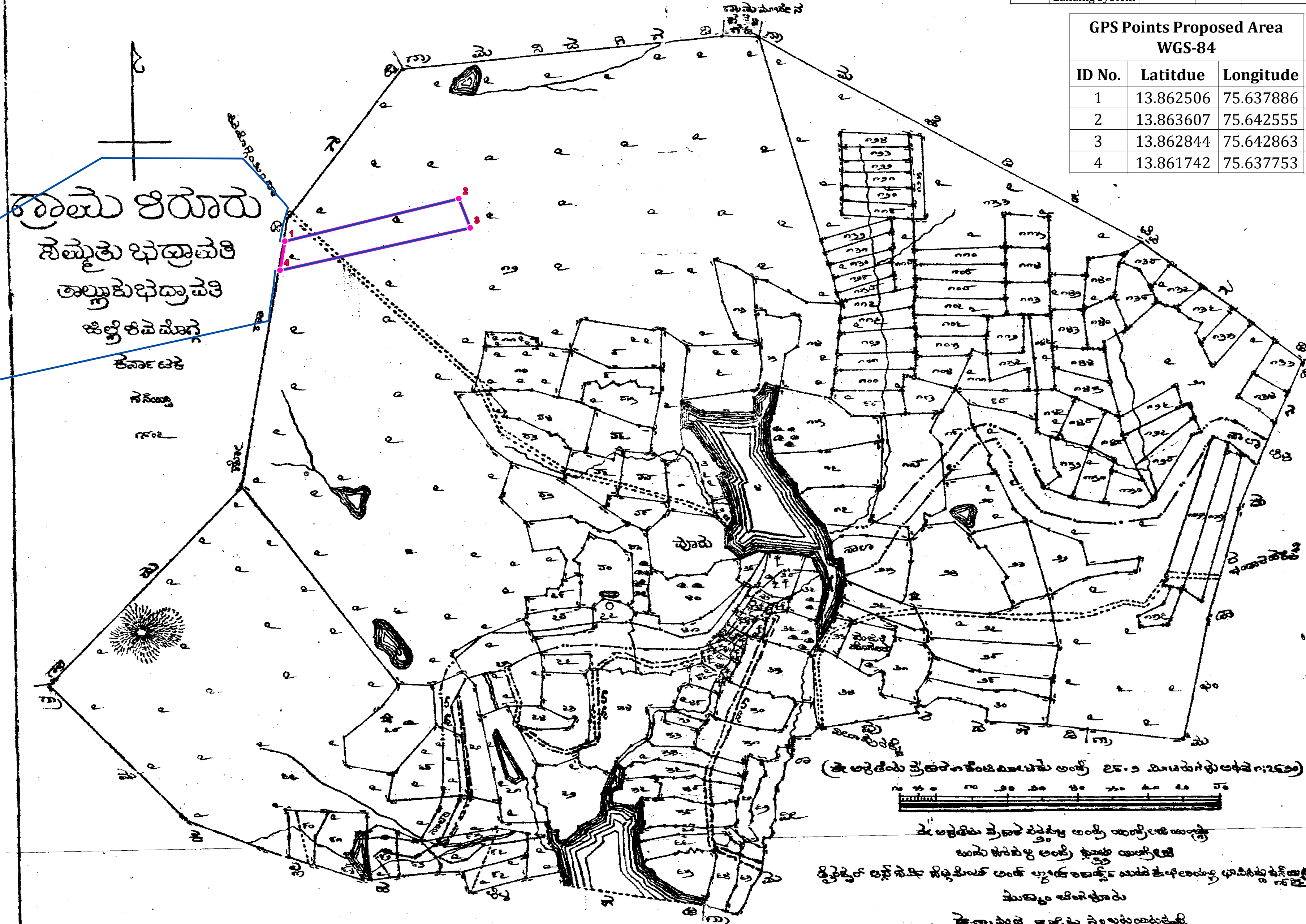

ತಮ್ಮ ವಿಶ್ವಾಸಿ,
(ಎಂ. ಸಂಪತ್ ಕುಮಾರ್ ಸಿಂಗ್)
ಕಾರ್ಯಪಾಲಕ ಇಂಜಿನಿಯರ್,
ಲೋ.ಇ. ವಿಶೇಷ ವಿಭಾಗ, ಶಿವಮೊಗ್ಗ.

(ಈ ಅಕ್ಷರವು ಪ್ರಕಟಗೊಳಿಸಲ್ಪಟ್ಟ ಅಂಶ 25.2 ಮೀಟರ್‌ಗಳ ಅಳತೆಗೆ 1:2500)
ಈ ಅಕ್ಷರವು ಪ್ರಕಟಗೊಳಿಸಲ್ಪಟ್ಟ ಅಂಶ 25.2 ಮೀಟರ್‌ಗಳ ಅಳತೆಗೆ 1:2500
ಮತ್ತು ಈ ಅಕ್ಷರವು ಅಂಶ 25.2 ಮೀಟರ್‌ಗಳ ಅಳತೆಗೆ 1:2500
ಕ್ರಿಸ್ಟೋಫರ್ ಲೆನ್ಸ್‌ನಿಂದ ನಿರ್ಮಿಸಲ್ಪಟ್ಟ ಅಂಶ 25.2 ಮೀಟರ್‌ಗಳ ಅಳತೆಗೆ 1:2500
ಮುಖ್ಯಾಧಿಕಾರಿಗಳು
ಶಿವಮೊಗ್ಗ ಸರ್ಕಾರಿ ಸಂಸ್ಥೆಯಿಂದ.

DIVERSION OF 4.5769 HECTARE OF FOREST LAND FOR DEVELOPMENT OF AIRPORT IN SY NO. 12 OF SIRIYURU VILLAGE, IN FAVOUR OF EXECUTIVE ENGINEER KARNATAKA PUBLIC WORKS DEPARTMENT SHIVAMOGGA

Legend

- GPS Points
- Proposed Area ILS
- Airport Outer Boundary
- Village_Boundary fn
- Shiriyuru_Village



Sl No.	Component Name	Village Name	Survey No.	Extent in Ha
1	Instrument Landing System	Shiriyuru	12	4.576995

GPS Points Proposed Area WGS-84

ID No.	Latitdue	Longitude
1	13.862506	75.637886
2	13.863607	75.642555
3	13.862844	75.642863
4	13.861742	75.637753

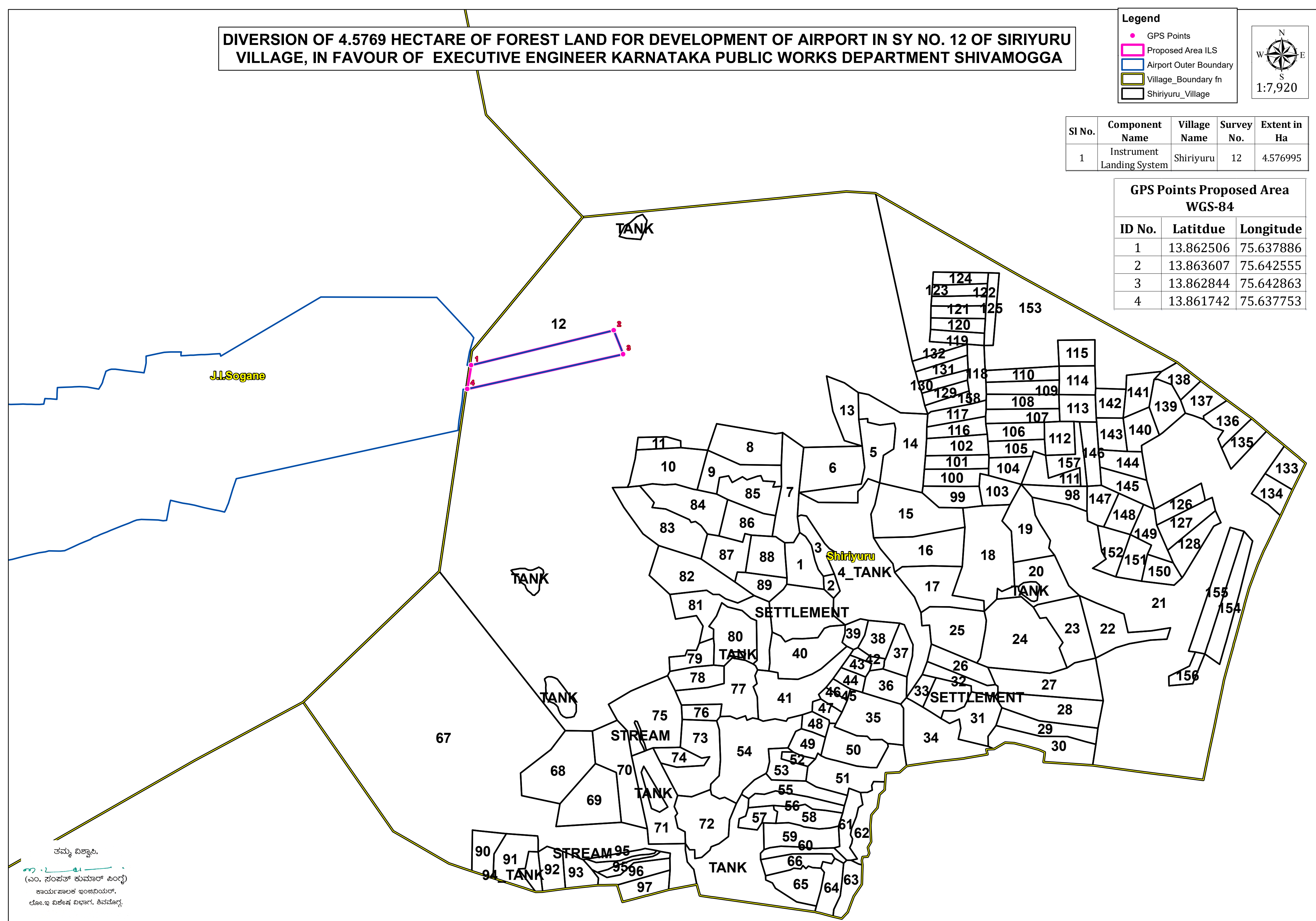

ಶ್ರೀಮತಿ ವಿಶ್ವಾಸಿ,
(ಎಂ. ಸಂಪತ್ ಕುಮಾರ್ ಸಿಂಗ್)
ಕಾರ್ಯಪಾಲಕ ಇಂಜಿನಿಯರ್,
ಲೋ.ಇ. ವಿಶೇಷ ವಿಭಾಗ, ಶಿವಮೊಗ್ಗ.

DIVERSION OF 4.5769 HECTARE OF FOREST LAND FOR DEVELOPMENT OF AIRPORT IN SY NO. 12 OF SIRIYURU VILLAGE, IN FAVOUR OF EXECUTIVE ENGINEER KARNATAKA PUBLIC WORKS DEPARTMENT SHIVAMOGGA

Legend

- GPS Points
- Proposed Area ILS
- Airport Outer Boundary
- Village_Boundary fn

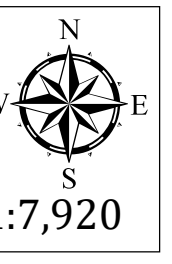

Sl No.	Component Name	Village Name	Survey No.	Extent in Ha
1	Instrument Landing System	Shiriyuru	12	4.576995

GPS Points Proposed Area WGS-84

ID No.	Latitdue	Longitude
1	13.862506	75.637886
2	13.863607	75.642555
3	13.862844	75.642863
4	13.861742	75.637753

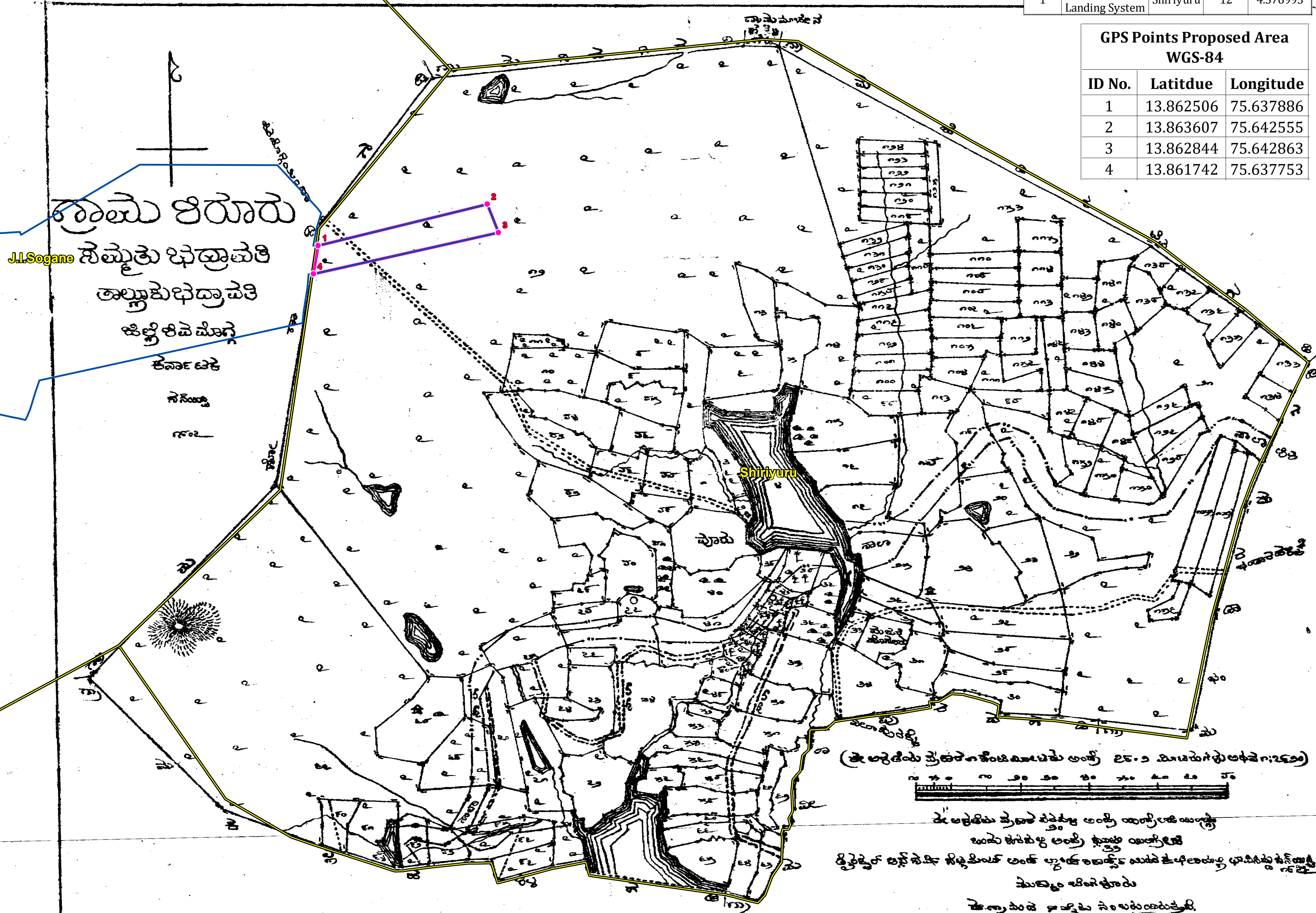

ತಮ್ಮ ವಿಶ್ವಾಸಿ,
(ಎಂ. ಸಂಪತ್ ಕುಮಾರ್ ಸಿಂಗ್)
ಕಾರ್ಯಪಾಲಕ ಇಂಜಿನಿಯರ್,
ಲೋ.ಇ. ವಿಶೇಷ ವಿಭಾಗ, ಶಿವಮೊಗ್ಗ.

(ಈ ಅಕ್ಷರವು ಪ್ರಕಟಗೊಳಿಸಲ್ಪಟ್ಟ ಅಂಶ 25.2 ಮೀಟರ್‌ಗಳ ಅಕ್ಷರ: 2500)

ಈ ಅಕ್ಷರವು ಪ್ರಕಟಗೊಳಿಸಲ್ಪಟ್ಟ ಅಂಶ 25.2 ಮೀಟರ್‌ಗಳ ಅಕ್ಷರ: 2500

ಮುಖ್ಯ ಮಂತ್ರಿ, ಕರ್ನಾಟಕ ಸರ್ಕಾರ

ಶಿವಮೊಗ್ಗ