

LEGEND

○	TOP POINTS
—	METAL GULLY
—	ROAD
—	ENTRY/EXIT
▨	FOREST LAND

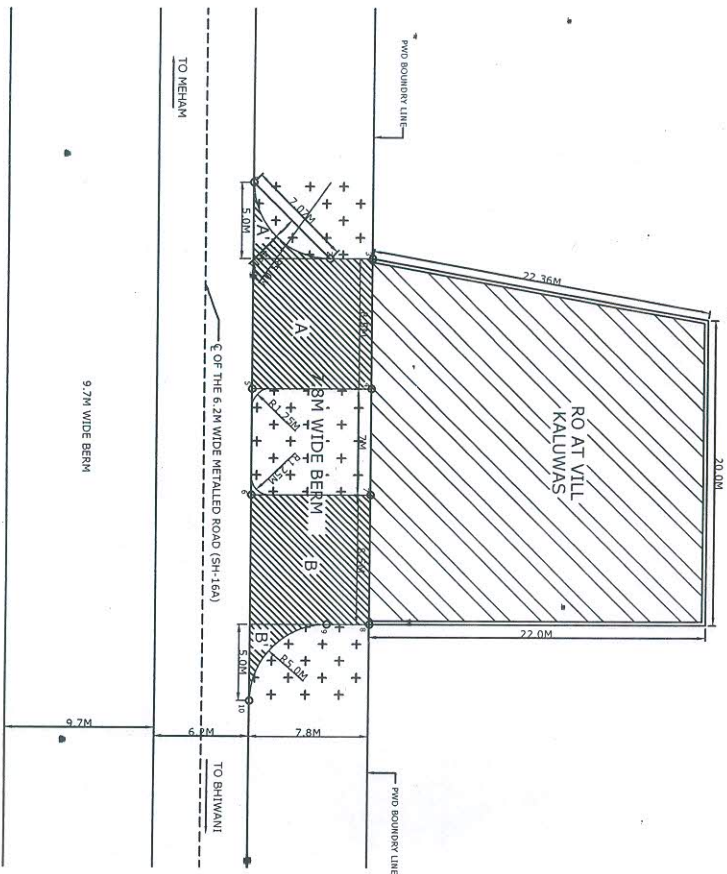

SGPS INFORMATION OF THE SITE

S/N	LONGITUDE		LATITUDE	
	DECIMAL	DMS	DECIMAL	DMS
1	84.813	76.09	24.7	76.186
2	84.855	76.09	24.679	76.186
3	84.844	76.09	24.689	76.186
4	84.851	76.09	24.689	76.186
5	84.831	76.09	24.621	76.186
6	84.841	76.09	24.631	76.186
7	84.841	76.09	24.641	76.186
8	84.821	76.09	24.631	76.186
9	84.821	76.09	24.621	76.186
10	84.801	76.09	24.481	76.186

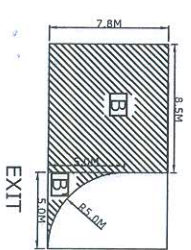

AREA CALCULATIONS

PROTECTED FOREST FOR APPROACH ROAD (ENTRY)

A = 8.5 X 7.8 = 66.3 SQM.
 A' = (1/2 X 5 X 5) - (2/3 X 7.07 X 1.46) SQM.
 TOTAL = 66.3 - 6.88 = 59.42 SQM.

PROTECTED FOREST FOR APPROACH ROAD (EXIT)

B = 8.5 X 7.8 = 66.3 SQM.
 B' = (1/2 X 5 X 5) - (2/3 X 7.07 X 1.46) SQM.
 TOTAL = 66.3 + 5.62 = 71.92 SQM. OR 0.007192 HAC

PROTECTED FOREST AREA REQUIRED FOR DIVERSION = 143.84 SQM. OR 0.014384 HAC

REV/NO	DESCRIPTION	DATE	REV BY	APP BY

INDIAN OIL CORPORATION LIMITED
 MARKETING DIVISION
 HISSAR DIVISIONAL OFFICE

INDIAN OIL CORPORATION LIMITED
 RAIPAL
 MANAGER (R.S.)
 HISSAR DIVISIONAL OFFICE

INDIAN OIL CORPORATION LTD.
 HISSAR - 125005/Hissar - 125005

SUBJECT:- RETAIL OUTLET ON BHIWANI-MEHAM ROAD(SH-16A), VILL.- KALUWAS, TEHSIL & DISTT.-BHIWANI(HARYANA).

TITLE:- SITE AND LAYOUT PLAN

DATE: 28-05-2016
 SCALE: 1:150

PREPARED BY: SHUBHAM ASSOCIATES
 NEW DELHI
 PH: 25974228, 9868161585