

: KERALA
: WAYANAD
: SULTHAN BATTERY
: SOUTH WAYAND DIVISION
: PULPALLY
: Dasanakkara to Pakkam

ROAD BOUNDARY From Dasanakkara to Pakkam

Thourh Forest AREA

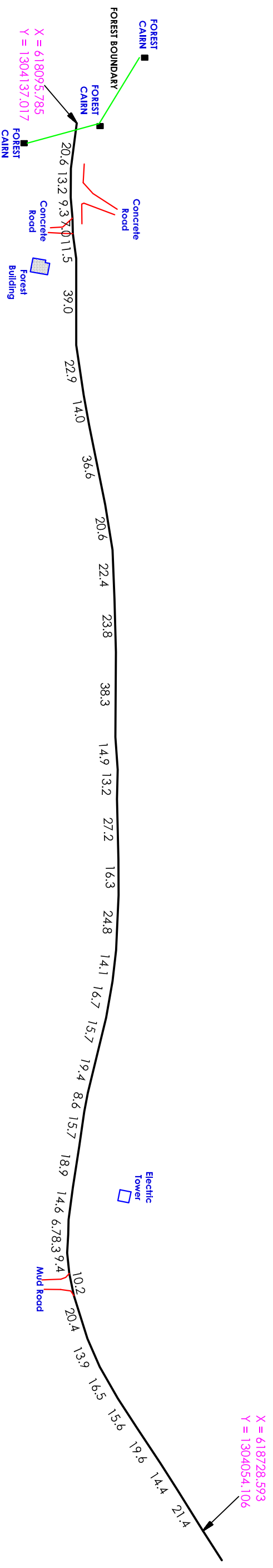

Sheet F1

STATE : KERALA
DISTRICT : WAYANAD
TALUK : SULTHAN BATHERY
DIVISION : SOUTH WAYAND DIVISION
STATION : PULPALLY
LOCATION : Dasanakkara to Pakkam

ROAD BOUNDARY From Dasanakkara to Pakkam
Thourh Forest AREA

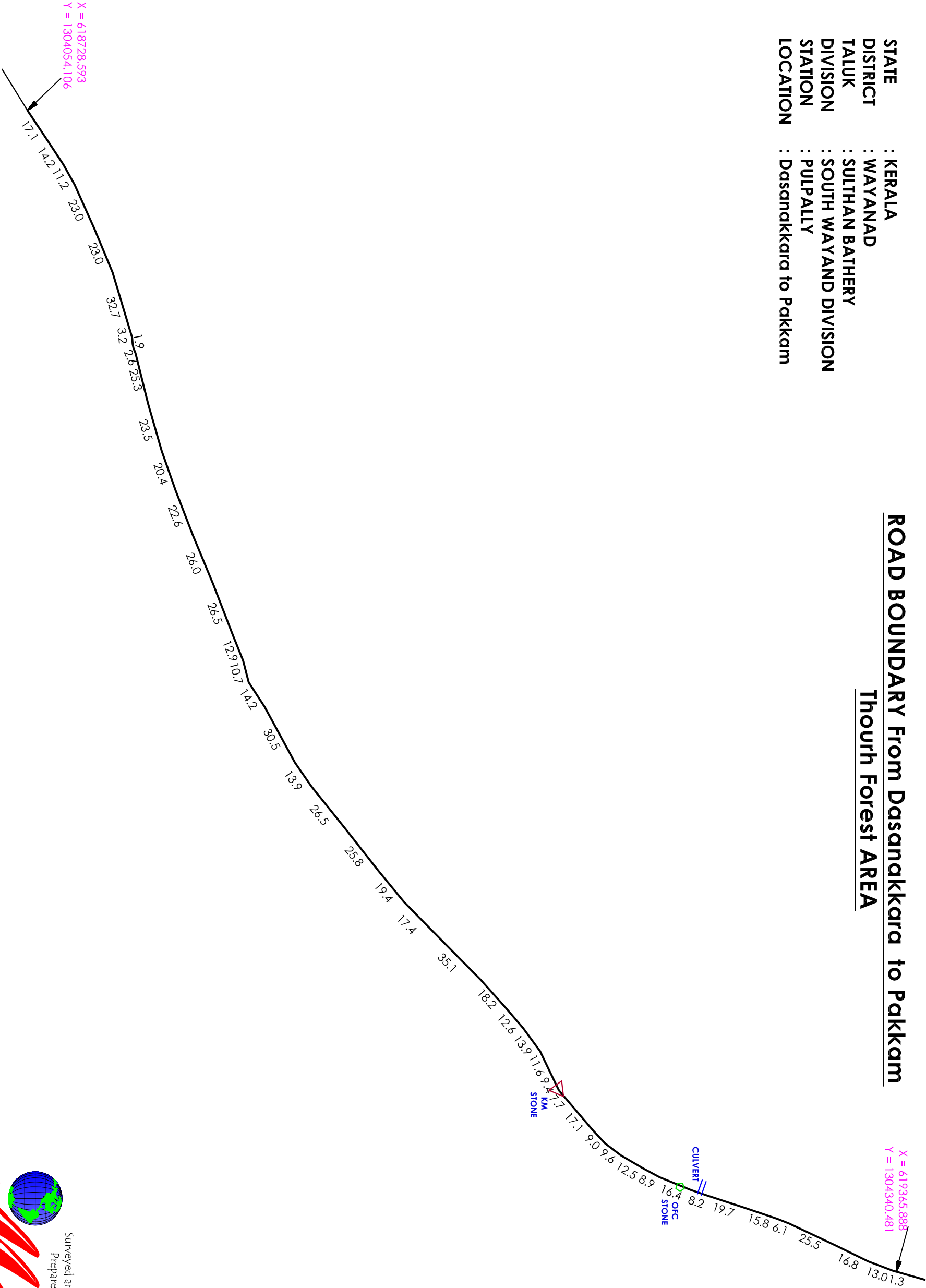

ROAD BOUNDARY From Dasanakkara to Pakkam
Thourh Forest AREA

STATE : KERALA
DISTRICT : WAYANAD
TALUK : SULTHAN BATHERY
DIVISION : SOUTH WAYAND DIVISION
STATION : PULPALLY
LOCATION : Dasanakkara to Pakkam

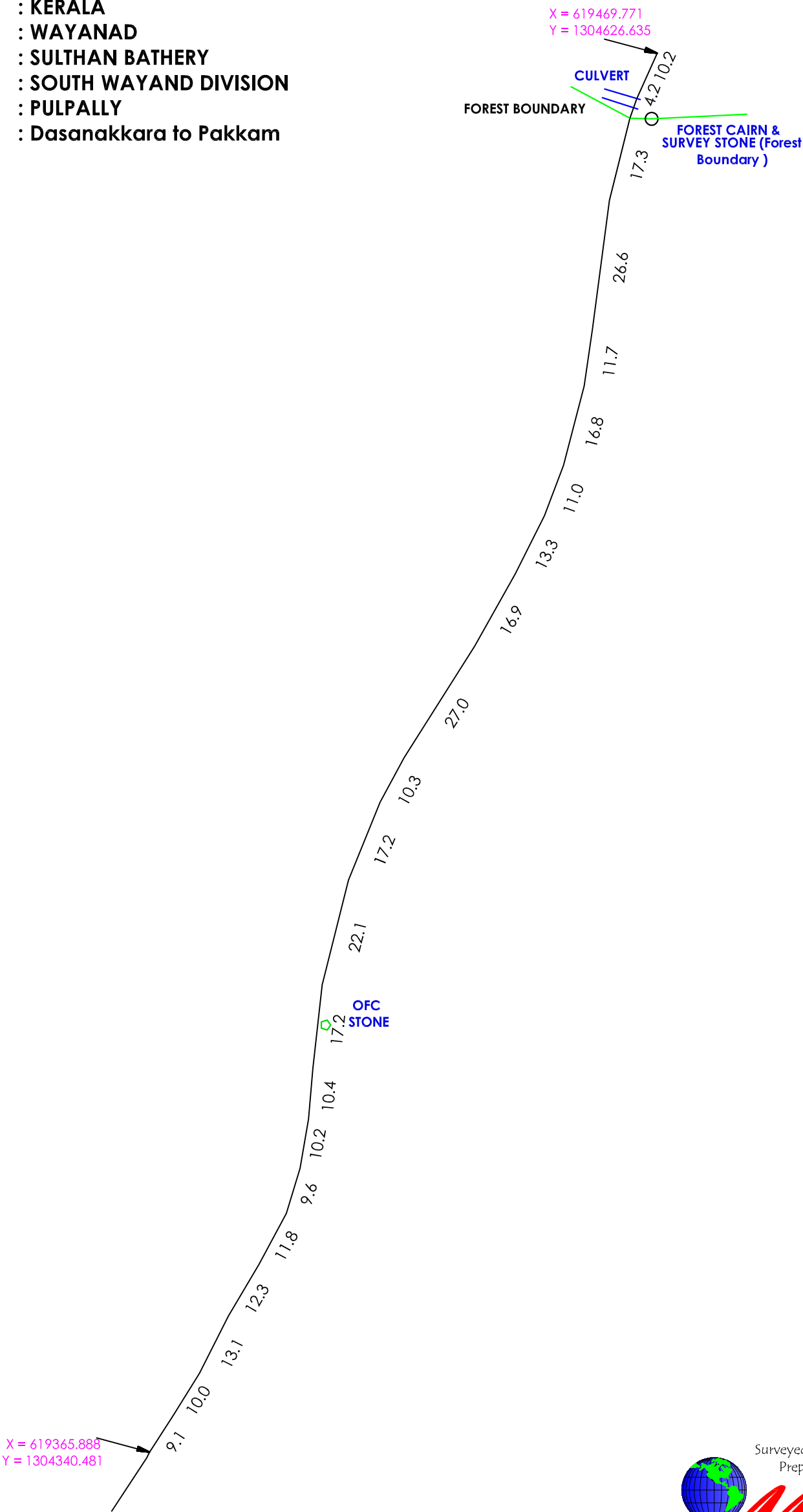

STATE : KERALA

DISTRICT : WAYANAD

TALUK : SULTHAN BATHERY

DIVISION : SOUTH WAYAND DIVISION

STATION : PULPALLY

LOCATION : Pakkam Forest to Kurichipatta Brethen Assembly Hall

ROAD BOUNDARY From Pakkam Forest to Kurichipatta

Thourh Forest AREA

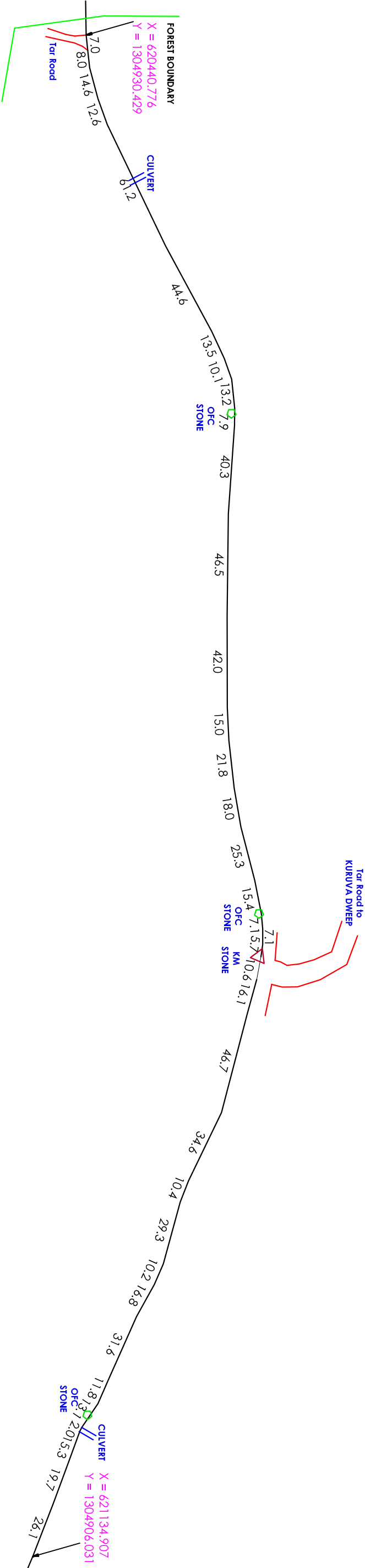

STATE : KERALA
DISTRICT : WAYANAD
TALUK : SULTHAN BATHERY
DIVISION : SOUTH WAYAND DIVISION
STATION : PULPALLY
LOCATION : Pakkam Forest to Kurichipatta Brethen Assembly Hall

ROAD BOUNDARY From Pakkam Forest to Kurichipatta
Thourh Forest AREA

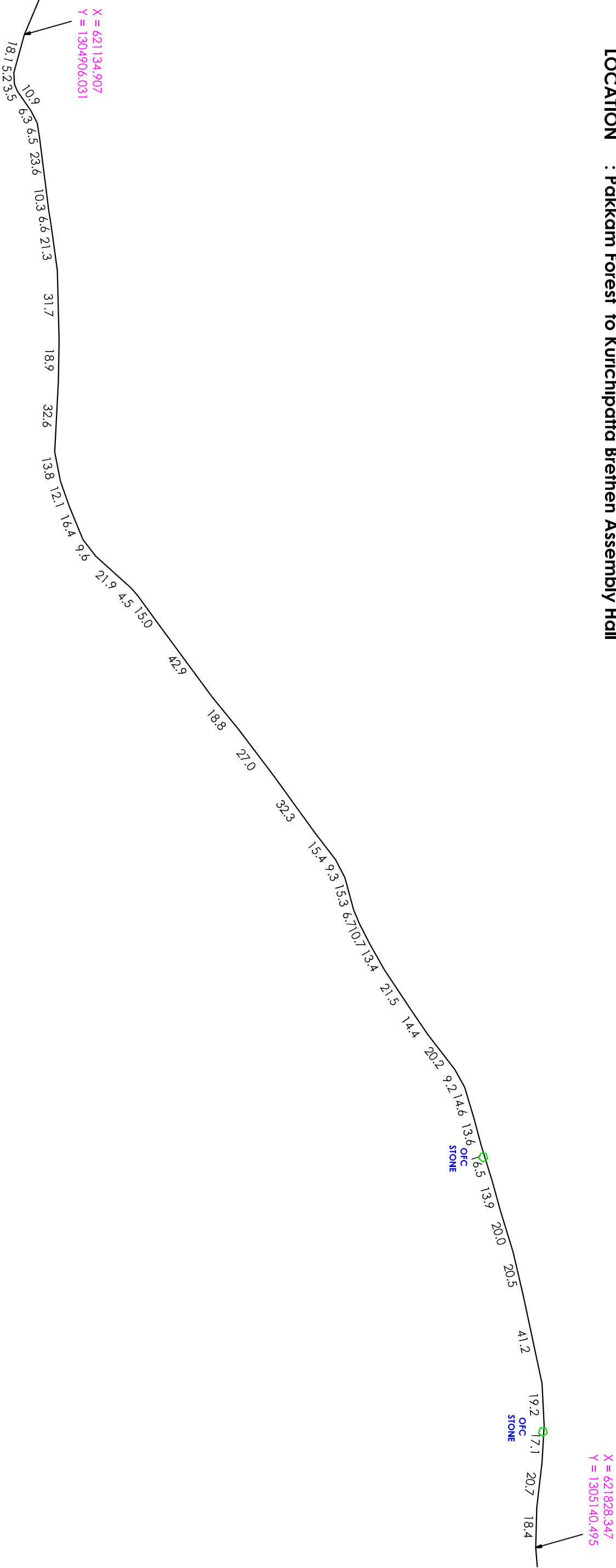

**ROAD BOUNDARY From Pakkam Forest to Kurichipatta
Thourh Forest AREA**

STATE : KERALA
DISTRICT : WAYANAD
TALUK : SULTHAN BATHERY
DIVISION : SOUTH WAYAND DIVISION
STATION : PULPALLY
LOCATION : Pakkam Forest to Kurichipatta Brethen Assembly Hall

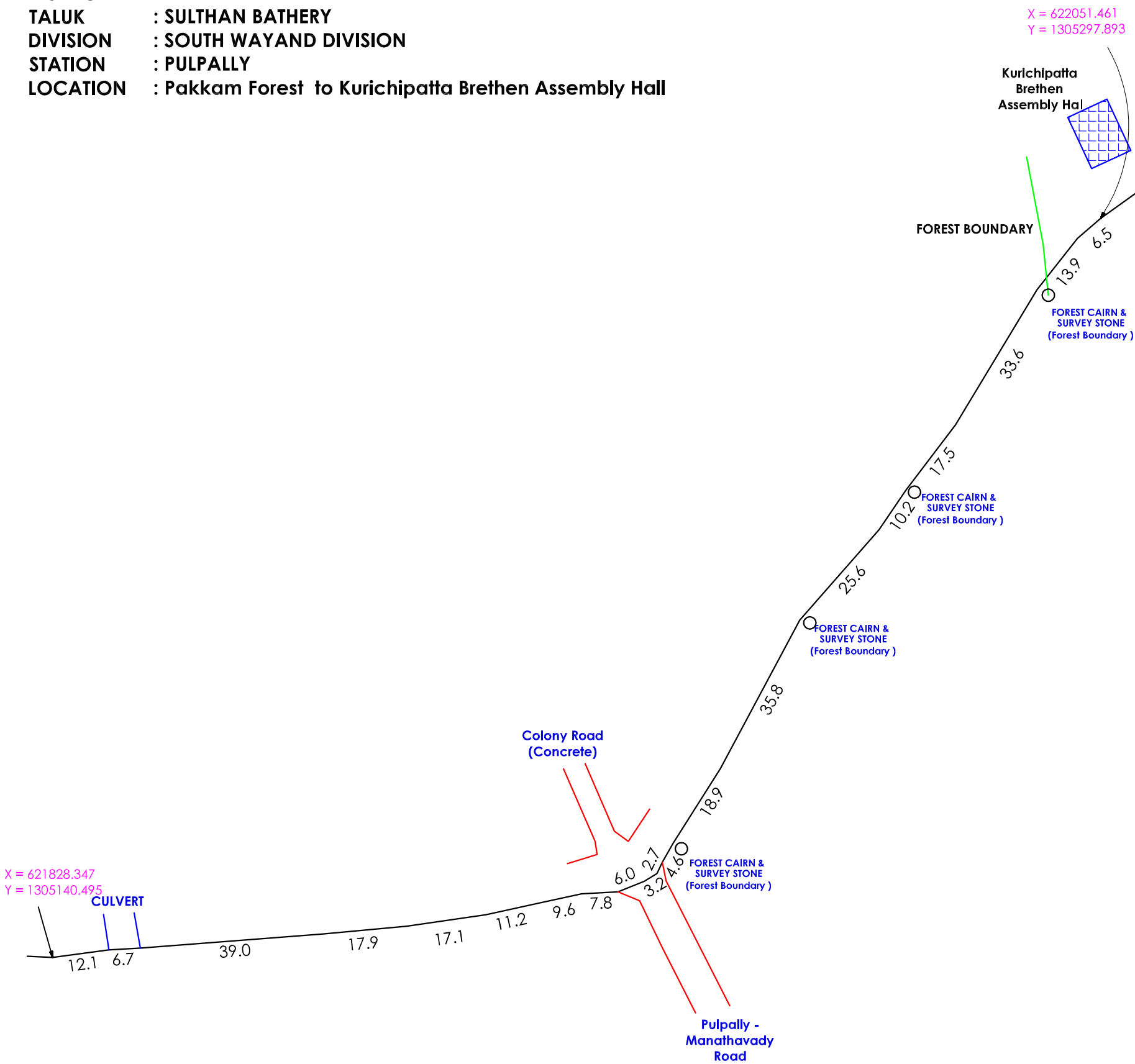

ROAD BOUNDARY From Iron Gate to Iron Gate
Thourh FOREST AREA

STATE	: KERALA
DISTRICT	: WAYANAD
TALUK	: SULTHAN BATHERY
DIVISION	: SOUTH WAYAND DIVISION
STATION	: PULPALLY
LOCATION	: Iron Gate to iron Gate

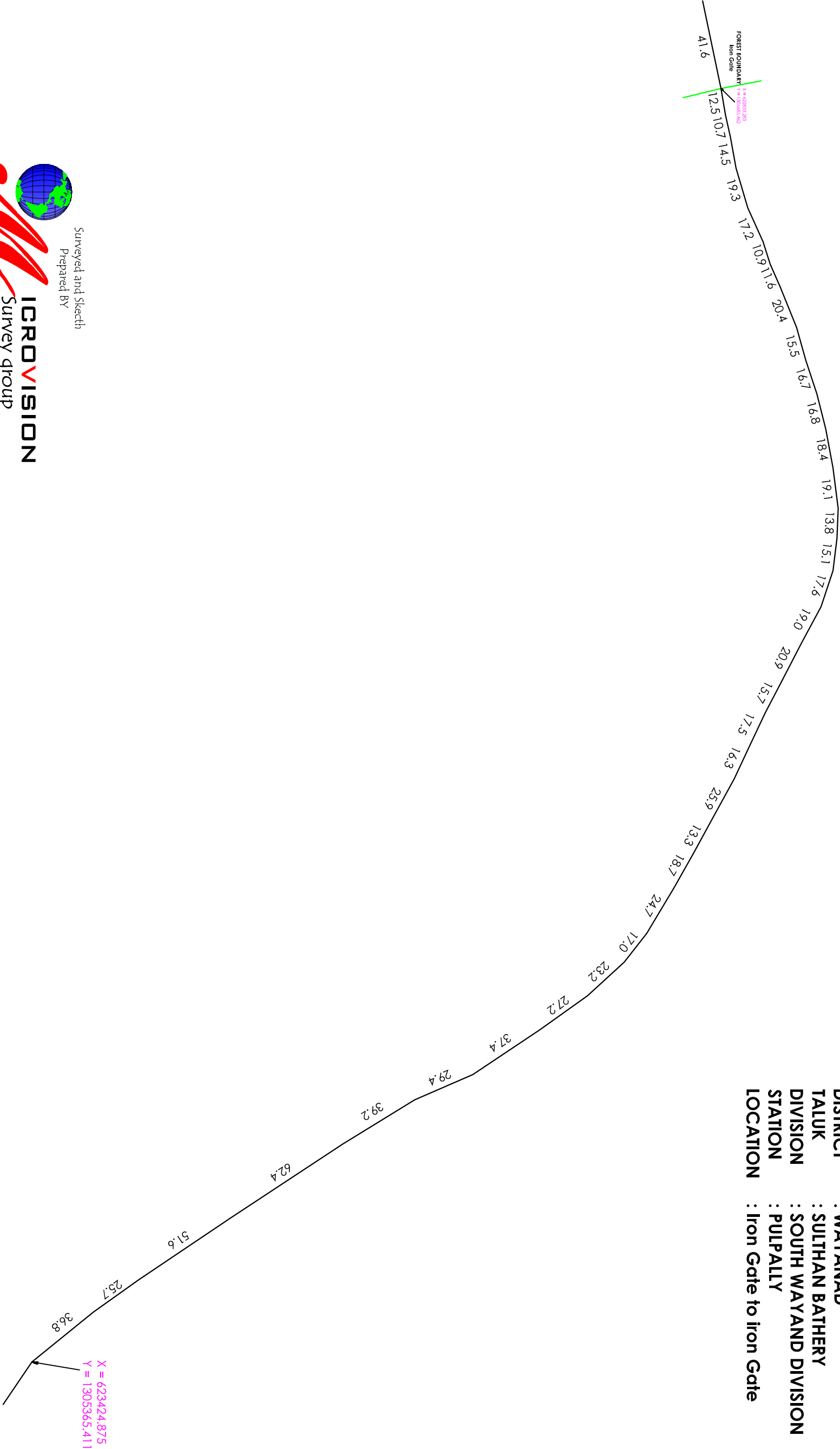

ROAD BOUNDARY From Iron Gate to Iron Gate
Thourh FOREST AREA

STATE : KERALA
DISTRICT : WAYANAD
TALUK : SULTHAN BATHERY
DIVISION : SOUTH WAYAND DIVISION
STATION : PULPALLY
LOCATION : iron Gate to iron Gate

X = 623424.875
Y = 1305365.411

51.2

26.3

32.1

27.2

35.3

47.7

34.4

29.6

28.2

28.0

24.9

41.0

18.0

25.0

13.7

27.6

19.8

14.3

11.4

73.5

18.0

11.4

51.2

50.6

X = 623752.696
Y = 1304717.963

ROAD BOUNDARY From iron Gate to iron Gate
Thourh Forest AREA

STATE : KERALA
DISTRICT : WAYANAD
TALUK : SULTHAN BATHERY
DIVISION : SOUTH WAYAND DIVISION
STATION : PULPALLY
LOCATION : iron Gate to iron Gate

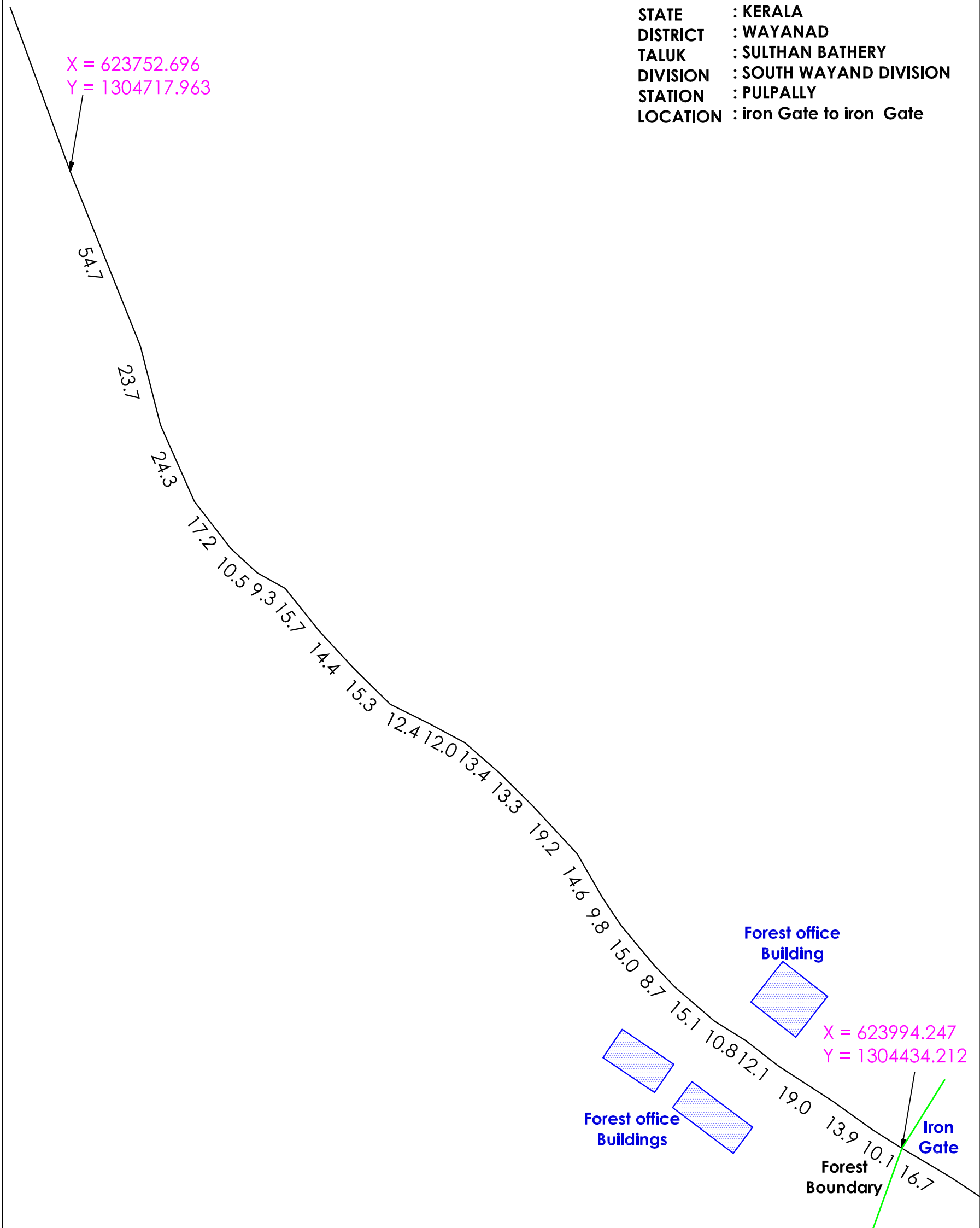

ROAD BOUNDARY From Check Post to Check Post Thourh
FOREST AREA

X = 623718.350
Y = 1302786.072
OFC STONE
FOREST BOUNDARY
FOREST CAIRN

STATE : KERALA
DISTRICT : WAYANAD
TALUK : SULTHAN BATHERY
DIVISION : SOUTH WAYAND DIVISION
STATION : PULPALLY
LOCATION : Chekpost to Chekpost
(Nadavayal)

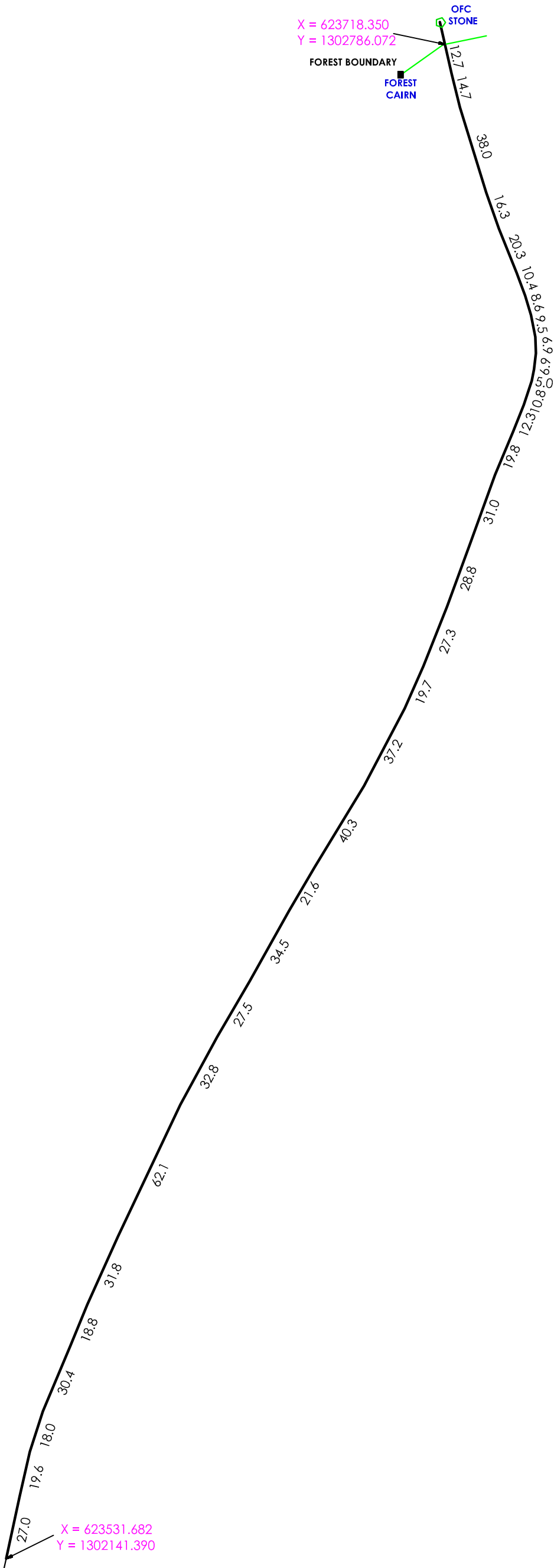

ROAD BOUNDARY From Check Post to Check Post Thourh
FOREST AREA

STATE : KERALA
DISTRICT : WAYANAD
TALUK : SULTHAN BATHERY
DIVISION : SOUTH WAYAND DIVISION
STATION : PULPALLY
LOCATION : Chekpost to Chekpost
(Nadavayal)

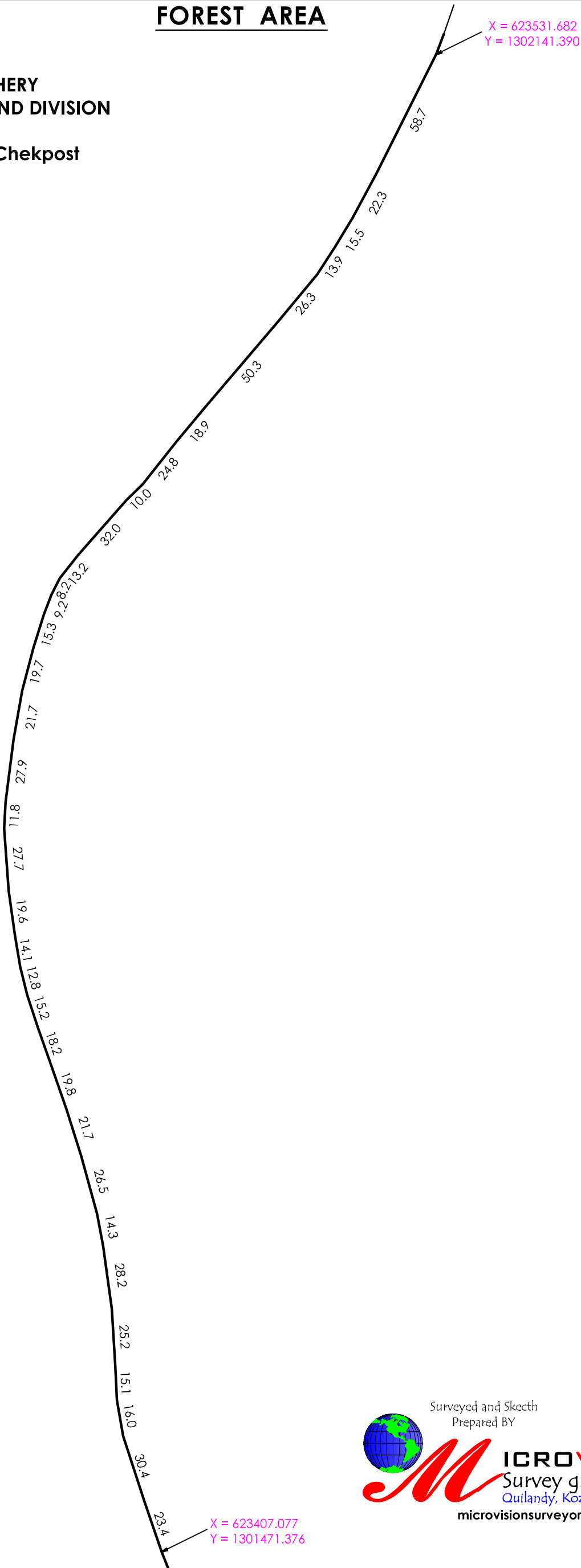

ROAD BOUNDARY From Check Post to Check Post Thourh

FOREST AREA

STATE : KERALA
DISTRICT : WAYANAD
TALUK : SULTHAN BATHERY
DIVISION : SOUTH WAYAND DIVISION
STATION : PULPALLY
LOCATION : Chekpost to Chekpost
(Nadavayal)

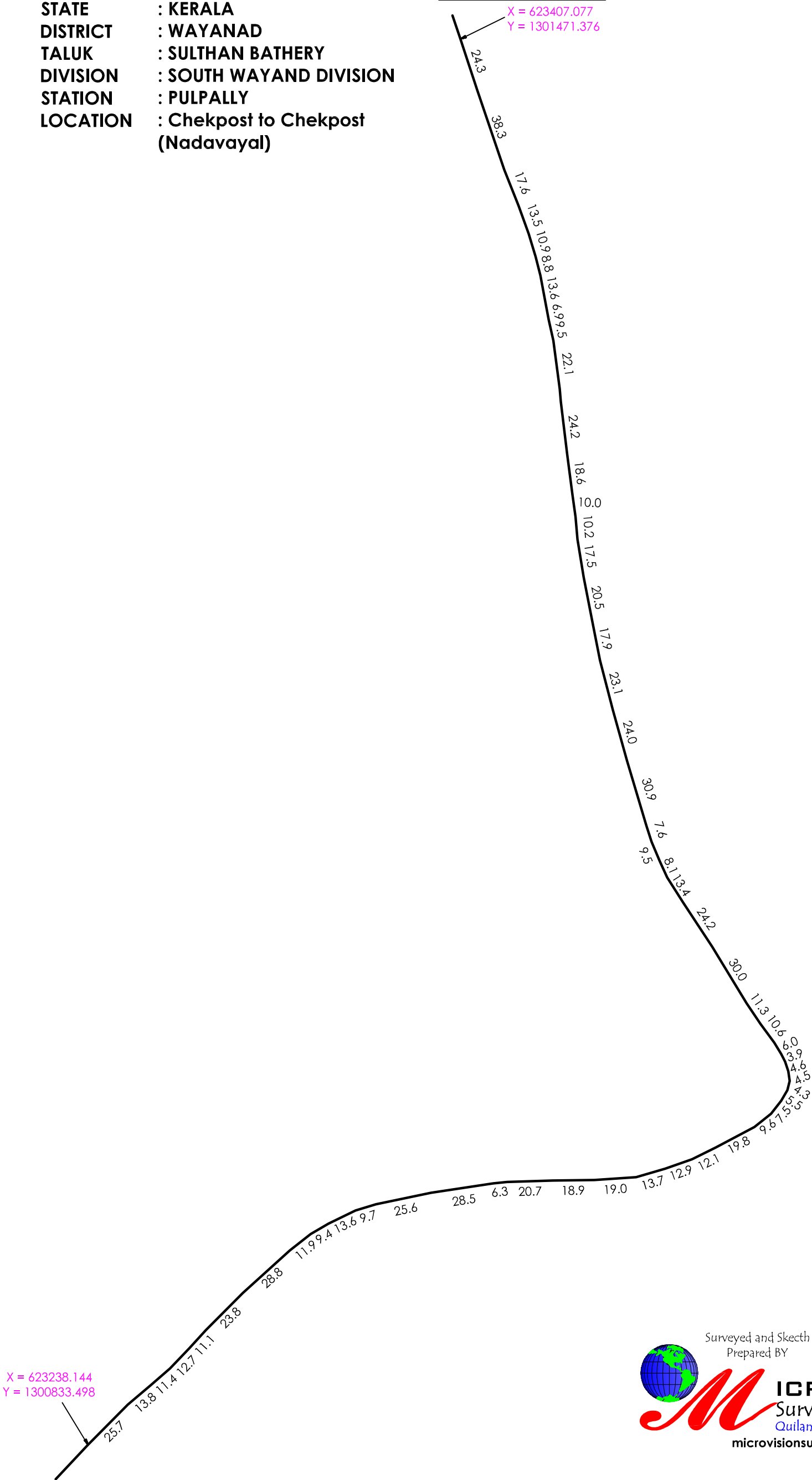

ROAD BOUNDARY From Check Post to Check Post Thourh
FOREST AREA

STATE : KERALA
DISTRICT : WAYANAD
TALUK : SULTHAN BATHERY
DIVISION : SOUTH WAYAND DIVISION
STATION : PULPALLY
LOCATION : Chekpost to Chekpost
(Nadavayal)

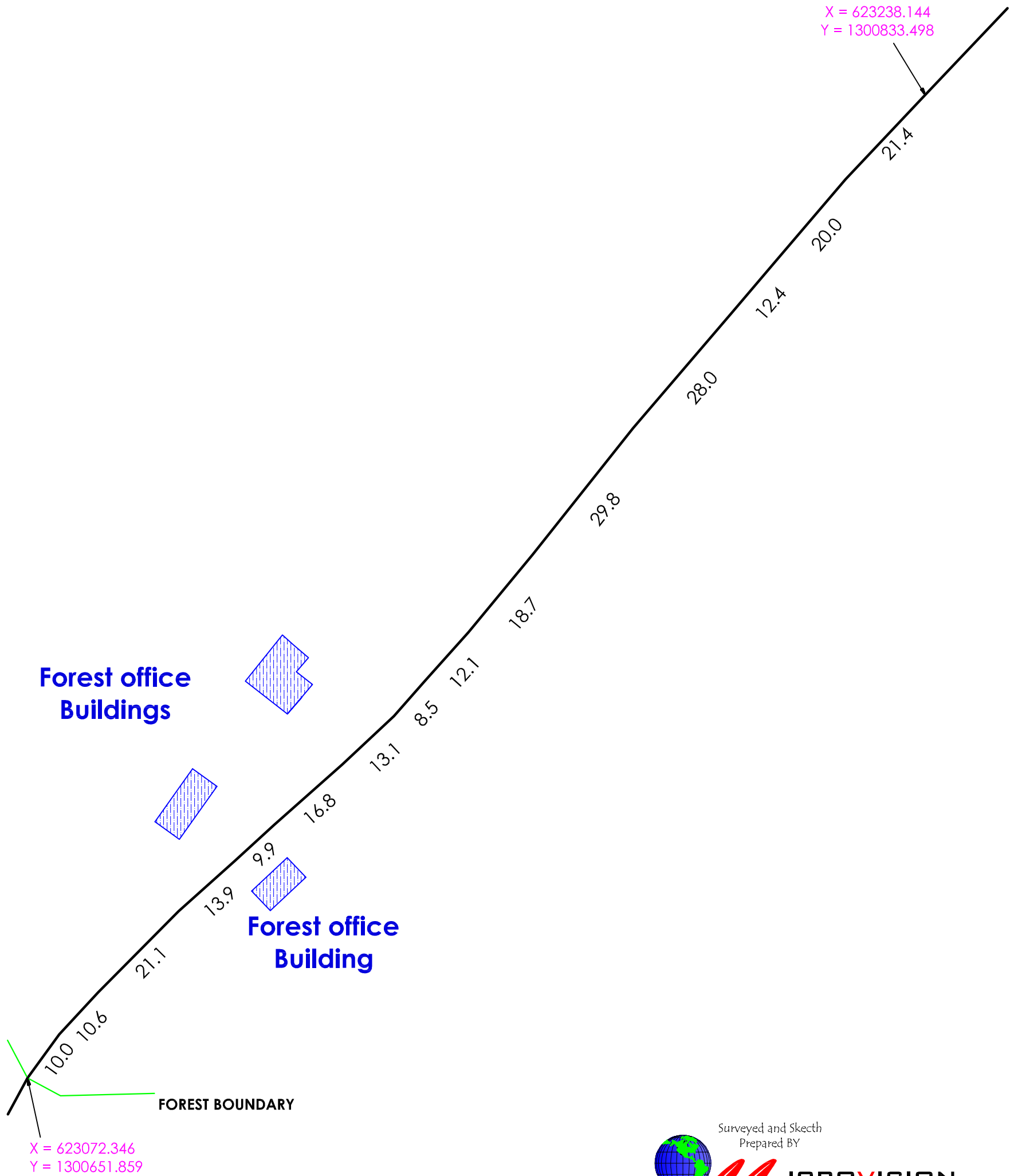

ROAD BOUNDARY Kallurkunnu- GST route Thourh FOREST AREA

STATE : KERALA
DISTRICT : WAYANAD
TALUK : SULTHAN BATHERY
DIVISION : SOUTH WAYAND DIVISION
STATION : Irulam

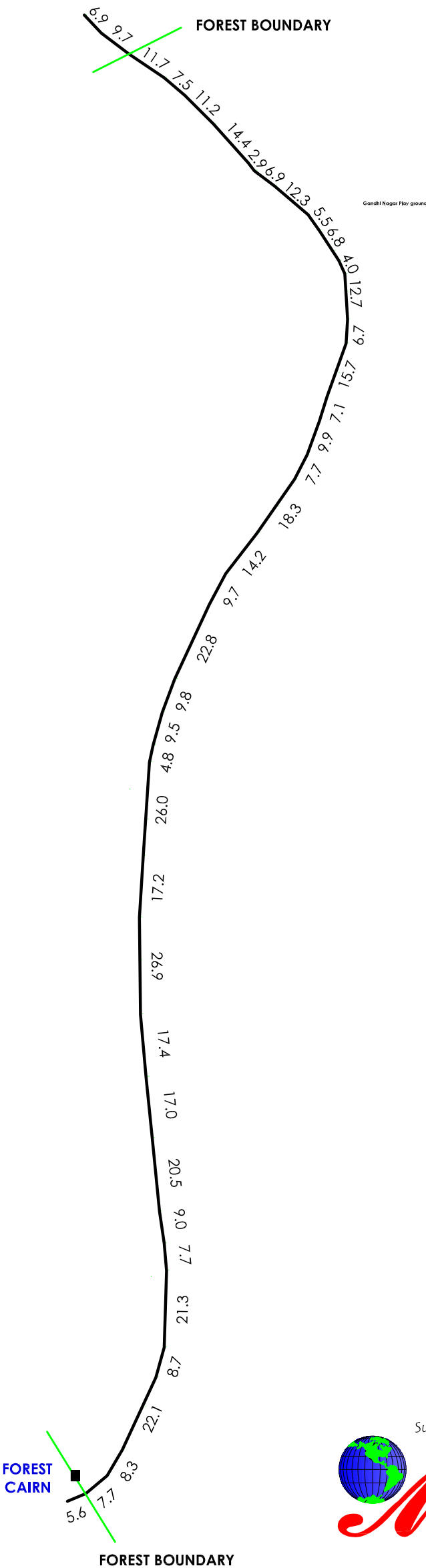

Surveyed and Skeeth
Prepared BY



MICROVISION
Survey group
Quilandy, Kozhikode
microvisionsurveyors@gmail.com