

# Georeference Map of Forest Land Proposed for Compensatory Afforestation

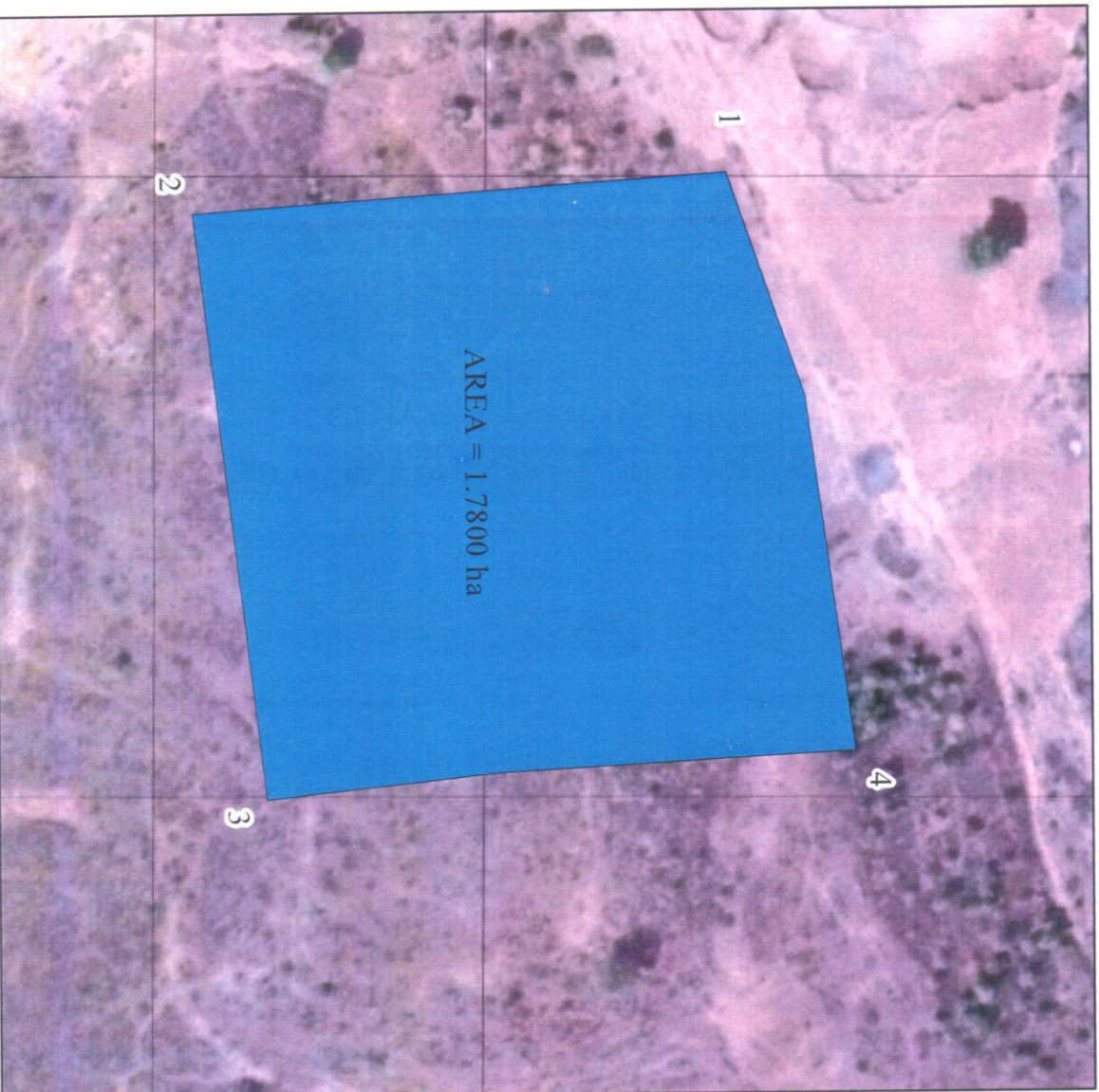

## Location :

District : Dadra & Nagar Haveli

Village : Galonda

Survey Number : 351

Area : 1.7800 ha

1 cm = 15 mtrs



## GPS Reading :

1. 73° 3' 49.954" E, 20° 17' 09.847" N
2. 73° 3' 50.292" E, 20° 17' 05.874" N
3. 73° 3' 54.952" E, 20° 17' 06.449" N
4. 73° 3' 54.551" E, 20° 17' 10.831" N

## Prepared By

*Galonda*  
Surveyor (D.W.)

(Name and Signature)  
Forest Department

## Counter Signed By:

*Paul*  
RFO (NR)  
(Name and Signature)

*Quiche*  
ACF (T)  
(Name and Signature)