

Name of Project: Construction of New BG Railway Line in Forest lands in various villages of Shimoga & Davangere District in favour of Deputy Chief Engineer, construction, South Western Railway Mysuru

GPS MAP SHOWING AREA FOR SIDLIPURA VILLAGE
(Forest Area: 0.2 Hectares)

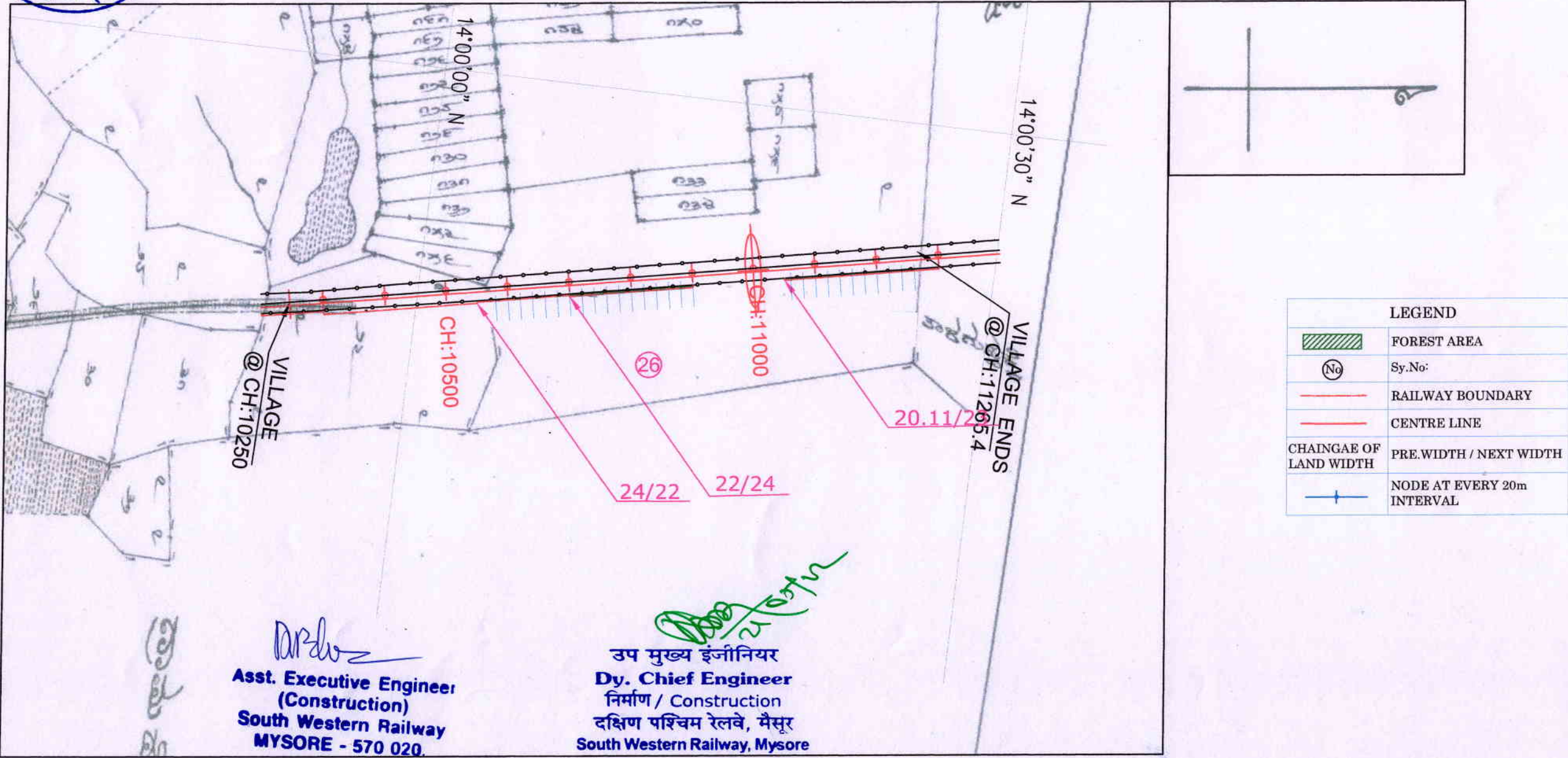

Name of Project: Construction of New BG Railway Line in Forest lands in various villages of Shimoga & Davangere District in favour of Deputy Chief Engineer, construction, South Western Railway Mysuru

GPS MAP SHOWING AREA FOR SIDLIPURA VILLAGE (Forest Area 0.2 Hectares)

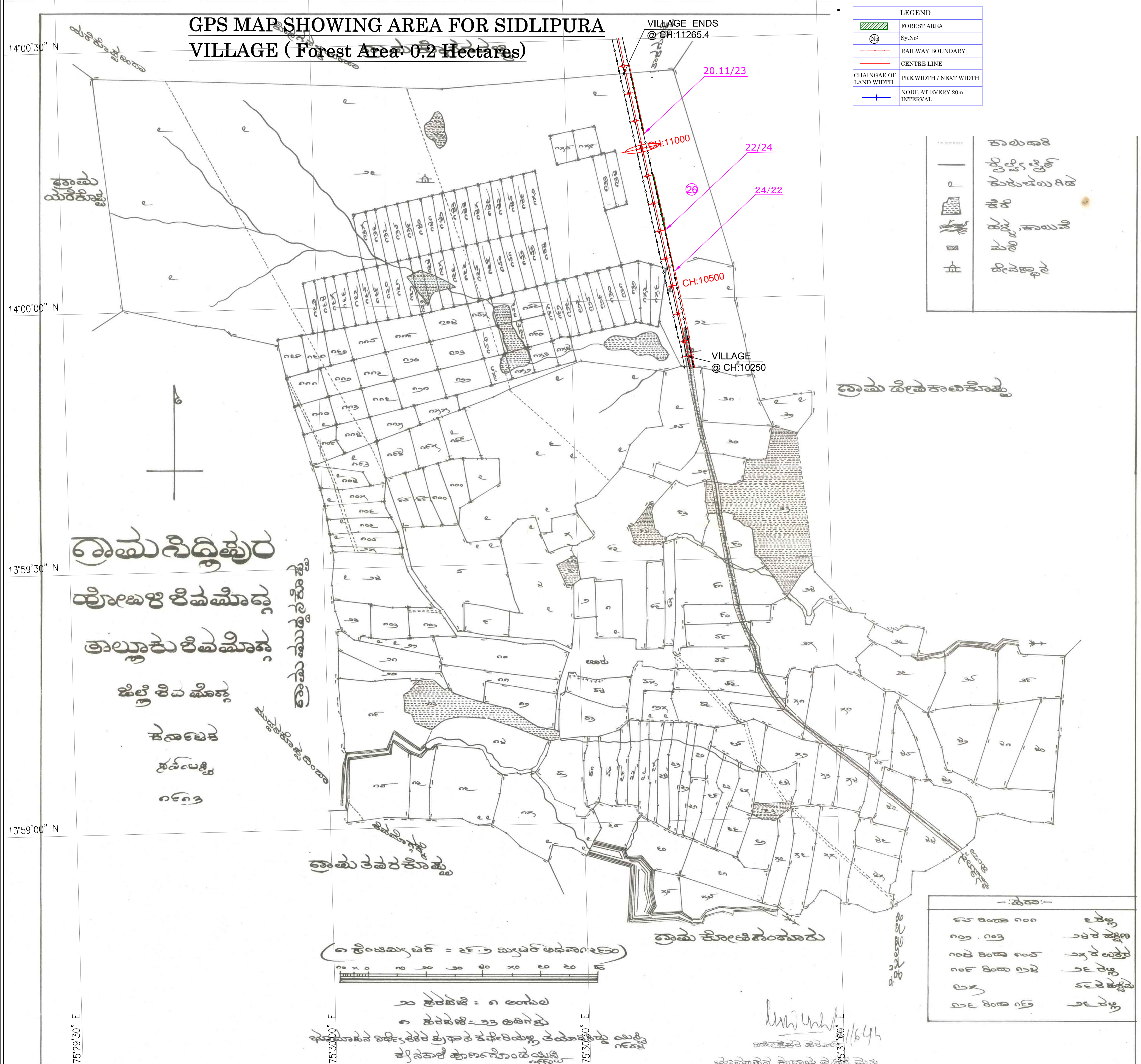

Name of Project: Construction of New BG Railway Line in Forest lands in various villages of Shimoga & Davangere District in favour of Deputy Chief Engineer, construction, South Western Railway Mysuru

GPS MAP SHOWING AREA FOR SIDLIPURA VILLAGE
(Forest Area: 0.2 Hectares)

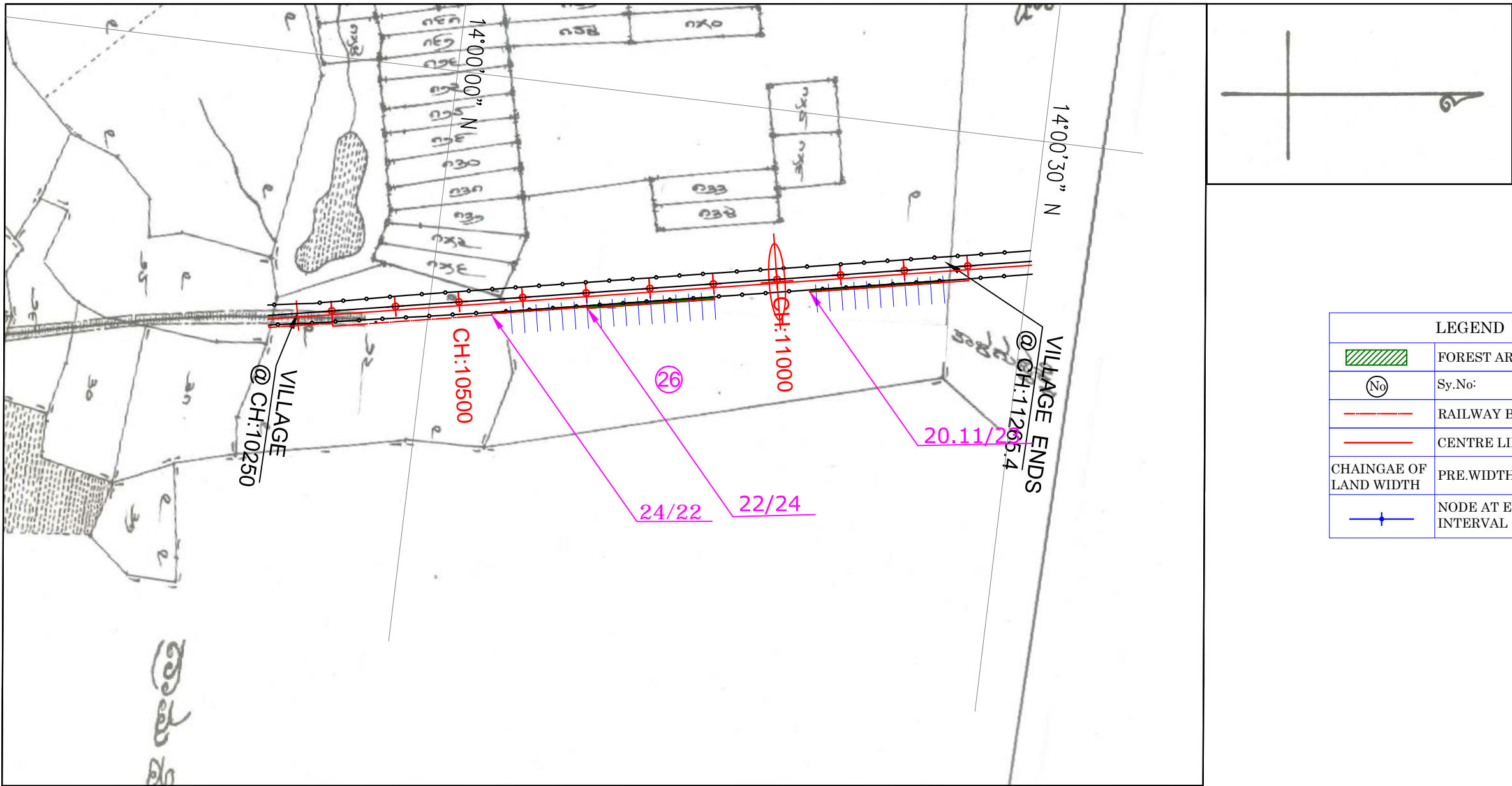

Name of Project: Construction of New BG Railway Line in Forest lands in various villages of Shimoga & Davangere District in favour of Deputy Chief Engineer, construction, South Western Railway Mysuru

GPS MAP SHOWING AREA FOR KONNAGAVALLI VILLAGE
(Forest Area: 0.33 Hectares)

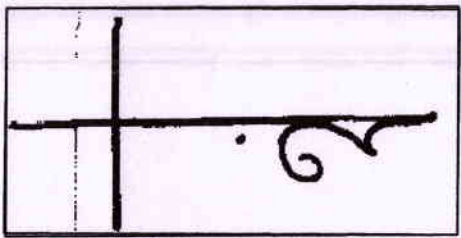
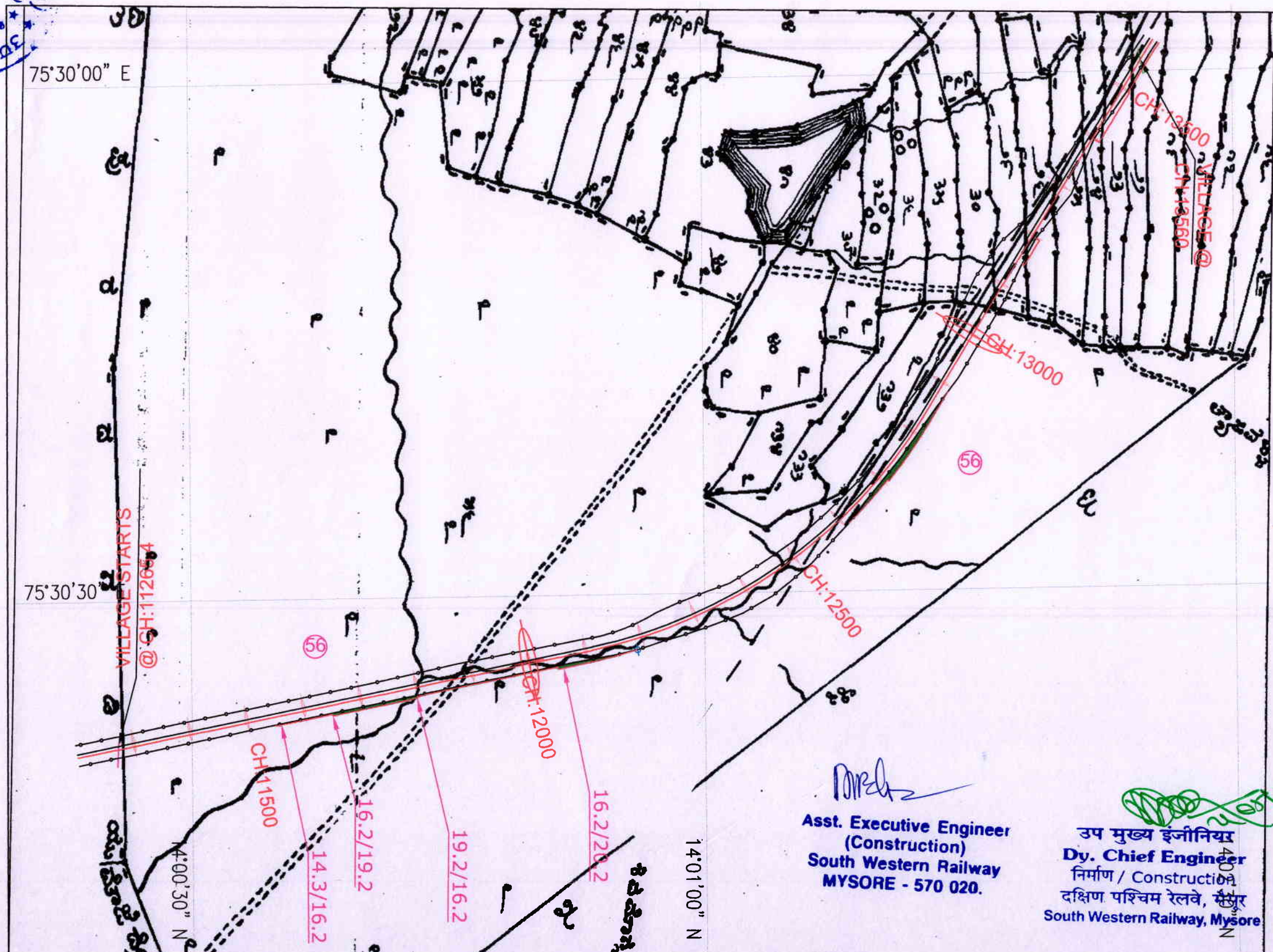



LEGEND	
	FOREST AREA
No	Sy.No:
	RAILWAY BOUNDARY
	CENTRE LINE
CHAINGAE OF LAND WIDTH	PRE.WIDTH / NEXT WIDTH
	NODE AT EVERY 20m INTERVAL

Asst. Executive Engineer
(Construction)
South Western Railway
MYSORE - 570 020.

उप मुख्य इंजीनियर
Dy. Chief Engineer
निर्माण / Construction
दक्षिण पश्चिम रेलवे, मैसूर
South Western Railway, Mysore

29

LEGEND	
	FOREST AREA
No	Sy.No:
	RAILWAY BOUNDARY
	CENTRE LINE
CHAINGAE OF LAND WIDTH	PRE.WIDTH / NEXT WIDTH
	NODE AT EVERY 20m INTERVAL

GPS MAP SHOWING AREA FOR KONNAGAVALI VILLAGE (Forest Area: 0.33 Hectares)

The map displays the following details:

- Title:** GPS MAP SHOWING AREA FOR KONNAGAVALI VILLAGE (Forest Area: 0.33 Hectares)
- Scale:** A graphical scale bar indicating distances from 0 to 100 meters.
- North Arrow:** Located at the top right, pointing towards the upper right corner.
- Grid System:** The map is overlaid with a coordinate grid. Latitude coordinates are marked on the left side (14°02'38" N, 14°02'00" N, 14°01'30" N, 14°01'00" N, 14°00'30" N). Longitude coordinates are marked along the bottom edge (75°29'00" E, 75°29'30" E, 75°30'00" E, 75°30'30" E).
- Village Boundary:** Indicated by a dashed line labeled "VILLAGE STARTS @ CH:11265.4".
- Road Network:** Several roads are shown, including a main road running diagonally across the center and smaller access roads.
- Land Parcels:** Numerous small rectangular plots are delineated, many containing numbers (e.g., 1, 2, 3, ..., 100).
- Forest Area:** A specific area is identified as having a forest cover of 0.33 hectares.
- Other Labels:** Various place names and landmarks are written in Kannada script, such as "ಕೊನ್ನಗವಳ್ಳಿ ಗ್ರಾಮ" (Konnagavalli Village) and "ಅರಣ್ಯ ಭೂಮಿ" (Forest Land).

ကလေး

VILLAGE
CH:13560

(ఈ అళియ క్రూర గణించియ్యదు అందరేక్షియియ్యదు గళు అధిదా గ: ౨౯౦)

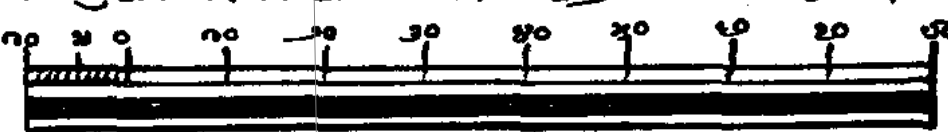

ఈ అశోకయోజనా దశరథశిఖా అందరే యింగ్రేజులు (1)
 2. అందు దశరథ శిఖా అందరే యింగ్రేజులు (33)
 ఈ గ్రామమున అచ్చురు, నందిరు, యిరువురు ప్రజలు (93)

VILLAGE STARTS
@ CH:11265.4

క్రయ రూపాయి 3 = 00

ಆಯಾ ರಿಸಿಡ ವರು.ನಿ.ಅರ್.ವೈ.ಸಾ.ಸಾ.ಹಾಲ್ ಕೆ|| ೫೬ ||

Name of Project: Construction of New BG Railway Line in Forest lands in various villages of Shimoga & Davangere District in favour of Deputy Chief Engineer, construction, South Western Railway Mysuru

GPS MAP SHOWING AREA FOR KONNAGAVALLI VILLAGE

(Forest Area: 0.33 Hectares)

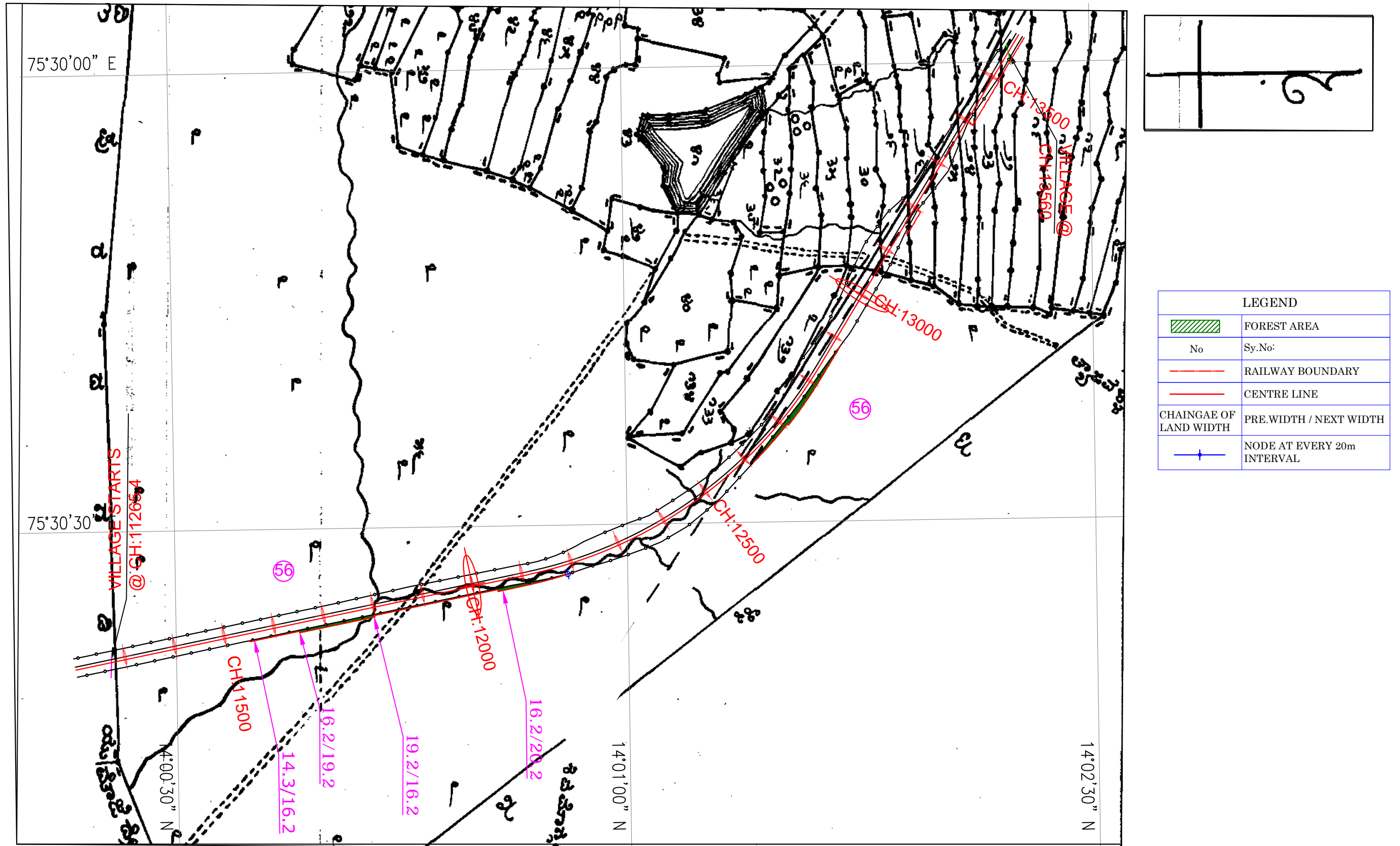



Name of Project: Construction of New BG Railway Line in Forest lands in various villages of Shimoga & Davangere District in favour of Deputy Chief Engineer, construction, South Western Railway Mysuru

GPS MAP SHOWING AREA FOR KONDAJJI VILLAGE (Forest Area: 1.20 Hectares)

LEGEND	
	FOREST AREA
	Sy.No.
	RAILWAY BOUNDARY
	CENTRE LINE
	CHAINAGE OF LAND WIDTH
	PRE WIDTH / NEXT WIDTH
	NODE AT EVERY 20m INTERVAL

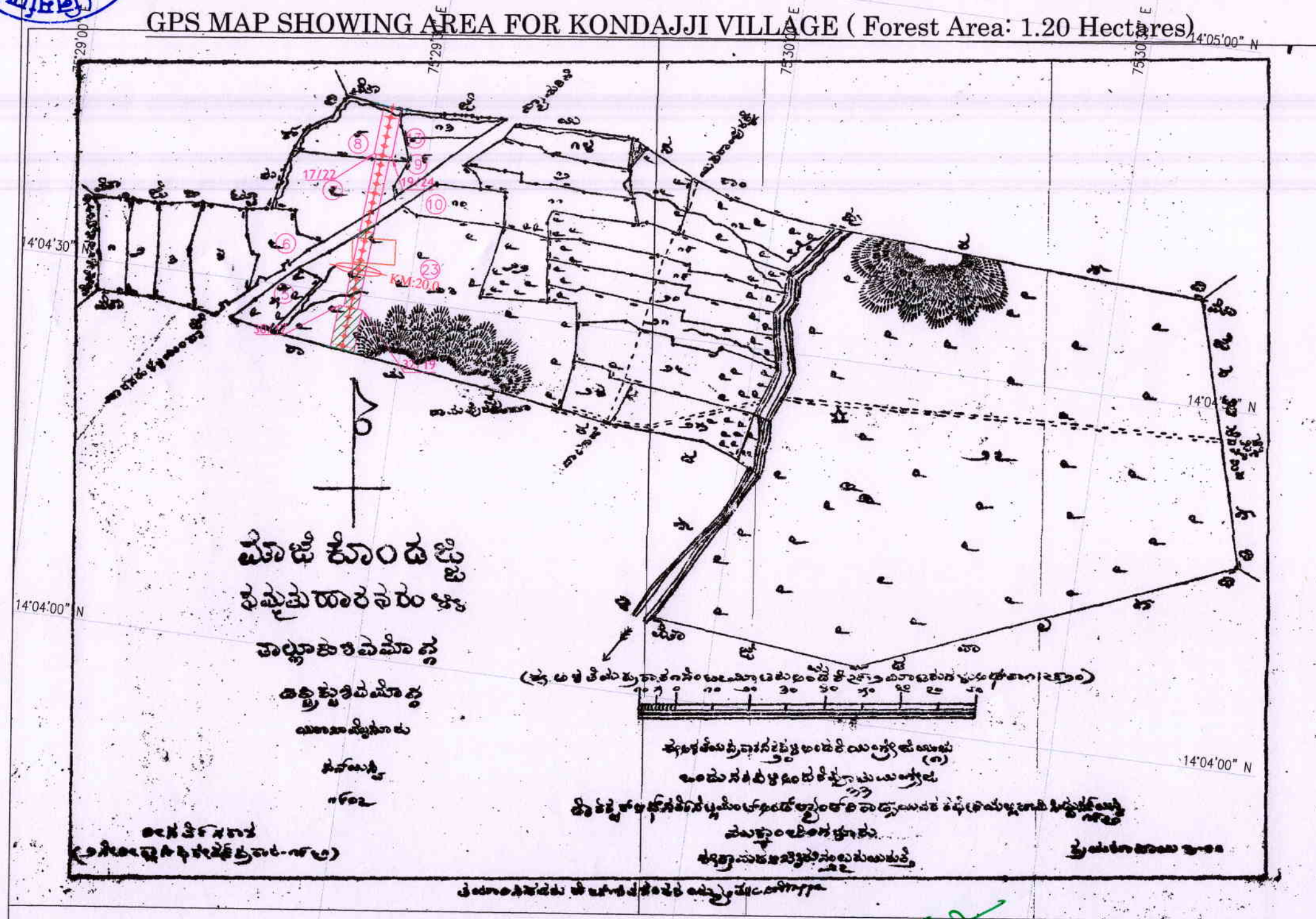

Asst. Executive Engineer
(Construction)
South Western Railway
MYSORE - 570 020.

उप मुख्य इंजीनियर
Dy. Chief Engineer
निर्माण / Construction
दक्षिण पश्चिम रेलवे, मैसूर
South Western Railway, Mysore

Name of Project: Construction of New BG Railway Line in Forest lands in various villages of Shimoga & Davangere District in favour of Deputy Chief Engineer, construction, South Western Railway Mysuru

GPS MAP SHOWING AREA FOR KONDAJJI VILLAGE

(Forest Area: 1.20 Hectares)

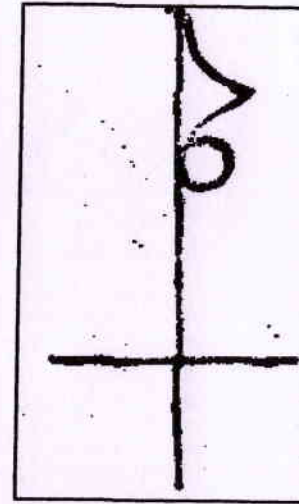
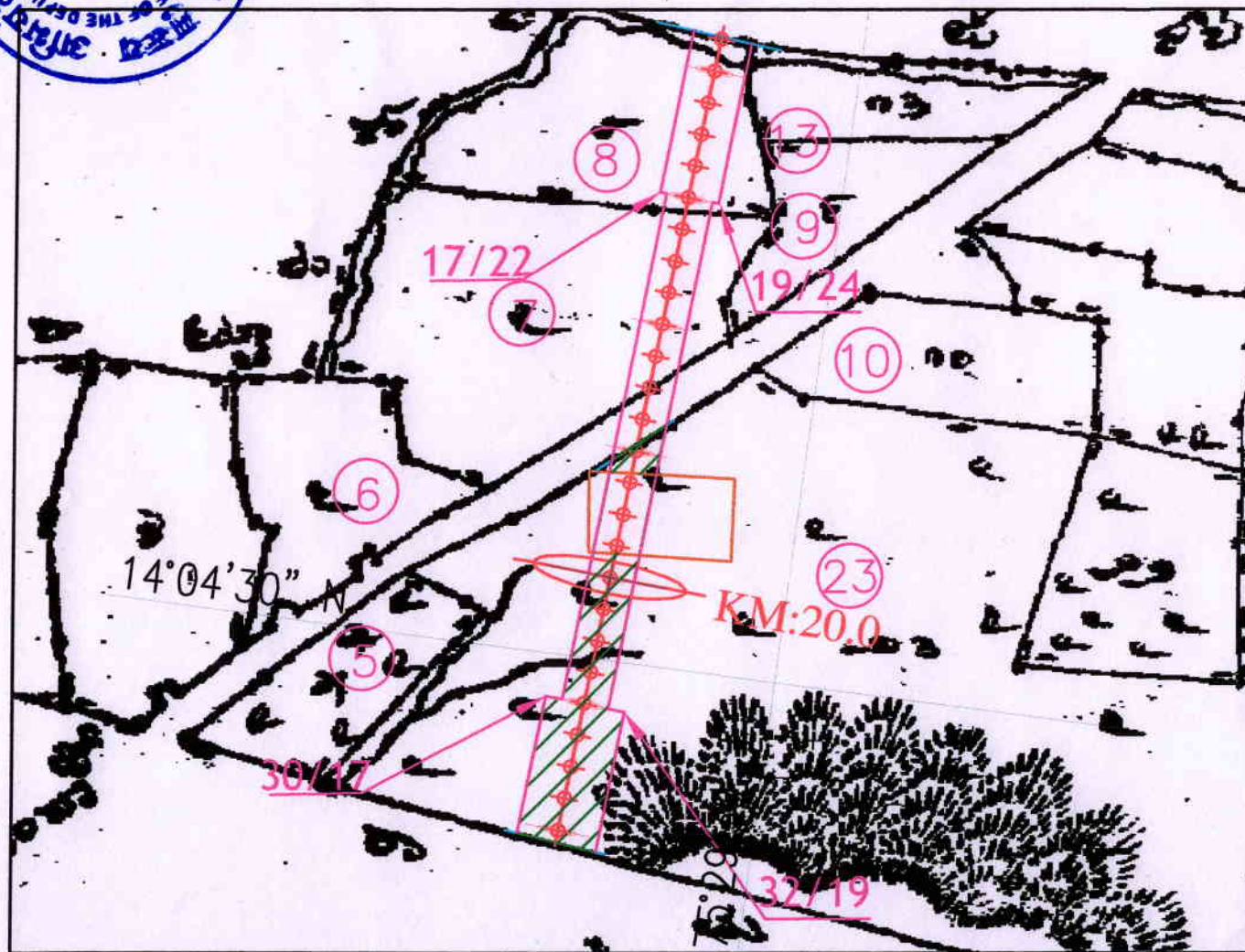

LEGEND	
	FOREST AREA
	Sy.No:
	RAILWAY BOUNDARY
	CENTRE LINE
CHAINGAE OF LAND WIDTH	PRE.WIDTH / NEXT WIDTH
	NODE AT EVERY 20m INTERVAL

Asst. Executive Engineer
(Construction)
South Western Railway
MYSORE - 570 020.

उप मुख्य इंजीनियर
Dy. Chief Engineer
निर्माण / Construction
दक्षिण पश्चिम रेलवे, मैसूर
South Western Railway, Mysore

GPS MAP SHOWING AREA FOR KONDAJJI VILLAGE (Forest Area: 1.20 Hectares)

GPS MAP SHOWING AREA FOR KONDAJJI VILLAGE (Forest Area: 1.20 Hectares)

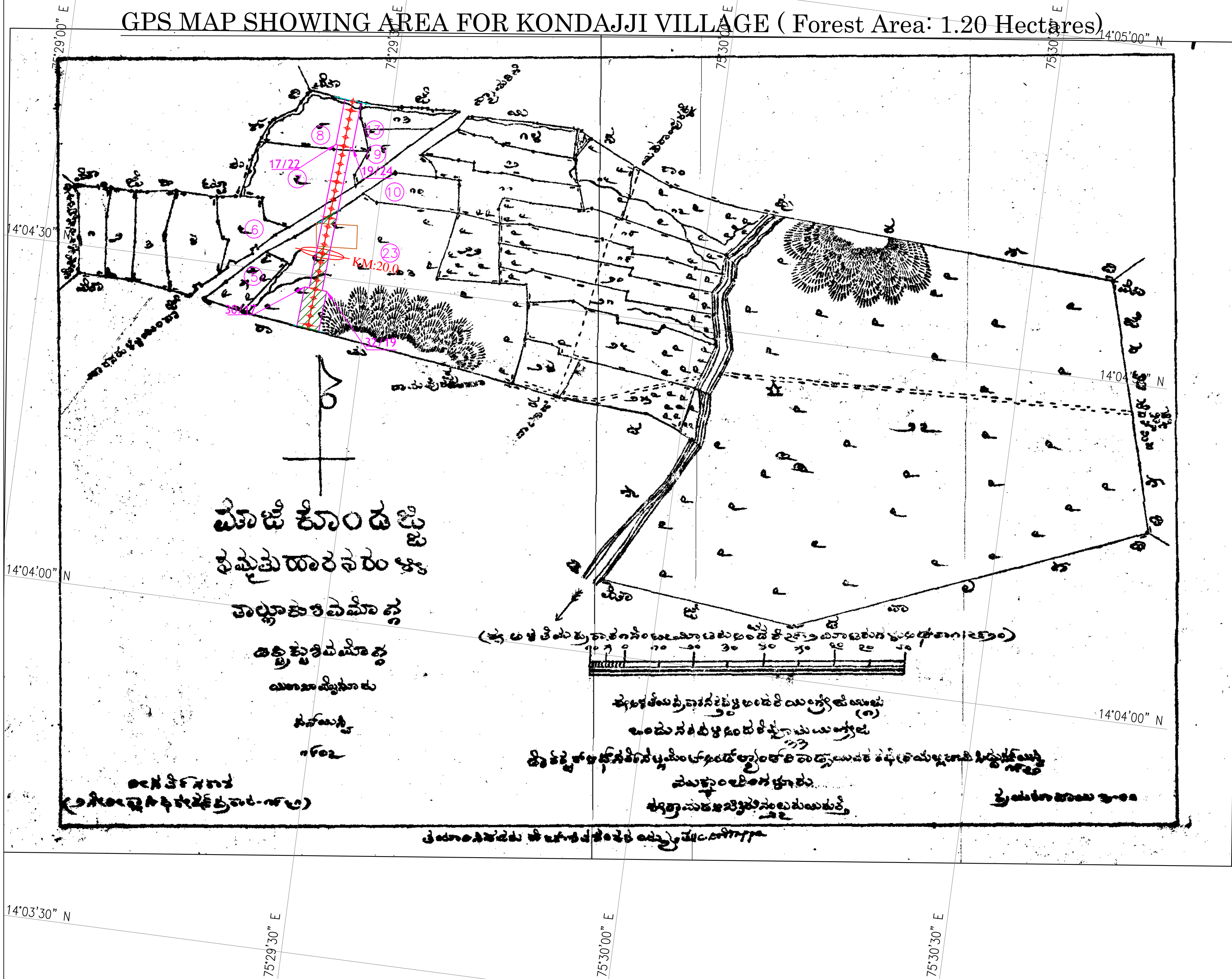

Name of Project: Construction of New BG Railway Line in Forest lands in various villages of Shimoga & Davangere District in favour of Deputy Chief Engineer, construction, South Western Railway Mysuru

GPS MAP SHOWING AREA FOR KONDAJJI VILLAGE

(Forest Area: 1.20 Hectares)

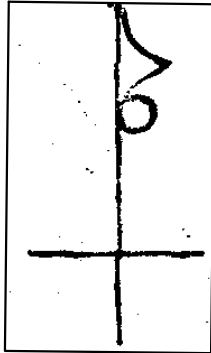
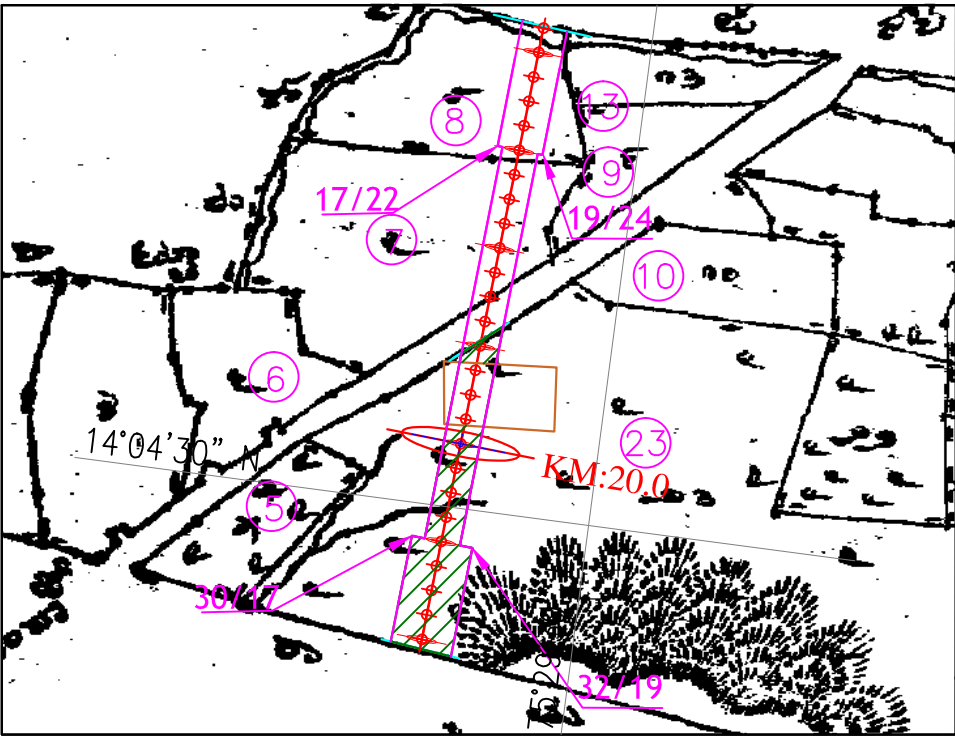

LEGEND	
	FOREST AREA
	Sy.No:
	RAILWAY BOUNDARY
	CENTRE LINE
CHAINGAE OF LAND WIDTH	PRE.WIDTH / NEXT WIDTH
	NODE AT EVERY 20m INTERVAL



Name of Project: Construction of New BG Railway Line in Forest lands in various villages of Shimoga & Davangere District in favour of Deputy Chief Engineer, construction, South Western Railway Mysuru

GPS MAP SHOWING AREA FOR NARAYANAPURA VILLAGE (Forest Area: 0.17 Hectares)

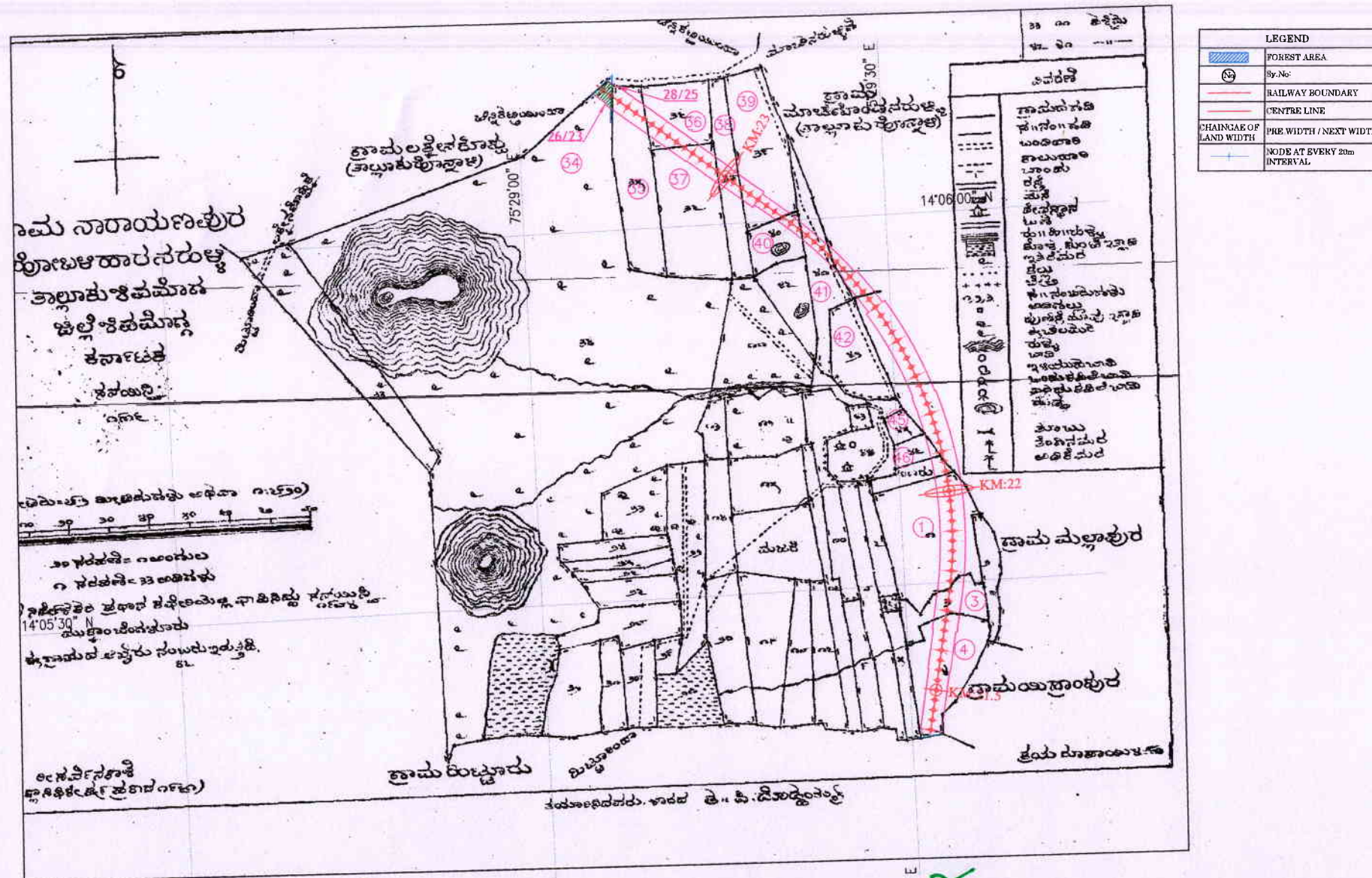

Asst. Executive Engineer
(Construction)
South Western Railway
MYSORE - 570 020.

उप मुख्य इंजीनियर
Dy. Chief Engineer
निर्माण / Construction
दक्षिण पश्चिम रेलवे, मैसूर
South Western Railway, Mysore

Name of Project: Construction of New BG Railway Line in Forest lands in various villages of Shimoga & Davangere District in favour of Deputy Chief Engineer, construction, South Western Railway Mysuru



GPS MAP SHOWING AREA FOR NARAYANAPURA VILLAGE
(Forest Area: 0.17 Hectares)

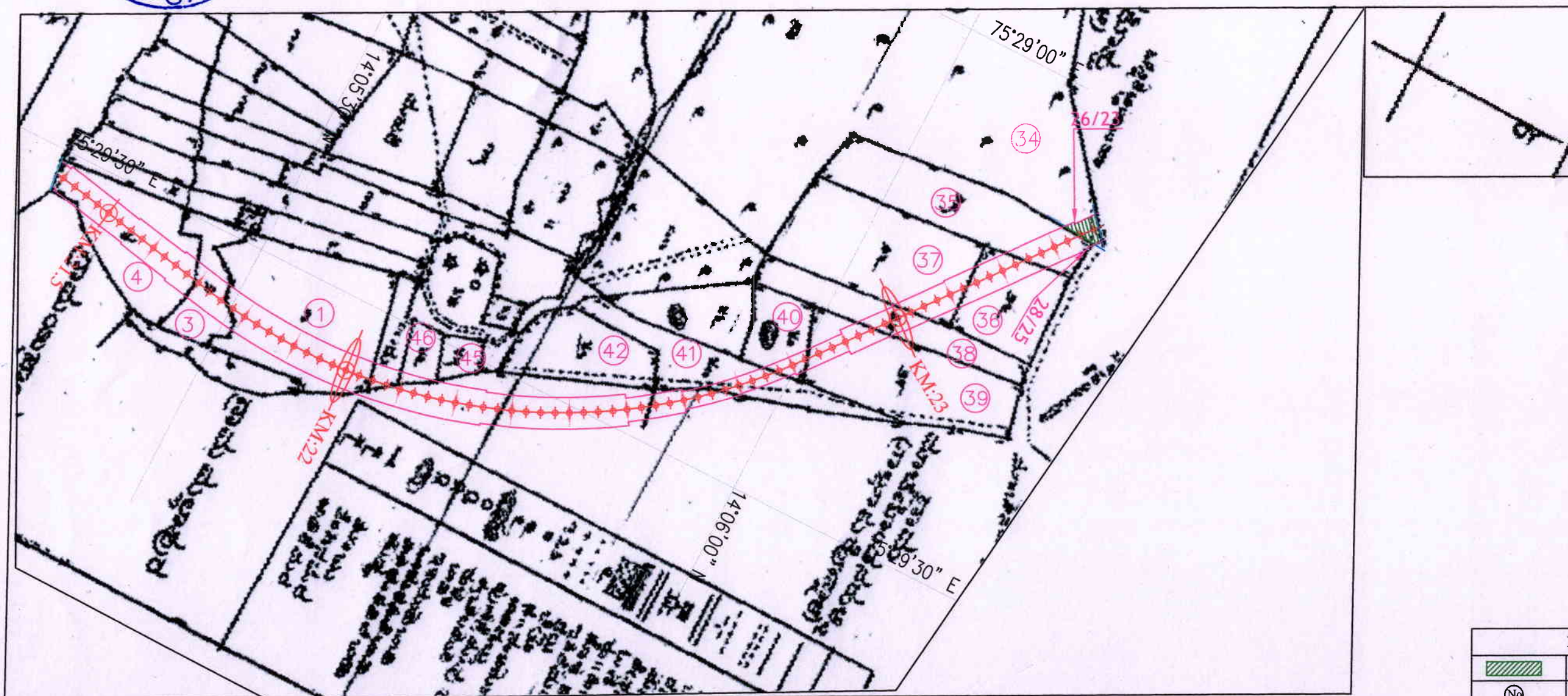

LEGEND	
	FOREST AREA
	Sy.No:
	RAILWAY BOUNDARY
	CENTRE LINE
CHAINGAE OF LAND WIDTH	PRE.WIDTH / NEXT WIDTH
	NODE AT EVERY 20m INTERVAL





[Signature]
Asst. Executive Engineer
(Construction)
South Western Railway
MYSORE - 570 020.

[Signature]
उप मुख्य इंजीनियर
Dy. Chief Engineer
निर्माण / Construction
दक्षिण पश्चिम रेलवे, मैसूर
South Western Railway, Mysore

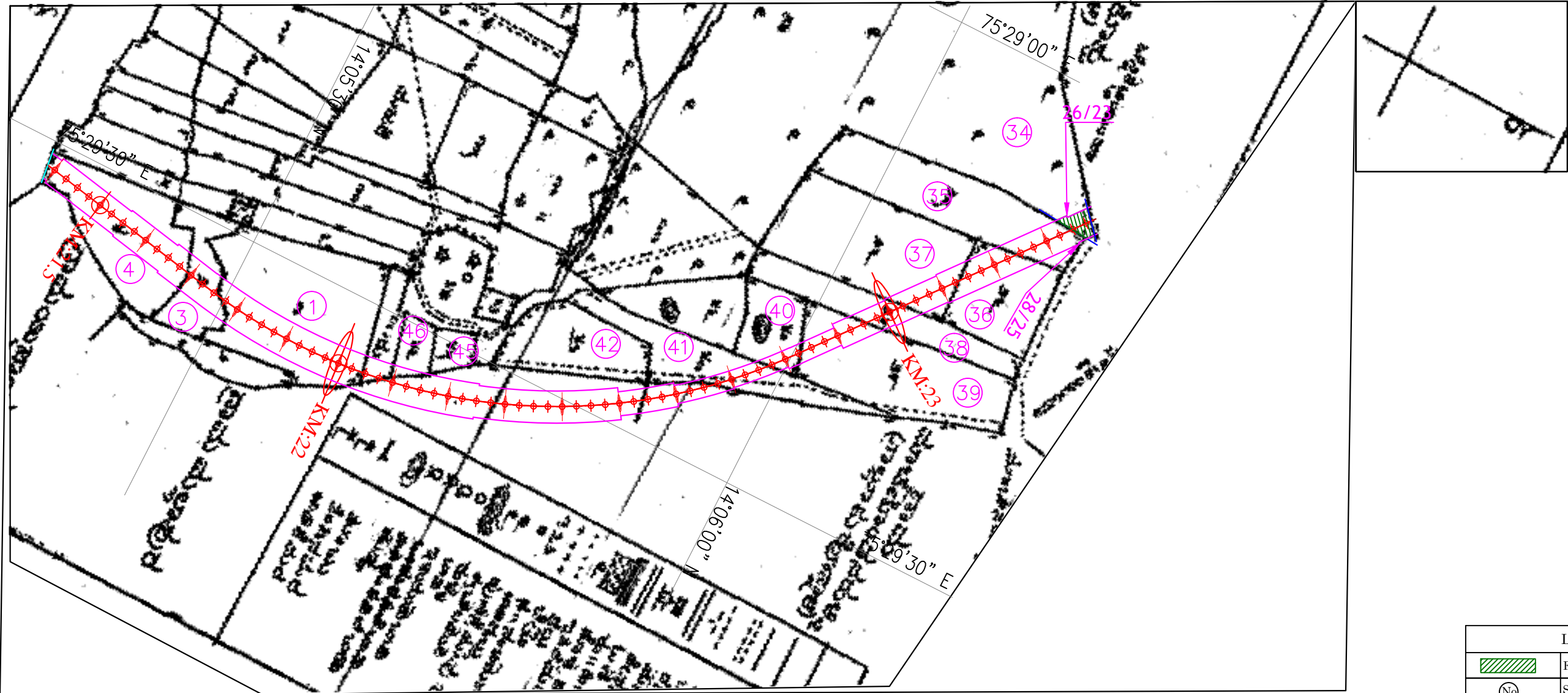
Name of Project: Construction of New BG Railway Line in Forest lands in various villages of Shimoga & Davangere District in favour of Deputy Chief Engineer, construction, South Western Railway Mysuru

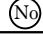
GPS MAP SHOWING AREA FOR NARAYANAPURA VILLAGE
(Forest Area: 0.17 Hectares)



LEGEND	
	FOREST AREA
	Sy.No:
	RAILWAY BOUNDARY
	CENTRE LINE
CHAINGAE OF LAND WIDTH	PRE.WIDTH / NEXT WIDTH
	NODE AT EVERY 20m INTERVAL

Name of Project: Construction of New BG Railway Line in Forest lands in various villages of Shimoga & Davangere District in favour of Deputy Chief Engineer, construction, South Western Railway Mysuru

GPS MAP SHOWING AREA FOR NARAYANAPURA VILLAGE (Forest Area: 0.17 Hectares)

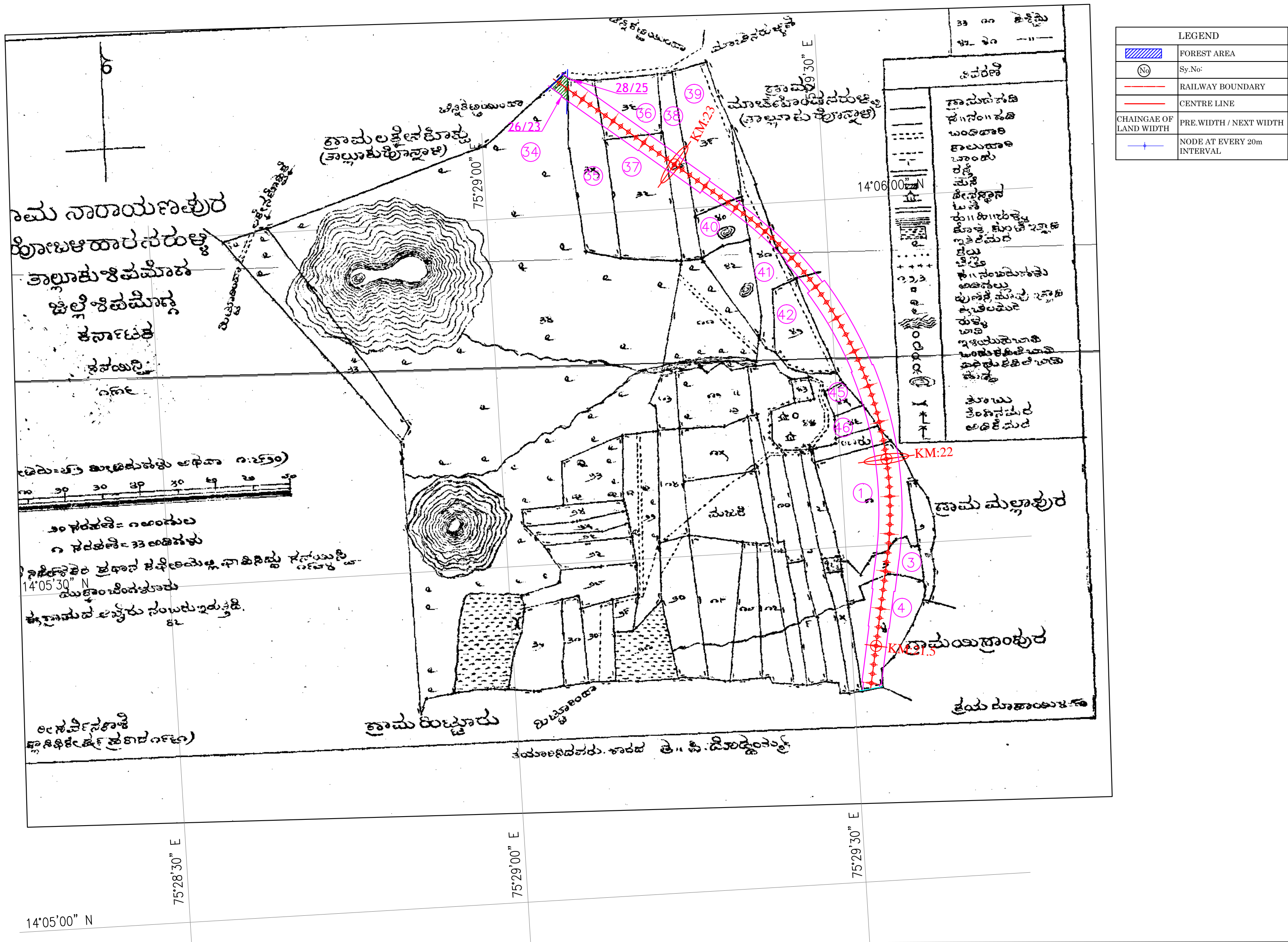



Name of Project: Construction of New BG Railway Line in Forest lands in various villages of Shimoga & Davangere District in favour of Deputy Chief Engineer, construction, South Western Railway Mysuru

GPS MAP SHOWING AREA FOR LAKKENAKOPPA VILLAGE (Forest Area: 0.21 Hectares)

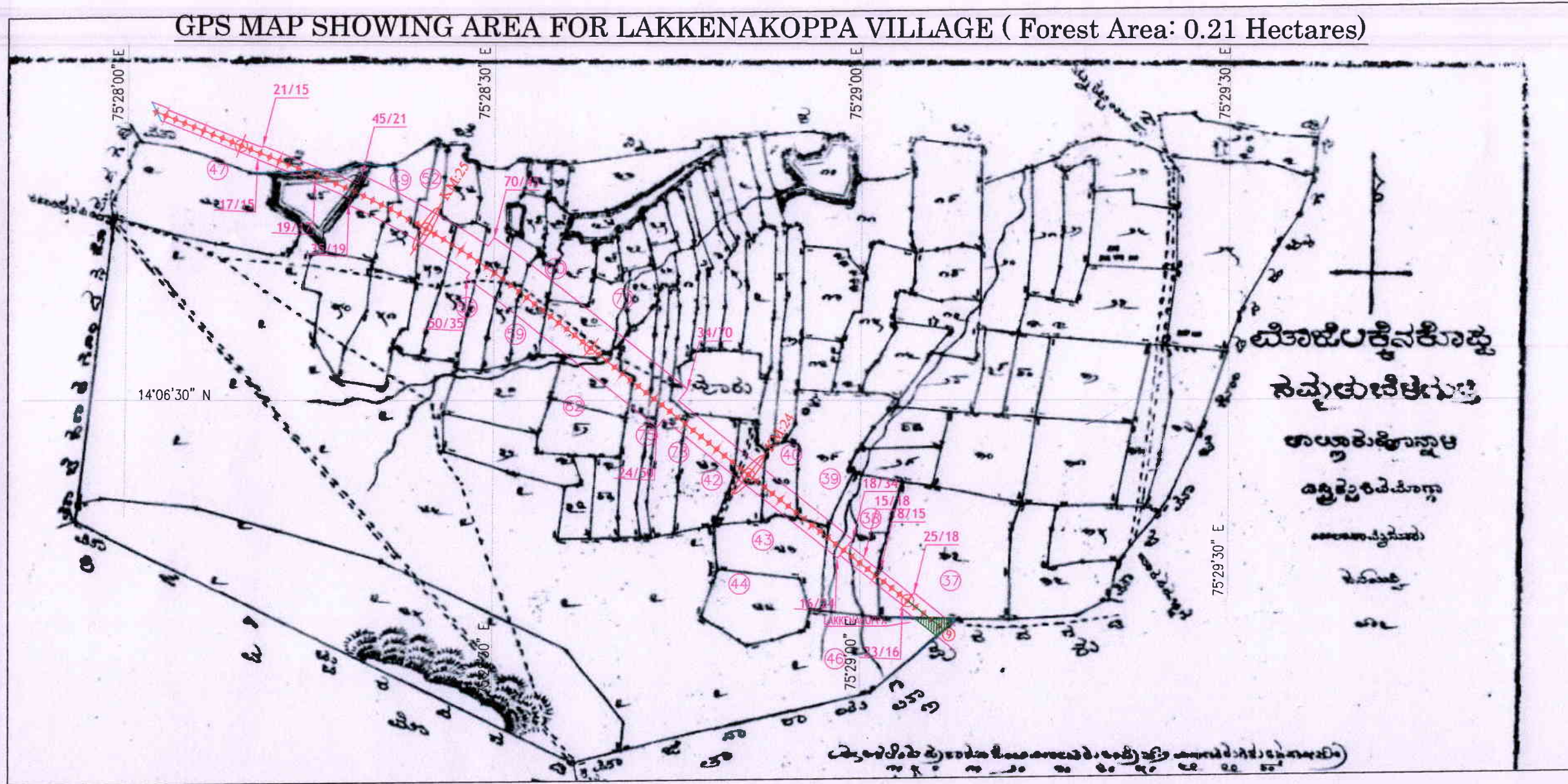

LEGEND	
	FOREST AREA
	Sr.No.
	RAILWAY BOUNDARY
	CENTRE LINE
	PRE WIDTH / NEXT WIDTH
	NODE AT EVERY 20m INTERVAL

Asst. Executive Engineer
(Construction)
South Western Railway
MYSORE - 570 020.

उप मुख्य इंजीनियर
Dy. Chief Engineer
निर्माण / Construction
दक्षिण पश्चिम रेलवे, मैसूर
South Western Railway, Mysore

Name of Project: Construction of New BG Railway Line in Forest lands in various villages of Shimoga & Davangere District in favour of Deputy Chief Engineer, construction, South Western Railway Mysuru

GPS MAP SHOWING AREA FOR LAKKENAKOPPA VILLAGE (Forest Area: 0.21 Hectares)



LEGEND	
	FOREST AREA
	Sy.No:
	RAILWAY BOUNDARY
	CENTRE LINE
CHAINAGE OF LAND WIDTH	PRE.WIDTH / NEXT WIDTH
	NODE AT EVERY 20m INTERVAL

[Signature]
Asst. Executive Engineer
(Construction)
South Western Railway
MYSORE - 570 020.

[Signature]
उप मुख्य इंजीनियर
Dy. Chief Engineer
निर्माण / Construction
दक्षिण पश्चिम रेलवे, मैसूर
South Western Railway, Mysore

Name of Project: Construction of New BG Railway Line in Forest lands in various villages of Shimoga & Davangere District in favour of Deputy Chief Engineer, construction, South Western Railway Mysuru

GPS MAP SHOWING AREA FOR LAKKENAKOPPA VILLAGE
(Forest Area: 0.21 Hectares)



Name of Project: Construction of New BG Railway Line in Forest lands in various villages of Shimoga & Davangere District in favour of Deputy Chief Engineer, construction, South Western Railway Mysuru

GPS MAP SHOWING AREA FOR LAKKENAKOPPA VILLAGE (Forest Area: 0.21 Hectares)

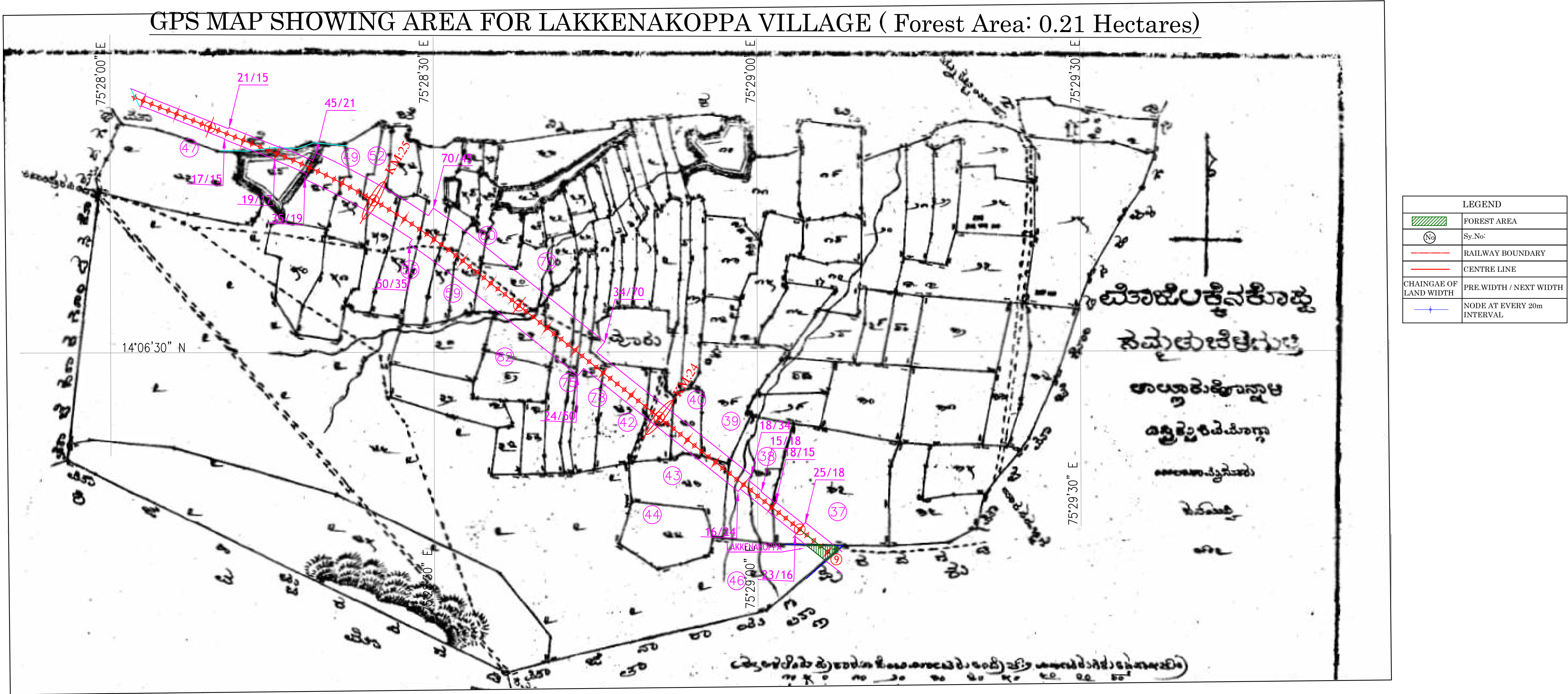

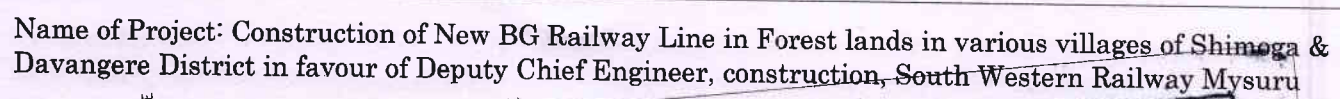

GPS MAP SHOWING AREA FOR BELAKATTE VILLAGE (Forest Area: 3.22 Hectares)

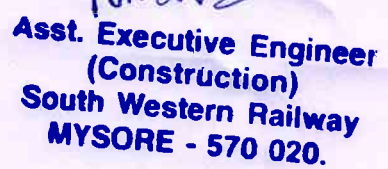

उप मुख्य इंजीनियर
Dy. Chief Engineer
 निर्माण / Construction
 दक्षिण पश्चिम रेलवे, मैसूर
South Western Railway, Mysore

Name of Project: Construction of New BG Railway Line in Forest lands in various villages of Shimoga & Davangere District in favour of Deputy Chief Engineer, construction, South Western Railway Mysuru



GPS MAP SHOWING AREA FOR BELAKATTE VILLAGE
(Forest Area: 3.22 Hectares)

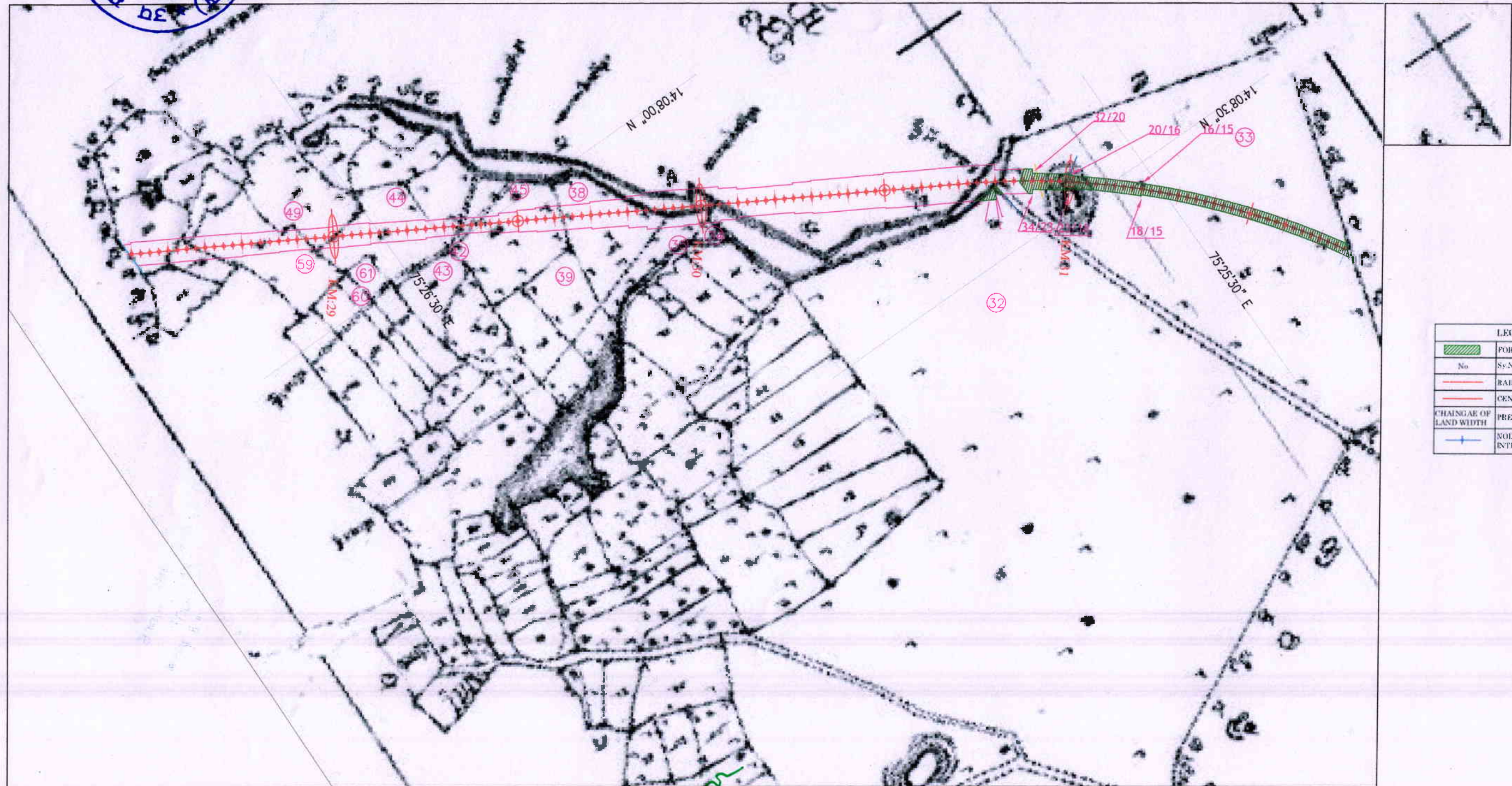

LEGEND	
	FOREST AREA
No.	Sy No.
	RAILWAY BOUNDARY
	CENTRE LINE
CHANGAE OF LAND WIDTH	PRE WIDTH / NEXT WIDTH
	NODE AT EVERY 20m INTERVAL

Asst. Executive Engineer
(Construction)
South Western Railway
MYSORE - 570 020.

उप मुख्य इंजीनियर
Dy. Chief Engineer
निर्माण / Construction
दक्षिण पश्चिम रेलवे, मैसूर
South Western Railway, Mysore

Name of Project: Construction of New BG Railway Line in Forest lands in various villages of Shimoga & Davangere District in favour of Deputy Chief Engineer, construction, South Western Railway Mysuru

GPS MAP SHOWING AREA FOR BELAKATTE VILLAGE (Forest Area: 3.22 Hectares)



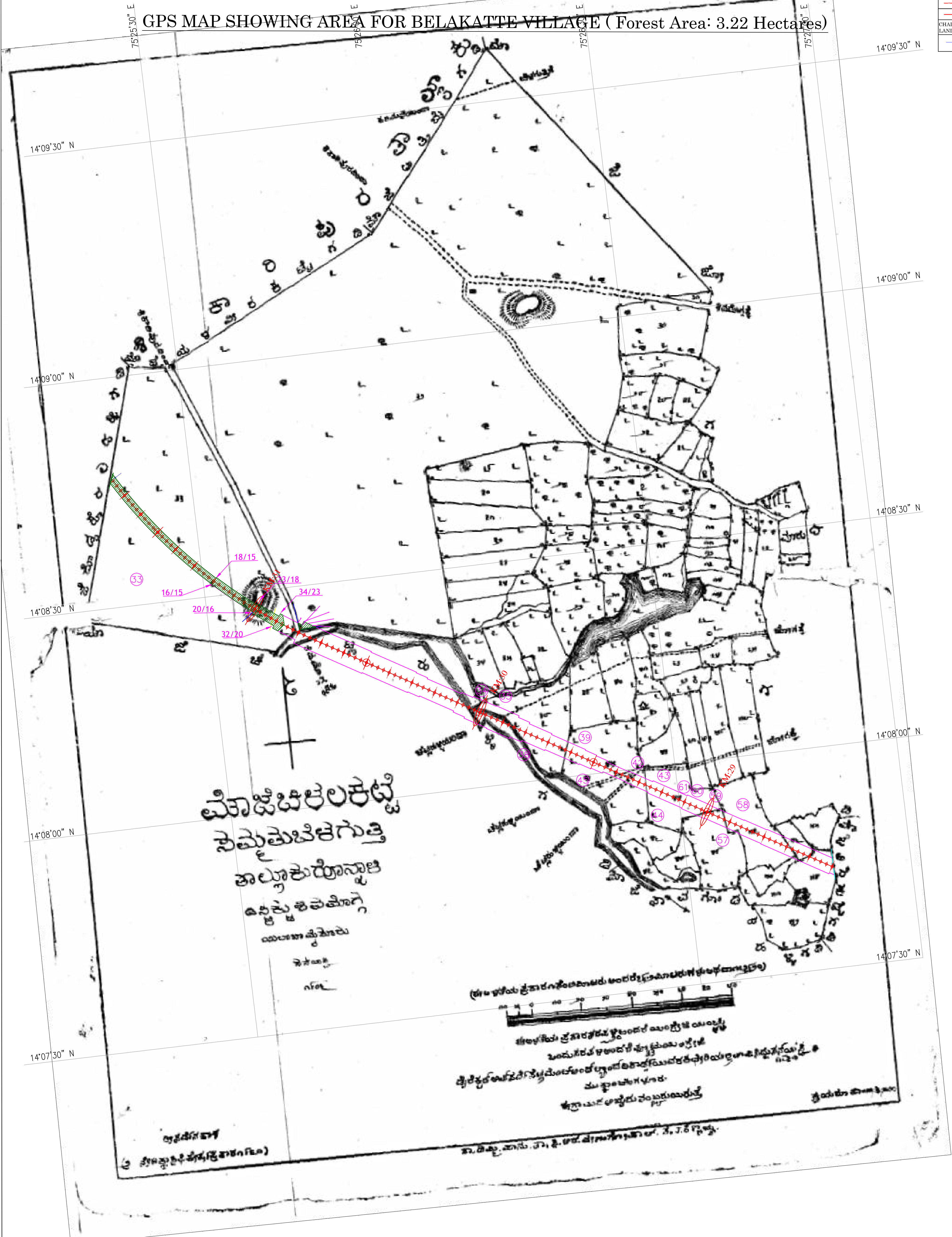

LEGEND	
	FOREST AREA
No	Sy.No
	RAILWAY BOUNDARY
	CENTRE LINE
CHANGAE OF LAND WIDTH	PRE WIDTH / NEXT WIDTH
	NODE AT EVERY 20m INTERVAL

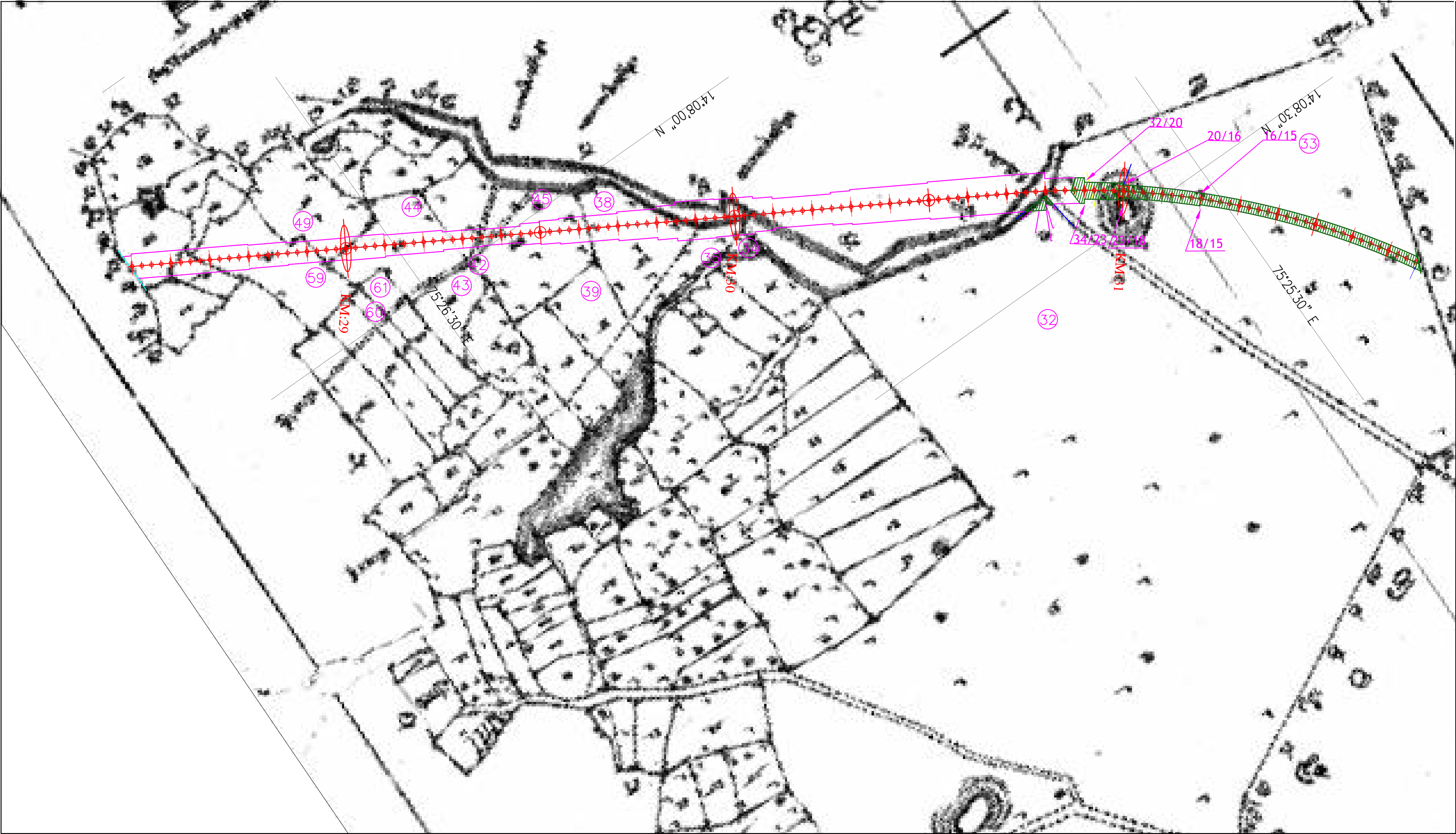

Name of Project: Construction of New BG Railway Line in Forest lands in various villages of Shimoga & Davangere District in favour of Deputy Chief Engineer, construction, South Western Railway Mysuru

GPS MAP SHOWING AREA FOR BELAKATTE VILLAGE
(Forest Area: 3.22 Hectares)



LEGEND	
	FOREST AREA
No	Sy.No:
	RAILWAY BOUNDARY
	CENTRE LINE
CHAINAGE OF LAND WIDTH	PRE. WIDTH / NEXT WIDTH
	NODE AT EVERY 20m INTERVAL



Name of Project: Construction of New BG Railway Line in Forest lands in various villages of Shimoga & Davangere District in favour of Deputy Chief Engineer, construction, South Western Railway Mysuru

GPS MAP SHOWING AREA FOR HIREKORALAHALLI VILLAGE (Forest Area: 3.71 Hectares)

LEGEND	
	FOREST AREA
	RAILWAY BOUNDARY
	RAILWAY LINE
	RAILWAY WIDTH
	RAILWAY WIDTH
	RAILWAY WIDTH
	RAILWAY WIDTH

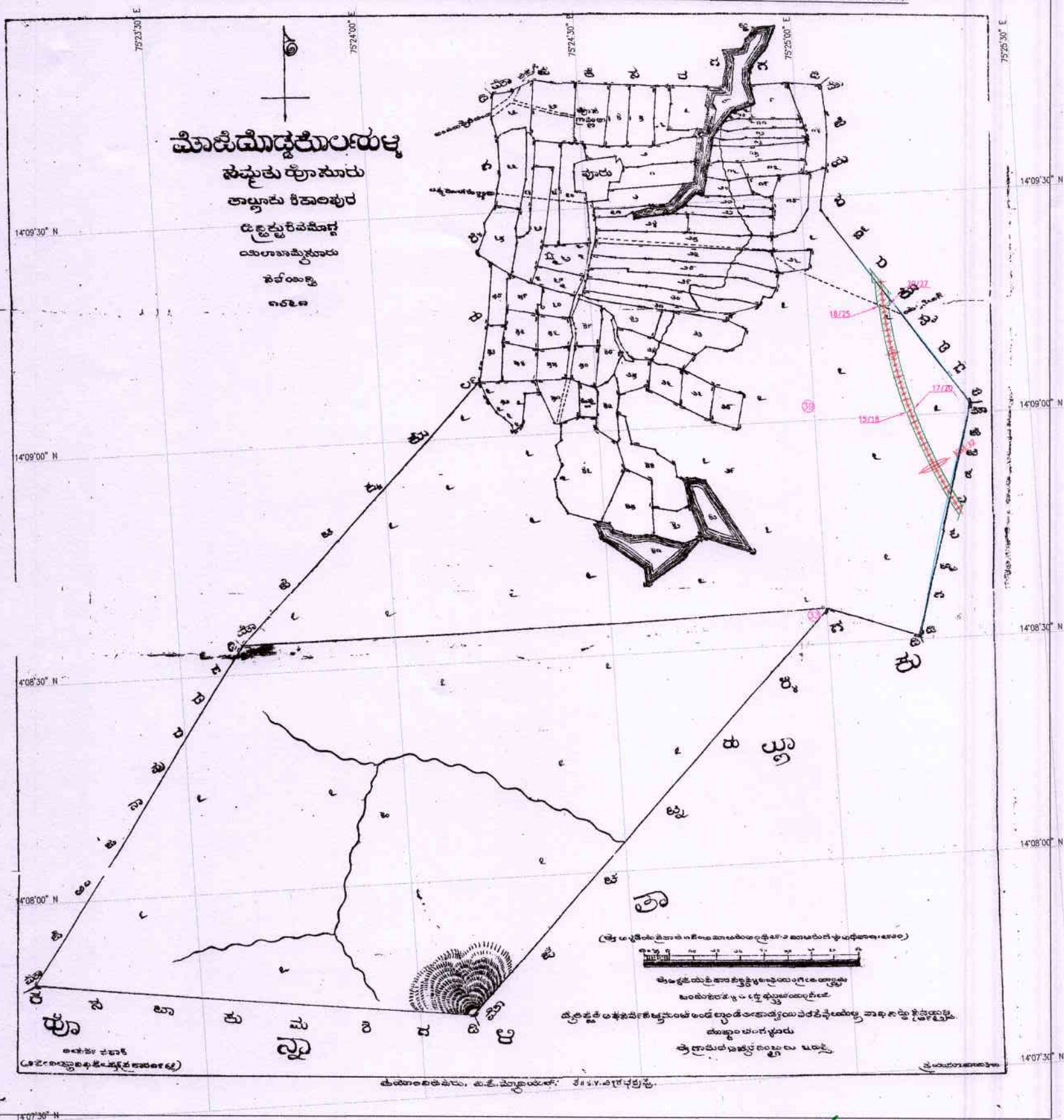



Asst. Executive Engineer
(Construction)
South Western Railway
MYSORE - 570 020.

उप मुख्य इंजीनियर
Dy. Chief Engineer
निर्माण / Construction
दक्षिण पश्चिम रेलवे, मैसूर
South Western Railway, Mysore

Name of Project: Construction of New BG Railway Line in Forest lands in various villages of Shimoga & Davangere District in favour of Deputy Chief Engineer, construction, South Western Railway Mysuru

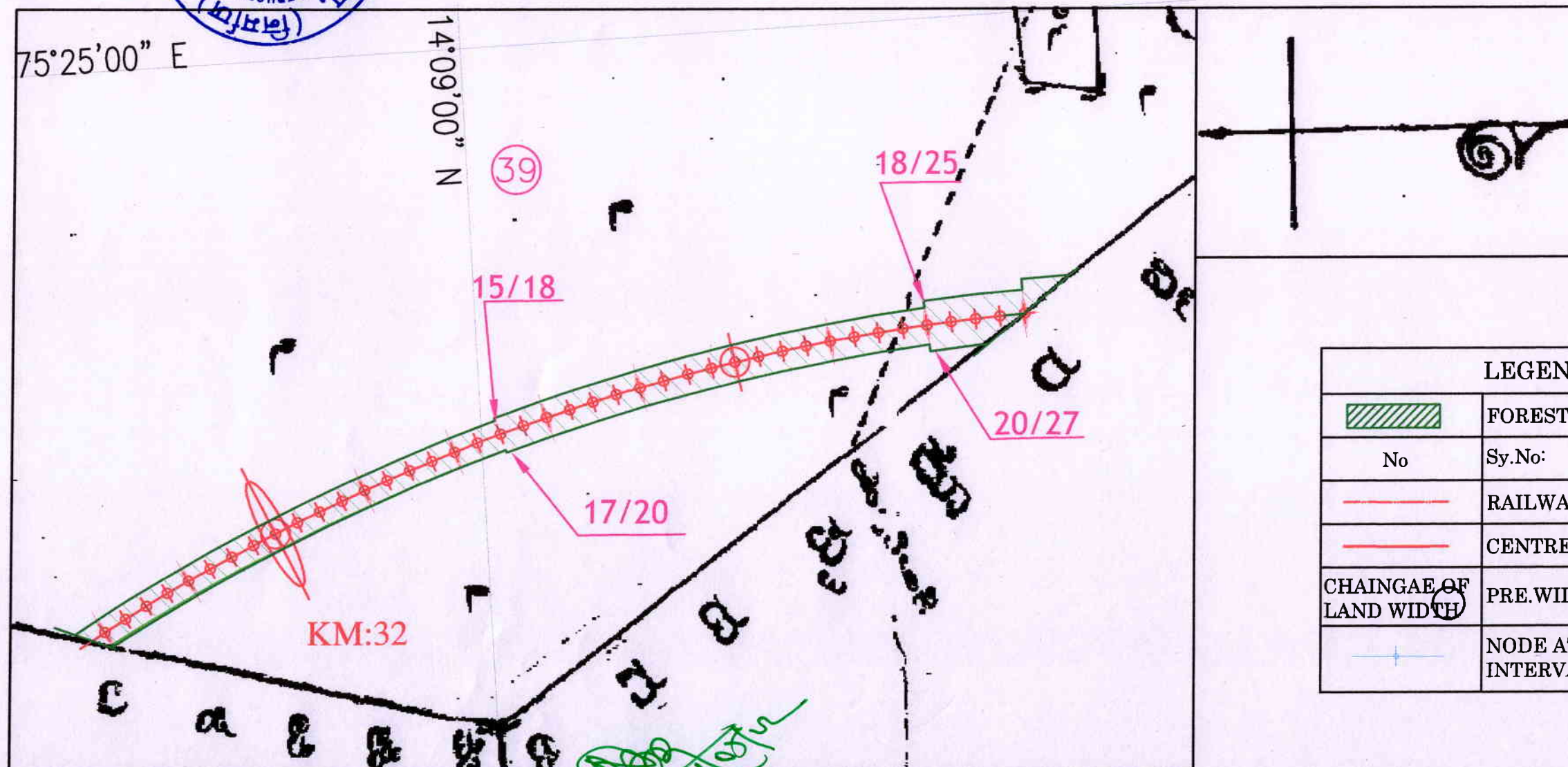
GPS MAP SHOWING AREA FOR HIREKORALAHALLI VILLAGE (Forest Area: 3.71 Hectares)



LEGEND	
	FOREST AREA
No	Sy.No:
	RAILWAY BOUNDARY
	CENTRE LINE
CHAINGAE OF LAND WIDTH	PRE.WIDTH / NEXT WIDTH
	NODE AT EVERY 20m INTERVAL

Asst. Executive Engineer
(Construction)
South Western Railway
MYSORE - 570 020.

उप मुख्य इंजीनियर
Dy. Chief Engineer
निर्माण / Construction
दक्षिण पश्चिम रेलवे, मैसूर
South Western Railway, Mysore

Name of Project: Construction of New BG Railway Line in Forest lands in various villages of Shimoga & Davangere District in favour of Deputy Chief Engineer, construction, South Western Railway Mysuru



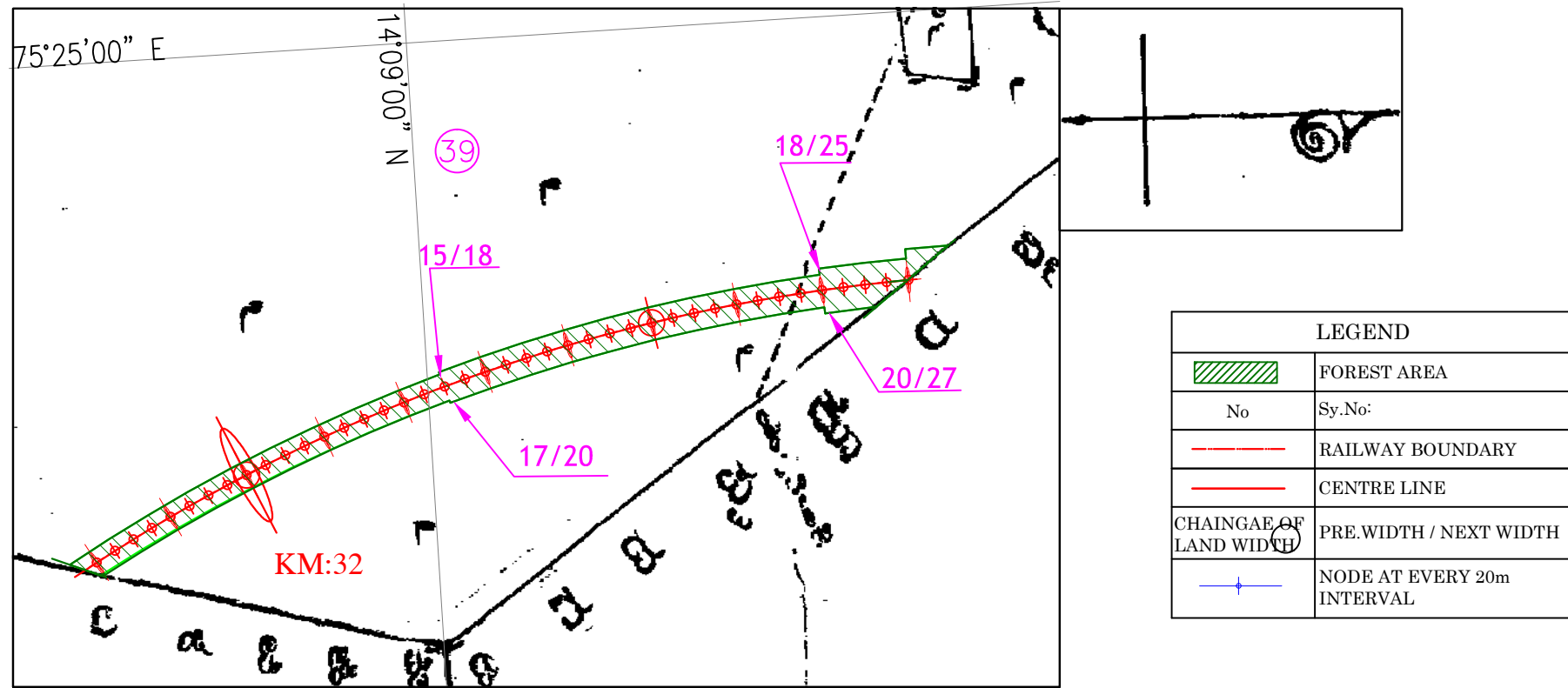



GPS MAP SHOWING AREA FOR HIREKORALAHALLI VILLAGE
(Forest Area: 3.71 Hectares)

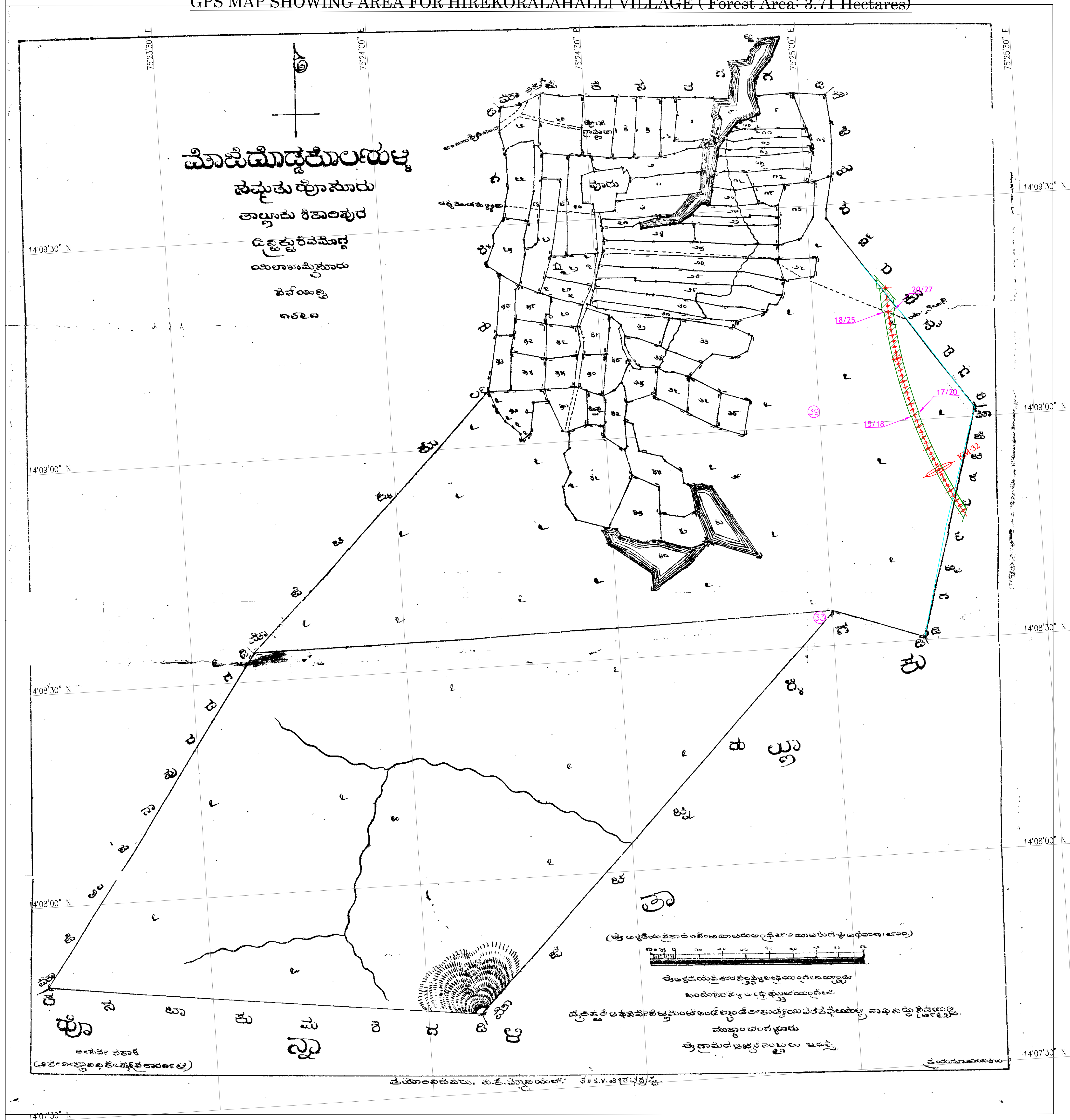

Name of Project: Construction of New BG Railway Line in Forest lands in various villages of Shimoga & Davangere District in favour of Deputy Chief Engineer, construction, South Western Railway Mysuru

GPS MAP SHOWING AREA FOR HIREKORALAHALLI VILLAGE (Forest Area: 3.71 Hectares)



LEGEND	
	FOREST AREA
	Sy.No:
	RAILWAY BOUNDARY
	CENTRE LINE
	PRE. WIDTH / NEXT WIDTH
	NODE AT EVERY 20m INTERVAL