

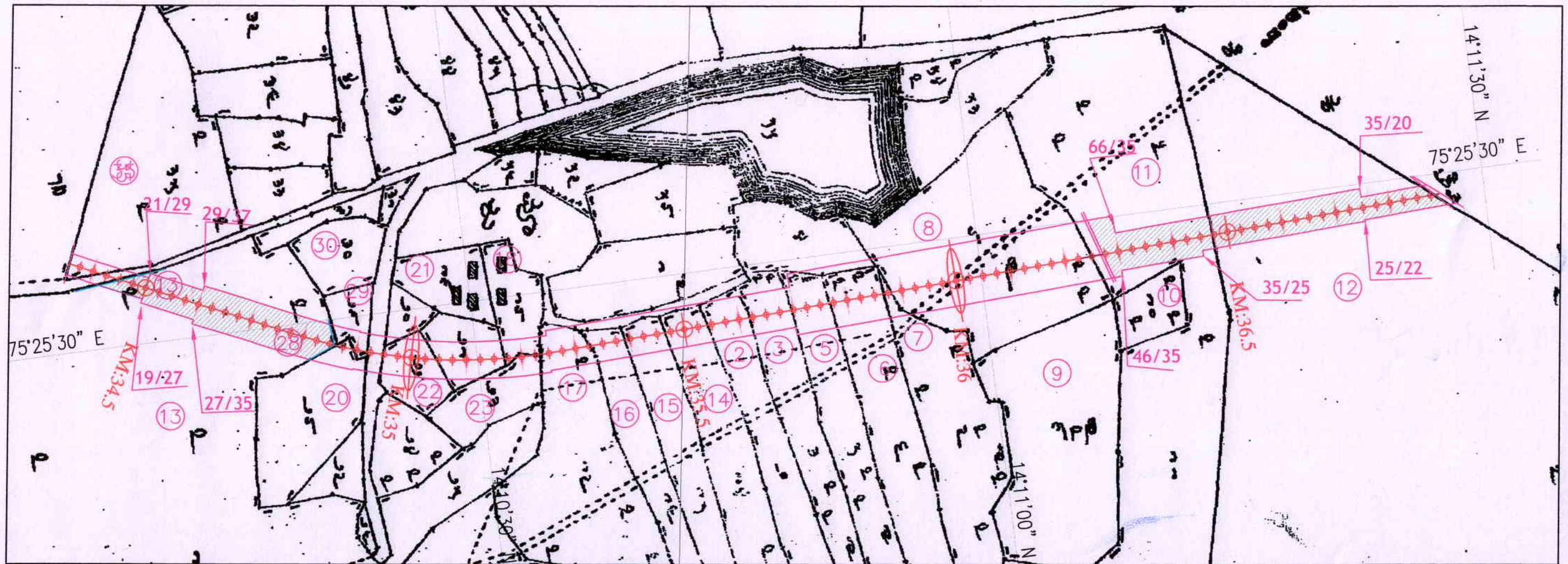

Name of Project: Construction of New BG Railway Line in Forest lands in various villages of Shimoga & Davangere District in favour of Deputy Chief Engineer, construction, South Western Railway Mysuru



GPS MAP SHOWING AREA FOR HAROGOPPA VILLAGE (Forest Area: 6.29 Hectares)



[Signature]
Asst. Executive Engineer
(Construction)
South Western Railway
MYSORE - 570 020.

[Signature]
उप मुख्य इंजीनियर
Dy. Chief Engineer
निर्माण / Construction
दक्षिण पश्चिम रेलवे, मैसूर
South Western Railway, Mysore

LEGEND	
	FOREST AREA
	Sy.No:
	RAILWAY BOUNDARY
	CENTRE LINE
CHAINAGE OF LAND WIDTH	PRE.WIDTH / NEXT WIDTH
	NODE AT EVERY 20m INTERVAL

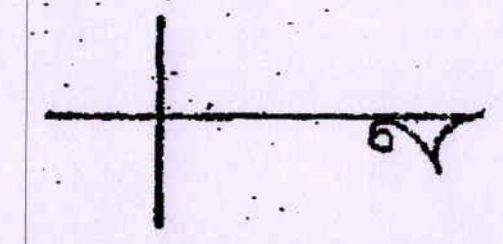

Name of Project: Construction of New BG Railway Line in Forest lands in various villages of Shimoga & Davangere District in favour of Deputy Chief Engineer, construction, South Western Railway Mysuru

GPS MAP SHOWING AREA FOR HAROGOPPA VILLAGE (Forest Area: 6.29 Hectares)
Sy no-11=1.62Hectares, Sy no-12=2.16Hectares, Sy no-13=2.51Hectares



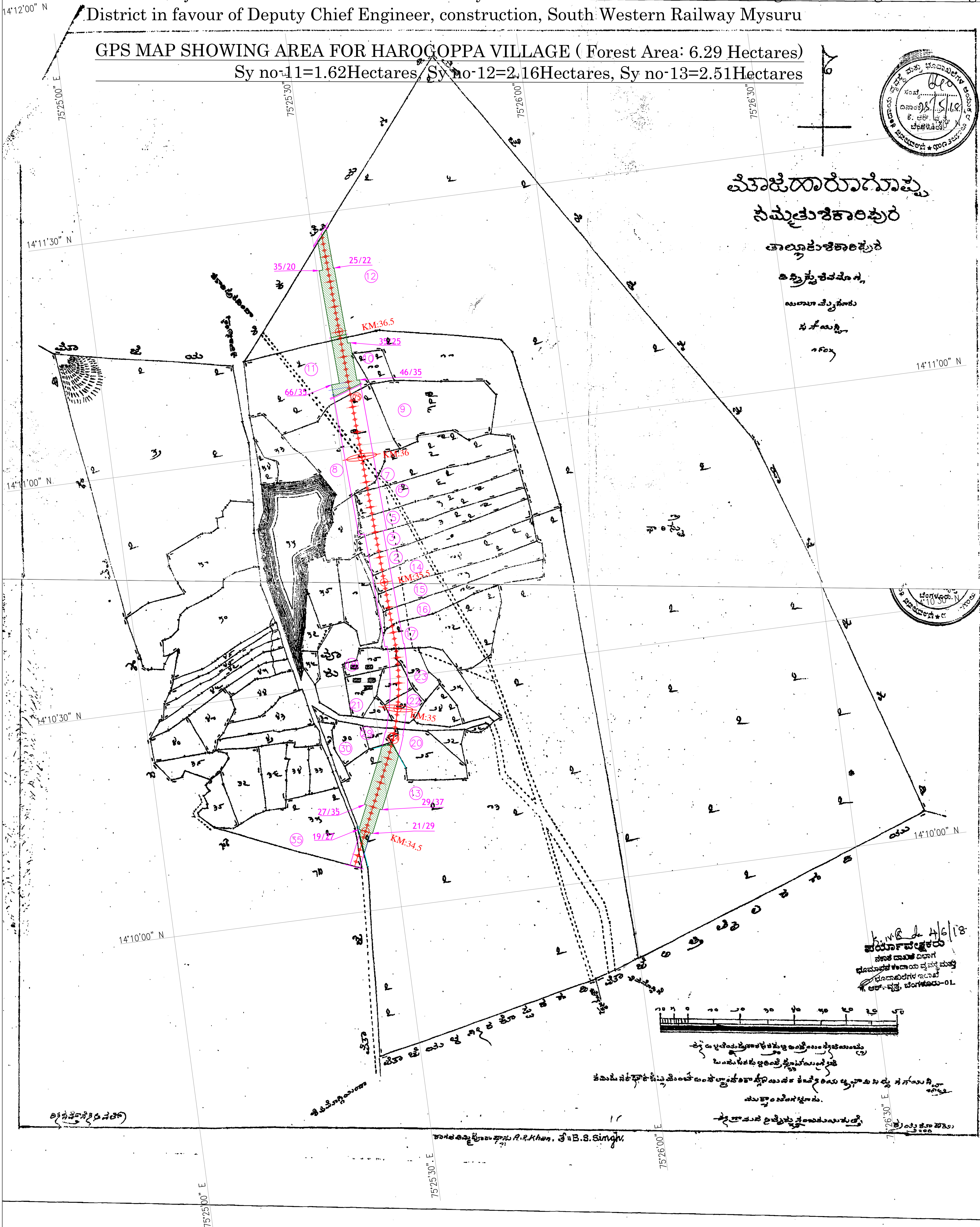

LEGEND	
	FOREST AREA
	Sy.No
	RAILWAY BOUNDARY
	CENTRE LINE
CHAINAGE OF LAND WIDTH	PRE.WIDTH / NEXT WIDTH
	NODE AT EVERY 20m INTERVAL

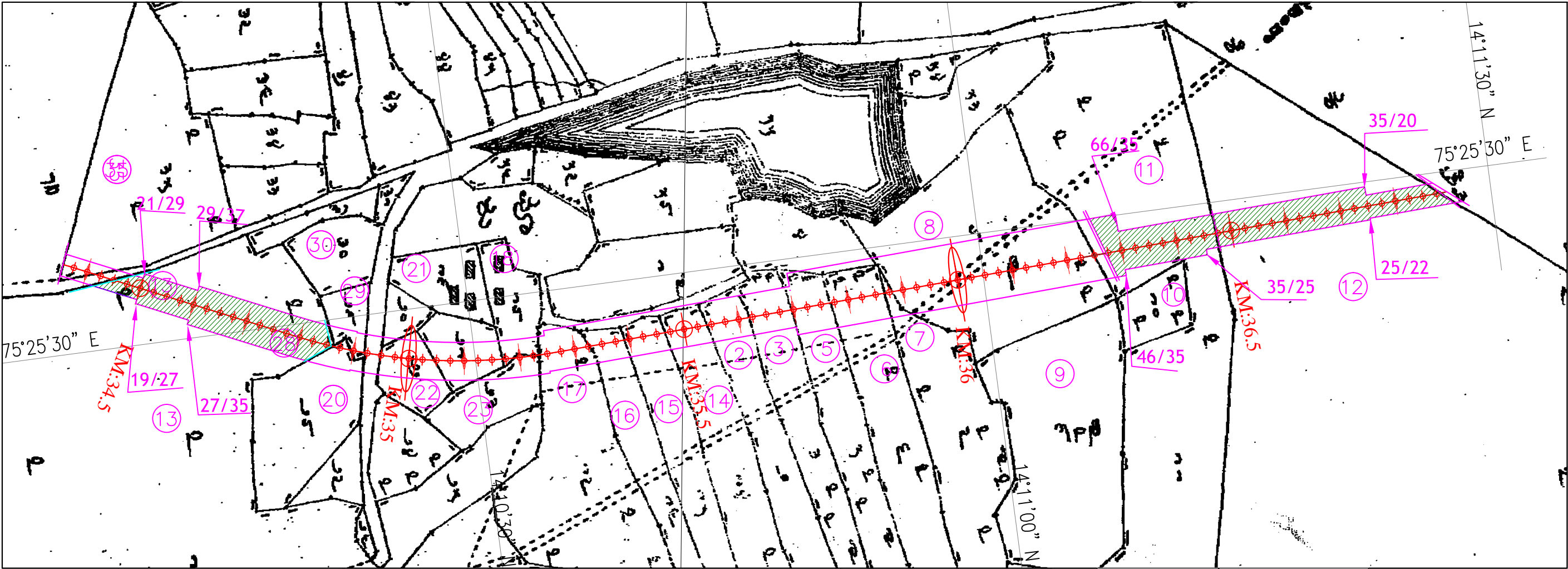

Name of Project: Construction of New BG Railway Line in Forest lands in various villages of Shimoga & Davangere District in favour of Deputy Chief Engineer, construction, South Western Railway Mysuru

GPS MAP SHOWING AREA FOR HAROGOPPA VILLAGE
(Forest Area: 6.29 Hectares)



LEGEND	
	FOREST AREA
	Sy.No:
	RAILWAY BOUNDARY
	CENTRE LINE
CHAINGAE OF LAND WIDTH	PRE.WIDTH / NEXT WIDTH
	NODE AT EVERY 20m INTERVAL

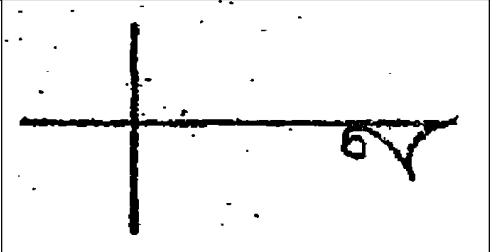



Name of Project: Construction of New BG Railway Line in Forest lands in various villages of Shimoga & Davangere District in favour of Deputy Chief Engineer, construction, South Western Railway Mysuru

GPS MAP SHOWING AREA FOR YERAKATTI VILLAGE (Forest Area: 10.5 Hectares)

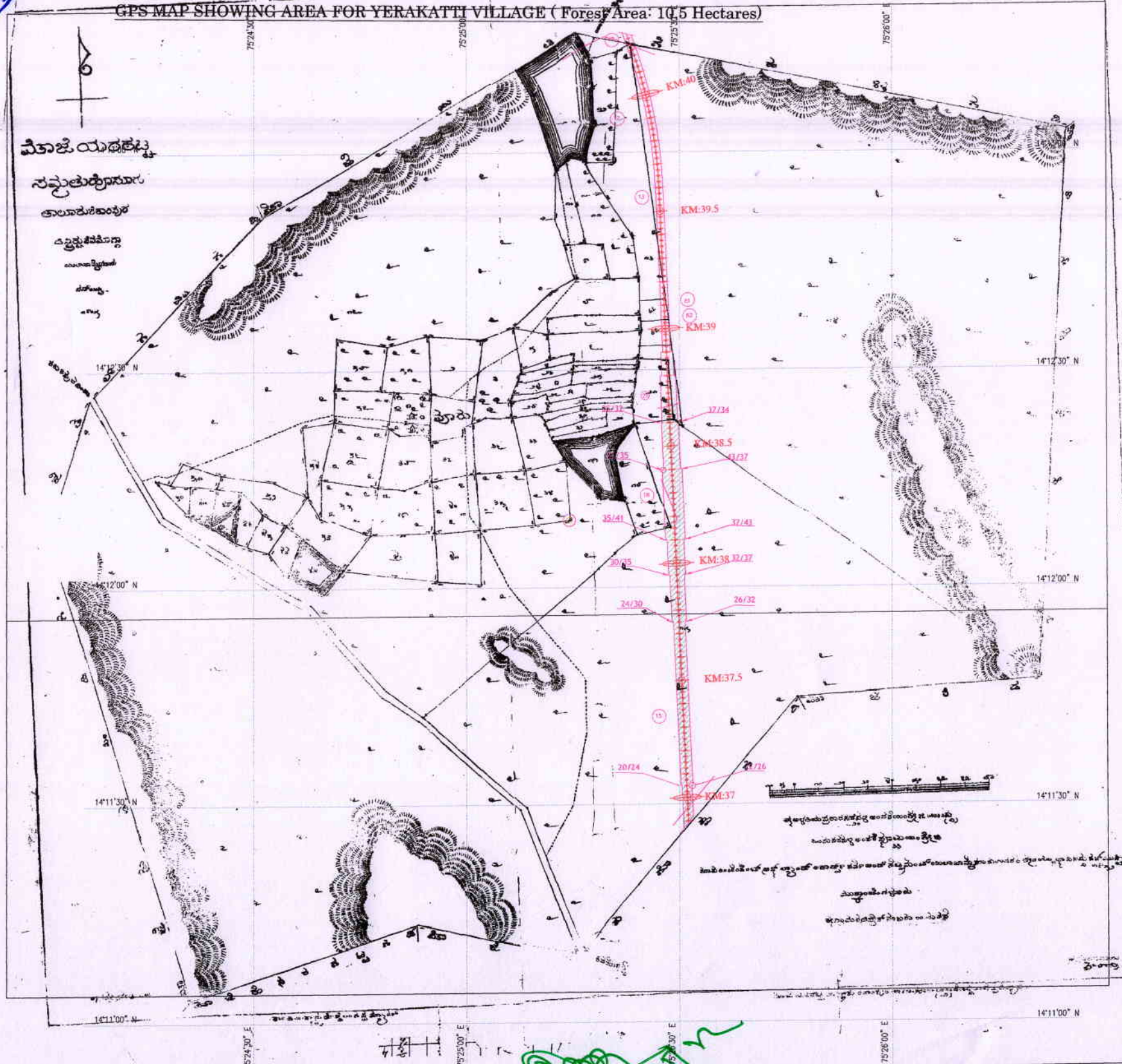

LEGEND	
	FOREST AREA
	RAILWAY BOUNDARY
	RAILWAY LINE
	OTHER LINE
	BOUNDARY OF LAND WIDTH
	INTERVAL AT EVERY 50m

Asst. Executive Engineer
(Construction)
South Western Railway
MYSORE - 570 020.

उप मुख्य इंजीनियर
Dy. Chief Engineer
निर्माण / Construction
दक्षिण पश्चिम रेलवे, मैसूर
South Western Railway, Mysore

Name of Project: Construction of New BG Railway Line in Forest lands in various villages of Shimoga & Davangere District in favour of Deputy Chief Engineer, construction, South Western Railway Mysuru



GPS MAP SHOWING AREA FOR YERAKATTI VILLAGE
(Forest Area: 10.5 Hectares)

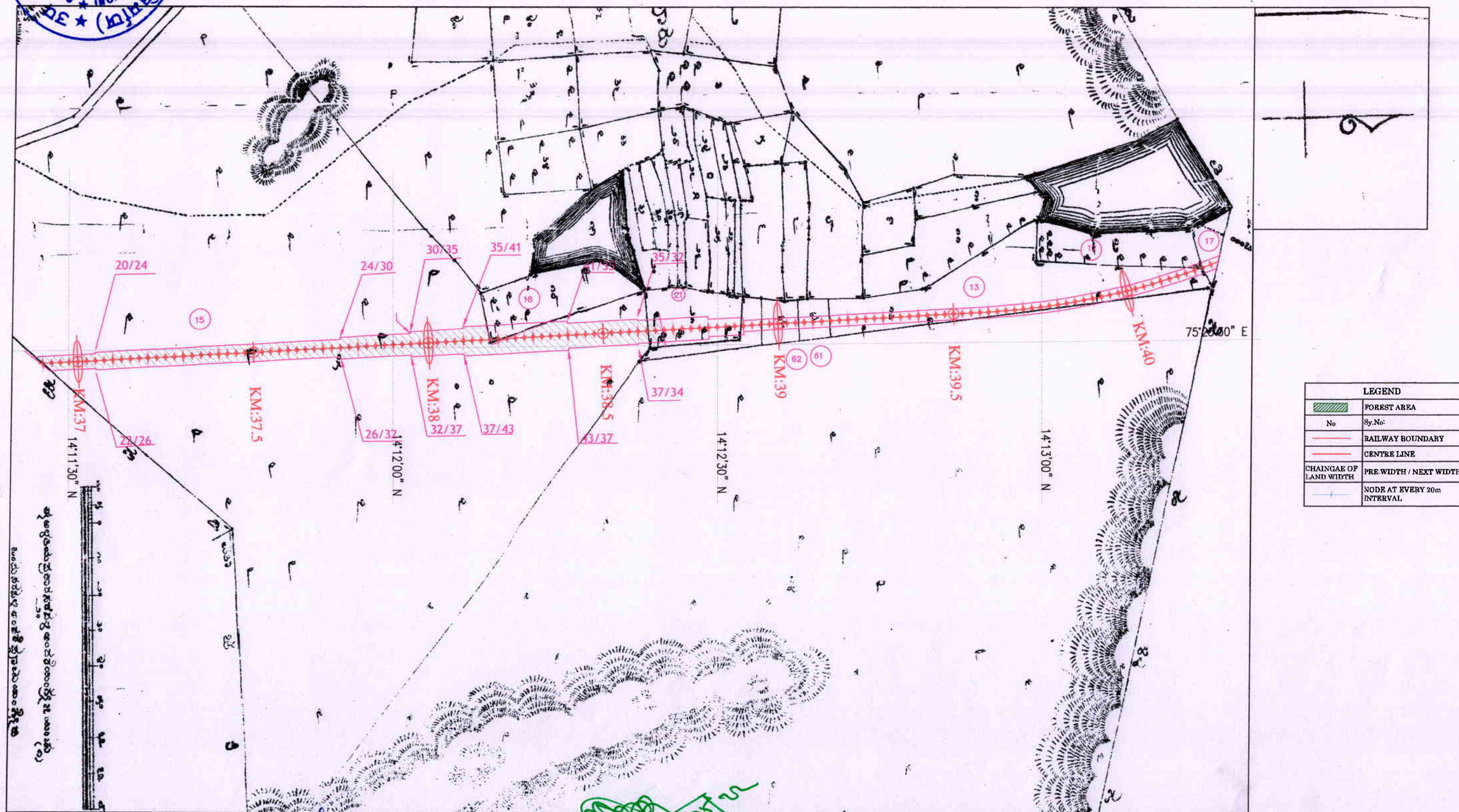

LEGEND	
	FOREST AREA
No	Sy.No:
	RAILWAY BOUNDARY
	CENTRE LINE
CHAINAGE OF LAND WIDTH	PRE WIDTH / NEXT WIDTH
	NODE AT EVERY 20m INTERVAL

[Signature]
Asst. Executive Engineer
(Construction)
South Western Railway
MYSORE - 570 020.

[Signature]
उप मुख्य इंजीनियर
Dy. Chief Engineer
निर्माण / Construction
दक्षिण पश्चिम रेलवे, मैसूर
South Western Railway, Mysore

~~GPS MAP SHOWING AREA FOR YERAKATTI VILLAGE (Forest Area: 10.5 Hectares)~~

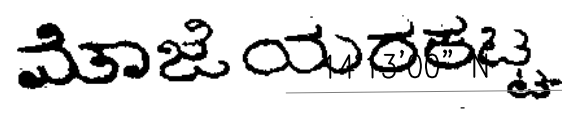

ಸವ್ಯತುರೈಗನೂರು

అలూరుకొండపేట

ಪ್ರಪಂಚವಿವರಣೆ

മുഹമ്മദ് സ്കൂളിൽ

ಸರ್ವೋಚ್ಚ -

ਅੰਤ

14°12'30" N

14°12'00" N

14°11'30" N





14°11'00" N

7E•30E•3L

75°25'30" E

75°26'00" E

14°11'00"

LEGEND	
	FOREST AREA
	Sy.No:
	RAILWAY BOUNDARY
	CENTRE LINE
CHAINGAE OF LAND WIDTH	PRE.WIDTH / NEXT WIDTH
	NODE AT EVERY 20m INTERVAL

Name of Project: Construction of New BG Railway Line in Forest lands in various villages of Shimoga & Davangere District in favour of Deputy Chief Engineer, construction, South Western Railway Mysuru

GPS MAP SHOWING AREA FOR YERAKATTI VILLAGE
(Forest Area: 10.5 Hectares)

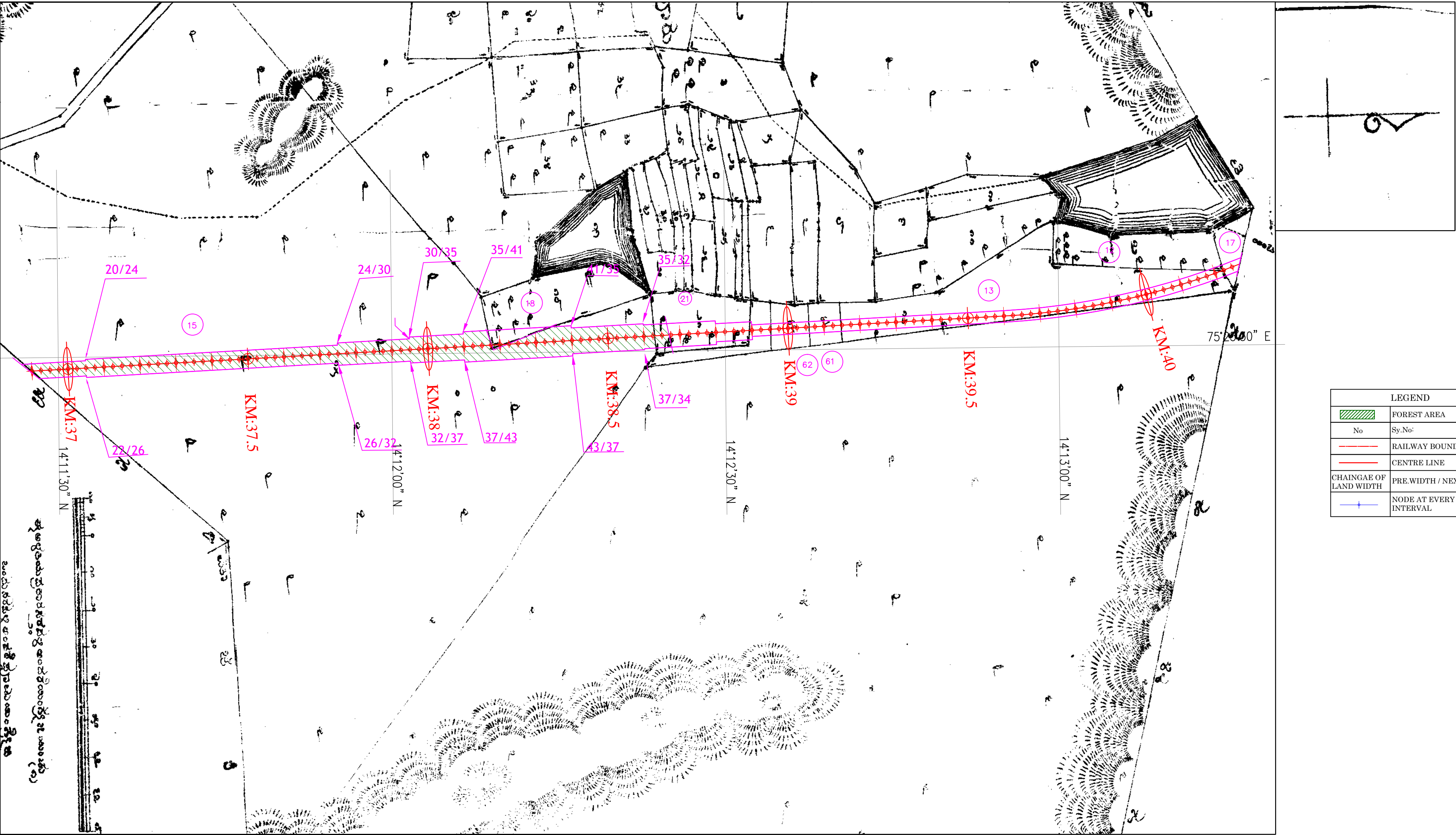



Name of Project: Construction of New BG Railway Line in Forest lands in various villages of Shimoga & Davangere District in favour of Deputy Chief Engineer, construction, South Western Railway Mysuru

LEGEND	
	FOREST AREA
	RAILWAY BOUNDARY
	CENTER LINE
	BOUNDARY OF LAND WIDTH
	ROAD AT EVERY 2nd INTERVAL

GPS MAP SHOWING AREA FOR ITTIGEHALLI VILLAGE (Forest Area: 2.37 Hectares)
Sy no-28=0.40Hectares,Sy no-81=1.97Hectares

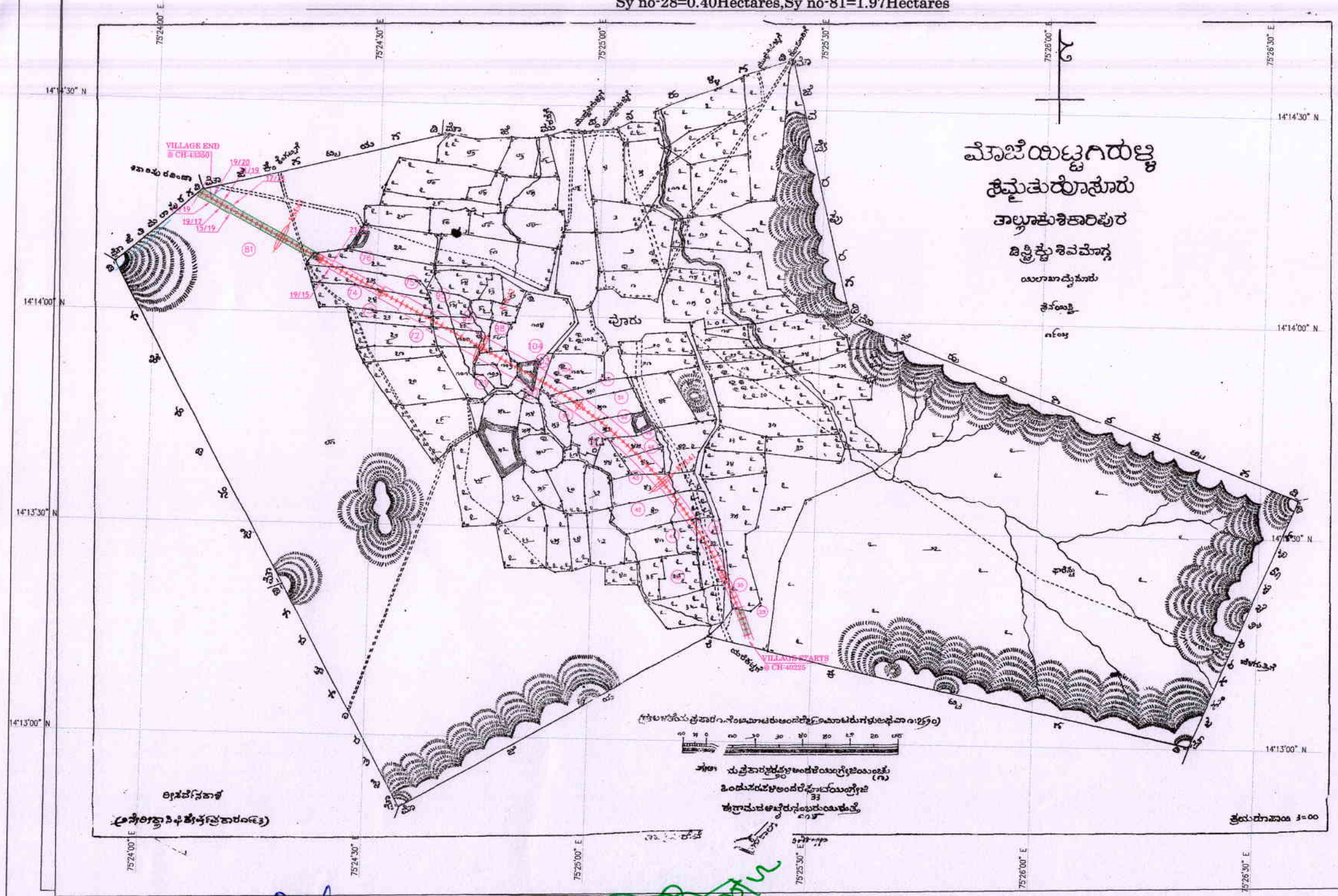

Asst. Executive Engineer
(Construction)
South Western Railway
MYSORE - 570 020.

उप मुख्य इंजीनियर
Dy. Chief Engineer
निर्माण / Construction
दक्षिण पश्चिम रेलवे, मैसूर
South Western Railway, Mysore

Name of Project: Construction of New BG Railway Line in Forest lands in various villages of Shimoga & Davangere District in favour of Deputy Chief Engineer, construction, South Western Railway Mysuru



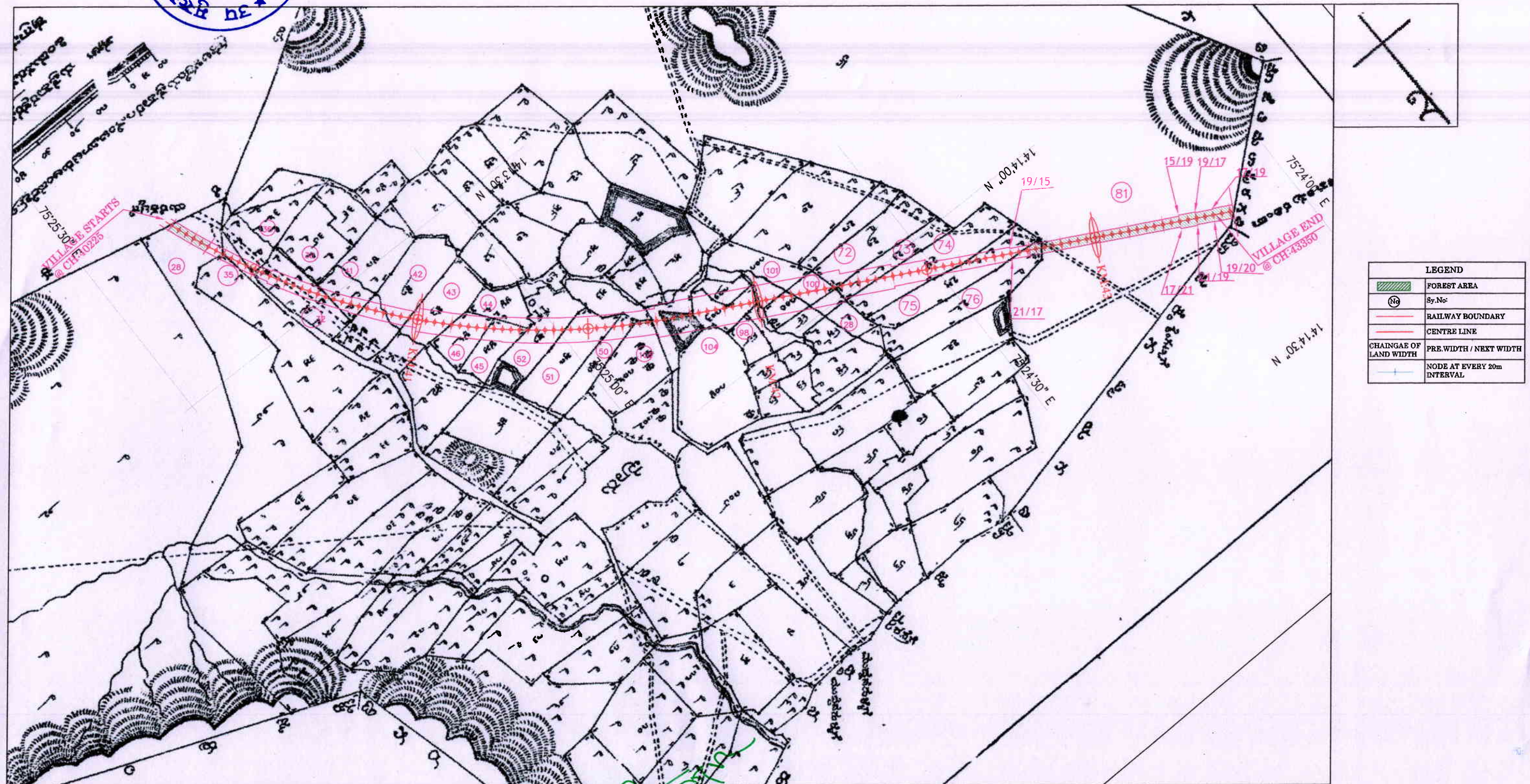

GPS MAP SHOWING AREA FOR ITTIGEHALLI VILLAGE
(Forest Area: 2.37 Hectares)



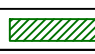
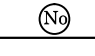
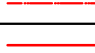
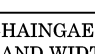
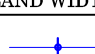
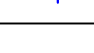

Asst. Executive Engineer
(Construction)
South Western Railway
MYSORE - 570 020.

उप मुख्य इंजीनियर
Dy. Chief Engineer
निर्माण / Construction
दक्षिण पश्चिम रेलवे, मैसूर
South Western Railway, Mysore

Name of Project: Construction of New BG Railway Line in Forest lands in various villages of Shimoga & Davangere District in favour of Deputy Chief Engineer, construction, South Western Railway Mysuru

LEGEND	
	FOREST AREA
	Sy.No
	RAILWAY BOUNDARY
	CENTRE LINE
	CHANGE OF LAND WIDTH
	PRE WIDTH / NEXT WIDTH
	NODE AT EVERY 50m INTERVAL

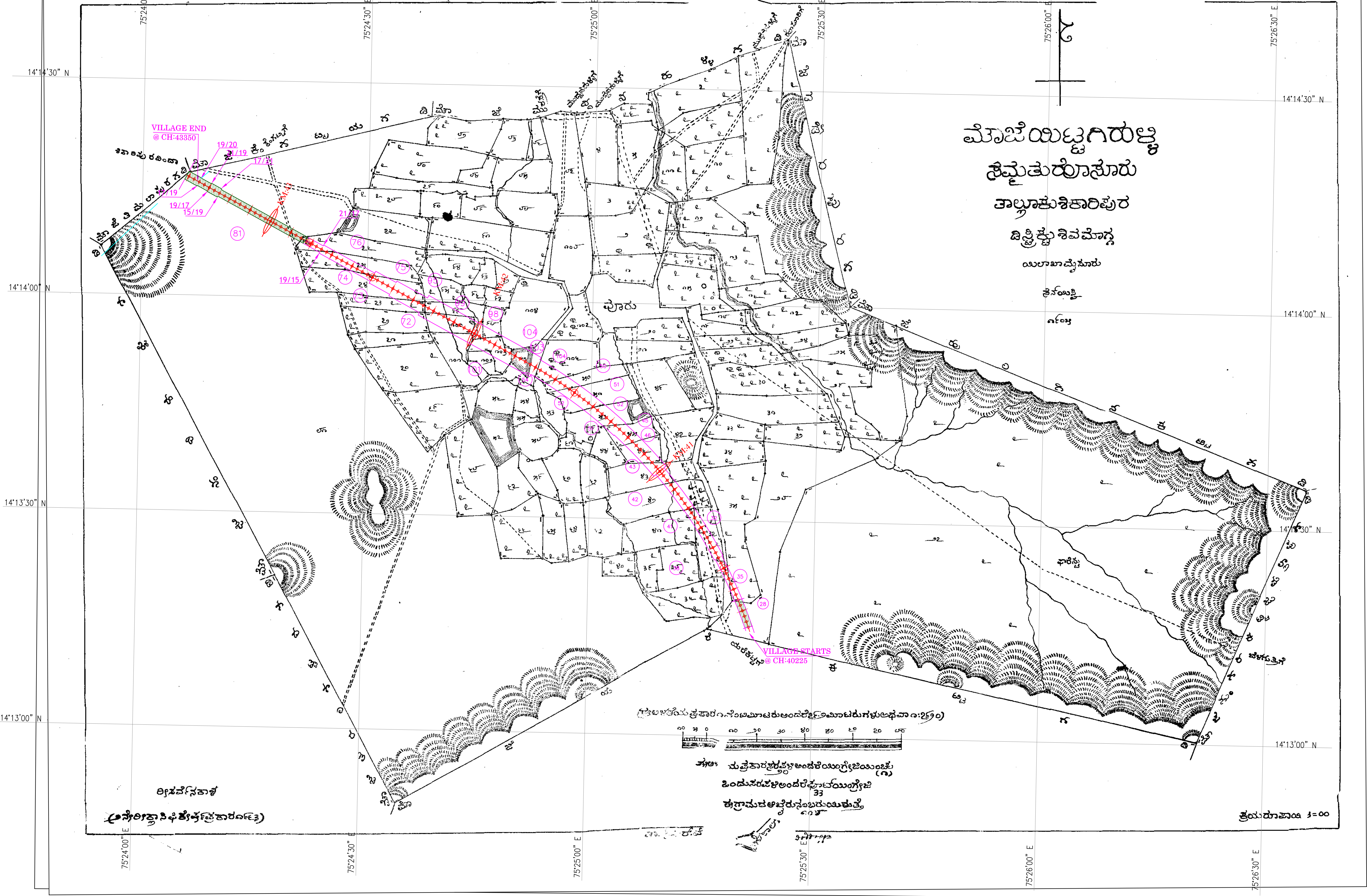
GPS MAP SHOWING AREA FOR ITTIGEHALLI VILLAGE (Forest Area: 2.37 Hectares)
Sy no-28=0.40Hectares,Sy no-81=1.97Hectares



Name of Project: Construction of New BG Railway Line in Forest lands in various villages of Shimoga & Davangere District in favour of Deputy Chief Engineer, construction, South Western Railway Mysuru

GPS MAP SHOWING AREA FOR ITTIGEHALLI VILLAGE
(Forest Area: 2.37 Hectares)

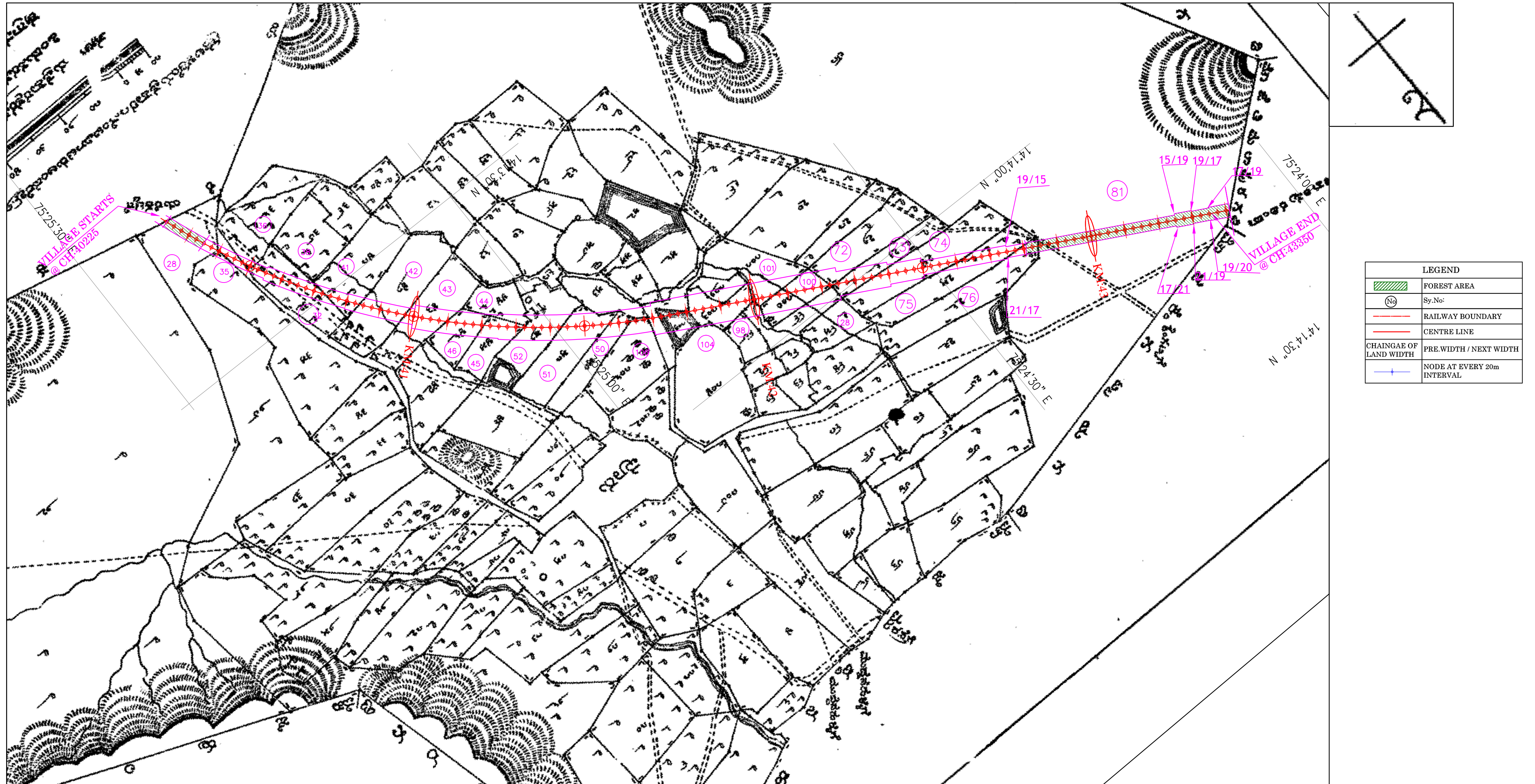



Name of Project: Construction of New BG Railway Line in Forest lands in various villages of Shimoga & Davangere District in favour of Deputy Chief Engineer, construction, South Western Railway Mysuru

GPS MAP SHOWING AREA FOR THIMLAPURA VILLAGE (Forest Area: 4.96 Hectares)

LEGEND	
	FOREST AREA
	Sp. No.
	RAILWAY BOUNDARY
	CENTRE LINE
	CHANNEL OF LAND WIDTH
	FORE WIDTH / STREET WIDTH
	MARK AT EVERY 20m INTERVAL

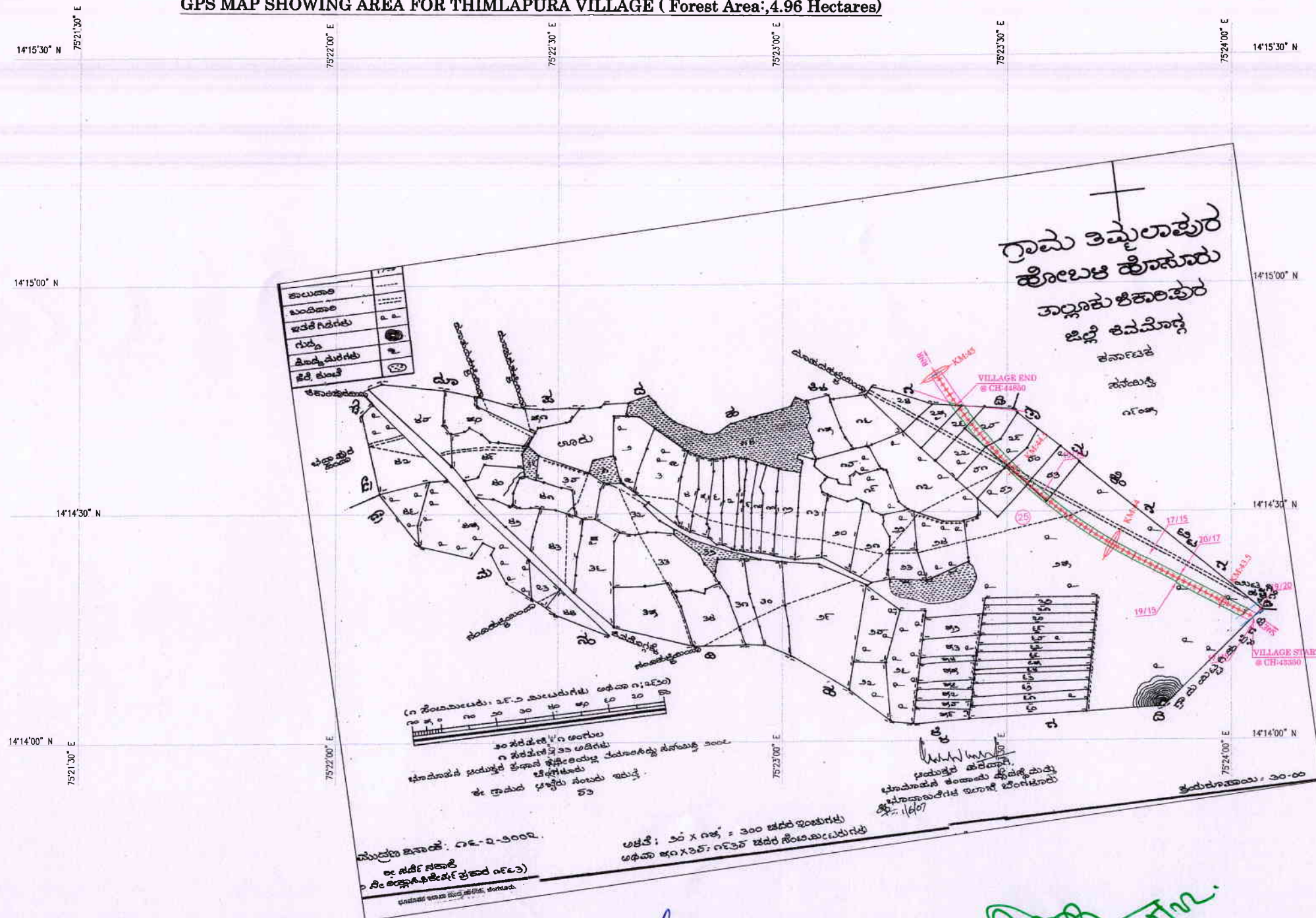

Asst. Executive Engineer
(Construction)
South Western Railway
MYSORE - 570 020.

उप मुख्य इंजीनियर
Dy. Chief Engineer
निर्माण / Construction
दक्षिण पश्चिम रेलवे, मैसूर
South Western Railway, Mysore

Name of Project: Construction of New BG Railway Line in Forest lands in various villages of Shimoga & Davangere District in favour of Deputy Chief Engineer, construction, South Western Railway Mysuru



GPS MAP SHOWING AREA FOR THIMLAPURA VILLAGE (Forest Area: 4.96 Hectares)

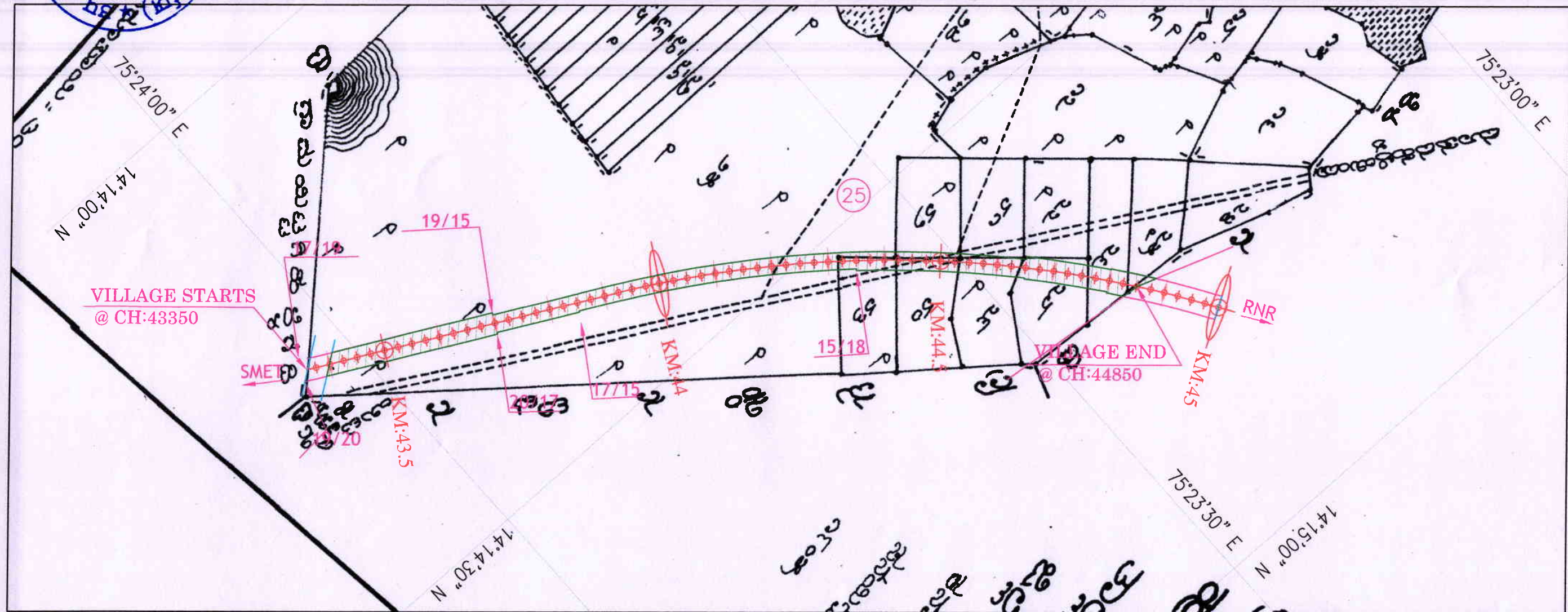



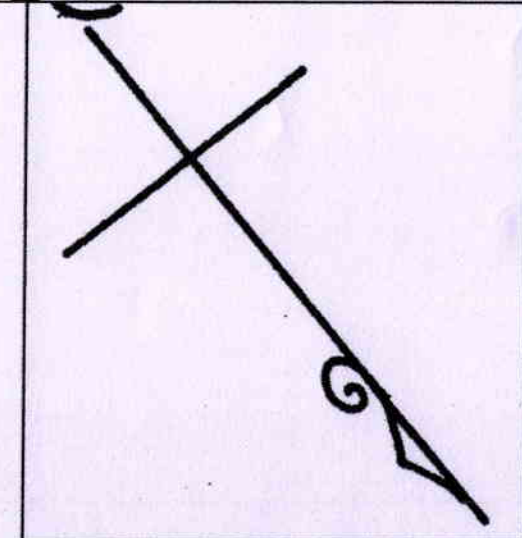

[Signature]
Asst. Executive Engineer
(Construction)
South Western Railway
MYSORE - 570 020.

[Signature]
उप मुख्य इंजीनियर
Dy. Chief Engineer
निर्माण / Construction
दक्षिण पश्चिम रेलवे, मैसूर
South Western Railway, Mysore

LEGEND	
	FOREST AREA
No	Sy.No:
	RAILWAY BOUNDARY
	CENTRE LINE
CHAINGAE OF LAND WIDTH	PRE.WIDTH / NEXT WIDTH
	NODE AT EVERY 20m INTERVAL



LEGEND	
	FOREST AREA
	Sy.No.
	RAILWAY BOUNDARY
	CENTRE LINE
CHAINAGE OF LAND WIDTH	PRE.WIDTH / NEXT WIDTH
	NODE AT EVERY 20m INTERVAL

[illegible]

Name of Project: Construction of New BG Railway Line in Forest lands in various villages of Shimoga & Davangere District in favour of Deputy Chief Engineer, construction, South Western Railway Mysuru

GPS MAP SHOWING AREA FOR THIMLAPURA VILLAGE
(Forest Area: 4.96 Hectares)

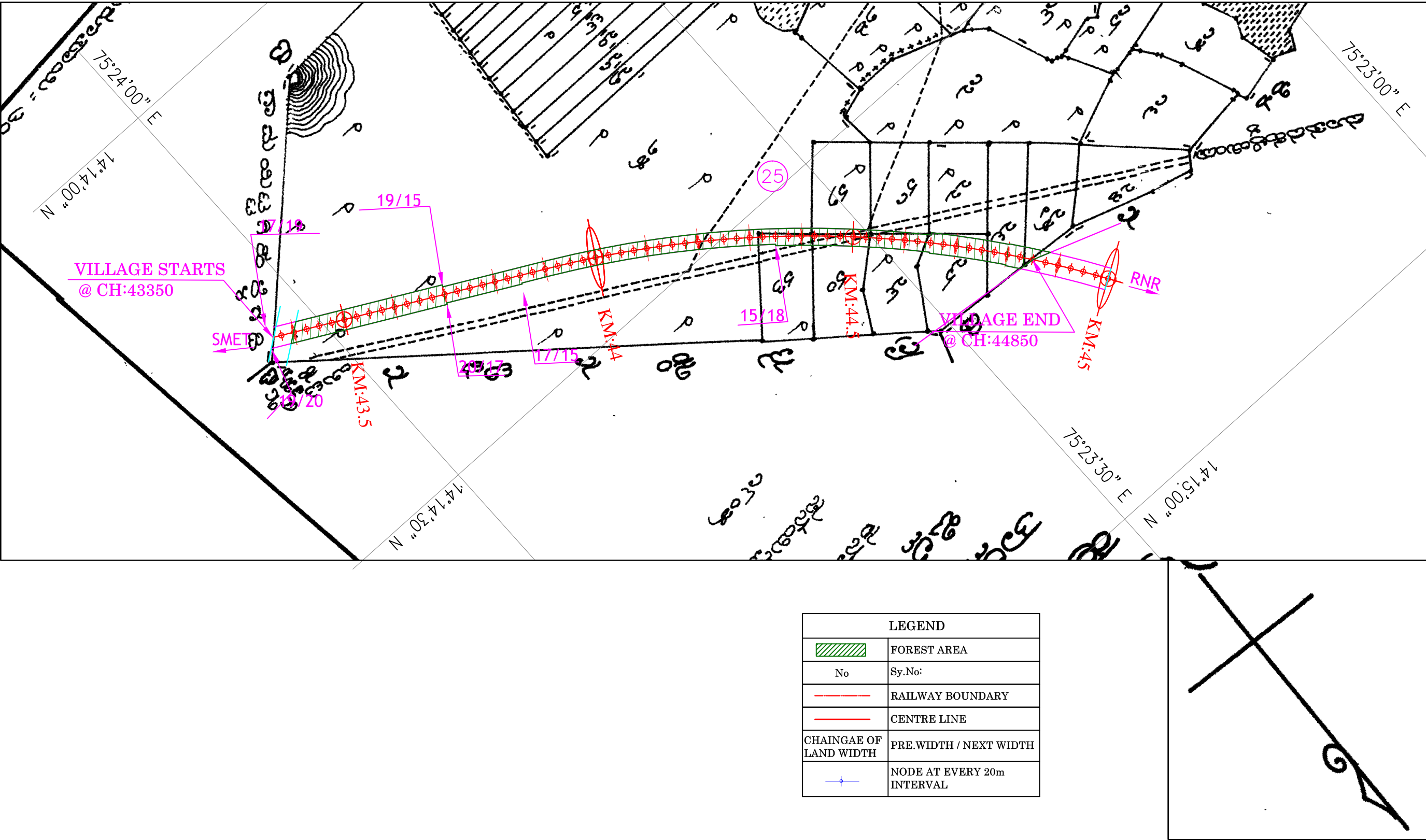



Name of Project: Construction of New BG Railway Line in Forest lands in various villages of Shimoga & Davangere District in favour of Deputy Chief Engineer, construction, South Western Railway Mysuru

GPS MAP SHOWING AREA FOR DOOPADAHALLI VILLAGE (Forest Area: 5.77 Hectares)

Sy no-27=5.74 Hectares, Sy no-49=0.030 Hectares

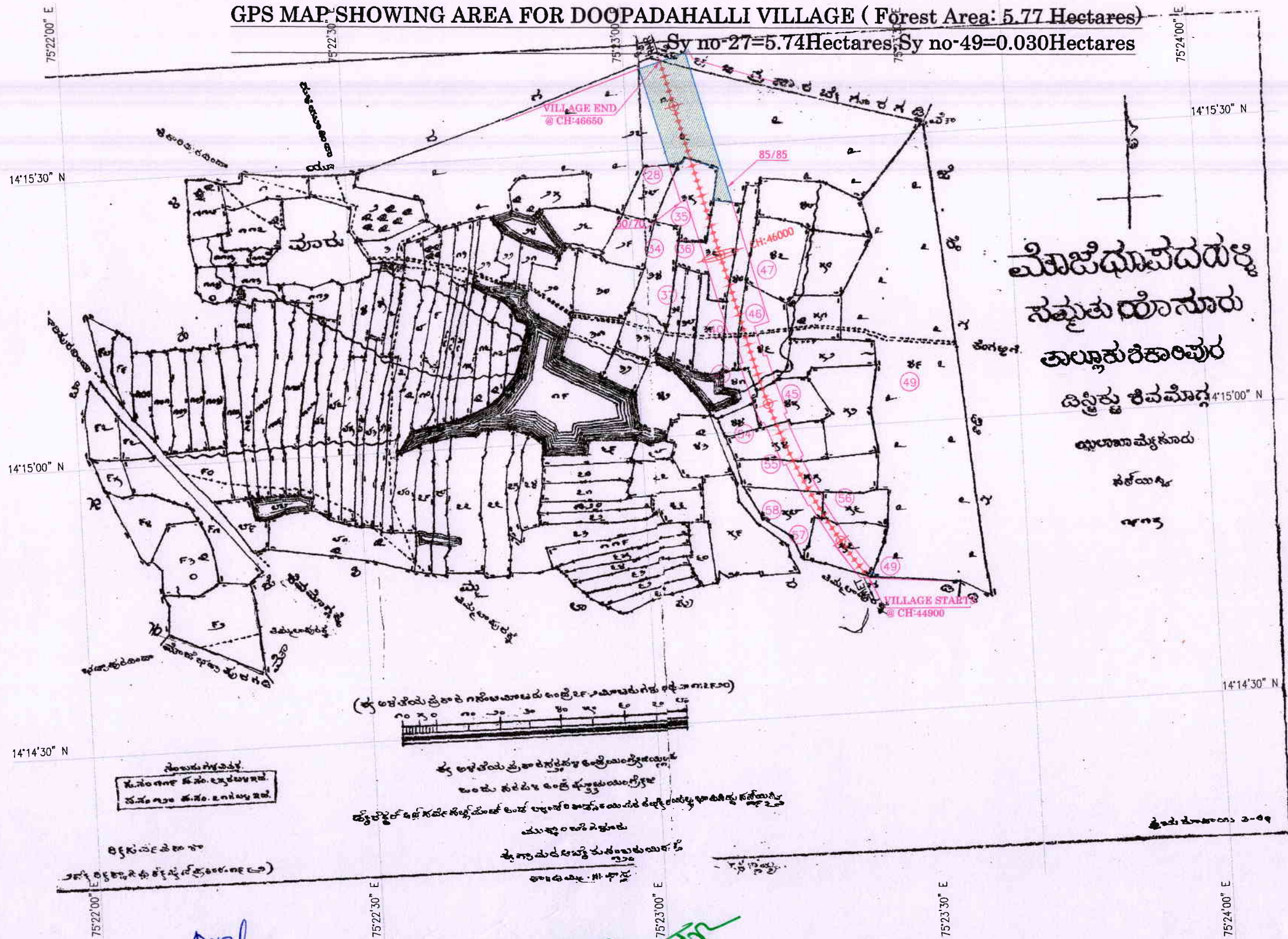

LEGEND	
	FOREST AREA
	Sy.No.
	RAILWAY BOUNDARY
	CENTRE LINE
	CHANGES OF LAND WIDTH
	PRE WIDTH / NEXT WIDTH
	NODE AT EVERY 20m INTERVAL

Asst. Executive Engineer
(Construction)
South Western Railway
MYSORE - 570 020.

उप मुख्य इंजीनियर
Dy. Chief Engineer
निर्माण / Construction
दक्षिण पश्चिम रेलवे, मैसूर
South Western Railway, Mysore

Name of Project: Construction of New BG Railway Line in Forest lands in various villages of Shimoga & Davangere District in favour of Deputy Chief Engineer, construction, South Western Railway Mysuru



GPS MAP SHOWING AREA FOR DOOPADAHALLI VILLAGE
(Forest Area: 5.77 Hectares)

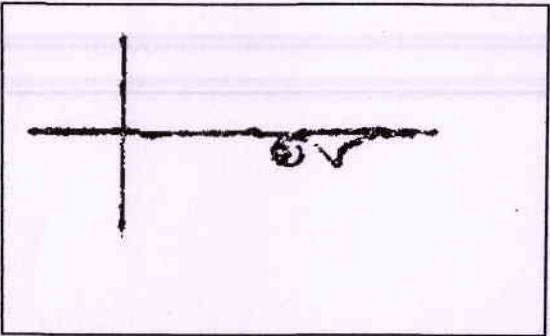
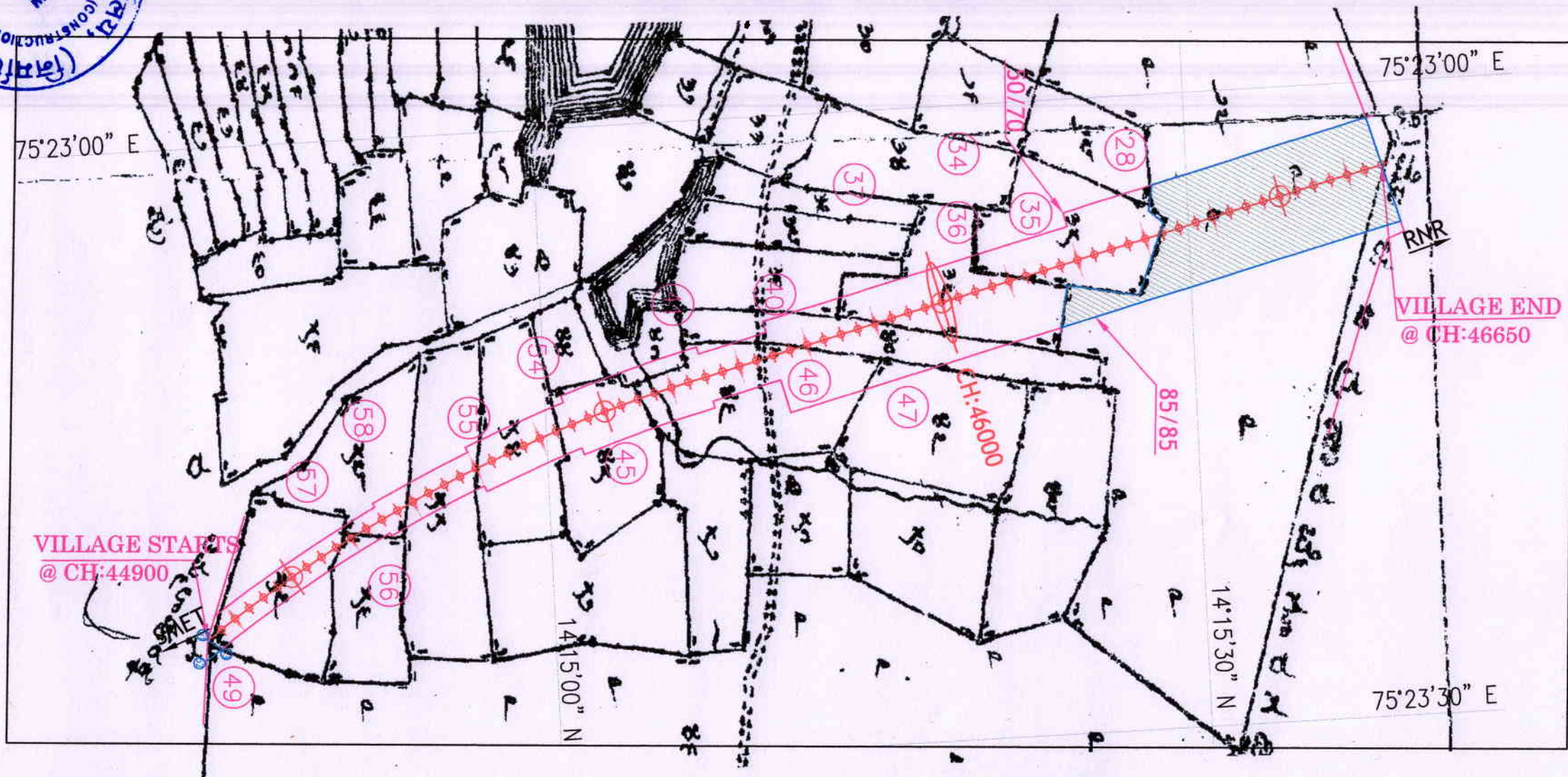

LEGEND	
	FOREST AREA
	Sy.No:
	RAILWAY BOUNDARY
	CENTRE LINE
	CHAINGAE OF LAND WIDTH
	NODE AT EVERY 20m INTERVAL





[Signature]
**Asst. Executive Engineer
(Construction)
South Western Railway
MYSORE - 570 020.**

[Signature]
**उप मुख्य इंजीनियर
Dy. Chief Engineer
निर्माण / Construction
दक्षिण पश्चिम रेलवे, मैसूर
South Western Railway, Mysore**

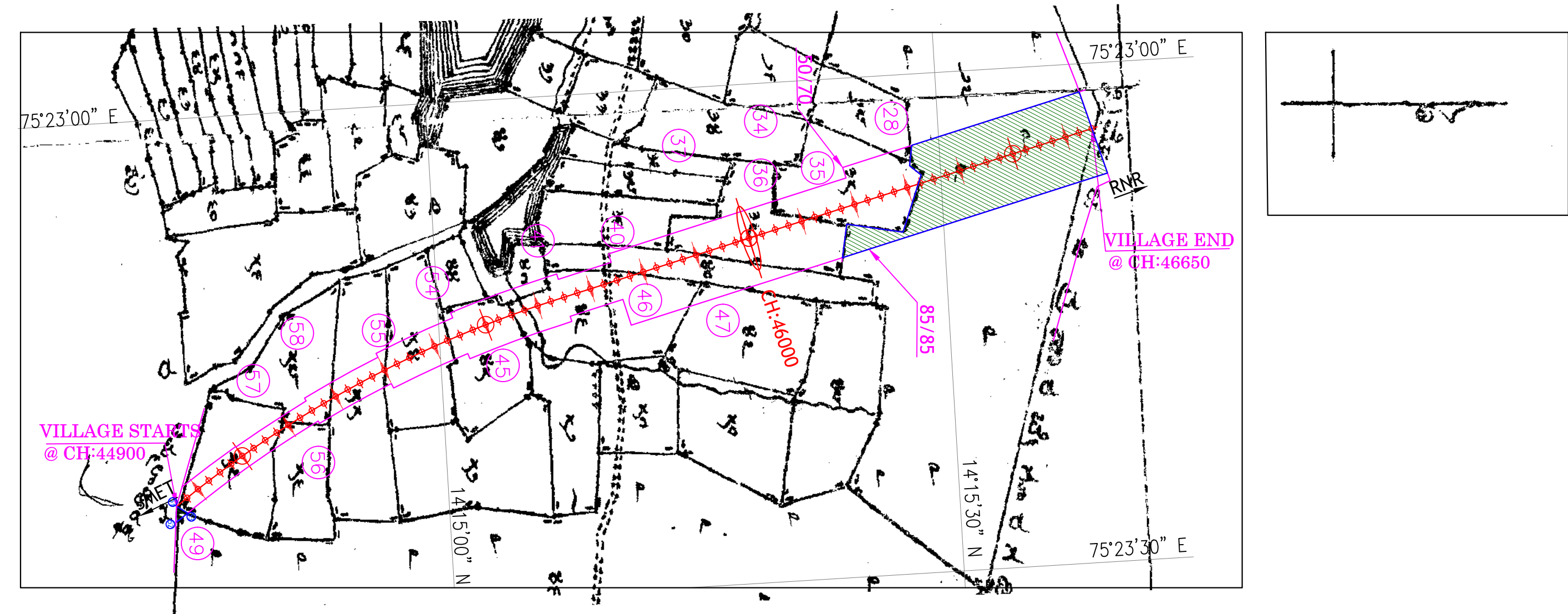
Name of Project: Construction of New BG Railway Line in Forest lands in various villages of Shimoga & Davangere District in favour of Deputy Chief Engineer, construction, South Western Railway Mysuru

GPS MAP SHOWING AREA FOR DOOPADAHALLI VILLAGE
(Forest Area: 5.77 Hectares)



LEGEND	
	FOREST AREA
	Sy.No:
	RAILWAY BOUNDARY
	CENTRE LINE
CHAINGAE OF LAND WIDTH	PRE.WIDTH / NEXT WIDTH
	NODE AT EVERY 20m INTERVAL

Sy no-27=5.74Hectares; Sy no-49=0.030Hectares

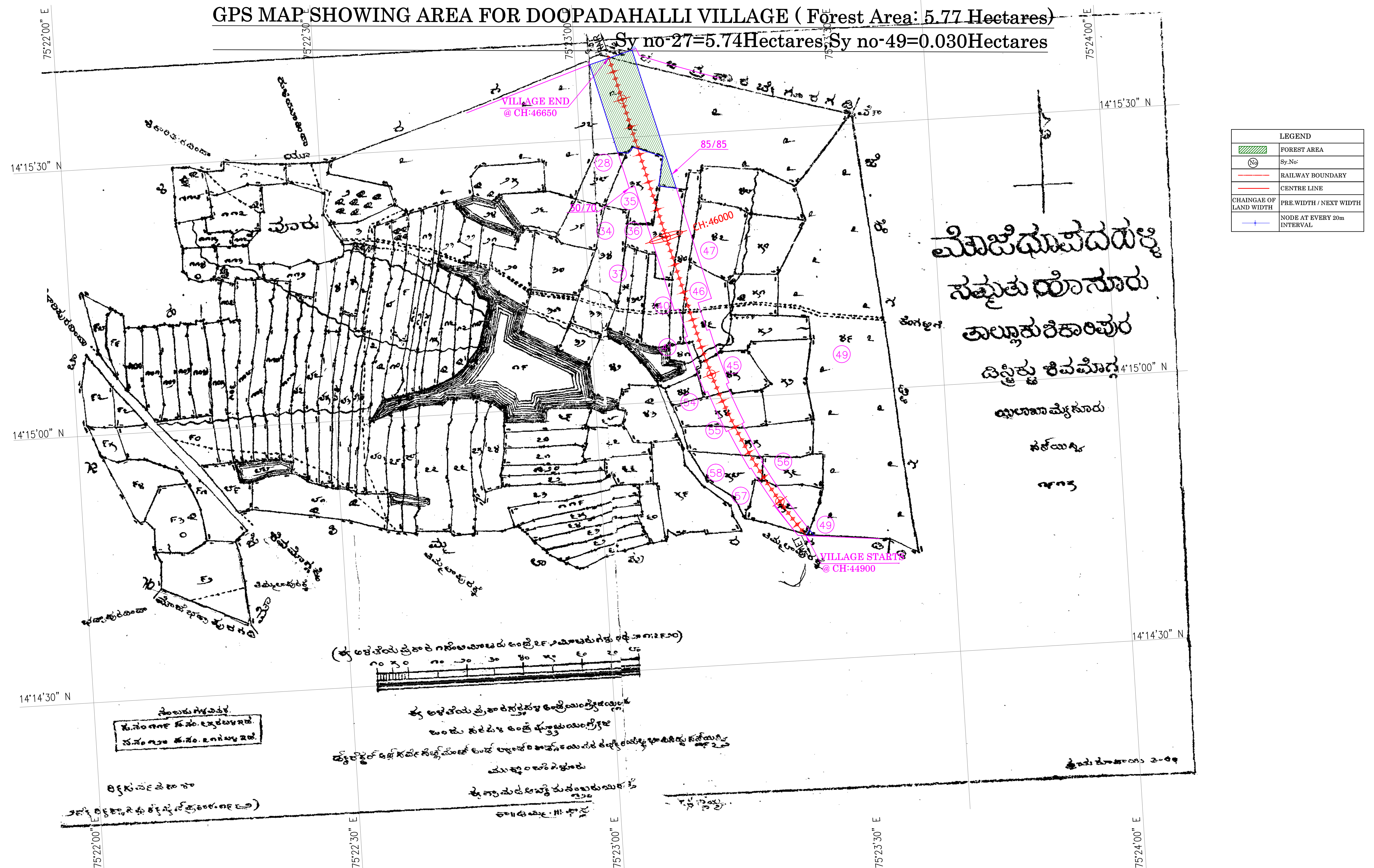

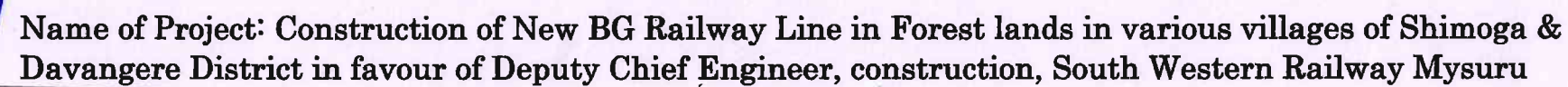

(Forest Area: 8.98 Hectares)

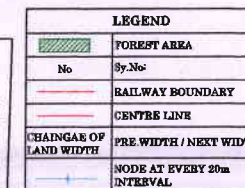

उप मुख्य इंजीनियर
Dy. Chief Engineer
निर्माण / Construction
दक्षिण पश्चिम रेलवे, मैसूर
South Western Railway, Mysore

Name of Project: Construction of New BG Railway Line in Forest lands in various villages of Shimoga & Davangere District in favour of Deputy Chief Engineer, construction, South Western Railway Mysuru



GPS MAP SHOWING AREA FOR SADASHIVPURA VILLAGE (Forest Area: 8.98Hectares)

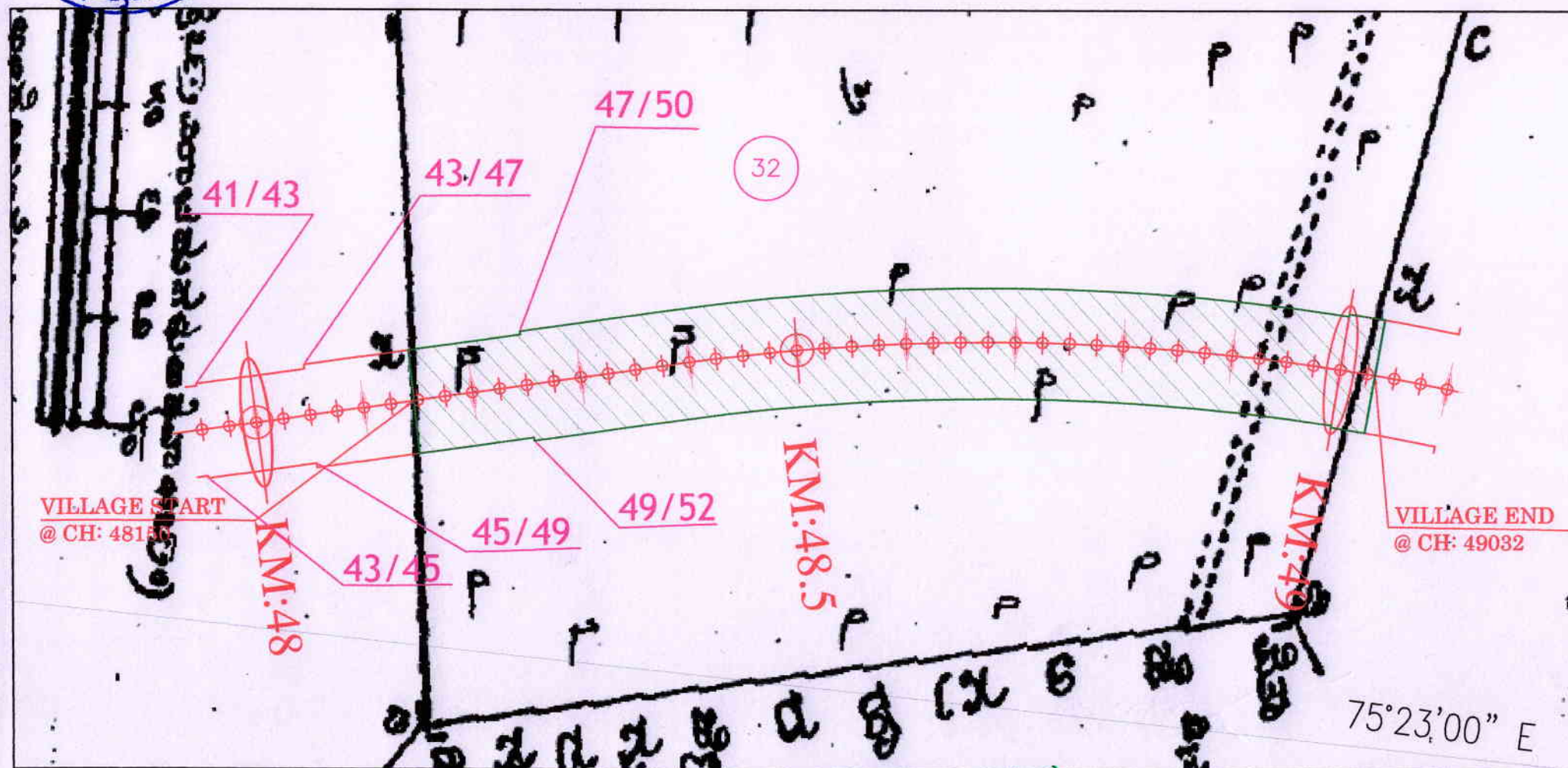

LEGEND	
	FOREST AREA
No	Sy.No:
	RAILWAY BOUNDARY
	CENTRE LINE
CHAINGAE OF LAND WIDTH	PRE.WIDTH / NEXT WIDTH
	NODE AT EVERY 20m INTERVAL

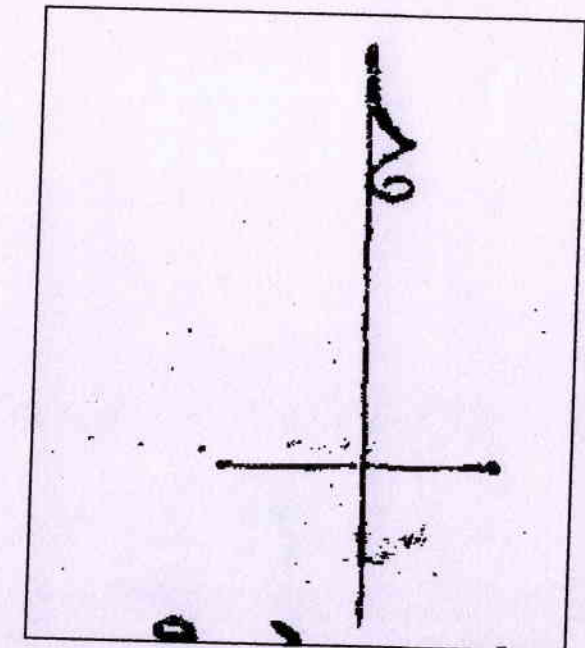





[Signature]
Asst. Executive Engineer
(Construction)
South Western Railway
MYSORE - 570 020.

[Signature]
उप मुख्य इंजीनियर
Dy. Chief Engineer
निर्माण / Construction
दक्षिण पश्चिम रेलवे, मैसूर
South Western Railway, Mysore

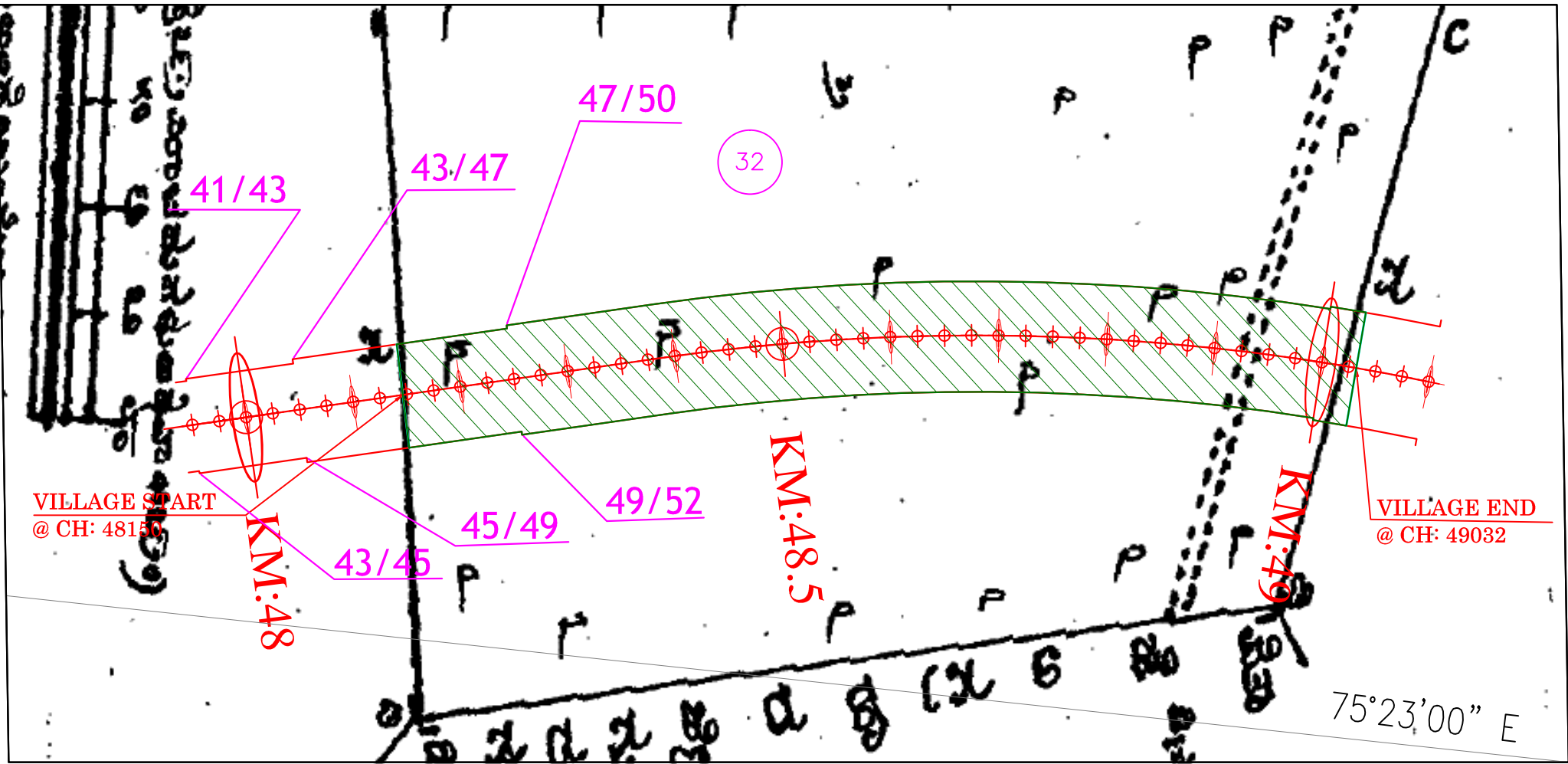
Name of Project: Construction of New BG Railway Line in Forest lands in various villages of Shimoga & Davangere District in favour of Deputy Chief Engineer, construction, South Western Railway Mysuru

GPS MAP SHOWING AREA FOR SADASHIVPURA
VILLAGE (Forest Area: 8.98Hectares)





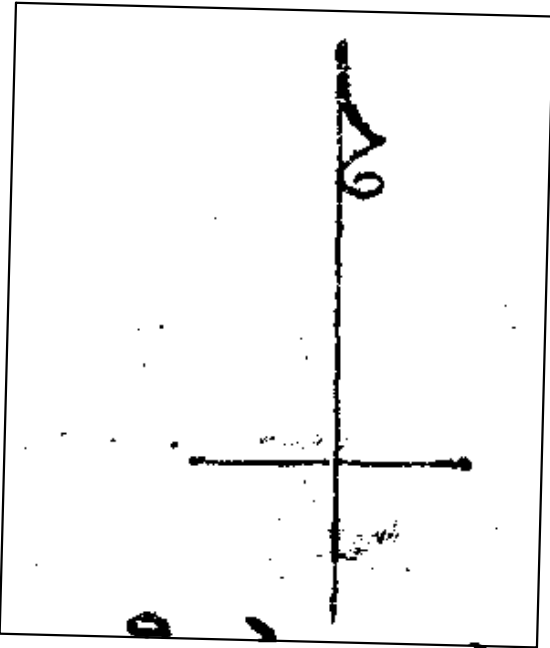

LEGEND	
	FOREST AREA
No	Sy.No:
	RAILWAY BOUNDARY
	CENTRE LINE
CHAINGAE OF LAND WIDTH	PRE.WIDTH / NEXT WIDTH
	NODE AT EVERY 20m INTERVAL

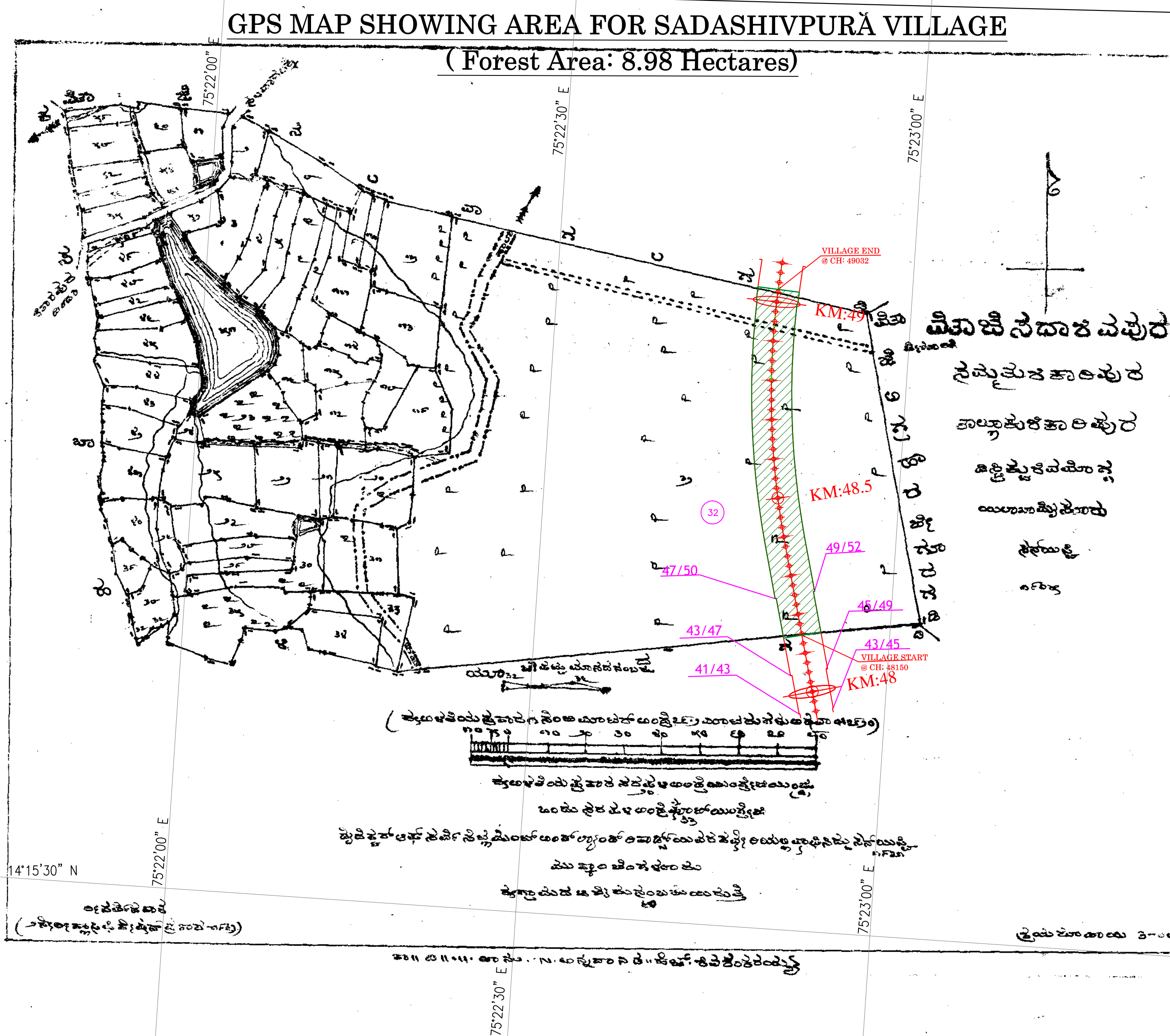

Name of Project: Construction of New BG Railway Line in Forest lands in various villages of Shimoga & Davangere District in favour of Deputy Chief Engineer, construction, South Western Railway Mysuru



LEGEND	
	FOREST AREA
No	Sy.No:
	RAILWAY BOUNDARY
	CENTRE LINE
CHAINGAE OF LAND WIDTH	PRE.WIDTH / NEXT WIDTH
	NODE AT EVERY 20m INTERVAL