

4 laning of Betul-Khandwa Section of National Highway(NH-347B) from Betul Design Ch 0+000 to Khandwa Design Ch 125+300 (length-125.300 km) under BHARATMALA Pariyojana Feeder route (Phase- I) in the State of Madhya Pradesh on Hybrid Annuity Mode

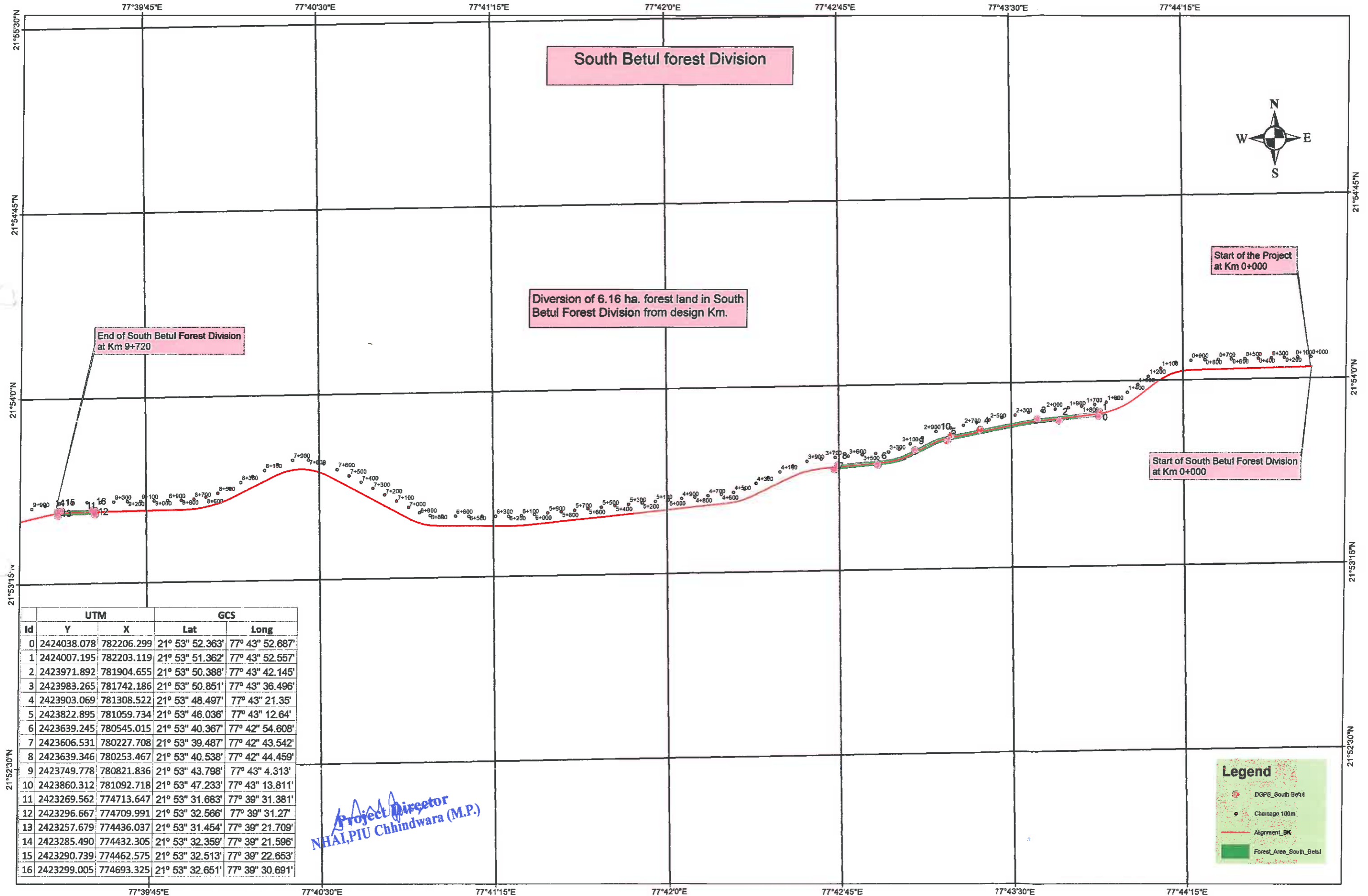

South Betul forest Division

Diversion of 6.16 ha. forest land in South Betul Forest Division from design Km.

End of South Betul Forest Division at Km 9+720

Start of the Project at Km 0+000

Start of South Betul Forest Division at Km 0+000

Id	UTM		GCS	
	Y	X	Lat	Long
0	2424038.078	782206.299	21° 53' 52.363"	77° 43' 52.687"
1	2424007.195	782203.119	21° 53' 51.362"	77° 43' 52.557"
2	2423971.892	781904.655	21° 53' 50.388"	77° 43' 42.145"
3	2423983.265	781742.186	21° 53' 50.851"	77° 43' 36.496"
4	2423903.069	781308.522	21° 53' 48.497"	77° 43' 21.35"
5	2423822.895	781059.734	21° 53' 46.036"	77° 43' 12.64"
6	2423639.245	780545.015	21° 53' 40.367"	77° 42' 54.608"
7	2423606.531	780227.708	21° 53' 39.487"	77° 42' 43.542"
8	2423639.346	780253.467	21° 53' 40.538"	77° 42' 44.459"
9	2423749.778	780821.836	21° 53' 43.798"	77° 43' 4.313"
10	2423860.312	781092.718	21° 53' 47.233"	77° 43' 13.811"
11	2423269.562	774713.647	21° 53' 31.683"	77° 39' 31.381"
12	2423296.667	774709.991	21° 53' 32.566"	77° 39' 31.27"
13	2423257.679	774436.037	21° 53' 31.454"	77° 39' 21.709"
14	2423285.490	774432.305	21° 53' 32.359"	77° 39' 21.596"
15	2423290.739	774462.575	21° 53' 32.513"	77° 39' 22.653"
16	2423299.005	774693.325	21° 53' 32.651"	77° 39' 30.691"

Project Director
NHAI, PIU Chhindwara (M.P.)

Legend

- DGPS_South Betul
- Change 100m
- Alignment_BK
- Forest_Area_South_Betul

← BETUL

KHANDWA →

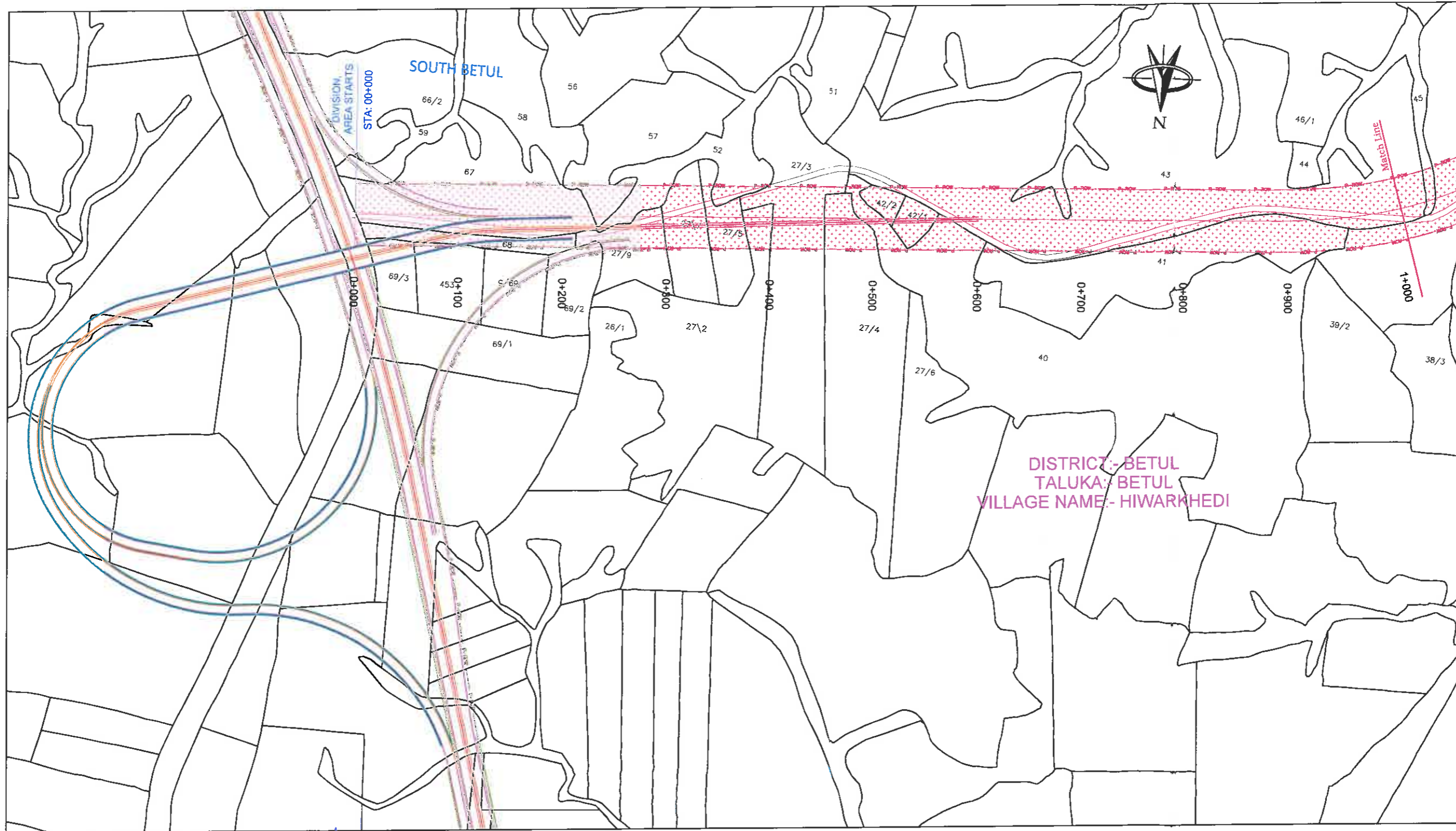

DISTRICT:- BETUL
TALUKA:- BETUL
VILLAGE NAME:- HIWARKHEDI

- LEGEND:-**
- PROPOSED CENTER LINE
 - PROPOSED ROW
 - VILLAGE BOUNDARY
 - NON- FOREST LAND
 - FOREST LAND
 - BOUNDARY POINT

Project Director
Chhindwara (M.P.)

DATE	REV. NO.	DESCRIPTION	BY

DESIGN CONSULTANT:
LEA ASSOCIATES SOUTH ASIA PVT. LTD.,
B-1, E-27, 11nd FLOOR, MOHAN COOPERATIVE INDUSTRIAL ESTATE, MATHURA ROAD, NEW DELHI-110044
INDIA

SCALE:
1:4000

CLIENT:
 NATIONAL HIGHWAYS AUTHORITY OF INDIA
(Ministry of Road Transport & Highways)
Government of India

PROJECT:
4 laning of Betul-Khandwa Section of National Highway(NH-347B) from Betul Design Ch 0+000 to Khandwa Design Ch 125+300 (length-125.300 km) Under BHARATMALA Pariyojana Feeder route (Phase- I) in the State of Madhya Pradesh on Hybrid Annuity Mode.

DRAWING TITLE:
APPLICATION FOR DIVERSION OF FOREST LAND
(KM. 0+000 TO KM. 1+000)

DRG. NO.	73579/LASAIHWM/DP/IBK/DGPS-01	REV.	0
DATE:	May 2018	DRAWN :	Rawindra Patwal
DESIGNED	Tanmoy Baur	CHECKED	Sarde Alam
APPROVED	J.K.Das	SHEET SIZE A3	

← BETUL

KHANDWA →

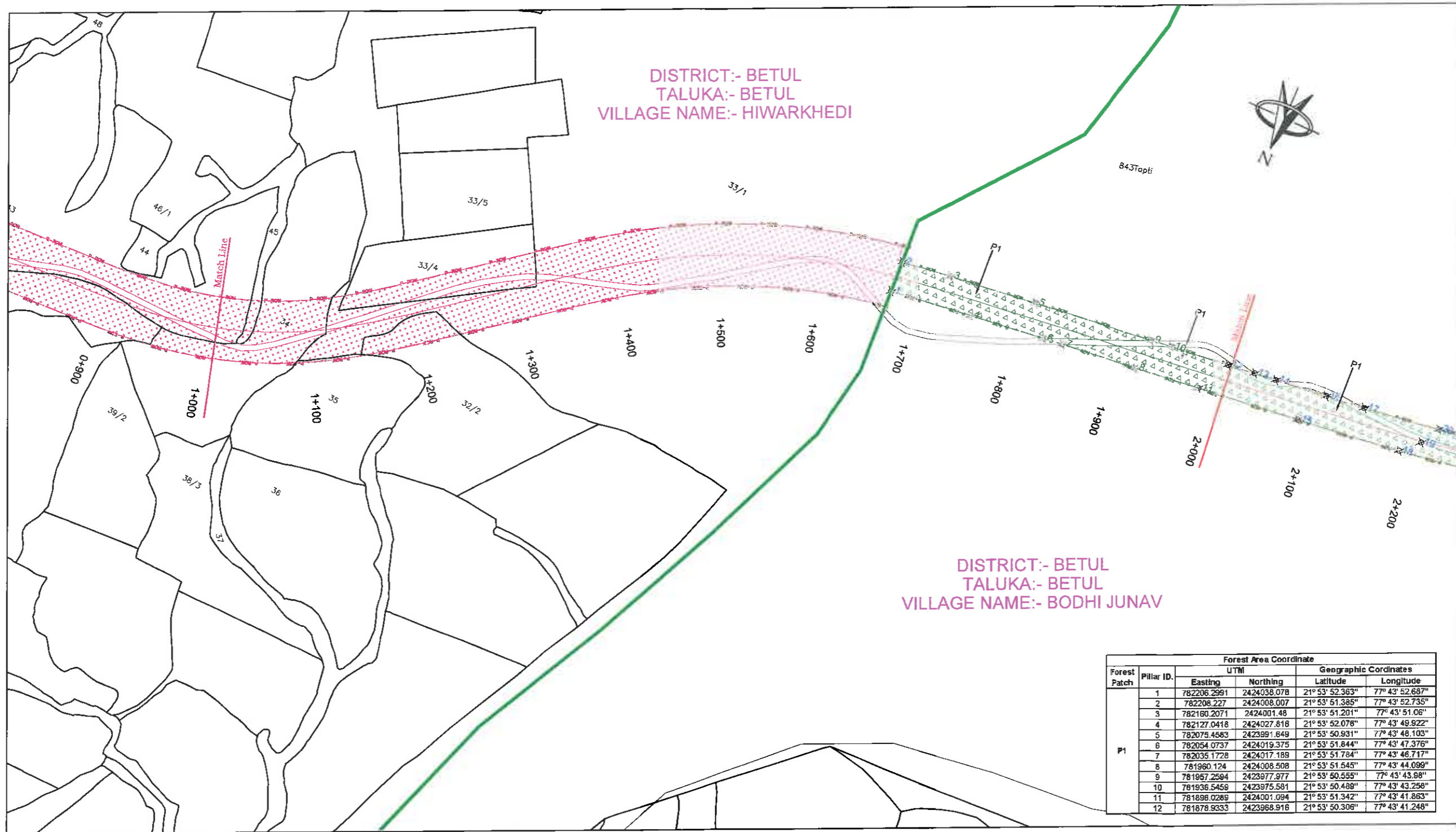

DISTRICT:- BETUL
TALUKA:- BETUL
VILLAGE NAME:- HIWARKHEDI

DISTRICT:- BETUL
TALUKA:- BETUL
VILLAGE NAME:- BODHI JUNAV

Forest Patch	Pillar ID.	UTM		Geographic Coordinates	
		Easting	Northing	Latitude	Longitude
P1	1	782206.2991	2424038.078	21° 53' 52.363"	77° 43' 52.687"
	2	782208.227	2424008.007	21° 53' 51.385"	77° 43' 52.735"
	3	782180.2071	2424001.48	21° 53' 51.201"	77° 43' 51.06"
	4	782127.0418	2424027.818	21° 53' 52.078"	77° 43' 48.922"
	5	782075.4683	2423991.849	21° 53' 50.931"	77° 43' 48.103"
	6	782054.0737	2424019.375	21° 53' 51.844"	77° 43' 47.376"
	7	782035.1728	2424017.189	21° 53' 51.784"	77° 43' 46.717"
	8	781960.124	2424008.508	21° 53' 51.545"	77° 43' 44.099"
	9	781957.2584	2423977.977	21° 53' 50.555"	77° 43' 43.98"
	10	781936.5459	2423975.581	21° 53' 50.488"	77° 43' 43.258"
	11	781898.0289	2424001.094	21° 53' 51.342"	77° 43' 41.863"
	12	781878.9333	2423968.916	21° 53' 50.306"	77° 43' 41.248"

- LEGEND:-**
- PROPOSED CENTER LINE
 - PROPOSED ROW
 - VILLAGE BOUNDARY
 - NON- FOREST LAND
 - FOREST LAND
 - BOUNDARY POINT

Ravindra Patwal
Project Director
NHAI, PIU Chhindwara (M.P.)

DATE	REV. NO.	DESCRIPTION	BY
REVISIONS			

DESIGN CONSULTANT:
LEA ASSOCIATES SOUTH ASIA PVT. LTD.,
B-1, E-27, 11th FLOOR, MOHAN COOPERATIVE INDUSTRIAL ESTATE, MATHURA ROAD, NEW DELHI-110044
INDIA

SCALE:
1:4000

CLIENT:
 NATIONAL HIGHWAYS AUTHORITY OF INDIA
(Ministry of Road Transport & Highways)
Government of India

PROJECT:
4 laning of Betul-Khandwa Section of National Highway(NH-347B) from Betul Design Ch 0+000 to Khandwa Design Ch 125+300 (length-125.300 km) Under BHARATMALA Pariyojana Feeder route (Phase-I) in the State of Madhya Pradesh on Hybrid Annuity Mode.

DRAWING TITLE:
APPLICATION FOR DIVERSION OF FOREST LAND
(KM. 1+000 TO KM. 2+000)

DRG. NO.	REV.
73579/LASAWHWDPR/BKIDGPS-02	0
DATE: May 2018	DRAWN: Ravindra Patwal
DESIGNED: Tanmoy Baur	CHECKED: Sarde Alam
	APPROVED: J.K.Das
SHEET SIZE A3	

← BETUL

KHANDWA →

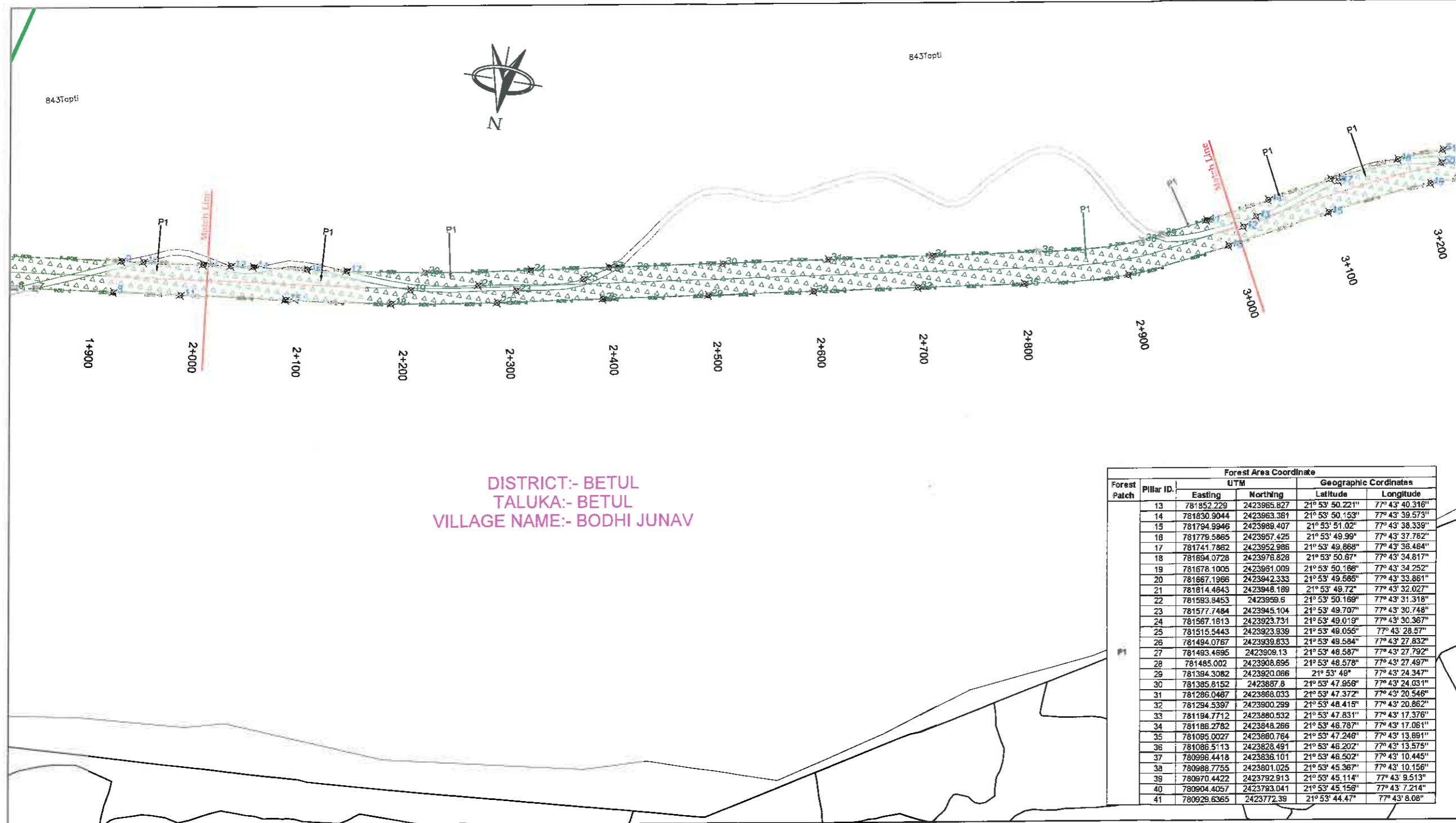

DISTRICT:- BETUL
TALUKA:- BETUL
VILLAGE NAME:- BODHI JUNAV

Forest Patch	Pillar ID.	UTM		Geographic Coordinates	
		Easting	Northing	Latitude	Longitude
13	781852.229	2423965.827	21° 53' 50.221"	77° 43' 40.316"	
14	781830.9044	2423963.381	21° 53' 50.153"	77° 43' 39.573"	
15	781794.9946	2423988.407	21° 53' 51.02"	77° 43' 38.339"	
16	781779.5865	2423957.425	21° 53' 49.99"	77° 43' 37.782"	
17	781741.7862	2423952.986	21° 53' 49.868"	77° 43' 38.484"	
18	781694.0728	2423976.828	21° 53' 50.67"	77° 43' 34.817"	
19	781678.1005	2423981.009	21° 53' 50.186"	77° 43' 34.252"	
20	781667.1966	2423942.333	21° 53' 49.585"	77° 43' 33.861"	
21	781814.4643	2423948.189	21° 53' 49.72"	77° 43' 32.027"	
22	781593.8453	2423959.6	21° 53' 50.169"	77° 43' 31.318"	
23	781577.7484	2423945.104	21° 53' 49.707"	77° 43' 30.748"	
24	781567.1613	2423923.731	21° 53' 49.019"	77° 43' 30.367"	
25	781515.5443	2423923.939	21° 53' 48.055"	77° 43' 28.67"	
26	781494.0767	2423939.833	21° 53' 48.584"	77° 43' 27.832"	
27	781493.4695	2423909.13	21° 53' 48.587"	77° 43' 27.792"	
28	781485.002	2423908.695	21° 53' 48.578"	77° 43' 27.497"	
29	781394.3082	2423920.066	21° 53' 49"	77° 43' 24.347"	
30	781385.8152	2423887.8	21° 53' 47.958"	77° 43' 24.031"	
31	781286.0467	2423868.033	21° 53' 47.372"	77° 43' 20.546"	
32	781294.5397	2423900.299	21° 53' 48.415"	77° 43' 20.862"	
33	781194.7712	2423860.532	21° 53' 47.831"	77° 43' 17.376"	
34	781188.2782	2423848.266	21° 53' 48.787"	77° 43' 17.061"	
35	781095.0027	2423860.764	21° 53' 47.246"	77° 43' 13.881"	
36	781086.5113	2423828.491	21° 53' 46.202"	77° 43' 13.575"	
37	780996.4418	2423838.101	21° 53' 46.502"	77° 43' 10.445"	
38	780988.7755	2423801.025	21° 53' 45.367"	77° 43' 10.156"	
39	780970.4422	2423792.913	21° 53' 45.114"	77° 43' 9.513"	
40	780904.4057	2423793.041	21° 53' 45.156"	77° 43' 7.214"	
41	780929.6365	2423772.39	21° 53' 44.47"	77° 43' 8.08"	

- LEGEND:-**
- PROPOSED CENTER LINE
 - PROPOSED ROW
 - VILLAGE BOUNDARY
 - NON- FOREST LAND
 - FOREST LAND
 - BOUNDARY POINT

Ravindra Patwal
Project Director
NHAI, PIU Chhindwara (M.P.)

DATE	REV. NO.	DESCRIPTION	BY
REVISIONS			

DESIGN CONSULTANT:
LEA ASSOCIATES SOUTH ASIA PVT. LTD.,
B-1, E-27, 11th FLOOR, MOHAN COOPERATIVE INDUSTRIAL ESTATE, MATHURA ROAD, NEW DELHI-110044
INDIA

SCALE:
1:4000

CLIENT:
 NATIONAL HIGHWAYS AUTHORITY OF INDIA
(Ministry of Road Transport & Highways)
Government of India

PROJECT:
4 laning of Betul-Khandwa Section of National Highway(NH-347B) from Betul Design Ch 0+000 to Khandwa Design Ch 125+300 (length-125.300 km) Under BHARATMALA Pariyojana Feeder route (Phase- I) in the State of Madhya Pradesh on Hybrid Annuity Mode.

DRAWING TITLE:
APPLICATION FOR DIVERSION OF FOREST LAND
(KM. 2+000 TO KM. 3+000)

DRG. NO.
73579LASAVHWYDPR/BKIDGPS-03

DATE: May 2018
DRAWN: Ravindra Patwal

DESIGNED Tanmoy Baur	CHECKED Sarada Alam	APPROVED J.K.Das
-------------------------	------------------------	---------------------

SHEET SIZE A3

← BETUL

KHANDWA →

DISTRICT:- BETUL
TALUKA:- BETUL
VILLAGE NAME:- BODHI JUNAV

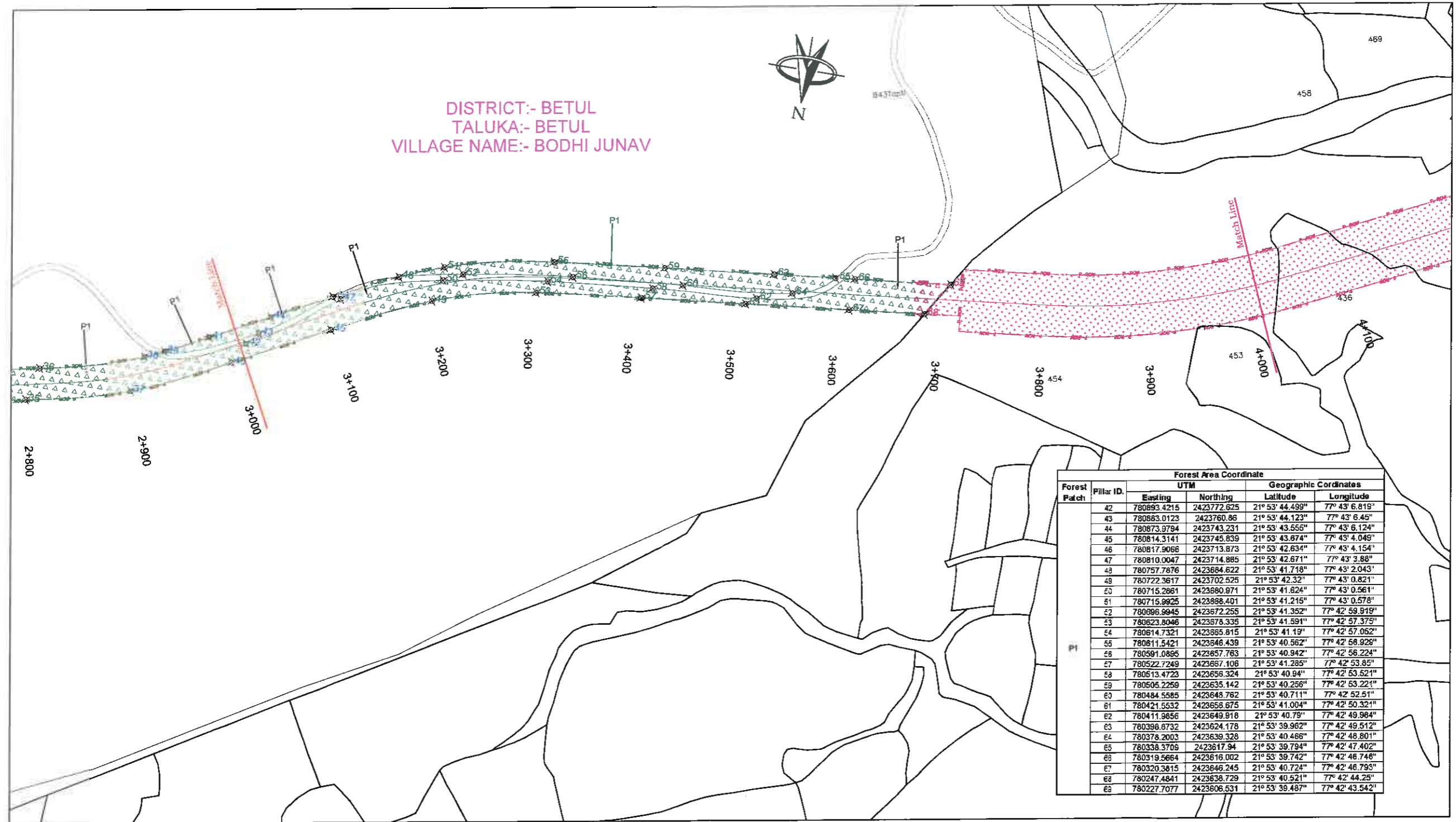

Forest Patch	Pillar ID.	UTM		Geographic Coordinates	
		Easting	Northing	Latitude	Longitude
42	780893.4215	2423772.625	21° 53' 44.499"	77° 43' 6.819"	
43	780883.0123	2423760.86	21° 53' 44.123"	77° 43' 6.45"	
44	780873.9794	2423743.231	21° 53' 43.555"	77° 43' 6.124"	
45	780814.3141	2423745.839	21° 53' 43.874"	77° 43' 4.048"	
46	780817.9066	2423713.873	21° 53' 42.634"	77° 43' 4.154"	
47	780810.0047	2423714.985	21° 53' 42.671"	77° 43' 3.88"	
48	780757.7876	2423684.622	21° 53' 41.718"	77° 43' 2.043"	
49	780722.3617	2423702.525	21° 53' 42.32"	77° 43' 0.821"	
50	780715.2861	2423680.871	21° 53' 41.824"	77° 43' 0.561"	
51	780715.9925	2423688.401	21° 53' 41.215"	77° 43' 0.578"	
52	780696.9945	2423672.255	21° 53' 41.352"	77° 42' 59.919"	
53	780623.8046	2423578.335	21° 53' 41.591"	77° 42' 57.379"	
54	780614.7321	2423665.815	21° 53' 41.19"	77° 42' 57.052"	
55	780611.5421	2423646.439	21° 53' 40.562"	77° 42' 56.926"	
56	780591.0895	2423657.763	21° 53' 40.942"	77° 42' 56.224"	
57	780522.7249	2423667.106	21° 53' 41.285"	77° 42' 53.85"	
58	780613.4723	2423656.324	21° 53' 40.94"	77° 42' 53.521"	
59	780605.2259	2423635.142	21° 53' 40.256"	77° 42' 53.224"	
60	780484.5585	2423648.762	21° 53' 40.711"	77° 42' 52.51"	
61	780421.5532	2423658.675	21° 53' 41.004"	77° 42' 50.321"	
62	780411.9856	2423649.818	21° 53' 40.79"	77° 42' 49.984"	
63	780398.8732	2423624.178	21° 53' 39.962"	77° 42' 49.512"	
64	780378.2003	2423639.328	21° 53' 40.486"	77° 42' 48.801"	
65	780338.3709	2423617.94	21° 53' 39.794"	77° 42' 47.402"	
66	780319.5664	2423616.002	21° 53' 39.742"	77° 42' 46.746"	
67	780320.3815	2423646.245	21° 53' 40.724"	77° 42' 46.793"	
68	780247.4841	2423638.729	21° 53' 40.521"	77° 42' 44.25"	
69	780227.7077	2423606.531	21° 53' 39.487"	77° 42' 43.542"	

LEGEND:-

- PROPOSED CENTER LINE
- PROPOSED ROW
- VILLAGE BOUNDARY
- NON- FOREST LAND
- FOREST LAND
- BOUNDARY POINT

J.K. Das
Project Director
NHAI, PIU Chhindwara (M.P.)

DATE	REV. NO.	DESCRIPTION	BY

DESIGN CONSULTANT:
LEA ASSOCIATES SOUTH ASIA PVT. LTD.,
B-1, E-27, 11nd FLOOR, MOHAN COOPERATIVE INDUSTRIAL ESTATE, MATHURA ROAD, NEW DELHI-110044
INDIA

SCALE:
1:4000

CLIENT:
 NATIONAL HIGHWAYS AUTHORITY OF INDIA
(Ministry of Road Transport & Highways)
Government of India

PROJECT:
4 laning of Betul-Khandwa Section of National Highway(NH-347B) from Betul Design Ch 0+000 to Khandwa Design Ch 125+300 (length-125.300 km) Under BHARATMALA Pariyojana Feeder route (Phase- I) in the State of Madhya Pradesh on Hybrid Annuity Mode.

DRAWING TITLE:
APPLICATION FOR DIVERSION OF FOREST LAND
(KM.3+000 TO KM.4+000)

DRG. NO.	REV.
73579\LASA\HW\MDPR\BKIDGPS-04	0
DATE: May 2018	DRAWN: Ravindra Patwal
DESIGNED: Tanmoy Baur	CHECKED: Sarde Alam
APPROVED: J.K.Das	
SHEET SIZE A3	

← BETUL

KHANDWA →

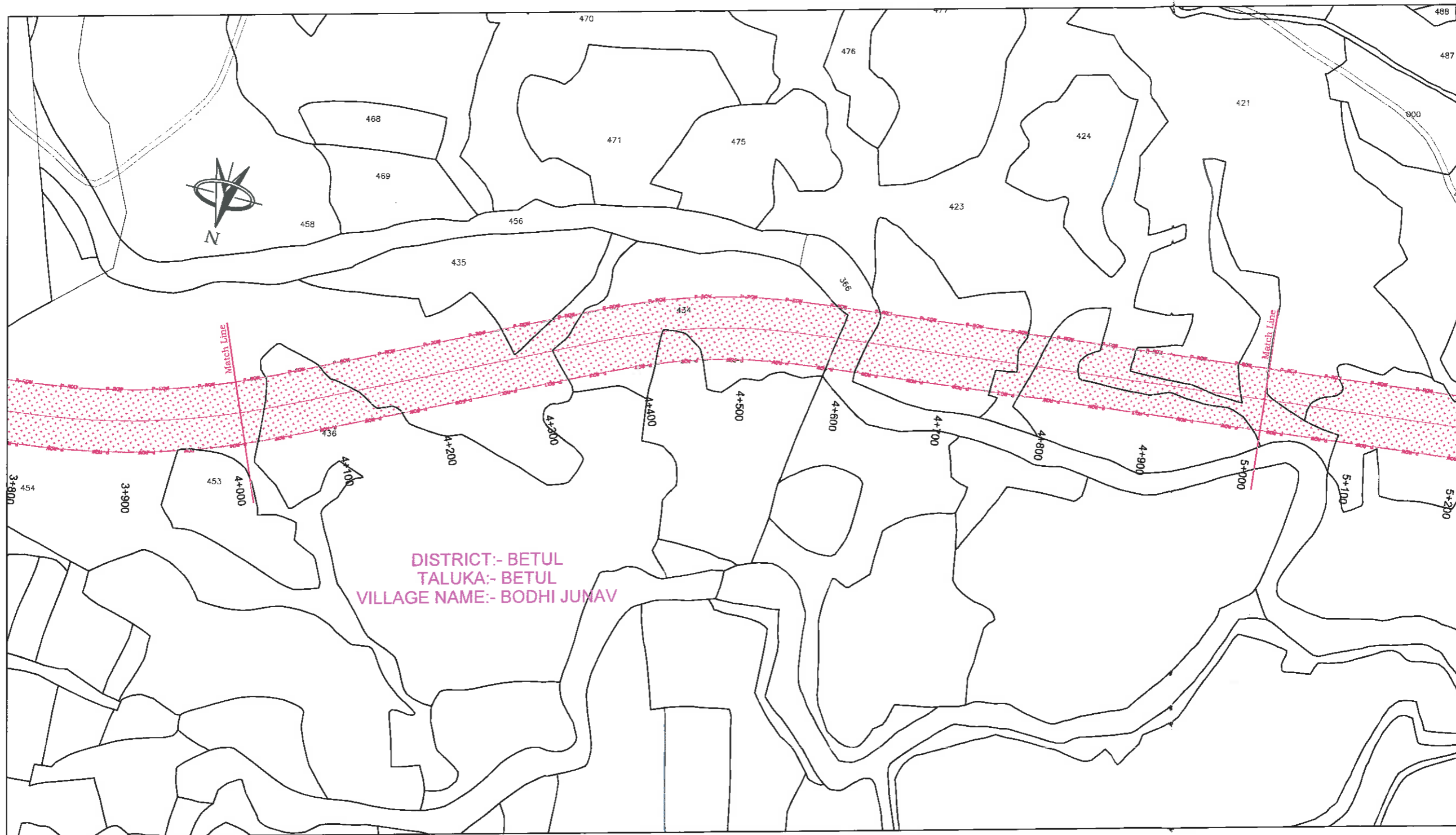

LEGEND:-

	PROPOSED CENTER LINE
	PROPOSED ROW
	VILLAGE BOUNDARY
	NON- FOREST LAND
	FOREST LAND
	BOUNDARY POINT

Ravi Kumar
Project Director
 NHAI, PIU Chhindwara (M.P.)

DATE	REV. NO.	DESCRIPTION	BY
REVISIONS			

DESIGN CONSULTANT:
LEA ASSOCIATES SOUTH ASIA PVT. LTD.,
 B-1, E-27, 1st FLOOR, MOHAN COOPERATIVE INDUSTRIAL ESTATE, MATHURA ROAD, NEW DELHI-110044 INDIA



SCALE:
 1:4000

CLIENT:
 NATIONAL HIGHWAYS AUTHORITY OF INDIA
 (Ministry of Road Transport & Highways)
 Government of India

PROJECT:
 4 laning of Betul-Khandwa Section of National Highway(NH-347B) from Betul Design Ch 0+000 to Khandwa Design Ch 125+300 (length-125.300 km) Under BHARATMALA Pariyojana Feeder route (Phase- I) in the State of Madhya Pradesh on Hybrid Annuity Mode.

DRAWING TITLE:
 APPLICATION FOR DIVERSION OF FOREST LAND
 (KM.4+000 TO KM.5+000)

DRG. NO.	73579LASA\HW\DPRI\BKIDGPS-05	REV.	0
DATE:	May 2018	DRAWN:	Ravindra Patwal
DESIGNED	Tanmoy Baur	CHECKED	Sarde Alam
APPROVED	J.K.Das	SHEET SIZE A3	

← BETUL

KHANDWA →

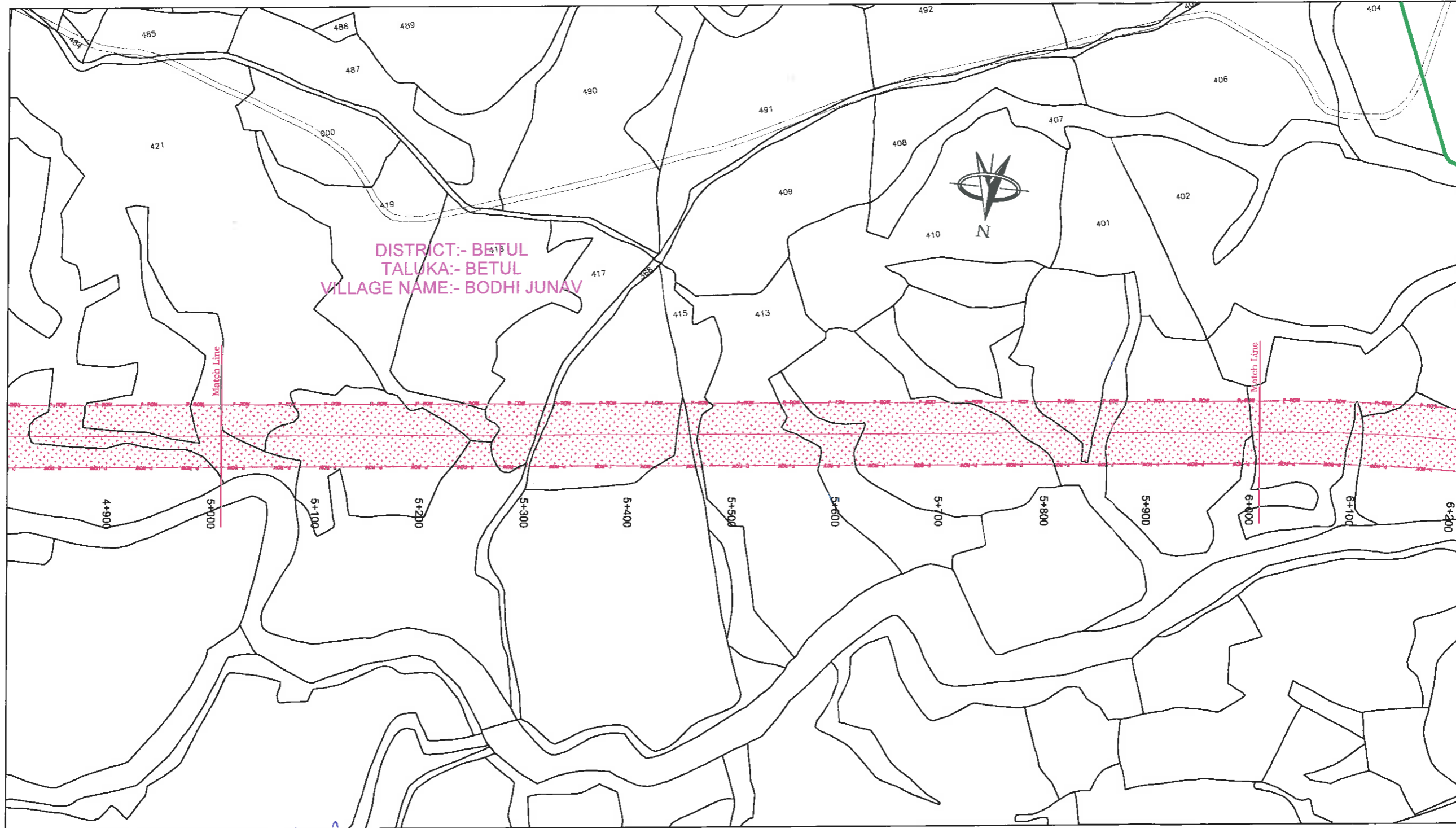

DISTRICT:- BETUL
 TALUKA:- BETUL
 VILLAGE NAME:- BODHI JUNAV

- LEGEND:-**
- PROPOSED CENTER LINE
 - PROPOSED ROW
 - VILLAGE BOUNDARY
 - NON- FOREST LAND
 - FOREST LAND
 - BOUNDARY POINT

ANA
Project Director
 NHAI/PIU Chhindwara (M.P.)

DATE	REV. NO.	DESCRIPTION	BY
REVISIONS			

DESIGN CONSULTANT:
LEA ASSOCIATES SOUTH ASIA PVT. LTD.,
 B-1, E-27, 11nd FLOOR, MOHAN COOPERATIVE
 INDUSTRIAL ESTATE, MATHURA ROAD,
 NEW DELHI-110044
 INDIA

SCALE:
 1:4000

CLIENT:
NATIONAL HIGHWAYS AUTHORITY OF INDIA
 (Ministry of Road Transport & Highways)
 Government of India

PROJECT:
 4 laning of Betul-Khandwa Section of National Highway(NH-347B) from Betul Design Ch 0+000 to Khandwa Design Ch 125+300 (length-125.300 km) Under BHARATMALA Pariyojana Feeder route (Phase-I) in the State of Madhya Pradesh on Hybrid Annuity Mode.

DRAWING TITLE:
APPLICATION FOR DIVERSION OF FOREST LAND
 (KM.5+000 TO KM.6+000)

DRG. NO.	REV.
73579\LASAIHWYDPRIBKIDGPS-06	0
DATE: May 2018	DRAWN: Ravindra Patwal
DESIGNED: Tanmoy Baur	CHECKED: Sarde Alam
APPROVED: J.K.Das	
SHEET SIZE A3	

← BETUL

KHANDWA →

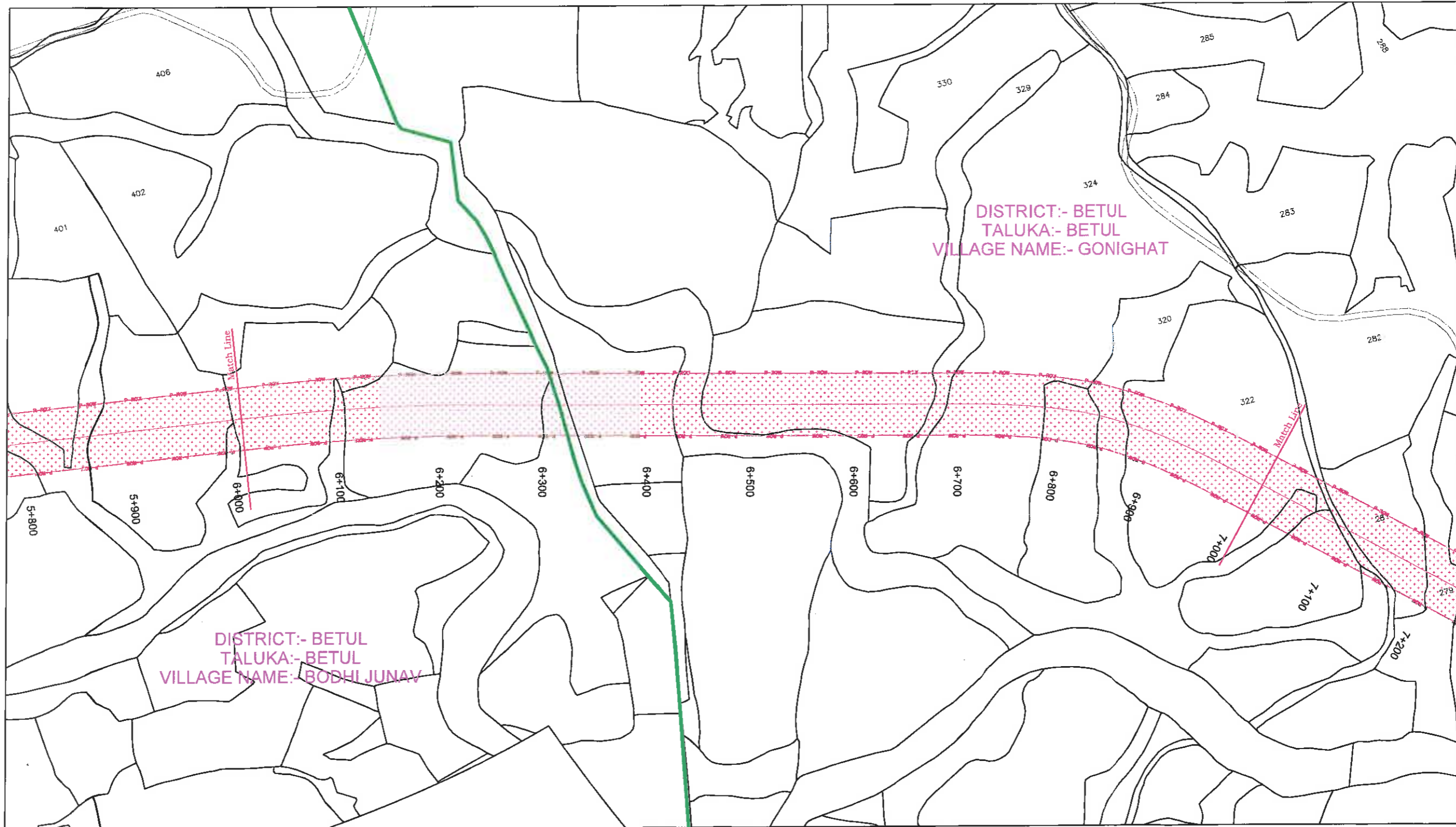

DISTRICT:- BETUL
TALUKA:- BETUL
VILLAGE NAME:- GONIGHAT

DISTRICT:- BETUL
TALUKA:- BETUL
VILLAGE NAME:- BODHI JUNAV

- LEGEND:-**
- PROPOSED CENTER LINE
 - PROPOSED ROW
 - VILLAGE BOUNDARY
 - NON- FOREST LAND
 - FOREST LAND
 - BOUNDARY POINT

A. K. Singh
Project Director
NHAI, PIU Chhindwara (M.P.)

DATE	REV. NO.	DESCRIPTION	BY
REVISIONS			

DESIGN CONSULTANT:
LEA ASSOCIATES SOUTH ASIA PVT. LTD.,
B-1, E-27, 11th FLOOR, MOHAN COOPERATIVE INDUSTRIAL ESTATE, MATHURA ROAD, NEW DELHI-110044
INDIA



SCALE:
1:4000

CLIENT:
 **NATIONAL HIGHWAYS AUTHORITY OF INDIA**
(Ministry of Road Transport & Highways)
Government of India

PROJECT:
4 laning of Betul-Khandwa Section of National Highway(NH-347B) from Betul Design Ch 0+000 to Khandwa Design Ch 125+300 (length-125.300 km) Under BHARATMALA Pariyojana Feeder route (Phase- I) in the State of Madhya Pradesh on Hybrid Annuity Mode.

DRAWING TITLE:
APPLICATION FOR DIVERSION OF FOREST LAND
(KM.6+000 TO KM.7+000)

DRG. NO. 73579LASAHWMDPRBKDGPS-07	REV. 0
DATE: May 2018	DRAWN: Ravindra Patwal
DESIGNED: Tanmoy Baur	CHECKED: Sarde Alam
APPROVED: J.K.Das	
SHEET SIZE A3	

← BETUL

KHANDWA →

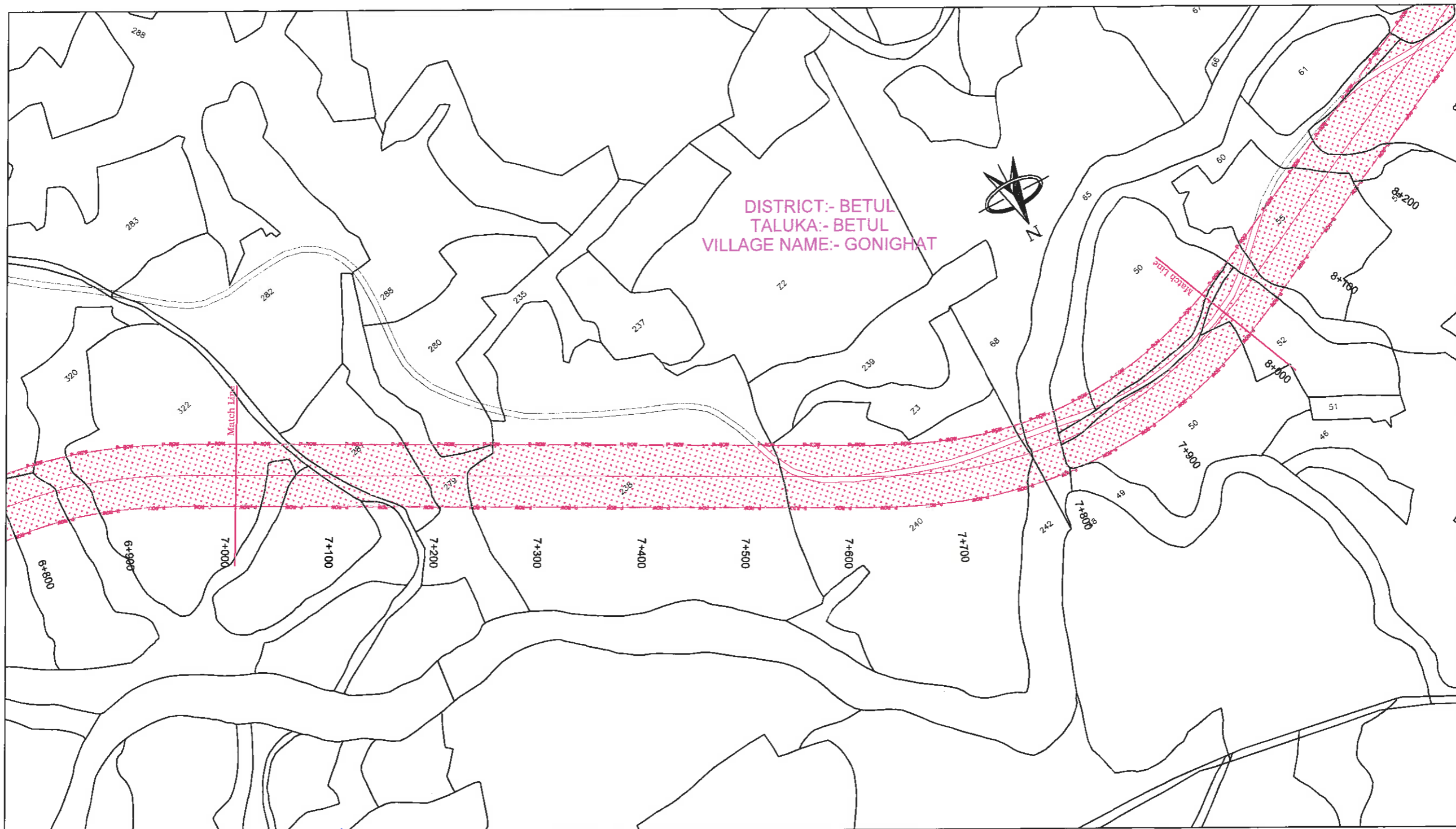

DISTRICT:- BETUL
TALUKA:- BETUL
VILLAGE NAME:- GONIGHAT

- LEGEND:-**
- PROPOSED CENTER LINE
 - PROPOSED ROW
 - VILLAGE BOUNDARY
 - NON- FOREST LAND
 - FOREST LAND
 - BOUNDARY POINT

[Signature]
Project Director
NHAI, PIU Chhindwara (M.P.)

DATE	REV. NO.	DESCRIPTION	BY
REVISIONS			

DESIGN CONSULTANT:
LEA ASSOCIATES SOUTH ASIA PVT. LTD.,
B-1, E-27, 11th FLOOR, MOHAN COOPERATIVE INDUSTRIAL ESTATE, MATHURA ROAD, NEW DELHI-110044
INDIA

SCALE:
1:4000

CLIENT:
 NATIONAL HIGHWAYS AUTHORITY OF INDIA
(Ministry of Road Transport & Highways)
Government of India

PROJECT:
4 laning of Betul-Khandwa Section of National Highway(NH-347B) from Betul Design Ch 0+000 to Khandwa Design Ch 125+300 (length-125.300 km) Under BHARATMALA Pariyojana Feeder route (Phase- I) in the State of Madhya Pradesh on Hybrid Annuity Mode.

DRAWING TITLE:
APPLICATION FOR DIVERSION OF FOREST LAND (KM.7+000 TO KM.8+000)

DRG. NO. 73579\LASAIHWY\DP\B\K\DGPS-08	REV. 0
DATE: May 2018	DRAWN: Ravindra Patwal
DESIGNED: Tanmoy Baur	CHECKED: Sarde Alam
APPROVED: J.K.Das	
SHEET SIZE A3	

← BETUL

KHANDWA →

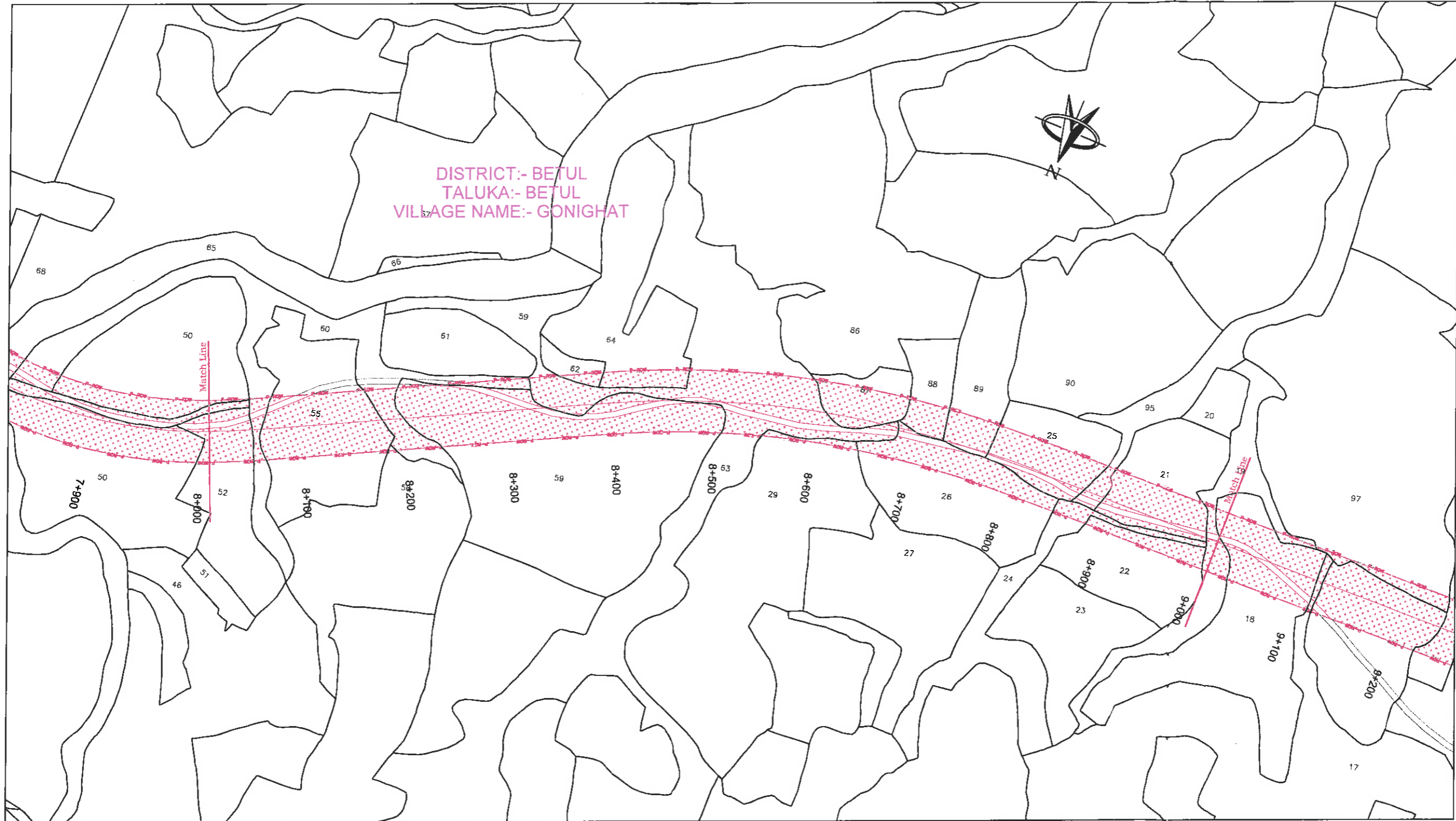

- LEGEND:-**
- PROPOSED CENTER LINE
 - PROPOSED ROW
 - VILLAGE BOUNDARY
 - NON- FOREST LAND
 - FOREST LAND
 - BOUNDARY POINT

A. K. Mishra
Project Director
 NHAI, PIU Chhindwara (M.P.)

DATE	REV. NO.	DESCRIPTION	BY

DESIGN CONSULTANT:
LEA ASSOCIATES SOUTH ASIA PVT. LTD.,
 B-1, E-27, 1st FLOOR, MOHAN COOPERATIVE
 INDUSTRIAL ESTATE, MATHURA ROAD,
 NEW DELHI-110044
 INDIA

SCALE:
 1:4000

CLIENT:
 **NATIONAL HIGHWAYS AUTHORITY OF INDIA**
 (Ministry of Road Transport & Highways)
 Government of India

PROJECT:
 4 laning of Betul-Khandwa Section of National Highway(NH-347B) from Betul Design Ch 0+000 to Khandwa Design Ch 125+300 (length-125.300 km) Under BHARATMALA Pariyojana Feeder route (Phase- I) in the State of Madhya Pradesh on Hybrid Annuity Mode.

DRAWING TITLE:
APPLICATION FOR DIVERSION OF FOREST LAND
 (KM.8+000 TO KM.9+000)

DRG. NO.	73579\LASAIHWY\DRB\BKDGPS-09	REV.	0
DATE:	May 2018	DRAWN:	Ravindra Patwal
DESIGNED	Tanmoy Baur	CHECKED	Sarde Alam
APPROVED	J.K.Das	SHEET SIZE A3	

← BETUL

KHANDWA →

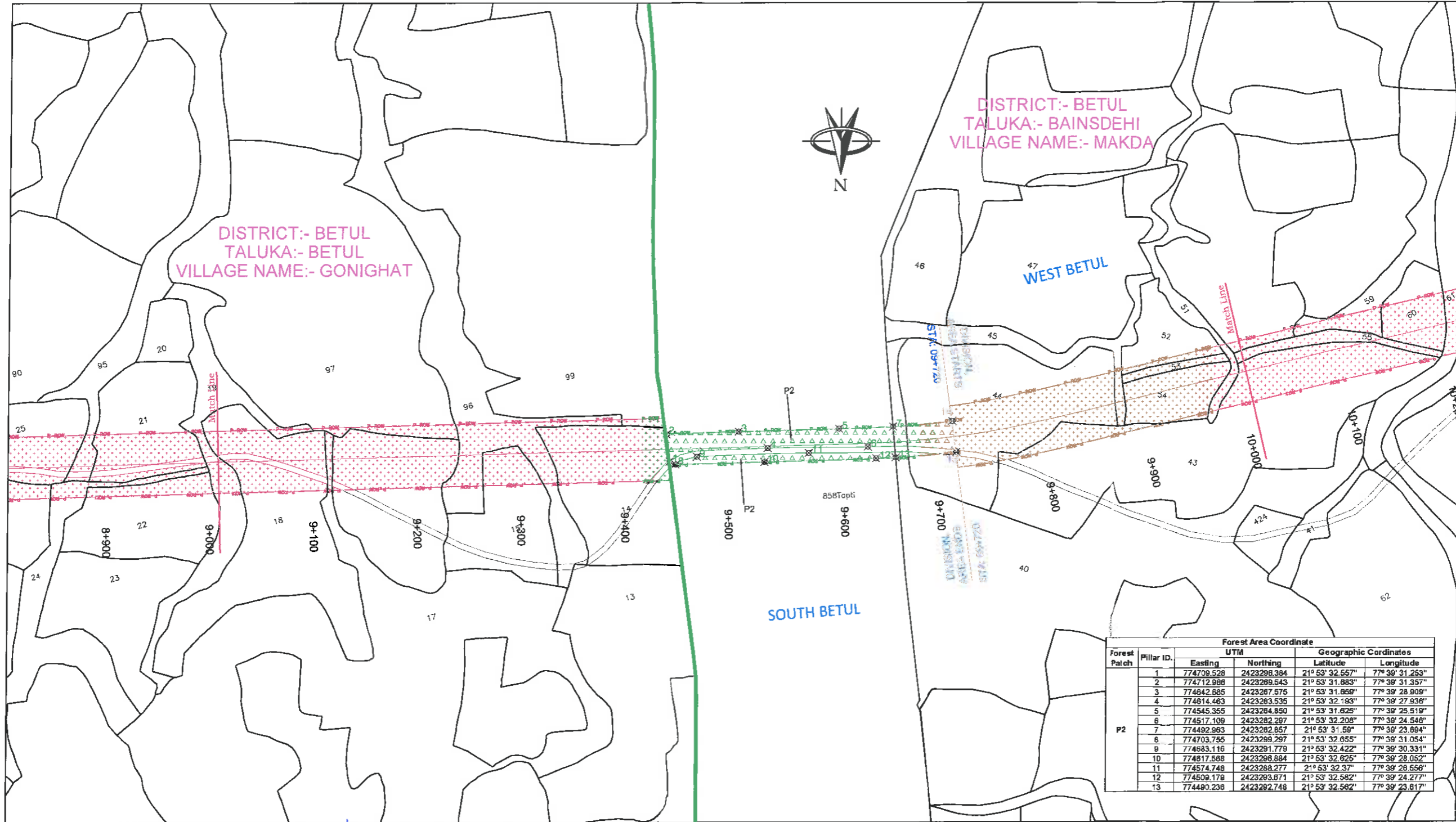

- LEGEND:-**
- PROPOSED CENTER LINE
 - PROPOSED ROW
 - VILLAGE BOUNDARY
 - NON- FOREST LAND
 - FOREST LAND
 - ✕ BOUNDARY POINT

Handwritten Signature
Project Director
NHALPIU Chhindwara (M.P.)

Forest Patch	Pillar ID.	UTM		Geographic Coordinates	
		Easting	Northing	Latitude	Longitude
P2	1	774709.528	2423288.384	21° 53' 32.557"	77° 39' 31.253"
	2	774712.988	2423289.543	21° 53' 31.883"	77° 39' 31.357"
	3	774642.685	2423287.575	21° 53' 31.659"	77° 39' 28.909"
	4	774614.463	2423283.535	21° 53' 32.193"	77° 39' 27.936"
	5	774545.355	2423284.850	21° 53' 31.625"	77° 39' 25.519"
	6	774517.109	2423282.297	21° 53' 32.208"	77° 39' 24.548"
	7	774492.963	2423282.657	21° 53' 31.58"	77° 39' 23.694"
	8	774703.755	2423288.297	21° 53' 32.655"	77° 39' 31.054"
	9	774683.116	2423291.779	21° 53' 32.422"	77° 39' 30.331"
	10	774817.588	2423298.884	21° 53' 32.625"	77° 39' 28.052"
	11	774574.748	2423288.277	21° 53' 32.37"	77° 39' 28.556"
	12	774509.178	2423293.871	21° 53' 32.582"	77° 39' 24.277"
	13	774480.238	2423292.748	21° 53' 32.582"	77° 39' 23.617"

DATE	REV. NO.	DESCRIPTION	BY
REVISIONS			

DESIGN CONSULTANT:
LEA ASSOCIATES SOUTH ASIA PVT. LTD.,
 B-1, E-27, 1st FLOOR, MOHAN COOPERATIVE INDUSTRIAL ESTATE, MATHURA ROAD, NEW DELHI-110044
 INDIA

SCALE:
 1:4000

CLIENT:
NATIONAL HIGHWAYS AUTHORITY OF INDIA
 (Ministry of Road Transport & Highways)
 Government of India

PROJECT:
 4 Laning of Betul-Khandwa Section of National Highway(NH-347B) from Betul Design Ch 0+000 to Khandwa Design Ch 125+300 (length-125.300 km) Under BHARATMALA Pariyojana Feeder route (Phase- I) in the State of Madhya Pradesh on Hybrid Annuity Mode.

DRAWING TITLE:
APPLICATION FOR DIVERSION OF FOREST LAND
 (KM.9+000 TO KM.10+000)

DRG. NO.	REV.
73579\LASA\HWY\DRB\KIDGPS-10	0
DATE: May 2018	DRAWN: Ravindra Patwal
DESIGNED: Tanmoy Baur	CHECKED: Sarde Alam
APPROVED: J.K.Das	
SHEET SIZE A3	