

MINISTRY OF SHIPPING, ROAD TRANSPORT & HIGHWAYS GOV. OF INDIA
 NATIONAL HIGHWAY DIVISION, CHANDRAPUR
 NAME OF PROJECT :- UPGRADEATION OF NATIONAL HIGHWAY FROM BAMHNI TO ASHTI
 NH -353 B SECTION BAMNI-KOTHARI-GONDPIPRI-ASHTI LENGTH 52 KM
 CHAINAGE (22000M To 24000M)

LEGEND

Sr. No.	SYMBOL	DESCRIPTION
1.		PROPOSED ROAD
3.		VILLAGE BOUNDARY
4.		STREAM, NALLA / RIVER
5.		KHASRA BOUNDARY, GAOTHAN
6.		COMPARTMENT FOREST
7.		RESERVE FOREST
8.		WILD LIFE BOUNDARY

Tab.- CHANDRAPUR Dist.-CHANDRAPUR St.-MAHARASHTRA

NAME OF VILLAGES IN SECTION
 LAWARI (NAVI DAHELI), ASHTI

VILLAGE BOUNDARY CO - ORDINATES DETAILS

SR.NO.	CODE	EASTING	NORTHING	LATITUDE	LONGITUDE
1	7	334039.527	2193242.434	79°24'55.182"	19°49'41.313"

NAME OF PLAN
 ROAD PLAN

SURVEYED & PREPARED BY

 SOHAM FERRO MANGANESE Pvt. Ltd.
 OFFICE : Block No.17, Ground Floor,N.K.Y. Towers
 Ajami Square, Wardha Road,Nagpur 440015
 Ph. : (O) 0712-2252221, 2239964
 E-mail : sohamcad@rediffmail.com, soham.ferromagnese@gmail.com

SCALE (M.)
 1 : 4000
 SHEET NO.
 1/12

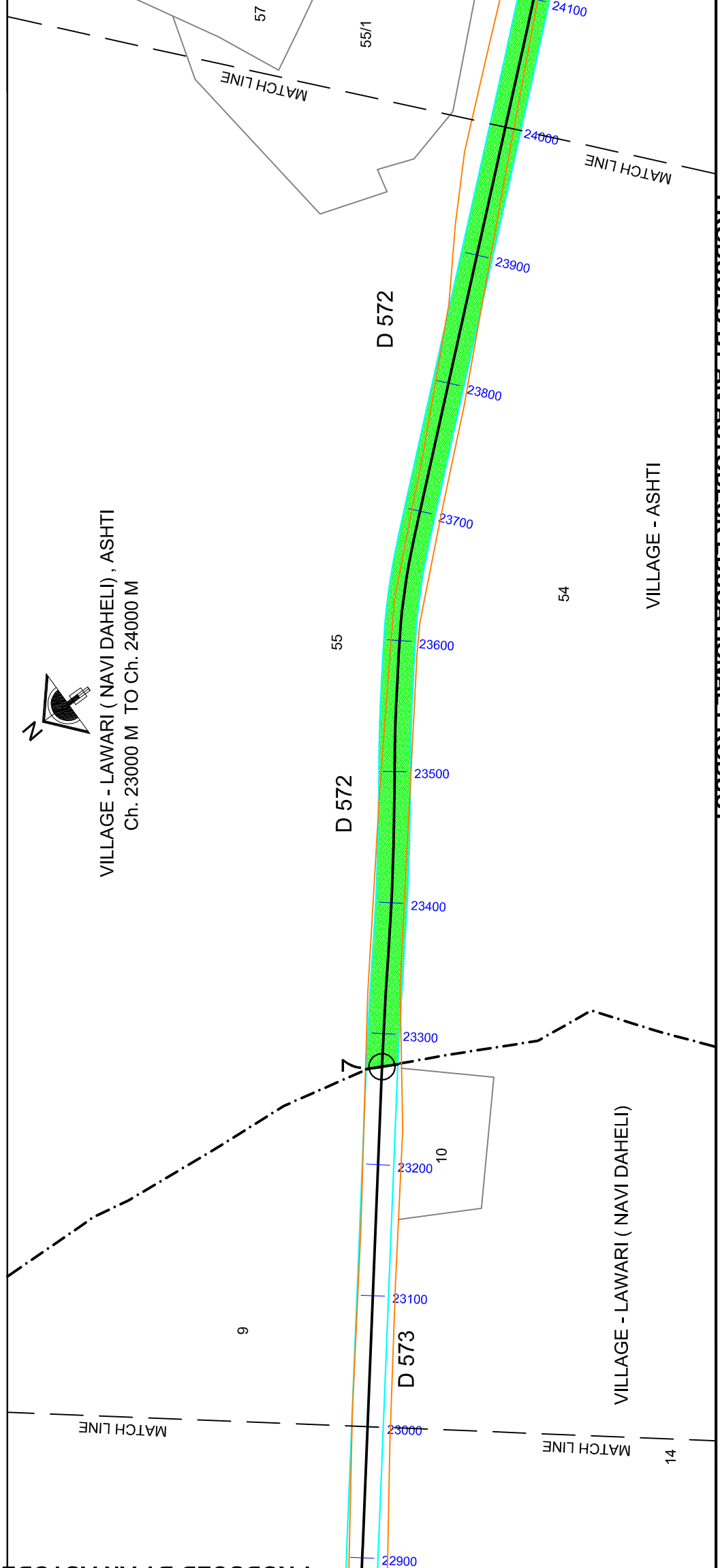
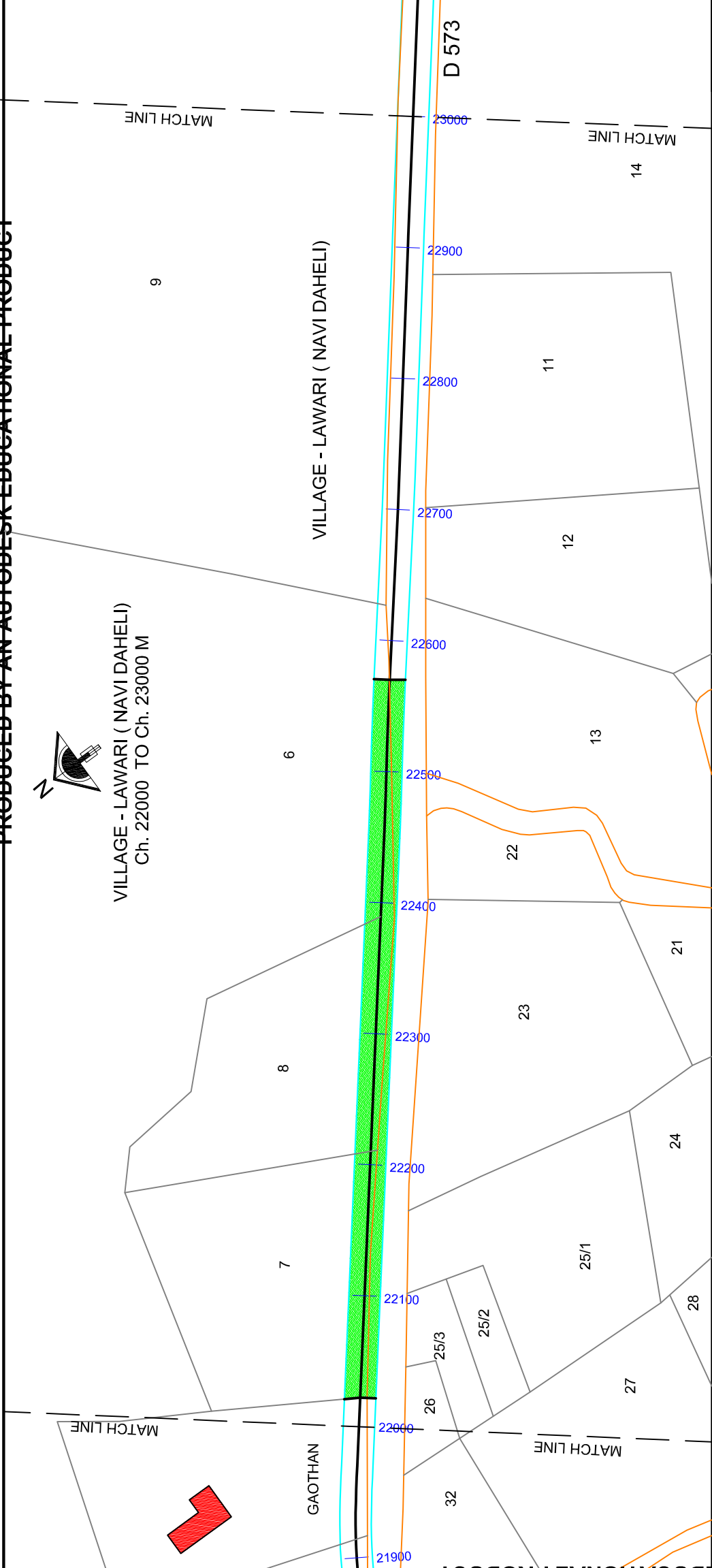

MINISTRY OF SHIPPING, ROAD TRANSPORT & HIGHWAYS GOV. OF INDIA
 NATIONAL HIGHWAY DIVISION, CHANDRAPUR
 NAME OF PROJECT :- UPGRADEATION OF NATIONAL HIGHWAY FROM BAMHNI TO ASHTI
 NH -353 B SECTION BAMNI-KOTHARI-GONDPIPRI-ASHTI LENGTH 52 KM
 CHAINAGE (24000 M TO 26000 M)

LEGEND

Sr. No.	SYMBOL	DESCRIPTION
1.		PROPOSED ROAD
3.		VILLAGE BOUNDARY
4.		STREAM, NALLA / RIVER
5.		KHASRA BOUNDARY, GAOTHAN
6.		COMPARTMENT FOREST
7.		RESERVE FOREST
8.		WILD LIFE BOUNDARY

Tah.- CHANDRAPUR Dist.-CHANDRAPUR St.-MAHARASHTRA
 NAME OF VILLAGES IN SECTION ASHTI , KALAMANA

VILLAGE BOUNDARY CO - ORDINATES DETAILS

SR.NO.	CODE	EASTING	NORTHING	LATITUDE	LONGITUDE
1	8	335121.581	2192136.64	79°25'32.721"	19°49'5.681"
2	9	335292.669	2192102.89	79°25'38.611"	19°49'4.636"
3	10	335951.7212	2192157.862	79°26'1.240"	19°49'6.622"

ROAD PLAN

SURVEYED & PREPARED BY
 SOHAM FERRO MANGANEASE Pvt. Ltd.
 OFFICE : Block No.17, Ground Floor, N.K.Y. Towers
 Ajani Square, Wardha Road, Nagpur 440015
 Ph. : (O) 0712-2252221, 2239964
 E-mail : sohamlead@rediffmail.com, soham.ferromangnese@gmail.com

SCALE (M) 1 : 4000 SHEET NO. 2/12

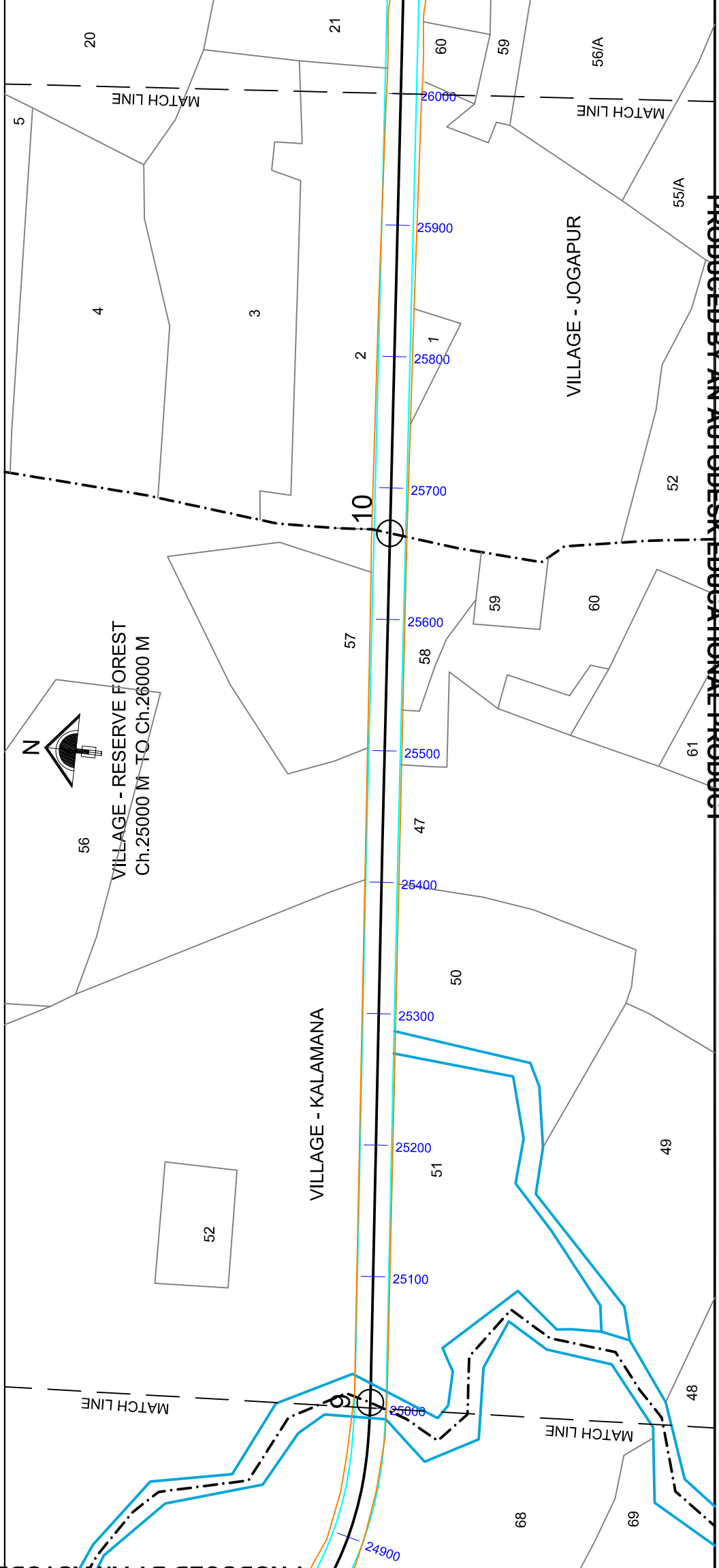
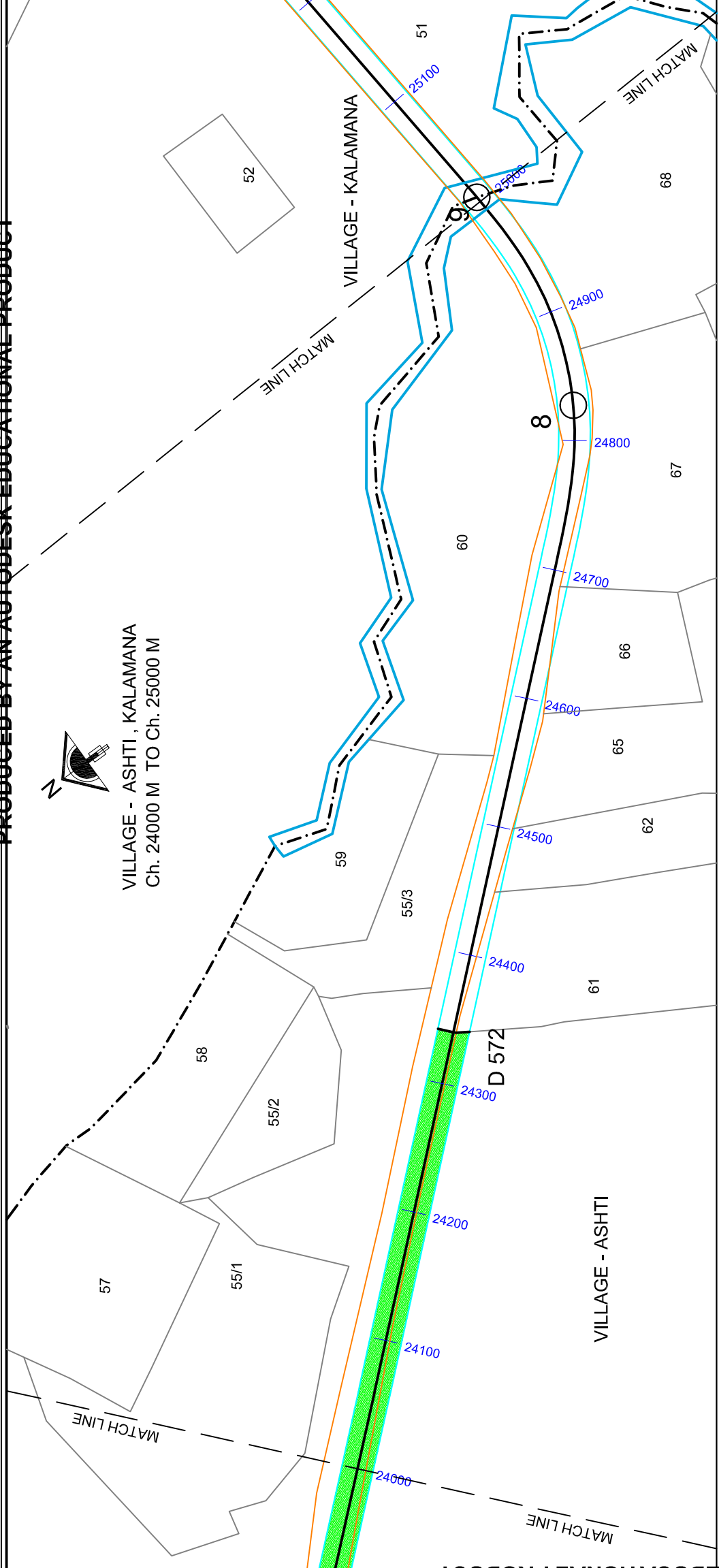

MINISTRY OF SHIPPING, ROAD TRANSPORT & HIGHWAYS GOV. OF INDIA
 NATIONAL HIGHWAY DIVISION, CHANDRAPUR
 NAME OF PROJECT :- UPGRADEATION OF NATIONAL HIGHWAY FROM BAMNI TO ASHTI
 NH -353 B SECTION BAMNI-KOTHARI-GONDPIPRI-ASHTI LENGTH 52 KM
 CHAINAGE (33000M To 35000M)

LEGEND

Sr. No.	SYMBOL	DESCRIPTION
1.		PROPOSED ROAD
3.		VILLAGE BOUNDARY
4.		STREAM, NALLA / RIVER
5.		KHASRA BOUNDARY, GAOTHAN
6.		COMPARTMENT FOREST
7.		RESERVE FOREST
8.		WILD LIFE BOUNDARY

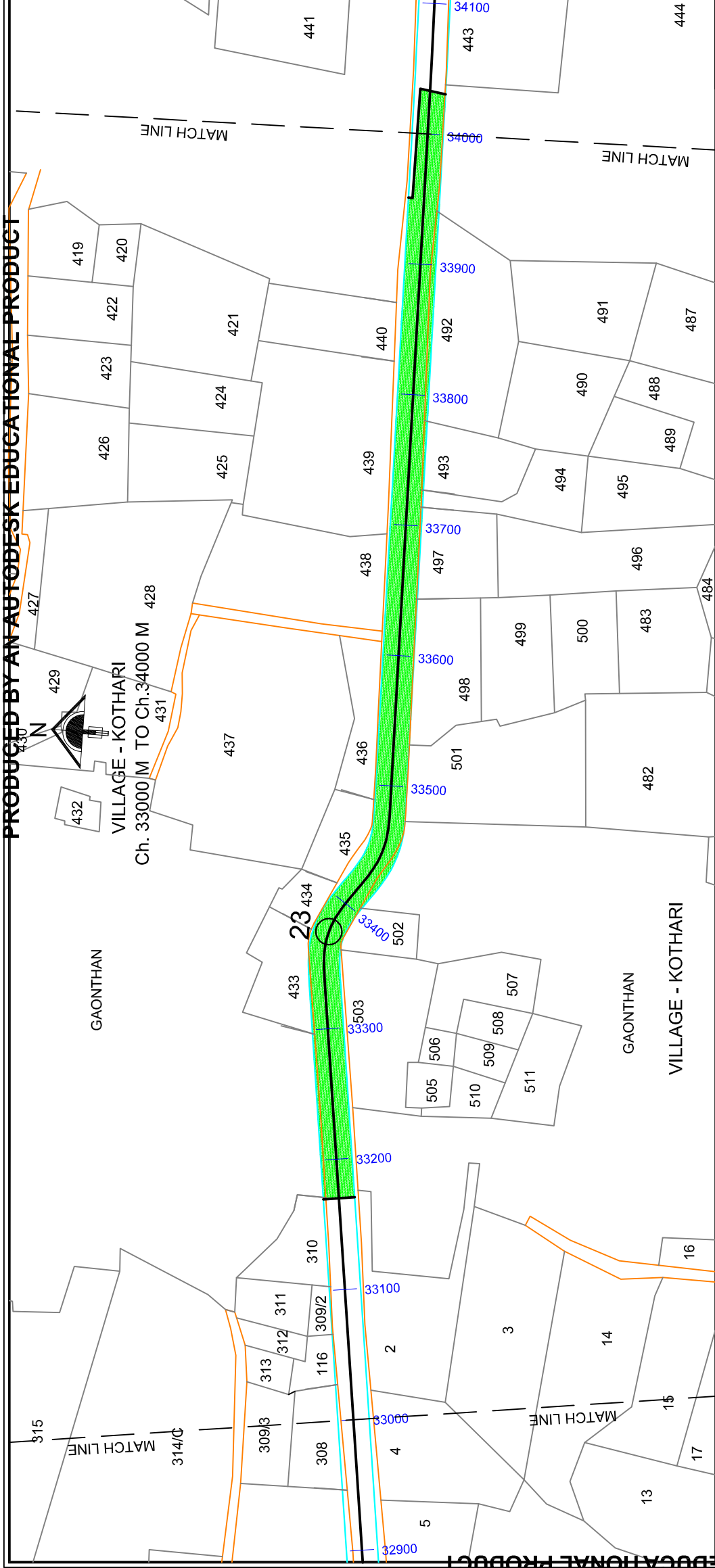

Tab.- CHANDRAPUR Dist.-CHANDRAPUR St.-MAHARASHTRA

NAME OF VILLAGES IN SECTION
 KOTHARI , RESERVED FOREST

VILLAGE BOUNDARY CO - ORDINATES DETAILS

SR.NO.	CODE	EASTING	NORTHING	LATITUDE	LONGITUDE
1	23	342168.9948	2189082.072	79°29'35.830"	19°47'28.432"
2	24	343218.8014	2189036.852	79°30'11.913"	19°47'27.265"
3	25	343511.3308	2188763.344	79°30'22.047"	19°47'18.454"

ROAD PLAN

NAME OF PLAN	ROAD PLAN	
SURVEYED & PREPARED BY	SOHAM FERRO MANGANEASE Pvt. Ltd. OFFICE : Block No.17, Ground Floor,N.K.Y. Towers Ajami Square, Wardha Road,Nagpur 440015 Ph. : (O) 0712-2252221, 2239964 E-mail : sohamcad@rediffmail.com, soham.ferromagnese@gmail.com	
SCALE (M)	1 : 4000	SHEET NO. 3/12

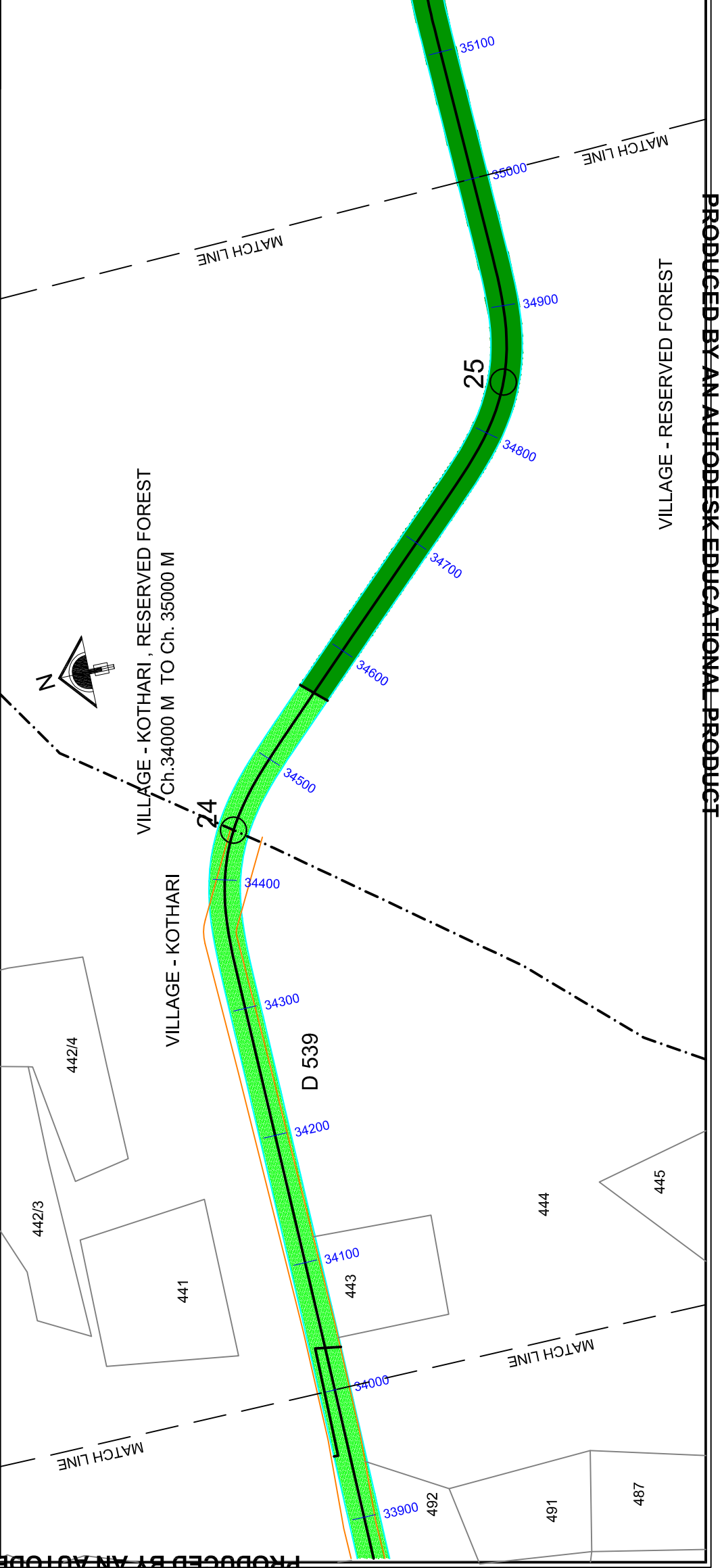

MINISTRY OF SHIPPING, ROAD TRANSPORT & HIGHWAYS GOV. OF INDIA
 NATIONAL HIGHWAY DIVISION, CHANDRAPUR
 NAME OF PROJECT :- UPGRADEATION OF NATIONAL HIGHWAY FROM BAMHNI TO ASHTI
 NH -353 B SECTION BAMNI-KOTHARI-GONDDIPRI-ASHTI LENGTH 52 KM

CHAINAGE (35000M TO 37000M)

LEGEND

Sr. No.	SYMBOL	DESCRIPTION
1.		PROPOSED ROAD
3.		VILLAGE BOUNDARY
4.		STREAM, NALLA / RIVER
5.		KHASRA BOUNDARY, GAOTHAN
6.		COMPARTMENT FOREST
7.		RESERVE FOREST
8.		WILD LIFE BOUNDARY

Tab.- St. - MAHARASHTRA
 Dist. -

NAME OF VILLAGES IN SECTION RESERVED FOREST

VILLAGE BOUNDARY CO - ORDINATES DETAILS

SR.NO.	CODE	EASTING	NORTHING	LATITUDE	LONGITUDE
1	26	343887.5383	2188747.847	79°30'35.321"	19°47'18.063"
2	27	344198.0672	2188620.898	79°30'45.685"	19°47'14.020"
3	28	344622.8198	2188535.865	79°31'0.304"	19°47'11.376"
4	29	344967.8129	2188622.533	79°31'12.131"	19°47'14.293"
5	30	345259.9815	2188438.718	79°31'22.224"	19°47'8.395"

ROAD PLAN

SURVEYED & PREPARED BY
 SOHAM FERRO MANGANEASE Pvt. Ltd.
 OFFICE : Block No.17, Ground Floor,N.K.Y. Towers
 Ajani Square, Wardha Road,Nagpur-440015
 Ph. : (O) 0712-2252221, 2239964
 E-mail : sohamcad@rediffmail.com, soham.ferromagnese@gmail.com

SCALE (M) 1 : 4000 SHEET NO. 4/12

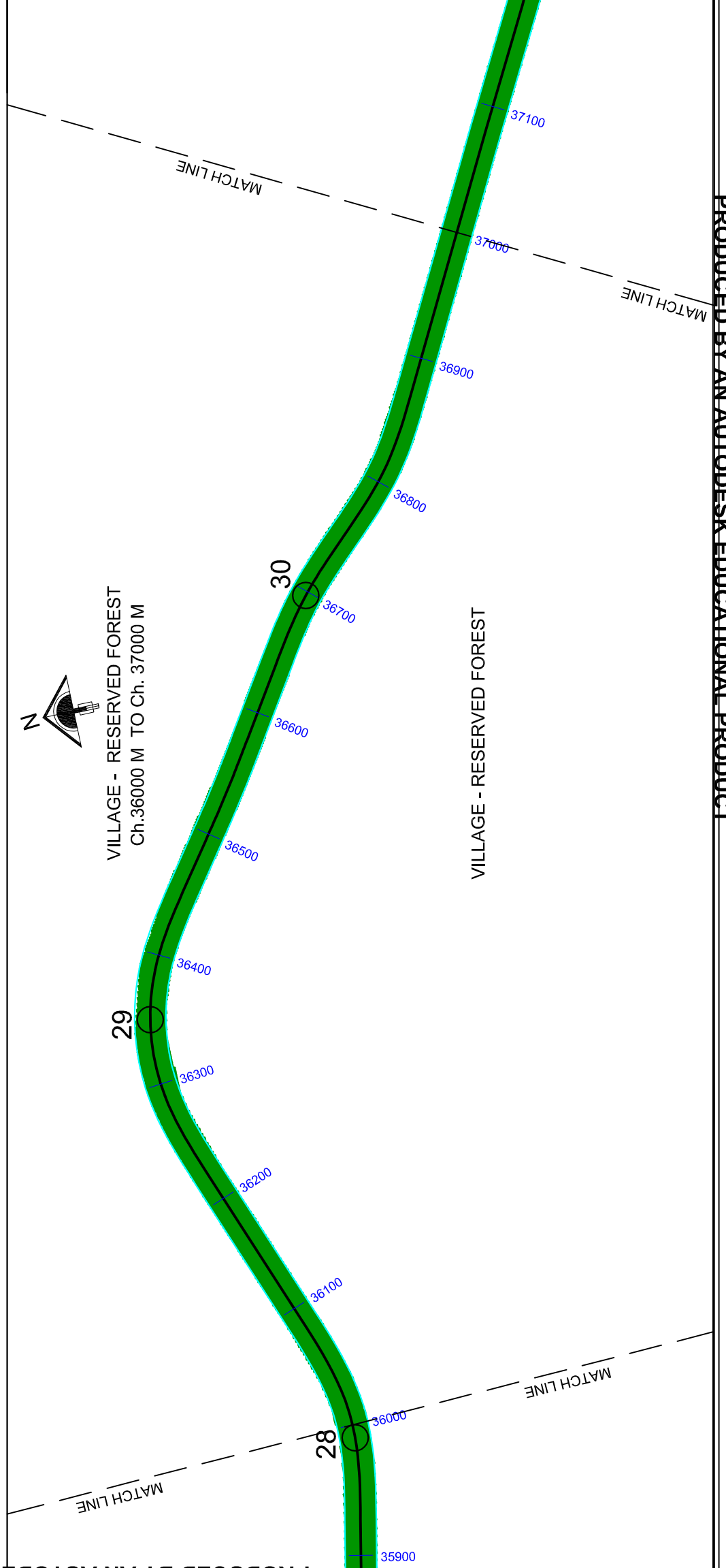
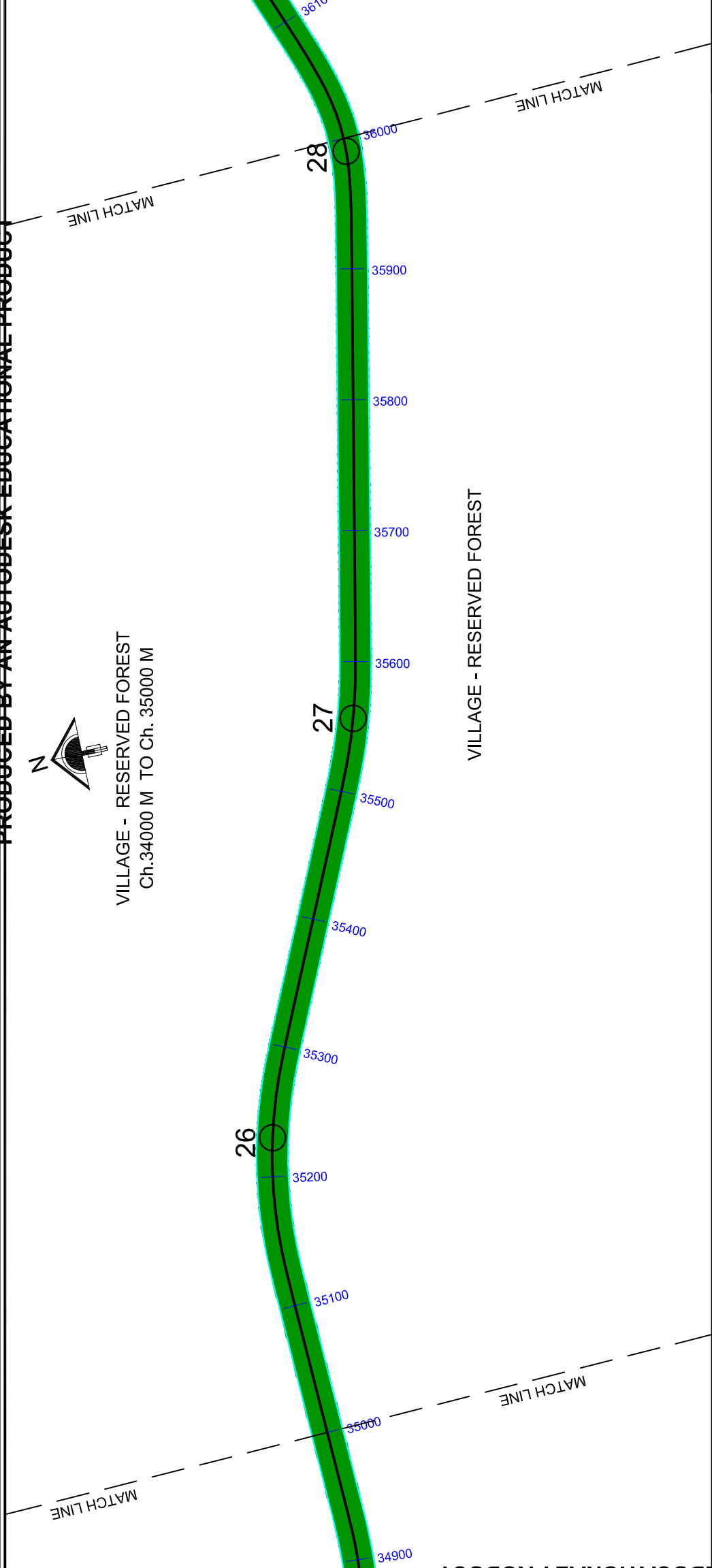

MINISTRY OF SHIPPING, ROAD TRANSPORT & HIGHWAYS GOV. OF INDIA
 NATIONAL HIGHWAY DIVISION, CHANDRAPUR
 NAME OF PROJECT :- UPGRADEATION OF NATIONAL HIGHWAY FROM BAMHNI TO ASHTI
 NH -353 B SECTION BAMNI-KOTHARI-GONDPIPRI-ASHTI
 LENGTH 52 KM

CHAINAGE (37000M To 39000M)

LEGEND

Sr. No.	SYMBOL	DESCRIPTION
1.		PROPOSED ROAD
3.		VILLAGE BOUNDARY
4.		STREAM, NALLA / RIVER
5.		KHASRA BOUNDARY, GAOTHAN
6.		COMPARTMENT FOREST
7.		RESERVE FOREST
8.		WILD LIFE BOUNDARY

Tah.- Dist.- St.-MAHARASHTRA

NAME OF VILLAGES IN SECTION RESERVED FOREST

VILLAGE BOUNDARY CO - ORDINATES DETAILS

SR.NO.	CODE	EASTING	NORTHING	LATITUDE	LONGITUDE
1	31	345726.2513	2188145.604	79°31'38.331"	19°46'58.995"
2	32	346182.439	2187828.004	79°31'54.099"	19°46'48.795"
3	33	347220.9319	2187872.027	79°32'29.765"	19°46'50.519"
4	34	347411.2269	2187760.889	79°32'36.336"	19°46'46.957"

ROAD PLAN

SOHAM FERRO MANGANEASE Pvt. Ltd.
 OFFICE : Block No.17, Ground Floor,N.K.Y. Towers
 Ajani Square, Wardha Road,Nagpur 440015
 Ph. : (O) 0712-2252221, 2239964
 E-mail : sohamferro@gmail.com, soham.ferromagnese@gmail.com

SCALE (M) 1 : 4000 SHEET NO. 5/12

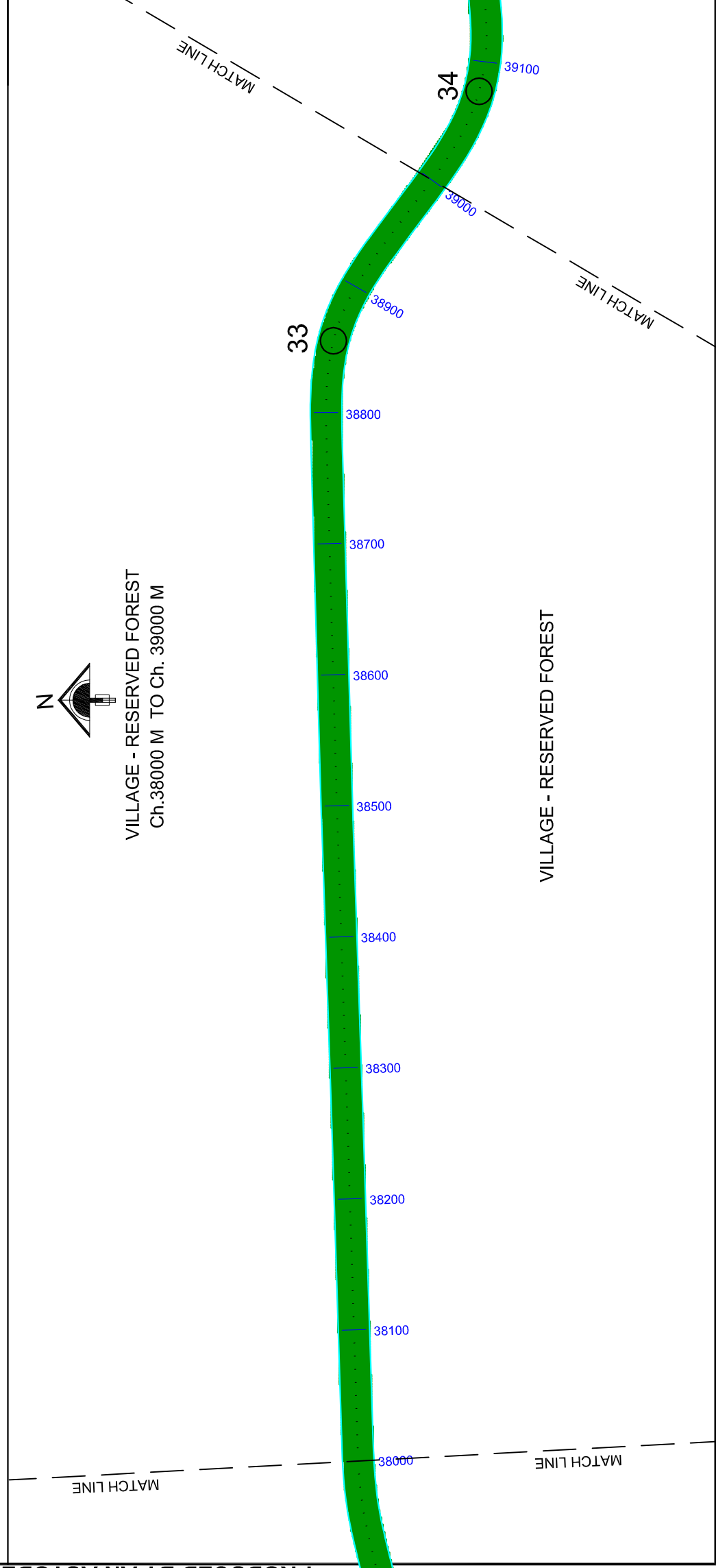
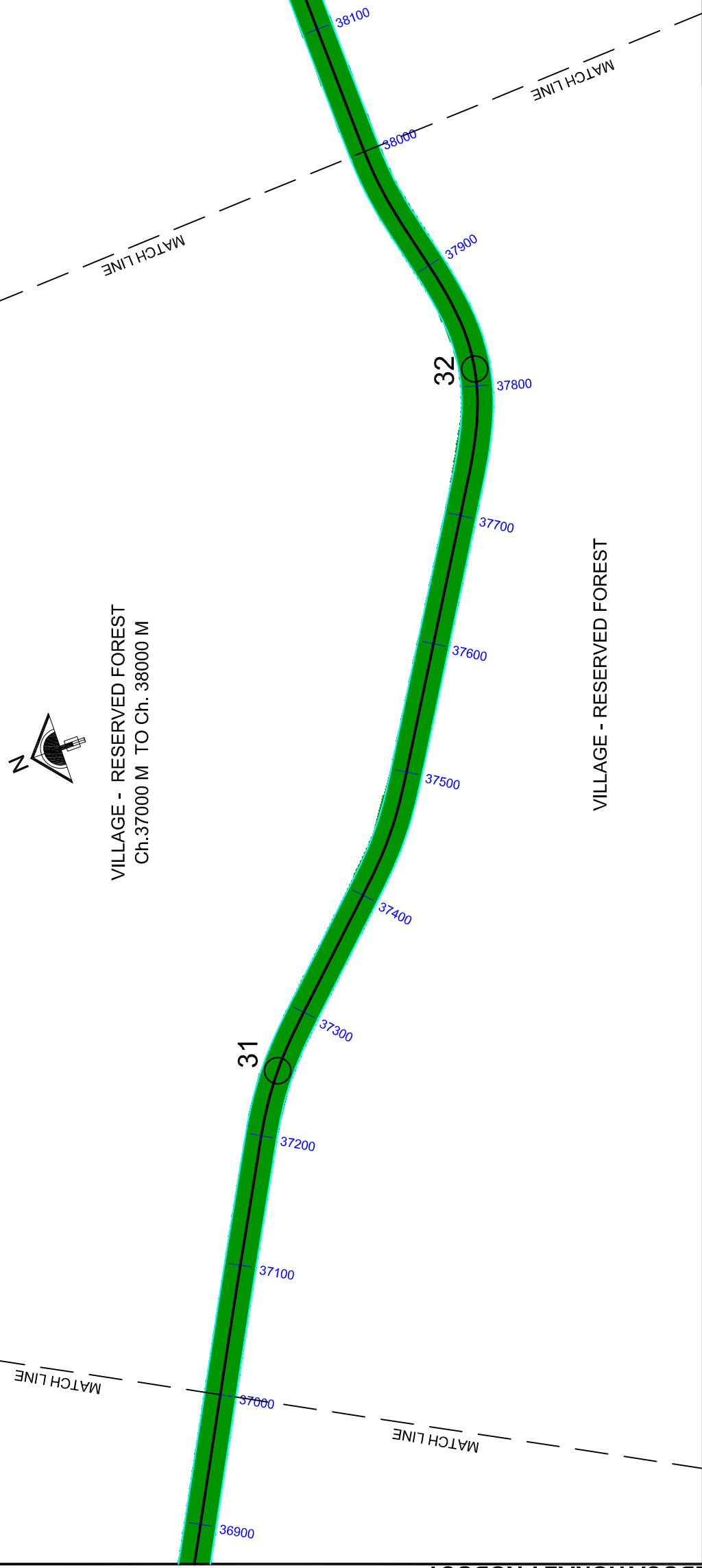

MINISTRY OF SHIPPING, ROAD TRANSPORT & HIGHWAYS GOV. OF INDIA
 NATIONAL HIGHWAY DIVISION, CHANDRAPUR
 NAME OF PROJECT :- UPGRADEATION OF NATIONAL HIGHWAY FROM BAMHNI TO ASHTI
 NH -353 B SECTION BAMNI-KOTHARI-GONDPIPRI-ASHTI LENGTH 52 KM
 CHAINAGE (39000M TO 41000M)

LEGEND

Sr. No.	SYMBOL	DESCRIPTION
1.		PROPOSED ROAD
3.		VILLAGE BOUNDARY
4.		STREAM, NALLA / RIVER
5.		KHASRA BOUNDARY, GAOTHAN
6.		COMPARTMENT FOREST
7.		RESERVE FOREST
8.		WILD LIFE BOUNDARY

Tah. - St. - MAHARASHTRA
 Dist. -

NAME OF VILLAGES IN SECTION
 RESERVED FOREST

VILLAGE BOUNDARY CO - ORDINATES DETAILS

SR.NO.	CODE	EASTING	NORTHING	LATITUDE	LONGITUDE
1	34	347411.2269	2187760.889	79°32'36.336"	19°46'46.957"
2	35	347734.0515	2187785.105	79°32'47.420"	19°46'47.835"
3	36	348042.6204	2187608.461	79°32'58.073"	19°46'42.176"
4	37	348283.5854	2187335.987	79°33'6.432"	19°46'33.362"
5	38	348587.3167	2187181.009	79°33'16.912"	19°46'21.025"
6	39	348700.6747	2186952.47	79°33'20.874"	19°46'21.025"
7	40	348959.1795	2186830.318	79°33'29.790"	19°46'17.124"

ROAD PLAN

SURVEYED & PREPARED BY

 SOHAM FERRO MANGANEASE Pvt. Ltd.
 OFFICE : Block No.17, Ground Floor,N.K.Y. Towers
 Ajami Square, Wardha, Road, Nagpur-440015
 Ph. : (O) 0712-2252221, 2239964
 E-mail : sohamced@rediffmail.com, soham.ferromagnese@gmail.com

SCALE (M) 1 : 4000 SHEET NO. 6/12

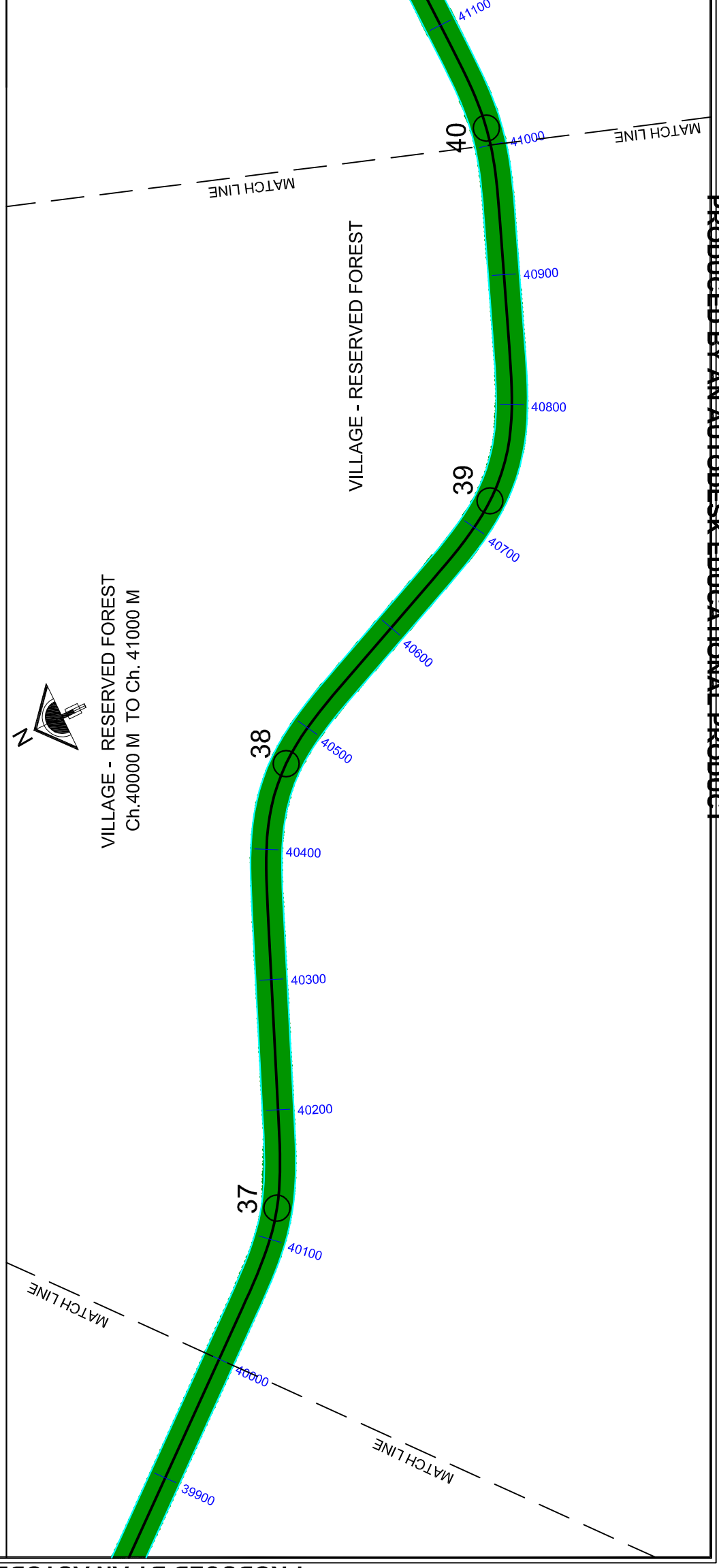
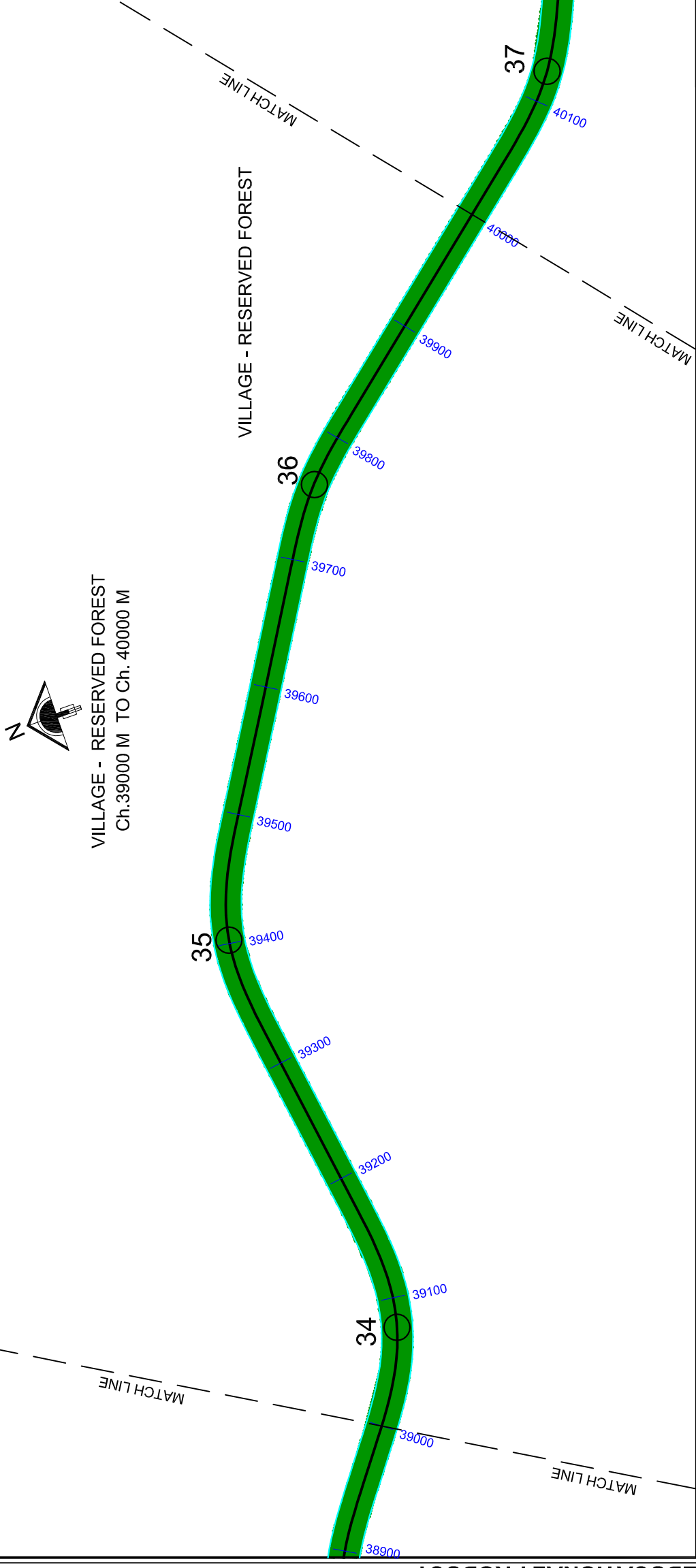

MINISTRY OF SHIPPING, ROAD TRANSPORT & HIGHWAYS GOV. OF INDIA
 NATIONAL HIGHWAY DIVISION, CHANDRAPUR
 NAME OF PROJECT :- UPGRADEATION OF NATIONAL HIGHWAY FROM BAMNI TO ASHTI
 NH -353 B SECTION BAMNI-KOTHARI-GONDIPIPRI-ASHTI LENGTH 52 KM
 CHAINAGE (41000M TO43000M)

LEGEND

Sr. No.	SYMBOL	DESCRIPTION
1.		PROPOSED ROAD
3.		VILLAGE BOUNDARY
4.		STREAM, NALLA / RIVER
5.		KHASRA BOUNDARY, GAOTHAN
6.		COMPARTMENT FOREST
7.		RESERVE FOREST
8.		WILD LIFE BOUNDARY

Tah.- GONDPIPRI Dist.-CHANDRAPUR St.-MAHARASHTRA
 NAME OF VILLAGES IN SECTION RESERVED FOREST , GANPUR

VILLAGE BOUNDARY CO - ORDINATES DETAILS

SR.NO.	CODE	EASTING	NORTHING	LATITUDE	LONGITUDE
1	41	349175.109	2186829.82	79°33'37.209"	19°46'17.167"
2	42	350117.470	2186834.436	79°34'9.582"	19°46'17.577"
3	43	350324.460	2186744.154	79°34'16.719"	19°46'14.698"

ROAD PLAN

SURVEYED & PREPARED BY
 SOHAM FERRO MANGANEASE Pvt. Ltd.
 OFFICE : Block No.17, Ground Floor,N.K.Y. Towers
 Ajanti Square, Wardha Road,Nagpur 440015
 Ph. : (O) 0712-2252221, 2239964
 E-mail : sohamcad@rediffmail.com, soham.ferromagnese@gmail.com

SCALE (M) 1 : 4000 SHEET NO. 7/12

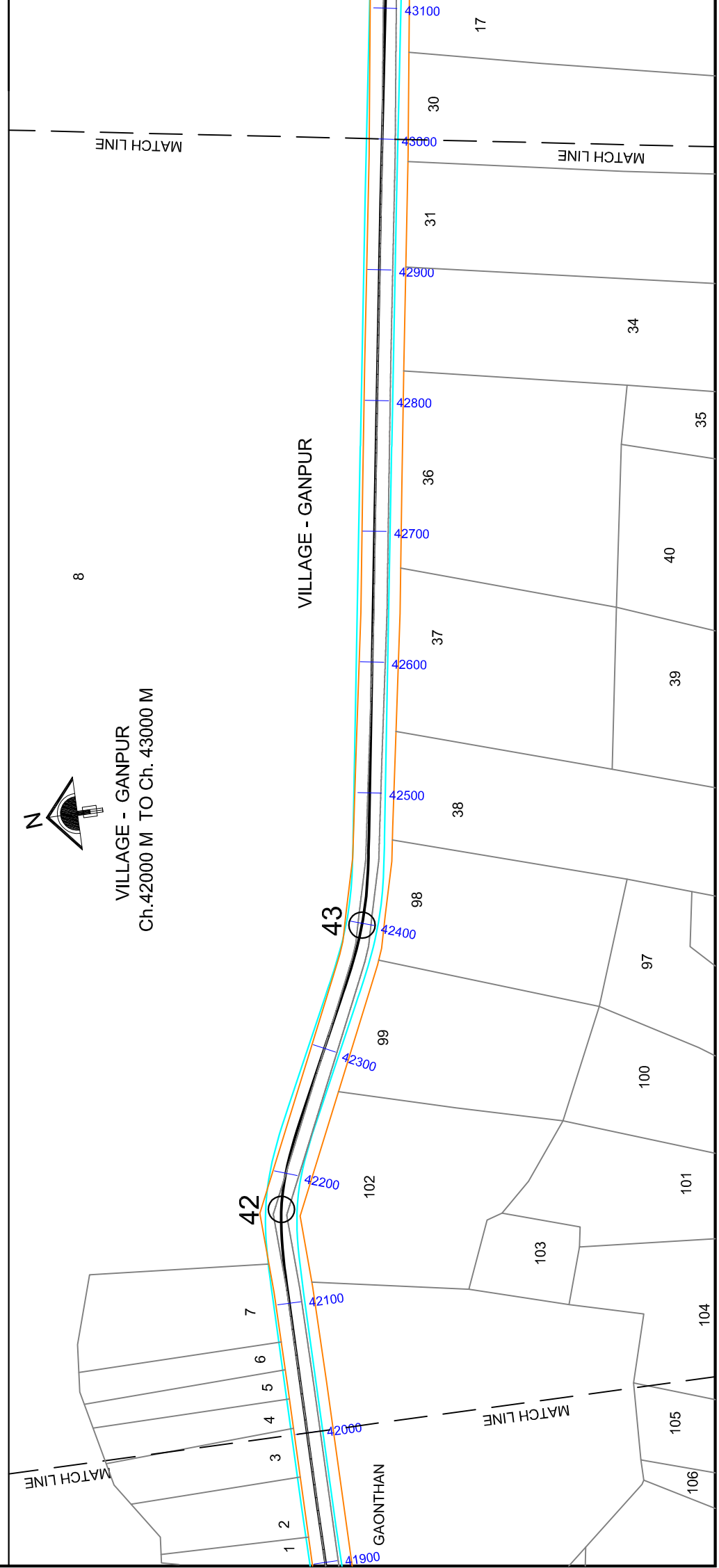
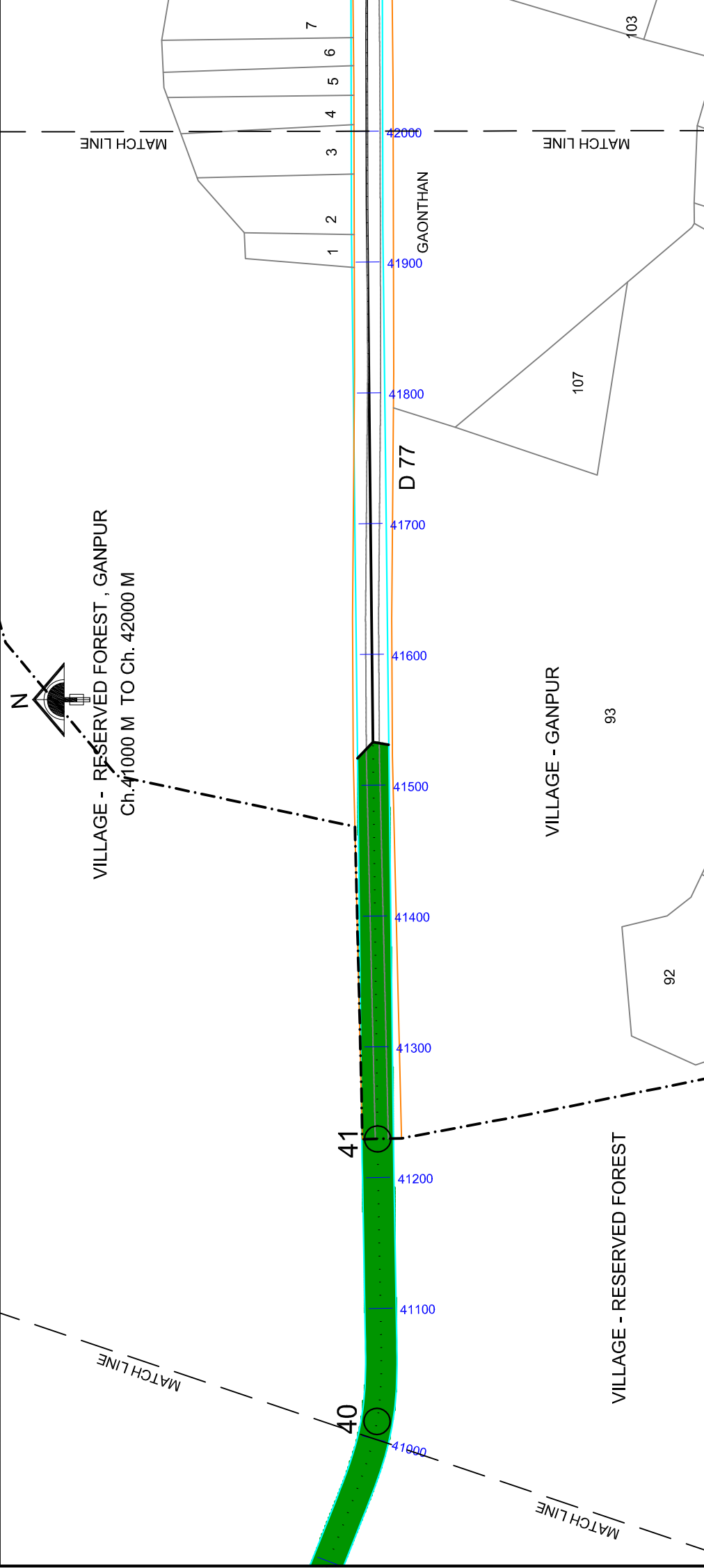

MINISTRY OF SHIPPING, ROAD TRANSPORT & HIGHWAYS GOV. OF INDIA
 NATIONAL HIGHWAY DIVISION, CHANDRAPUR
 NAME OF PROJECT :- UPGRADEATION OF NATIONAL HIGHWAY FROM BAMHNI TO ASHTI
 NH -353 B SECTION BAMNI-KOTHARI-GONDPIPRI-ASHTI LENGTH 52 KM
 CHAINAGE (24000 M TO 26000 M)

LEGEND

Sr. No.	SYMBOL	DESCRIPTION
1.		PROPOSED ROAD
3.		VILLAGE BOUNDARY
4.		STREAM, NALLA / RIVER
5.		KHASRA BOUNDARY, GAOTHAN
6.		COMPARTMENT FOREST
7.		RESERVE FOREST
8.		WILD LIFE BOUNDARY

Tab.- GONDPIPARI Dist.-CHANDRAPUR St.-MAHARASHTRA
 NAME OF VILLAGES IN SECTION GANPUR , RESERVED FOREST

VILLAGE BOUNDARY CO - ORDINATES DETAILS

SR.NO.	CODE	EASTING	NORTHING	LATITUDE	LONGITUDE
1	44	351366.6434	2186575.225	79°34'52.572"	19°46'9.489"
2	45	335292.669	2186546.851	79°35'.701"	19°46'8.630"
3	46	352109.3665	2186897.044	79°35'17.996"	19°46'20.157"

ROAD PLAN

NAME OF PLAN

SURVEYED & PREPARED BY



SOHAM FERRO MANGANEASE Pvt. Ltd.
 OFFICE : Block No.17, Ground Floor,N.K.Y. Towers
 Ajanti Square, Wardha Road,Nagpur 440015
 Ph. : (O) 0712-2252221, 2239964
 E-mail : sohamcad@rediffmail.com, soham.ferromagnese@gmail.com

SCALE (M) 1 : 4000 SHEET NO. 8/12

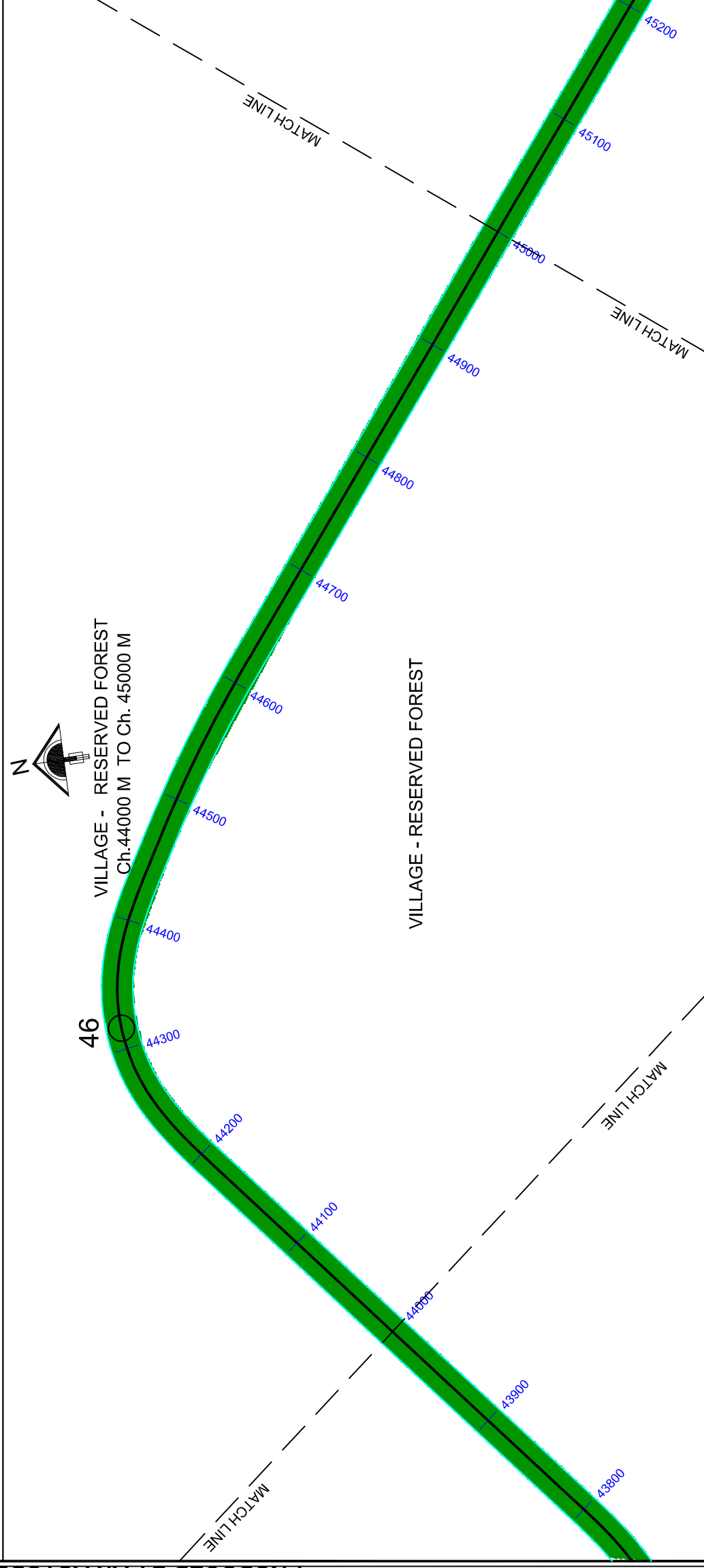
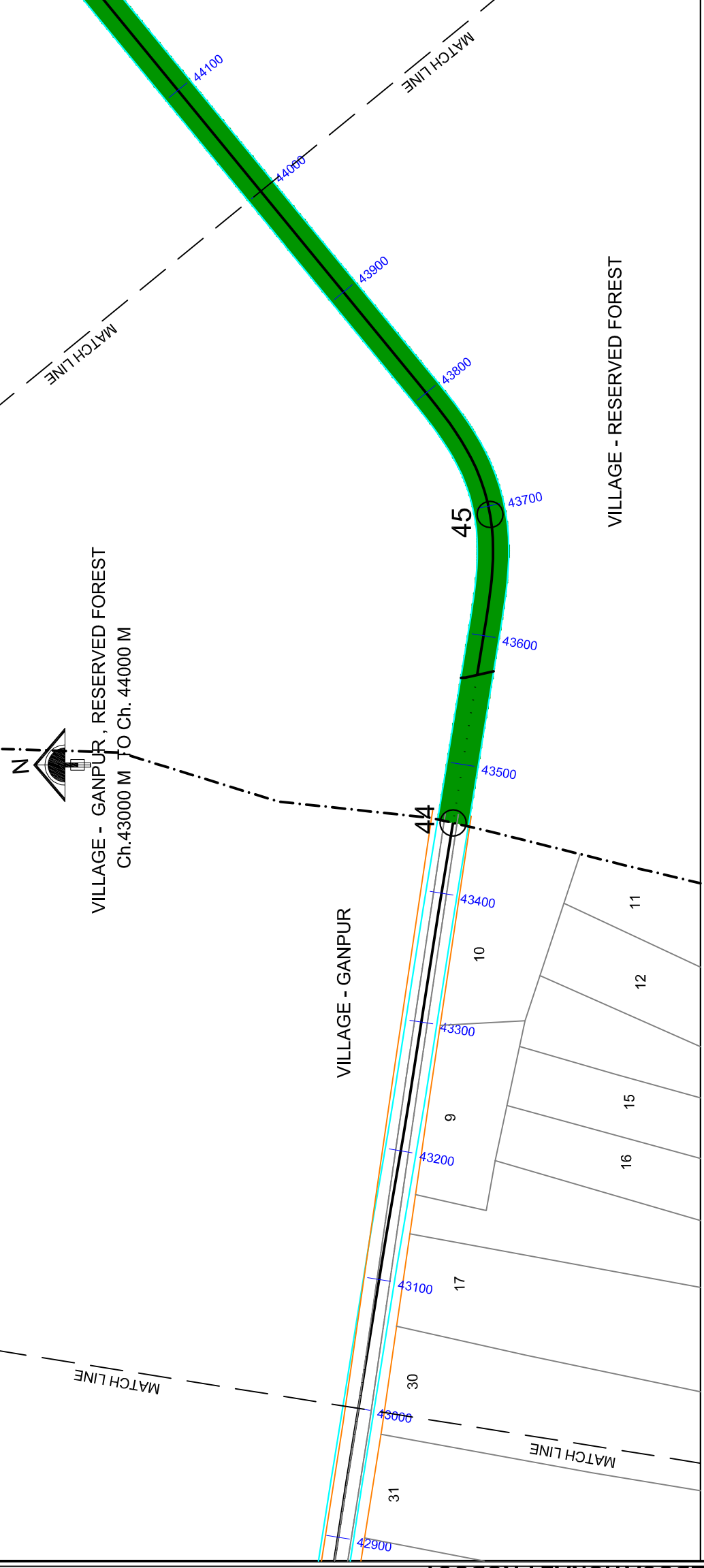

MINISTRY OF SHIPPING, ROAD TRANSPORT & HIGHWAYS GOV. OF INDIA
 NATIONAL HIGHWAY DIVISION, CHANDRAPUR
 NAME OF PROJECT :- UPGRADEATION OF NATIONAL HIGHWAY FROM BAMNI TO ASHTI
 NH -353 B SECTION BAMNI-KOTHARI-GONDDIPRI-ASHTI LENGTH 52 KM

CHAINAGE (33000M To 35000M)

LEGEND		
Sr. No.	SYMBOL	DESCRIPTION
1.		PROPOSED ROAD
3.		VILLAGE BOUNDARY
4.		STREAM, NALLA / RIVER
5.		KHASRA BOUNDARY, GAOTHAN
6.		COMPARTMENT FOREST
7.		RESERVE FOREST
8.		WILD LIFE BOUNDARY

Tah.- Dist.- St.-MAHARASHTRA

NAME OF VILLAGES IN SECTION RESERVED FOREST

VILLAGE BOUNDARY CO - ORDINATES DETAILS					
SR.NO.	CODE	EASTING	NORTHING	LATITUDE	LONGITUDE
1	47	353050.0304	2186246.446	79°35'50.498"	19°45'59.252"
2	48	353587.4341	2186160.573	79°36'8.985"	19°45'56.603"

NAME OF PLAN **ROAD PLAN**

SURVEYED & PREPARED BY

SOHAM FERRO MANGANESE Pvt. Ltd.
 OFFICE : Block No.17, Ground Floor,N.K.Y. Towers
 Ajani Square, Wardha Road,Nagpur 440015
 Ph. : (O) 0712-2252221, 2239964
 E-mail : sohamcad@rediffmail.com, soham.ferromagnese@gmail.com

SCALE (M) **1 : 4000** SHEET NO. **9/12**

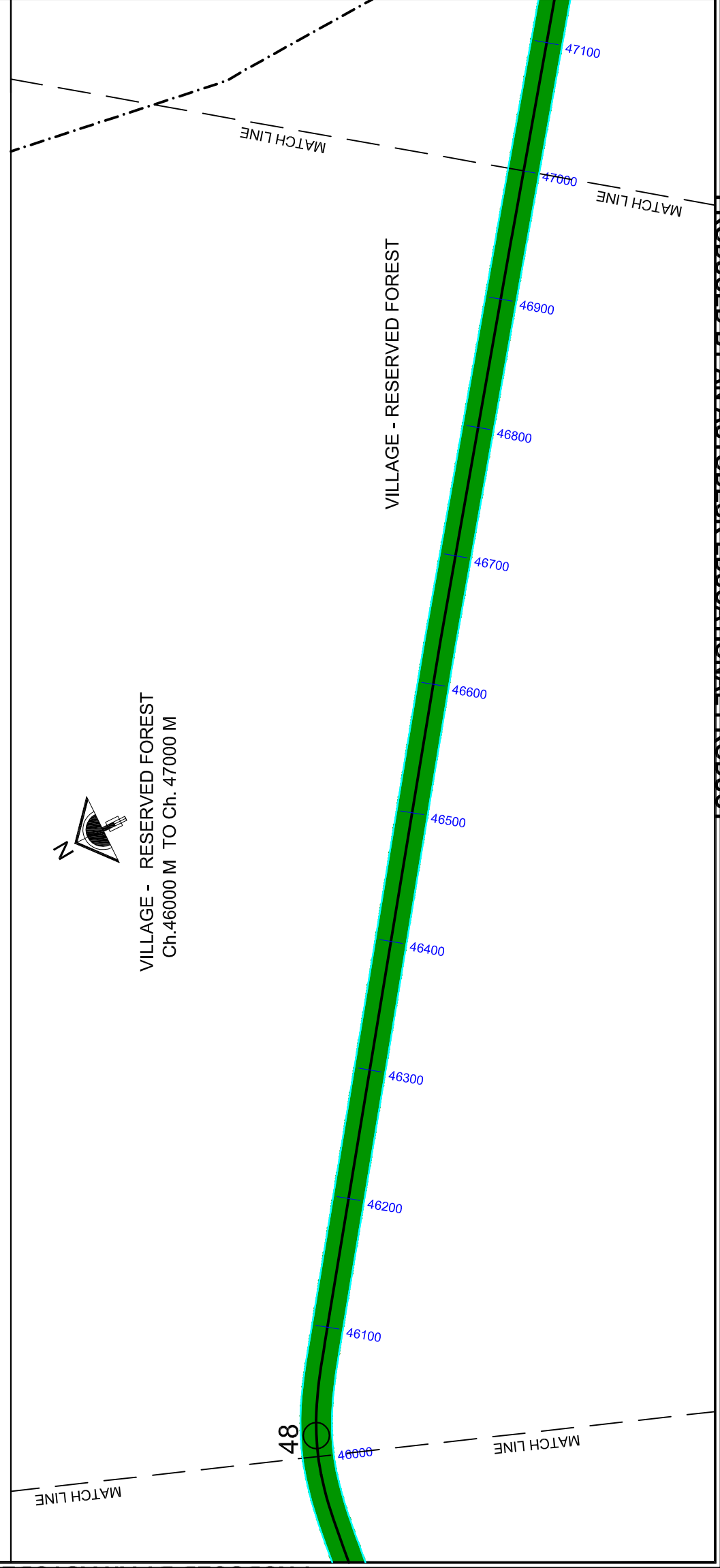
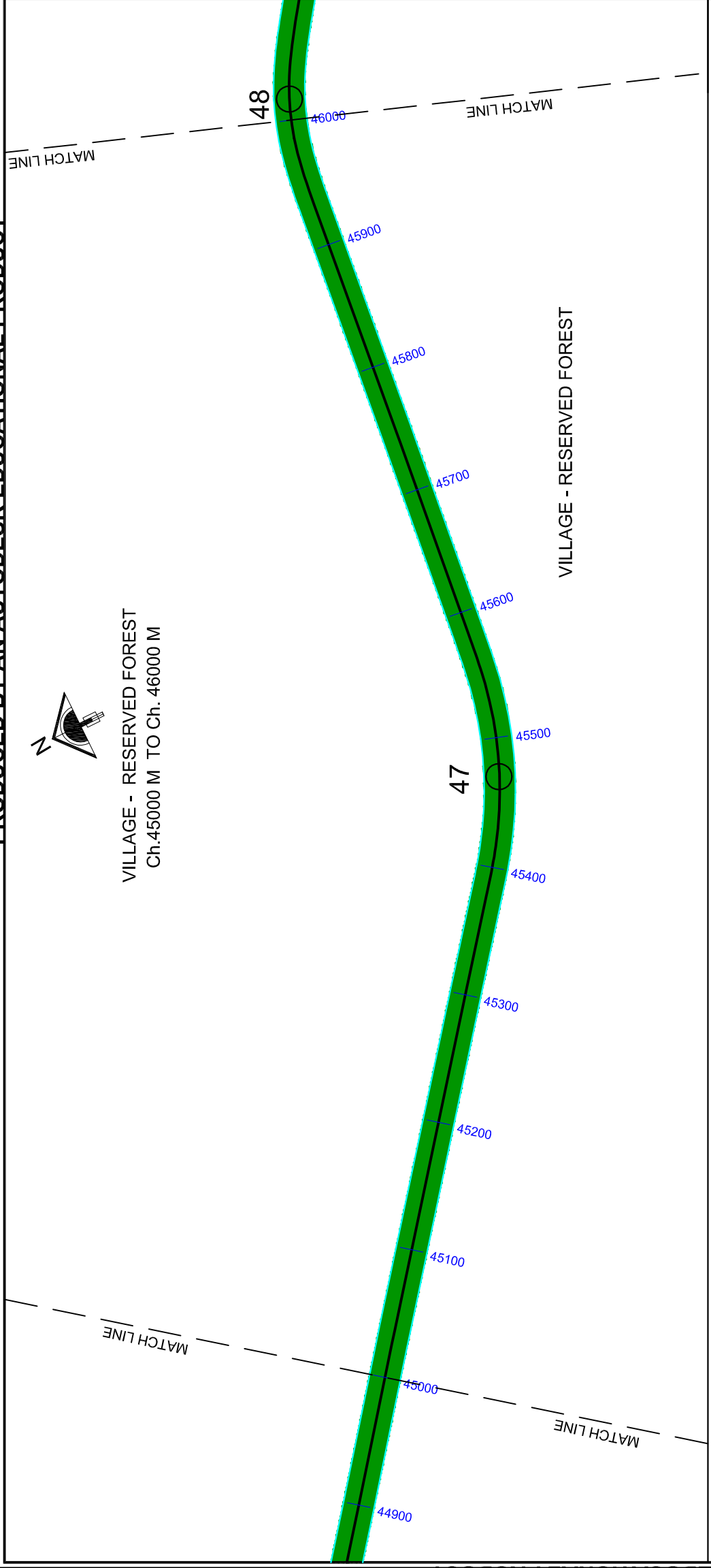

MINISTRY OF SHIPPING, ROAD TRANSPORT & HIGHWAYS GOV. OF INDIA
 NATIONAL HIGHWAY DIVISION, CHANDRAPUR
 NAME OF PROJECT :- UPGRADATION OF NATIONAL HIGHWAY FROM BAMHNI TO ASHTI
 NH -353 B SECTION BAMNI-KOTHARI-GONDPIPARI-ASHTI LENGTH 52 KM
 CHAINAGE (35000M To 37000M)

LEGEND

Sr. No.	SYMBOL	DESCRIPTION
1.		PROPOSED ROAD
3.		VILLAGE BOUNDARY
4.		STREAM, NALLA / RIVER
5.		KHASRA BOUNDARY, GAOTHAN
6.		COMPARTMENT FOREST
7.		RESERVE FOREST
8.		WILD LIFE BOUNDARY

Tab.-GONDPIPARI Dist.-CHANDRAPUR St.-MAHARASHTRA
 NAME OF VILLAGES IN SECTION RESERVED FOREST , AKSAPUR

VILLAGE BOUNDARY CO - ORDINATES DETAILS

SR.NO.	CODE	EASTING	NORTHING	LATITUDE	LONGITUDE
1	49	354572.2136	2185452.401	79°36'43.016"	19°45'33.835"
2	50	354739.8788	2185341.593	79°36'48.806"	19°45'30.276"
3	51	355906.4447	2185069.346	79°37'28.958"	19°45'21.733"

ROAD PLAN

NAME OF PLAN
 SURVEYED & PREPARED BY

 SOHAM FERRO MANGANEASE Pvt. Ltd.
 OFFICE : Block No.17, Ground Floor,N.K.Y. Towers
 Ajani Square, Wardha Road,Nagpur-440015
 Ph. : (O) 0712-2252221, 2239964
 E-mail : sohamcad@rediffmail.com, soham.ferromagnese@gmail.com

SCALE (M)	1 : 4000	SHEET NO.	10/12
-----------	----------	-----------	-------

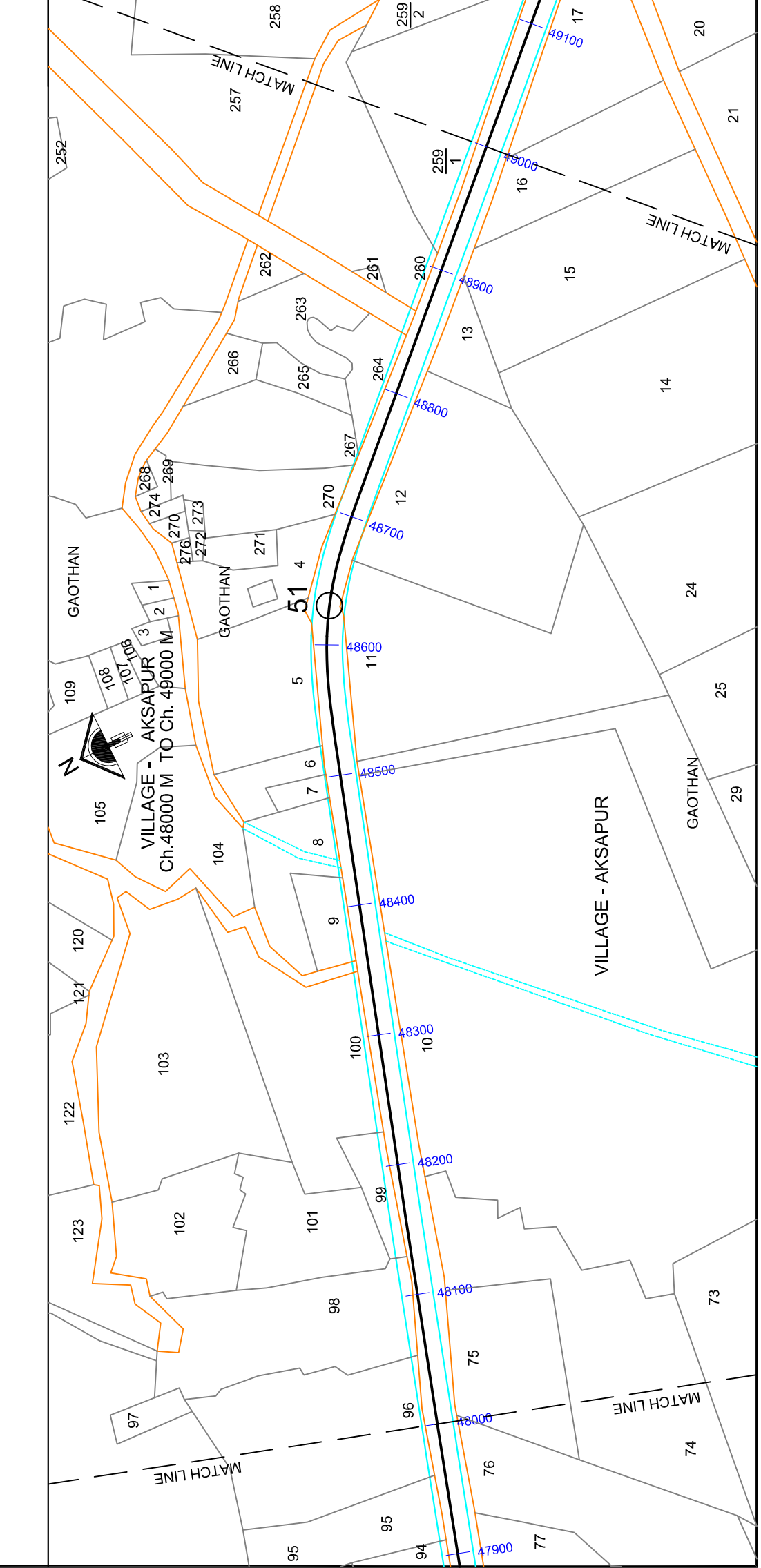
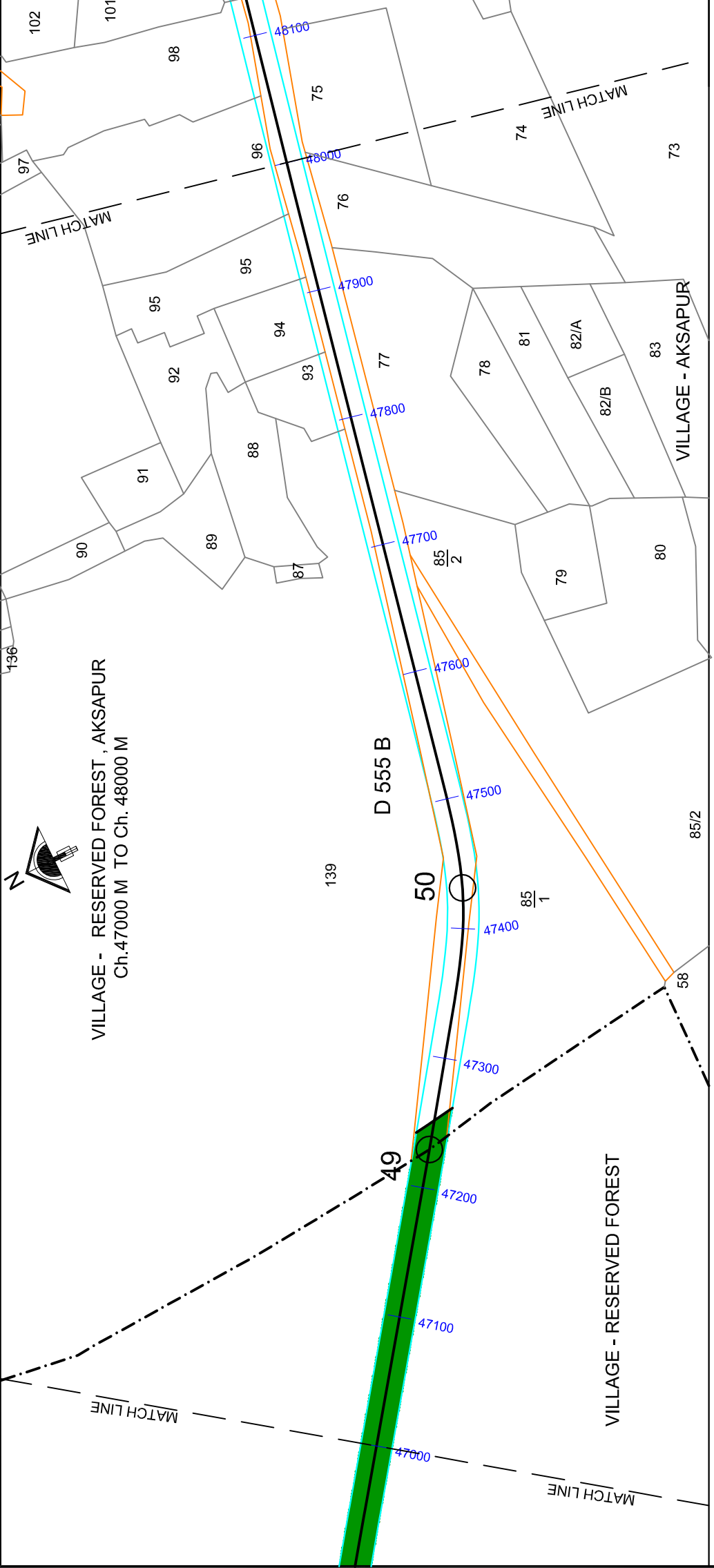

MINISTRY OF SHIPPING, ROAD TRANSPORT & HIGHWAYS GOV. OF INDIA
 NATIONAL HIGHWAY DIVISION, CHANDRAPUR
 NAME OF PROJECT :- UPGRADEATION OF NATIONAL HIGHWAY FROM BAMHNI TO ASHTI
 NH -353 B SECTION BAMNI-KOTHARI-GONDPAPRI-ASHTI LENGTH 52 KM

CHAINAGE (53000M To 55000M)

LEGEND

Sr. No.	SYMBOL	DESCRIPTION
1.		PROPOSED ROAD
3.		VILLAGE BOUNDARY
4.		STREAM, NALLA / RIVER
5.		KHASRA BOUNDARY, GAOTHAN
6.		COMPARTMENT FOREST
7.		RESERVE FOREST
8.		WILD LIFE BOUNDARY

Tab. -GONDPAPRI Dist. -CHANDRAPUR St. -MAHARASHTRA

NAME OF VILLAGES IN SECTION
 GHANPUR , CHAKRA VYANKATPUR ,RESERVED FOREST

VILLAGE BOUNDARY CO - ORDINATES DETAILS

SR.NO.	CODE	EASTING	NORTHING	LATITUDE	LONGITUDE
1	58	359686.1731	2182160.966	79°39'39.591"	19°43'48.122"
2	59	360011.6752	2181919.458	79°39'50.836"	19°43'40.351"
3	60	360593.4489	2181440.779	79°40'10.947"	19°43'24.931"

NAME OF PLAN
ROAD PLAN

SURVEIVED & PREPARED BY

SOHAM FERRO MANGANESE Pvt. Ltd.
 OFFICE : Block No.17, Ground Floor,N.K.Y. Towers
 Ajami Square, Wardha Road,Nagpur-440015
 Ph. : (O) 0712-2252221, 2239964
 E-mail : sohamcad@rediffmail.com, soham.ferromagnese@gmail.com

SCALE (M)
1 : 4000
 SHEET NO. **11/12**

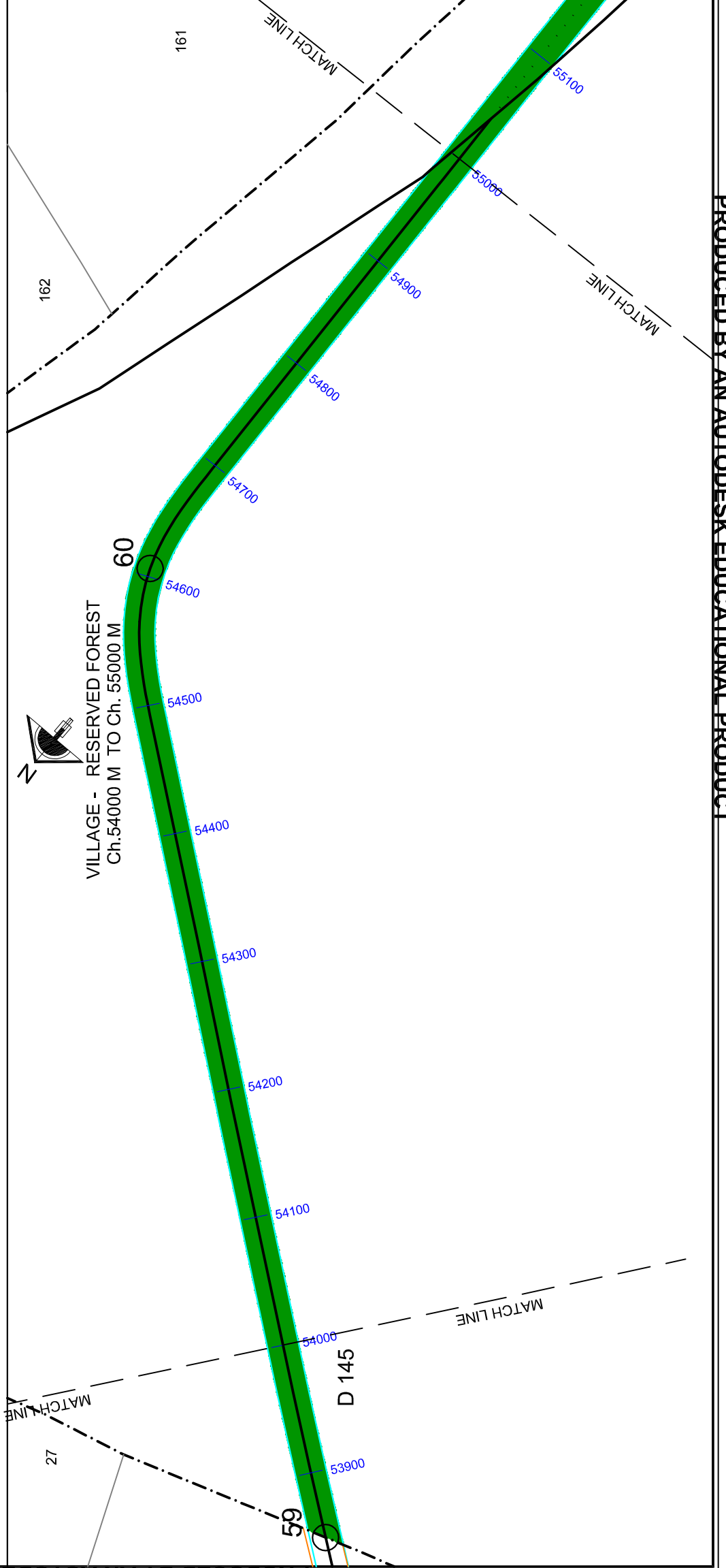
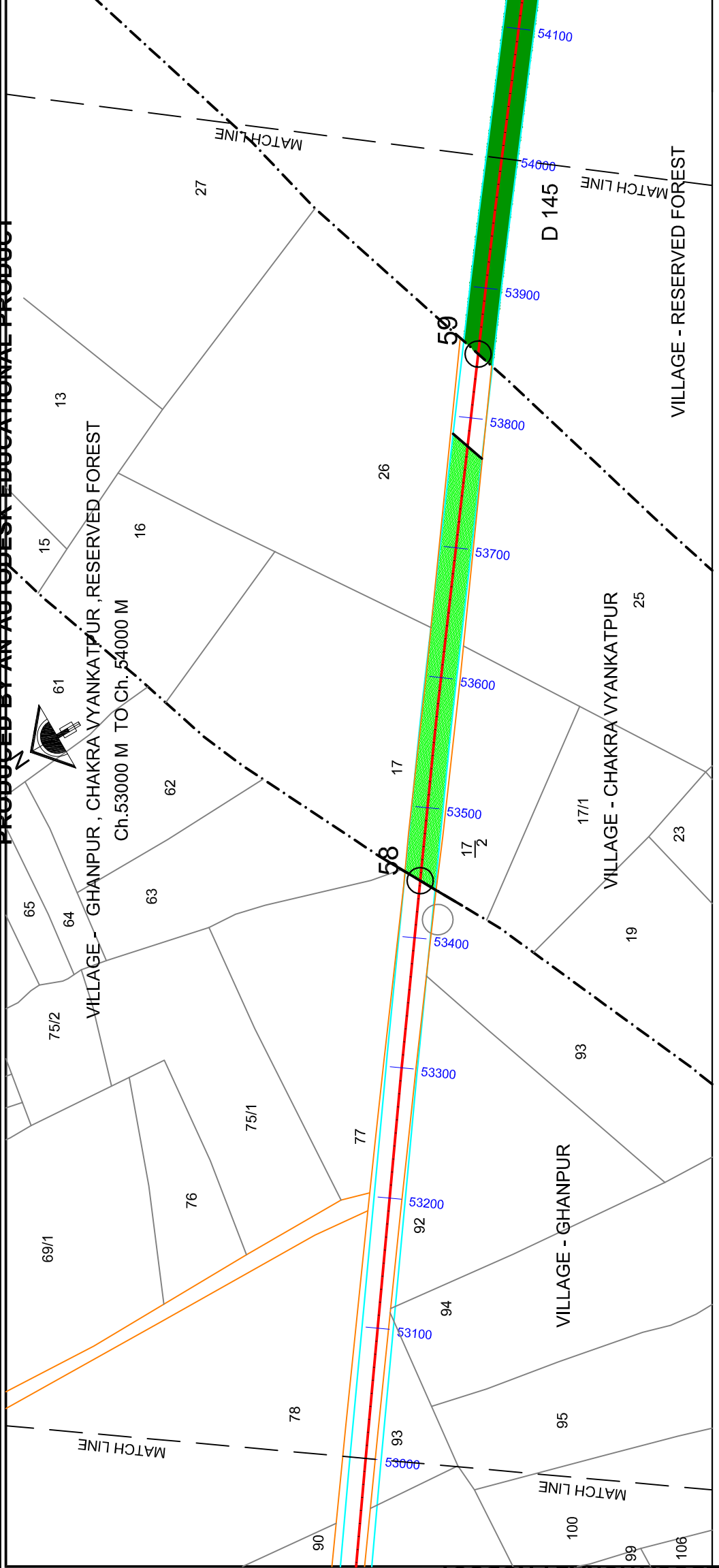

MINISTRY OF SHIPPING, ROAD TRANSPORT & HIGHWAYS GOV. OF INDIA
 NATIONAL HIGHWAY DIVISION, CHANDRAPUR
 NAME OF PROJECT :- UPGRADEATION OF NATIONAL HIGHWAY FROM BAMHNI TO ASHTI
 NH -353 B SECTION BAMNI-KOTHARI-GONDPIPRI-ASHTI LENGTH 52 KM

CHAINAGE (55000M To 57000M)

LEGEND

Sr. No.	SYMBOL	DESCRIPTION
1.		PROPOSED ROAD
3.		VILLAGE BOUNDARY
4.		STREAM, NALLA / RIVER
5.		KHASRA BOUNDARY, GAOTHAN
6.		COMPARTMENT FOREST
7.		RESERVE FOREST
8.		WILD LIFE BOUNDARY

Tah.- GONDPIPARI Dist.-CHANDRAPUR St.-MAHARASHTRA
 NAME OF VILLAGES IN SECTION
 RESERVED FOREST , GONDPIPARI

VILLAGE BOUNDARY CO - ORDINATES DETAILS					
SR.NO.	CODE	EASTING	NORTHING	LATITUDE	LONGITUDE
1	61	360639.9188	2180640.605	19°42'58.920"	79°40'12.759"
2	62	360683.6581	2180582.531	19°42'57.042"	79°40'14.277"
3	63	361926.0005	2180283.674	19°40'57.024"	79°40'57.637"

NAME OF PLAN
ROAD PLAN

SURVEYED & PREPARED BY

SOHAM FERRO MANGANEASE Pvt. Ltd.
 OFFICE : Block No.17, Ground Floor,N.K.Y. Towers
 Ajami Square, Wardha Road,Nagpur 440015
 Ph. : (O) 0712-2252221, 2239964
 E-mail : sohamcad@rediffmail.com, soham.ferromagnese@gmail.com

SCALE (M)
1 : 4000
 SHEET NO. **12/12**

