

Diversion of 1.6147 Hac. Of forest land for Construction of laying R.C.C. Box Type Drain along on Hisar-BaglaRoad, up to new NH 52 BY PASS HISAR

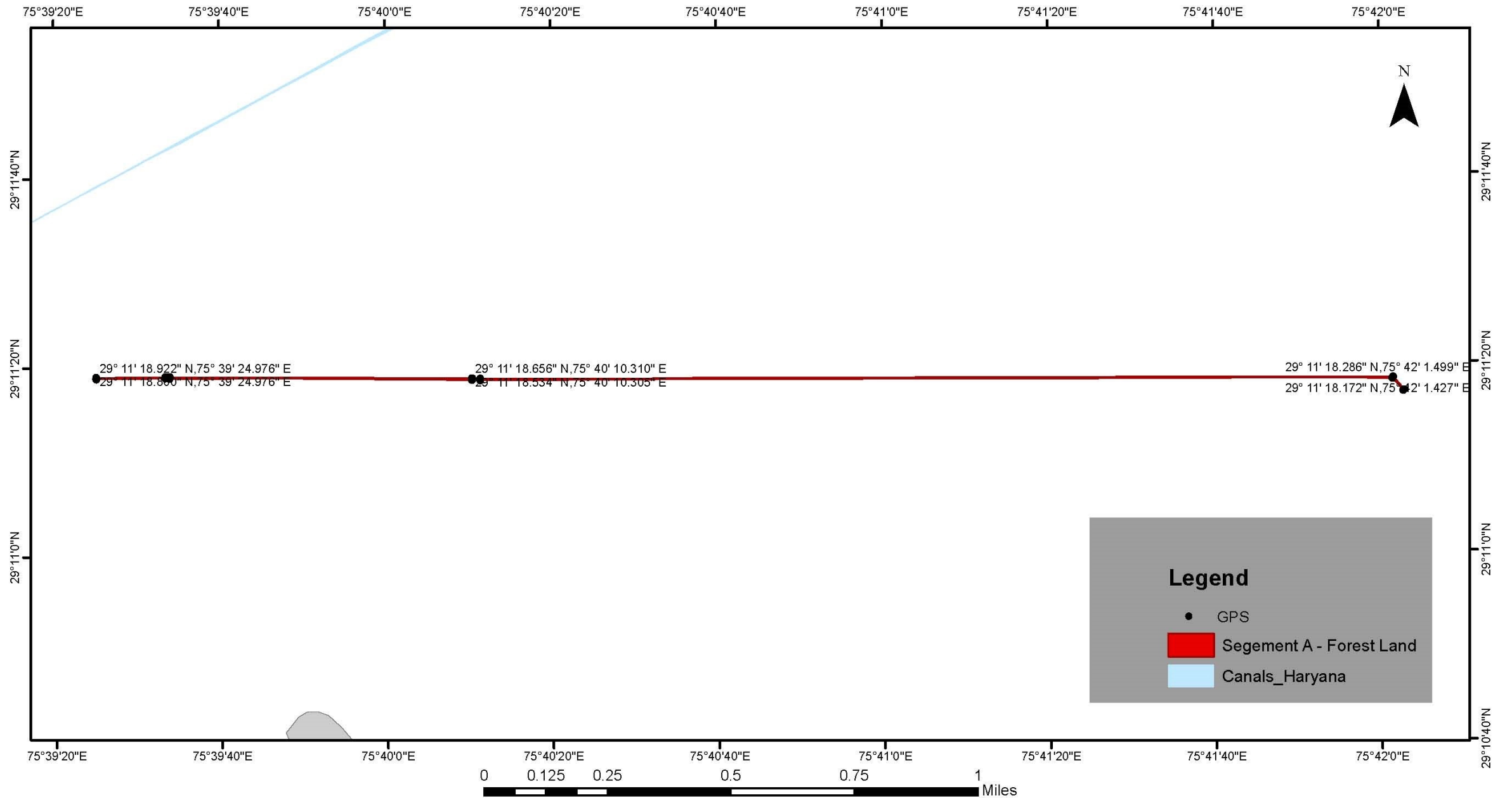

Diversion of 1.6147 Hac. Of forest land for Construction of laying R.C.C. Box Type Drain along on Hisar-BaglaRoad, up to new NH 52 BY PASS HISAR

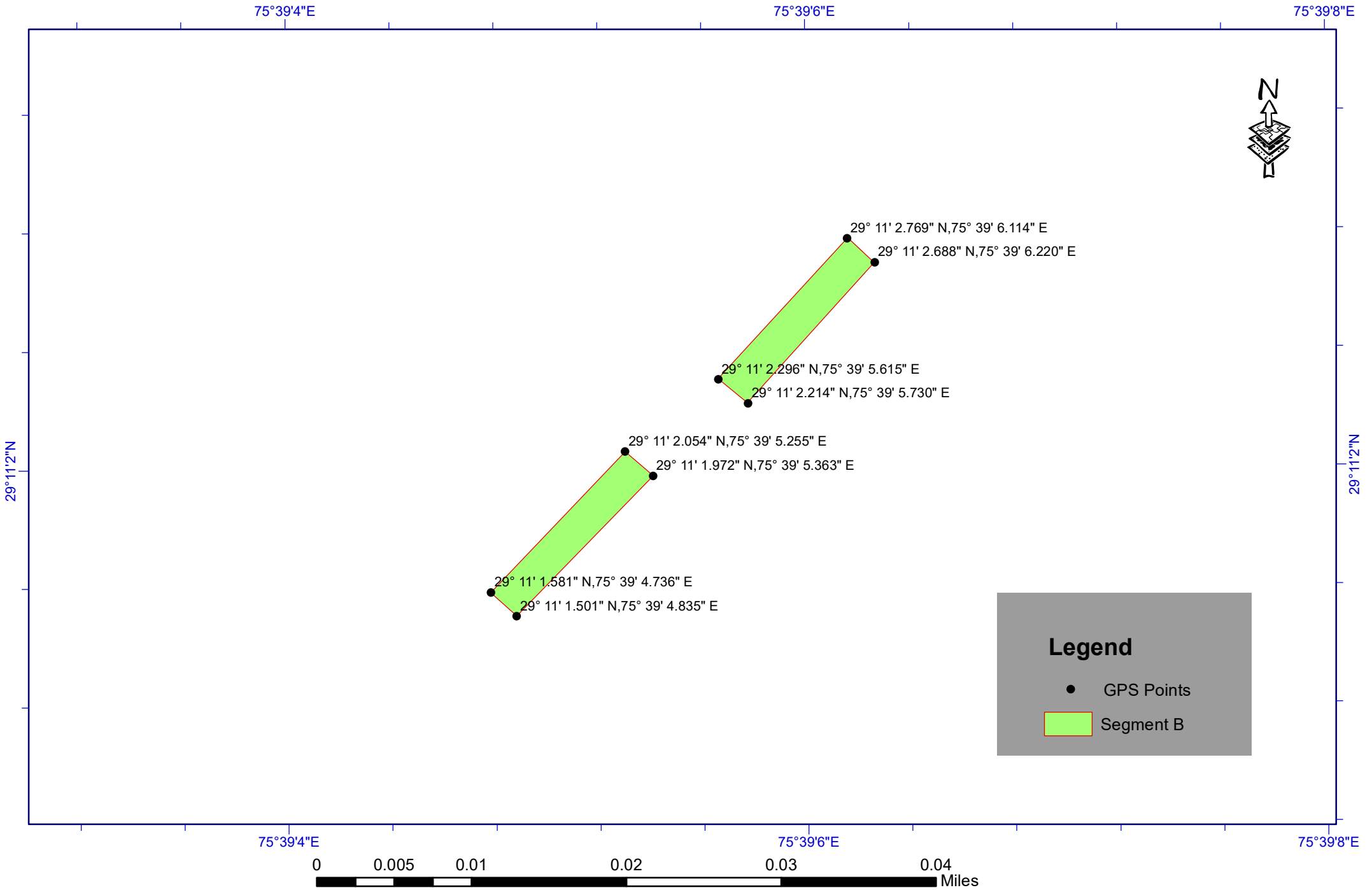

Diversion of 1.6147 Hac. Of forest land for Construction of laying R.C.C. Box Type Drain along on Hisar-BaglaRoad, up to new NH 52 BY PASS HISAR

