

CLIENT :



**GAIL (India) Limited.**

(A Govt. of India Undertaking - A Maharatna Company)  
7th Floor, Jubilee Tower, Sector-1, Noida- 201 301

PROJECT - **JAGADISHPUR - HALDIA & SPUR PIPELINE**

TITLE - **VIJAIPUR-AURAIYA-PHULPUR GAS PIPELINE**

**PROTECTED FOREST (District- PRATAPGARH - Uttar Pradesh)**

National Highway-31 (Raebareilly To Pratapgarh)

1/2

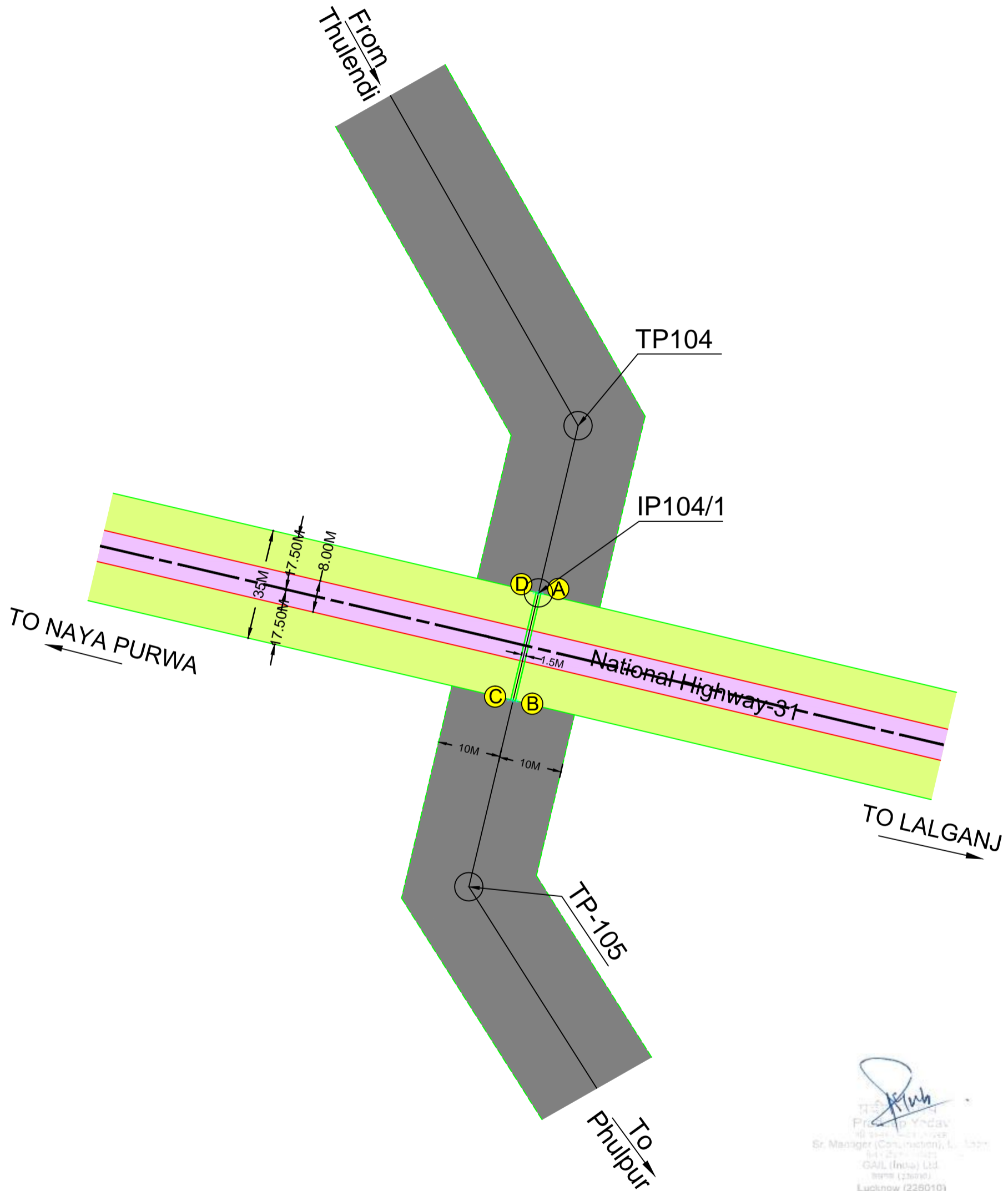

*[Signature]*  
Sr. Manager (Construction), GAIL (India) Ltd.  
Lucknow (226010)

**LEGEND**

	Forest Rou Coordinate		Existing Road
	Route of Proposed Pipeline		Existing Road Row
	TP,IP		
	Center Line of Road		

PROTECTED FOREST (District- PRATAPGARH - Uttar Pradesh)						
National Highway-31 (Raebareilly To Pratapgarh)						
Sr. No	Code	Co-Ordinates(WGS84)		Length (m)	Width (m)	Area Sq mt
		Latitude	Longitude			
1	A	25° 56' 35.42" N	81° 39' 31.80" E	35,000	1.5	52,500
	B	25° 56' 34.31" N	81° 39' 31.51" E			
	C	25° 56' 34.32" N	81° 39' 31.46" E			
	D	25° 56' 35.43" N	81° 39' 31.75" E			

LIST OF TP WITH GPS CO-ORDINATES		
TP No	WGS 84 Co ordinates	
	Latitude (N)	Longitude (E)
TP 104	81°39'32.297" N	25°56'37.164" E
IP 104/1	81°39'31.77" N	25°56'35.195" E
TP 105	81°39'31.023" N	25°56'32.407" E

N.T.S.

CLIENT :



# GAIL (India) Limited.

(A Govt. of India Undertaking - A Maharatna Company)  
7th Floor, Jubilee Tower, Sector-1, Noida- 201 301

PROJECT - JAGADISHPUR - HALDIA & SPUR PIPELINE

TITLE - VIJAIPUR-AURAIYA-PHULPUR GAS PIPELINE

**PROTECTED FOREST (District- PRATAPGARH - Uttar Pradesh)**  
Along Asphalted Road ( Lalganj To Kalakankar )

2/2

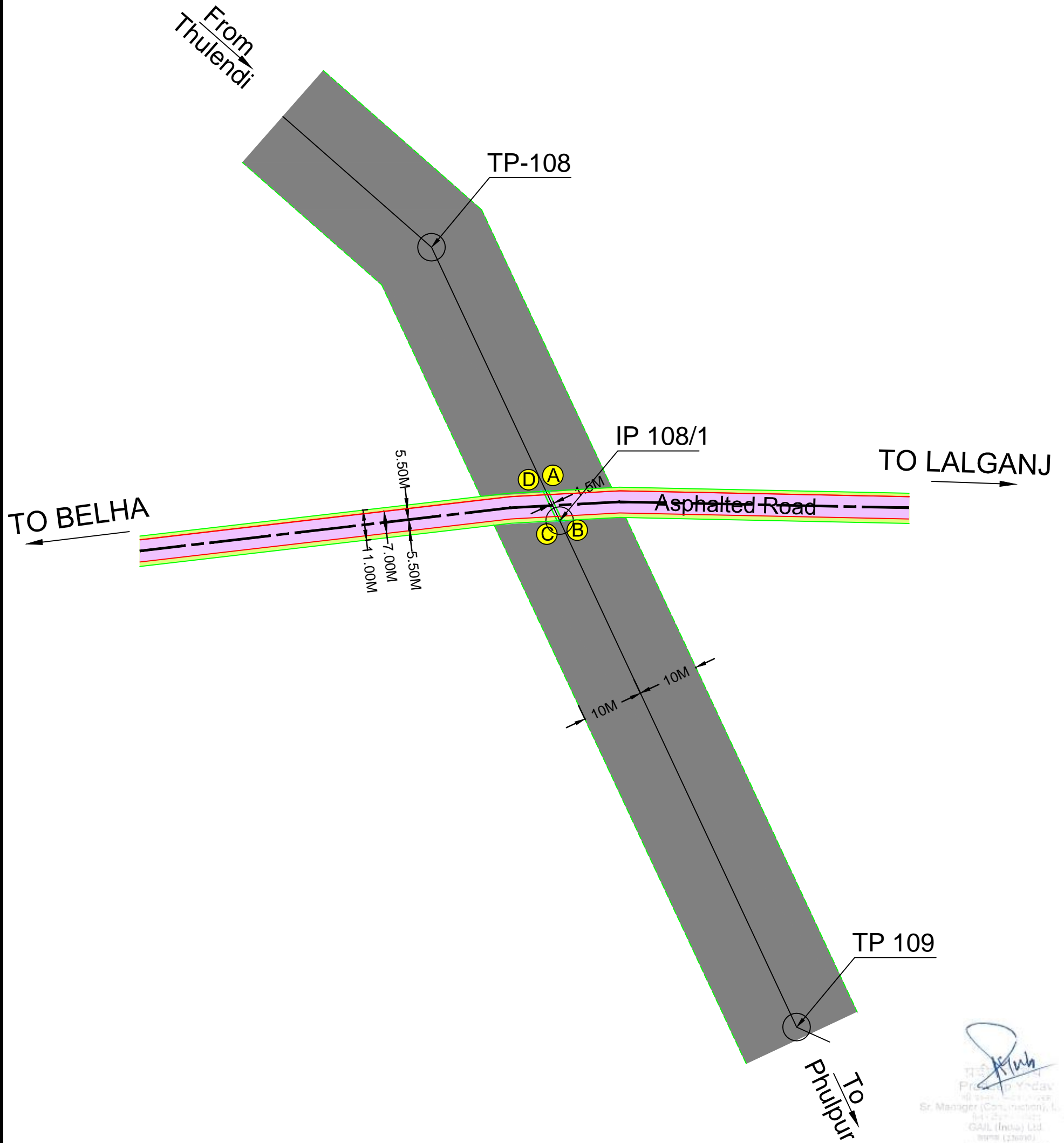
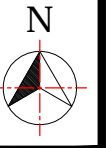

*[Signature]*  
Sr. Manager (Construction), GAIL (India) Ltd.  
Lucknow (226010)

LEGEND			
	Forest Rou Coordinate		Existing Road
	Route of Praposed Pipeline		Existing Road Row
	TP,IP		
	Center Line of Road		

PROTECTED FOREST (District- PRATAPGARH - Uttar Pradesh)						
Along Asphalted Road ( Lalganj To Kalakankar )						
Sr. No	Code	Co-Ordinates(WGS84)		Length (m)	Width (m)	Area Sq mt
		Latitude	Longitude			
2	A	25° 55' 45.79" N	81° 40' 22.61" E	10.661	1.5	15.992
	B	25° 55' 45.47" N	81° 40' 22.77" E			
	C	25° 55' 45.47" N	81° 40' 22.71" E			
	D	25° 55' 45.79" N	81° 40' 22.55" E			

LIST OF TP WITH GPS CO-ORDINATES		
TP No	WGS 84 Co ordinates	
	Latitude (N)	Longitude (E)
TP 108	81°40'21.309" N	25°55'48.401" E
IP 108/1	81°40'22.802" N	25°55'45.478" E
TP 109	81°40'25.551" N	25°55'40.096" E

N.T.S.