

pipe treated effluent Channel Sinhthala Road at Kulian Road to Village Sinhthala to Dholu to M.P. Sottar to Rangoli Induction Canal near Village-Chando Kalan.
 (FP/HR/Others/31522/2018)

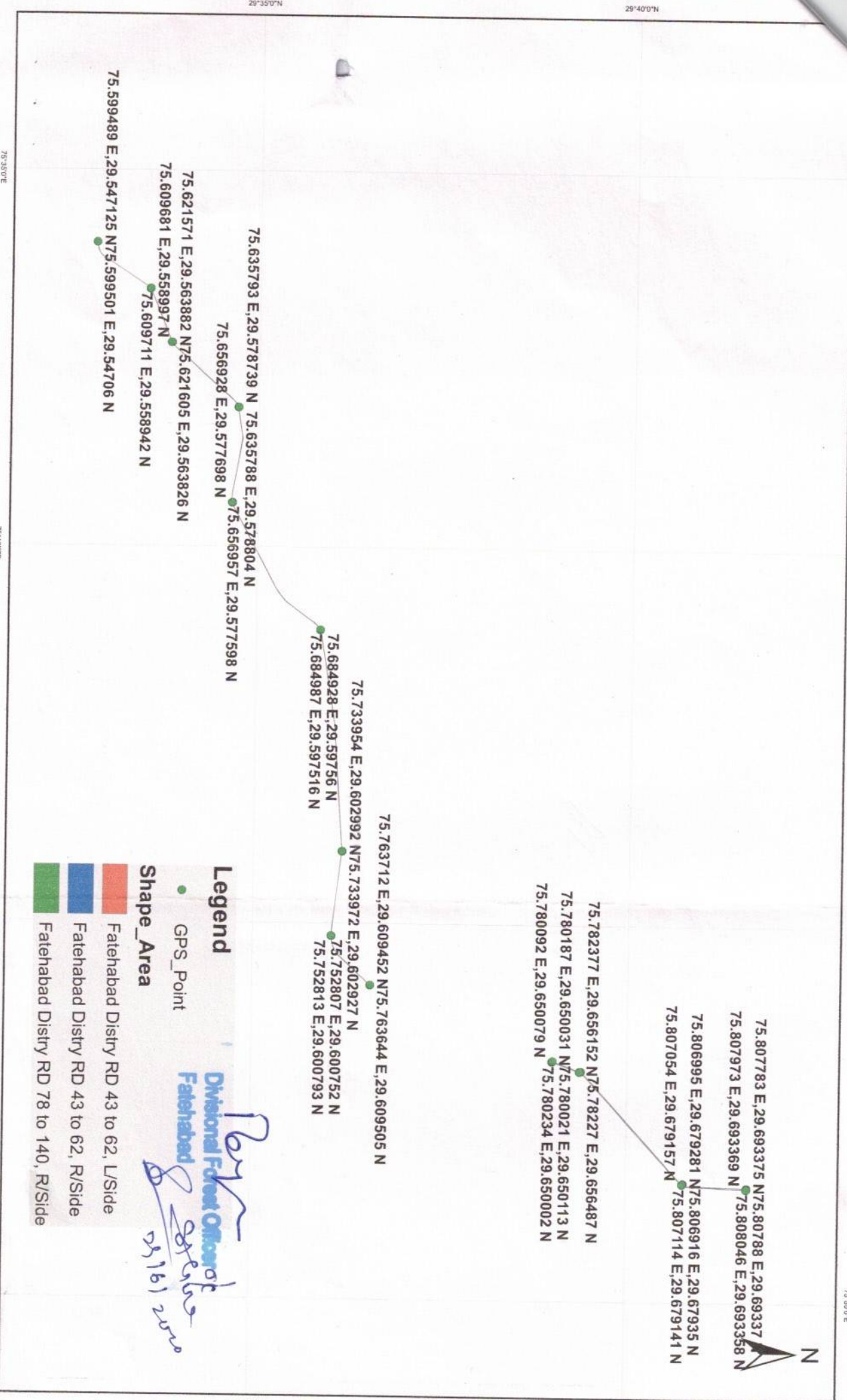

75.807783 E,29.693375 N
 75.807973 E,29.693369 N
 75.806995 E,29.679281 N
 75.807054 E,29.679157 N
 75.80788 E,29.69337
 75.808046 E,29.693358 N
 75.806916 E,29.67935 N
 75.807114 E,29.679141 N

75.782377 E,29.656152 N
 75.780187 E,29.650031 N
 75.780092 E,29.650079 N
 75.78227 E,29.656487 N
 75.780021 E,29.650113 N
 75.780234 E,29.650002 N

75.763712 E,29.609452 N
 75.733954 E,29.602992 N
 75.684928 E,29.59756 N
 75.684987 E,29.597516 N
 75.763644 E,29.609505 N
 75.733972 E,29.602927 N
 75.752807 E,29.600752 N
 75.752813 E,29.600793 N

75.635793 E,29.578739 N
 75.656928 E,29.577698 N
 75.621571 E,29.563882 N
 75.609681 E,29.558997 N
 75.609711 E,29.558942 N
 75.635788 E,29.578804 N
 75.656957 E,29.577598 N
 75.621605 E,29.563826 N
 75.599489 E,29.547125 N
 75.599501 E,29.54706 N

Legend

- GPS_Point
- Fatehabad Distry RD 43 to 62, L/Side
- Fatehabad Distry RD 43 to 62, R/Side
- Fatehabad Distry RD 78 to 140, R/Side

Handwritten signature and date:
 Divisional Forest Officer
 Fatehabad
 29/16/2020



75.350°E 75.400°E 75.450°E 75.500°E

29°35'0"N 29°40'0"N

29°35'0"N 29°40'0"N