

Map Showing DGPS Surveyed Co-ordinates and Boundary of Forest Area Proposed to be Diverted for M/s Larsen & Toubroltd. for Bauxite over 1813.29 Acre or 733.83 Hectare in Village-Chulbari Sheet5, Tahasil-Thuumulrampur, District-Kalahandi, Forest Division-Kalahandi, Odisha

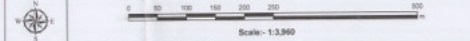

LEGEND

- Observation Point
- Forest Pillar
- Ml. Boundary Pillar
- Signal Ml. Boundary
- ▭ Patch Boundary
- ▭ Forest Plot

CO-ORDINATES OF SCOP/DGPS OBSERVATION POINT

DGPS OBSERVATION ID	EASTING	NORTHING	LATITUDE	LONGITUDE
6	72281.421	2151431.304	N19°20'56.9194"	E83°07'08.4251"
7	722033.443	2157972.981	N19°30'04.50742"	E83°06'06.25117"
72	721810.840	2158851.080	N19°30'48.82087"	E83°06'48.19805"
12	721208.058	2158440.371	N19°30'30.46310"	E83°06'28.22040"
8	721564.818	2158027.880	N19°30'18.63444"	E83°06'41.36582"
68	72482.880	2159142.030	N19°30'52.81757"	E83°07'12.28307"

CO-ORDINATES OF FOREST PILLAR

Forest Pillar ID	Eastng	Northng	Longitude	Latitude
Patch-33				
596	722488.662	2158344.109	83°07'12.10040"	19°30'23.306934"
597	722314.345	2158384.632	83°07'06.098665"	19°30'21.442285"
598	722080.316	2158774.015	83°06'58.324156"	19°30'40.697949"
599	722483.546	2158837.072	83°07'12.176937"	19°30'42.586101"
Patch-34				
600	721579.742	2158324.971	83°06'40.971378"	19°30'26.299412"
601	721581.764	2158221.491	83°06'40.997048"	19°30'22.934297"
602	721707.974	2158224.880	83°06'45.325728"	19°30'22.993667"
603	722087.912	2157957.115	83°06'58.226364"	19°30'13.167380"
604	722091.024	2157642.185	83°06'58.212466"	19°30'03.896788"
605	721905.856	2157753.905	83°06'51.910793"	19°30'07.570000"
606	721724.159	2157940.302	83°06'45.760400"	19°30'13.735390"
607	721526.735	2158072.557	83°06'38.047475"	19°30'18.114241"
608	721468.123	2158130.741	83°06'37.062475"	19°30'20.029357"
609	721391.870	2158203.929	83°06'34.478913"	19°30'22.439321"
610	721308.759	2158282.615	83°06'31.939797"	19°30'25.031555"
611	721242.742	2158368.811	83°06'29.435414"	19°30'27.859511"
612	721108.406	2158452.861	83°06'28.293556"	19°30'30.605844"
613	721288.159	2158535.479	83°06'31.063861"	19°30'33.260337"

Area Statement:-

Patch No	Roll Plot No	Tenant Name	Land Schedule Proposed Area		DGPS Surveyed Area	
			Area in Acre	Area in Hectare	Area in Acre	Area in Hectare
Patch-33	405(P)	Abada Ajyoga Anabadi	45.60	18.536	44.04	17.824
Patch-34	410(P)	Abada Ajyoga Anabadi	58.60	22.987	56.85	22.912
Total Area			102.60	41.52	100.91	40.84



Certified that this map has been finally framed and a copy of it has been finally published in accordance with rule 29 read with rule 6D of O. S. & S. Rules 1962 on 18th DEC 1992.

[Signature]
Settlement Officer.

ମୌଜା ଚୁଲବାରୀ, ପିଟ ନଂ ୫
 ଥାନା ଥୁମୁଲରାମ୍ପୁର ନଂ ୨୦୫
 ଚକ୍ରବର୍ତ୍ତୀ ସ୍ୱାଧୀନତା ଦିନ ପୂର୍ବରୁ ନଂ ୨୦୫
CHULBARI, SHEET No 5
 Thana Thuumul Rampur No 205
ଜିଲ୍ଲା କଳାହାଣ୍ଡି
 ଚକ୍ର ୧୦୮-୧୯୯୭
 Scale 1:13,960
 Year 1992-93

- ସୂଚନା**
- ୧. ପ୍ରାୟୋଗୀ ... △
 - ୨. ଚକ୍ରପ୍ରାୟୋଗୀ ... ○
 - ୩. ଚକ୍ରପ୍ରାୟୋଗୀର ଉପସ୍ଥଳ ... ⊕
 - ୪. ଚକ୍ରପ୍ରାୟୋଗୀର ସୀମା ... ⊕

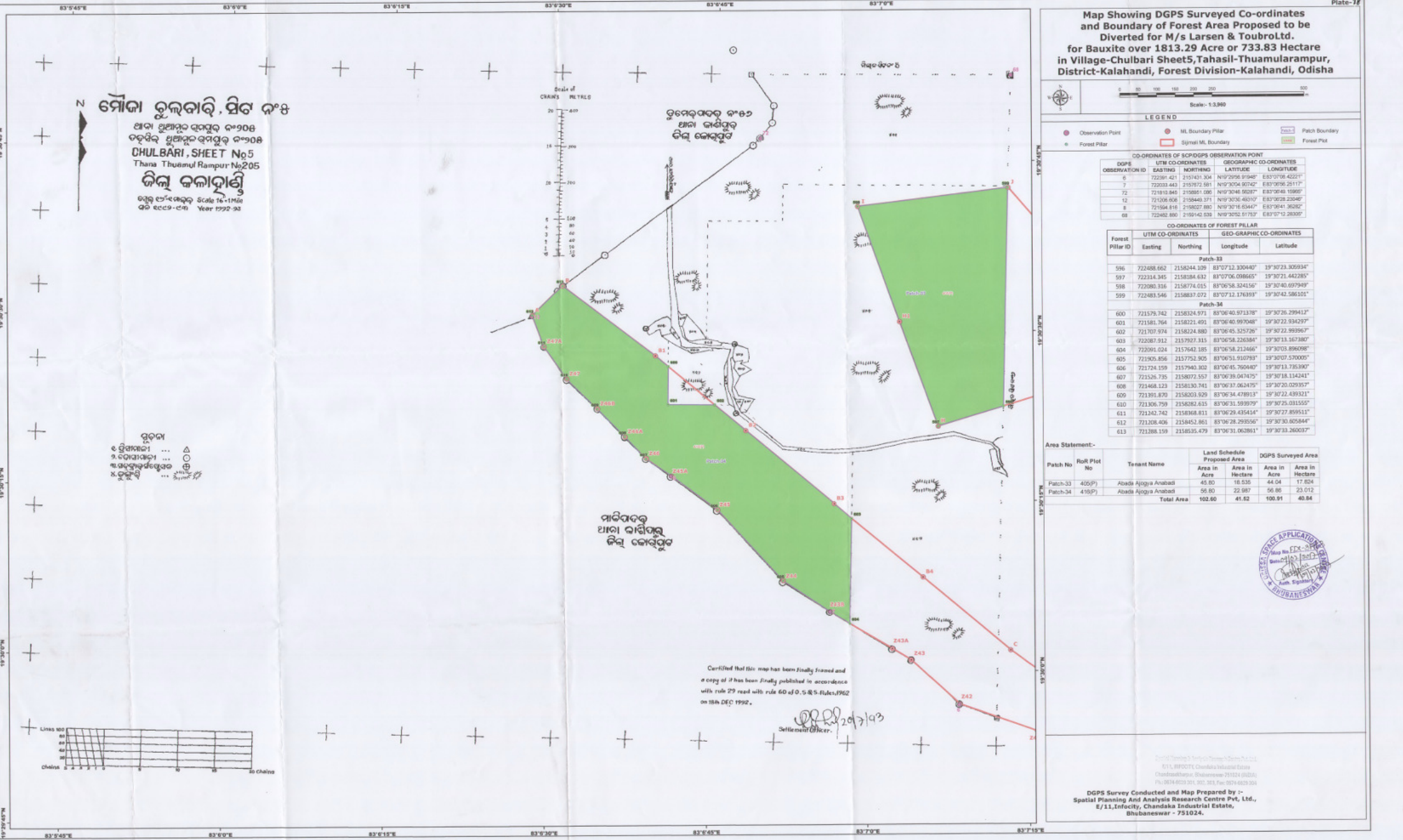

Map Showing DGPS Surveyed Co-ordinates and Boundary of Forest Area Proposed to be Diverted for M/s Larsen & Toubro Ltd. for Bauxite over 1813.29 Acre or 733.83 Hectare in Village-Chulbari Sheet6, Tahasil-Thuamularampur, District-Kalahandi, Forest Division-Kalahandi, Odisha

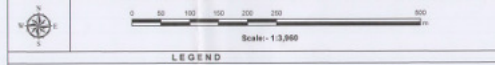

LEGEND

- Observation Point
- Ml. Boundary Pillar
- Forest Pillar
- Sijmal Ml. Boundary
- ▭ Patch Boundary
- ▭ Forest Plot

CO-ORDINATES OF SCIP/DGPS OBSERVATION POINT

DGPS OBSERVATION ID	UTM CO-ORDINATES EASTING	NORTHING	GEOGRAPHIC CO-ORDINATES LONGITUDE	LATITUDE
66	722485.480	2157942.630	N19°29'52.9193"	83°07'12.3930"
3	722921.637	2167405.980	N19°29'57.3460"	83°07'26.6059"
64	722386.101	2159150.867	N19°30'52.5804"	83°07'29.5094"
5	722602.077	2157364.538	N19°29'54.0569"	83°07'15.1874"
1	722052.053	2156003.596	N19°30'21.8713"	83°07'38.5304"
93	723871.488	2160805.100	N19°30'44.7280"	83°07'58.8022"

CO-ORDINATES OF FOREST PILLAR

Forest Pillar ID	UTM CO-ORDINATES		GEO-GRAPHIC CO-ORDINATES	
	Easting	Northing	Longitude	Latitude
Patch-35				
614	722484.261	2157400.528	83°07'11.934900"	19°29'55.877604"
615	722492.871	2157609.860	83°07'11.975999"	19°30'02.683600"
616	722865.396	2157394.084	83°07'21.648378"	19°29'54.543511"
617	722790.438	2157813.868	83°07'21.772668"	19°30'09.847024"
618	723124.292	2157817.860	83°07'31.720875"	19°30'09.842435"
619	723117.433	2157767.212	83°07'31.455698"	19°30'07.548337"
620	723001.980	2157542.538	83°07'29.402006"	19°30'07.290354"
621	722928.977	2157450.781	83°07'26.688766"	19°29'57.338626"
622	722814.357	2157270.403	83°07'22.854004"	19°29'51.518374"
623	722607.976	2157364.464	83°07'15.818327"	19°29'54.659422"

Area Statement:-

Patch No	Roll Plot No	Tenant Name	Lead Schedule Proposed Area		DGPS Surveyed Area	
			Area in Acre	Area in Hectare	Area in Acre	Area in Hectare
Patch 35	438P	Abaka Ajogya Anabadi	33.75	13.65	35.59	14.56
Total Area			33.75	13.66	35.59	14.56



Certified that this map has been finally framed and a copy of it has been finally published in accordance with rule 29 read with rule 60 of O.S.R. Rules, 1962 on 14th DEC 1992.

(Signature)
Settlement Officer

DGPS Survey Conducted and Map Prepared by :-
Spatial Planning And Analysis Research Centre Pvt. Ltd.,
8/11, Infocity, Chandaka Industrial Estate,
Bhubaneswar - 751024.

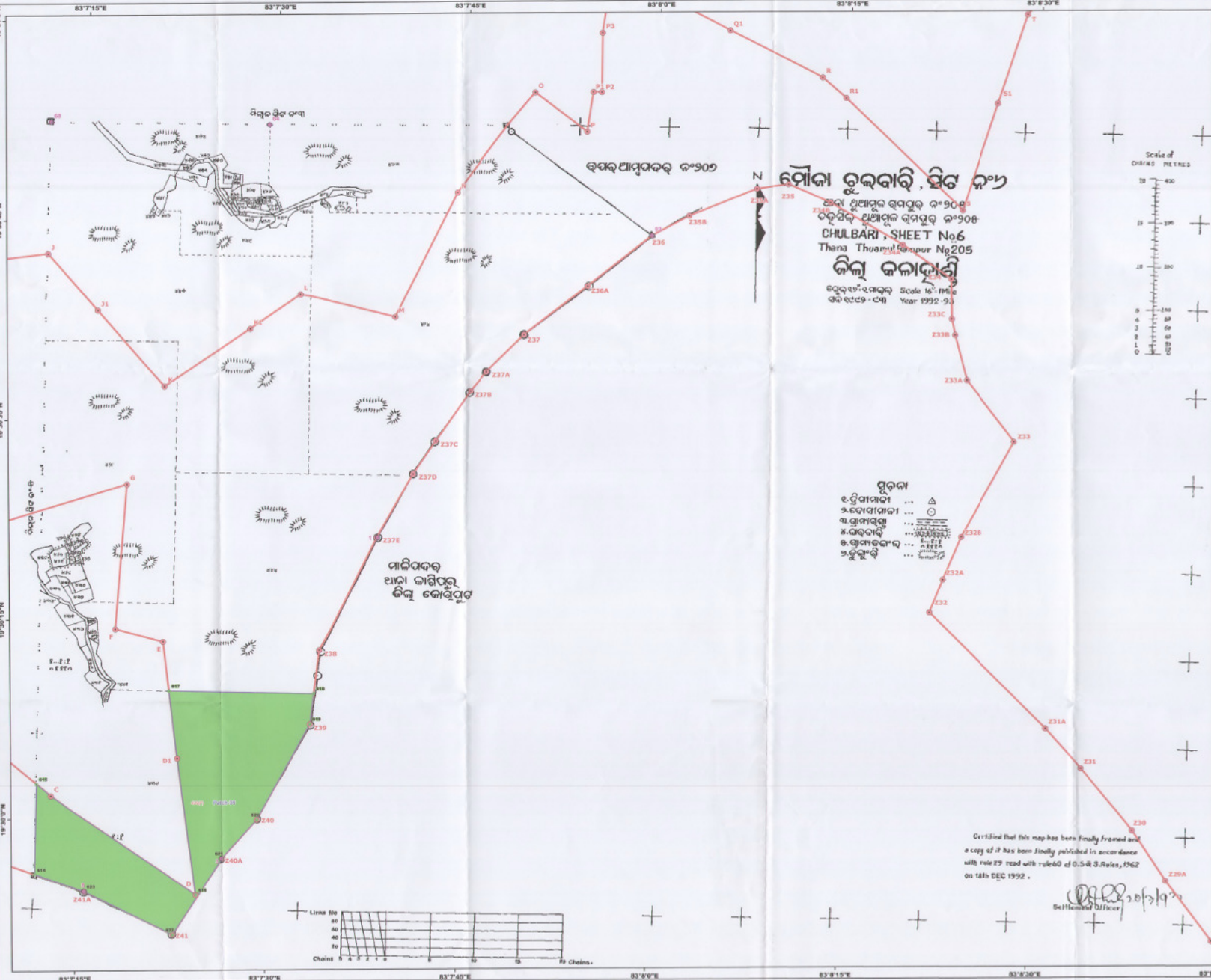

Map Showing DGPS Surveyed Co-ordinates and Boundary of Forest Area Proposed to be Diverted for M/s Larsen & Toubrol Ltd. for Bauxite over 1813.29 Acre or 733.83 Hectare in Village-Chulbari Sheet5, Tahasil-Thuumulrampur, District-Kalahandi, Forest Division-Kalahandi, Odisha

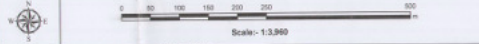

LEGEND

- Observation Point
- Forest Pillar
- Ml. Boundary Pillar
- Signal Ml. Boundary
- ▭ Patch Boundary
- ▭ Forest Plot

CO-ORDINATES OF SCOP/DGPS OBSERVATION POINT

DGPS OBSERVATION ID	EASTING	NORTHING	LATITUDE	LONGITUDE
6	72281.421	2151431.304	N19°20'56.9194"	E83°07'08.4221"
7	722033.443	2157972.981	N19°30'04.50742"	E83°06'06.25117"
72	721810.840	2158851.080	N19°30'48.82087"	E83°06'48.19805"
12	721208.058	2158440.371	N19°30'30.46310"	E83°06'28.22040"
8	721564.818	2158027.880	N19°30'18.63449"	E83°06'41.36382"
68	72482.880	2159142.030	N19°30'52.81757"	E83°07'12.28307"

CO-ORDINATES OF FOREST PILLAR

Forest Pillar ID	Eastng	Northng	Longitude	Latitude
Patch-33				
596	722488.662	2158344.109	83°07'12.10040"	19°30'23.306934"
597	722314.345	2158384.632	83°07'06.098665"	19°30'21.442285"
598	722080.316	2158774.015	83°06'58.324156"	19°30'40.697949"
599	722483.546	2158837.072	83°07'12.176939"	19°30'42.586101"
Patch-34				
600	721579.742	2158324.971	83°06'40.971378"	19°30'26.299412"
601	721581.764	2158221.491	83°06'40.997048"	19°30'22.934297"
602	721707.974	2158224.880	83°06'45.325728"	19°30'22.993667"
603	722087.912	2157957.115	83°06'58.226364"	19°30'13.167380"
604	722091.024	2157642.185	83°06'58.212466"	19°30'03.896798"
605	721905.856	2157753.905	83°06'51.910793"	19°30'07.570000"
606	721724.159	2157940.302	83°06'45.760400"	19°30'13.735390"
607	721526.735	2158072.557	83°06'38.047475"	19°30'18.114241"
608	721468.123	2158130.741	83°06'37.062475"	19°30'20.029357"
609	721391.870	2158203.929	83°06'34.478913"	19°30'22.439321"
610	721308.759	2158282.615	83°06'31.939797"	19°30'25.031555"
611	721242.742	2158368.811	83°06'29.435414"	19°30'27.859511"
612	721208.406	2158452.861	83°06'28.293556"	19°30'30.605844"
613	721288.159	2158535.479	83°06'31.063861"	19°30'33.260337"

Area Statement:-

Patch No	Roll Plot No	Tenant Name	Land Schedule Proposed Area		DGPS Surveyed Area
			Area in Acre	Area in Hectare	
Patch-33	405(P)	Abada Ajyoga Anabadi	45.60	18.536	44.04
Patch-34	410(P)	Abada Ajyoga Anabadi	56.60	22.887	56.85
Total Area			102.60	41.42	100.91



Certified that this map has been finally framed and a copy of it has been finally published in accordance with rule 29 read with rule 6D of O. S. & S. Rules 1962 on 18th DEC 1992.

[Signature]
Settlement Officer.

ମୌଜା ଚୁଲବାରୀ, ପିଟ ନଂ ୫
 ଥାନା ଥୁଆମୁଲରାମ୍ପୁର ନଂ ୨୦୫
 ଚକ୍ରବର୍ତ୍ତୀ ସ୍ୱାଧୀନତା ଦିନ ପୂର୍ବରୁ ନଂ ୨୦୫
CHULBARI, SHEET No 5
 Thana Thuumul Rampur No 205
ଜିଲ୍ଲା କଳାହାଣ୍ଡି
 ଚକ୍ର ୧୦୯-୧୯୯୭
 Scale 1:61,000
 Year 1992-93

- ସୂଚନା**
- ୧. ପ୍ରାନ୍ତସୀମା ...
 - ୨. ଚାକରାସୀମା ...
 - ୩. ଗଣନାକାର୍ଯ୍ୟକ୍ଷେତ୍ର ...
 - ୪. ଚୁଲବାରୀ ...

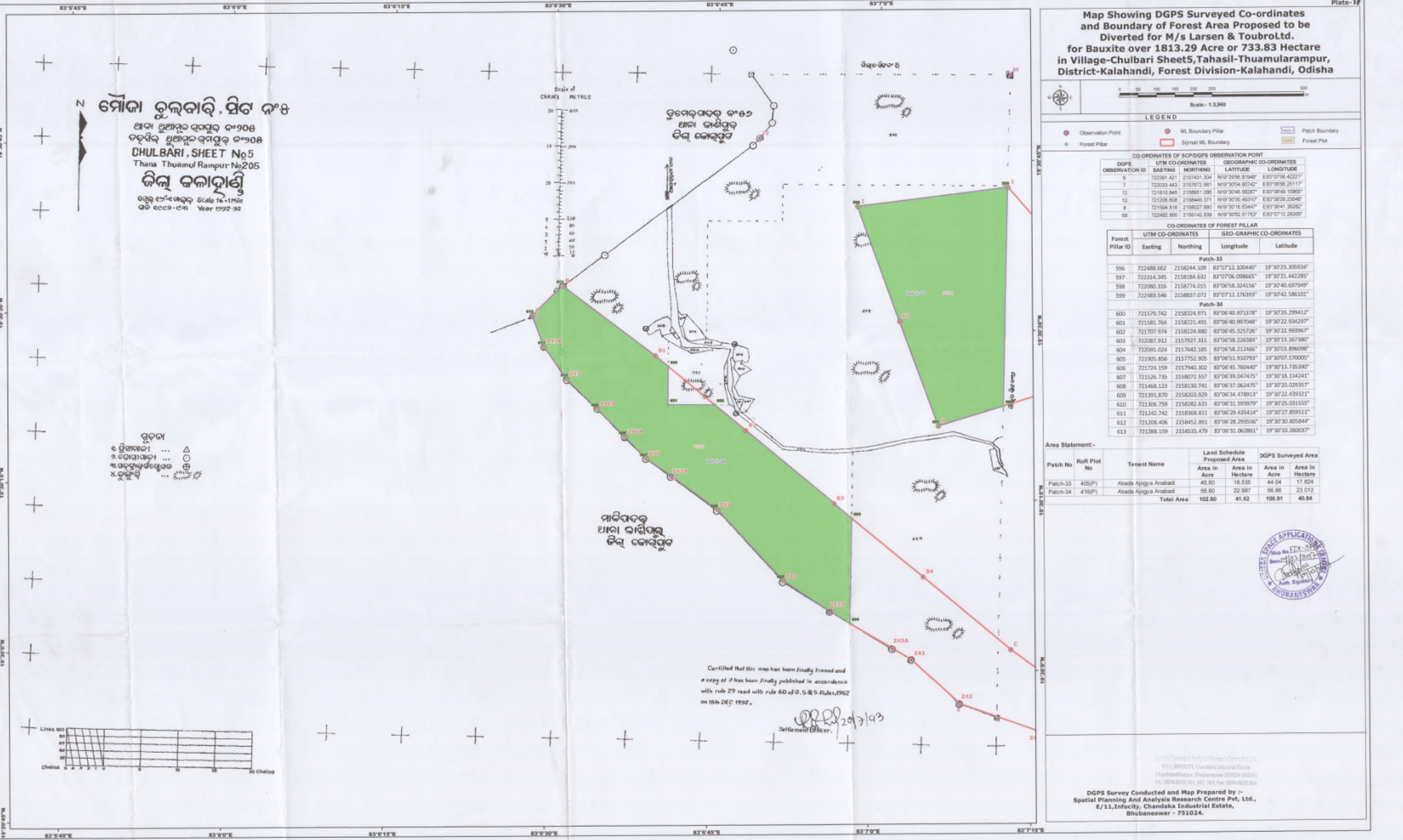

Map Showing DGPS Surveyed Co-ordinates and Boundary of Forest Area Proposed to be Diverted for M/s Larsen & Toubro Ltd. for Bauxite over 1813.29 Acre or 733.83 Hectare in Village-Tijamali Sheet 2, Thausil-Thumularampur, District-Kalahandi, Forest Division-Kalahandi, Odisha

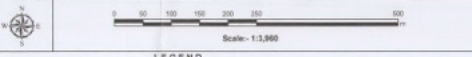

LEGEND

- Observation Point
- M. Boundary Pillar
- Forest Pillar
- Signal M. Boundary
- ▭ Patch Boundary
- Forest Plot

CO-ORDINATES OF SCDGPS OBSERVATION POINT

DGPS OBSERVATION ID	EASTING	NORTHING	LATITUDE	LONGITUDE
23	725205.088	2156881.815	N19°30'56.7606"	E83°18'45.23899"
25	725205.088	2156881.899	N19°30'56.76240"	E83°18'45.23933"
39	724981.354	2156785.111	N19°30'38.0807"	E83°18'23.48119"
42	724981.088	2156553.242	N19°30'56.71176"	E83°18'32.49782"
54	725881.055	2156295.172	N19°30'56.22388"	E83°18'36.71382"
78	725194.383	2156780.702	N19°31'11.53326"	E83°18'44.21538"

CO-ORDINATES OF FOREST PILLAR

Forest Pillar ID	UTM CO-ORDINATES		GEO-GRAPHIC CO-ORDINATES	
	Eastings	Northings	Longitude	Latitude
Patch-4				
123	725397.483	2159575.332	83°E 52.4029128"	19°31' 5.085332"
124	725402.336	2159593.956	83°E 52.5769512"	19°31' 6.9120560"
125	725460.726	2159594.236	83°E 52.5769760"	19°31' 5.9150068"
126	725651.084	2159509.970	83°E 51.1388968"	19°31' 1.7893916"
127	725628.219	2159488.178	83°E 0.27648"	19°31' 2.4820672"
128	725614.217	2159452.423	83°E 59.783012"	19°31' 1.324332"
129	725605.882	2159425.720	83°E 59.4789884"	19°31' 0.4586744"
130	725600.567	2159411.052	83°E 59.2954512"	19°31' 0.0304048"
131	725594.153	2159394.014	83°E 59.0679564"	19°30' 59.4386024"
132	725582.582	2159361.979	83°E 58.6548908"	19°30' 58.8967644"
133	725587.953	2159305.234	83°E 58.8175112"	19°30' 56.5081388"
134	725553.827	2159180.389	83°E 57.5934396"	19°30' 52.5047184"
135	725411.462	2159003.022	83°E 52.6359876"	19°30' 46.7965548"
136	725337.382	2158925.967	83°E 50.0629812"	19°30' 44.321598"
137	725207.556	2158791.096	83°E 45.5540532"	19°30' 40.0091724"
138	725200.981	2158683.613	83°E 45.282264"	19°30' 36.6979736"
139	725113.494	2158694.542	83°E 42.3518516"	19°30' 36.5629572"
140	725118.028	2158783.958	83°E 42.2125204"	19°30' 39.746608"
141	724576.217	2158778.778	83°E 28.9256688"	19°30' 30.856856"
142	724727.923	2159035.350	83°E 29.2137648"	19°30' 48.1255488"
143	724828.010	2159261.030	83°E 32.7419310"	19°30' 55.4219928"
144	724844.707	2159284.825	83°E 33.3246192"	19°30' 56.1888216"
145	725111.177	2159288.094	83°E 42.4625532"	19°30' 56.1887588"
146	725308.894	2159290.519	83°E 49.2413676"	19°30' 56.1851424"
147	725305.995	2159448.052	83°E 49.3174848"	19°30' 7.897476"
148	725338.581	2159641.421	83°E 50.4113988"	19°30' 7.5811512"
149	725378.055	2159589.985	83°E 51.7427232"	19°30' 5.828448"

Area Statement:-

Patch No	RoR Plot No	Tenant Name	Land Schedule Proposed Area		DGPS Surveyed Area	
			Area in Acre	Area in Hectare	Area in Acre	Area in Hectare
Patch-4	195	Abada Jyoti Anshadi(D.L.C)	59.55	20.46	49.41	20.00
	193(P)	Abada Jyoti Anshadi(D.L.C)	16.18	6.55	16.90	6.84
	197	Abada Jyoti Anshadi(D.L.C)	48.5	20.03	48.26	19.53
Total Area			116.23	47.04	114.57	46.37



Certified that this map has been finally framed and a copy of it has been finally published in accordance with rule 29 read with rule 60 of O.S.R. Rules, 1962 on 28th AUG. 1992.

(Signature)
Settlement Officer

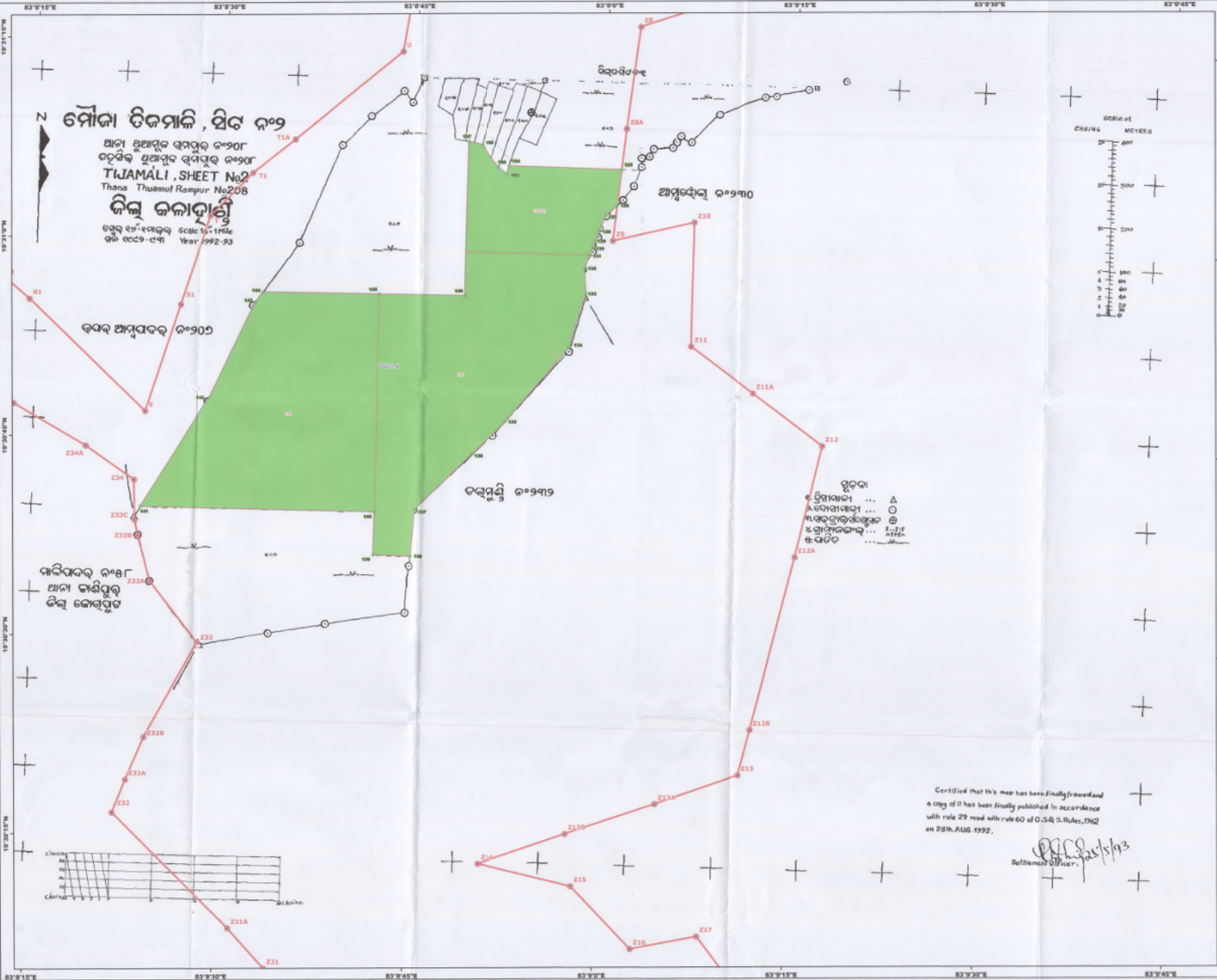

Spatial Planning & Analysis Research Centre Pvt. Ltd.
1/11, Infocity, Chandaka Industrial Estate,
Bhubaneswar - 751024.
Ph: 0674-6929301, 302, 303, Fax: 0674-6929306

DGPS Survey Conducted and Map Prepared by :-
Spatial Planning And Analysis Research Centre Pvt. Ltd.,
E/11, Infocity, Chandaka Industrial Estate,
Bhubaneswar - 751024.