

DGPS MAP SHOWING THE NON FOREST GOVT. LAND IDENTIFIED/ALLOTTED OVER 9.80 HA. IN VILLAGE CHAMPAJHARA UNDER BANSPAL TAHSIL OF KEONJHAR DISTRICT FOR RAISING COMPENSATORY AFFORESTATION FOR DALPAHAD IRON & MANGANESE MINES OF M/S DHARAMCHAND JAIN.

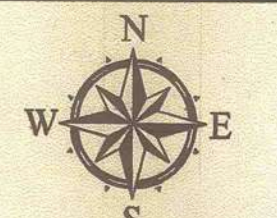

Scale = 1:3,960

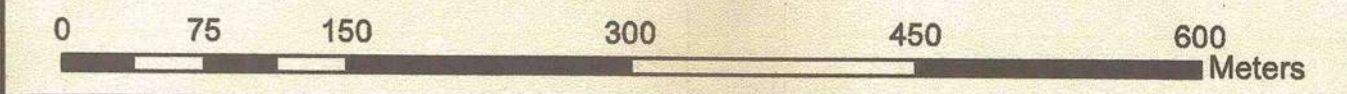

ମୌଜା ଚମ୍ପାହର, ପିଟ ନଂ ୨

ଥାନା କାଞ୍ଚିପାଣି ନଂ ୭୧
ଚମ୍ପାହର ଡେଇଁକୋଇଲ ନଂ ୭୧
CHAMPAJHARA, SHEET N°2
Thana Kanjipani N°71

ଜିଲ୍ଲା କେମ୍ବୁଡ଼ିର

ସ୍କେଲ: ୪,୦୦୦ Scale 1:4,000
ସନ ୧୯୮୦-୧୯୮୧ମସିହା Year-1980-81

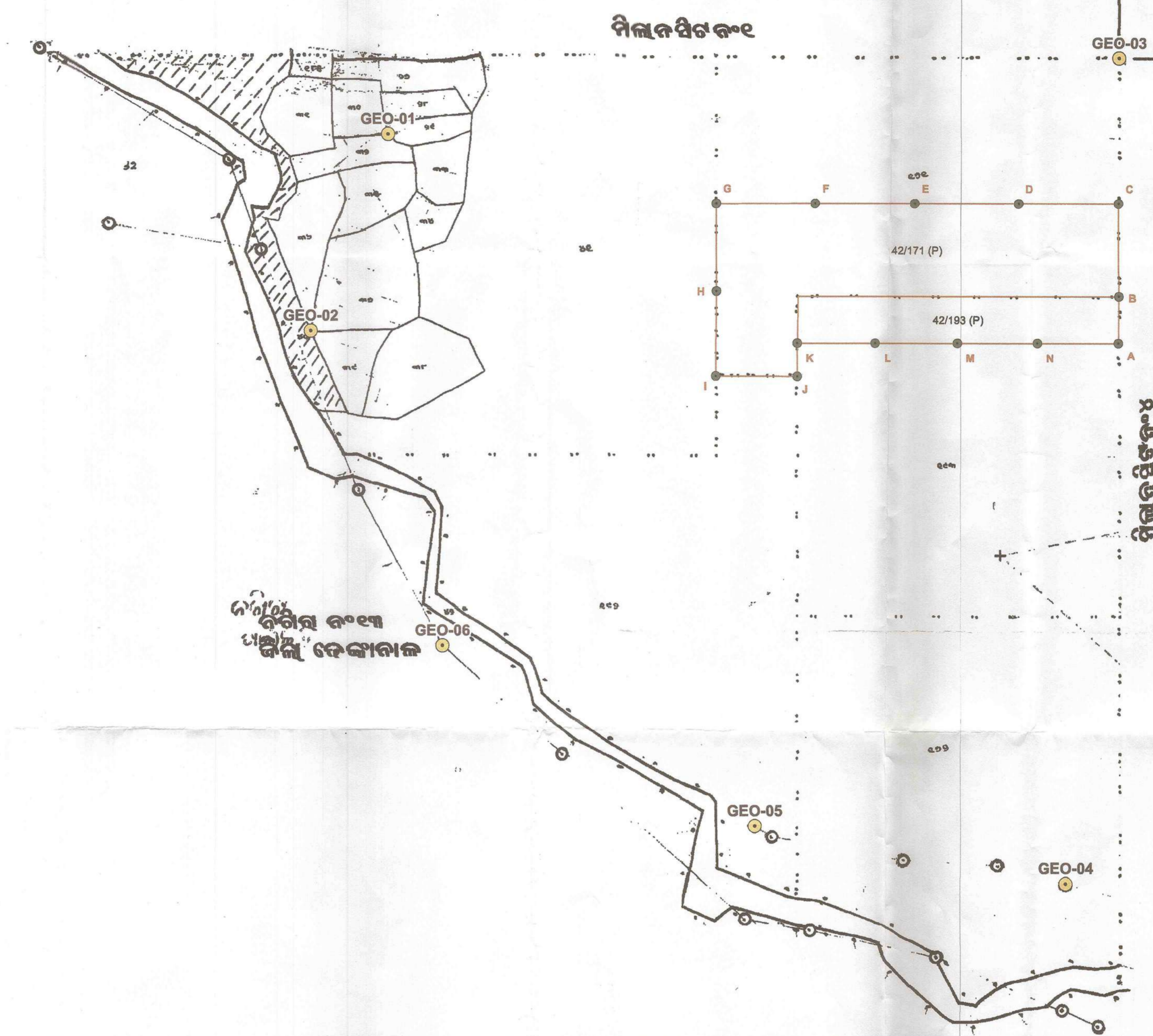

AREA STATISTICS OF COMPENSATORY AFFORESTATION LAND IN CHAMPAJHARA

Name of the Tahasil	Name of the Village	Khata No	Plot No	Kissam	Allotted Area For Comensatory Afforestation (In Ha.)	Map Area (In Ha.)
Telkoi	Champajhara	24	42/171 (P)	Parbat-II	7.310	7.314
Telkoi	Champajhara		42/193 (P)	Parbat-II	2.490	2.491
TOTAL					9.800	9.805

DGPS SURVEYED PILLAR CO-ORDINATED

Sl. No.	Pillar_Id	Geodetic System (WGS-84)		Projection Sytem (UTM-45)	
		Latitude	Longitude	Easting (M.)	Northing(M.)
1	A	21° 34' 48.10050"	N85° 18' 01.63557"	E324040.6772	2387303.1665
2	B	21° 34' 50.04755"	N85° 18' 01.61296"	E324040.6803	2387363.0544
3	C	21° 34' 53.95045"	N85° 18' 01.55839"	E324040.4207	2387483.1030
4	D	21° 34' 53.89448"	N85° 17' 57.05856"	E323910.9638	2387482.7951
5	E	21° 34' 53.84953"	N85° 17' 52.39568"	E323776.8203	2387482.8782
6	F	21° 34' 53.79986"	N85° 17' 47.91268"	E323647.8496	2387482.7604
7	G	21° 34' 53.75073"	N85° 17' 43.46662"	E323519.9417	2387482.6491
8	H	21° 34' 50.07117"	N85° 17' 43.50776"	E323519.8862	2387369.4730
9	I	21° 34' 46.53489"	N85° 17' 43.54870"	E323519.8737	2387260.7033
10	J	21° 34' 46.56051"	N85° 17' 47.19459"	E323624.7582	2387260.3436
11	K	21° 34' 47.95251"	N85° 17' 47.17934"	E323624.7878	2387303.1588
12	L	21° 34' 47.98913"	N85° 17' 50.69490"	E323725.9269	2387303.1790
13	M	21° 34' 48.02687"	N85° 17' 54.40673"	E323832.7120	2387303.1729
14	N	21° 34' 48.06292"	N85° 17' 58.00362"	E323936.1902	2387303.1513

DGPS SURVEYED GEO REFERENCE CO-ORDINATED

Sl. No.	Pillar_Id	Geodetic System (WGS-84)		Projection Sytem (UTM-45)	
		Latitude	Longitude	Easting (M.)	Northing(M.)
1	GEO-01	21° 34' 56.46452" N	85° 17' 28.66584" E	323095.1104	2387570.7764
2	GEO-02	21° 34' 48.21539" N	85° 17' 25.31144" E	322995.8358	2387318.1368
3	GEO-03	21° 35' 00.02633" N	85° 18' 01.49786" E	324040.7190	2387669.9826
4	GEO-04	21° 34' 25.53426" N	85° 17' 59.53411" E	323972.6523	2386609.8136
5	GEO-05	21° 34' 27.78743" N	85° 17' 45.50934" E	323569.9646	2386683.5168
6	GEO-06	21° 34' 35.18631" N	85° 17' 31.42606" E	323167.3316	2386915.5030

Legend

- Boundary Points
- Geo Ref. Points
- Plot Boundary

- DGPS Survey of Compensatory Afforestation land identified in Champajhar village under Banspal Tahsil, Keonjhar district in lieu of forest areas proposed for diversion coming within the M.L. area of Dalpahar Iron & Mn. Mines of M/s D.C.Jain has been carried out by the user agency through M/s Triveni Earth Movers Pvt. Ltd., Unchabali., Keonjhar.
- DGPS Survey Co-ordinates are verified by ORSAC. Also Maps showing Compensatory Afforestation land are verified with geo-referenced cadastral sheets / surveyed points compared with Ortho-rectified Cartosat Satellite image and found that maps are correct at a confidence level of 95%.
- The Compensatory Afforestation non-forest land comes in one cadastral sheets of Champajhar village Mouza of Bansapal Tahsil, Keonjhar district.
- Total Compensatory Afforestation land works out to **9.805Ha.** from the submitted .shp files, against the required area of 9.8Ha. as mentioned in the record.



 Forest Section Officer
Sukati
 Tahasildar
Banspal
COUNTERSIGNED
 Divisional Forest Officer
Keonjhar Division

DGPS SURVEY & MAP PREPARED BY-

THRIVENI EARTHMOVERS PRIVATE LIMITED

AT- UNCHABALI, P.O.- BAMEBARI
DIST.- KEONJHAR, ODISHA - 758009

