

Geo-REFERENCED MAP OF CA LAND AT VILL. DOLRI TEH PARASWADA, BALAGHAT

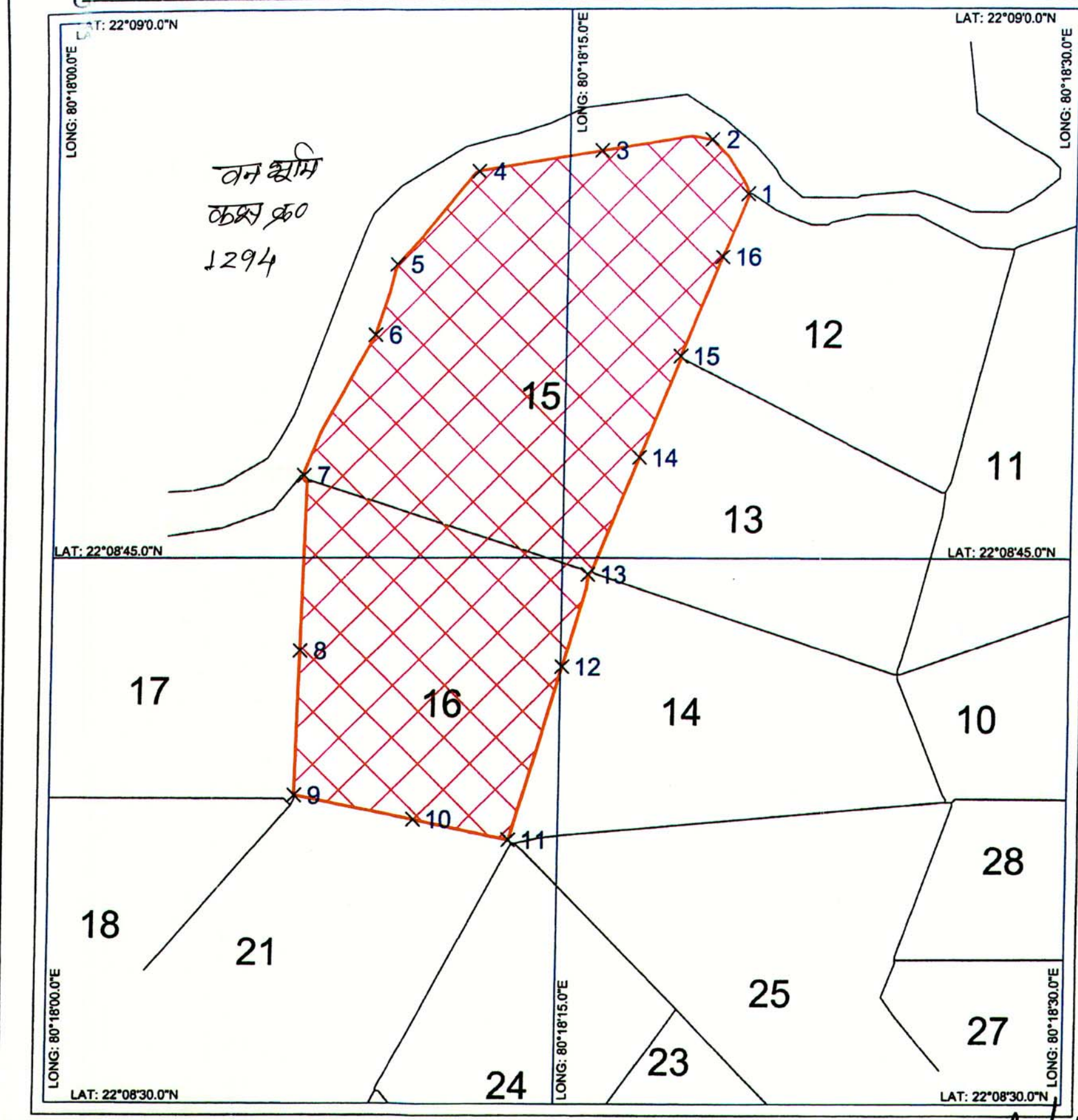

LEGEND

- KHASRA LINE WITH KHASRA NO.
- APPLIED FOR CA LAND
- GRID LINE
- × 31 PILLAR NO.

For 
The D.M.C.Co.Ltd.

CO-ORDINATE LIST OF KHASRA NO 15, 16
IN VILLAGE - DORLI

PT-ID	UTM-44N		LATITUDE			LONGITUDE		
	NORTHING	EASTING	D	M	S	D	M	S
1	2449413.686	428422.674	22	8	54.152	80	18	21.057
2	2449459.371	428391.832	22	8	55.633	80	18	19.973
3	2449450.575	428299.360	22	8	55.333	80	18	16.746
4	2449433.777	428195.870	22	8	54.772	80	18	13.136
5	2449355.954	428127.639	22	8	52.230	80	18	10.766
6	2449296.815	428109.967	22	8	50.304	80	18	10.159
7	2449178.357	428051.616	22	8	46.443	80	18	8.141
8	2449030.930	428050.125	22	8	41.649	80	18	8.112
9	2448908.700	428046.493	22	8	37.673	80	18	8.005
10	2448887.695	428146.831	22	8	37.005	80	18	11.511
11	2448870.247	428227.870	22	8	36.449	80	18	14.343
12	2449016.471	428271.301	22	8	41.211	80	18	15.836
13	2449093.989	428292.213	22	8	43.735	80	18	16.553
14	2449192.722	428334.082	22	8	46.953	80	18	17.999
15	2449277.883	428367.583	22	8	49.727	80	18	19.155
16	2449360.841	428401.940	22	8	52.430	80	18	20.341

VILLAGE - DORLI
TEHSIL - PARASWARA , DIST - BALAGHAT

LESSEE: PRAPOSED LAND
D.M.C.C. Ltd MUMBAI (M.H)
BOXITE MINE PHADKI MOHGAON

AREA: 13.339 Ha. (32.939 Acre)

Scale: 1:3960

Divisional Forest Officer
North Balaghat Divi. Balaghat

Range officer
North Lamta (T)

अध्यायक (सामान्य)

GEO-REFERENCED MAP OF CA LAND AT VILLAGE KHURSHITOLA, TEHSIL PARASWADA, DIST. BALAGHAT

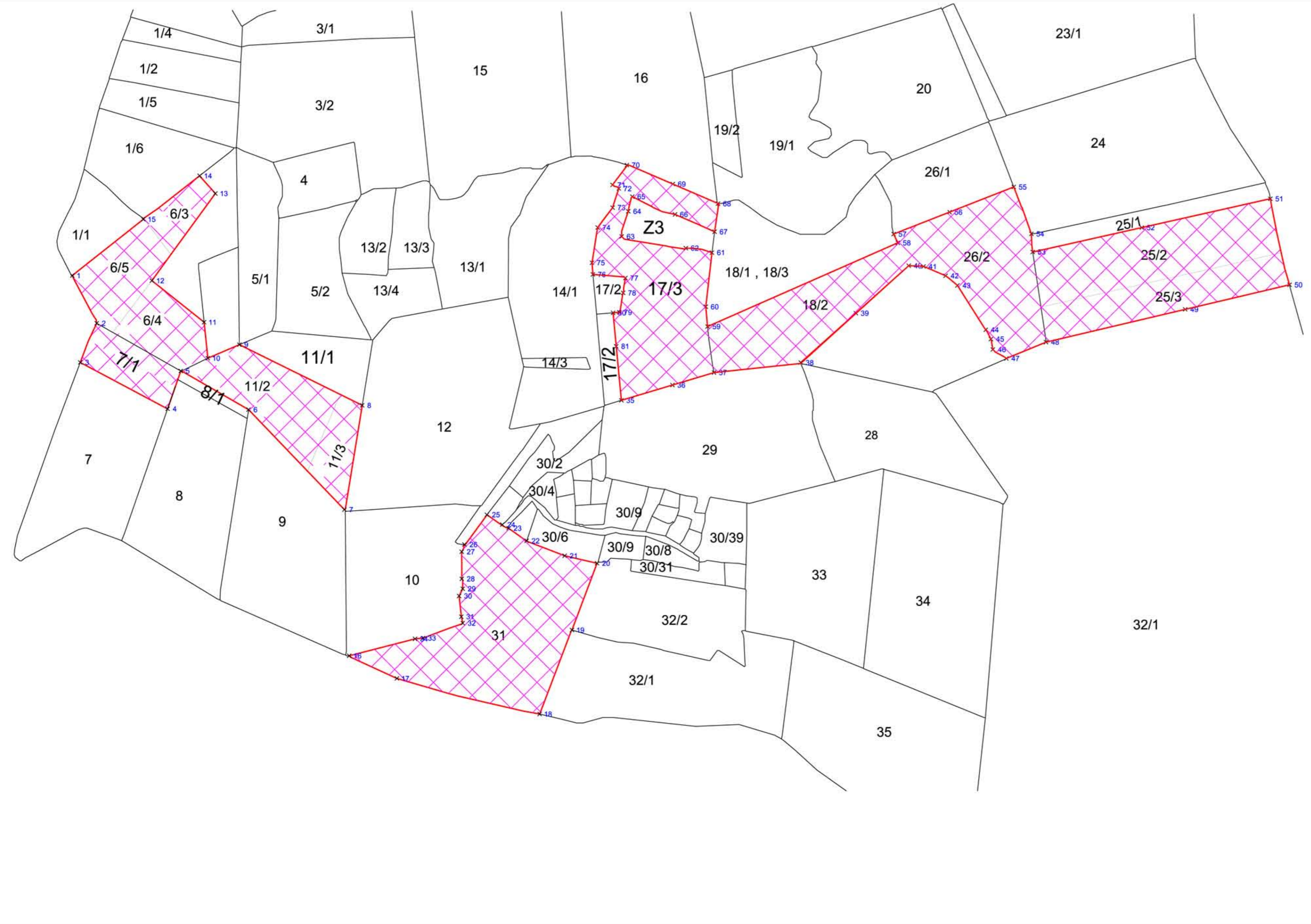

CO-ORDINATE LIST OF KHASRA NO
6/5, 11/2, 11/3, 7/1, 17/3, 18/2, 25/2, 25/3, 31,
KHURSITOLA
6/3, 6/4,
IN VILLAGE -

PT-ID	UTM-44N		LATITUDE			LONGITUDE			PT-ID	UTM-44N		LATITUDE			LONGITUDE		
	NORTHING	EASTING	D	M	S	D	M	S		NORTHING	EASTING	D	M	S	D	M	S
1	2452381.197	435890.395	22	10	31.71	80	22	41.337	41	2452395.031	437198.981	22	10	32.34	80	23	27.03
2	2452307.756	435927.991	22	10	29.33	80	22	42.660	42	2452380.733	437232.832	22	10	31.87	80	23	28.21
3	2452247.58	435902.63	22	10	27.37	80	22	41.780	43	2452365.844	437251.143	22	10	31.39	80	23	28.85
4	2452176.15	436036.94	22	10	25.06	80	22	46.480	44	2452297.731	437294.643	22	10	29.18	80	23	30.38
5	2452234.498	436057.129	22	10	26.96	80	22	47.180	45	2452283.414	437302.627	22	10	28.72	80	23	30.66
6	2452175.074	436161.25	22	10	25.05	80	22	50.824	46	2452267.468	437305.432	22	10	28.2	80	23	30.76
7	2452021.382	436308.612	22	10	20.07	80	22	55.991	47	2452253.638	437326.265	22	10	27.75	80	23	31.49
8	2452181.578	436336.09	22	10	25.28	80	22	56.928	48	2452278.726	437387.247	22	10	28.58	80	23	33.62
9	2452274.904	436147.225	22	10	28.29	80	22	50.320	49	2452329.095	437601.21	22	10	30.24	80	23	41.08
10	2452253.995	436098.704	22	10	27.6	80	22	48.629	50	2452366.849	437761.584	22	10	31.49	80	23	46.68
11	2452309.388	436093.052	22	10	29.4	80	22	48.424	51	2452499.104	437732.141	22	10	35.79	80	23	45.63
12	2452373.327	436012.712	22	10	31.47	80	22	45.609	52	2452454.819	437534.534	22	10	34.32	80	23	38.74
13	2452507.162	436110.357	22	10	35.84	80	22	49.000	53	2452417.246	437366.878	22	10	33.08	80	23	32.89
14	2452534.341	436086.111	22	10	36.72	80	22	48.149	54	2452445.131	437364.727	22	10	33.99	80	23	32.81
15	2452467.549	435999.526	22	10	34.54	80	22	45.135	55	2452517.221	437337.723	22	10	36.33	80	23	31.86
16	2451796.691	436315.99	22	10	12.76	80	22	56.281	56	2452478.53	437238.983	22	10	35.06	80	23	28.41
17	2451761.881	436389.433	22	10	11.64	80	22	58.85	57	2452444.836	437152.995	22	10	33.95	80	23	25.42
18	2451707.107	436608.842	22	10	9.885	80	23	6.519	58	2452431.384	437159.465	22	10	33.51	80	23	25.64
19	2451836.203	436658.519	22	10	14.09	80	23	8.235	59	2452302.743	436866.854	22	10	29.29	80	23	15.44
20	2451938.922	436697.155	22	10	17.44	80	23	9.57	60	2452333.18	436864.214	22	10	30.28	80	23	15.35
21	2451950.483	436647.292	22	10	17.81	80	23	7.827	61	2452416.404	436873.758	22	10	32.99	80	23	15.67
22	2451973.386	436588.895	22	10	18.54	80	23	5.785	62	2452423.279	436833.521	22	10	33.21	80	23	14.26
23	2451998.279	436551.395	22	10	19.17	80	23	4.812	63	2452441.117	436735.004	22	10	33.77	80	23	10.82
24	2451998.279	436551.395	22	10	19.35	80	23	4.472	64	2452479.836	436745.054	22	10	35.03	80	23	11.17
25	2452013.492	436527.786	22	10	19.84	80	23	3.645	65	2452502.399	436751.339	22	10	35.77	80	23	11.38
26	2451967.649	436493.198	22	10	18.34	80	23	2.444	66	2452475.057	436816.898	22	10	34.89	80	23	13.68
27	2451956.545	436489.059	22	10	17.98	80	23	2.301	67	2452448.333	436877.858	22	10	34.03	80	23	15.81
28	2451914.933	436489.141	22	10	16.63	80	23	2.31	68	2452491.569	436883.048	22	10	35.43	80	23	15.98
29	2451899.677	436490.558	22	10	16.13	80	23	2.362	69	2452521.72	436813.61	22	10	36.4	80	23	13.55
30	2451888.57	436485.032	22	10	15.77	80	23	2.17	70	2452550.899	436742.926	22	10	37.34	80	23	11.08
31	2451856.749	436488.466	22	10	14.74	80	23	2.295	71	2452520.36	436720.808	22	10	36.35	80	23	10.31
32	2451846.969	436490.662	22	10	14.42	80	23	2.373	72	2452514.834	436730.522	22	10	36.17	80	23	10.65
33	2451823.886	436429.614	22	10	13.66	80	23	0.244	73	2452485.475	436721.046	22	10	35.21	80	23	10.33
34	2451822.626	436417.258	22	10	13.62	80	22	59.81	74	2452454.808	436698.06	22	10	34.21	80	23	9.529
35	2452189.264	436734.456	22	10	25.58	80	23	10.84	75	2452400.802	436689.31	22	10	32.46	80	23	9.231
36	2452212.801	436813.001	22	10	26.36	80	23	13.58	76	2452382.772	436690.733	22	10	31.87	80	23	9.283
37	2452231.948	436876.898	22	10	26.989	80	23	15.805	77	2452377.323	436740.678	22	10	31.7	80	23	11.03
38	2452247.33	437010.303	22	10	27.507	80	23	20.461	78	2452354.429	436737.255	22	10	30.95	80	23	10.91
39	2452323.283	437094.927	22	10	29.988	80	23	23.405	79	2452324.595	436731.072	22	10	29.98	80	23	10.7
40	2452396.212	437176.182	22	10	32.371	80	23	26.232	80	2452323.827	436721.708	22	10	29.96	80	23	10.37
									81	2452272.361	436726.584	22	10	28.28	80	23	10.55



1:3960

VILLAGE - KHURSITOLA
TEHSIL - PARASWARA , DIST - BALAGHAT

LESSEE D.M.C.C. Ltd MUMBAI (M.H)
BOXITE MINE PHADKI MOHGAON

AREA 27.49 Ha. (67.90 Acre)

LEGEND

— KHASRA LINE WITH KHASRA NO.

▨ APPLIED FOR CA LAND

— GRID LINE

× 31 PILLAR NO.