

LAYOUT PLAN OF ALTERNATE LAND FOR FOREST

KHASRA NO.: 368

Village: THAKA, Tehsil : ANTA, Distt. BARAN

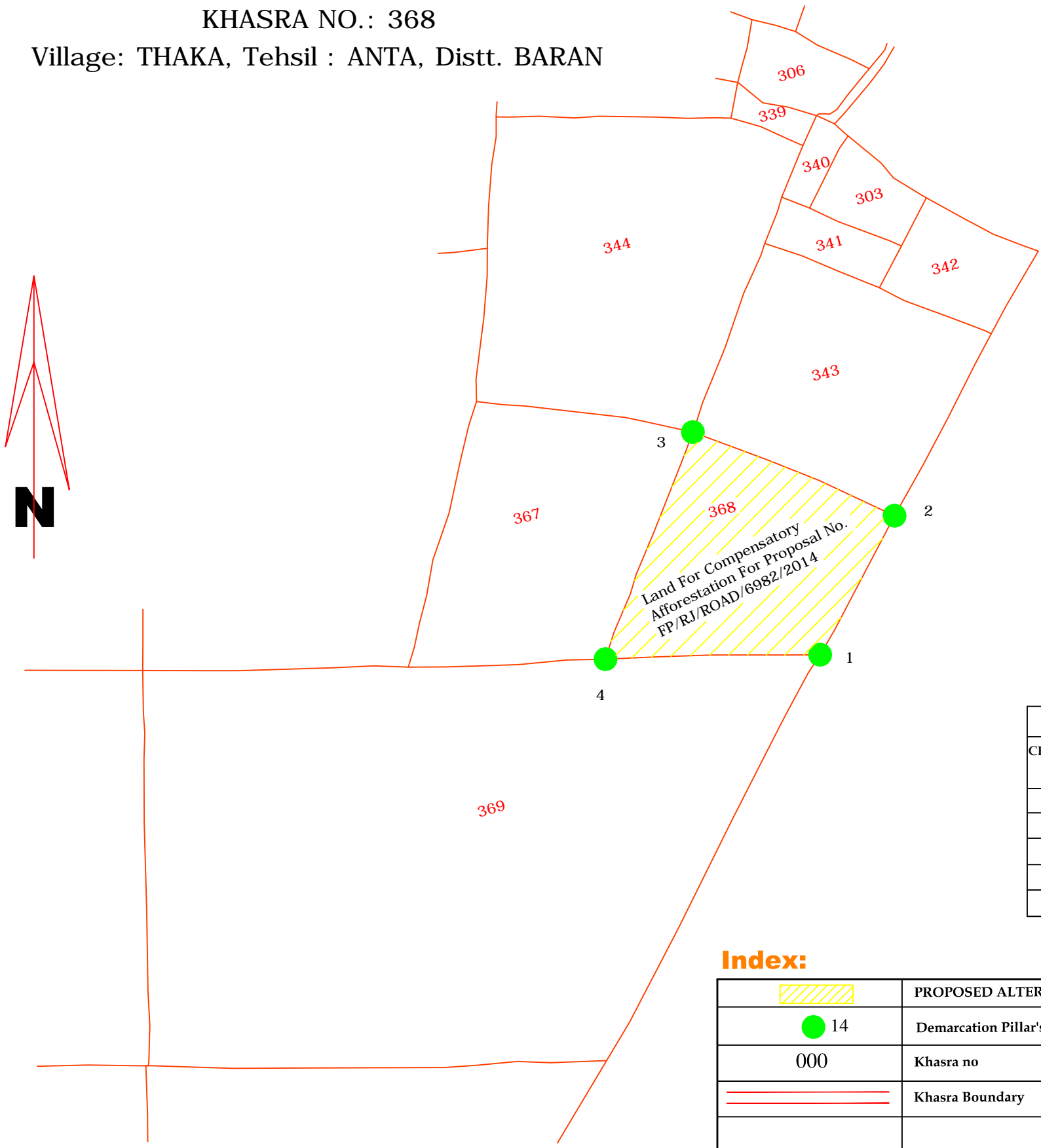





VILLAGE- THAKA

Khasra No.	Area in Hact.
368	2.25
Land For Compensatory Afforestation For Proposal No. FP/RJ/ROAD/6982/2014	2.22

LAT-LONG OF BOUNDRY PILLAR'S ON ALTERNATE LAND				
CENTER LINE PILLARS	LAT-LONG			
	UTM CO-ORDINATES		WGS-84 CO-ORDINATES	
	NORTHING	EASTING	LONGITUDE	LATITUDE
1	2773222.95	627180.11	76°15' 39.52"	25°04' 09.75"
2	2773327.66	627236.26	76°15' 41.56"	25°04' 13.14"
3	2773390.72	627084.21	76°15' 36.15"	25°04' 15.24"
4	2773219.49	627018.28	76°15' 33.74"	25°04' 09.69"

Index:

	PROPOSED ALTERNATE LAND
 14	Demarcation Pillar's
000	Khasra no
	Khasra Boundary

	
ASSISTANT ENGINEER PWD SUB. DIV. KELWARA	EXECUTIVE ENGINEER PWD DIV. SHAHABAD