

**DIVISION PLAN OF FOREST LAND FOR FILLING  
STATION OF BPCL ENTRY & EXIT AT VILL. HAIBUANA  
ON KALANWALI DABWALI ROAD IN SIRSA DISTT.  
KILLA NO. 107/118/1**

S. NO.	LATITUDE			LONGITUDE		
	DEGREE	MINUTES	SECOND	DEGREE	MINUTES	SECOND
1	29	54	8.559	74	49	39.118
2	29	54	8.370	74	49	38.233
3	29	54	8.495	74	49	38.301
4	29	54	8.573	74	49	39.084
5	29	54	8.570	74	49	39.075
6	29	54	8.670	74	49	37.651
7	29	54	8.338	74	49	38.089
8	29	54	8.945	74	49	38.026
9	29	54	8.992	74	49	38.060
10	29	54	8.938	74	49	38.689



**Legend**

- Dgps Point
- Retail Outlet
- Road
- Entry / Exit
- FOREST LAND

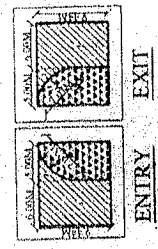

**DETAIL OF FOREST LAND USED FOR ACCESS**

**ENTRY AREA DETAIL**

1. 84403.00 = 86.64 SQ.MT.
2. 1311.41 = 13.50 X 5.00 = 17.50 SQ.MT.
3. LESS AREA OF NO. 2 = (17.50 X 1.40) = 8.88 SQ.MT.
4. TOTAL AREA = (84403.00 + 17.50 - 8.88) = 84411.62 SQ. MT.

**AREA DETAIL OF EXIST**

1. 14463.00 = 84.44 SQ.MT.
2. 1311.41 = 13.50 X 5.00 = 17.50 SQ.MT.
3. LESS AREA OF NO. 2 = (17.50 X 1.40) = 8.88 SQ.MT.
4. TOTAL AREA = (14463.00 + 17.50 - 8.88) = 14471.62 SQ. MT.

**5. TOTAL AREA**

= ENTRY + EXIST  
= 84411.62 SQ.MT. OR 176.50 HECT.  
OR 80125 HECT.

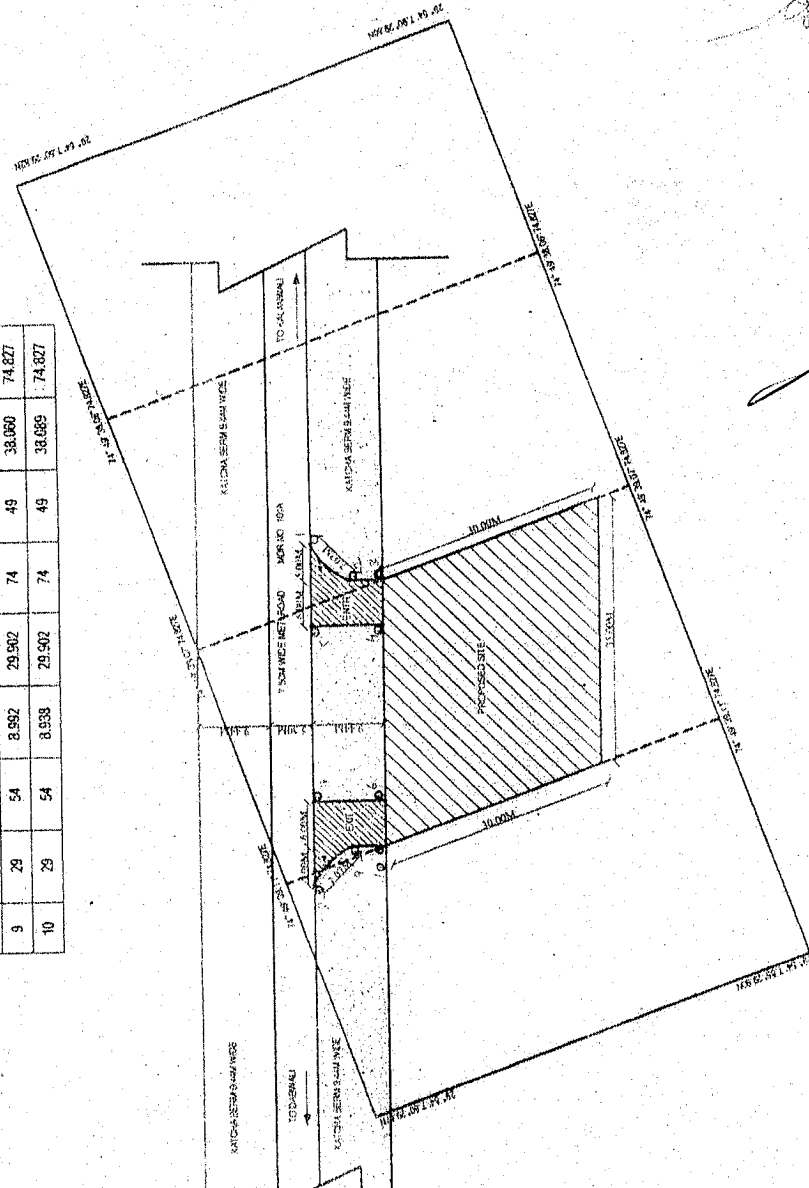

Map Prepared For  
**BPCL RETAIL OUTLET**  
AT VILL. HAIBUANA

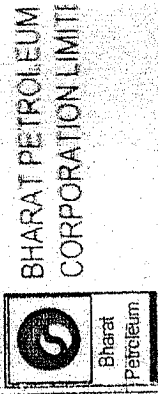

*(Signature)*

Anurag Singh  
Staff No. 10370  
A. M. Engg. Retail  
Hisar Territory  
Bharat Petroleum Corp. Ltd.

**प्रादेशिक प्रबन्धक (रिटेल)**  
**भारत पेट्रोलियम कार्पोरेशन लि०**  
**हिसार (हरियाणा)**

Anurag Singh  
A. M. Engg. Retail  
Hisar Territory  
Bharat Petroleum Corp. Ltd.