

GIS Generated Coordinates for Proposed Site of Over-Bridge on Rambagh Railway Line, Allahabad

Forest Area Coordinates (Generated in GIS)

SN	LATITUDE	LONGITUDE
1	25° 26' 32.215" N	81° 50' 54.840" E
2	25° 26' 32.276" N	81° 50' 54.564" E
3	25° 26' 31.990" N	81° 50' 54.383" E
4	25° 26' 31.936" N	81° 50' 54.662" E
5	25° 26' 30.284" N	81° 50' 53.236" E
6	25° 26' 30.169" N	81° 50' 53.482" E
7	25° 26' 29.908" N	81° 50' 53.309" E
8	25° 26' 30.027" N	81° 50' 53.060" E

पी० सी० वर्मा
सहायक अभियन्ता
सेतु निर्माण इकाई, इलाहाबाद (पश्चिम)

Proposed Site Map for Over-Bridge on Rambagh Railway Line, Allahabad

For Official Use Only

INSET VIEW-I

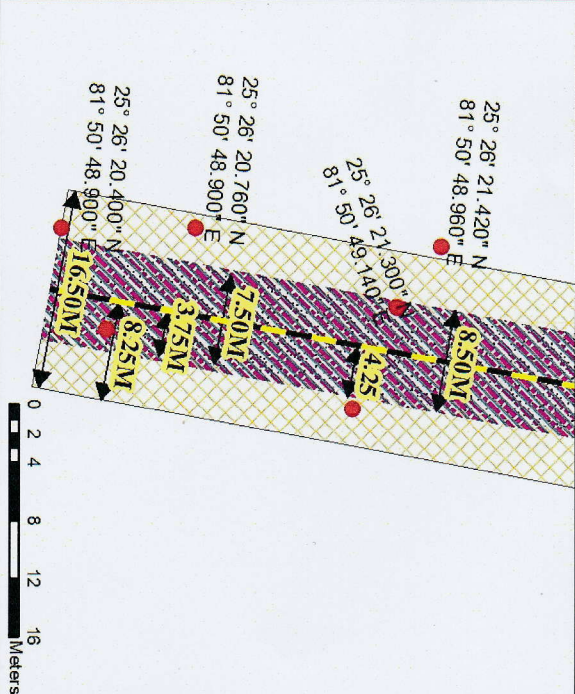
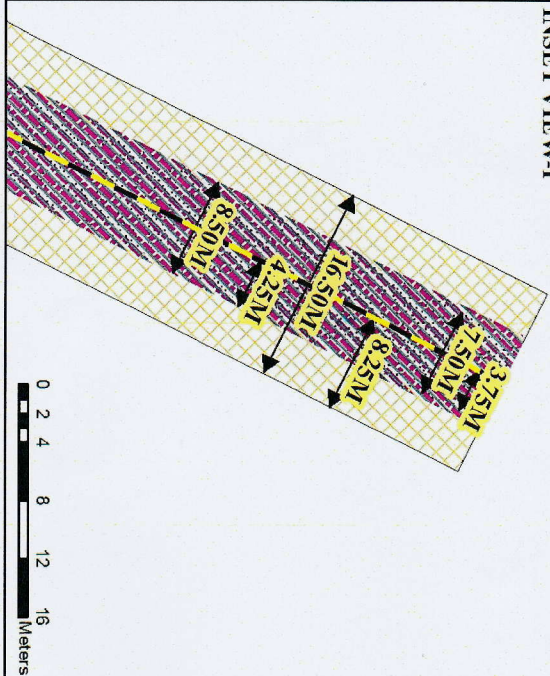

25° 26' 41.160" N
81° 50' 59.820" E
ROAD MEDICAL SIDE

INSET VIEW-III



पी० सी० वर्मा
सहायक अभियन्ता
पेटु निर्माण इकाई, कानपुर (प्रथम)

Legend

- GPS Coordinates of the Road
- Forest Boundary Coordinates Generated in GIS
- Centre Line of the Road
- Existing Road
- Railway Line
- Railway Occupied Area
- Eastern Shoulder
- Proposed Bridge
- Forest Strip Area Along
- Railway Line
- Forest Strip Area Falling in Bridge

Prepared by



Remote Sensing Applications Centre, Uttar Pradesh
(Dept. of Science & Technology, Govt. of U.P.)
Sector-G, Jankipuram, Kursi Road
Lucknow-226 021

Note: Map Based on GPS Coordinates and measurements given in the Drawing Provided by Divisional Director, Social Forestry Division, Allahabad.