







S.NO.	CHAINAGE	VILLAGE NAME	(RHS) FOREST AREA IN Ha.	(LHS) FOREST AREA IN Ha.	TOTAL FOREST AREA IN Ha.
1	0+000 0+300	Ambai (156)	0.0809	0.0994	0.1804
2	0+300 0+600	Basauni (151)	0.1265	0.1486	0.2751
3	0+600 1+000	Khiribaand (146)	0.1038	0.1490	0.2528
4	1+000 1+850	Jamuni (203)	0.3648	0.2959	0.6607
5	1+850 2+100	Pista (204)	0.0815	0.2453	0.3268
6	2+100 3+080	Baijani (202)	0.7182	0.5014	1.2196
7	3+080 3+810	Phulvariya (253)	0.5025	0.4676	0.9701
8	3+810 4+200	Pista (251)	0.2341	0.2944	0.5284
9	4+200 5+510	Phulvariya (253)	0.3287	1.2645	1.5932

 M.K PANDEY
 EXECUTIVE ENGINEER
 N.H DIVISION
 BHAGALPUR

NON FOREST AREA IN SQ. M	749459.0180
NON FOREST AREA IN HA.	74.9459
TALUK	
RANGE	

LEGEND:

EXISTING CENTER LINE		DESIGN CHAINAGE	1234
PROPOSED ROW		FOREST HATCH	
EXISTING ROW		NON FOREST AREA	
VILLAGE BOUNDARY			

CLIENT:

RCD BIHAR,
NH DIVISION



CONSULTANTS:





PROJECT:

Consultancy services for the preparation of Feasibility Study and Detailed Project Report for Improvement to Two lane with paved shoulder of various stretches in state of Bihar. Bhagalpur at NH 33 - Dhaka Mor on NH 333A - Baljhor (Bihar & Jharkhand border).

DRAWN	DEEPAK
DESIGNED	ARVIND
CHECKED	AKSHAY
APPROVED	MAYANK

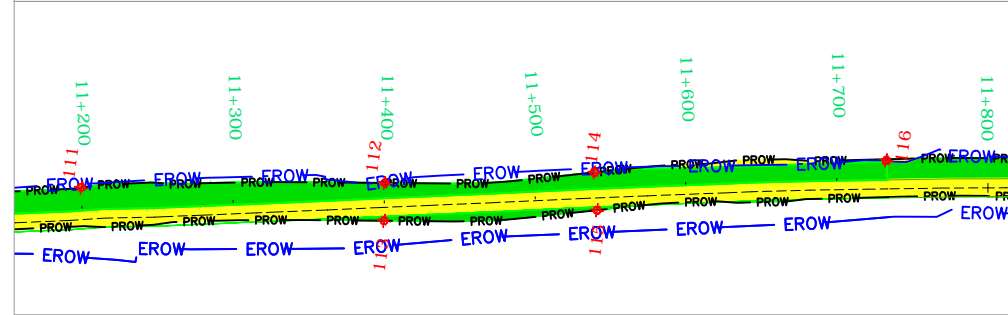
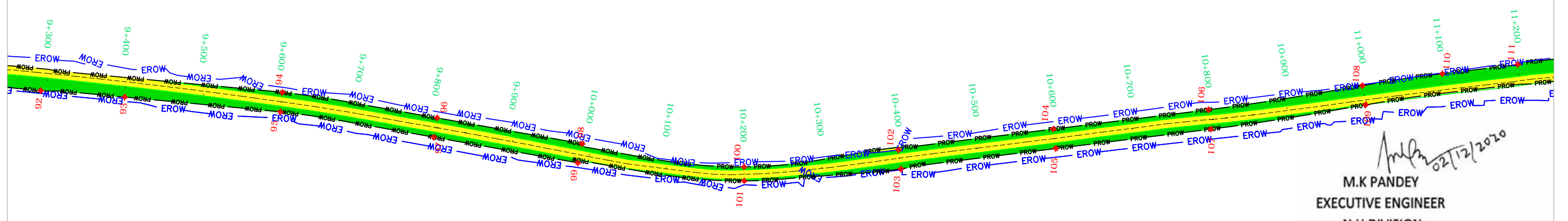
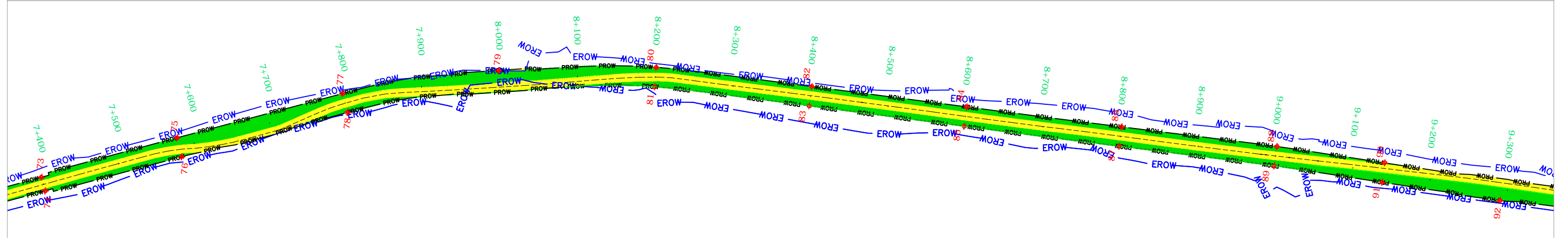
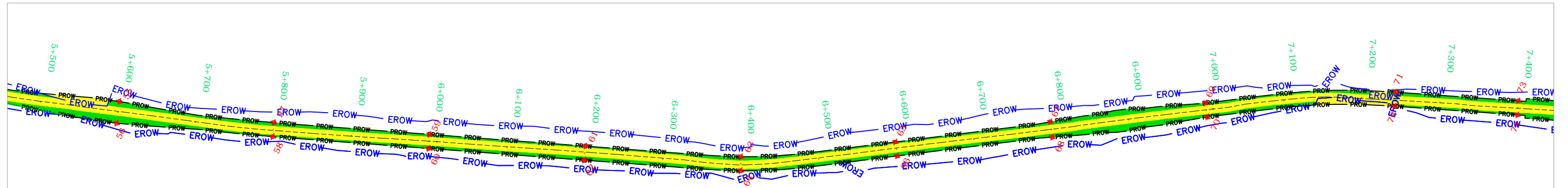
TITLE:	FOREST LAND DIVERSION PLAN GEO REFERENCED MAP FROM KM. 0+000 TO 5+510	
SCALE AT A3:	1 : 4000	REV: PO / R0
DRG. NO:	001	DATE: Aug. 2020









 02/12/2020
M.K PANDEY
 EXECUTIVE ENGINEER
 N.H DIVISION
 BHAGALPUR

S.NO.	CHAINAGE	VILLAGE NAME	(RHS) FOREST AREA IN Ha.	(LHS) FOREST AREA IN Ha.	TOTAL FOREST AREA IN Ha.
10	5+510 8+000	Pureani (255)	0.8849	1.2516	2.1364
11	8+000 9+050	Fatehpur	0.6044	0.7297	1.3341
12	9+050 9+900	Bhawanipur (263)	0.8800	0.2733	1.1533
13	9+900 11+735	Jagdishpur (428)	0.6051	1.6036	2.2087

NON FOREST AREA IN SQ. M	749459.0180
NON FOREST AREA IN HA.	74.9459
TALUK	
RANGE	

LEGEND:

EXISTING CENTER LINE		DESIGN CHAINAGE	1234
PROPOSED ROW		FOREST HATCH	
EXISTING ROW		NON FOREST AREA	
VILLAGE BOUNDARY			

CLIENT:

RCD BIHAR,
NH DIVISION



CONSULTANTS:





PROJECT:

Consultancy services for the preparation of Feasibility Study and Detailed Project Report for Improvement to Two lane with paved shoulder of various stretches in state of Bihar. Bhagalpur at NH 33 - Dhaka Mor on NH 333A - Baljhor (Bihar & Jharkhand border).

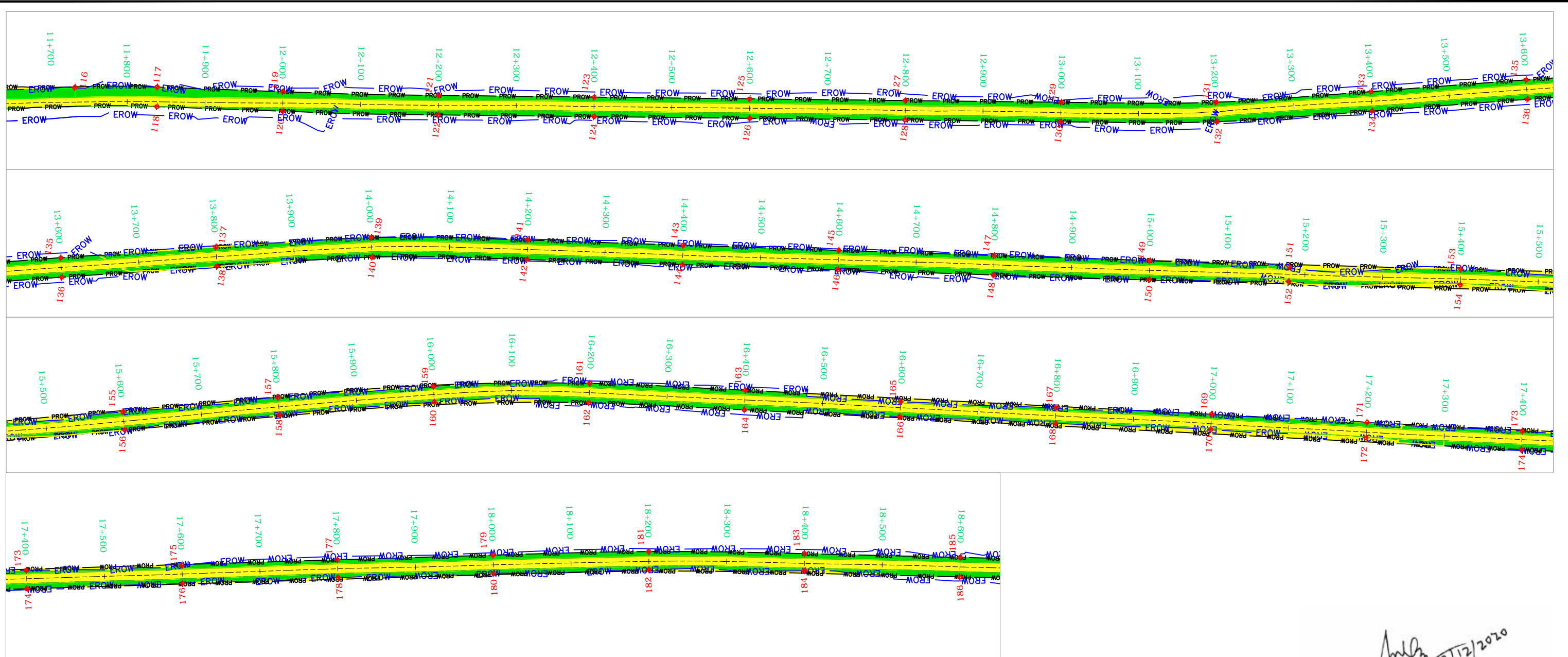

DRAWN	DEEPAK
DESIGNED	ARVIND
CHECKED	AKSHAY
APPROVED	MAYANK

TITLE: FOREST LAND DIVERSION PLAN
GEO REFERENCED MAP
FROM KM. 5+510 TO 11+735

SCALE AT A3:	1 : 4000	REV:	P0 / R0
DRG. NO:	002	DATE:	Aug. 2020



S.NO.	CHAINAGE	VILLAGE NAME	(RHS) FOREST AREA IN Ha.	(LHS) FOREST AREA IN Ha.	TOTAL FOREST AREA IN Ha.	
14	11+735	12+250	Agia Chak (472)	0.1934	0.4838	0.6772
15	12+250	13+000	Zohra Chak (474)	0.5068	0.4887	0.9956
16	13+000	13+650	Tekuni (476)	0.4402	0.4017	0.8418
17	13+650	14+800	Madhai (478)	0.7567	0.7254	1.4821
18	14+800	15+150	Neamatpur (438)	0.1897	0.2035	0.3932
19	15+150	16+150	Sanjha (436)	0.3727	0.4388	0.8115
20	16+150	16+480	Mosinchak (435)	0.2271	0.2154	0.4424
21	16+480	17+250	Jouadchak (433)	0.2483	0.3229	0.5712
22	17+250	17+450	Munianchak (432)	0.1346	0.1007	0.2353
23	17+450	18+510	Kathiawan (430)	0.5757	0.6258	1.2015

 M.K PANDEY
 EXECUTIVE ENGINEER
 N.H DIVISION
 BHAGALPUR

NON FOREST AREA IN SQ. M	749459.0180
NON FOREST AREA IN HA.	74.9459
TALUK	
RANGE	

LEGEND: EXISTING CENTER LINE  PROPOSED ROW  EXISTING ROW  VILLAGE BOUNDARY  DESIGN CHAINAGE  1234 FOREST HATCH  NON FOREST AREA 	CLIENT: RCD BIHAR, NH DIVISION 	CONSULTANTS:  	PROJECT: Consultancy services for the preparation of Feasibility Study and Detailed Project Report for Improvement to Two lane with paved shoulder of various stretches in state of Bihar. Bhagalpur at NH 33 - Dhaka Mor on NH 333A - Baljhor (Bihar & Jharkhand border).	DRAWN DEEPAK DESIGNED ARVIND CHECKED AKSHAY APPROVED MAYANK	TITLE: FOREST LAND DIVERSION PLAN GEO REFERENCED MAP FROM KM. 11+735 TO 18+510 SCALE AT A3: 1 : 4000 DRG. NO: 003 REV: P0 / R0 DATE: Aug. 2020
---	--	--	--	--	--

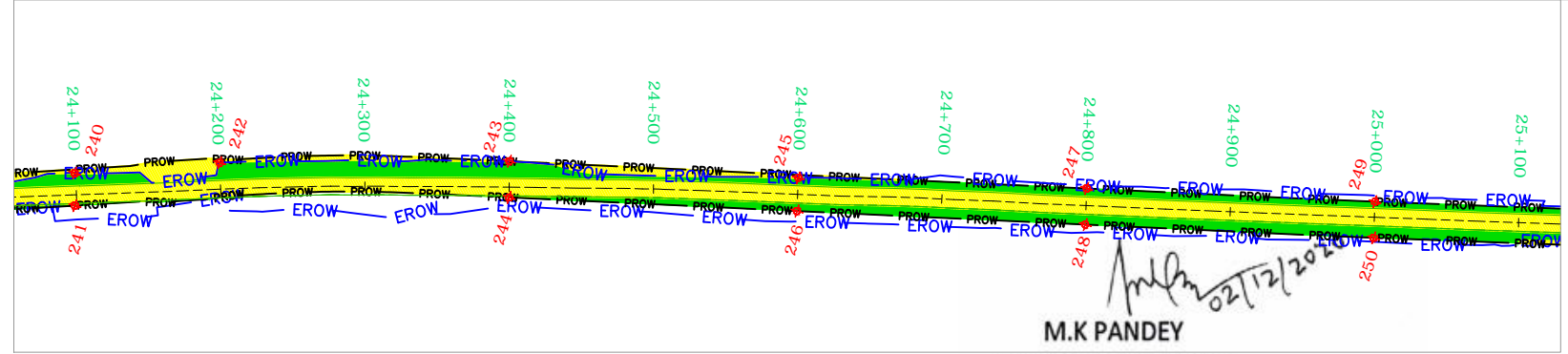
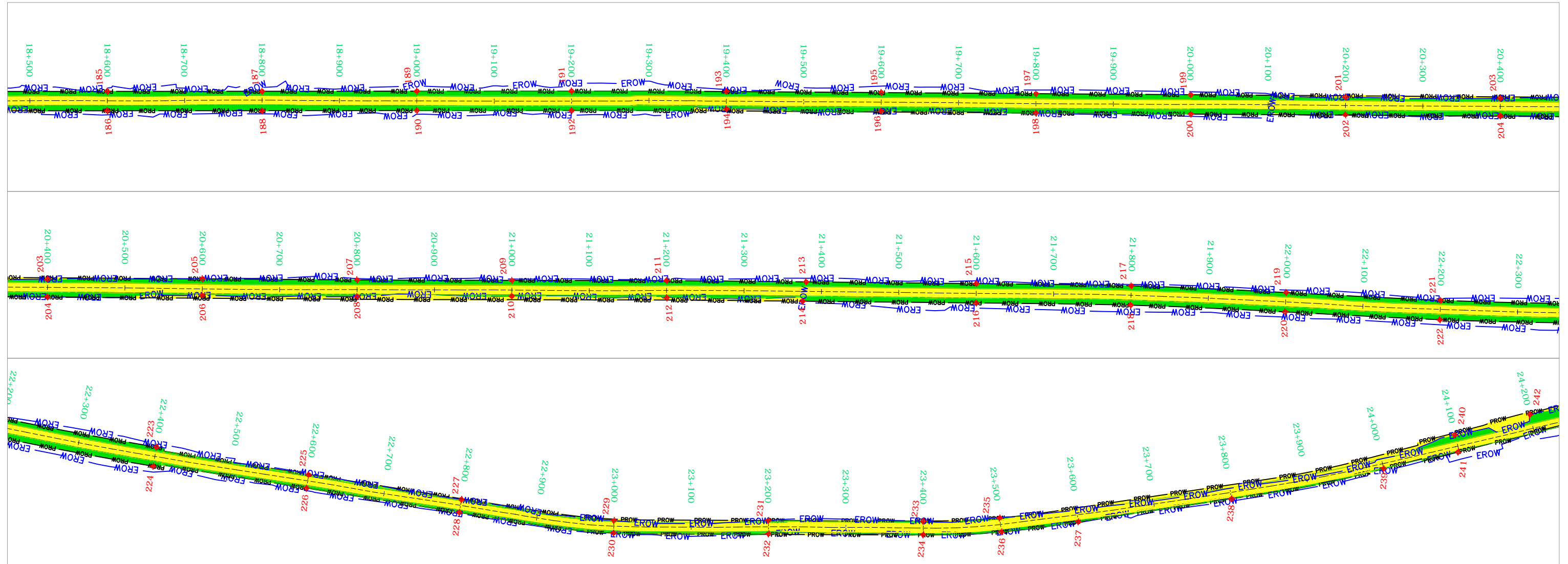

M.K PANDEY
 EXECUTIVE ENGINEER
 N.H DIVISION
 BHAGALPUR

S.NO.	CHAINAGE	VILLAGE NAME	(RHS) FOREST AREA IN Ha.	(LHS) FOREST AREA IN Ha.	TOTAL FOREST AREA IN Ha.
24	18+510 19+360	Bakhrabela (412)	0.5659	0.5246	1.0905
25	19+360 20+100	Khiri (411)	0.4268	0.4880	0.9147
26	20+100 20+500	Jiwan (409)	0.2534	0.1920	0.4454
27	20+500 21+380	Khaira (566)	0.2040	0.5798	0.7838
28	21+380 22+500	Safiachak (568)	0.7237	0.6724	1.3960
29	22+500 23+200	Rajaun	0.2180	0.1171	0.3351
30	23+200 24+000	Kifaeatpur	0.1886	0.0768	0.2654
31	24+000 24+090	Bhusia (573)	0.0082	0.0017	0.0099
32	24+090 25+100	Dhauni (596)	0.4650	0.7187	1.1837

NON FOREST AREA IN SQ. M	749459.0180
NON FOREST AREA IN HA.	74.9459
TALUK	
RANGE	

LEGEND:

EXISTING CENTER LINE		DESIGN CHAINAGE	1234
PROPOSED ROW		FOREST HATCH	
EXISTING ROW		NON FOREST AREA	
VILLAGE BOUNDARY			

CLIENT:
 RCD BIHAR,
 NH DIVISION



PROJECT:
 Consultancy services for the preparation of Feasibility Study and Detailed Project Report for Improvement to Two lane with paved shoulder of various stretches in state of Bihar. Bhagalpur at NH 33 - Dhaka Mor on NH 333A - Baljhor (Bihar & Jharkhand border).

DRAWN	DEEPAK
DESIGNED	ARVIND
CHECKED	AKSHAY
APPROVED	MAYANK

TITLE: FOREST LAND DIVERSION PLAN GEO REFERENCED MAP FROM KM. 18+510 TO 25+100	
SCALE AT A3:	1 : 4000
REV:	PO / R0
DRG. NO:	004
DATE:	Aug. 2020

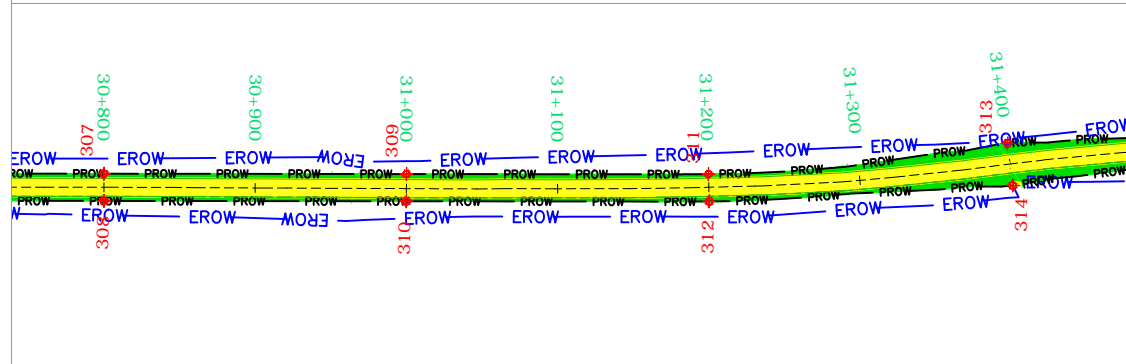
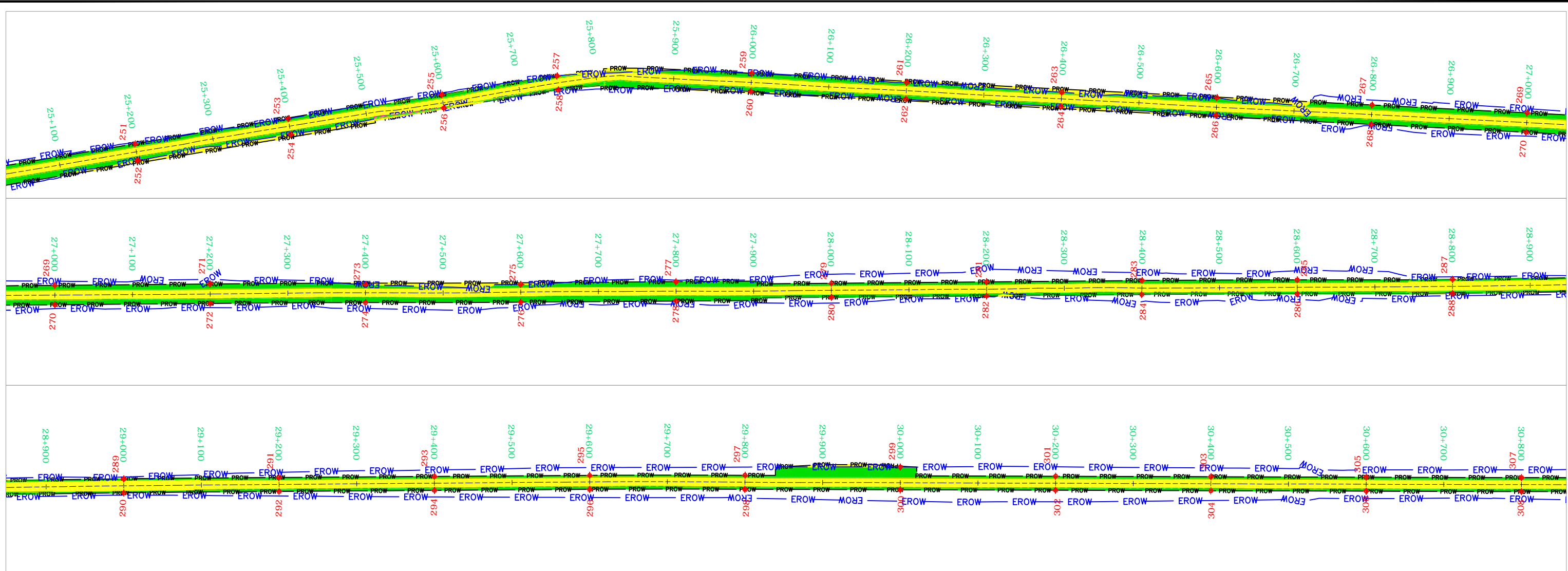

 M.K PANDEY
 EXECUTIVE ENGINEER
 N.H DIVISION
 BHAGALPUR

S.NO.	CHAINAGE	VILLAGE NAME	(RHS) FOREST AREA IN Ha.	(LHS) FOREST AREA IN Ha.	TOTAL FOREST AREA IN Ha.
33	25+100 26+500	Bangaon (581)	0.5927	0.5589	1.1517
34	26+500 26+700	Sohani (587)	0.1114	0.0977	0.2090
35	26+700 26+860	Murama (582)	0.1043	0.1051	0.2094
36	26+860 27+360	Chandpur Malik (586)	0.3119	0.3215	0.6334
37	27+360 28+750	Punsia (588)	0.5881	0.5398	1.1279
38	28+750 29+100	Kavari	0.1039	0.1070	0.2108
39	29+100 30+500	Bhojpur (111)	0.4432	0.6095	1.0528
40	30+500 30+960	Nemuaa (112)	0.1319	0.1419	0.2738
41	30+960 31+400	Masudanpur (116)	0.1424	0.1696	0.3119

NON FOREST AREA IN SQ. M	749459.0180
NON FOREST AREA IN HA.	74.9459
TALUK	
RANGE	

LEGEND:			
EXISTING CENTER LINE		DESIGN CHAINAGE	1234
PROPOSED ROW		FOREST HATCH	
EXISTING ROW		NON FOREST AREA	
VILLAGE BOUNDARY			

CLIENT:

RCD BIHAR,
NH DIVISION



CONSULTANTS:





PROJECT:

Consultancy services for the preparation of Feasibility Study and Detailed Project Report for Improvement to Two lane with paved shoulder of various stretches in state of Bihar. Bhagalpur at NH 33 - Dhaka Mor on NH 333A - Baljhor (Bihar & Jharkhand border).

DRAWN	DEEPAK
DESIGNED	ARVIND
CHECKED	AKSHAY
APPROVED	MAYANK

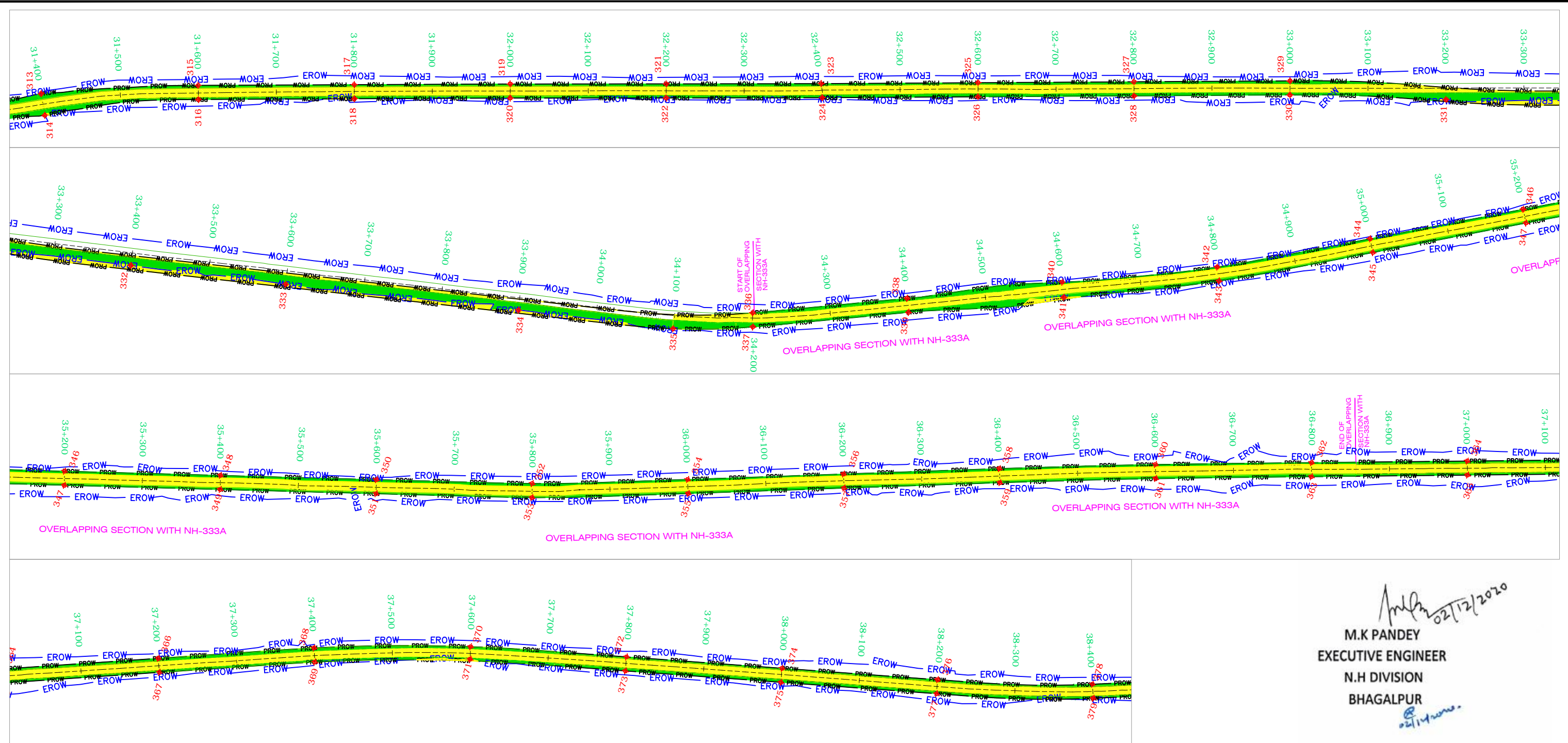
TITLE: FOREST LAND DIVERSION PLAN GEO REFERENCED MAP FROM KM. 25+100 TO 31+400	
SCALE AT A3:	1 : 4000
REV:	P0 / R0
DRG. NO:	005
DATE:	Aug. 2020









 02/12/2020
M.K PANDEY
 EXECUTIVE ENGINEER
 N.H DIVISION
 BHAGALPUR
 02/14/2020

S.NO.	CHAINAGE	VILLAGE NAME	(RHS) FOREST AREA IN Ha.	(LHS) FOREST AREA IN Ha.	TOTAL FOREST AREA IN Ha.
42	31+400 33+860	Kharhara (117)	1.3157	0.5156	1.8313
43	33+860 34+540	Dhaka (51)	0.4619	0.1332	0.5951
44	34+540 37+300	Sondeeha (118)	0.7813	0.9058	1.6871
45	37+300 38+480	Dafarpur (119)	0.3752	0.3189	0.6940

NON FOREST AREA IN SQ. M	749459.0180
NON FOREST AREA IN HA.	74.9459
TALUK	
RANGE	

LEGEND:

EXISTING CENTER LINE		DESIGN CHAINAGE	1234
PROPOSED ROW		FOREST HATCH	
EXISTING ROW		NON FOREST AREA	
VILLAGE BOUNDARY			

CLIENT:

RCD BIHAR,
NH DIVISION



CONSULTANTS:





PROJECT:

Consultancy services for the preparation of Feasibility Study and Detailed Project Report for Improvement to Two lane with paved shoulder of various stretches in state of Bihar. Bhagalpur at NH 33 - Dhaka Mor on NH 333A - Baljhor (Bihar & Jharkhand border).

DRAWN	DEEPAK
DESIGNED	ARVIND
CHECKED	AKSHAY
APPROVED	MAYANK

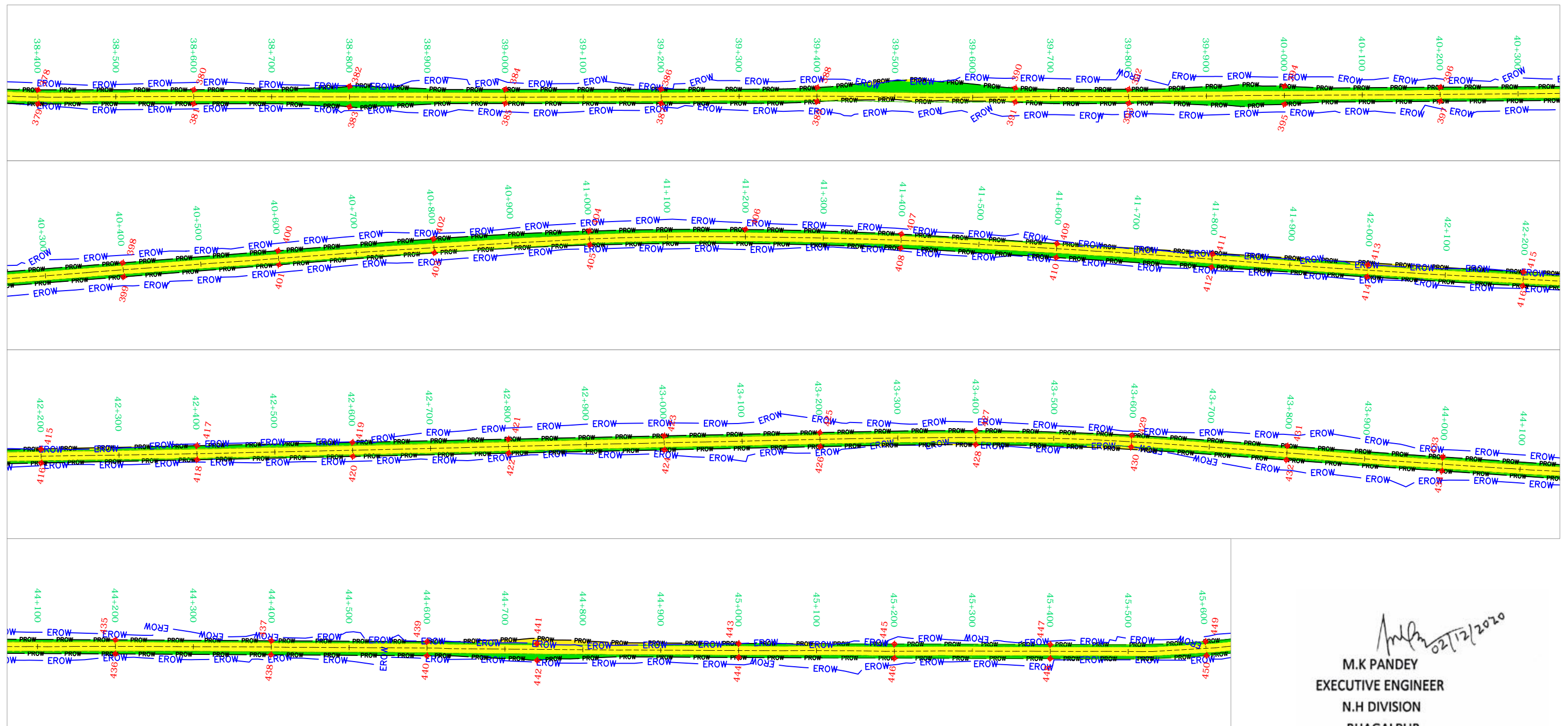
TITLE: FOREST LAND DIVERSION PLAN GEO REFERENCED MAP FROM KM. 31+400 TO 38+480	
SCALE AT A3:	1 : 4000
REV:	PO / R0
DRG. NO:	006
DATE:	Aug. 2020



 02/12/2020
M.K PANDEY
 EXECUTIVE ENGINEER
 N.H DIVISION
 BHAGALPUR
 02/11/2020

S.NO.	CHAINAGE	VILLAGE NAME	(RHS) FOREST AREA IN Ha.	(LHS) FOREST AREA IN Ha.	TOTAL FOREST AREA IN Ha.
46	38+480 41+540	Auria (385)	0.8155	1.3515	2.1670
47	41+540 44+240	Bagduma (386)	0.7924	0.7282	1.5206
48	44+240 45+300	Kasbamandar (383)	0.3996	0.2134	0.6131
49	45+300 45+600	Bausi (419)	0.1016	0.0779	0.1795

NON FOREST AREA IN SQ. M	749459.0180
NON FOREST AREA IN HA.	74.9459
TALUK	
RANGE	

LEGEND:

EXISTING CENTER LINE		DESIGN CHAINAGE	1234
PROPOSED ROW		FOREST HATCH	
EXISTING ROW		NON FOREST AREA	
VILLAGE BOUNDARY			

CLIENT:

RCD BIHAR,
NH DIVISION



CONSULTANTS:





PROJECT:

Consultancy services for the preparation of Feasibility Study and Detailed Project Report for Improvement to Two lane with paved shoulder of various stretches in state of Bihar. Bhagalpur at NH 33 - Dhaka Mor on NH 333A - Baljhor (Bihar & Jharkhand border).

DRAWN	DEEPAK
DESIGNED	ARVIND
CHECKED	AKSHAY
APPROVED	MAYANK

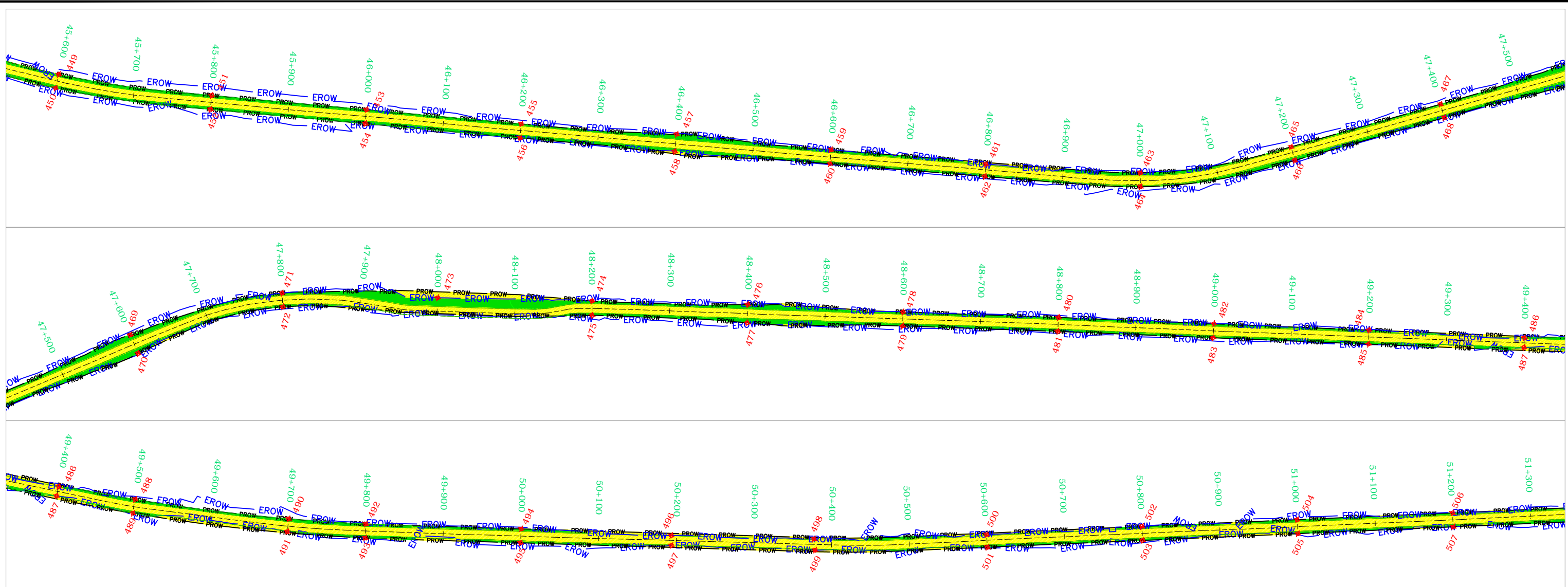
TITLE: FOREST LAND DIVERSION PLAN GEO REFERENCED MAP FROM KM. 38+480 TO 45+600	
SCALE AT A3:	1 : 4000
REV:	PO / R0
DRG. NO:	007
DATE:	Aug. 2020



S.NO.	CHAINAGE	VILLAGE NAME	(RHS) FOREST AREA IN Ha.	(LHS) FOREST AREA IN Ha.	TOTAL FOREST AREA IN Ha.
50	45+600 46+650	Daliya (418)	0.3501	0.3536	0.7037
51	46+650 48+100	Mainwa (417)	0.4075	0.6671	1.0746
52	48+100 48+250	Sujapur (402)	0.0267	0.1149	0.1416
53	48+250 48+870	Dahua (440)	0.2371	0.2175	0.4546
54	48+870 49+020	Nayagoan (409)	0.0407	0.0566	0.0973
55	48+020 49+120	Dahua (440)	0.0301	0.0258	0.0559
56	49+120 49+300	Karuani Kita (406)	0.0546	0.0409	0.0955
57	49+180 49+400	Bhikha Kita (407)	0.0000	0.0000	0.0000
58	49+300 51+900	Dahua Village	0.5848	0.4404	1.0252

 02/12/2020
M.K PANDEY
 EXECUTIVE ENGINEER
 N.H DIVISION
 BHAGALPUR

NON FOREST AREA IN SQ. M	749459.0180
NON FOREST AREA IN HA.	74.9459
TALUK	
RANGE	

LEGEND:

EXISTING CENTER LINE		DESIGN CHAINAGE	1234
PROPOSED ROW		FOREST HATCH	
EXISTING ROW		NON FOREST AREA	
VILLAGE BOUNDARY			

CLIENT:
**RCD BIHAR,
 NH DIVISION**



PROJECT:
 Consultancy services for the preparation of Feasibility Study and Detailed Project Report for Improvement to Two lane with paved shoulder of various stretches in state of Bihar. Bhagalpur at NH 33 - Dhaka Mor on NH 333A - Baljhor (Bihar & Jharkhand border).

DRAWN	DEEPAK
DESIGNED	ARVIND
CHECKED	AKSHAY
APPROVED	MAYANK

TITLE: FOREST LAND DIVERSION PLAN GEO REFERENCED MAP FROM KM. 45+600 TO 51+900	
SCALE AT A3:	1 : 4000
REV:	PO / R0
DRG. NO:	008
DATE:	Aug. 2020

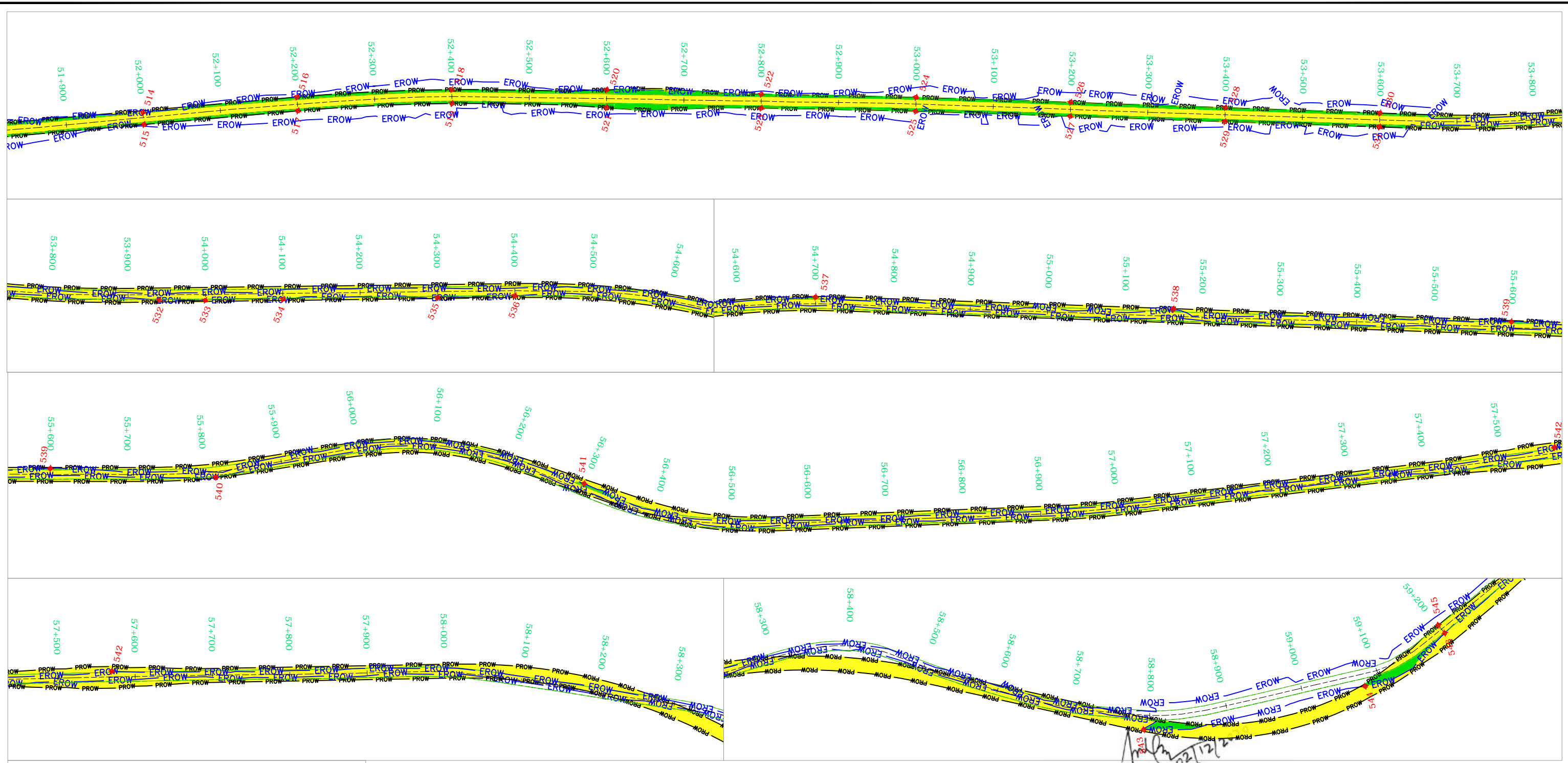

S.NO.	CHAINAGE	VILLAGE NAME	(RHS) FOREST AREA IN Ha.	(LHS) FOREST AREA IN Ha.	TOTAL FOREST AREA IN Ha.
59	51-900 53+650	Sikandarpur (438)	0.5515	0.7196	1.2711
60	53-650 56+500	Sukhia Barait (469)	0.0451	0.0587	0.1038
61	56-500 58+800	Bhaga (470)	0.0000	0.0074	0.0074
62	58-800 59+510	Gokula (471)	0.1679	0.0019	0.1698

M.K PANDEY
EXECUTIVE ENGINEER
N.H DIVISION
BHAGALPUR

NON FOREST AREA IN SQ. M	749459.0180
NON FOREST AREA IN HA.	74.9459
TALUK	
RANGE	

LEGEND:

EXISTING CENTER LINE		DESIGN CHAINAGE	1234
PROPOSED ROW		FOREST HATCH	
EXISTING ROW		NON FOREST AREA	
VILLAGE BOUNDARY			

CLIENT:
RCD BIHAR,
NH DIVISION

CONSULTANTS:

PROJECT:
Consultancy services for the preparation of Feasibility Study and Detailed Project Report for Improvement to Two lane with paved shoulder of various stretches in state of Bihar. Bhagalpur at NH 33 - Dhaka Mor on NH 333A - Baljhor (Bihar & Jharkhand border).

DRAWN	DEEPAK
DESIGNED	ARVIND
CHECKED	AKSHAY
APPROVED	MAYANK

TITLE: FOREST LAND DIVERSION PLAN GEO REFERENCED MAP FROM KM. 51+900 TO 59+510	
SCALE AT A3:	1 : 4000
REV:	PO / R0
DRG. NO:	009
DATE:	Aug. 2020

