

Copensatory afforastation Area of 3.84 Ha. of Village Tivareghea Prachitgad, Tah. Sangmeshwar, Dist. Ratnagiri Against Diversion of 3.84 Ha. forest land for Non Forest Use i.e. for Indusrial Unit of Ashok Leyland in District Bhandara in the state of Maharashtra.

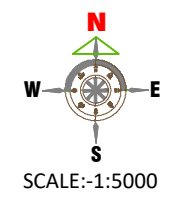
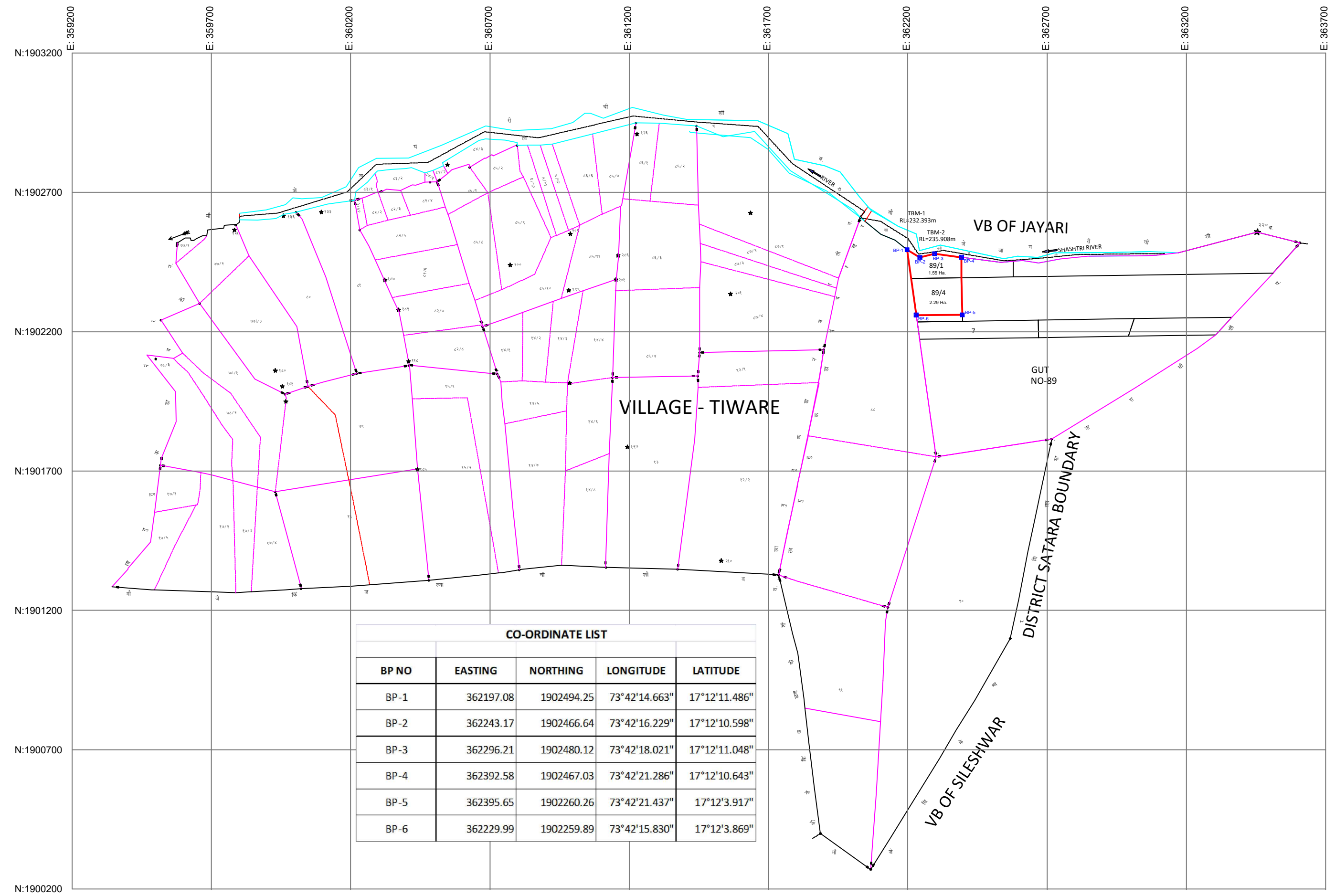

CO-ORDINATE LIST				
BP NO	EASTING	NORTHING	LONGITUDE	LATITUDE
BP-1	362197.08	1902494.25	73°42'14.663"	17°12'11.486"
BP-2	362243.17	1902466.64	73°42'16.229"	17°12'10.598"
BP-3	362296.21	1902480.12	73°42'18.021"	17°12'11.048"
BP-4	362392.58	1902467.03	73°42'21.286"	17°12'10.643"
BP-5	362395.65	1902260.26	73°42'21.437"	17°12'3.917"
BP-6	362229.99	1902259.89	73°42'15.830"	17°12'3.869"

--	--	--