

HILLAJHORA COMPARTMENT OF UPPER TENDU (CHALSA RANGE) UNDER JALPAIGURI DIVISION,
DIST- JALPAIGURI, W.B. (NEAR CHAPRAMARI RLY. STN.)
(LAT: 26°53'33.4" LONG: 88°51'45.94")

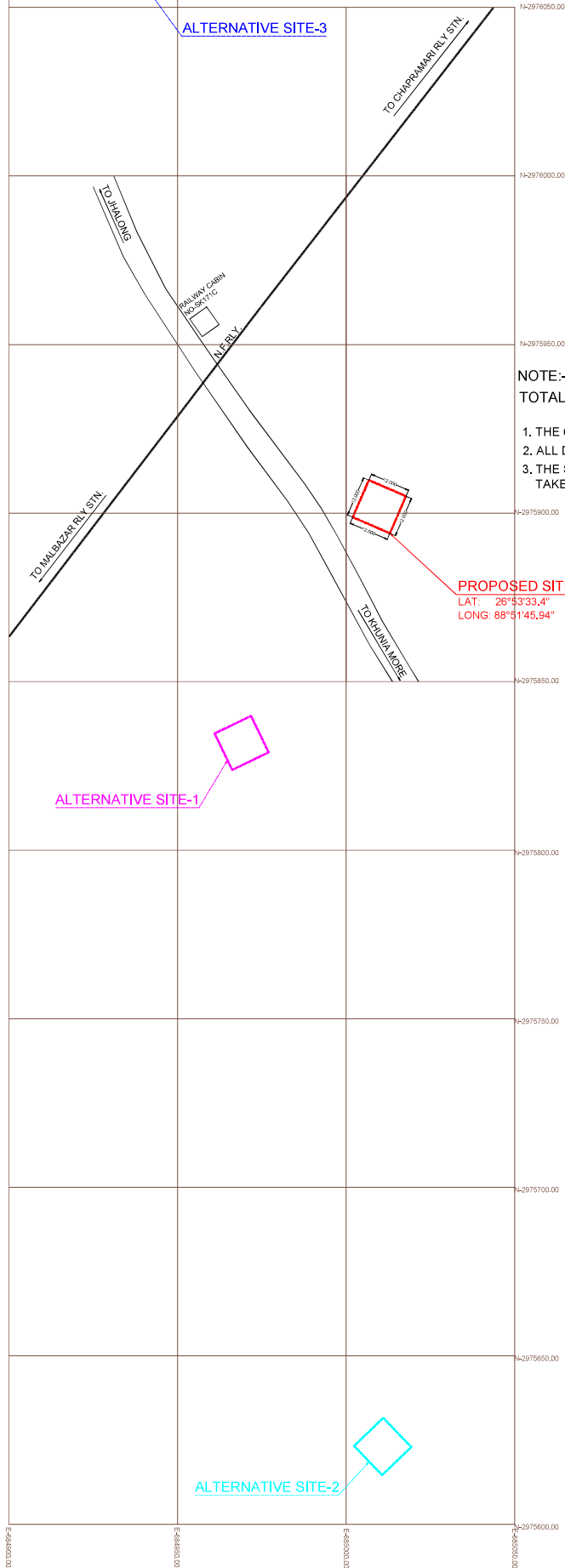

NOTE:-

TOTAL PROPOSED AREA FOR TOWER INSTALATION IS 144 SQM OR 0.0355 ACRES

1. THE COORDINATES GETTING FROM GPS HAVE CONSIDERED FOR SURVEY WORK
2. ALL DIMENSIONS ARE IN METERS.
3. THE SURVEY IS ORIENTED W.R.T MAGNETIC NORTH AND BEARING TAKEN AT 1ST STN.

RELIANCE JIO INFOCOMM.LTD
Ashish Dasgupta
AUTHORISED SIGNATORY

LEGEND-

- PROPOSED AREA-
- ALTERNATIVE SITE-1
- ALTERNATIVE SITE-2
- ALTERNATIVE SITE-3
- BLACK TOP ROAD-
- RAILWAY TRACK-
- DIMENSIONS-
- TREE-
- SPOT LEVEL-

DRAWING NO:-
GS/RELIANCE JIO/LOCATION PLAN /CHAPRAMARI RLY. STN./2021/1 OF 1

REV	CHK BY	APPV BY	ISSUED BY	DATE
R0	MB	RC	RC	JUNE, 2021

SCALE:-1:500

SURVEYED BY:-
GLOBAL SURVEYORS
PLOT OFFICE- 88/4000 B BARUPOHA
P.O.- SEARSOLE HALDIBARI,
DIST- JALPAIGURI (W.B.)
PIN- 743432/7231, 7241 240000 (R)
PHONE- 98343 37508
EMAIL- globalsurveyors2001@rediffmail.com
(AN ISO 9001:2008 CERTIFIED FIRM)

CLIENT -

RELIANCE JIO

BLOCK- 3B(3RD FLOOR) ECHO SPACE BUSINESS PARK, NEW TOWN, KOLKATA-157

TITLE- DETAILS LOCATION PLAN OF PROPOSED SITE (Size : 12M X12M) FOR INSTALLATION OF TOWER

PLACE- HILLAJHORA COMPARTMENT OF UPPER TENDU (CHALSA RANGE) UNDER JALPAIGURI
DIVISION, DIST- JALPAIGURI, W.B. (NEAR CHAPRAMARI RLY. STN.)