

VILLAGE MAP SHOWING PROPOSED 8.676 HECTARE DEGRADED FOREST LAND FOR CA PLANTATION IN SUNKADAKALLU VILLAGE  
SURVEY NO. 435 (PALAYANAKOTE FOREST BLOCK- 3) IN SUNKADAKALLU SOUTH WEST EXTENSION RF OF KUDLIGI RANGE  
IN VIJAYANAGARA DIVISION OF KARNATAKA STATE

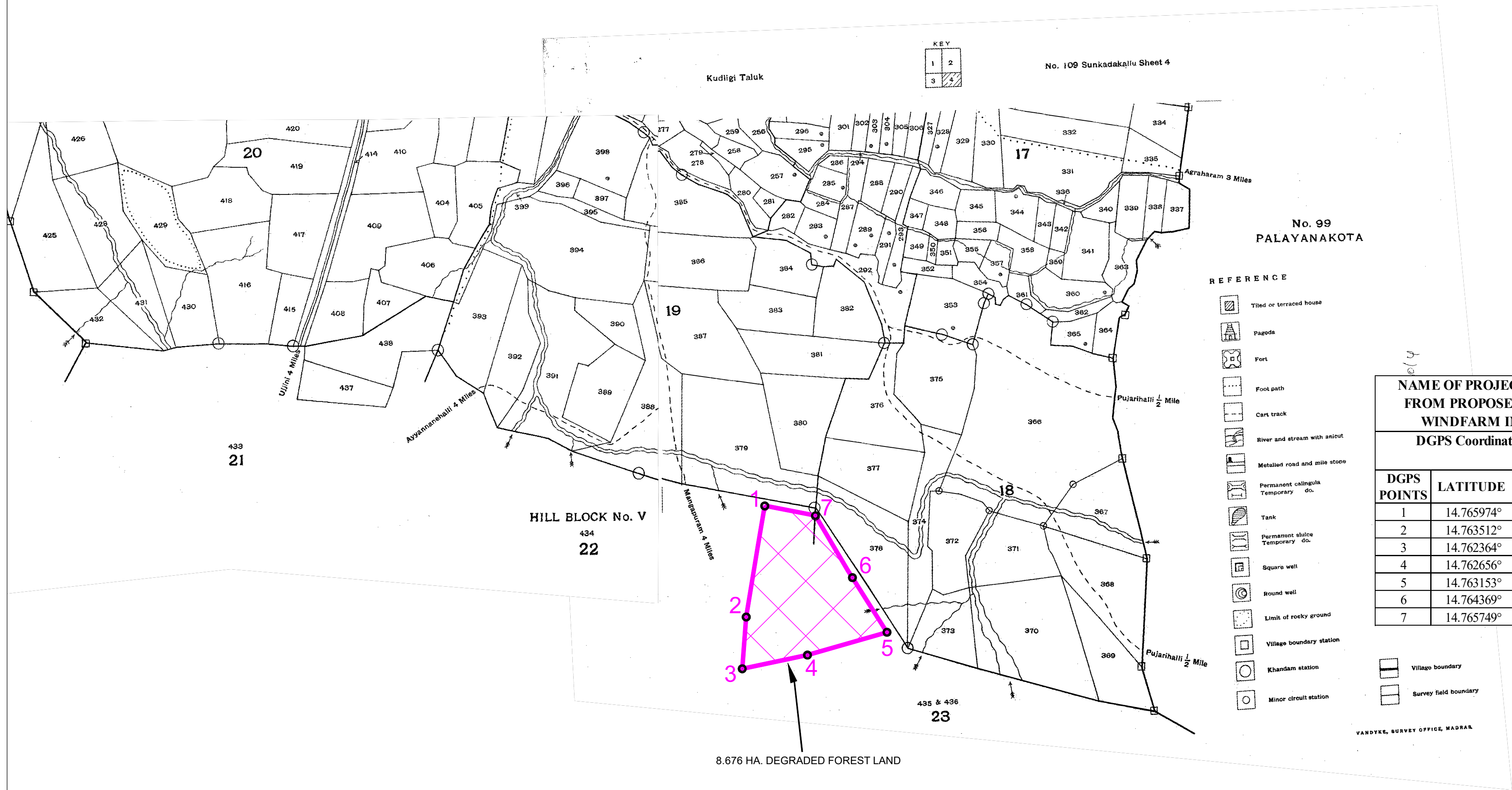

NORTH  
SCALE - 1:7,920

SYMBOL	DESCRIPTION
	8.676 HA. DEGRADED FOREST LAND
	GPS POINTS

NAME OF PROJECT: CONSTRUCTION OF 33 KV D/C TRANSMISSION LINE FROM PROPOSED 220/33 KV POOLING SUBSTATION TO THE PROPOSED WINDFARM IN KUDLIGI RANGE OF VIJAYANAGARA DISTRICT IN						
DGPS Coordinates (Degree, Decimal) of 8.676 Ha. Degraded Forest Land for Compensatory Afforestation						
DGPS POINTS	LATITUDE	LONGITUDE	AREA IN (HA.)	VILLAGE NAME	RANGE	SURVEY NO.
1	14.765974°	76.325247°	8.676	Sunkadakallu	Kudligi	435 (Palayanakote Forest Block No. 3)
2	14.763512°	76.324811°				
3	14.762364°	76.324714°				
4	14.762656°	76.326200°				
5	14.763153°	76.328012°				
6	14.764369°	76.327234°				
7	14.765749°	76.326399°				