

**RAJASTHAN**

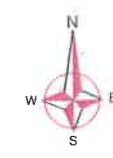
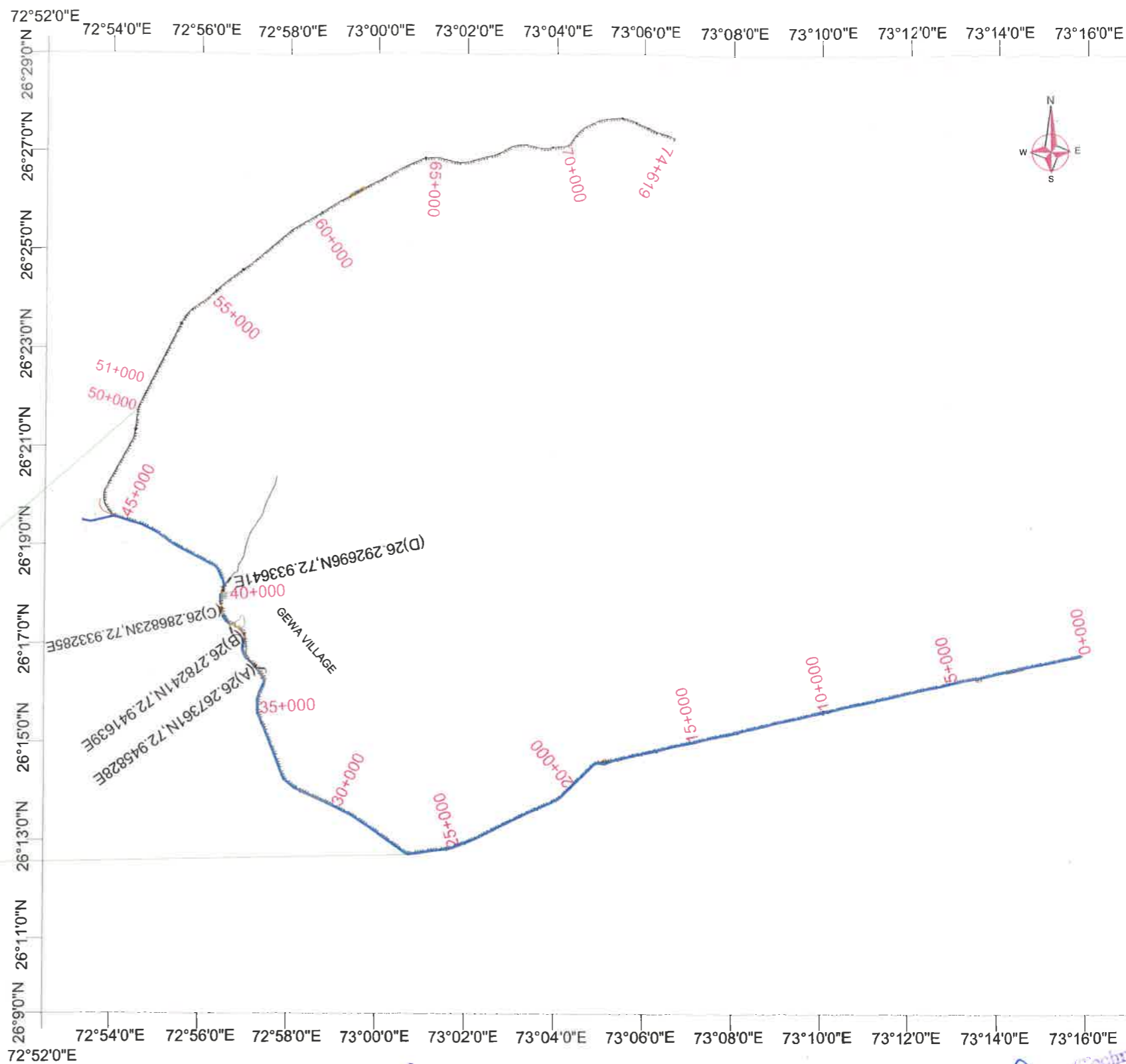
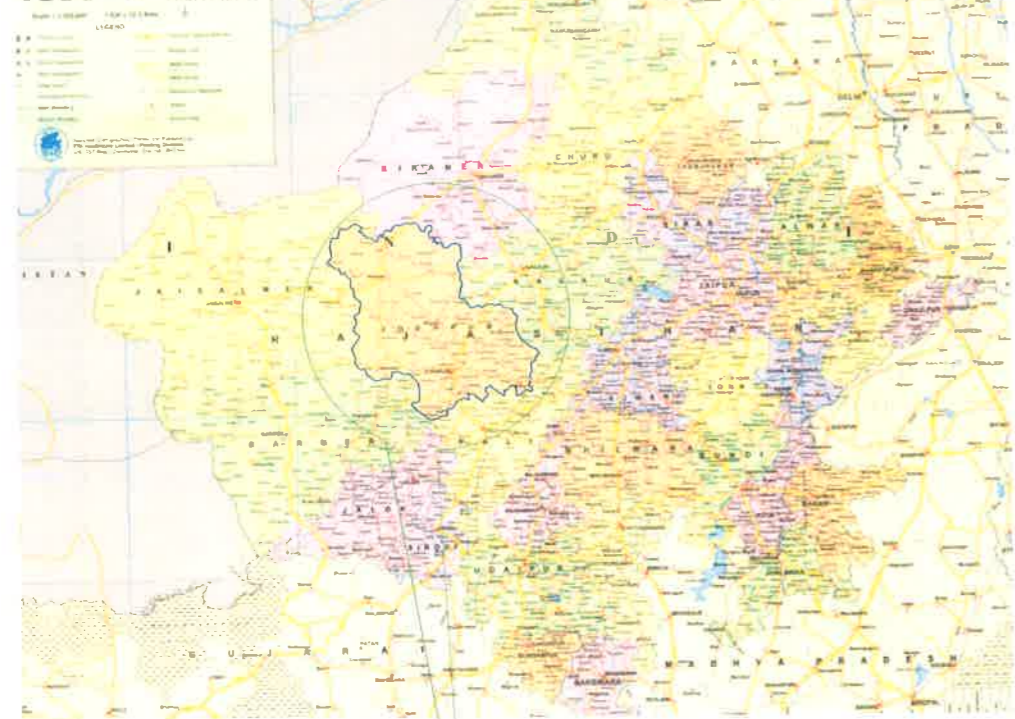

LEGEND	
Acquired Protected Forest Area	
Existing ROW	
Existing Road Center line	
Existing Paved Road	
Proposed ROW	
Proposed Center line	
Khasra Boundary	
Village Boundary	
District Boundary	
Forest Boundary	
GPS Point	

NOTES:-  
 1. All Dimensions are in Meters Except Kilometer Stones.  
 2. All Land Area in Square Meters.

CLIENT:  
**NATIONAL HIGHWAYS AUTHORITY OF INDIA**

CONSULTANT:  
**FEEDBACK INFRA**  
 Making Infrastructure Happen  
 Feedback Infras Private Limited  
 15th Floor, Tower 9B  
 DLF Cyber City Phase-III,  
 Gurgaon 122 002

The information contained herein is Confidential & Property of Feedback Infra Private Limited and not for Publication. The Information is Issued on the Understanding that no part thereof shall be Copied or Communicated to a Third Party without Authorisation in Writing from Feedback Infra Private Limited

Drawn by:	D.J		STATUS:	FP/RAJ/ROAD/32975/2018
Designed by:	M.K.N		PROJECT:	Preparation of Project Report for Jodhpur Ring Road in the State of Rajasthan, Section-I Dangiyawas to Keru.
Checked by:	R.M		TITLE:	Georeference Map of Road PF Jodhpur Ring Road
Approved By:	P.R		DRG NO.:	FIPL/HW/JR/GRM-01
Scale:	As Shown	Date:	Aug - 2018	REV. R-0
			SHEET:	6

Manager (Technical)  
 Jodhpur

Point No.	Latitude (N)			Longitude (E)			Area in (Ha)
	Degree	Minute	Second	Degree	Minute	Second	
A01	26	15	59.87	72	56	47.83	2414.0673
A02	26	16	1.11	72	56	46.70	
A03	26	16	2.27	72	56	45.85	
A04	26	16	3.58	72	56	44.47	
A05	26	16	4.74	72	56	43.39	
A06	26	16	5.50	72	56	42.73	
A07	26	16	6.02	72	56	42.10	
A08	26	16	7.17	72	56	40.68	
A09	26	16	8.08	72	56	39.43	
A10	26	16	9.20	72	56	38.02	
A11	26	16	9.92	72	56	37.11	
A12	26	16	10.88	72	56	35.96	
A13	26	16	11.80	72	56	35.27	
A15	26	16	11.72	72	56	35.71	
A16	26	16	11.14	72	56	36.36	
A17	26	16	10.23	72	56	37.49	
A18	26	16	9.52	72	56	38.35	
A19	26	16	8.93	72	56	39.79	
A20	26	16	7.37	72	56	40.96	
A21	26	16	6.25	72	56	42.32	
A22	26	16	5.70	72	56	42.99	
A23	26	16	5.04	72	56	43.78	
A24	26	16	4.16	72	56	44.85	
A25	26	16	2.90	72	56	46.31	
A26	26	16	1.99	72	56	47.71	
A27	26	15	59.73	72	56	49.94	
A28	26	15	59.96	72	56	46.95	7752.7266
A29	26	16	1.27	72	56	45.76	
A30	26	16	1.96	72	56	45.14	
A31	26	16	3.21	72	56	44.01	
A32	26	16	4.39	72	56	42.91	
A33	26	16	5.12	72	56	42.23	
A34	26	16	5.61	72	56	41.69	
A35	26	16	6.19	72	56	40.95	
A36	26	16	6.75	72	56	40.34	
A37	26	16	7.71	72	56	38.96	
A38	26	16	8.79	72	56	37.60	
A39	26	16	8.76	72	56	37.57	
A40	26	16	7.27	72	56	38.71	
A41	26	16	6.15	72	56	39.96	
A42	26	16	5.45	72	56	40.09	
A43	26	16	4.99	72	56	41.13	
A44	26	16	3.71	72	56	42.19	
A45	26	16	2.62	72	56	43.51	
A46	26	16	1.18	72	56	45.16	
A47	26	16	0.01	72	56	46.38	1339.4391
A48	26	16	34.77	72	56	30.82	
A49	26	16	35.01	72	56	30.75	
A50	26	16	35.36	72	56	30.57	
A51	26	16	35.34	72	56	30.89	
A52	26	16	35.31	72	56	31.85	
A53	26	16	34.57	72	56	31.73	
A54	26	16	33.58	72	56	31.95	
A55	26	16	32.79	72	56	31.39	
A56	26	16	34.09	72	56	31.00	

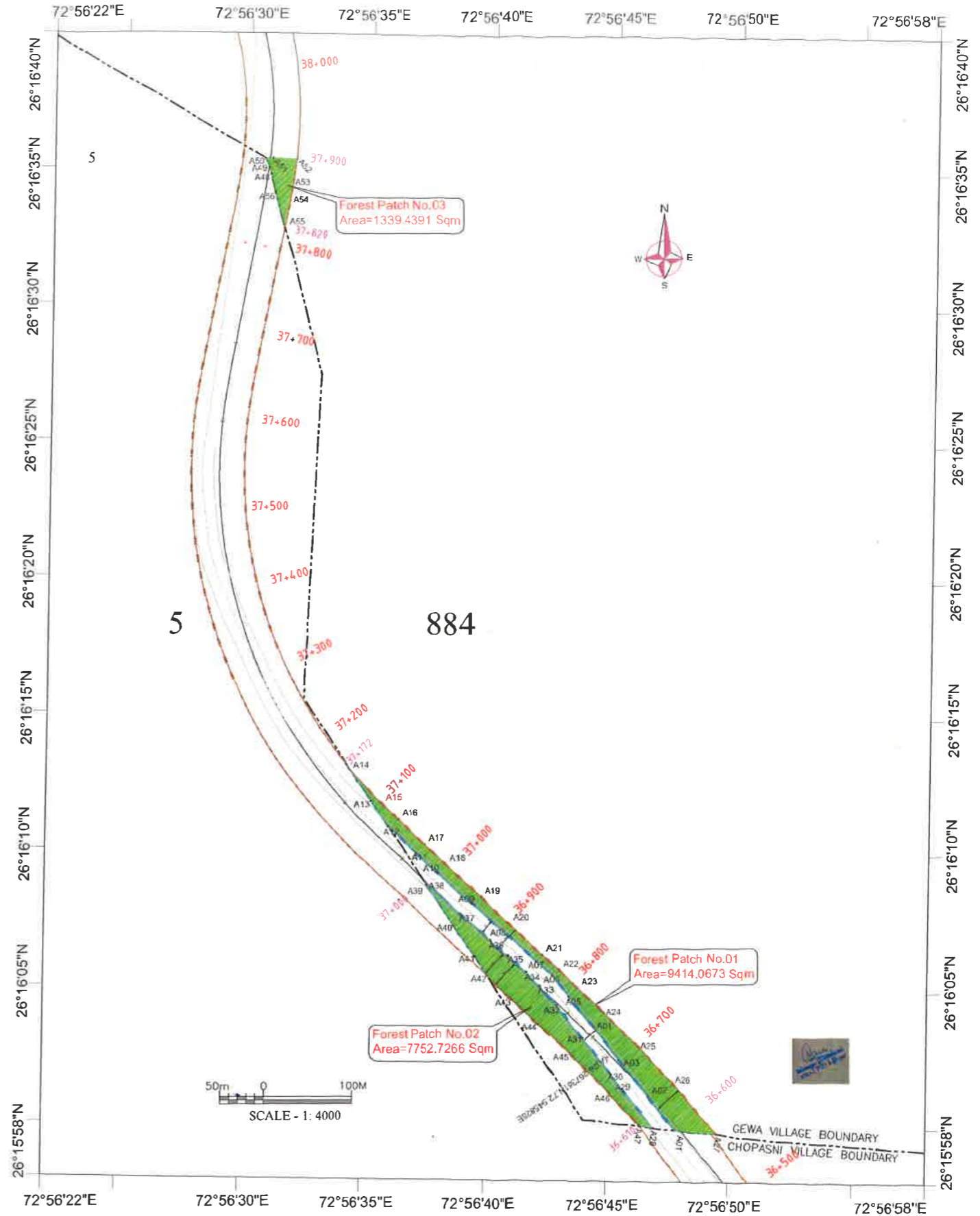

*P. Singh (Technical)*  
 Manager  
 NHAI, PTU Jodhpur

NOTES:-  
 1. All Dimensions are in Meters Except Kilometer Stones.  
 2. All Land Area in Square Meters.

REV	DATE	DESCRIPTION OF REVISIONS	BY

LEGEND

	Acquired Protected Forest Area
	Existing ROW
	Existing Road Center line
	Existing Paved Road
	Proposed ROW
	Proposed Center line
	Khasra Boundary
	Village Boundary
	District Boundary
	Forest Boundary
	GPS Point

CLIENT

**NATIONAL HIGHWAYS AUTHORITY OF INDIA**

CONSULTANT:

**FEEDBACK INFRA**  
 Making Infrastructure Happen

Feedback Infra Private Limited  
 15th Floor, Tower 9B  
 DLF Cyber City Phase-III  
 Gurgaon 122 002

The information contained herein is Confidential & Property of Feedback Infra Private Limited and not for Publication. The Information is Issued on the Understanding that no part thereof shall be Copied or Communicated to a Third Party without Authorization in Writing from Feedback Infra Private Limited

Drawn by:	D J	STATUS	FP/RAJ/ROAD/32975/2018
Designed by:	M K N	PROJECT	Preparation of Project Report for Jodhpur Ring Road in the State of Rajasthan, Section-I Dangiyawas to Keru.
Checked by:	RM	TITLE	Georeference Map of Road Forest Land Gewa Village Jodhpur Ring Road
Approved By:	PR	DRG NO	FIPL/HW/JR/GRM-02
Scale:	1:4000	REV	0
Date:	Sept - 2018	SHEET	01 of 03

Point No.	Latitude (N)			Longitude (E)			Area in (Ha)
	Degree	Minute	Second	Degree	Minute	Second	
B01	26	16	35.51	72	56	30.26	17035.348
B02	26	16	35.55	72	56	30.57	
B03	26	16	35.34	72	56	30.89	
B04	26	16	35.31	72	56	31.88	
B05	26	16	36.34	72	56	31.92	
B06	26	16	38.37	72	56	31.86	
B07	26	16	41.27	72	56	31.18	
B08	26	16	42.73	72	56	30.55	
B09	26	16	44.71	72	56	29.33	
B10	26	16	45.56	72	56	28.68	
B11	26	16	46.99	72	56	27.22	
B12	26	16	48.17	72	56	25.68	
B13	26	16	47.69	72	56	24.83	
B14	26	16	48.77	72	56	22.67	
B15	26	16	51.71	72	56	16.80	
B16	26	16	53.18	72	56	13.85	
B17	26	16	53.64	72	56	14.69	
B18	26	16	54.30	72	56	13.29	
B19	26	16	55.67	72	56	10.48	
B20	26	16	56.68	72	56	8.77	
B21	26	16	58.24	72	56	6.79	
B22	26	16	57.72	72	56	6.86	
B23	26	16	56.87	72	56	6.67	
B24	26	16	56.43	72	56	7.48	
B25	26	16	55.34	72	56	9.40	
B26	26	16	54.43	72	56	11.17	
B27	26	16	53.52	72	56	13.01	
B28	26	16	53.13	72	56	13.81	
B29	26	16	51.72	72	56	16.80	
B30	26	16	49.38	72	56	21.28	
B31	26	16	47.63	72	56	24.76	
B32	26	16	46.59	72	56	26.72	
B33	26	16	46.09	72	56	27.61	
B34	26	16	45.44	72	56	28.46	
B35	26	16	44.67	72	56	29.15	
B36	26	16	43.78	72	56	29.67	
B37	26	16	42.90	72	56	30.04	
B38	26	16	41.14	72	56	30.44	
B39	26	16	40.10	72	56	30.55	
B40	26	16	38.40	72	56	30.51	
B41	26	16	36.61	72	56	30.39	

Point No.	Latitude (N)			Longitude (E)			Area in (Ha)
	Degree	Minute	Second	Degree	Minute	Second	
B41	26	16	36.61	72	56	30.39	9565.198
B42	26	16	38.59	72	56	29.65	
B43	26	16	40.05	72	56	29.68	
B44	26	16	41.04	72	56	29.57	
B45	26	16	41.82	72	56	29.43	
B46	26	16	42.67	72	56	29.20	
B47	26	16	43.46	72	56	28.87	
B48	26	16	44.23	72	56	28.42	
B49	26	16	44.88	72	56	27.84	
B50	26	16	45.45	72	56	27.09	
B51	26	16	45.92	72	56	26.26	
B52	26	16	46.37	72	56	25.44	
B53	26	16	47.19	72	56	23.84	
B54	26	16	47.85	72	56	22.50	
B55	26	16	48.33	72	56	21.57	
B56	26	16	49.12	72	56	20.01	
B57	26	16	49.89	72	56	18.49	
B58	26	16	50.86	72	56	16.52	
B59	26	16	51.38	72	56	15.51	
B60	26	16	52.25	72	56	13.78	

Point No.	Latitude (N)			Longitude (E)			Area in (Ha)
	Degree	Minute	Second	Degree	Minute	Second	
B61	26	16	52.95	72	56	12.33	9565.198
B62	26	16	53.64	72	56	10.94	
B63	26	16	54.57	72	56	9.13	
B64	26	16	54.27	72	56	9.37	
B65	26	16	53.94	72	56	9.49	
B66	26	16	53.11	72	56	11.17	
B67	26	16	52.05	72	56	13.40	
B68	26	16	51.14	72	56	15.31	
B69	26	16	50.46	72	56	16.75	
B70	26	16	49.62	72	56	18.50	
B71	26	16	48.86	72	56	20.09	
B72	26	16	48.18	72	56	21.52	
B73	26	16	47.72	72	56	22.45	
B74	26	16	47.00	72	56	23.77	
B75	26	16	45.90	72	56	25.35	
B76	26	16	44.60	72	56	26.73	
B77	26	16	43.38	72	56	27.71	
B78	26	16	42.47	72	56	28.29	
B79	26	16	41.23	72	56	28.90	
B80	26	16	40.03	72	56	29.33	

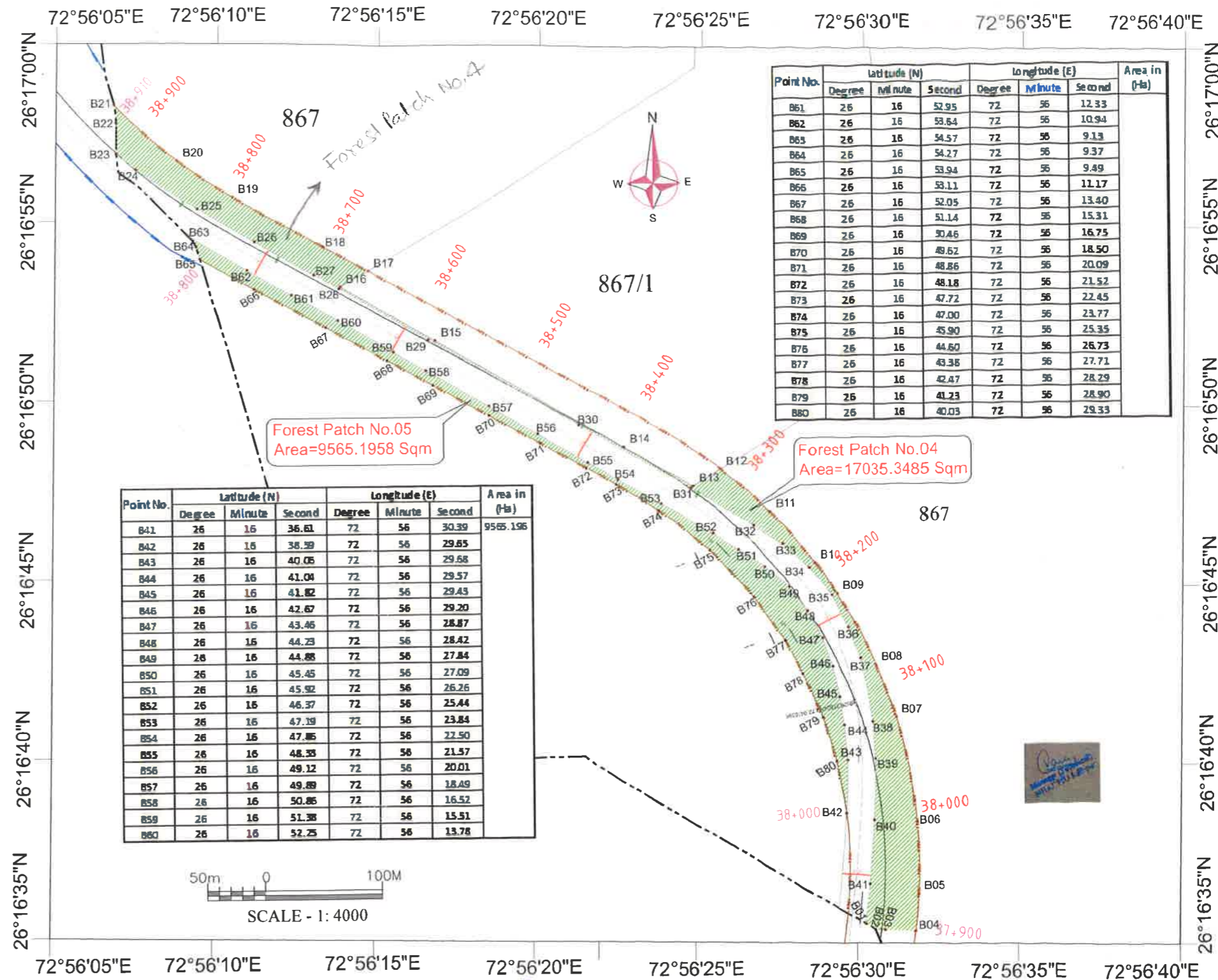

LEGEND	
Acquired Protected Forest Area	
Existing ROW	
Existing Road Center line	
Existing Paved Road	
Proposed ROW	
Proposed Center line	
Khasra Boundary	
Village Boundary	
District Boundary	
Forest Boundary	
GPS Point	

NOTES:-  
 1. All Dimensions are in Meters Except Kilometer Stones.  
 2. All Land Area in Square Meters.

CLIENT:  
  
**NATIONAL HIGHWAYS AUTHORITY OF INDIA**

CONSULTANT:  
**FEEDBACK INFRA**  
 Feedback Infras Private Limited  
 15th Floor, Tower 9B  
 DLF Cyber City Phase-III,  
 Gurgaon 122 002

The information contained herein is Confidential & Property of Feedback Infra Private Limited and not for Publication. The Information is Issued on the Understanding that no part thereof shall be Copied or Communicated to a Third Party without Authorisation in Writing from Feedback Infra Private Limited

Drawn by:	D.J.	
Designed by:	M.K.N.	
Checked by:	R.M.	
Approved By:	P.R.	
Scale:	1:4000	
Date:	Sept - 2018	

STATUS:	PP/RAD/ROAD/32945/2018
PROJECT:	Preparation of Project Report for Jodhpur Ring Road in the State of Rajasthan, Section-I Dangiyawas to Keru.
TITLE:	Georeference Map of Road Forest Land Gewa Village Jodhpur Ring Road
DRG NO:	FIPL/HW/JR/GRM-02
REV. R-0	SHEET: 02 of 03

S No.	Name of District	Name of Taluka	Name of Village	Design Chainage		Length in km	Proposed ROW in mtr	LHS/RHS	Survey No.	Type of Land	Nature of Land	Required Area in (Sqm)
				From	To							
1				36+600	37-172	0.572	60	RHS	884	Govt	Forest	9414.0673
2				36+610	37+000	0.390	60	LHS	884	Govt	Forest	7752.7266
3				37+820	37+900	0.080	60	RHS	884	Govt	Forest	1339.4391
4				37+900	38+910	1.010	60	RHS	867	Govt	Forest	17095.349
5				38+000	38+800	0.800	60	LHS	867	Govt	Forest	9565.1958
6	Jodhpur	Jodhpur	Gewa	39+160	39+772	0.612	60	RHS	867	Govt	Forest	10422.402
7				39+180	39+585	0.405	60	LHS	867	Govt	Forest	5435.3423
8				39+930	40+020	0.090	60	RHS	867	Govt	Forest	1428.9802
9				39+900	40+020	0.120	60	LHS	867	Govt	Forest	1500.4838
10				40+020	40+310	0.290	60	RHS	858	Govt	Forest	6775.8433
11				40+020	40+255	0.235	60	LHS	858	Govt	Forest	4670.2368
Total Required Land= 73940.085												

Point No.	Latitude (N)			Longitude (E)			Area in (Ha)
	Degree	Minute	Second	Degree	Minute	Second	
C01	26	17	3.79	72	56	2.92	10422.402
C02	26	17	4.91	72	56	2.53	
C03	26	17	7.29	72	56	1.97	
C04	26	17	9.84	72	56	1.47	
C05	26	17	12.88	72	56	0.88	
C06	26	17	15.28	72	56	0.42	
C07	26	17	17.84	72	55	59.92	
C08	26	17	20.06	72	55	59.51	
C09	26	17	22.49	72	55	59.29	
C10	26	17	23.16	72	55	58.54	
C11	26	17	20.12	72	55	58.86	
C12	26	17	17.77	72	55	59.27	
C13	26	17	15.16	72	55	59.76	
C14	26	17	12.76	72	56	0.23	
C15	26	17	9.80	72	56	0.82	
C16	26	17	7.20	72	56	1.34	
C17	26	17	6.83	72	56	1.43	
C18	26	17	4.77	72	56	2.08	
C19	26	17	4.01	72	56	2.33	
C20	26	17	4.38	72	56	1.30	5435.3423
C21	26	17	5.70	72	56	0.87	
C22	26	17	6.64	72	56	0.58	
C23	26	17	7.51	72	56	0.37	
C24	26	17	9.37	72	56	0.02	
C25	26	17	11.16	72	55	59.67	
C26	26	17	12.51	72	55	59.40	
C27	26	17	13.87	72	55	59.13	
C28	26	17	15.23	72	55	58.86	
C29	26	17	16.20	72	55	58.66	
C30	26	17	17.15	72	55	58.50	
C31	26	17	14.95	72	55	58.47	
C32	26	17	13.35	72	55	58.61	
C33	26	17	11.68	72	55	58.83	
C34	26	17	10.44	72	55	59.13	
C35	26	17	7.38	72	55	59.98	
C36	26	17	4.51	72	56	0.78	
C37	26	17	28.34	72	55	59.91	1428.9802
C38	26	17	30.32	72	56	0.54	
C39	26	17	31.02	72	56	0.75	
C40	26	17	31.06	72	56	1.43	
C41	26	17	30.14	72	56	1.17	
C42	26	17	28.73	72	56	0.74	
C43	26	17	28.58	72	56	0.10	
C44	26	17	27.33	72	55	58.62	1500.4838
C45	26	17	29.42	72	55	59.35	
C46	26	17	30.55	72	55	59.70	
C47	26	17	30.96	72	55	59.83	
C48	26	17	30.92	72	55	59.16	
C49	26	17	30.71	72	55	59.10	
C50	26	17	29.19	72	55	58.64	

Point No.	Latitude (N)			Longitude (E)			Area in (Ha)
	Degree	Minute	Second	Degree	Minute	Second	
D01	26	17	31.00	72	56	0.53	6775.8433
D02	26	17	31.85	72	56	1.06	
D03	26	17	34.62	72	56	1.70	
D04	26	17	36.06	72	56	2.38	
D05	26	17	38.22	72	56	2.85	
D06	26	17	39.21	72	56	3.03	
D07	26	17	40.29	72	56	4.01	
D08	26	17	38.55	72	56	3.78	
D09	26	17	36.88	72	56	3.36	
D10	26	17	34.44	72	56	2.90	
D11	26	17	33.72	72	56	2.32	
D12	26	17	32.63	72	56	1.95	
D13	26	17	31.06	72	56	1.43	
D14	26	17	30.97	72	56	0.04	4670.2368
D15	26	17	32.97	72	56	0.61	
D16	26	17	34.86	72	56	1.30	
D17	26	17	36.13	72	56	1.73	
D18	26	17	38.38	72	56	2.41	
D19	26	17	36.39	72	56	0.89	
D20	26	17	34.13	72	56	0.20	
D21	26	17	31.94	72	55	59.46	
D22	26	17	30.92	72	55	59.14	
D23	26	17	30.96	72	55	59.83	

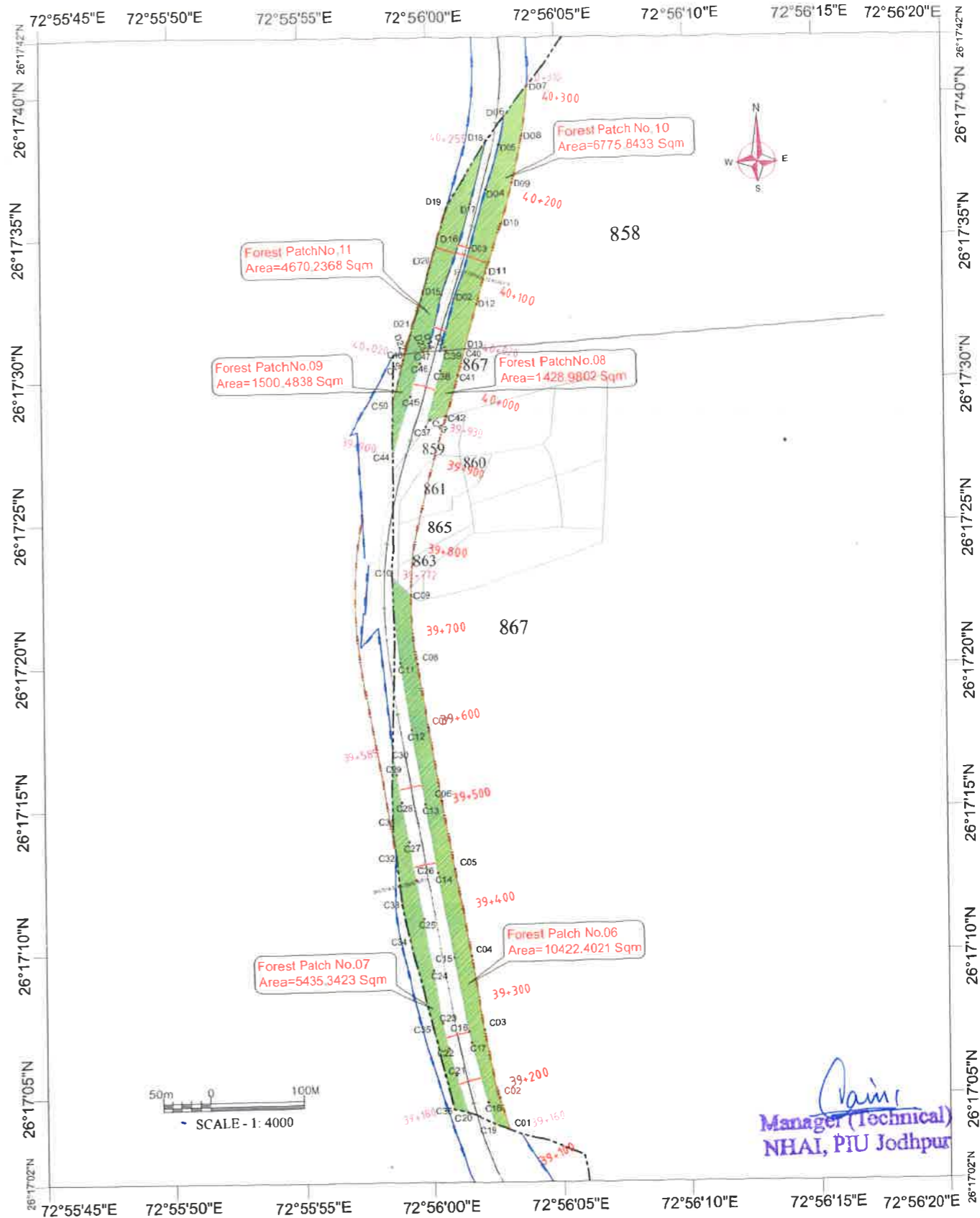

NOTES:  
 1. All Dimensions are in Meters Except Kilometer Stones  
 2. All Land Area in Square Meters

LEGEND	
Acquired Protected Forest Area	
Existing ROW	
Existing Road Center line	
Existing Paved Road	
Proposed ROW	
Proposed Center line	
Khasra Boundary	
Village Boundary	
District Boundary	
Forest Boundary	
GPS Point	

CLIENT: NATIONAL HIGHWAYS AUTHORITY OF INDIA

CONSULTANT: **FEEDBACK INFRA**  
 Making Infrastructure Happen  
 Feedback Infra Private Limited  
 15th Floor, Tower 6B  
 DLF Cyber City Phase-III  
 Gurgaon 122 002

Drawn by:	DJ	STATUS	FP/RAJ/ROAD/32975/2018
Designed by:	MKN	PROJECT	Preparation of Project Report for Jodhpur Ring Road in the State of Rajasthan, Section-I Dangyawas to Keru.
Checked by:	RM	TITLE	Georeference Map of Road Forest Land Gewa Village Jodhpur Ring Road
Approved By:	PR	DRG NO.	FIPL/HW/JR/GRM-02
Scale:	1:4000	REV	0
Date:	Sept - 2018	SHEET	03 of 03

REV	DATE	DESCRIPTION OF REVISIONS	BY