

**GEO-REFERENCE MAP OF THE PROTECTED FOREST LAND PROPOSED TO BE DIVERTED FOR ENTRY/EXIT AND MIDDLE APPROACH TO BPCL RETAIL OUTLET ON ( PILBHIT-BAREILLY-MATHURA ROAD, S.H.- 33) AT KM 135, CHAINAGE 134.022, KHASRA NO.- 489, VILLAGE- MANPUR NAGARIA, TEHSIL.- KASGANJ, DISTRICT.- KASGANJ ( UP)**

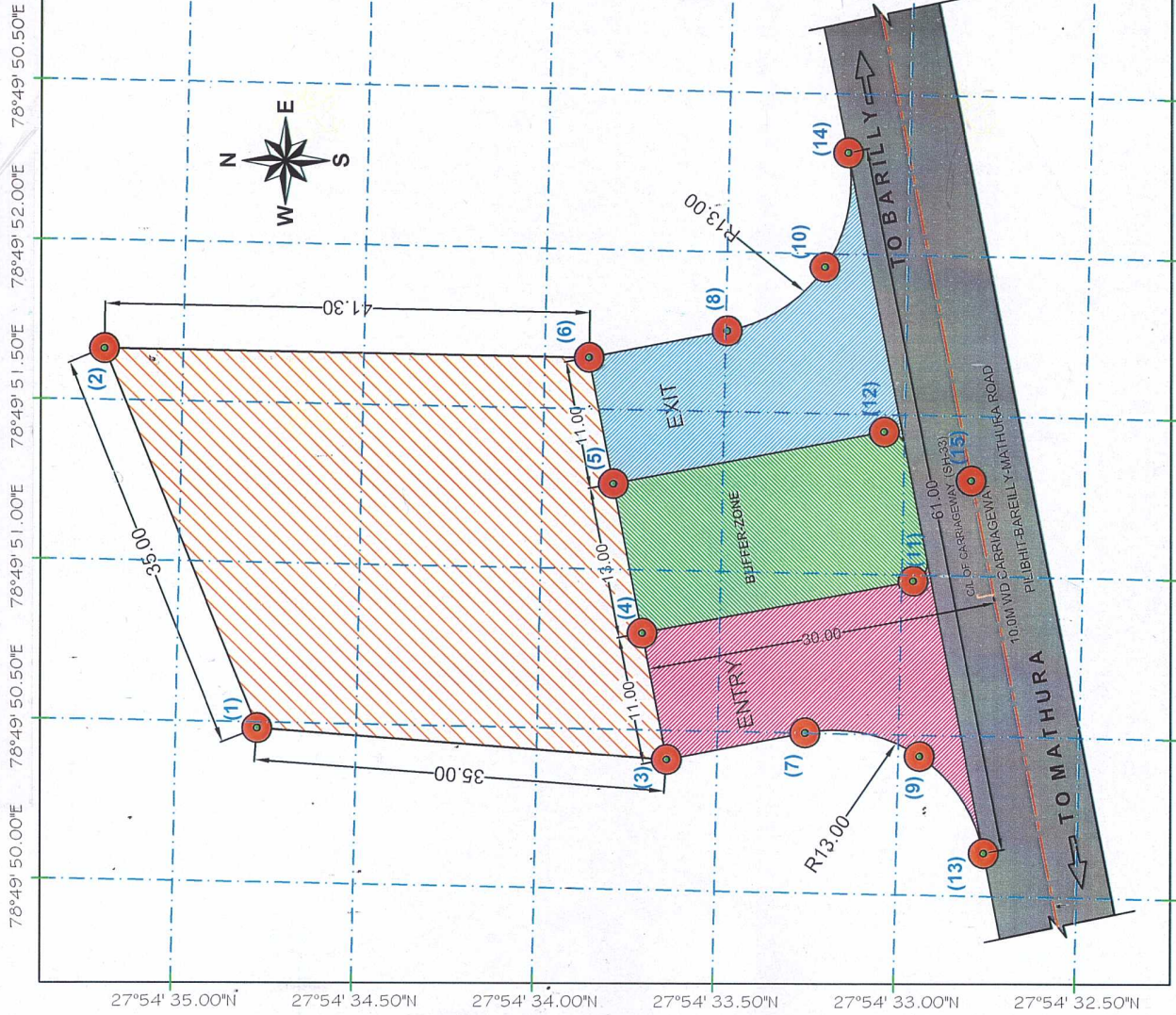

| LOCATION | LONGITUDE      | LATITUDE       |
|----------|----------------|----------------|
| (1)      | 78°49' 50.48"E | 27°54' 34.77"N |
| (2)      | 78°49' 51.66"E | 27°54' 35.21"N |
| (3)      | 78°49' 50.40"E | 27°54' 33.63"N |
| (4)      | 78°49' 50.80"E | 27°54' 33.71"N |
| (5)      | 78°49' 51.26"E | 27°54' 33.80"N |
| (6)      | 78°49' 51.66"E | 27°54' 33.87"N |
| (7)      | 78°49' 50.50"E | 27°54' 33.25"N |
| (8)      | 78°49' 51.75"E | 27°54' 33.49"N |
| (9)      | 78°49' 50.43"E | 27°54' 32.93"N |
| (10)     | 78°49' 51.95"E | 27°54' 33.22"N |
| (11)     | 78°49' 50.98"E | 27°54' 32.96"N |
| (12)     | 78°49' 51.44"E | 27°54' 33.05"N |
| (13)     | 78°49' 50.13"E | 27°54' 32.75"N |
| (14)     | 78°49' 52.31"E | 27°54' 33.16"N |
| (15)     | 78°49' 51.26"E | 27°54' 32.80"N |

- LEGEND**
- GPS CO-ORDINATES OF THE LOCATION
  - 10.0M WIDE CARRIAGE WAY (SH-33)
  - CENTER LINE OF THE CARRIAGE WAY
  - PROPOSED SITE FOR NEW RETAIL-OUTLET
  - PROTECTED FOREST OF ENTRY
  - PROTECTED FOREST OF MIDDLE LAND
  - PROTECTED FOREST OF EXIT

प्रादेशिक प्रबंधक (रिजि.) मथुरा  
 भारत पेट्रोलियम कॉर्पोरेशन लिमिटेड  
 प्लॉट नं. 26 इंडियन पेट्रोलियम लिमिटेड  
 साइड की, मो. रिफाइनरी, मथुरा-281005

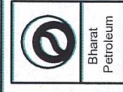

|                          |            |         |         |
|--------------------------|------------|---------|---------|
| NAME OF DRAWING          | G.P.S. MAP |         |         |
| DRAWING NO./PROJECT NO.  | MGR(E)     | MGR(RS) | SDRS/SM |
| MANPUR NAGARIA(KGJ)-2017 |            |         |         |
| SCALE:- AS SHOWN ABOVE   |            |         |         |

*(Tamesh Chatterjee)*