

LAYOUT PLAN OF ALTERNATE LAND FOR FOREST

KHASRA NO.: 763,874,875,912

Village: RAJPURA, Tehsil : ASIND, Distt. BHILWARA

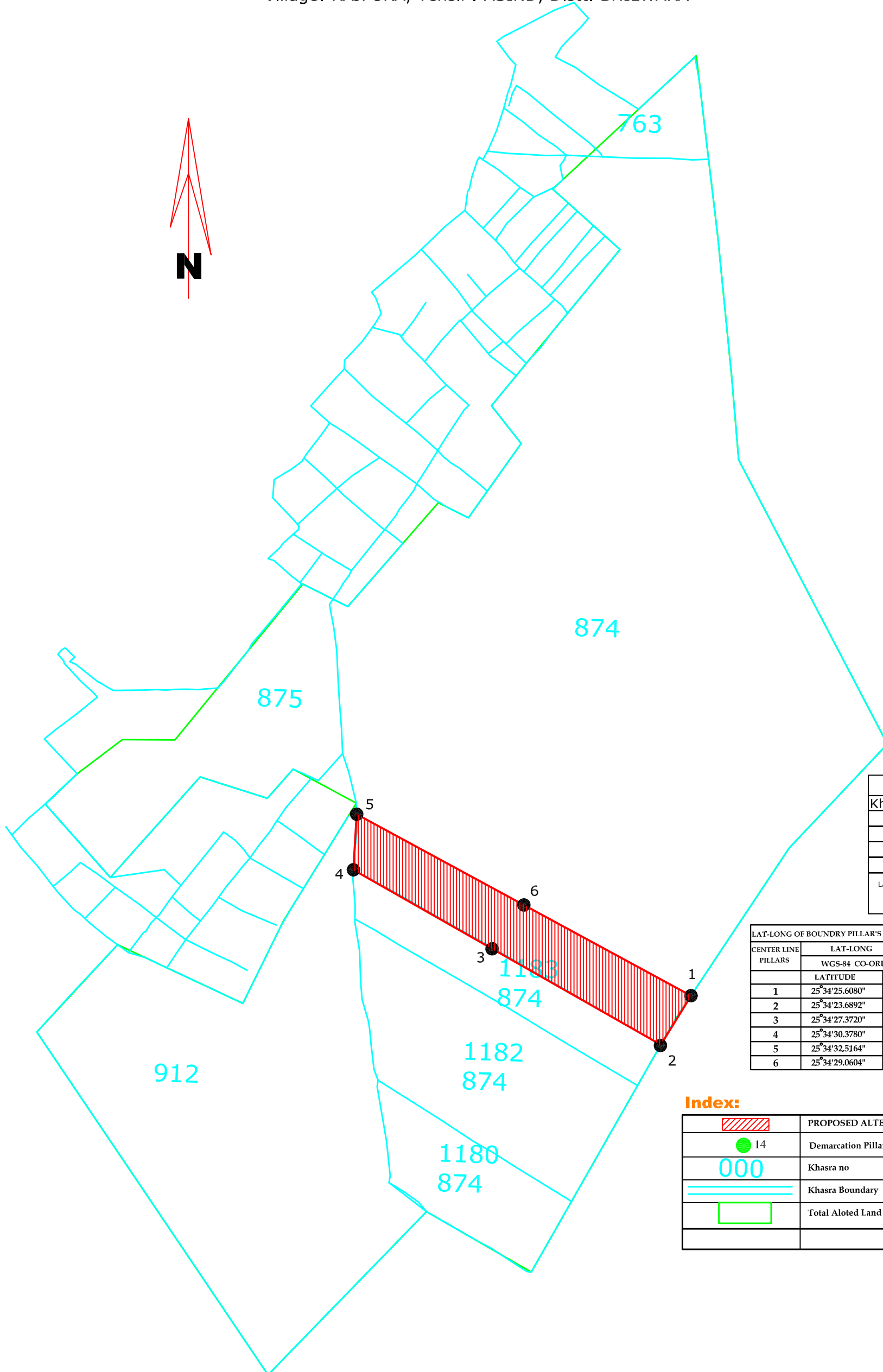

VILLAGE- RAJPURA	
Khasra No.	Area in Hact.
763	2.15
874	45.77
875	5.59
912	15.85
LAND FOR PRPOSAL NO. 20888/2016 KHASARA NO. 874	2.76

LAT-LONG OF BOUNDRY PILLAR'S ON ALTERNATE LAND		
CENTER LINE PILLARS	LAT-LONG	
	WGS-84 CO-ORDINATES	
	LATITUDE	LONGITUDE
1	25°34'25.6080"	74°20'23.5336"
2	25°34'23.6892"	74°20'22.2472"
3	25°34'27.3720"	74°20'15.0974"
4	25°34'30.3780"	74°20'09.2088"
5	25°34'32.5164"	74°20'09.3357"
6	25°34'29.0604"	74°20'16.4347"

Index:

	PROPOSED ALTERNATE LAND
	Demarcation Pillar's
	Khasra no
	Khasra Boundary
	Total Aloted Land

Handwritten signature

EXECUTIVE ENGINEER
PWD (PMGSY-WB)
DIV. - SHAHPURA(BHILWARA)