

Plan Showing the Non-Forest Govt. Land Selected For Compensatory Afforestation in Village Baneikela Under Gurundia Tahasil in District Sundargarh, Odisha Over an Area Of 14.826Ac. OR 6.000Ha. in Lieu of Oraghat Iron & Manganese Mines of S.A.Halim in Sundargarh district..

Scale 16"= 1 Mile

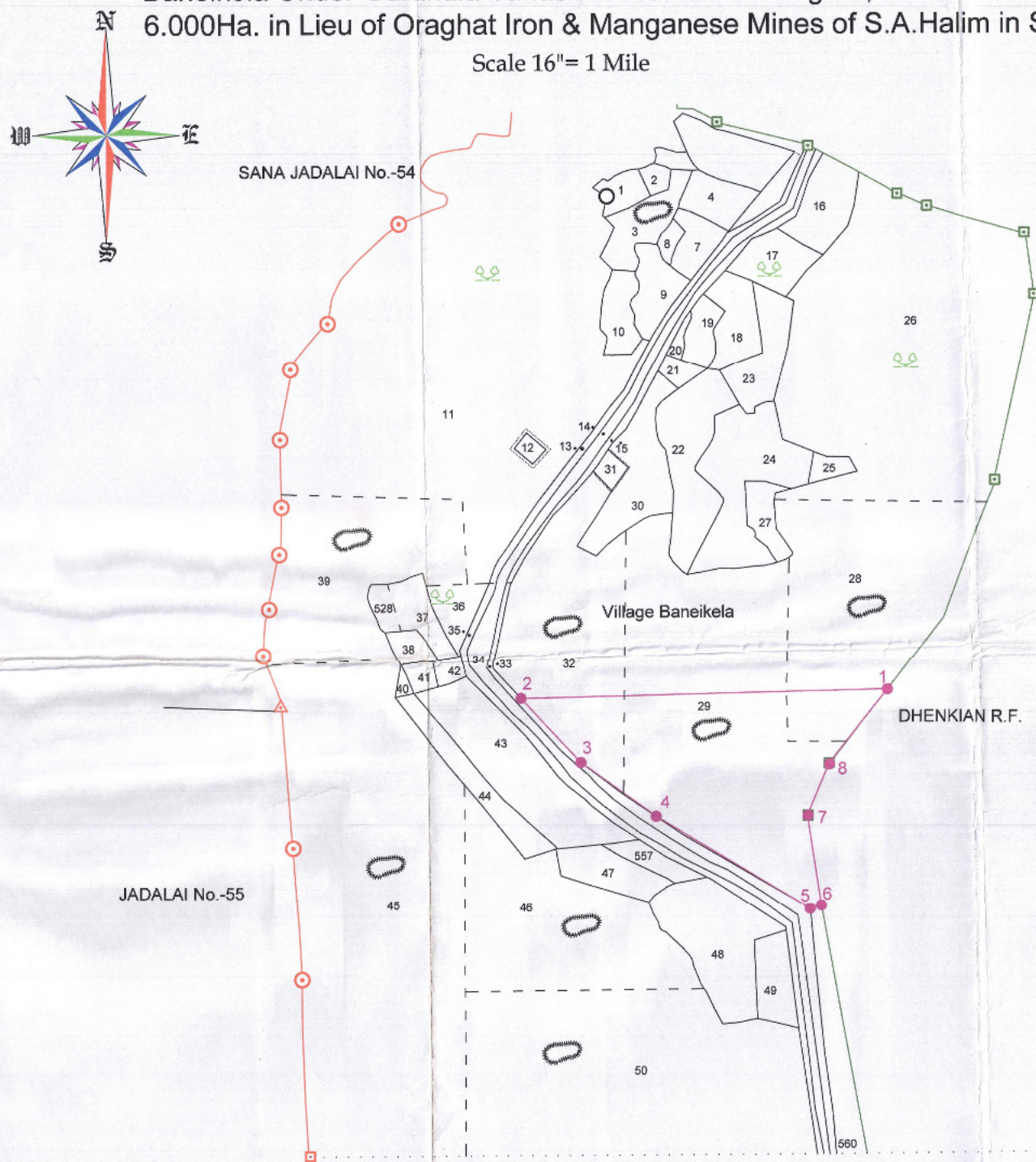

FIELD NOTE OF THE SELECTED AREA FOR COMPENSATORY AFFORESTATION OF ORAGHAT IRON & MANGANESE MINES OF S.A. HALIM IN SUNDARGARH DISTRICT.

LINE	FORE BEARING	BACK BEARING	DISTANCE (IN METER)
1-2	270° 00' 00"	90° 00' 00"	447.48
2-3	138° 00' 00"	318° 00' 00"	106.92
3-4	127° 00' 00"	307° 00' 00"	114.84
4-5	121° 00' 00"	301° 00' 00"	221.76
5-6	65° 00' 00"	245° 00' 00"	15.84
6-7	351° 00' 00"	171° 00' 00"	110.88
7-8	23° 00' 00"	203° 00' 00"	71.28
8-1	38° 00' 00"	218° 00' 00"	114.84

GPS READING OF THE SELECTED AREA FOR COMPENSATORY AFFORESTATION OF ORAGHAT IRON & MANGANESE MINES OF S.A. HALIM IN SUNDARGARH DISTRICT.

LINE	NORTH	EAST
1	21° 56' 48.5"	84° 47' 22.1"
2	21° 56' 48.2"	84° 47' 9.8"
3	21° 56' 45.7"	84° 47' 11.5"
4	21° 56' 43.5"	84° 47' 14.3"
5	21° 56' 38.2"	84° 47' 19.7"
6	21° 56' 38.4"	84° 47' 20.5"
7	21° 56' 42.5"	84° 47' 19.8"
8	21° 56' 45.3"	84° 47' 20"

SCHEDULE OF LAND SELECTED FOR COMPENSATORY AFFORESTATION OF ORGHAT IRON & MANGANESE MINES OF S.A. HALIM IN SUNDARGARH DISTRICT.

KHATA No.	PLOT No.	NAME OF TENANT.	KISSAM	TOTAL AREA IN Ac.	AQUIRED AREA IN Ac.	REMARKS.
66	28	AAA	PAHAD	12.86	1.241	PART
66	29	AAA	PAHAD	20.00	11.428	PART
66	32	AAA	PAHAD	10.19	2.157	PART
TOTAL				14.826Ac. OR 6.000Ha.		

BOUNDARY DESCRIPTION OF THE PLOT SELECTED FOR COMPENSATORY AFFORESTATION OF ORGHAT IRON AND MANGANESE MINES OF S.A. HALIM IN SUNDARGARH DISTRICT.

PLOT No.	EAST BOUNDARY	WEST BOUNDARY	NORTH BOUNDARY	SOUTH BOUNDARY
28	DHENKIAN R.F.	29	28(P)	DHENKIAN R.F.29
29	DHENKIAN R.F.28(P)	32(P),33	29(P)	33
32	29(P)	33	32(P)	33

### INDEX

	SELECTED AREA FOR COMPENSATORY AFFORESTATION
	REVENUE PLOTS
	RESERVED FOREST BOUNDARY
	VILLAGE BOUNDARY
	PUBLIC ROAD

### CERTIFICATE

Certified that,

1. The Non-Forest / Revenue forest land identified for Compensatory Afforestation is free from encroachment & encumbrances.
2. This area has not been allotted for any other purpose.
3. Section-4 notification has not been issued for any of the above plots.

### CERTIFICATE

Certified that,

1. This Non-Forest / Revenue forest Compact patch and suitable from management point of view.
2. The Non-Forest / Revenue forest has / has not been included in the DLC report.
3. This land is suitable for Compensatory Afforestation purpose.

Sayed Abdul Halim  
Mine Owner

SIGNATURE OF THE  
USER AGENCY

Forest Range Officer  
Tamara Range

Sectional Forester  
Gurundia Section

Divisional Forest Officer  
Batal Division

COUNTERSIGNED  
Divisional Forest Officer  
Batal Division