

S. NO.	LATITUDE			LONGITUDE		
	DEGREE	MINUTES	SECOND	DEGREE	MINUTES	SECOND
1	29	54	8.559	74	49	39.118
2	29	54	8.370	74	49	39.233
3	29	54	8.496	74	49	38.301
4	29	54	8.573	74	49	39.084
5	29	54	8.570	74	49	39.075
6	29	54	8.670	74	49	37.651
7	29	54	8.938	74	49	38.089
8	29	54	8.945	74	49	38.028
9	29	54	8.992	74	49	38.080
10	29	54	8.938	74	49	38.089

**DIVERSION PLAN OF FOREST LAND FOR FILLING  
STATION OF BPCL ENTRY & EXIT AT VILL. HAIBUANA  
ON KALANWALI DABWALI ROAD IN SIRSA DISTT.  
KILLA NO. 107/118/1**

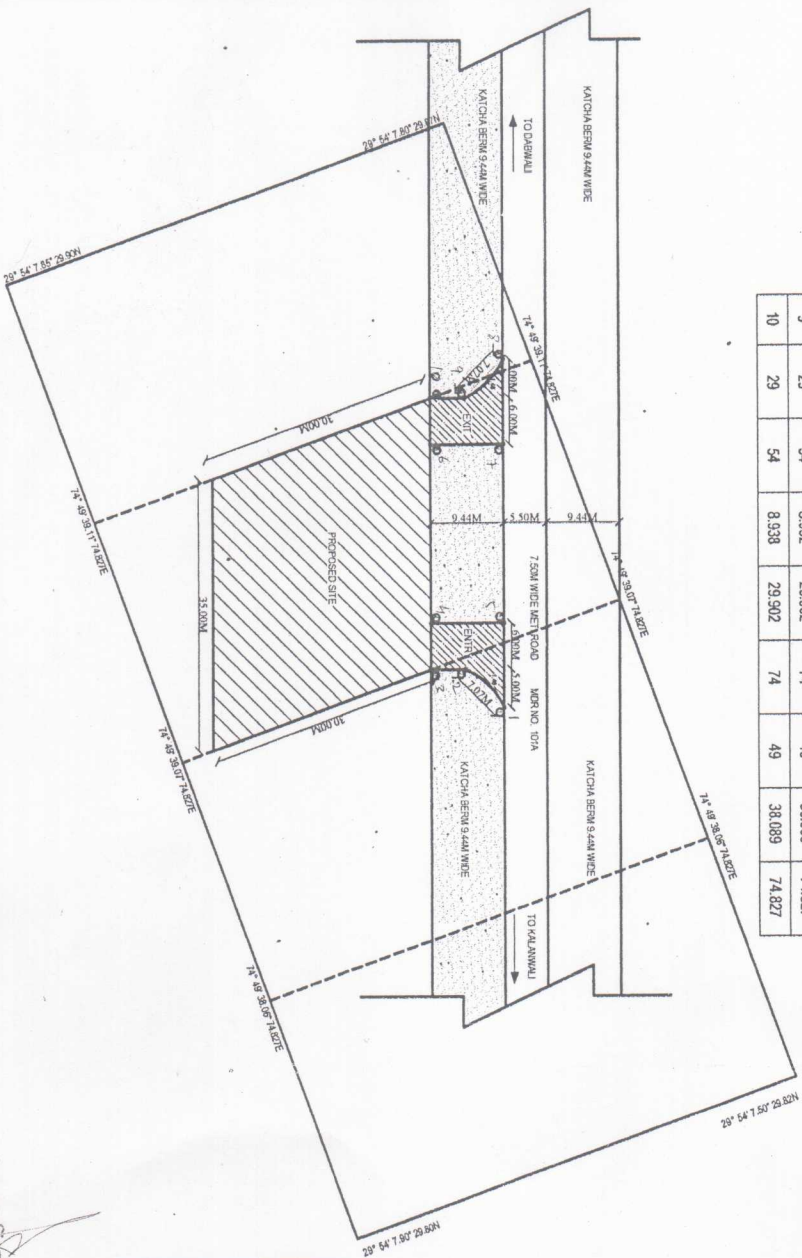

**DETAIL OF FOREST LAND USED FOR ACCESS**

ENTRY AREA DETAIL	
1. 9.44X3.50	= 33.24 SQ.MT.
2. 1/2 X L X H	= 1/2 X 5.00 X 5.00 = 12.50 SQ. MT.
3. LESS AREA OF NO 2	= 1/2 (0.71 X 1.49) = 0.53 SQ.MT.
4. TOTAL AREA	= (33.24 + 12.50 - 0.53) = 45.21 SQ. MT.

EXIT AREA DETAIL OF EXIST	
1. 9.44X3.50	= 33.24 SQ.MT.
2. 1/2 X L X H	= 1/2 X 5.00 X 5.00 = 12.50 SQ. MT.
3. LESS AREA OF NO 2	= 1/2 (0.71 X 1.49) = 0.53 SQ.MT.
4. TOTAL AREA	= (33.24 + 12.50 - 0.53) = 45.21 SQ. MT.

5. TOTAL AREA	
= ENTRY + EXIST	= 62.26 + 62.26
= 124.52 SQ.MT. OR 178 SQ.MT.	
	OR 0.0125 HECT.

Anurag Singh  
Staff No.: 10370  
A. M. Engr. Retail  
Hisar Territory  
Bharat Petroleum Corp. Ltd.

श्री अरुण सिंह (रिटेल)  
ए. एम. इंजी. रिटेल  
हिंसा (डिपार्टमेंट)



- Legend**
- Dips Point
  - Retail Outlet
  - Road
  - ▨ Entry / Exit
  - ▨ FOREST LAND

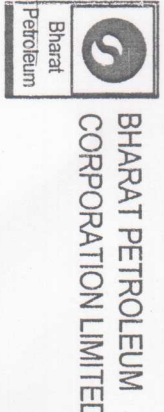

Map Prepared For  
**BPCL Retail Outlet**  
At Vill. HAIBUANA