

Digital GIS Map of Proposed Kanpur Lucknow Expressway (from Ch. 59+260 to Ch. 59+315)

Forest Area Coordinates

Point_ID	Latitude	Longitude
1	26° 28' 44.160" N	80° 34' 56.484" E
2	26° 28' 44.401" N	80° 34' 56.087" E
3	26° 28' 46.017" N	80° 34' 56.545" E
4	26° 28' 45.654" N	80° 34' 57.740" E
5	26° 28' 45.289" N	80° 34' 57.499" E
6	26° 28' 44.748" N	80° 34' 56.895" E

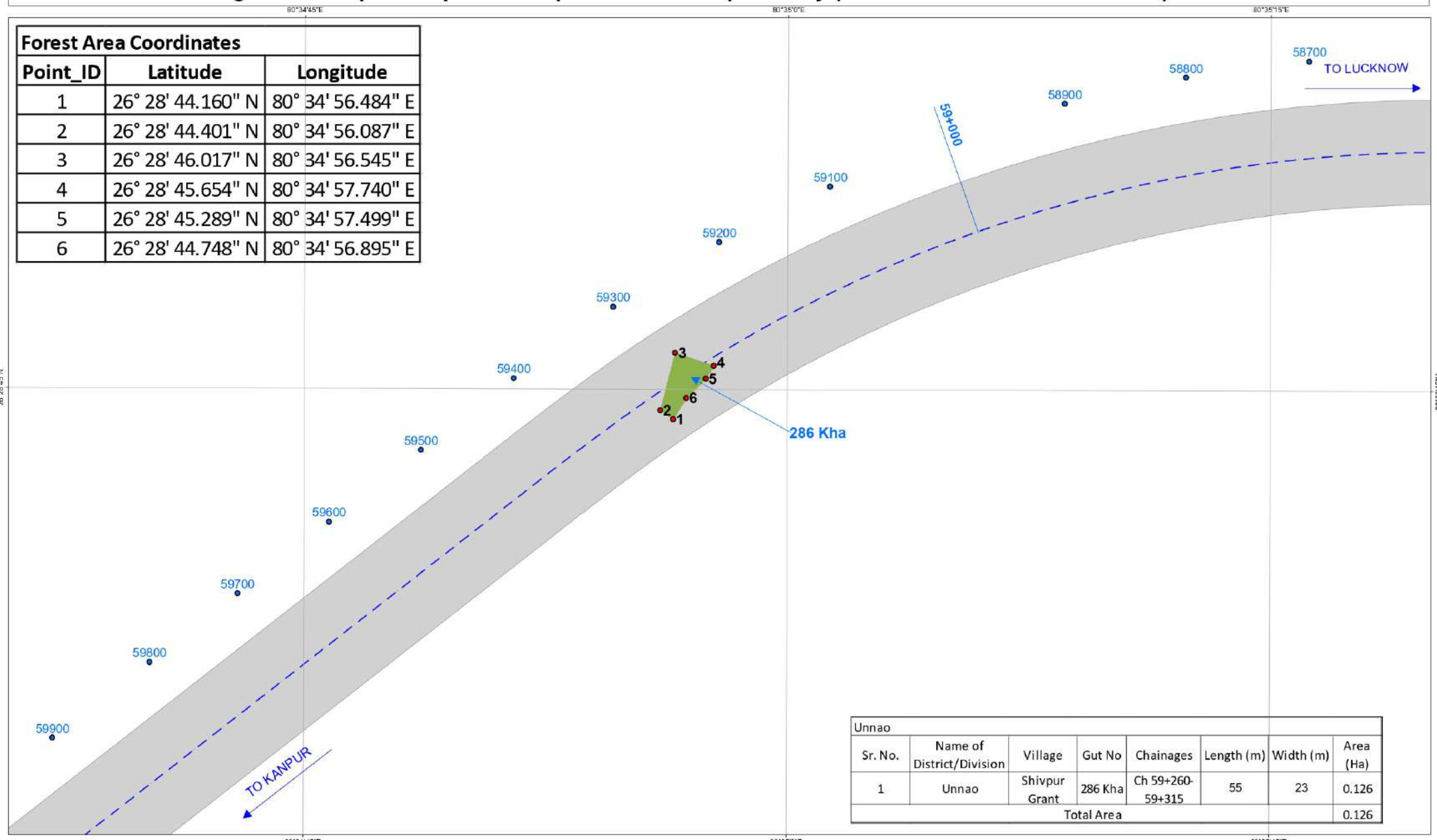

Unnao							
Sr. No.	Name of District/Division	Village	Gut No	Chainages	Length (m)	Width (m)	Area (Ha)
1	Unnao	Shivpur Grant	286 Kha	Ch 59+260-59+315	55	23	0.126
Total Area							0.126

CLIENT

CONSULTANT

Egis India Consulting Engineers Pvt Ltd.
Egis Tower , Plot No. 66, Sector-32,
Gurgaon, Haryana-122001, India

PROJECT

Project Development Consultancy Services for "Kanpur Lucknow Expressway Project"

LEGEND

- Reserved Forest (RF)
- Protected Forest (PF)
- Non Forest Land
- 1,2,3... GPS No.
- Road Centreline
- +1000 Road Chainages

TITLE

Reserved Forest in Unnao District Village- Shivpur Grant

Scale: 1:3,000 @ A3

Digital GIS Map of Proposed Kanpur Lucknow Expressway (from Ch. 65+450 to Ch. 65+510)

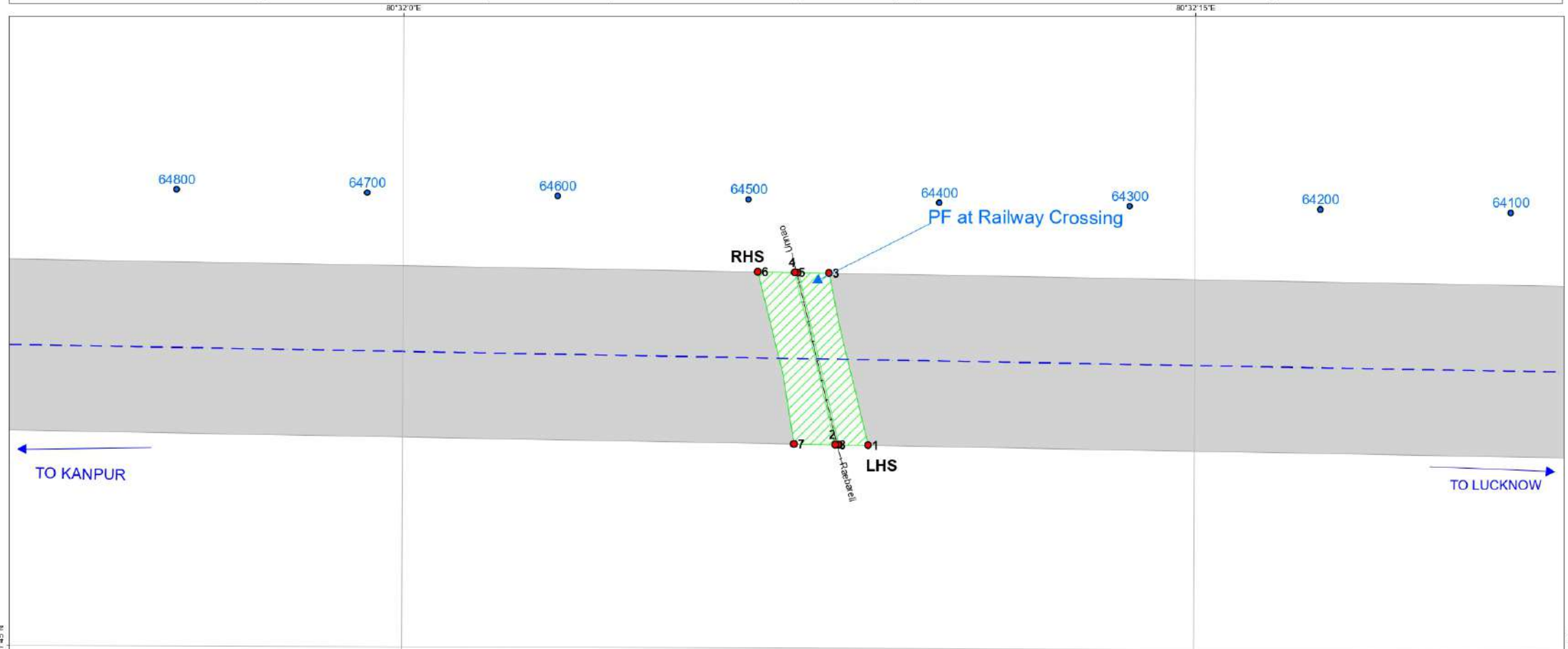

Forest Area Coordinates		
Point_ID	Latitude	Longitude
1	26° 27' 48.465" N	80° 32' 8.851" E
2	26° 27' 48.474" N	80° 32' 8.294" E
3	26° 27' 51.402" N	80° 32' 8.100" E
4	26° 27' 51.409" N	80° 32' 7.516" E
5	26° 27' 51.410" N	80° 32' 7.453" E
6	26° 27' 51.419" N	80° 32' 6.748" E
7	26° 27' 48.485" N	80° 32' 7.448" E
8	26° 27' 48.474" N	80° 32' 8.231" E

Unnao							
Sr. No.	Name of District/Division	Village	Chainages	Side	Length (m)	Width (m)	Area (Ha)
1	Unnao	Railway Crossing- Amarsus	Km 64+450-64+510	LHS	92.4	15	0.1381
				RHS	92.7	18.5	0.1771
Total Area							0.3152

CLIENT

CONSULTANT

Egis India Consulting Engineers Pvt Ltd.
Egis Tower , Plot No. 66, Sector-32, Gurgaon, Haryana-122001, India

PROJECT

Project Development Consultancy Services for "Kanpur Lucknow Expressway Project"

LEGEND

- Reserved Forest (RF)
- Protected Forest (PF)
- Non Forest Land
- 1,2,3... GPS No.
- Road Centreline
- 1+000 Road Chainages

TITLE **Protected Forest in Unnao District Railway Crossing Village- Amarsus**

Scale: 1:2,000 @ A3

Digital GIS Map of Proposed Kanpur Lucknow Expressway (from CH. 65+100 to CH. 66+300)

80°31'10"E

80°31'20"E

80°31'30"E

80°31'40"E

Protected Forest Details							
S.no.	Name of District/Division	Village	Chainages	Side	Length (m)	Average Width (m)	Area (Ha)
1	Unnao	Kurarai	KM 65+500	LHS	500	17.5	0.875
		Kalan &	to 65+850	RHS	500	19	0.95
Total Area							1.825

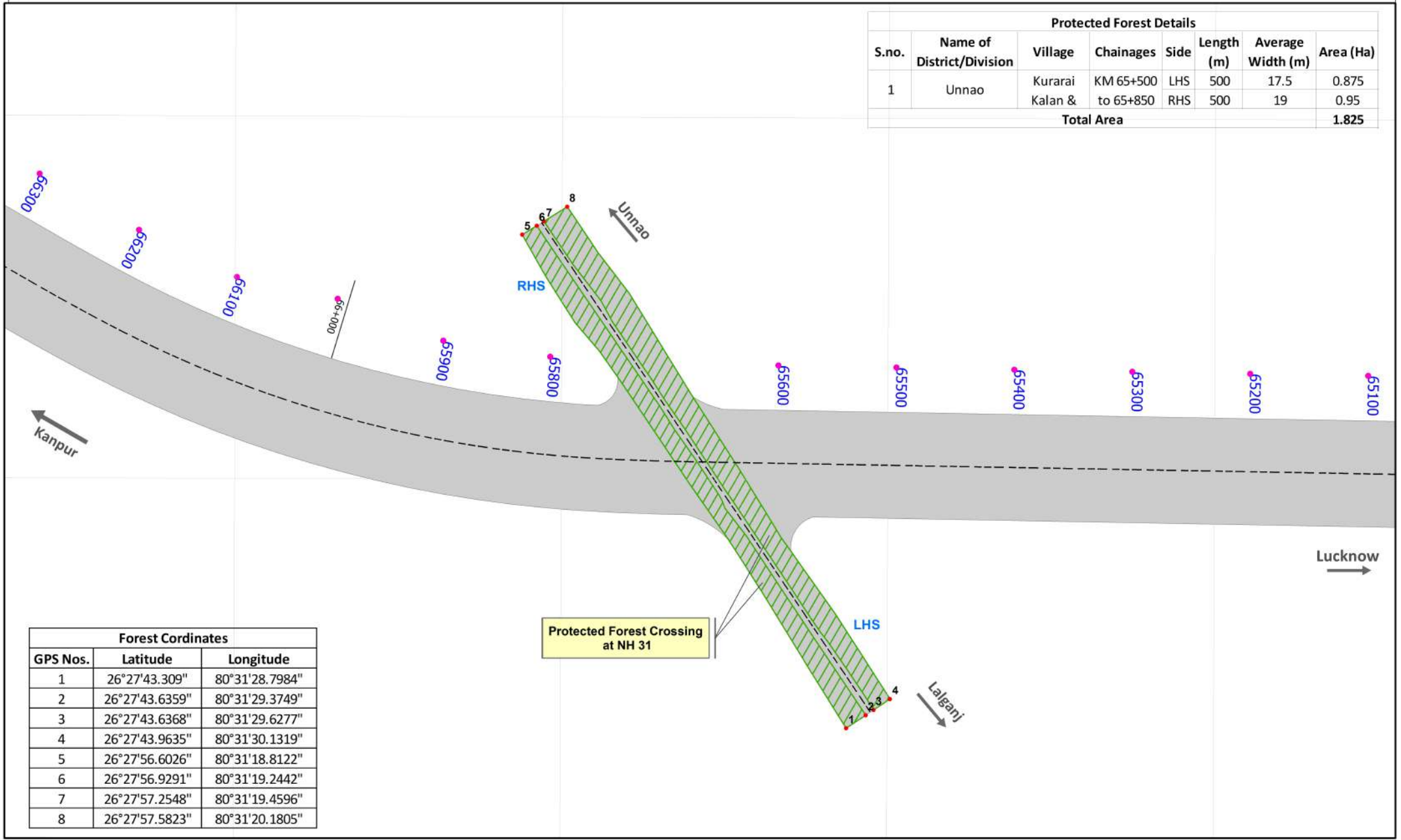

Forest Coordinates		
GPS Nos.	Latitude	Longitude
1	26°27'43.309"	80°31'28.7984"
2	26°27'43.6359"	80°31'29.3749"
3	26°27'43.6368"	80°31'29.6277"
4	26°27'43.9635"	80°31'30.1319"
5	26°27'56.6026"	80°31'18.8122"
6	26°27'56.9291"	80°31'19.2442"
7	26°27'57.2548"	80°31'19.4596"
8	26°27'57.5823"	80°31'20.1805"

Protected Forest Crossing at NH 31

LEGEND	
	GPS_Nos_PF_unnao_CH65+900
	Center_Line
	PF_Unnao
	Non_Forest_Area

Reserve Forest For Unnao District (Kanpur Lucknow Expressway) NH-232A Crossing

Scale: 1:2,957 @A3



CLIENT

CONSULTANT

egis

Egis India Consulting Engineers Pvt Ltd.
Egis Tower, Plot No. 66, Sector-32, Gurgaon, Haryana-122001, India

PROJECT

Consultancy Services for Preparation of Detailed Project Report of Kanpur - Lucknow Expressway, having an approximate length of 75km (the "Project") including spurs through BOT and EPC basis

Digital GIS Map of Proposed Kanpur Lucknow Expressway (from CH.73+000 to CH. 73+933)

80°26'30"E 80°26'40"E 80°26'50"E 80°27'0"E 80°27'10"E

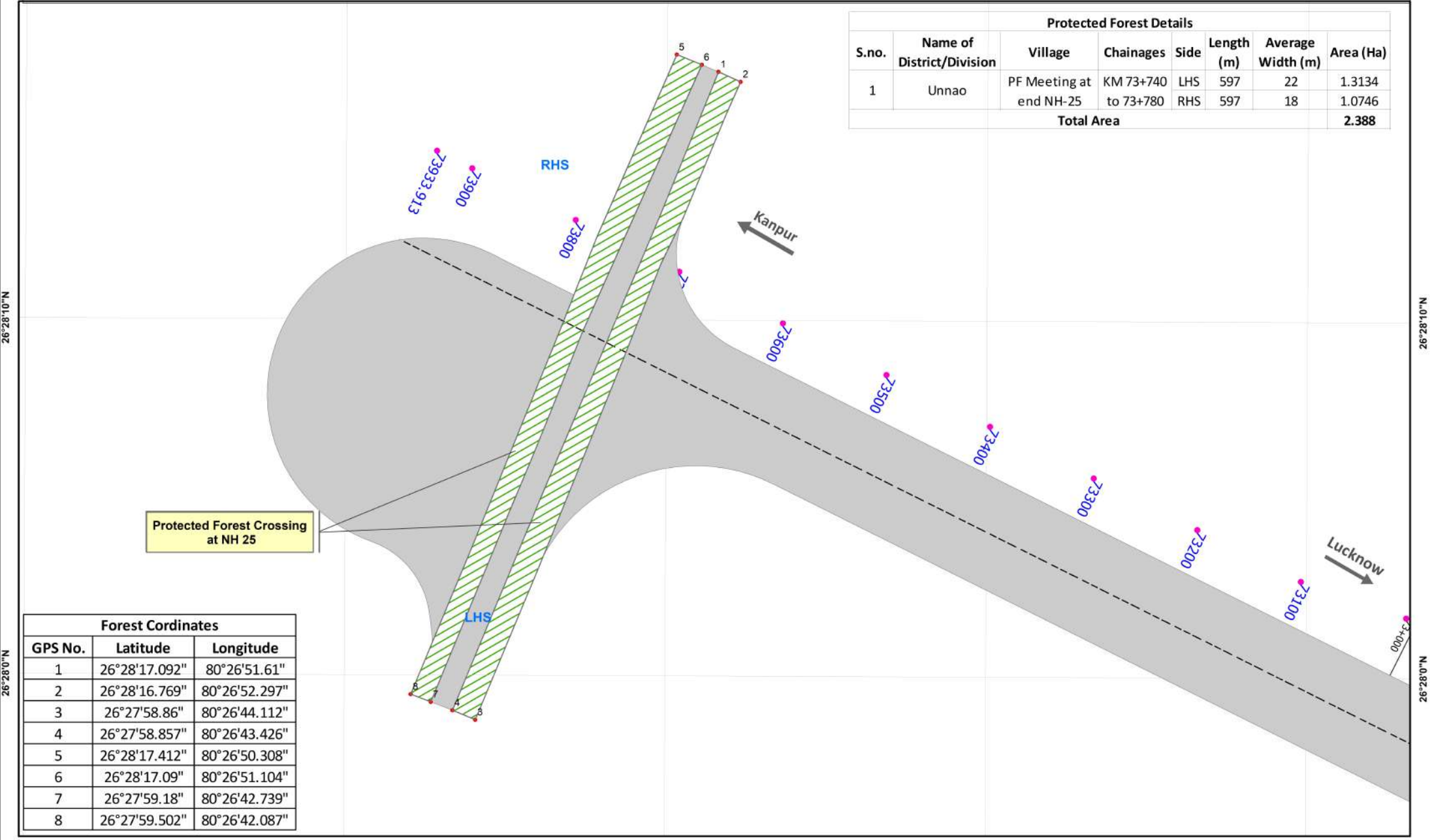

Protected Forest Details							
S.no.	Name of District/Division	Village	Chainages	Side	Length (m)	Average Width (m)	Area (Ha)
1	Unnao	PF Meeting at end NH-25	KM 73+740 to 73+780	LHS RHS	597 597	22 18	1.3134 1.0746
Total Area							2.388

Protected Forest Crossing at NH 25

Forest Coordinates		
GPS No.	Latitude	Longitude
1	26°28'17.092"	80°26'51.61"
2	26°28'16.769"	80°26'52.297"
3	26°27'58.86"	80°26'44.112"
4	26°27'58.857"	80°26'43.426"
5	26°28'17.412"	80°26'50.308"
6	26°28'17.09"	80°26'51.104"
7	26°27'59.18"	80°26'42.739"
8	26°27'59.502"	80°26'42.087"

80°26'30"E 80°26'40"E 80°26'50"E 80°27'0"E 80°27'10"E





CONSULTANT

 Egis India Consulting Engineers Pvt Ltd.
 Egis Tower, Plot No. 66, Sector-32, Gurgaon, Haryana-122001, India

PROJECT
 Consultancy Services for Preparation of Detailed Project Report of Kanpur - Lucknow Expressway, having an approximate length of 75km (the "Project") including spurs through BOT and EPC basis

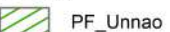
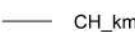
LEGEND

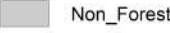
 PF_Unnao	 CH_km
 Center_Line	 GPS_Nos_PF_Unnao
 Non_Forest Area	

TITLE
 Protected Forest For Unnao District (Kanpur Lucknow Expressway) NH-25



Scale: 1:3,010 @A3

