

FOREST

SITE INFORMATION

1. TOTAL PLOT AREA	= 1219.96 SQM.
2. TOTAL BUILDING AREA	= 50.54 SQM.
KHEWAT NO.	38/36
KHATONI NO.	41
MUSTKIL NO.	25
KILA NO.	16/2,17,18,23,24,25/1

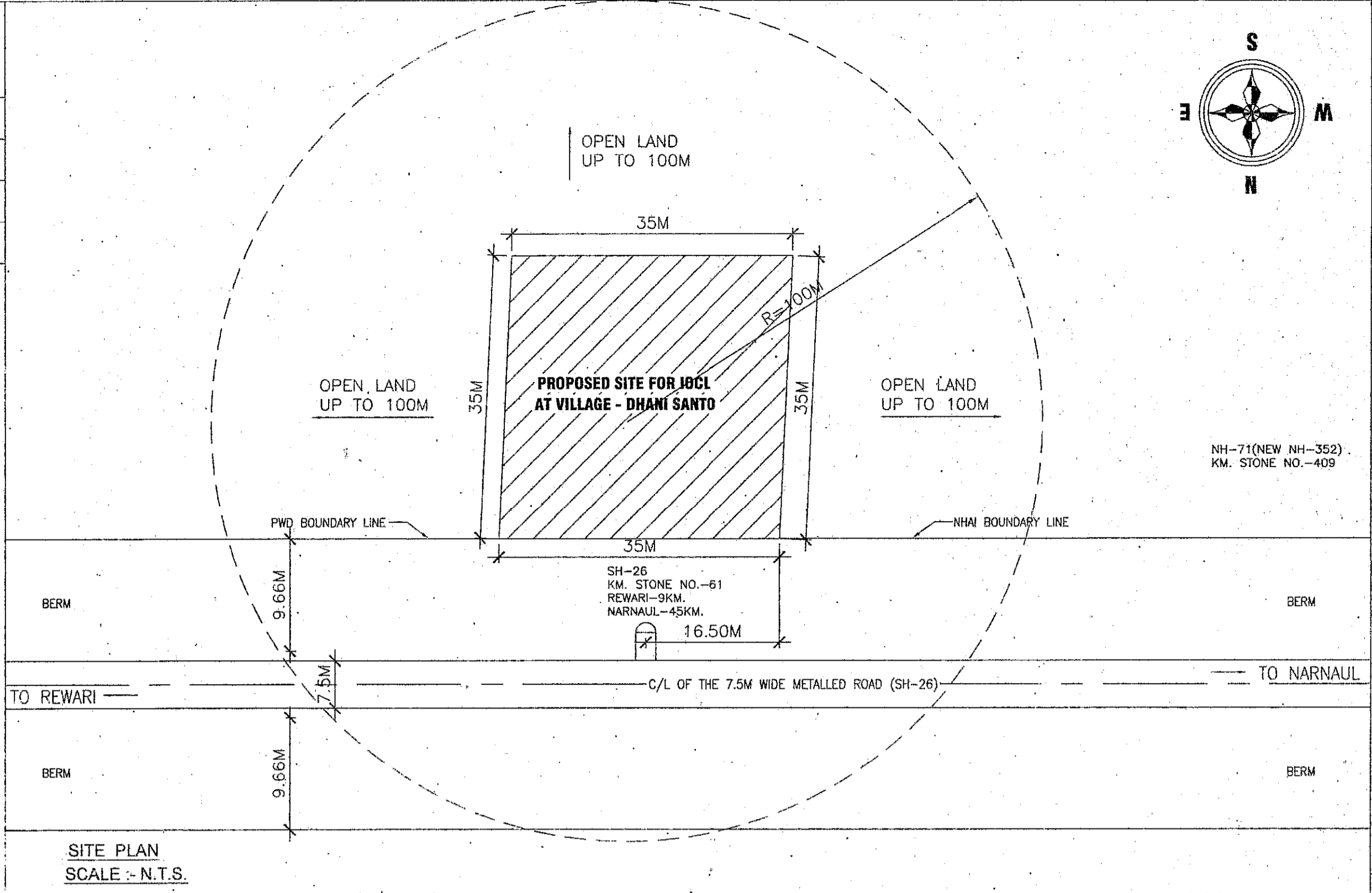
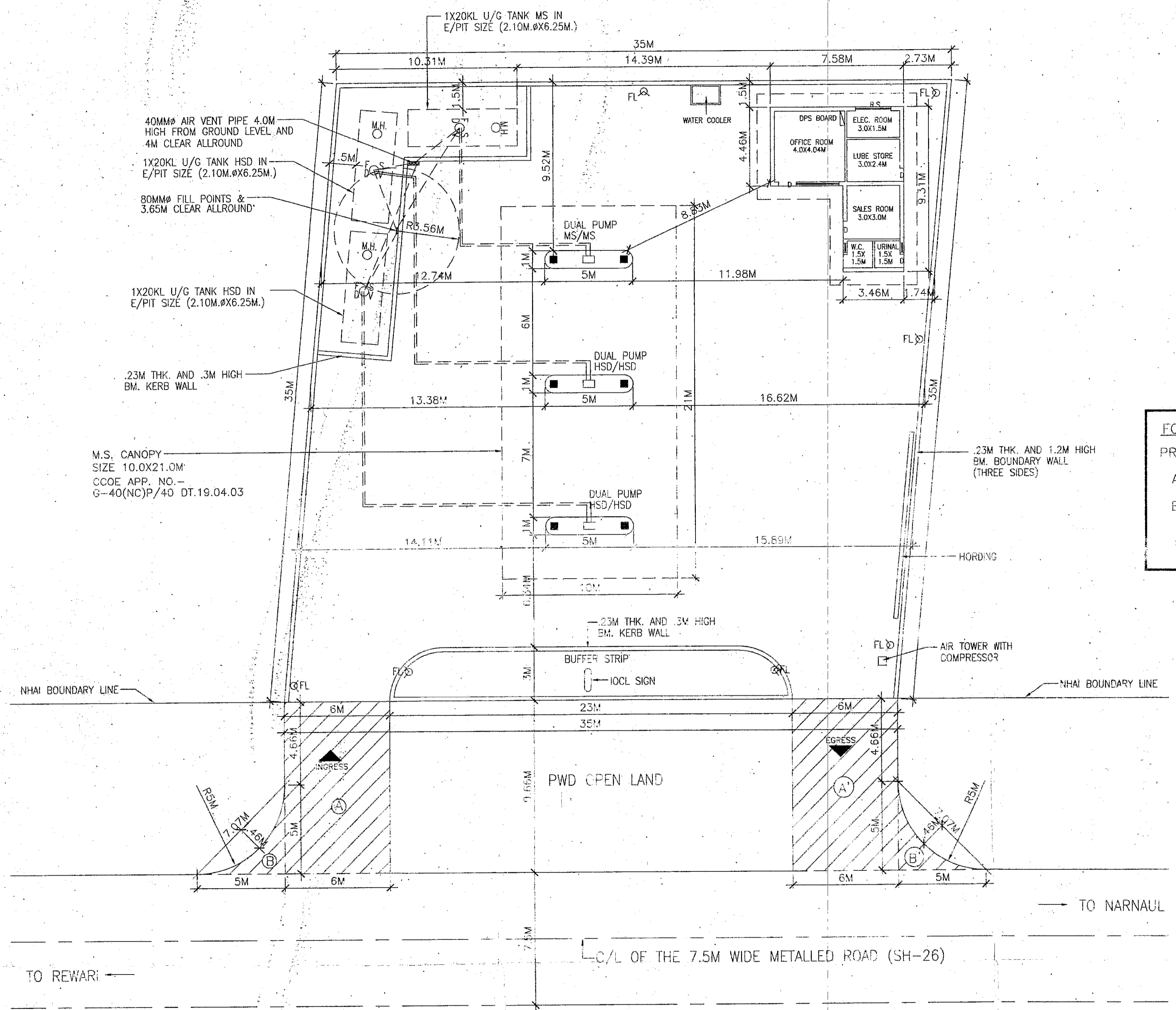
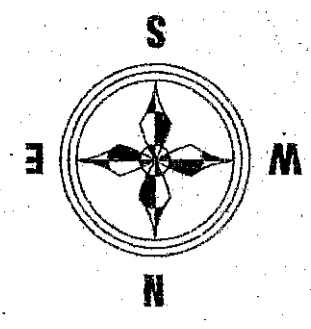

FOREST AREA CALCULATION

PROTECTED FOREST FOR APPROACH ROAD

$A+A' = 2 (0.65 \times 6) = 7.80 \text{ SQM.}$

$B+B' = 2 (1/2 \times 5 \times 5 + 2/3 \times 7.07 \times 1.46) = 11.24 \text{ SQM.}$

$C+C' = 12.16 \text{ SQM. OR } 0.0127 \text{ HA.}$

- NOTES :-**
- V= VENT PIPES 4 M HIGH AND 4.0 M CLEAR AROUND END COVERED WITH 2 LAYERS OF BRASS WIRE GAUGE 11 MESH PER LINEAR CENTIMETRE.
 - F= FILL POINTS FITTED WITH CAM LOCK COUPLE IN AND AIR TIGHT THREADED BRASS CAP FOR DECANTING FROM TANK LORRY.
 - D= DIP PIPES WITH CAP ASSEMBLY.
 - ALL ELECTRICAL FITTINGS ARE FLAME PROOF CONFORMING TO IS :2148.
 - ALL DOORS OF BUILDING TO BE OPENED OUTWARDLY.
 - NO SEWER OR SURFACE DRAIN WITHIN 6 M OF THE U/G TANKS & D/U.
 - PREMISES TO BE USED FOR ONLY STORAGE OF PETROLEUM PRODUCTS.
 - TANKS ARE PAINTED WITH TWO LAYERS OF HOT BITUMEN OVER TWO COATS OF RED LEAD PRIMER TO PROTECT AGAINST CORROSION.
 - FABRICATION DESIGN OF UNDER GROUND STORAGE TANK ARE CONFORMING TO IS: 10987:1992 AS PER C.C.O.E. NAGPUR ORDER NO. G-40 (SC)/P/MISC. 94. DATED 24.02.95.
 - ALL DIMENSIONS ARE IN MM UNLESS OTHERWISE NOTED.
 - S.B.- SAND BUCKET 10 NO'S AS PER EXPLOSIVE RULES.
 - F.F.- FIRE EXTINGUISHER-10 NO'S AS PER EXPLOSIVE RULES.
 - TANK GIVEN HYDROULIC PRESSURE TEST PRIOR TO INSTALLATION AND BEFORE ANY PROTECTIVE COATING AS APPLIED. THE TEST SHOULD BE MENTIONED AT A CONTROLLED PRESSURE OF 0.36 KG/SQ.C.M. FOR 2 HOURS
 - DIP ROD SUPPLIED WITH THE TANK FOR THIS TYPE OF INSTALLATION SHOULD BE 3280 MM LONG INSTEAD OF STANDARD 2350 MM.
 - FABRICATION THICKNESS OF SHELL PLATES AND END PLATE OF TANKS:
20 KL SHELL- 6 MM
END - 8 MM
 - TANKS CONFORMS TO 124, 125 & 131 OF THE PETROLEUM RULE - 2002.
 - ALL LIGHT POLES ARE FITTED AS PER APPROVAL OF C.C. NAGPUR WIDE LETTER NO. PL-III(MB) DATED:26.11.1963.
 - NATURAL DOWN SLOPE FROM THE EDGE OF METALLED ROAD TO CULVERT ON APPROACHES WILL BE MAINTAINED FREE FLOW OF WATER TOWARDS DRAIN.
 - SITE MEETS APPLICABLE IRC 1983 NORMS WITH LATEST AMENDMENTS.
 - EV = EXTENDED VENT POINTS
F = EXTENDED FILL POINTS.
 - THE PROPOSED SITE IS FREE FROM ANY TYPE OF LITIGATION AND NO CASE IS PENDING IN ANY COURT OF LAW.
 - NO ELECTRIC LINE PASSING OVER THE R.O. PREMISES.

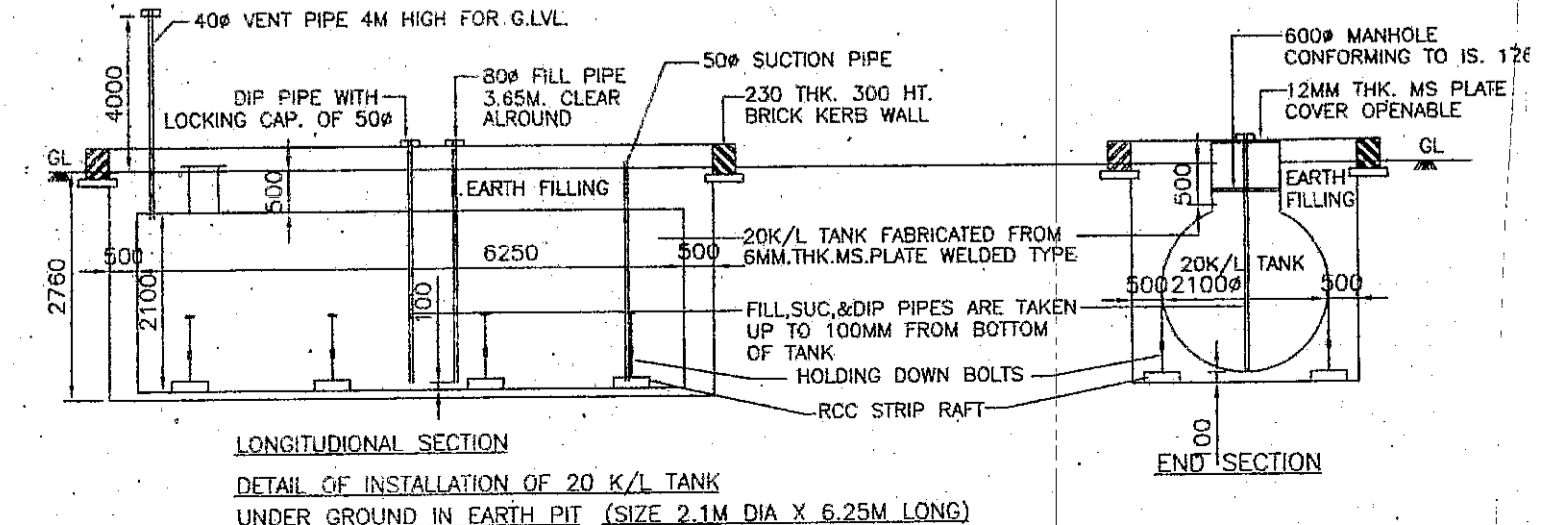
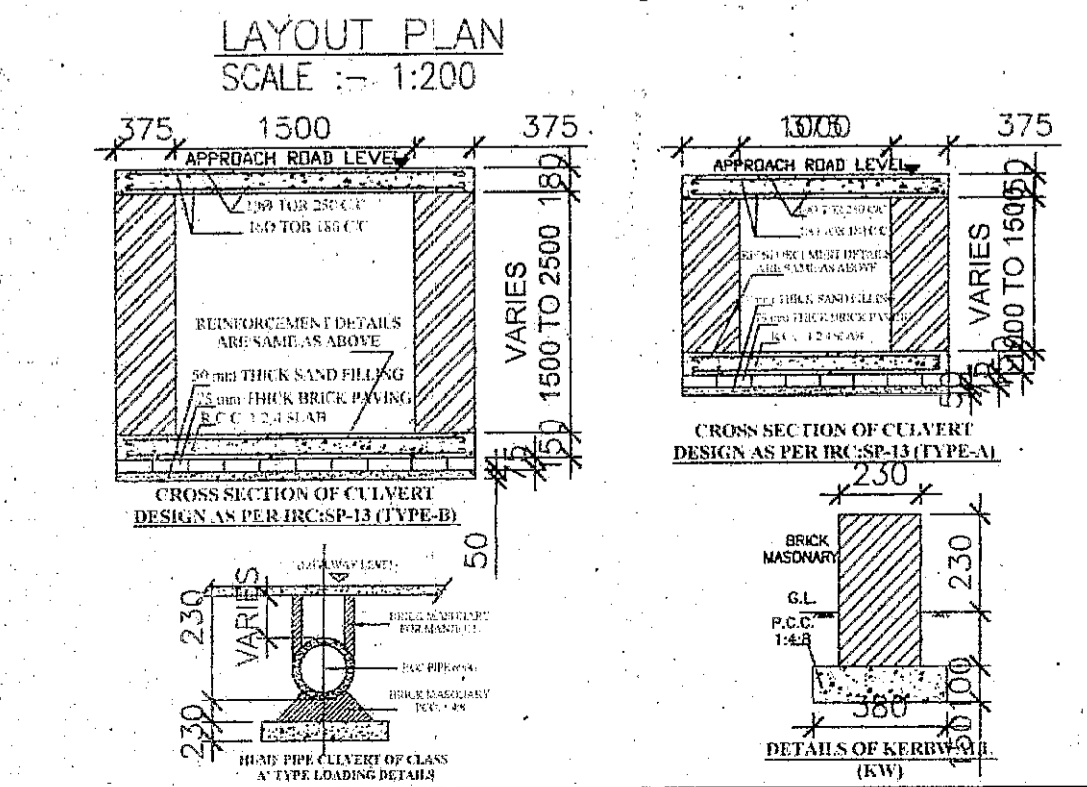
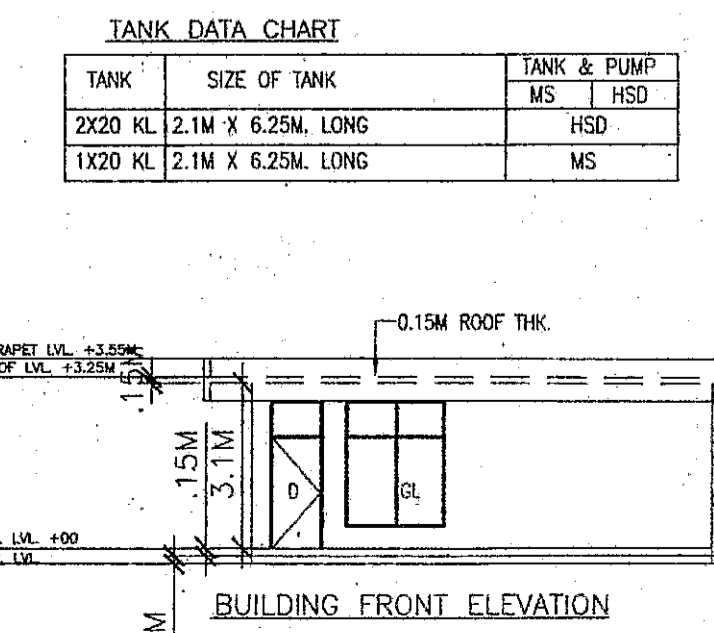
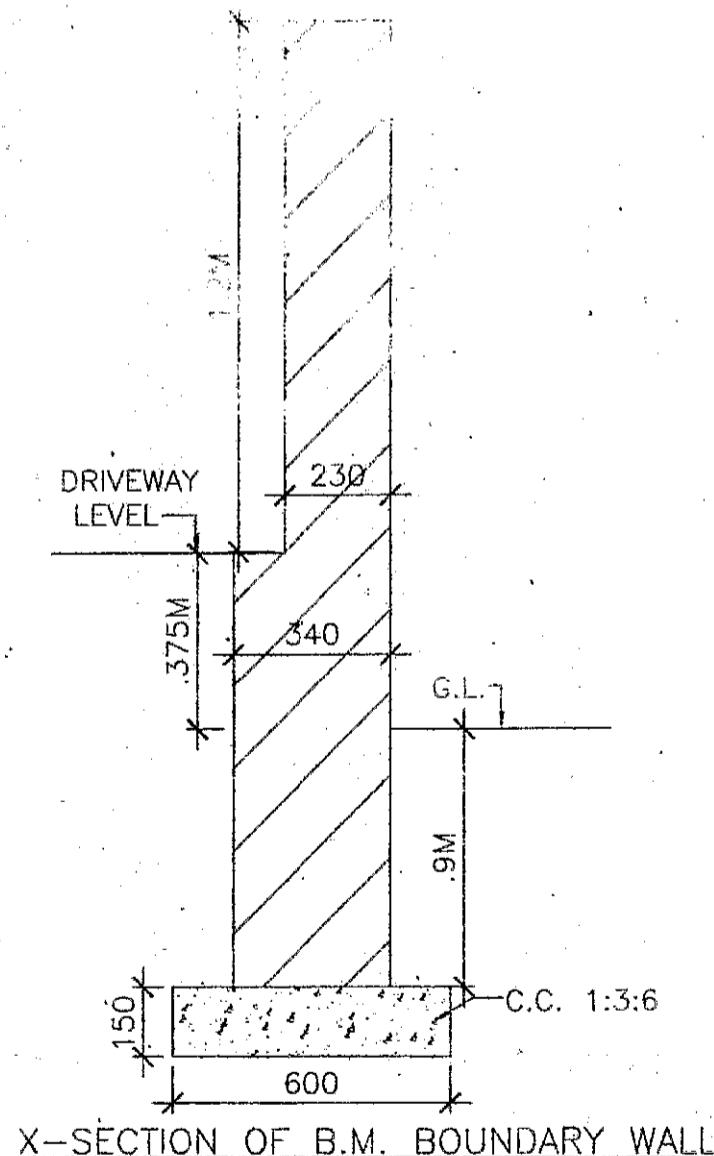

DATE	REV. No.	BRIEF DESCRIPTION OF REVISIONS MADE	CHECKED
	REV-1		
	REV-2		
	REV-3		

Indian Oil Corporation Limited
(Marketing Division)
Gurgaon Divisional Office,

IndianOil

SUBJECT :- PROPOSED RETAIL OUTLET MSHSD FACILITY ON REWARI-NARNAUL ROAD (SH-26), AT VILLAGE - DHANI SANTO TEHSIL-REWARI, DISTRICT - REWARI (HARYANA)

KHASRA NO.	-	POLICE STATION	RAMPUR
DRAWN BY.	MTO	RLY STATION	KHORI
APPROVED BY		STATE	HARYANA
CHECKED BY		SCALE	1:150
EXP. LICENCE NO.	NEW R/O	DRAWING NO.	GDO/S/12014

PREPARED BY:- MICRO TECH ONE NEW DELHI
MOBILE NO. 9971100480
Email-microtech_2007@rediffmail.com

DY./SR.MGR.(ENGG) MGR.(RS)/SM(RS) CDRSM, GDO