

THE TOPO (Location) MAP SHOWING THE CA (COMPENSATORY AFFORISTATION ) AREA IDENTIFIED IN SY. NO.53 OF SINGAPPAGARAPALLI VILLAGE, & SY. NO.62 OF DEVALA VARAPALLI VILLAGE , PATHAPALYA HOBLI , BAGEPALLI TALUK & RANGE, CHIKKABALLAPURA DISTRICT & DIVISION . AGAINST PROJECT FOR THE IMPROVEMENT OF THE RURAL ROAD IN THE SCHEME OF PRADHAN MANTRI GRAM SADAK YOJANA (PMGSY). - (IMPROVEMENT TO THE ROAD CONNECTING FROM PATHAPALYA TO POLANAYAKANAHALLI Via. KAMASANAHALLI, PEDDANAGURLU IN BAGEPALLI TALUK, CHIKKABALLAPURA DISTRICT,) IN FAVOR OF EXECUTIVE ENGINEER (EE), KARNATAKA RURAL ROAD DEVELOPMENT AGENCY (KRRDA), CHIKKABALLAPURA - 562 101.

AREA DETAILS OF THE CA (COMPENSATORY AFFORISTATION ) AREA IDENTIFIED IN SY. NO.53 OF SINGAPPAGARAPALLI VILLAGE, & SY. NO. 62 OF DEVALA VARAPALLI VILLAGE , PATHAPALYA HOBLI , BAGEPALLI TALUK & RANGE, CHIKKABALLAPURA DISTRICT & DIVISION . AGAINST PROJECT FOR THE IMPROVEMENT OF THE RURAL ROAD IN THE SCHEME OF PRADHAN MANTRI GRAM SADAK YOJANA (PMGSY). - (IMPROVEMENT TO THE ROAD CONNECTING FROM PATHAPALYA TO POLANAYAKANAHALLI Via. KAMASANAHALLI, PEDDANAGURLU IN BAGEPALLI TALUK,CHIKKABALLAPURA DITRICT,) - IN FAVOR OF EXECUTIVE ENGINEER (EE), KARNATAKA RURAL ROAD DEVELOPMENT AGENCY (KRRDA), CHIKKABALLAPURA - 562 101.

SL. NO.	DESCRIPTION	EXTENT IN Ha.	SY. NO.	VILLAGE	HOBLI	TALUK	DISTRICT
1	PROPOSED CA (COMPENSATORY AFFORISTATION ) AREA IDENTIFIED	1.7524	53	SINGAPPAGARAPALLI	PATAPALYA	BAGEPALLI	CHIKKABALLAPURA
2		0.6822	62	DEVALA VARAPALLI	PATAPALYA	BAGEPALLI	CHIKKABALLAPURA
GRAND TOTAL IN Ha		2.4346					

GPS DETAILS OF THE CA (COMPENSATORY AFFORISTATION) AREA IDENTIFIED IN SY. NO.53 OF SINGAPPAGARAPALLI VILLAGE, & SY. NO. 62 OF DEVALA VARAPALLI , VILLAGE , PATHAPALYA HOBLI , BAGEPALLI TALUK & RANGE, CHIKKABALLAPURA DISTRICT & DIVISION . AGAINST PROJECT FOR THE IMPROVEMENT OF THE RURAL ROAD IN THE SCHEME OF PRADHAN MANTRI GRAM SADAK YOJANA (PMGSY). - (IMPROVEMENT TO THE ROAD CONNECTING FROM PATHAPALYA TO POLANAYAKANAHALLI Via. KAMASANAHALLI, PEDDANAGURLU IN BAGEPALLI TALUK,CHIKKABALLAPURA DITRICT,) -IN FAVOR OF EXECUTIVE ENGINEER (EE), KARNATAKA RURAL ROAD DEVELOPMENT AGENCY (KRRDA), CHIKKABALLAPURA - 562 101.- DATUM :- WGS-84 , Hddd. dddd°

SL. NO.	GPS ID	NORTHING	EASTING	REMAKS
1	CA-1	N13.72795	E77.98468	GPS BOUNDARY POINTS CA (COMPENSATORY AFFORISTATION) AREA IDENTIFIED IN SY. NO.53 OF SINGAPPAGARAPALLI VILLAGE, & SY. NO. 62 OF DEVALA VARAPALLI VILLAGE , BAGEPALLI TALUK
2	CA-2	N13.72700	E77.98509	
3	CA-3	N13.72549	E77.98313	
4	CA-4	N13.72580	E77.98290	
5	CA-5	N13.72721	E77.98398	
6	CA-6	N13.72753	E77.98382	

ENLARGED VIEW  
SCALE :NTS

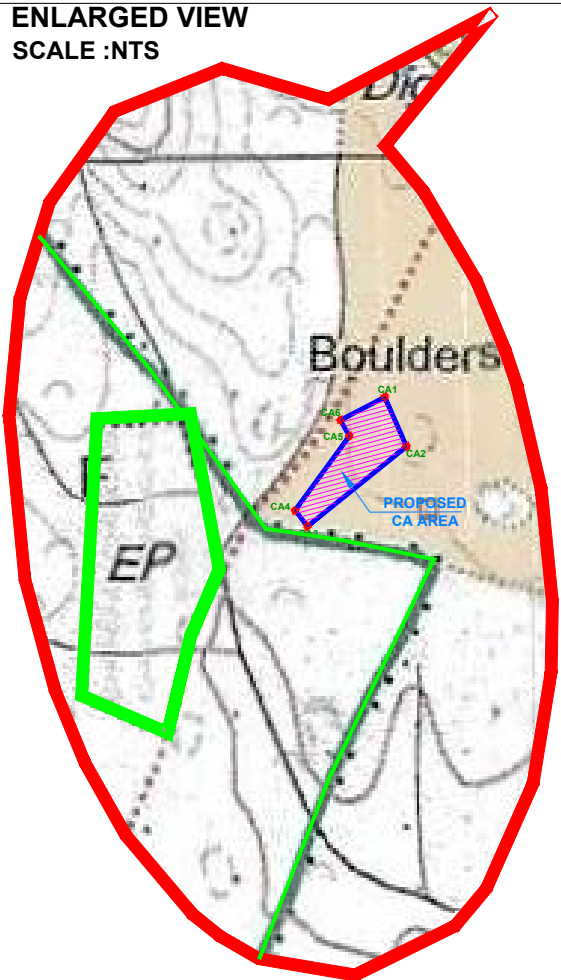

SY. NO. : 53.(PART)  
VILLAGE : SINGAPPAGARAPALLI.  
HOBLI : PATHAPALYA.  
TALUK : BAGEPALLI.  
DISTRICT : CHIKKABALLAPURA.

SY. NO. : 62. (PART).  
VILLAGE : DEVALA VAARAPALLI.  
HOBLI : PATHAPALYA.  
TALUK : BAGEPALLI.  
DISTRICT : CHIKKABALLAPURA.

SEAL & SIGNATURE

EXECUTIVE ENGINEER  
Project Division (PMGSY)  
CHICKBALLAPUR

SCALE :-1:50000



INDEX

SL No.	SYMBOL	DESCRIPTION
01		PROPOSED CA (COMPENSATORY AFFORISTATION) BOUNDARY
02		FOREST AREA BOUNDARY.
03		GPS STATION POINTS

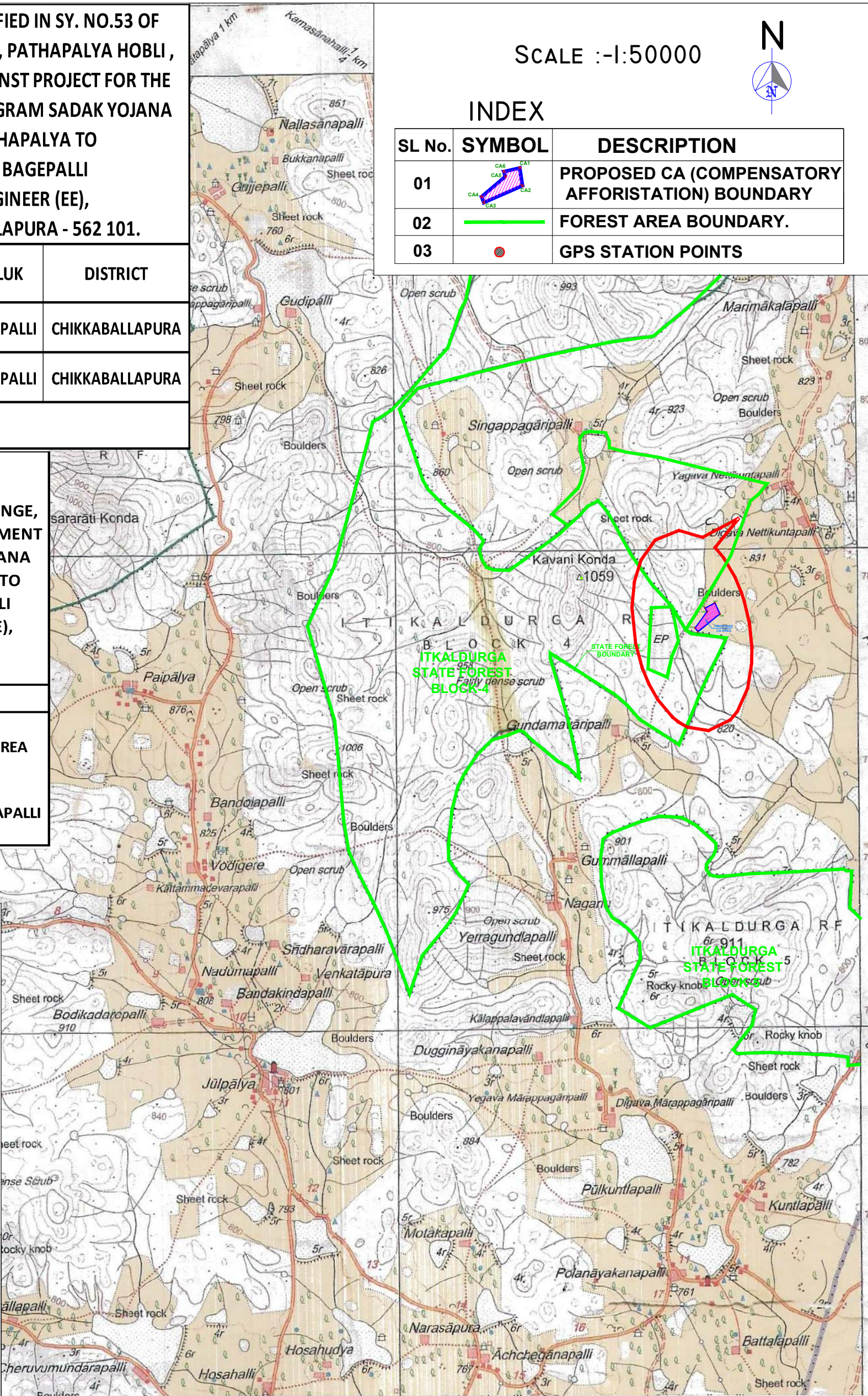

TOPO SHEET NO.:D43R14